



# IMILAB EC5 Floodlight Camera User Manual

Please read this manual carefully before using the device  
and retain it for future reference.

# Product Introduction

---

## • Package list

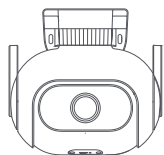

IMILAB EC5 Floodlight Camera

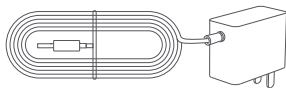

Power adapter



Wall mounting pack



Wall/ceiling mounting positioning stickers



User manual

## • Product Appearance

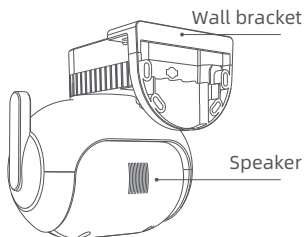
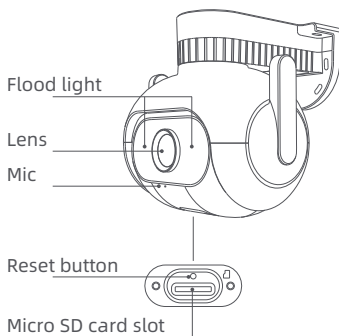

# Installing the Device

---

The device can be wall mounted, ceiling mounted or tied around a support.

- Wall mounting

1. Attach the wall mounting positioning sticker on the desired installation location on a wall. Drill two holes at the positions indicated on the sticker. Drilling diameter of around 6.0 mm; drilling depth of around 30mm.

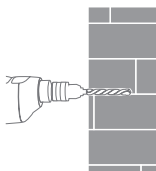
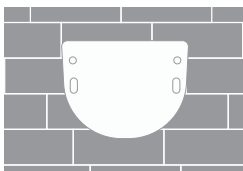

2. Insert two plastic expansion nuts into the wall. Put the base plate on the wall. Secure the base plate by inserting the screws into the expansion nuts.

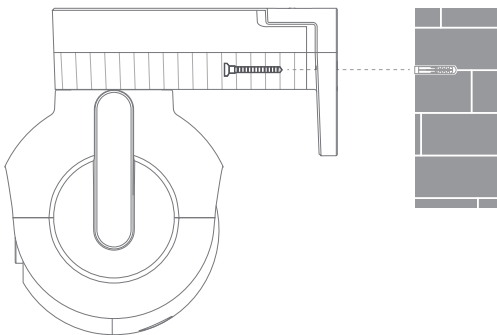

- Ceiling mounting

1. Attach the ceiling mounting positioning sticker on the desired installation location on the ceiling. Drill two holes at the positions indicated on the sticker. Drilling diameter of around 6.0 mm; drilling depth of around 30mm.

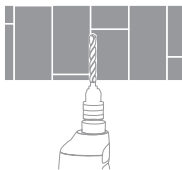
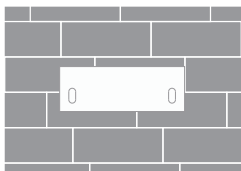

2. Insert two plastic expansion nuts into the wall. Put the base plate on the ceiling. Secure the base plate by inserting the screws into the expansion nuts.

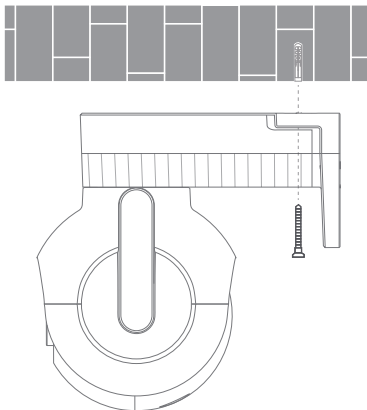

- Pole mounting

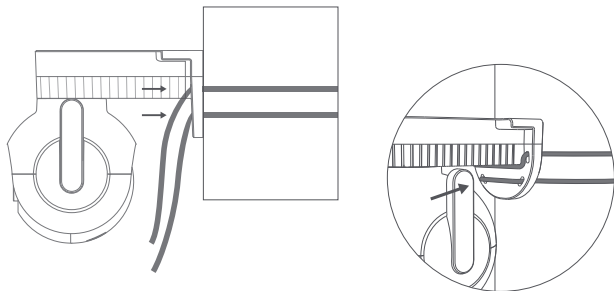

## Connecting the Device

---

- Turn on the camera

Insert the power supply cable into the camera's power supply port. Connect the other end of the power supply cable to a power source.

- Insert a micro SD card.

Ensure that the camera is disconnected from the power supply. Use a screwdriver to remove the protective case and expose the micro SD card slot.

The contact points of the micro SD card should be facing down. Insert the micro SD card into the slot.

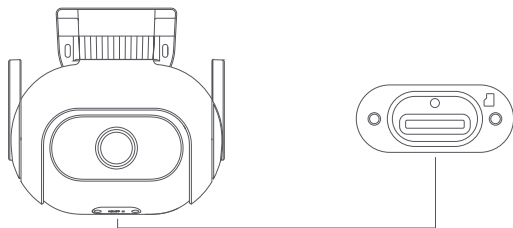

Note:

When inserting or removing the micro SD card, please disconnect the camera from the power supply. Please use a micro SD card from a reputable manufacturer (up to 256GB). The recommended read and write speed of the micro SD card is at least U1/Class 10.

- Restoring factory settings

Press and hold the reset button to restore the factory settings. The content inside the micro SD card will not be deleted.

## Connecting to Mi Home App

---

This product works with Mi Home and can be controlled using the Mi Home app.

Scan the QR code to download and install the Mi Home app. If you already have Mi Home app installed, you will be directed to the device connection page. You can also search for "Mi Home" in an app store to download and install the Mi Home app. Open the Mi Home app. Tap "+" at the top right corner and following the on-screen instructions to add the device.



64295C5D

Note: Actual operation may differ due to Mi Home app update. Please follow the on-screen instructions of the Mi Home app.

# About works with mijia

---

“works with mijia” signifies that the product herein is designed to connect and interact with Mi Home app or Mi AI. Please be noted that the product herein is certified by the app interaction only. Xiaomi and Mijia are not responsible for any of the product manufacturing, safety and regulatory standards, or quality supervision.



## Specifications

---

Name: IMILAB EC5 Floodlight Camera

Model: CMSXJ55A

Input: 12V $\overline{\text{---}}$ 1A

Resolution: 2304 x 1296

Operating Temperature: -30°C ~ 60°C

Wireless Connectivity: Wi-Fi IEEE 802.11 b/g/n 2.4GHz

Dimensions: 139 x 128 x 135 mm

Net Weight: 630 g

Viewing Angle: 95°

Aperture: F2.1

IP rating: IP66

FCC ID: 2APA9-CMSXJ55A

# Full Color Night Vision

---

The light sensor can automatically switch the device to night vision mode through IR-CUT based on changes in the lighting of the environment. Built-in high power exposure light can present colorful images even in the darkness.



Night vision effect illustration

## Video Playback

---

Past videos can only be viewed when a compatible micro SD card is inserted in IMILAB EC5 Floodlight Camera. After inserting a micro SD card and turning on the device, the camera will automatically start recording.

In the control interface for IMILAB EC5 Floodlight Camera in the Mi Home app, tap the playback button to enter the video playback page. You can also view a recording by selected a time period.

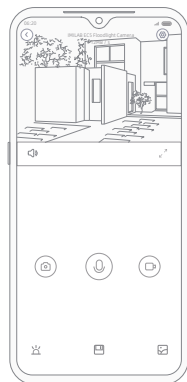

# Sharing a Video

---

In the control interface for IMILAB EC5 Floodlight Camera in the Mi Home app, you can set the device as a shared device in the settings menu and invite others to watch the recordings. Users must download the Mi Home app and login to their Xiaomi account in order to view the recordings of the shared device.



## Note:

The illustrations are for reference only. The pages may differ based on actual Mi Home app version and mobile phone operating system.

# Home Security

---

The Home Security function can be turned on/off in the control interface for IMILAB EC5 Floodlight Camera in the Mi Home app.

The device can detect and record movements within the viewing angle and push the recording to the client. Users can set the surveillance time, alert sensitivity, alert interval, etc.



## Note:

The illustrations are for reference only. The pages may differ based on actual Mi Home app version and mobile phone operating system.

# Precautions

---

- The working temperature of the device is -30°C to 60°C. Do not use the device when the temperature is too high or too low.
- For better results, avoid placing the camera in front of or next to a glass surface, a white-colored wall or other reflective surfaces as this may cause the recording to have un-even lighting between the foreground and background or be over-exposed.
- Please ensure that the device is within Wi-Fi signal coverage.
- Place it at a location with good Wi-Fi signal strength.
- Try to avoid placing the device near a metallic object, a microwave oven or other objects that may cause signal interference.

## FCC Statement

---

Changes or modifications not expressly approved by the party responsible for compliance could void the user's authority to operate the equipment. This device complies with Part 15 of the FCC Rules.

Operation is subject to the following two conditions:

- (1) This device may not cause harmful interference, and
- (2) This device must accept any interference received, including interference that may cause undesired operation.

Note: This equipment has been tested and found to comply with the limits for a Class B digital device, pursuant to Part 15 of the FCC Rules. These limits are designed to provide reasonable protection against harmful interference in a residential installation. This equipment generates, uses, and can radiate radio frequency energy, and if not installed and used in accordance with the instructions, may cause harmful interference to radio communications. However, there is no guarantee that interference will not occur in a particular installation. If this equipment does cause harmful interference to radio or television reception, which can be determined by turning the equipment off and on, the user is encouraged to try to correct the interference by one or more of the following measures:

-Reorient or relocate the receiving antenna.

- Increase the separation between the equipment and receiver.
- Connect the equipment into an outlet on a circuit different from that to which the receiver is connected.

-Consult the dealer or an experienced radio/TV technician for help.

FCC 20cm Statement: This equipment complies with FCC radiation exposure limits set forth for an uncontrolled environment. This equipment should be installed and operated with a minimum distance of 20cm between the radiator & your body. This transmitter must not be co-located or operating in conjunction with any other antenna or transmitter.

## WEEE Disposal and Recycling Information

---



All products bearing this symbol are waste electrical and electronic equipment (WEEE as in directive 2012/19/EU) which should not be mixed with unsorted household waste. Instead, you should protect human health and the environment by handing over your waste equipment to a designated collection point for the recycling of waste electrical and electronic equipment, appointed by the government or local authorities. Correct disposal and recycling will help prevent potential negative consequences to the environment and human health. Please contact the installer or local authorities for more information about the location as well as terms and conditions of such collection points.

## Adaptor Statements

---

Hereby, Shanghai Imilab Technology Co., Ltd. declares that the radio equipment type IMILAB EC5 Floodlight Camera is in compliance with Directive 2014/53/EU.

The full text of the EU declaration of conformity is available at the following internet address: <https://www.imilabglobal.com/pages/eu-declaration-of-conformity>

