

# Installation Guide

Smart Door Locks Australia

SDL-T1



First, please refer to the **installation video** by scanning the QR code below.



V.1.2.0

## Precautions for Installation

**WARNING:** FAILURE TO FOLLOW THESE INSTRUCTIONS COULD RESULT IN DAMAGE TO THE PRODUCT AND COULD LEAD TO FAILURE OF THE PRODUCT TO PROVIDE ACCESS.

- For your safety, be careful when operating tools or heavy machinery during installation.
- For best results, avoid installing the product in a rainy, humid, or saline environment (e.g. coastal area), or a place exposed to direct sunlight for a long period of time.
- Long-term exposure to direct sunlight may cause a crack on the touch pad. Avoid exposure to direct sunlight.
- Excessive dew condensation may affect product performance.
- You must not repair this product without authorization.
- Install the product while the **door is open**. Even after completing the installation, **do not close the door** until you check if the product is operating properly.
- While installing the product, do not let it **fall to the ground**. If the product falls or is dropped during installation, you may be injured or the product may be damaged.
- Do not install the batteries until you complete the installation.

## Packing List

Item	Qty	Item	Qty
Exterior Assembly	1	Bolt Screws: 10*5 mm (For Aluminum Door)	4
Interior Assembly	1	Bolt Screws: 25*4mm (For Wooden Door)	4
Bolt	1	Strike & Strike Box	1+1
Key Fobs	3	M4*12mm Screw	2
Mechanical Keys	2	M4*30mm Screw for Door Thickness 35-50mm	3
Waterproof Rubber Plates	2	M4*50mm Screw for Door Thickness 50-65mm	3
Screw Stubs: M4*30mm (1 Extra)	3	Chuck	1
Screw Stubs: M4*40mm (2 Extra)	3	User Manual	1

# Installation Guide

## 1. Preparing the door

1.1. If you are installing the SDL-T1 smart door lock on an existing door, please remove existing door hardware and latch or bolts before installing the new lock.

You can remove most existing door locks with a screwdriver.

If you are having problems removing your existing door lock or unsure if what you are doing can damage the existing door, please contact a locksmith or the current door hardware manufacturer for assistance.

1.2. After removing the existing lock, make sure your door is properly prepared. If you need to drill holes in your door, please use supplied templates to assist.

## 2. Installing the Bolt

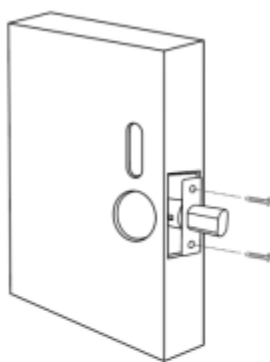

2.1 Adjust the bolt backset to a 60mm or 70mm setting based on your door preparation above.

2.2 Make sure the bolt is **retracted**.

2.3 Make sure the 'UP' icon of the bolt is pointing up.

2.4 Install the bolt onto the door using the screws provided.

### 3. Changing the direction for right or left swing doors

**Important:** If these aren't set properly, the deadbolt mechanism will fail to lock and unlock.

#### For left open doors



While facing the door, if the door hinges are on the left side of the door, you have a left open door.

3.1 Change the direction switch, on the back of the interior assembly, to the 'L' position.

3.2 Turn the interior assembly Knob to be in the horizontal position.

#### For right open doors



While facing the door, if the door hinges are on the right side of the door, you have a right open door.

3.3 Change the direction switch, on the back of the interior assembly, to the 'R' position

3.4 Turn the interior assembly Knob to be in the vertical position.

## 4. Installing the exterior assembly

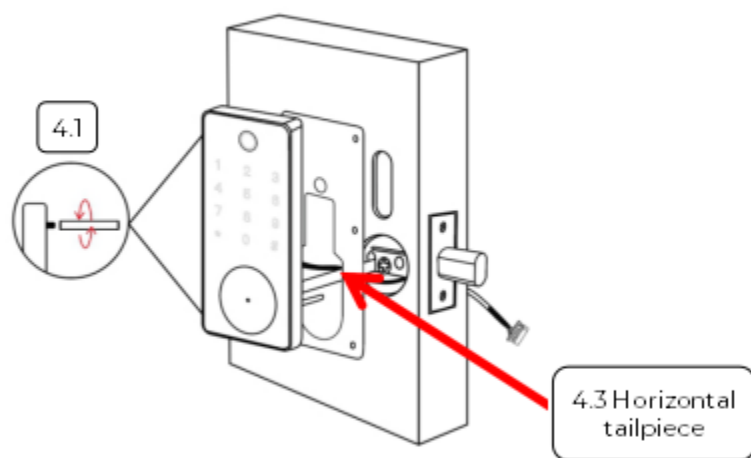

4.1 Attach the 3 screw stubs onto the back of the exterior assembly.

4.2 Install the rubber gasket.

4.3 Make sure the cylinder tailpiece is **horizontal**.

4.4 Install the exterior lock as shown by aligning the lock straight and passing the attached rods through the bolt.

4.5 Push the connection cable through the hole, below the Bolt.

## 5. Installing the Interior assembly mounting plate

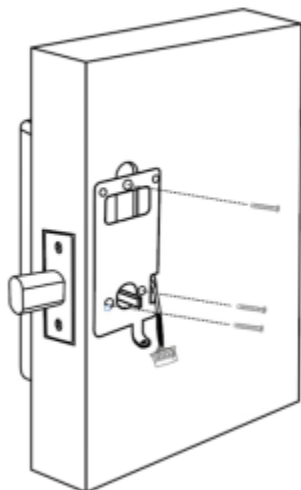

5.1 Route the cable through the hole on the Interior Assembly Mounting Plate.

5.2 Fix the Interior Assembly Mounting Plate to the door using the screws provided (2 shorter screws for the bottom and 1 longer screw for the top)

## 6. Installing the Interior assembly

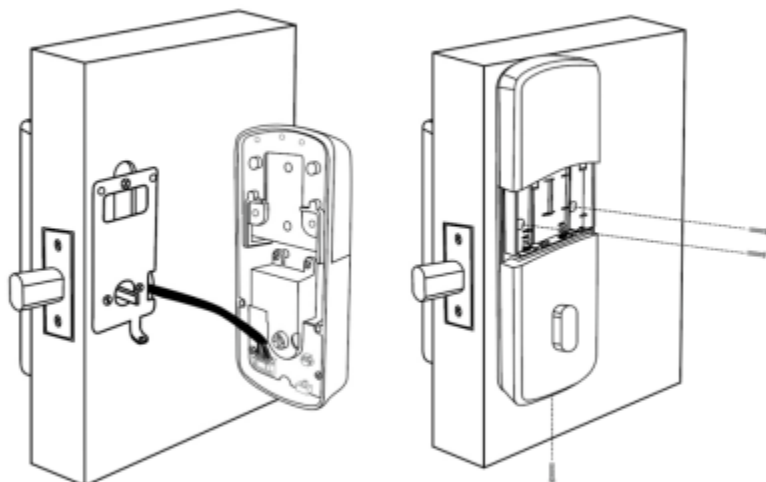

6.1 Install the rubber gasket.

6.2 Plug the cable that is coming through the door into the interior assembly. Make sure you match the direction of the plug correctly.

6.3 Remove the battery cover and keep it aside.

6.4 Align the interior assembly with the mounting plate holes and attach the Interior lock to the door frame. While you are doing so, gently push the excess cable into the hole.

6.5 Once the Interior lock is flushed against the door frame, secure the lock to the plate using screws provided.

6.6 Turn the Knob and check if the Bolt works properly. If the Bolt doesn't come out, remove and re-install both assemblies carefully.

6.7 Turn the Knob to keep the Bolt in the retracted position.



## 7. Installing batteries



7.1 Insert the batteries into the lock by matching the positive (+) and negative (-) orientation markings on the batteries to the battery chamber.

7.2 Secure the battery cover.

## 8. Installing the door strike

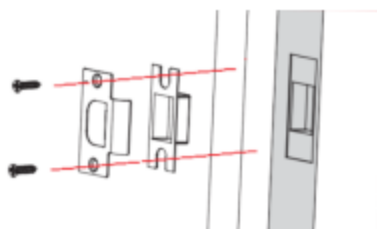

8.1 Make sure the slanted side of the mortise latch is closing against the slanted part of the strike plate before fixing it on to door frame.

8.2 Fix the door strike to the door frame.

## 9. Finishing installation

9.1 You're all done! You have completed the physical lock installation and now you're ready to get the lock set up.

# Power and Test

## 1. Activate the lock

1. Make sure fresh batteries are installed.
2. Touch or slide your finger over the keypad.
3. This should turn on the keypad and should provide voice feedback.

## 2. Test Lock and Unlock

### Important:

- Make sure you perform these operations while the door is open.
- Do not close the door until you have completed the programming and made sure the product is operating properly.

### From inside

1. Turn the Knob to lock and the Bolt should push out.
2. Turn the Knob to unlock and the Bolt should retract.

### From outside

3. Touch the keypad with the back of your fingers to activate the lock. Press & hold the # key for 3 seconds and the Bolt should lock.
4. Enter the default passcode '123456#' and the Bolt should unlock.

If all the steps above are successful, you can begin the programming of SDL-TI. Otherwise, please re-install SDL-TI carefully as shown in the 'Installation Guide' section.

# User Guide

## 1. Product Overview

### 1.1. Exterior

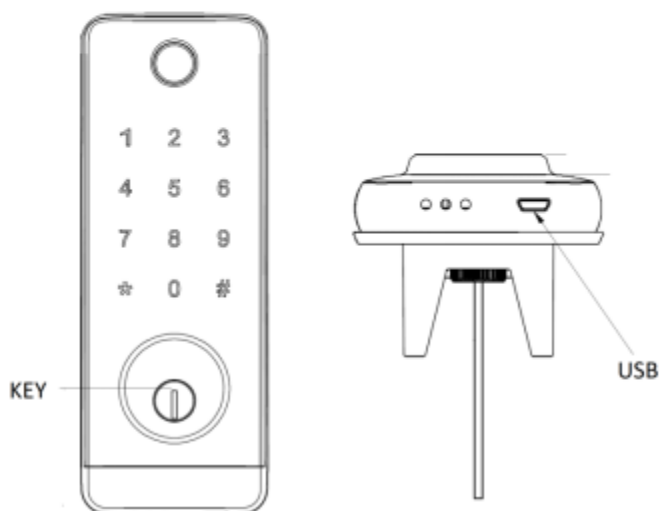

#### **Anti-peep Keypad**

Used to enter the code and unlock from the outside.

#### **Fingerprint Reader**

Used to verify your finger and unlock from the outside.

#### **Key Fob/IC Card Reader**

Used to verify your key fob and unlock from the outside.

#### **Micro USB (5V)**

Used to connect a power bank to activate the lock when it runs out of battery.

#### **Backup Key Hole**

Used to insert the key to unlock.

#### **0-9 Number Button**

Used to input key code and unlock from outside.

## 1.2. Interior

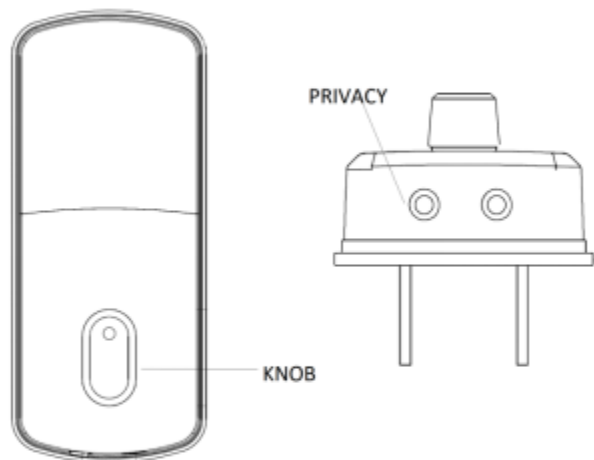

### **Battery Cover**

Used to cover the batteries.

### **Reset Button (inside the battery cover)**

Used to reset SDL-T1 to factory default settings.

### **Knob**

Used to lock or unlock SDL-T1 from inside.

### **Privacy Lockout button**

Used to turn on/off privacy lockout when necessary.

## 2. Basic operation

### 2.1. Cleaning the Keypad and Fingerprint Reader

Use a microfiber cloth and wipe across the Anti-peep Keypad, Fingerprint Reader and Key Fob Reader.

### 2.2. Lock Activation

Place a finger on the Fingerprint Reader, touch the Anti-peep keypad with the back of your hand or fingers, or, present the Fob on the Key Fob Reader.

### 2.3. Unlock from outside

#### Unlock by Code

1. Place a finger on the Anti-peep Keypad to activate SDL-TI.
2. Input the 4-8 digit User Code from a registered user and press #.

#### Unlock by Fingerprint

1. Press the finger from a registered user on the middle of the Fingerprint Reader to unlock it.

#### Unlock by Key Fob

1. Present the Key Fob from a registered user on the Key Fob Reader.

#### Unlock by Smartphone

1. Press the Unlock Button in the TTLock App.

#### Backup Key

1. Insert the backup key and rotate to unlock, just like any lock.

**Note:** Please keep at least one key in a secure location outside of your place for emergency purposes.

## **2.4. Unlock from inside**

1. Rotate the Knob to unlock SDL-TI.

## **2.5. Lock from outside**

*When Auto-Lock is on:*

SDL-TI will relock the Bolt automatically after the configured timeout.

*When Auto-Lock is off:*

1. Place a finger on the Anti-peep Keypad to activate SDL-TI.
  2. Press and hold the # key for 3 seconds.
- Or
3. Tap the 'Padlock' icon on the TLock App.

## **2.6. Lock from inside**

1. Rotate the Knob to unlock SDL-TI.

## 2.7. Factory Reset

**Important:** All data will be erased if you reset SDL-TI to factory default settings.

1. Open the battery cover.
2. Use a paper clip and press the "Reset" button for 5 seconds.
3. Press "000#" to complete the reset process.

## 2.8. 5V Emergency Power

**Note:** 5V Emergency Power is only for temporary power or not being able to charge the lock.

1. Locate the USB port at the bottom of SDL-TI's Exterior Assembly.
2. Use a regular 5V power bank to power.

## 2.9. Anti-peep Keypad

The lock supports 4-8 digit key codes. You can choose to enter any 16 digit code, as long as a correct code is included within the sequence of numbers you have entered.

Example User Code: **1234**

Example Valid Keypad Input: 045**1234**794

## 2.10. Finger Placement

- Your finger should cover the Reader completely with some pressure, touching the surrounding metal ring.
- Make sure that your finger and the Fingerprint Reader are clean and dry. For the Fingerprint Reader, use a clean microfiber cloth to wipe off any dirt or debris.
- While scanning your finger, you shouldn't tap too quickly or move your finger around.
- If you have trouble enrolling one finger, try another.

## **2.11. Use the Key Fob**

When using the Key Fob access, please place the Key Fob at the centre to cover the reader.

Approach the sensor with medium speed (instead of sudden motion). If it's not working, move the Key Fob away and re-try.

## **2.12. Lock Status**

### **Normal Mode**

This is the default mode. User must pass the fingerprint, code, fob or App access verification to unlock SDL-TI from outside.

### **Passage Mode**

SDL-TI will stay unlocked for convenient free passage.

### **Privacy Lockout Mode**

Press and hold the 'Privacy Lockout Button' on the interior assembly for 5 seconds to turn on/off Privacy Lockout mode.

When it is on or 'lockout' state, it can only be unlocked from outside, by the master admin user or using the backup mechanical key from outside. Indoor Knob always works.



# Programming Guide

## Important:

- Enable Bluetooth on your smart phone before continuing.
- All the operations related to configuring the new smart lock should be performed within one meter radius to the lock.

## 1. Download the app

Scan to download the APP or search 'TTLock' on your app store.



This section shows you the basic configurations of the smart lock using the TTLock application to get you started using the smart door lock.

For a complete guide of the TTLock application functions, scan the QR code below.



## 2. Login to TTLock Account

If this is your first time using the TTLock app, you have to register a new user account. Once an account has been created, you can use the same account to manage all of your locks.

If you already have an account you can skip the registration and login to the application with your account credentials.

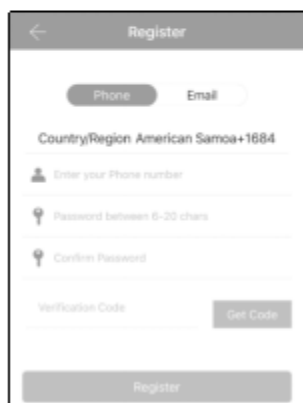

### Registering a new account

- 1.1 Open the TTLock application.
- 1.2 Follow the prompts to register a new account.

### Login to the account

- 1.3 Login to your account with your username and password.

### Login Successful

Once you are logged into the application you will be taken to the Home page of the TTLock application.

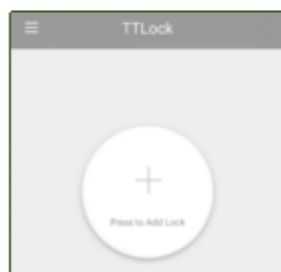

### 3. Adding the lock to the TLock app

#### Important:

- The default password is 123456.
- Once you complete this step, you will become the Bluetooth administrator of the lock. And, there can be only one **Bluetooth administrator** for a given lock.
- You can add more users with administrator privileges. But, the Bluetooth administrator has the highest permission level.
- To remove a **Bluetooth Administrator**, go to the 'Factory Reset' and follow the steps to reset the lock to the factory default.

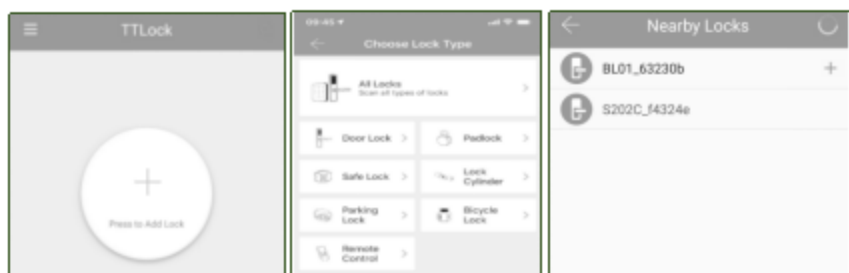

1.4 Tap the add button.

1.5 Tap the 'All Locks' button.

**Important:** Make sure the smart lock active (or keypad is illuminated). If not, touch or slide your finger over the keypad until the keypad is illuminated.

1.6 Now the application will scan for nearby locks and once a lock is found, tap the '+' button next to the correct lock.

1.7 Enter a lock name. E.g. Front door, Room 1

1.8 If successful, you will be taken to the Home page of the new lock. Now the lock is added to your account and ready to be configured.

## 4. Configuring the lock access using TLock application

### Unlock using the TLock application

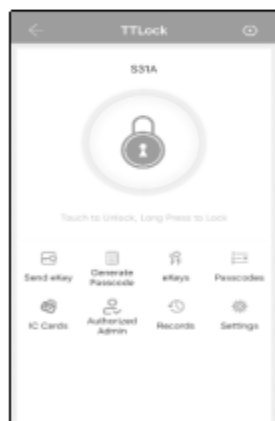

1.9 Make sure you are on the Home page of the newly added lock

1.10 tap the 'Padlock' icon to unlock the smart lock.

### Setting a passcode

There are multiple types of passcodes such as permanent, time-limited, one-time, etc. You can choose to create any type based on your access requirements for each user.

You can also choose to generate a random passcode from the Application or a custom passcode based on your needs.

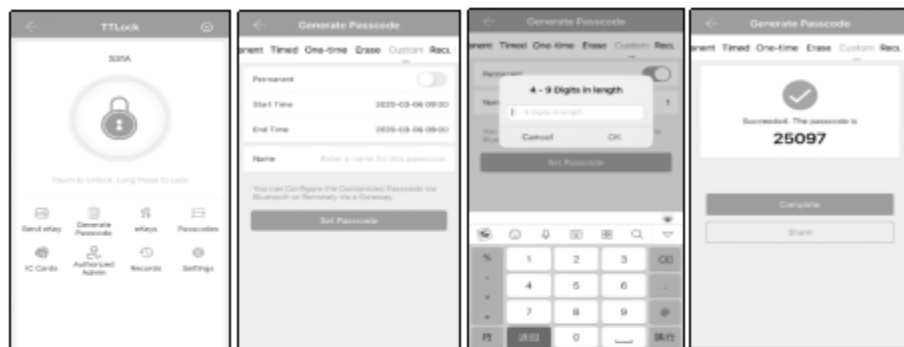

1. From the Home page options, tap 'Generate Passcode'.
2. Choose the type of passcode you want to create by navigating the tabs.
3. Generate the new passcode.

## Send e-key

You can send e-keys to other users to grant application access to the lock.

**Important:** The receiver must have the TTLock application installed and registered with TTLock prior to receiving the e-key.

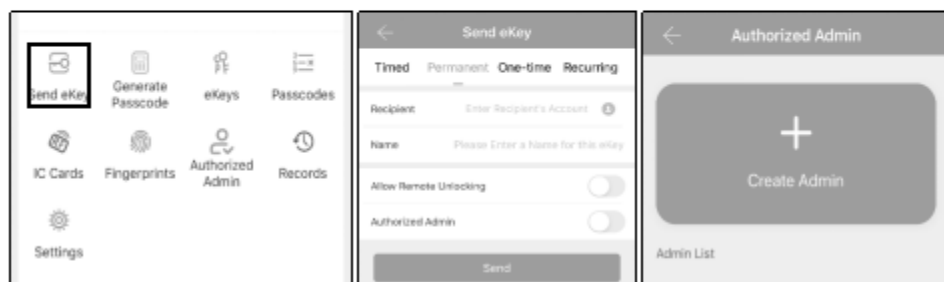

1. Tap 'Send eKey' on the lock Home screen.
2. Select the e-key type by navigating the tabs (i.e. timed, permanent, one-time, recurring).
3. Enter the recipient's TTlock account username and name.
4. You can choose to 'Allow Remote Unlocking' capability, if necessary.
5. Select 'Authorized Admin' if you want to make this user an administrator.
6. Tap 'Send'.

## Register IC Card/Key Fob

**Important:** This operation must be performed near the lock.

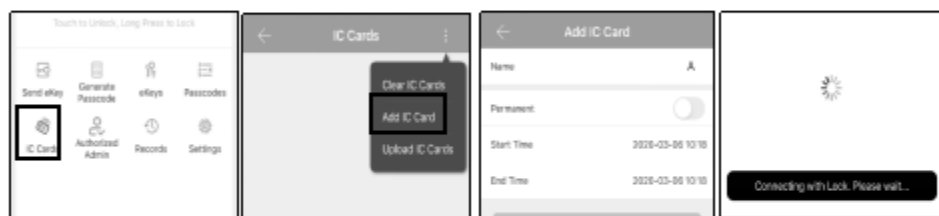

1. Tap 'IC Cards' on the lock Home screen.
2. Select 'Add IC Card' from the context menu.
3. Enter IC card details.
4. Tap the IC Card to the exterior lock panel IC card reader area.

## Register fingerprint

**Important:** This operation must be performed near the lock.

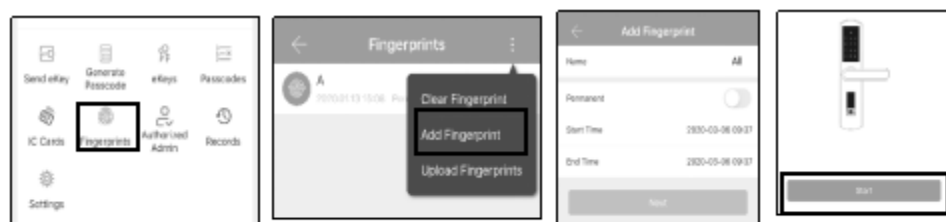

1. Tap 'Fingerprints' on the lock Home screen.
2. Select 'Add fingerprint' from the context menu.
3. Enter fingerprint details.
4. Start the fingerprint scan process and follow the on-screen instructions.

## Check Logs

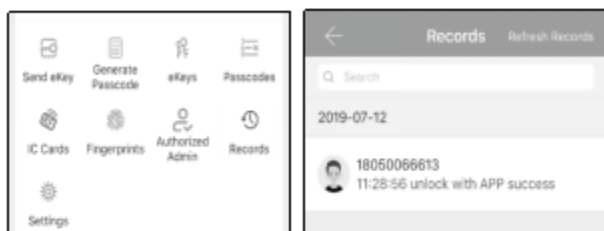

1. Tap 'Records' from the lock Home screen.

## 2. Configuring the Wi-Fi Gateway (optional)

### Important:

- You should install the Wi-Fi Gateway only after you have successfully finished installation and set up your Smart Lock using Bluetooth.
- When configuring, your phone and the Wi-Fi gateway must be connected to the same **2.4GHz** network.
- If the process times out at any point, power off the Gateway and start the process again.

## Understanding indicator light status



When the gateway is power on:

- Light flashes alternately with red and blue: Stand-by mode, ready for connection
- Blue light: working mode
- Red light: network failure

## Paring the Wi-Fi Gateway with the TLock App

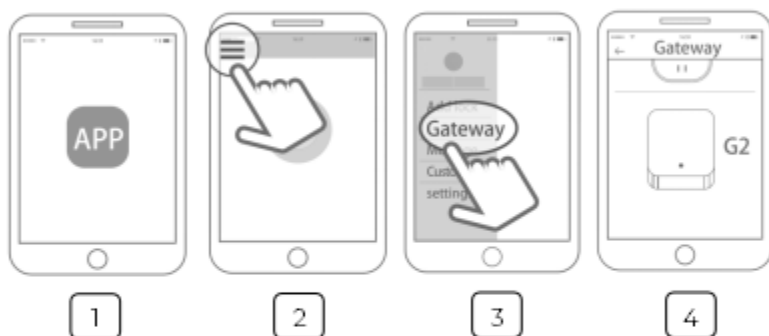

1. Open the TLock App.
2. Tap the '☰' button.
3. Select 'Gateway'.
4. Select 'G2'.

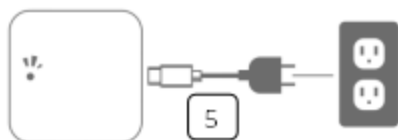

5. Plug the Gateway and power it on. The indicator light should flash red and blue alternatively.



6. Tap the '+' next to the correct Gateway.
7. Add Gateway
8. Select the 'WiFi' and enter the password.
9. Paring is now complete.