

Installation Guide

Smart Door Locks Australia

SDL-R1



Precautions for Installation

WARNING: FAILURE TO FOLLOW THESE INSTRUCTIONS COULD RESULT IN DAMAGE TO THE PRODUCT AND COULD LEAD TO A FAILURE OF THE PRODUCT TO PROVIDE ACCESS.

- For your safety, be careful when operating tools or heavy machinery during installation.
- For best results, avoid installing the product in a rainy, humid, or saline environment (e.g. coastal area), or a place exposed to direct sunlight for a long period of time.
- Long-term exposure to direct sunlight may cause a crack on the touch pad. Avoid exposure to direct sunlight.
- Excessive dew condensation may affect product performance.
- You must not repair this product without authorization.
- Install the product while the **door is open**. Even after completing the installation, **do not close the door** until you check if the product is operating properly.
- While installing the product, do not let it **fall to the ground**. If the product falls or is dropped during installation, you may be injured or the product may be damaged.
- Do not install the batteries until you complete the installation.

Packing List

| Item | Qty | Item | Qty |
|---------------------------------------|------------|--|------------|
| Exterior Assembly | 1 | Panel Connector Screws | 2 |
| Interior Assembly | 1 | Panel Connector Washer | 2 |
| Exterior Assembly Waterproof Cover | 1 | Water-resistant Rubber Gaskets | 2 |
| Key Cylinder | 1 | Metal Door Connector Screws (includes extras) | 8 |
| Cylinder Connector Plate | 1 | Wood Door Connector Screws (includes extras) | 8 |
| Mechanical Keys | 3 | Key Fobs | 2 |
| Keeper Box | 1 | User Manual | 1 |

Installation Guide

1. Preparing the door

1.1. If you are installing the SDL-R1 smart door lock on an existing door, please remove existing door hardware and latch or bolts before installing the new lock.

You can remove most existing door locks with a screwdriver.

If you are having problems removing your existing door lock or unsure if what you are doing can damage the existing door, please contact a locksmith or the current door hardware manufacturer for assistance.

1.2. After removing the existing lock, make sure your door is properly prepared. If you need to drill holes in your door, please use supplied templates to assist.

2. Installing the Lockset

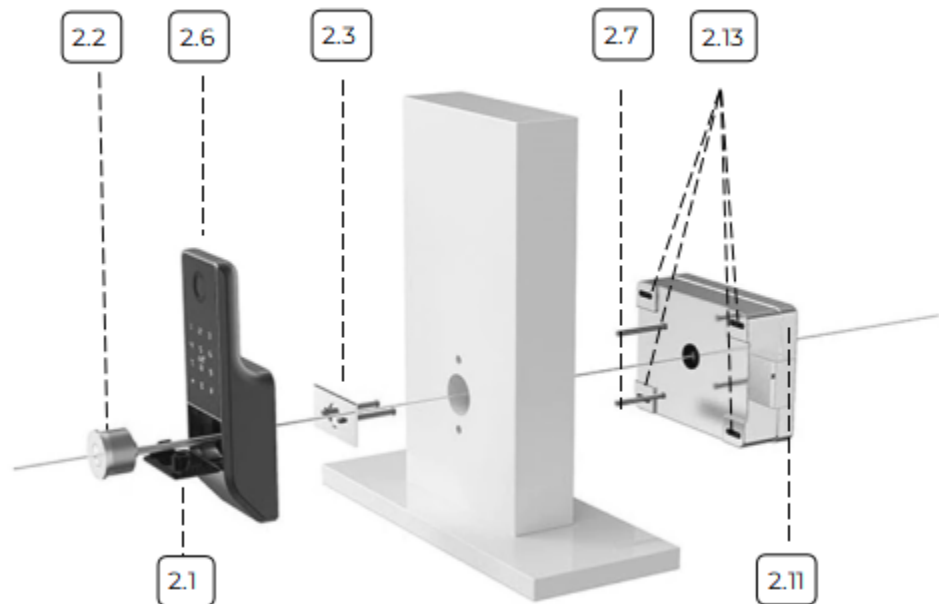

Installing the exterior panel

- 2.1 Open the Mechanical Key Hole cover and keep it aside.
- 2.2 Insert the Key Cylinder into the Key Hole.
- 2.3 Secure the key cylinder to the exterior lock panel using the metal plate and 2 small connector screws.
- 2.4 Install the water-resistant rubber gasket.
- 2.5 Push the connection cable through the door.
- 2.6 Install the exterior panel as shown by aligning the lock straight.
- 2.7 Secure the exterior panel to the door using 2 Long Panel Connector Screws and 2 Panel Connector Washers. If required, trim the Panel Connector Screws based on your door thickness.

Cutting the tailpiece to size (optional)

You may skip this step depending on your door thickness.

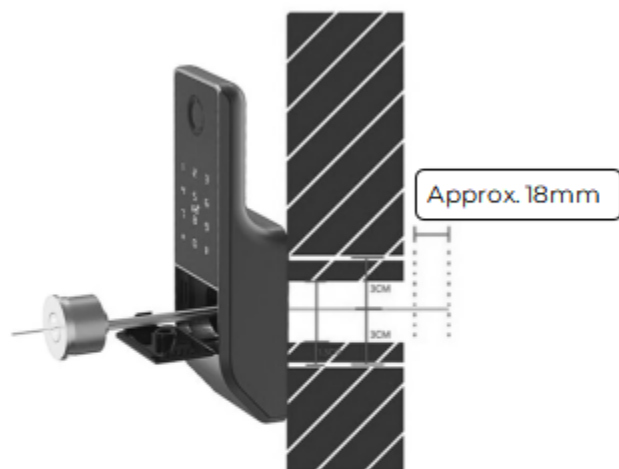

- 2.8 Using a permanent marker, place a cut mark on the tailpiece about 18mm from the door.
- 2.9 Carefully cut the tailpiece using cutting pliers.

Installing the interior panel

2.10 Install the water-resistant rubber gasket.

2.11 Open the Interior Panel Cover by removing the 2 screws on the side.

2.12 Push the Exterior Connection Cable through the opening on the back of the Interior panel.

2.13 Align the tailpiece to the Interior Panel and attach the Interior Panel to the door using 4 Connector Screws.

2.14 Plug the cable that is coming through the door into the main motherboard connector. Make sure you match the direction of the plug correctly.

2.15 Insert the batteries into the lock by matching the positive (+) and negative (-) orientation markings on the batteries to the battery chamber.

Changing the interior panel keypad orientation (optional)

You may skip this step if your door matches the factory default interior panel keypad orientation.

2.16 Close the Interior Panel Cover but do not install the 2 screws yet.

2.17 Touch the Interior Panel Keypad with your palm to activate it.

2.18 Now check the Interior Panel Keypad orientation. If the Keypad is upside down, remove the 6 screws on the back of the Keypad and change the orientation of the Keypad. Otherwise, you can skip this step.

Finishing the interior panel installation

2.19 Close the Interior Panel Cover and secure using the 2 screws.

Installing the keeper Box

Fix the Keeper box to the door jamb.

Power and Test

1. Testing the mechanical key

1. From outside - Use the mechanical key on the Exterior Panel to lock and unlock the locking mechanism.
2. From inside - Use the mechanical key on the Interior Panel to lock and unlock the locking mechanism.

2. Activate the lock

1. Make sure fresh batteries are installed.
2. Touch or slide your finger over the keypad.
3. This should turn on the keypad and should provide voice feedback.

3. Test Lock and Unlock

Important:

- Make sure you perform these operations while the **door is open**.
- **Do not close the door** until you have completed the programming and made sure the product is operating properly.
- During the testing steps below, the **bolt will not engage** because the door is not physically closed.

From outside

1. Touch the keypad with the back of your fingers to activate the lock. Press & hold the # key for 3 seconds and there should be voice feedback saying it is 'locked' (Note: The bolt will not come out automatically because the door is not physically closed.)
2. Enter the default passcode '123456#' and there should be voice feedback saying it is 'unlocked'. (Note: The bolt will not retract automatically because the door is not physically closed.)

From inside

1. Touch the keypad with the back of your fingers to activate the lock. Press & hold the # key for 3 seconds and there should be voice feedback saying it is 'locked' (Note: The bolt will not come out automatically because the door is not physically closed.)
2. Enter the default passcode '123456#' and there should be voice feedback saying it is 'unlocked'. (Note: The bolt will not retract automatically because the door is not physically closed.)

4. Finishing the testing

If all the steps above are successful, you can begin the programming of SDL-R1.

Otherwise, please re-install SDL-R1 carefully as shown in the 'Installation Guide' section.

User Guide

1. Product Overview

1.1. Exterior

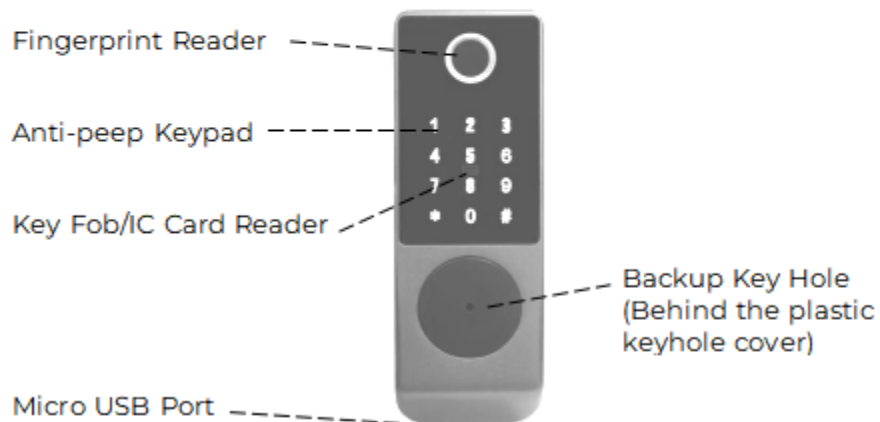

Anti-peep Keypad

Used to enter the code and unlock from the outside.

Fingerprint Reader

Used to verify your fingerprint and unlock from the outside.

Key Fob/IC Card Reader

Used to verify your key fob and unlock from the outside.

Micro USB (5V)

Used to connect a power bank to activate the lock when it runs out of battery.

Backup Key Hole

Used to insert the key to unlock.

1.2. Interior

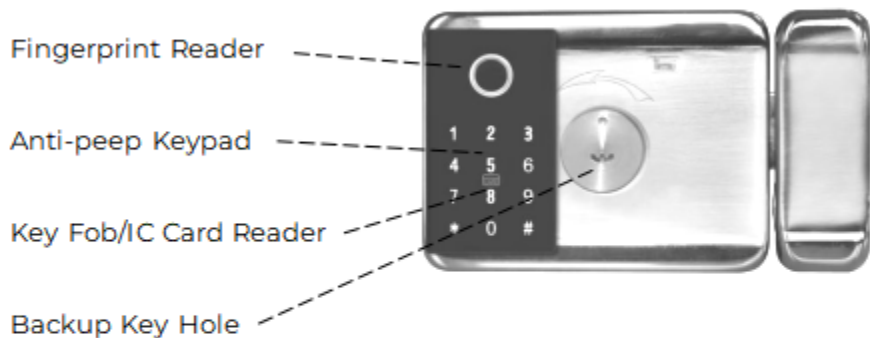

Anti-peep Keypad

Used to enter the code and unlock from the outside.

Fingerprint Reader

Used to verify your fingerprint and unlock from the outside.

Key Fob/IC Card Reader

Used to verify your key fob and unlock from the outside.

Backup Key Hole

Used to insert the key to unlock.

1.3. Interior - Interface Specification

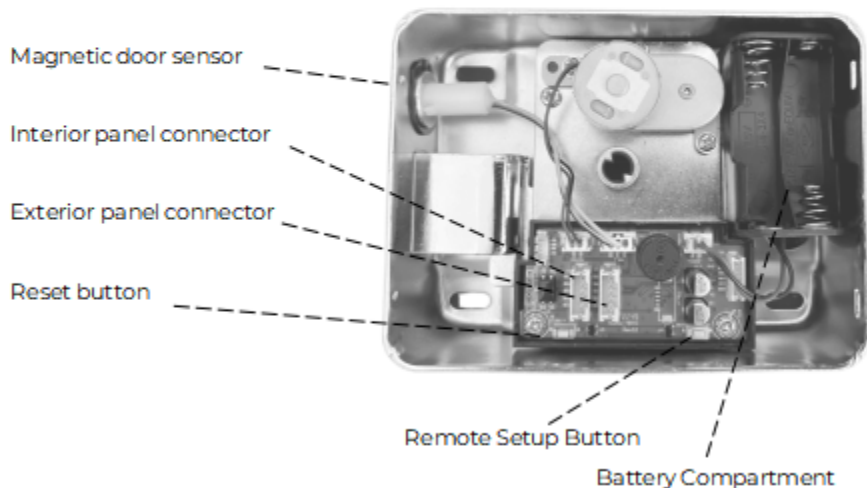

2. Basic operation

2.1. Cleaning the Keypad and Finger Reader

Use a microfiber cloth and wipe across the Anti-peep Keypad, Fingerprint Reader and Key Fob Reader.

2.2. Lock Activation

Place a finger on the Fingerprint Reader, touch the Anti-peep keypad with the back of your hand or fingers, or, present the Fob on the Key Fob Reader.

2.3. Unlock from outside

Unlock by Code

1. Place a finger on the Anti-peep Keypad to activate SDL-R1 Double-Sided Rim Lock.
2. Input the 4-8 digit User Code from a registered user and press #.

Unlock by Fingerprint

1. Press the finger from a registered user on the middle of the Fingerprint Reader to unlock it.

Unlock by Key Fob

1. Present the Key Fob from a registered user on the Key Fob Reader.

Unlock by Smartphone

1. Press the Unlock Button in the TTLock App.

Backup Key

3. Insert the backup key and rotate it to unlock, just like any lock.

Important: Please keep at least one key in a secure location outside of your place for emergency purposes.

2.4. Unlock from inside

Unlock by Code

1. Place a finger on the Anti-peep Keypad to activate SDL-R1 Double-Sided Rim Lock.
2. Input the 4-8 digit User Code from a registered user and press #.

Unlock by Fingerprint

1. Press the finger from a registered user on the middle of the Fingerprint Reader to unlock it.

Unlock by Key Fob

1. Present the Key Fob from a registered user on the Key Fob Reader.

Unlock by Smartphone

1. Press the Unlock Button in the TTLock App.

Backup Key

Insert the backup key and rotate it to unlock, just like any lock.

2.5. Factory Reset

Important:

- All data will be erased if you reset SDL-R1 Double-Sided Rim Lock to factory default settings.
- Interior Panel and Exterior Panel work independently and you should reset both panels if you want to reset the entire lockset. You can choose to reset only one or both Lock Panels, if required.

1. Open the battery cover.
2. Press and hold the "Reset" button for 5 seconds.
3. Press "000#" on the Panel you want to reset.
4. Repeat the process for the other Panel, if necessary.

2.6. 5V Emergency Power

Note: 5V Emergency Power is only for temporary power or not being able to charge the lock.

1. Locate the USB port at the bottom of the SDL-R1's Exterior Assembly.
2. Use a regular 5V power bank to power.

2.7. Anti-peep Keypad

The lock supports 4-8 digit key codes. You can choose to enter any 16-digit code, as long as a correct code is included within the sequence of numbers you have entered.

Example User Code: **1234**

Example Valid Keypad Input: 045**1234**794

2.8. Finger Placement

- Your finger should cover the Reader completely with some pressure, touching the surrounding metal ring.
- Make sure that your finger and the Fingerprint Reader are clean and dry. For the Fingerprint Reader, use a clean microfiber cloth to wipe off any dirt or debris.
- While scanning your finger, you shouldn't tap too quickly or move your finger around.
- If you have trouble enrolling one finger, try another.

2.9. Use the Key Fob

When using the Key Fob access, please place the Key Fob at the centre to cover the reader.

Approach the sensor with medium speed (instead of sudden motion). If it's not working, move the Key Fob away and re-try.

Programming Guide

Important:

- Enable Bluetooth on your smart phone before continuing.
- All the operations related to configuring the new smart lock should be performed within one meter radius to the lock.

1. Download the app

Scan to download the APP or search 'TTLock' on your app store.



This section shows you the basic configurations of the smart lock using the TTLock application to get you started using the smart door lock.

For a complete guide of the TTLock application functions, scan the QR code below.



2. Login to TTLock Account

If this is your first time using the TTLock app, you need to register a new user account. Once an account has been created, you can use the same account to manage all your locks.

If you already have an account, you can skip the registration and login to the application with your account credentials.

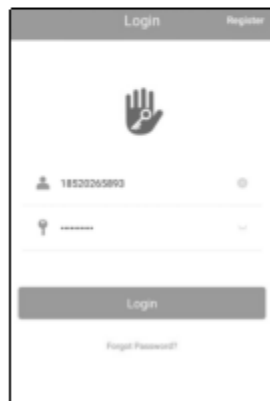
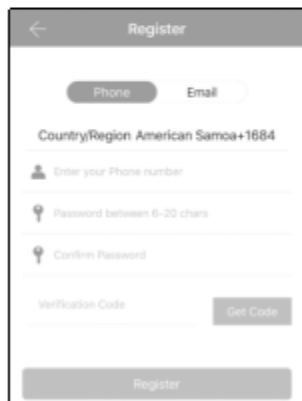

Registering a new account

1. Open the TTLock application
2. Follow the prompts to register a new account

Login to the account

3. Login to your account with your username and password.

Login Successful

Once you are logged into the application you will be taken to the Home page of the TTLock application.

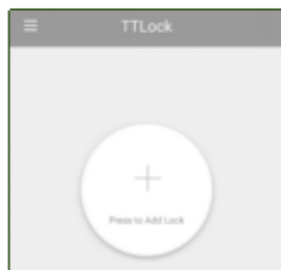

3. Adding the lock to the TTLock app (for both Exterior and Interior Panels)

Important:

- SDL-R1 is a **double-sided** Smart Lock. Therefore, you will have to register and configure the Interior Panel and the Exterior Panel separately in the TTLock App.
- Once you complete this step, you will become the Bluetooth administrator of the lock. There can be only one **Bluetooth administrator** for any given lock.
- You can add more users with administrator privileges, however, the Bluetooth administrator has the highest permission level.
- To remove a **Bluetooth Administrator**, go to the 'Factory Reset' and follow the steps to reset the lock to the factory default.

3.1 Adding the Exterior Panel

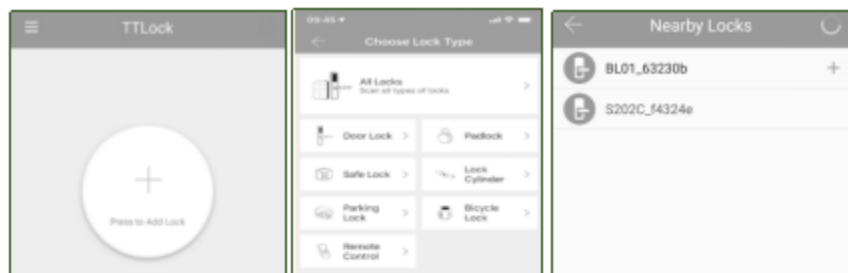

1. Tap the add button.
2. Tap the 'All Locks' button. Now the application will scan for nearby locks.
3. Touch the Exterior Panel Keypad with your palm to activate it. This will make the lock discoverable in the App.
4. Once a lock is found in the App, tap the '+' button next to the correct lock.

5. Enter a lock name. E.g. Side Door - Front (We recommend adding a prefix or suffix to the lock name to identify the exterior and interior panel)

6. If successful, you will be taken to the Home page of the new lock. Now the lock is added to your account and ready to be configured.

3.1 Adding the Interior Panel

1. Go back to the TTLock main screen.

2. Tap the '☰' button.

3. Tap 'Add Lock'

4. Now, repeat the same process to add the Interior Panel to the TTLock app.

4. Configuring the lock access using TTLock application

Important:

- You will have to configure the **Interior Panel and the Exterior Panel separately** in the TTLock App.
- We recommend configuring a single Panel first with all the access codes and methods required. Then, repeat the same process for the other Panel.

Unlock using the TTLock application

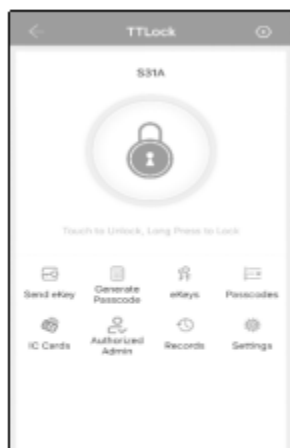

1. Make sure you are on the Home screen of the newly added lock you want to configure.

2. Tap the 'Padlock' icon to unlock the smart lock.

3. If successful, you will hear the sound of the lock handle engaging and you should be able to unlock the lock by rotating the exterior handle

Setting a passcode

There are multiple types of passcodes such as permanent, time-limited, one-time, etc. You can choose to create any type based on your access requirements for each user.

You can also choose to generate a random passcode from the Application or a custom passcode based on your needs.

1. From the Home page options, tap 'Generate Passcode'
2. Choose the type of passcode you want to create by navigating the tabs.
3. Generate the new passcode

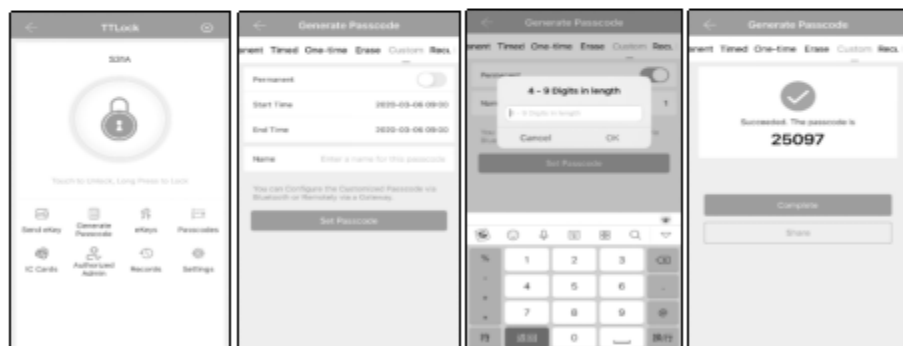

Send e-key

You can send e-keys to other users to grant application access to the lock.

Important: The receiver must have the TTLock application installed and registered with TTLock prior to receiving the e-key.

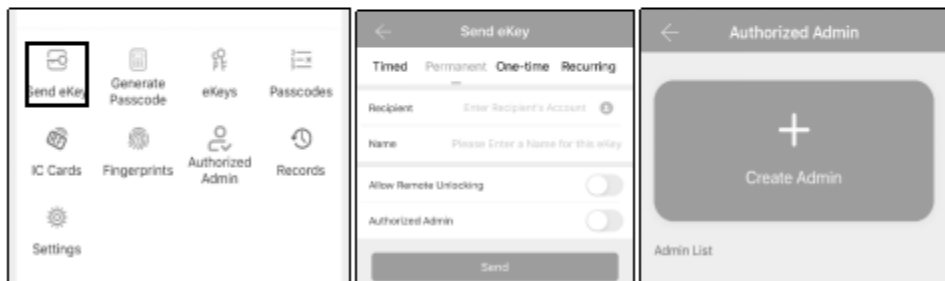

1. Tap 'Send eKey' on the lock Home screen.
2. Select the e-key type by navigating the tabs (i.e. timed, permanent, one-time, recurring)
3. Enter the recipient's TTlock account username and name
4. You can choose to 'Allow Remote Unlocking' capability, if necessary.
5. Select 'Authorized Admin' if you want to make this user an administrator.
6. Tap 'Send'.

Register IC Card/Key Fob

Important: This operation must be performed near the lock

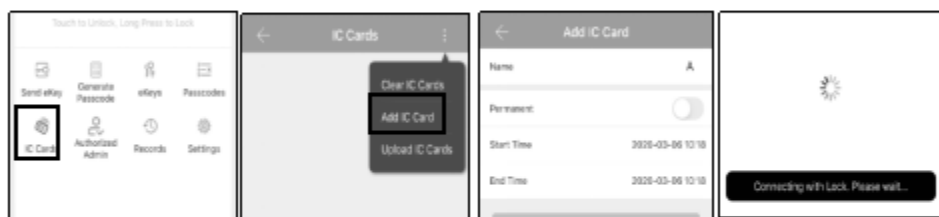

1. Tap 'IC Cards' on the lock Home screen.
2. Select 'Add IC Card' from the context menu.
3. Enter IC card details.
4. Tap the IC Card to the exterior lock panel IC card reader area.

Register fingerprint

Important: This operation must be performed near the lock



1. Tap 'Fingerprints' on the lock Home screen.
2. Select 'Add fingerprint' from the context menu.
3. Enter fingerprint details.
4. Start the fingerprint scan process and follow the on-screen instructions.

Check Logs

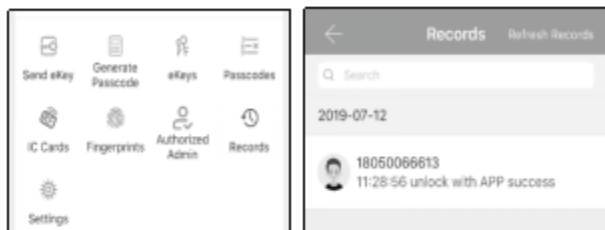

1. Tap 'Records' from the lock Home screen.

5. Configuring the Wi-Fi Gateway (optional)

Important:

- You should install the Wi-Fi Gateway only after you have successfully finished installation and set up your Smart Lock using Bluetooth.
- When configuring, your phone and the Wi-Fi gateway must be connected to the same **2.4GHz** network.
- If the process times out at any point, power off the Gateway and start the process again.

Understanding indicator light status



When the gateway is power on:

- Light flashes alternately with red and blue:
Stand-by mode, ready for connection
- Blue light: working mode
- Red light: network failure

Pairing the Wi-Fi Gateway with the TLock App



1. Open the TLock App.
2. Tap the '≡' button.
3. Select 'Gateway'.
4. Select 'G2'.

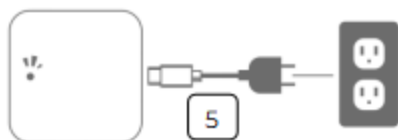

5. Plug the Gateway and power it on. The indicator light should flash red and blue alternatively.



6. Tap the '+' next to the correct Gateway.
7. Add Gateway
8. Select 'WiFi' and enter the password.
9. Pairing is now complete.

6. Other Functionalities

| Function | Steps |
|---------------------------|---|
| Tamper-proof alarm on/off | To On the alarm: *32#<admin_password>#1# To Off the alarm: *32#<admin_password>#0# |
| Change voice language | English: *39#<admin_password>#2# Chinese: *39#<admin_password>#1# |



We are here to help!

For additional support visit,
<https://support.smartdoorlocks.com.au>
or email sales@smartdoorlocks.com.au
or contact us 1300 624 046

