

Quick Start

Step 1 > Install Battery

>. Remove the (4) screws on the battery cover

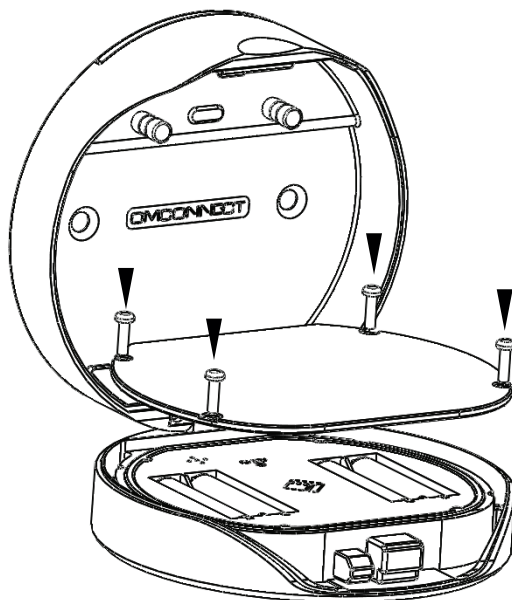

>. Put 4 AAA batteries into the battery dock.

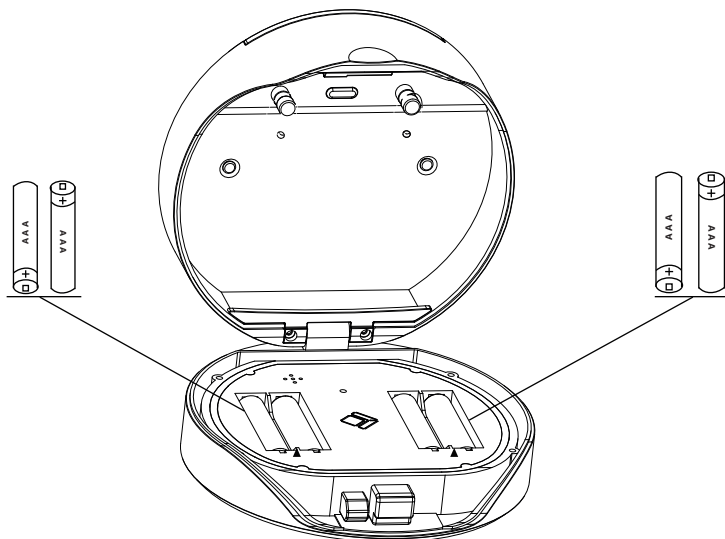

Step 2>Download Mobile App

>1. Scan QR Code below and download the App and turn on your mobile Bluetooth



Step 3>Add Device

>1.Go to App Home page, click Add Device or click "+" on the upper right.

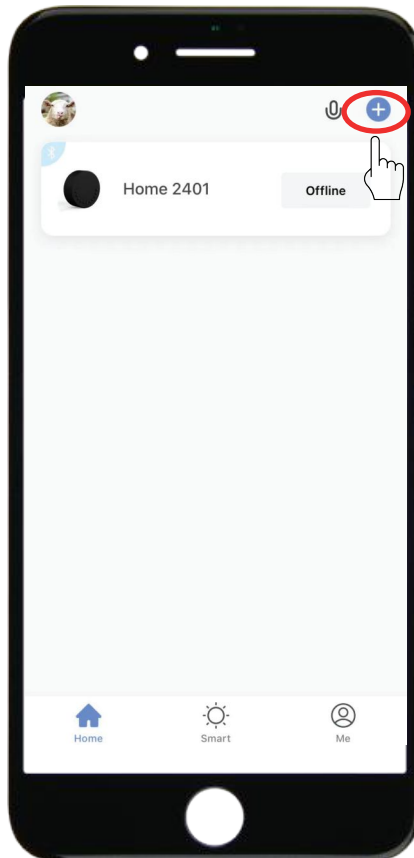

> **2.** Press **⏏** +9+ **⏏** and enter Admin password + **⏏** , when the light slowly blinks in blue the KeyBox is ready to pair.

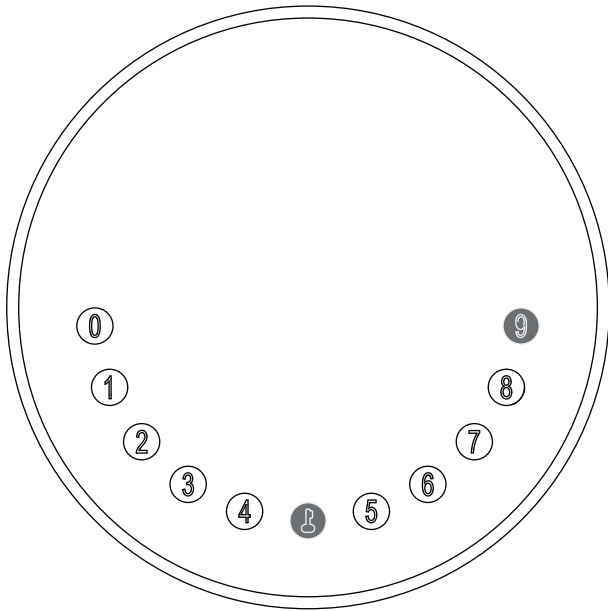

>3. You will see the detected device and click "Go to add".

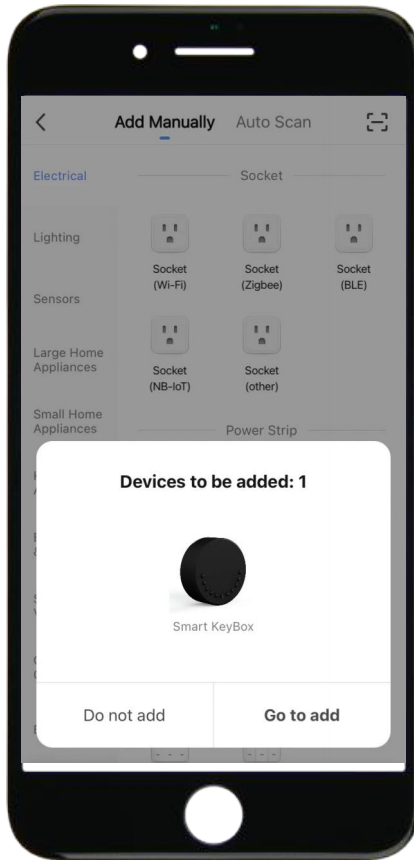

>4. Connecting, you need to wait for few seconds to let it finish.

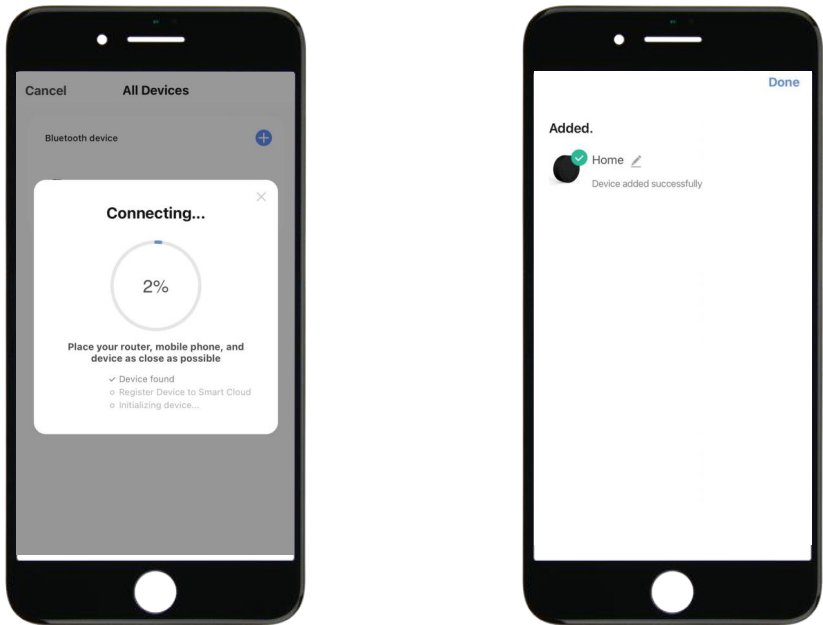

>5. Device added

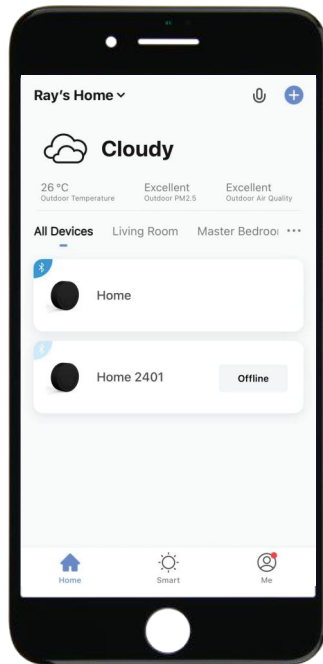

Step 4>Change Admin Password-Initial Admin Password:123456

>1. Press **↓** and hold for 3 beeps

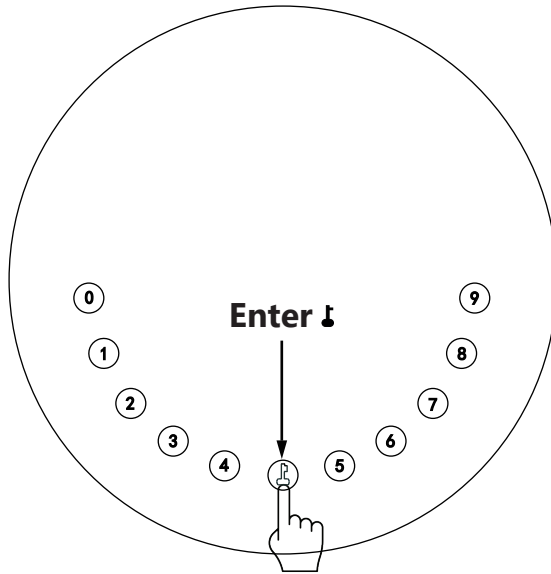

>2. Right after the 3 beeps please key in:

Initial Admin Password + **↓**+new admin password+ **↓**+new admin password+ **↓**

Mechanical Instructions

Password & Factory Mode:

1. Password Length

Password must be 6 digits (no more no less)

2. Add User Password

Press **⏏** + 0 + **⏏** until the blue light blinks

> . Enter admin password + **⏏**

> . Enter new user password + **⏏**

> . Enter new user password again and press **⏏**

> . When the **⏏**(Enter button) blinks in green, user password has been set.

3. Delete User Password

Press **⏏** + 2 + **⏏** until the blue light blinks

> . Enter admin password and press **⏏**

> . Enter the user password you wish to delete and press **⏏**

> . Enter the user password again and press **⏏**

> . When the **⏏**(Enter button) blinks in green the password has been deleted.

4. Delete All User Password

Press **⏏** + 00000 + **⏏** until the blue light blinks

> . Enter admin password and press **⏏**

> . When the **⏏**(Enter button) blinks in green all passwords have been deleted.

5. Virtual digits-Anti Peeping

Add any digits before and after the correct password the KeyBox unlock as always

6. System Lockdown

KeyBox will Lockdown for 5 minutes if entering wrong password continuously 5 times

7. Reset Factory Mode

Press and hold the reset button for 5 seconds and with a long beep

Bluetooth broadcasting & re-connecting:

Bluetooth broadcasting will turn to sleep mode if no operations within 1 minute.

Press any key to activate the Bluetooth, App&Device will get reconnected each other.

App Instructions

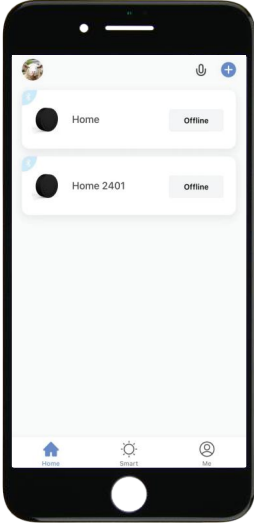

- ☑ You will see all devices and rooms on the home page.
- ☑ Tap the Device to start operating.
- ☑ Tap “Me” at the bottom to manage your home.

- ☑ Touch the lock sign to unlock and lock.
- ☑ Tap “Bell” sign to check the alarm records.
- ☑ Tap “Member Management” to add or delete members.
- ☑ Tap “opening record” to check opening logs.
- ☑ Tap “Intelligent Linkage” to turn on and off go home mode.
- ☑ Tap “Set” to manage passwords

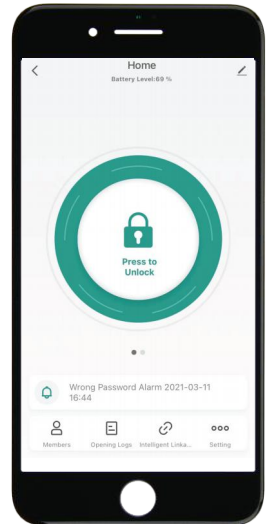

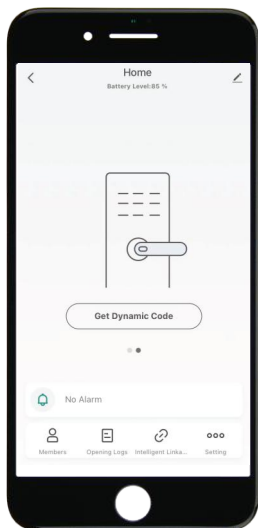

☑ Tap “Get dynamic code” to get a code.

☑ Tap “copy code” and send it to friend or family.

☑ Tap “Pen” sign to edit your personal information.

☑ Go to “Members” to add family or other members

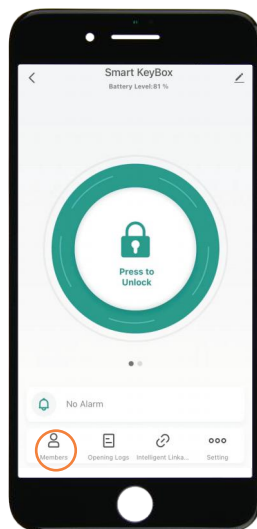

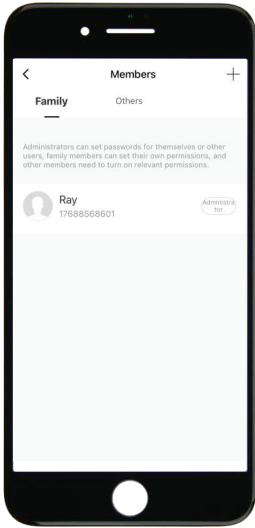

☒ Tap “+” to add family member or other members

☒ Tap “Add it now” under Family to add family members.

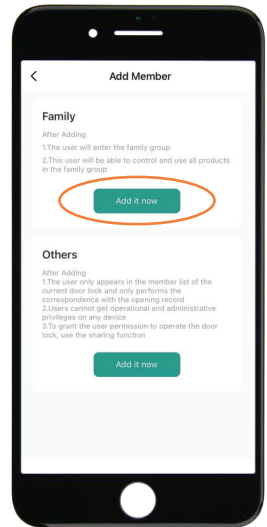

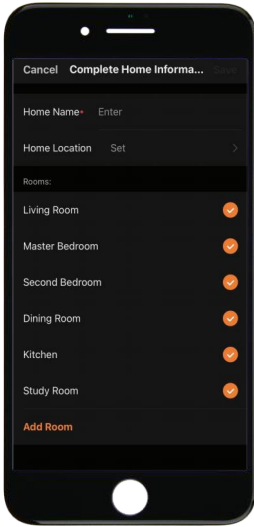

☑ Owner need to complete the Home information before adding any family member if required

☑ The member need to be registered to the App before adding as a family member

☑ Fill up member information and set the role of the member

☑ Tap "Save" to complete and the member will be able to operate the device on his App

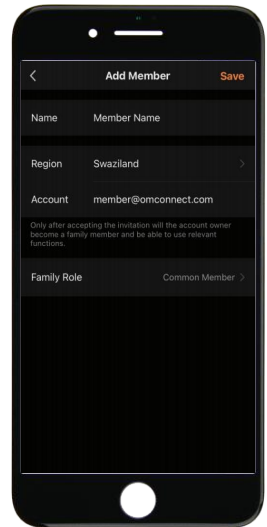

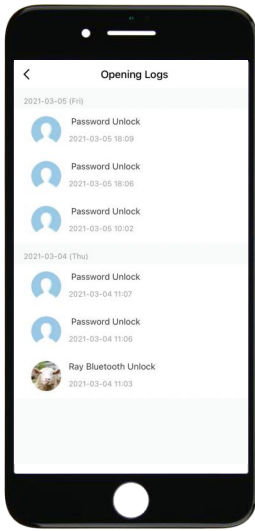

☑ Go to "Opening Logs" to check the unlocking history

☑ With this feature you will be able to find out when and who unlocked the KeyBox

☑ Go to "Intelligent Linkage" to set more smart functions

☑ Tap the green bar to turn on "Family go home" function.

☑ Tap the orange bar to turn on "Door lock alarm" function

☑ You will get notification if user unlocked with Bluetooth

☑ Go to "me" homepage and got to message center to check the records.

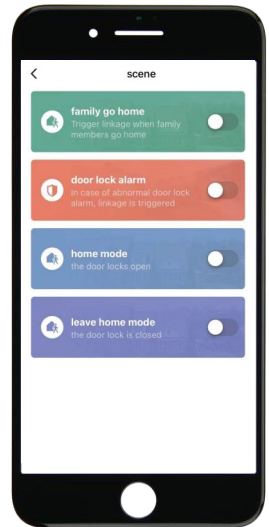

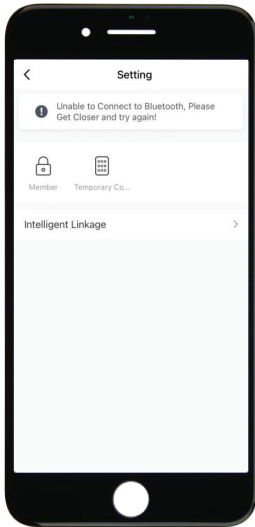

☒ Tap "password management" to add or remove codes.

☒ Tap "Temporary code" to manage online and offline codes.

☒ Tap "one-time code" under Online Code to set an online one time code.

☒ Tap "periodic Code" under Online Code to set an online code which will be available in a period of time.

☒ Tap "One-Time Code" under Offline Code to generate a one time offline code which will be a 10 digits code and use it when the device is offline.

☒ Tap "Offline Temporary Code" under Offline Code to generate an offline code (10 digits) which will be available in a period of time, and use when the device is offline or Bluetooth disconnected with device.

☒ Tap "Clear Code" to generate a code (10 digits) which is able to clear Codes that need to be invalid or clear all codes.

☒ Please note if the code less than 10 digits you need to regenerate a new code, the code must be 10 digits.

