

# LED Magnetic Strip Kit

## JSK Series

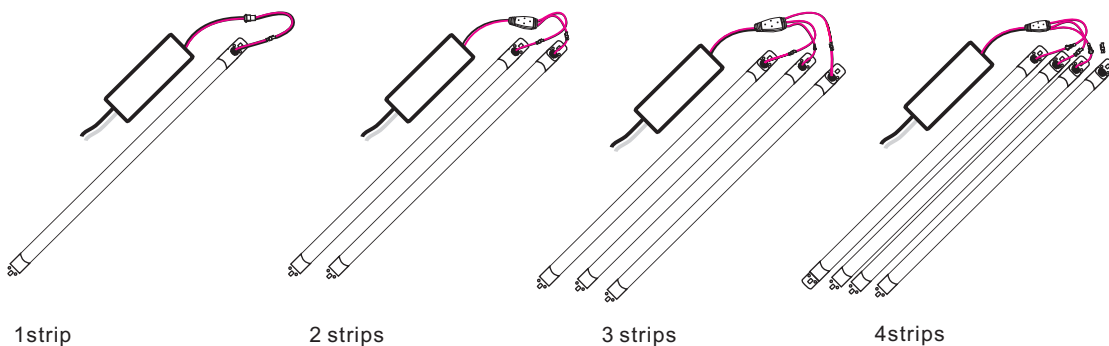

1 strip

2 strips

3 strips

4 strips

### Quick Details

Type: LED Retrofit Light

LED Type: SMD2835

CRI: >82

Certification: UL DLC

Efficiency: 140LM/W

Input voltage: AC100-277V

Dimming: 0-10V

Power: 16W, 24W, 36W, 32W, 54W, 48W, 72W

Installation: Magnetic Application: Indoor

CCT: 3000K, 4000K, 5000K, 6000K

Diffuser: Frosted

### Wiring Diagram

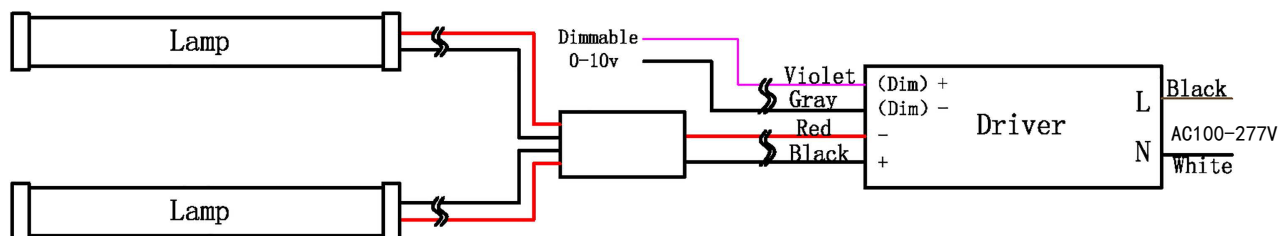

# INSTALLATION INSTRUCTION

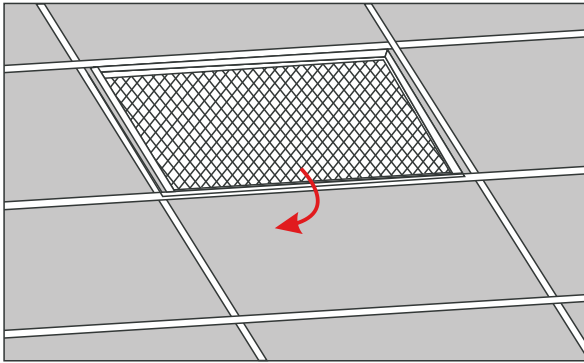

1. Open the old fixture's cover

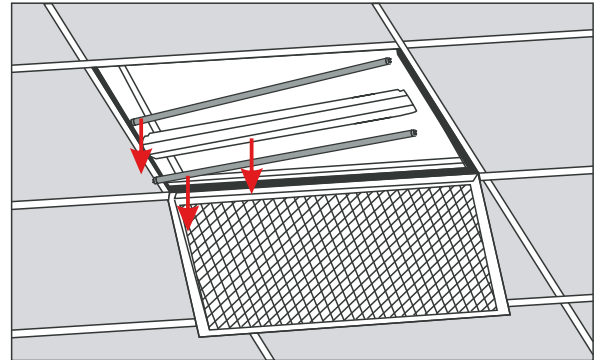

2. Take out the tubes and reflector

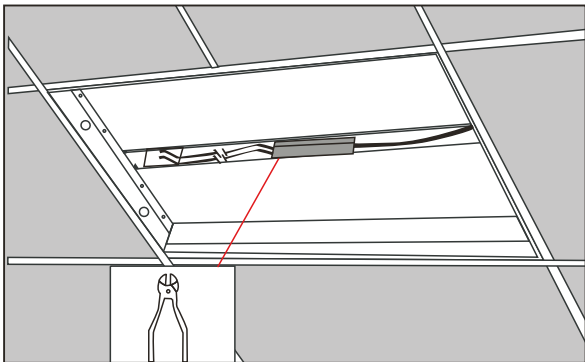

3. Take out the ballast

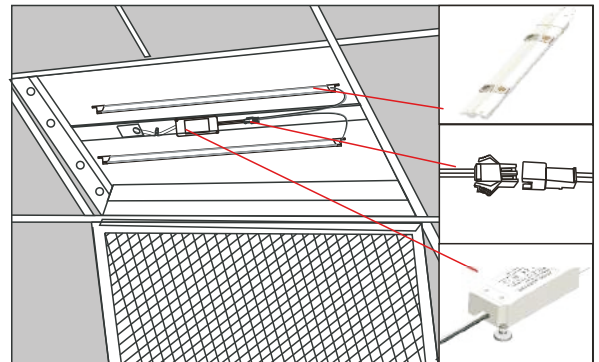

4. Install magnetic strips

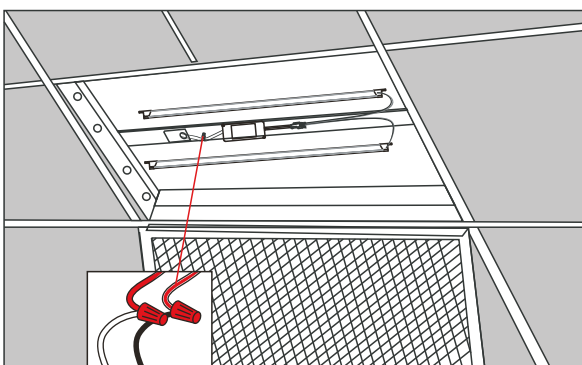

5. Rewire to the new power supply

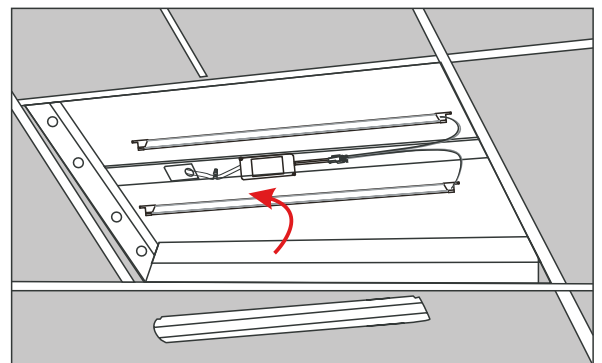

6. Re-install the reflector

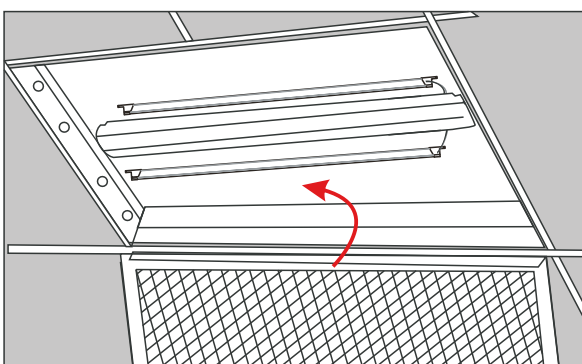

7. Close the cover

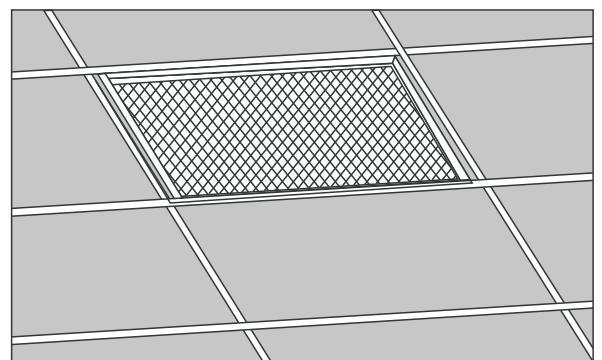

8. Turn on the light