

# Ovate - YBH

## Model: YBH

### Installation Instructions

All installations must be carried out by a qualified electrician following local regulations. Make sure that the power is switched off before installation. Please read and follow the 'Installation instructions' and 'Safety instructions' sections carefully before commencing installation. Installation of this model can change from time to time please read instructions every time before installation. For detailed specification, please go to our website [eurotechlighting.co.nz](http://eurotechlighting.co.nz)

Code:	Colour:	Dimensions (mm):	Dimmable:	Double Insulated:	Fixing area (mm):	IP Rating:	Kelvins:	Lumens:	Material:
YBH12W3K-WH	White	230 x 105 x 58.5	No	Yes	230 x 105	IP65	3000K	1030lm	UV resistant ABS + Poly-carbonate
YBH12W3K-BLK	Black						4000K	1050lm	
YBH12W4K-WH	White								
YBH12W4K-BLK	Black								
YBHDIM3K-WH	White		Yes				3000K	1030lm	
YBHDIM3K-BLK	Black								

#### Product Information

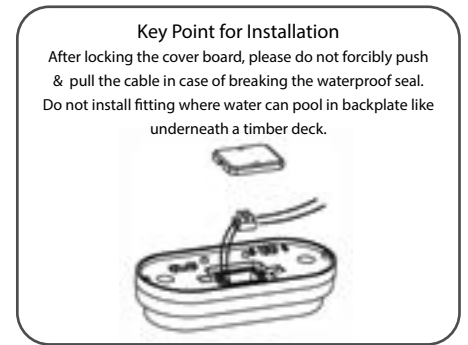
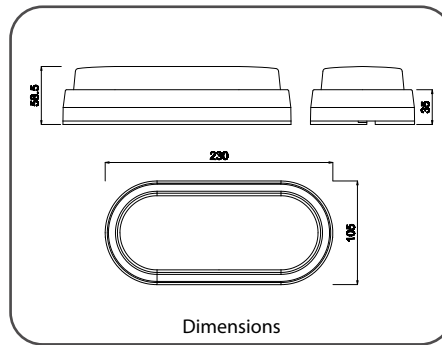
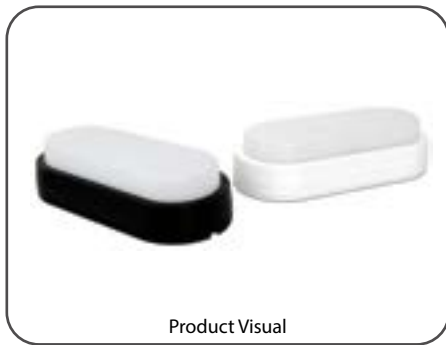

#### Installation Instructions

- Pre-drill two 6mm diameter location holes on the intended mounting surface, ensuring a depth of 30mm or more for each hole and a distance of 217.5mm between the two holes.
- Gently knock the provided plastic expansion tubes provided into the pre-drilled holes, ensuring the plastic tubes are flush with the mounting surface.
- Open the back terminal cover plate of the waterproof termination box with a screwdriver to find the connection terminal & interconnect power cables with the connection terminal. Note: Make sure the cables run in the provided channels. Reposition the prepared terminal into the box, and screw on the cover plate. It is important to ensure the cover plate has been installed correctly to maintain IP rating.
- Take the front cover off the product and line up the fixing holes of the fitting to the pre-drilled fixing holes on your mounting surface. Fix the fitting with provided screws.
- Ensure installation is correct before switching on the fitting to test. Once correct, fit the provided front cover.

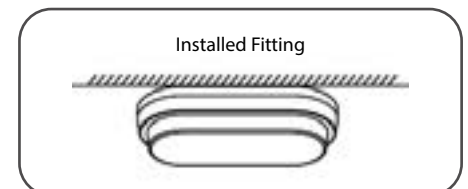
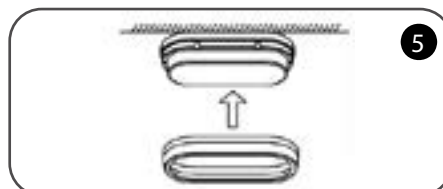
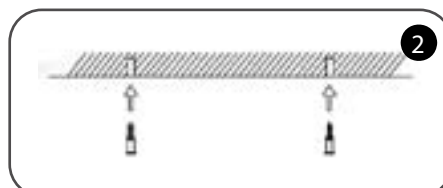
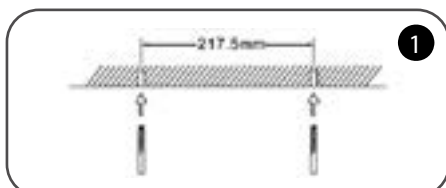

#### Safety Instructions

Read these instructions carefully before commencing installation.

- The light source contained in this luminaire shall only be replaced by the manufacturer or this service agent or a similar qualified person.
- This LED luminaire must be installed by a licensed electrician ONLY following all local regulations.
- Ensure that the cables will not be squeezed or damaged by sharp edges.
- Clean the light with a soft cloth and a standard PH-neutral detergent.
- Misuse of/ or changes to the appliance shall void all warranties.
- Do not install on a surface that is not suitable or deformed.
- Do not install on or above a surface with a high temperature.
- There should not be any materials that are corrosive, explosive.

