

Callista - LED Mirror Light Range

Model: BM9020, BM9060, BM6060, BM4214

Installation Instructions

All installations must be carried out by a qualified electrician following local regulations. Make sure that the power is switched off before installation.

Please read and follow the 'Installation instructions' and 'Safety instructions' sections carefully before commencing installation.

Installation of this model can change from time to time please read instructions every time before installation. For detailed specification, please go to our website eurotechlighting.co.nz

Product Information

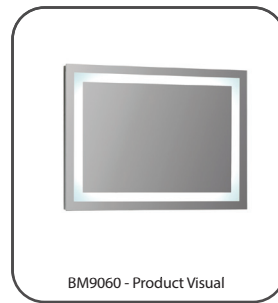

Installation Instructions | Hanging Bar Method

1. Make sure the power is turned off
2. Level the hanging by marking with a pencil in the hanging bar hole.
3. Use a drill to make the holes
4. Put the extension plug into the wall hole so both the wall holes and the hanging bar holes match. Securely screw hanging bar to wall.
5. Connect the wiring as per the below instructions.
6. Hang up the mirror. Check it is secure.
7. Turn power on & carry out required testing.

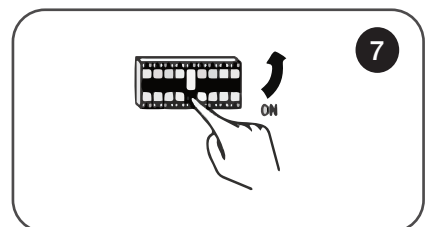
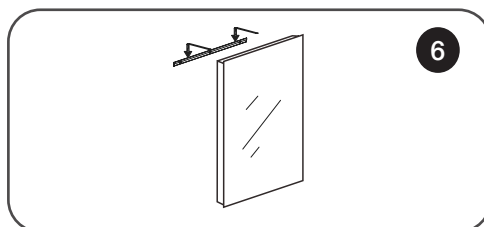
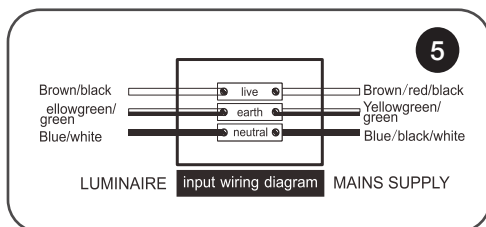
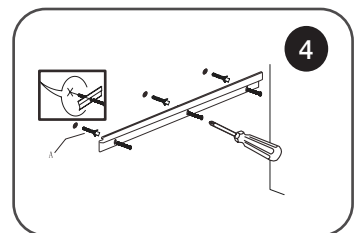
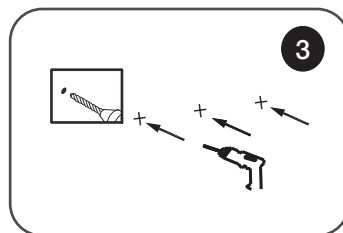
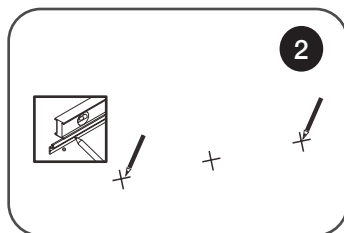
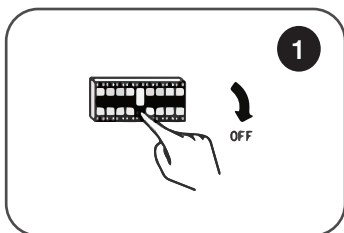

Safety Instructions

Read these instructions carefully before commencing installation.

1. The light source contained in this luminaire shall only be replaced by the manufacturer or this service agent or a similar qualified person.
2. This LED luminaire must be installed by a licensed electrician ONLY following all local regulations.
3. Ensure that the cables will not be squeezed or damaged by sharp edges.
4. Clean the light with a soft cloth and a standard PH-neutral detergent.
5. Misuse of/or changes to the appliance shall void all warranties.
6. Do not install on a surface that is not suitable or deformed.
7. Do not install on or above a surface with a high temperature.
8. There should not be any materials that are corrosive, explosive.



For detailed specification, please go to our website eurotechlighting.co.nz

Callista - LED Mirror Light Range

Model: BM9020, BM9060, BM6060, BM4214

Installation Instructions

All installations must be carried out by a qualified electrician following local regulations. Make sure that the power is switched off before installation.

Please read and follow the 'Installation instructions' and 'Safety instructions' sections carefully before commencing installation.

Installation of this model can change from time to time please read instructions every time before installation. For detailed specification, please go to our website eurotechlighting.co.nz

Product Information

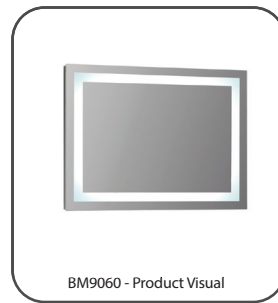

Installation Instructions - Hardy Holes Method

1. Make sure the power is turned off
2. Choose portrait or landscape installation first. Use a measuring tape to measure the distance between the two holes.
3. Using a level, mark the distance between the two holes. Use a drill to make the holes
4. Put the extension plug into the wall hole so both the wall holes and the hanging bar holes match. Securely screw hanging bar to wall.
5. Connect the wiring as per the below instructions.
6. Hang up the mirror, check it is secure.
7. Turn power on & carry out required testing.

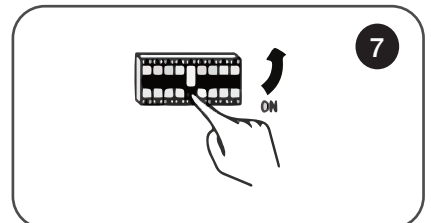
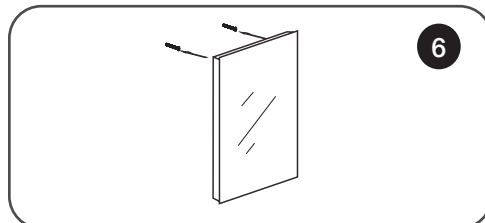
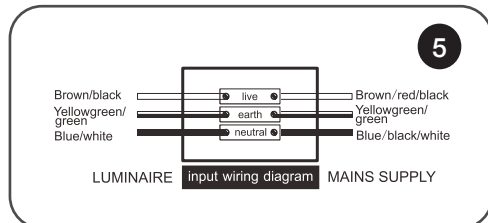
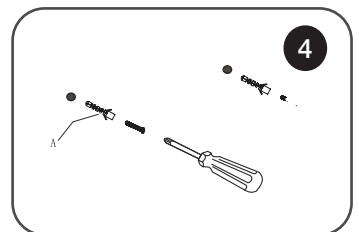
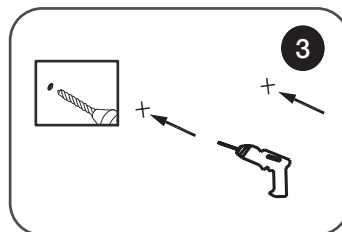
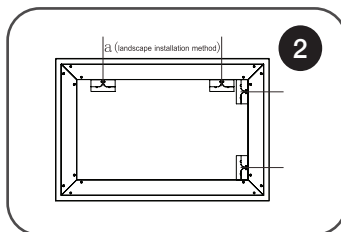
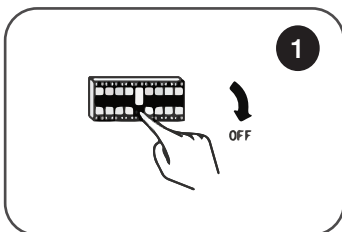

Safety Instructions

Read these instructions carefully before commencing installation.

1. The light source contained in this luminaire shall only be replaced by the manufacturer or this service agent or a similar qualified person.
2. This LED luminaire must be installed by a licensed electrician ONLY following all local regulations.
3. Ensure that the cables will not be squeezed or damaged by sharp edges.
4. Clean the light with a soft cloth and a standard PH-neutral detergent.
5. Misuse of/or changes to the appliance shall void all warranties.
6. Do not install on a surface that is not suitable or deformed.
7. Do not install on or above a surface with a high temperature.
8. There should not be any materials that are corrosive, explosive.



For detailed specification, please go to our website eurotechlighting.co.nz