

Sarah Batten

Model: SLIMBATTEN

Installation Instructions

All installations must be carried out by a qualified electrician following local regulations. Make sure that the power is switched off before installation. Please read and follow the 'Installation instructions' and 'Safety instructions' sections carefully before commencing installation.

Installation of this model can change from time to time please read instructions every time before installation. For detailed specification, please go to our website eurotechlighting.co.nz

Code:	Dimensions (mm):	IP Rating:	Kelvins:	Lumens:	Material:	Watts:
SLIMBATTEN36W4K	1200L x 80W x 43D	IP40	4000K	4200lm	Aluminium + Iron + PC	36W
SLIMBATTEN50W4K	1500L x 80W x 43D		4000K	5900lm		50W
SLIMBATTEN50W6K			6500K	6000lm		

Product Information



Installation Instructions

1. Pre-drill two 6mm diameter holes on the intended mounting surface, ensuring a depth of 30mm or more for each hole and a distance of no more than 1.1 metres apart. Gently knock the provided plastic expansion tubes provided into the pre-drilled holes, ensuring the plastic tubes are flush with the mounting surface.
2. Take the flush mounting clips and line up the fixing holes to the pre-drilled location holes on your mounting surface. Fix both flush mounting clips using the screws provided.
3. Open the back terminal cover plate of the termination box to find the connection terminal and interconnect mains power supply cables with the connection terminal. Make sure that all connections are secure and properly tightened.
4. Clip the slim LED batten onto the flush mounted clips.
Ensure installation is correct before switching on the fitting to test.

Please refer to the "switching capacity specifications" of this fitting when application is alongside technology such as sensors and dimmers.

Please refer to our website for more information (www.eurotechlighting.co.nz), or contact a Eurotech Lighting Consultant on: 09 818 6039

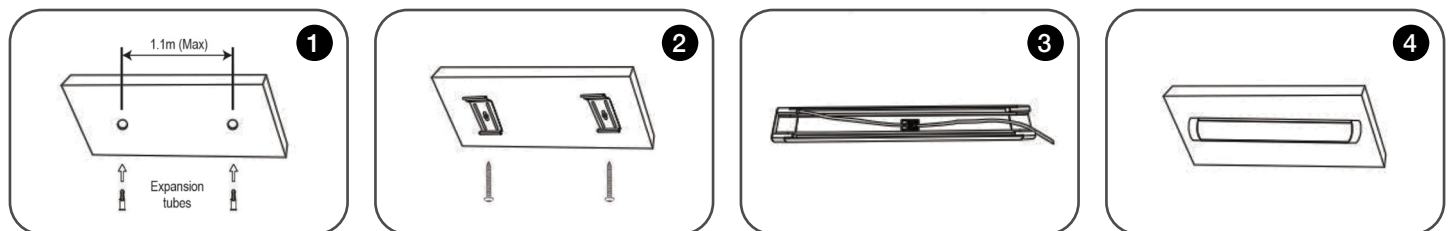

Safety Instructions

Read these instructions carefully before commencing installation.

1. The light source contained in this luminaire shall only be replaced by the manufacturer or this service agent or a similar qualified person.
2. This LED luminaire must be installed by a licensed electrician ONLY following all local regulations.
3. Ensure that the cables will not be squeezed or damaged by sharp edges.
4. Clean the light with a soft cloth and a standard PH-neutral detergent.
5. Misuse of/or changes to the appliance shall void all warranties.
6. Do not install on a surface that is not suitable or deformed.
7. Do not install on or above a surface with a high temperature.
8. There should not be any materials that are corrosive, explosive.



For detailed specification, please go to our website eurotechlighting.co.nz