

NIKAU - Spotlight on Spike

Model: LSP1007

Installation Instructions

All installations must be carried out by a qualified electrician following local regulations. Make sure that the power is switched off before installation. Please read and follow the 'Installation instructions' and 'Safety instructions' sections carefully before commencing installation.

Installation of this model can change from time to time please read instructions every time before installation. For detailed specification, please go to our website eurotechlighting.co.nz

| Code: | Colour: | Dimensions (mm): | IP Rating: | Lamps: | Material: | Voltage: |
|---------|---------|------------------|------------|-------------------------------|--|----------|
| LSP1007 | Black | 86Ø x 132L | IP54 | MR16 7W max (Not Included) | UV resistant, anti-corrosion, ABS + PC body & diffuser | 12V |

Product Information



Installation Instructions

1. Before starting the installation, please ensure that the power is disconnected.
2. Remove the waterproof lamp cover and install the correct low voltage LED lamp. The lamp must not exceed the specified wattage of the light fitting. Make sure that all seals are reinstalled for waterproofing.
3. Remove the screw from the base of the ground spike and use to screw the light fitting base to the spike.
4. Connect the brown(live) wire to the corresponding terminal on the terminal block (marked L) and the blue (neutral) wire to the corresponding terminal on the terminal block (marked N). Make sure this connection is enclosed in an appropriate IP54 enclosure or similar.
5. Position light in the ground and reconnect the power source.
6. Please do not look directly at the LED lamp once on.

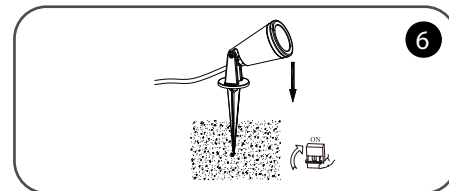
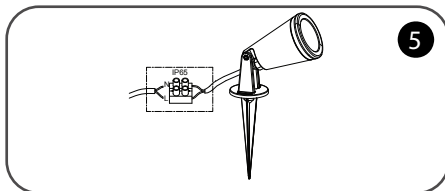
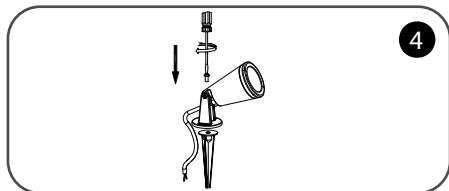
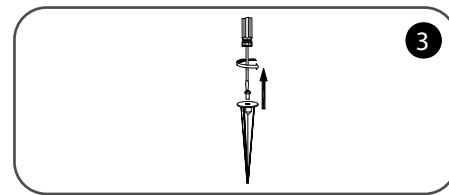
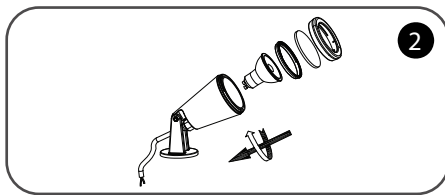
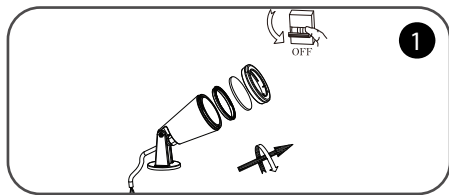

Safety Instructions

Read these instructions carefully before commencing installation.

1. This LED luminaire must be installed by a licensed electrician ONLY following all local regulations.
2. Ensure that the cables will not be squeezed or damaged by sharp edges.
3. Clean the light with a soft cloth and a standard PH-neutral detergent.
5. Do not install on a surface that is not suitable or deformed.
6. Do not install on or above a surface with a high temperature.
7. There should not be any materials that are corrosive, explosive.



For detailed specification, please go to our website eurotechlighting.co.nz