

Floodlight

Model: 10W, 20W & 30W - Sensor & Non-Sensor
Installation Instructions

All installations must be carried out by a qualified electrician following local regulations. Make sure that the power is switched off before installation.

Please read and follow the 'Installation instructions' and 'Safety instructions' sections carefully before commencing installation.

Installation of this model can change from time to time please read instructions every time before installation. For detailed specification, please go to our website eurotechlighting.co.nz

Code:		Colour:	Dimensions (mm):	IP Rating:	Kelvins:	Lumens:	Material:	Voltage:	Wattage:
LEDFLOOD10W4K	Non-Sensor	Available in Black & White	130L x 90W x 34D	IP65	4000K	930lm	Powder coated aluminium	230V	10W
LEDFLOOD10W4KS	Sensor								
LEDFLOOD20W4K	Non-Sensor		180L x 126W x 36D			2000lm			30W
LEDFLOOD20W4KS	Sensor								
LEDFLOOD30W4K	Non-Sensor		210L x 147W x 37D						
LEDFLOOD30W4KS	Sensor								

Product Information



Installation Instructions

1. Ensure mains power supply has been switched off.
2. Mount the fittings bracket to your building element with the screws provided.
3. Connect mains power to the fitting and terminate the connection in an IP rated junction box.
4. Connect the fitting to its bracket, making sure the fitting is in its desired direction before tightening the screws.
5. Turns mains power back on and test that the fitting works properly.

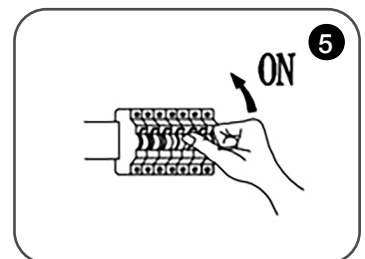
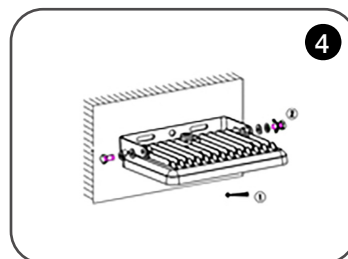
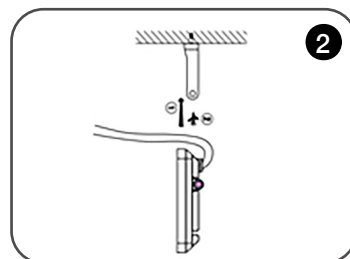
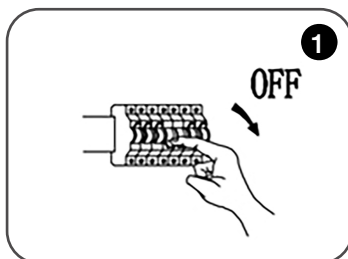

Safety Instructions

Read these instructions carefully before commencing installation.

1. The light source contained in this luminaire shall only be replaced by the manufacturer or this service agent or a similar qualified person.
2. This LED luminaire must be installed by a licensed electrician ONLY following all local regulations.
3. Ensure that the cables will not be squeezed or damaged by sharp edges.
4. Clean the light with a soft cloth and a standard PH-neutral detergent.
5. Misuse of/or changes to the appliance shall void all warranties.
6. Do not install on a surface that is not suitable or deformed.
7. Do not install on or above a surface with a high temperature.
8. There should not be any materials that are corrosive, explosive.



For detailed specification, please go to our website eurotechlighting.co.nz

Floodlight Remote Instructions

Model: 10W, 20W & 30W - Sensor Version

All installations must be carried out by a qualified electrician following local regulations. Make sure that the power is switched off before installation. Please read and follow the 'Installation instructions' and 'Safety instructions' sections carefully before commencing installation. Installation of this model can change from time to time please read instructions every time before installation. For detailed specification, please go to our website eurotechlighting.co.nz

Remote Functions:

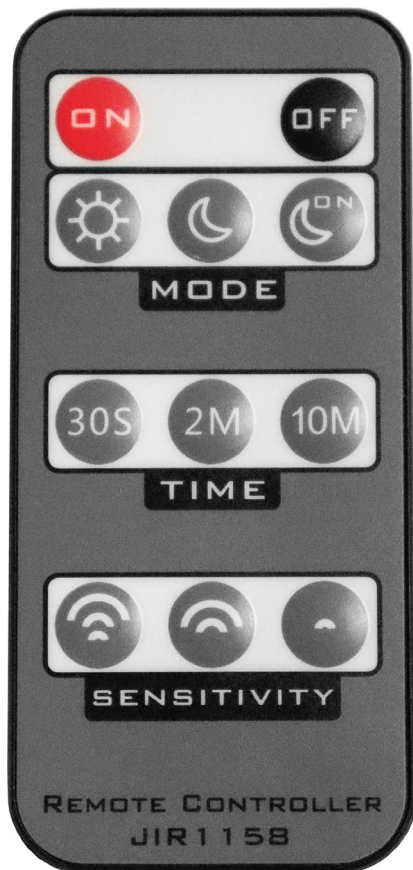

*ON: Manuel Override: Light will stay on. For use if you require your light to stay on for longer than 10M (e.g. fixing your car in your driveway). Refer sensor setup instructions below



*OFF: Will turn fitting off if required (e.g. if a stormy night is causing light to go on repeatedly). Note: When turned back on with "on" button previous operation selection below will be remembered.

*** ON/ OFF functions over ride sensor function. If ON/OFF buttons are used you must reset sensor. Refer sensor setup instructions below**

MODE:



DAY AND NIGHT OPERATION MODE: Sensor function (activation by movement) works during the day and the night. Will come on when movement is detected and will stay on for the time set then go off.



NIGHT OPERATION MODE: Sensor function (activation by movement) works during the night only (when light level below 50 lux). Light will come on when movement is detected and will stay on for the time set then go off.



ALL NIGHT MODE: The light comes on at night (when light level below 50 lux) and stays on until daylight (when light level above 50 lux). Light comes on in the dark and stays on.

TIME: S: second M: minute



30S: means after 30 seconds, the lamp will turn off



2M: means after 2 minutes, the lamp will turn off



10M: means after 10 minutes, the lamp will turn off

SENSITIVITY:



Detection range 5-8 metres



Detection range 3-5 metres







Detection range 1-3 metres

Sensor Setup Instructions:

***Note: Each time you push a function button your flood will flash to let you know the floodlight has receive the function instruction.**

Your sensor light is ready to go in 5 easy steps.

-  Push ON button to start
-  Select the MODE button that you want your sensor function to be enabled for eg: Night Operation Mode, which will enable your sensor light to function during low light levels.
Recommended setting is, night operation mode.
-  Select the length of TIME button that you wish your light to stay on eg: 30S means after 30 seconds, the lamp will turn off.
Recommended time setting is 2 minutes.
-  Select the SENSITIVITY button of the sensor eg: this will enable how far away something is detected to turn on your light fitting on.
Recommended sensitivity setting is 3-5 metre range: so movement from trees or neighbours does not affect sensor.
- The remote is now set up in sensor mode, ready to use

