

Pluto Highbay

Model: PLUTOHB / PLUTO+

Installation Instructions

All installations must be carried out by a qualified electrician following local regulations. Make sure that the power is switched off before installation. Please read and follow the 'Installation instructions' and 'Safety instructions' sections carefully before commencing installation. Installation of this model can change from time to time please read instructions every time before installation. For detailed specification, please go to our website eurotechlighting.co.nz

Code:	Colour:	Dimensions (mm):	Kelvins:	Beam Angles:	Material:	Voltage:	Wattage:
PLUTOHB / PLUTO+	Black	Ø330mmDia x 152H	4000K 5000K 6000K	90°	Aluminium alloy & PC symmetrical len	100-277 VAC	200W 160W 120W

Product Information



*PLUTOSENSOR, REMOTE & DIFFUSER SOLD SEPARATELY

Installation Instructions

1. Ensures mains power supply has been switched off.
2. Remove from packaging & check the product carefully to ensure there is no damage. DO NOT knock or stack highbays once removing from packaging.
3. This luminaire is designed to be installed In suspension from the ceiling by means of a chain or thick cable that can withstand the weight of this. Screw the M10 hook on the packaging to the luminaire as shown in the image below.
4. Install the coarse wire or cable to the ceiling by screwing it or using a suspension kit for ceiling fixture installations. Check that the fixing is correct before connecting the wiring. If the luminaire is held securely, proceed with the connection of the luminaire to the power supply.
5. Check that the supply voltage is correct and connect the power cables of the correct terminals or as per your local colour code.
6. To adjust the wattage or colour temperature you can access this via the rubber bung that is on the top part of the highbay. For wattage, you have three switch selections to pick from: Low (120W), Mid (160W) , High (200W). To change the colour temperature, you select the following switch options to select the desired colour temperature: A: 4000K, A+B: 5000K, B: 6000K.

Note - LoADJ dial is for manufacturing purposes only, any tampering will void the warranty

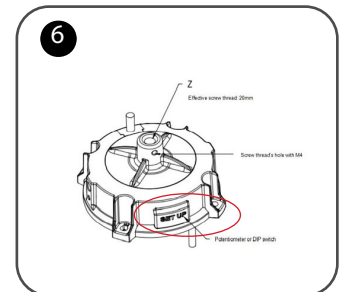
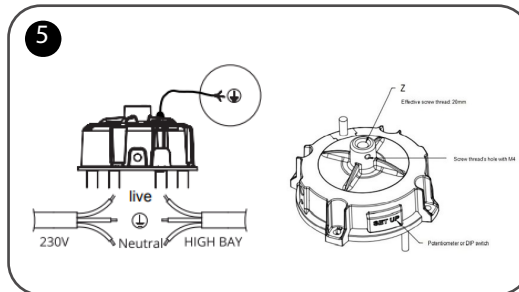
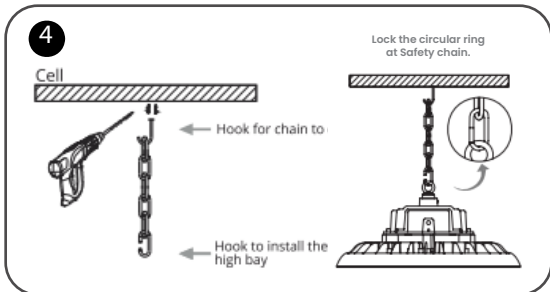
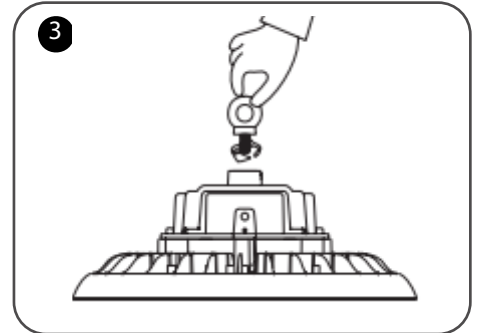
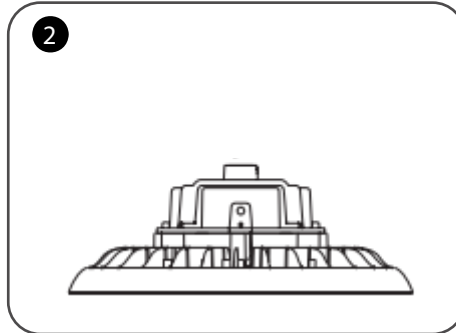
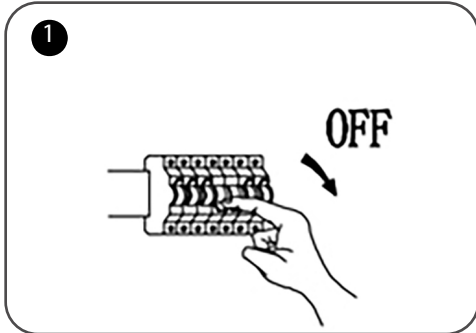

Safety Instructions

Read these instructions carefully before commencing installation.

1. The light source contained in this luminaire shall only be replaced by the manufacturer or this service agent or a similar qualified person.
2. This LED luminaire must be installed by a licensed electrician ONLY following all local regulations.
3. Ensure that the cables will not be squeezed or damaged by sharp edges.
4. Clean the light with a soft cloth and a standard PH-neutral detergent.
5. Misuse of/or changes to the appliance shall void all warranties.
6. Do not install on a surface that is not suitable or deformed.
7. Do not install on or above a surface with a high temperature.
8. There should not be any materials that are corrosive, explosive.



For detailed specification, please go to our website eurotechlighting.co.nz

