

Byron - Wall Lights

Model: LUS

Installation Instructions

All installations must be carried out by a qualified electrician following local regulations. Make sure that the power is switched off before installation. Please read and follow the 'Installation instructions' and 'Safety instructions' sections carefully before commencing installation.

Installation of this model can change from time to time please read instructions every time before installation. For detailed specification, please go to our website eurotechlighting.co.nz

Code:	Colour:	Dimensions (mm):	Double Insulated:	IP Rating:	Lamps:	Material:	Shape:	Type:	Voltage:
LUS2004	Black	186H x 76Ø x 99D	Yes	IP54	2 x GU10 10W max (Not Included)	UV resistant, anti-corrosion ABS + PC body & diffuser	Round	Up/Down	230V
LUS2204		215H x 90Ø x 113D					Square		
LUS2003		186H x 76W x 99D					Round		
LUS2203		215H x 90W x 113D							
LUS1004		148H x 76Ø x 99D			1 x GU10 10W max (Not Included)		Round	One-Way	
LUS1104		162H x 90Ø x 113D					Square		
LUS1003		148H x 76W x 99D							
LUS1103		162H x 90W x 113D							

Product Information



Installation Instructions

1. Make sure power is turned off.
2. Open the back plate of fitting with a phillips screwdriver.
3. Open the top and bottom of the fitting with an included Allen key.
4. Gently knock the provided plastic expansion tubes into the pre-drilled holes, ensuring the plastic tubes are flush with the mounting surface. Run the cable through the rubber seal. Fix the backplate to the mounting surface ensuring the arrow is facing up.
5. Connect cables paying attention to live + neutral markings.
Blue = Negative
Brown = Positive
6. Fit the body to the backplate with provided screws. Screw backplate back onto fitting.
7. Insert GU10 bulbs into the fitting. Refix caps with provided Allen key ensuring a tight seal is made.

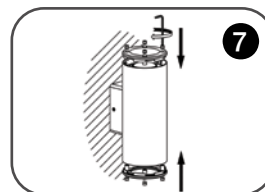
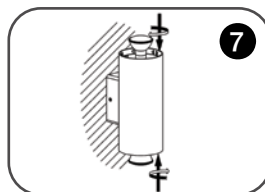
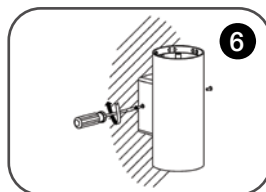
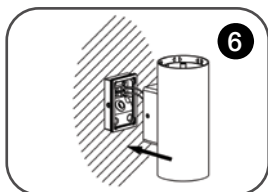
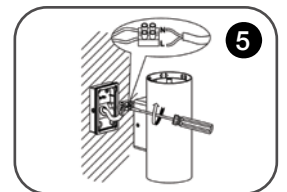
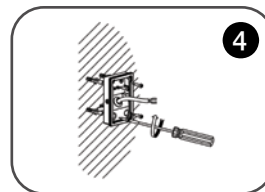
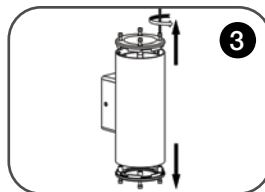
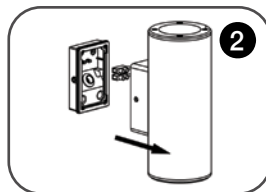
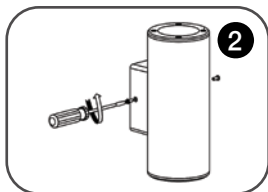

Safety Instructions

Read these instructions carefully before commencing installation.

1. This LED luminaire must be installed by a licensed electrician ONLY following all local regulations.
2. Ensure that the cables will not be squeezed or damaged by sharp edges.
3. Clean the light with a soft cloth and a standard PH-neutral detergent.
4. Misuse of/or changes to the appliance shall void all warranties.
5. Do not install on a surface that is not suitable or deformed.
6. Do not install on or above a surface with a high temperature.
7. There should not be any materials that are corrosive, explosive.



For detailed specification, please go to our website eurotechlighting.co.nz

