

# iVAC

## FILL LEVEL METER

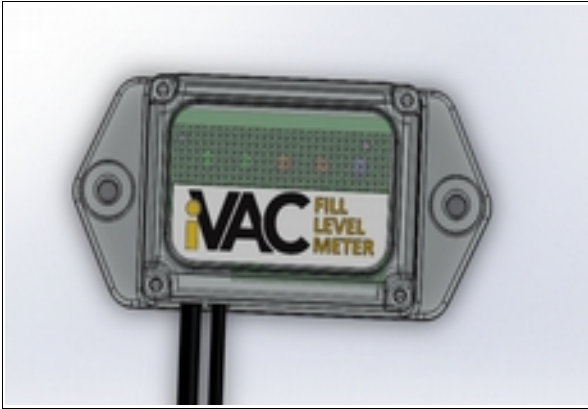
## INSTRUCTIONS



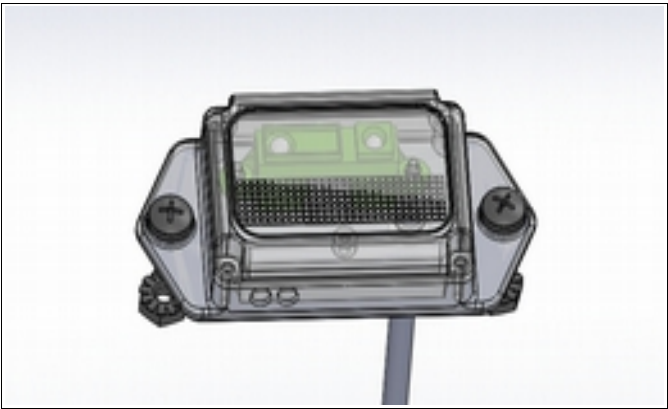
15840-0010

*full dust bins lead to clogged filters  
and reduced air flow – iVAC will help  
you to avoid this*

To gain the full benefit of your iVAC Fill Level Meter -  
please read these instructions **before** installation and use.



**DISPLAY MODULE**  
Visual level indicator



**SENSOR MODULE**  
Bin level sensor

There are three components, a Display module, a Sensor module and a USB 5 volt power supply.

The Display module has an array of five LED's indicating five pre-set fill levels. The first two LED's are green, the next two are orange and the final "FULL" indication is a flashing blue / red indicating a full bin that needs to be emptied.

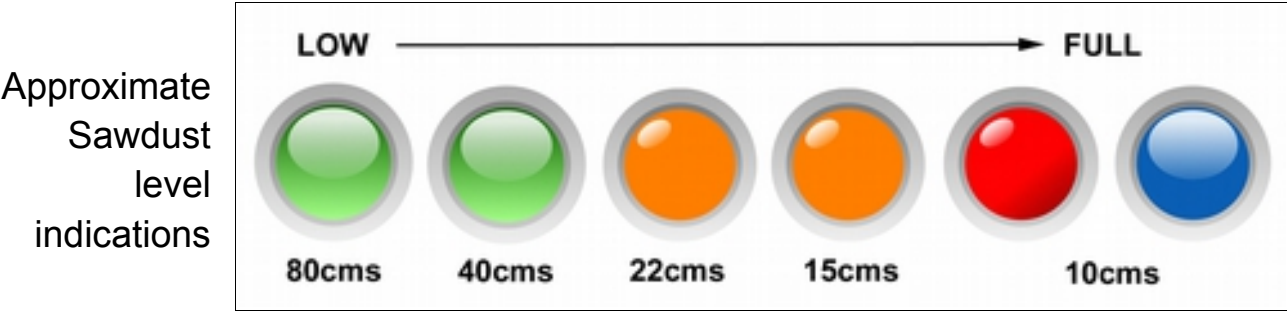
The Display module should be mounted in a prominent location in your workshop, giving you visual indications as your dust bin fills with sawdust.

The Sensor module uses Infra Red to detect dust levels in the dust bin and is installed to the underside of the lid of your dust bin. See figure "A"

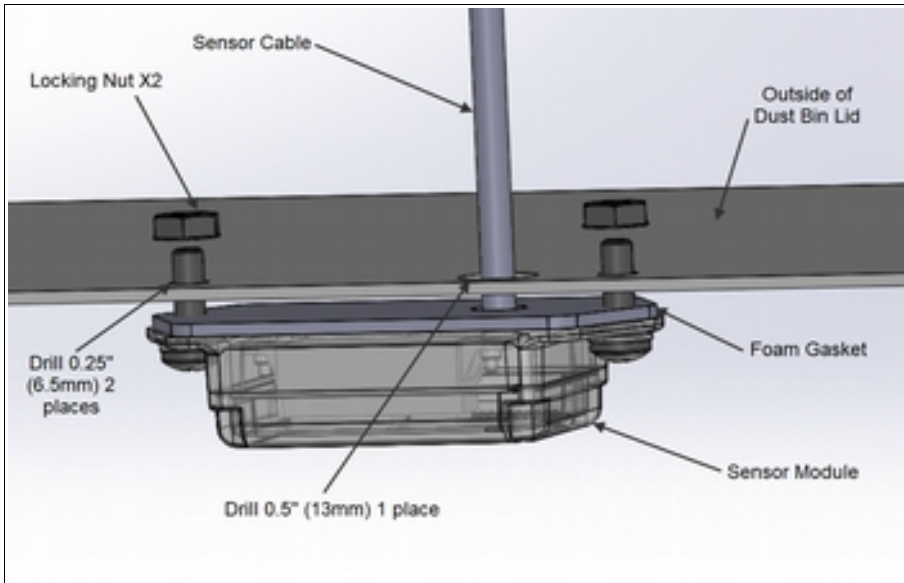
A drawing is provided showing the hole sizes and drilling locations in preparation for Sensor module installation. See Figure "B".

Connect the USB supply and you are setup and ready to go.

Once installed and connected, test the system by running your hand toward and away from the Sensor Module to get an indication of the different LED levels.

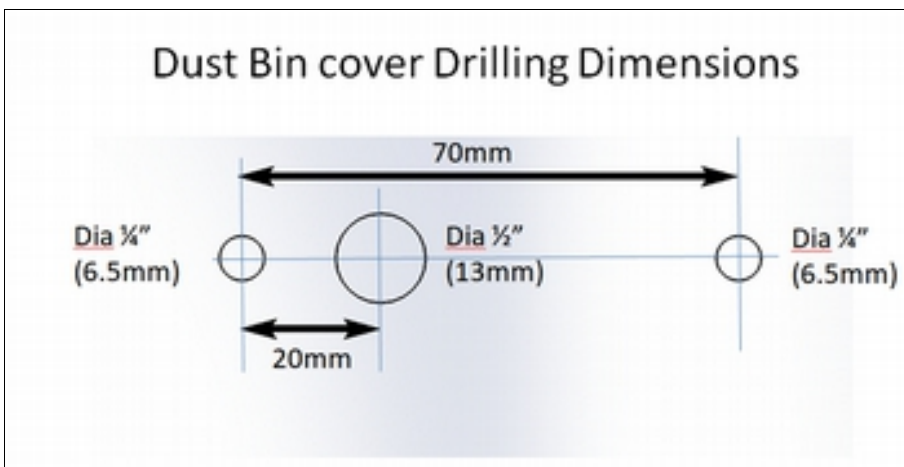


**FIGURE "A"**



The sensor module is fixed to the underside of your dust bin lid, perpendicular to the deepest area of your bin, and away from the central dust vortex. The second gasket is provided for bin lids that are not flat (an air tight seal is required). Add extra sealant if required.

**FIGURE "B"**



Drill the holes and feed the cable through the center hole from the inside, fasten the sensor unit to the lid - slightly compressing the sealing gasket. The second gasket can be used as a drill hole template.

**FIGURE "C"**



Connect the cables together as shown in Figure "C". Lining up the arrows as you push the fittings together. Tighten the nut to secure the fittings. The cable is 2.6 metres long.

**EARTHING**

Earthing the dust bin is recommended to prevent potentially damaging static build up and discharges through the Fill Level meter and it's wiring.

## **OPERATION**

The level sensing is more accurate and consistent when the extractor is off – suspended sawdust particles in the drum can lead to inaccurate indications.

Gently clean (with a soft, dry cloth) the sensor module if the indications become inaccurate – dust on the sensor surface can impair its performance.

Unplug (isolate) the system when unattended. e.g. night time and weekends.

## **GUARANTEE - Fill Level Meter 15840-0010**

The iVAC Fill Level Meter is guaranteed against defects in material and workmanship, under normal usage, for one year from the date of purchase.

This guarantee is not transferable and does not affect your statutory rights.

This guarantee does not apply in cases of improper use, negligence, lack of maintenance, lack of adequate dust bin earthing or accidental damage.

Under the terms of this guarantee a faulty Fill Level Meter will either be repaired or replaced free of charge.

Liability is limited to the Fill Level Meter only, no other costs will be reimbursed.

This guarantee does not confer any rights other than those expressly set out above.

## **SERVICE AND REPAIRS**

The iVAC Fill Level Meter can be repaired and maintained in our UK workshop. Beyond the guarantee period (one year) these repairs are chargeable.

We can provide a quote once the Fill Level Meter has been inspected and tested.

## **CONTACT**

**United Kingdom – Toolovation**

[www.toolovation.co.uk](http://www.toolovation.co.uk)

[ivac@toolovation.co.uk](mailto:ivac@toolovation.co.uk)

01531 636819



**Canada (head office) – iVAC**

[www.ivacswitch.com](http://www.ivacswitch.com)

[info@ivacswitch.com](mailto:info@ivacswitch.com)

