



FRAME WHEELS

Assembly Instructions

The information in this document is subject to change without notice.
© Copyright The Net Return™ 2007, 2021. All rights reserved.

767501

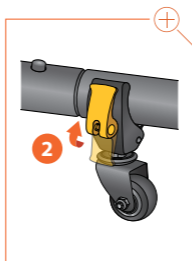
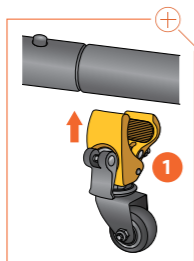
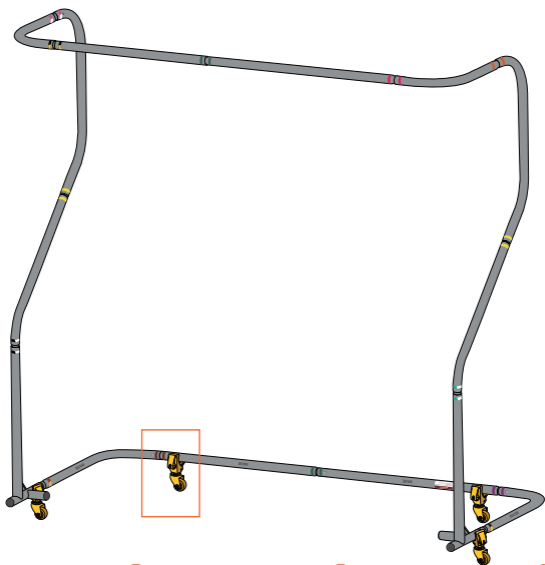

1. Starting at one of the locations highlighted above, fit a frame wheel over the frame as shown. It should be a snug fit.
2. Once in position, snap the lever up into place to clamp the wheel to the frame.
3. If the lever is too tight to snap into place, hold as shown and rotate one turn clockwise and then snap the lever up into place. If the lever is too loose, rotate the lever one turn counter clockwise.