

## Step 43 x 2

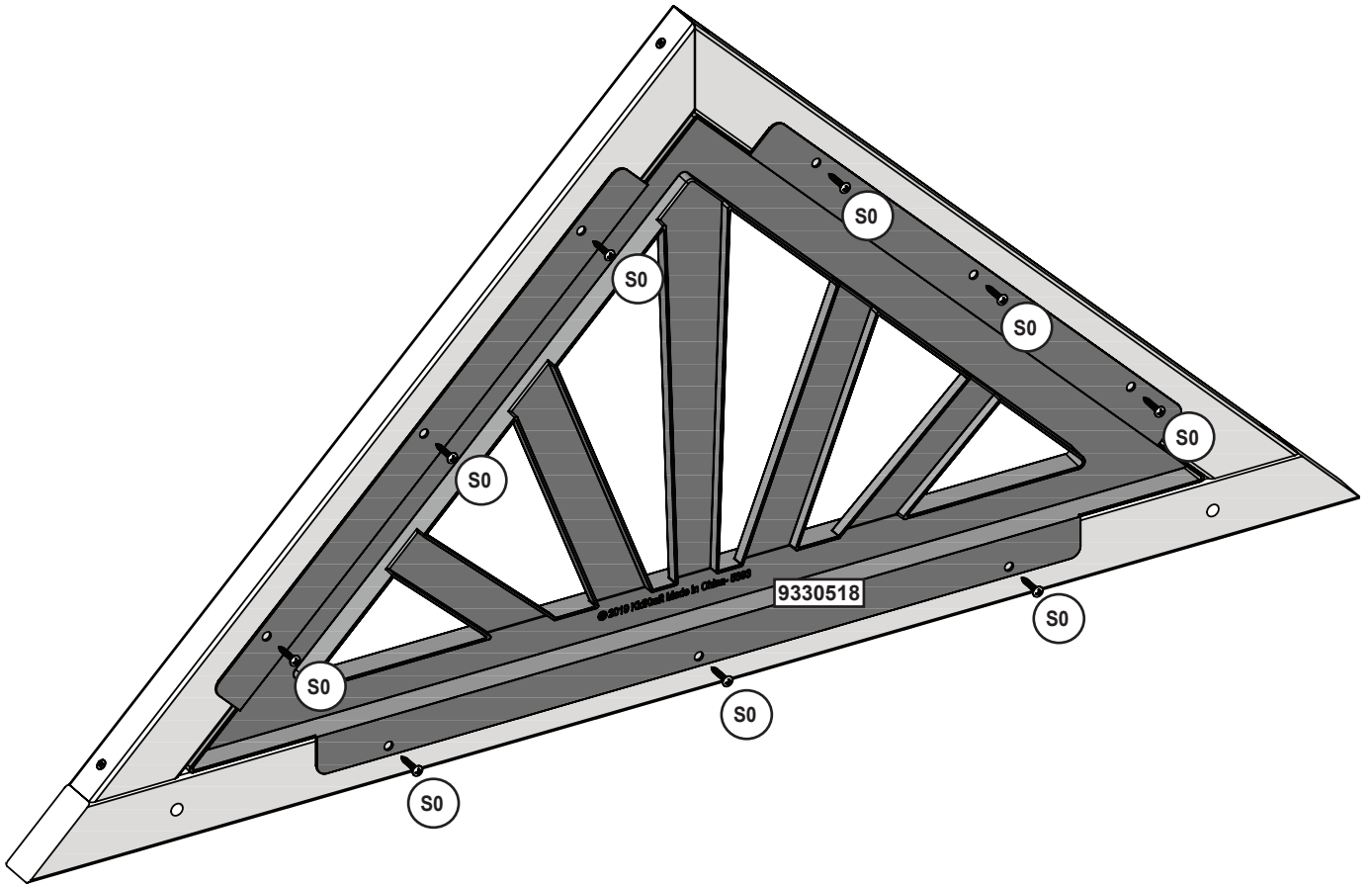

### Hardware

18 x  #8 x 22.2mm (#8 x 7/8")

### Other Parts

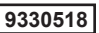
2 x 

# Step 44

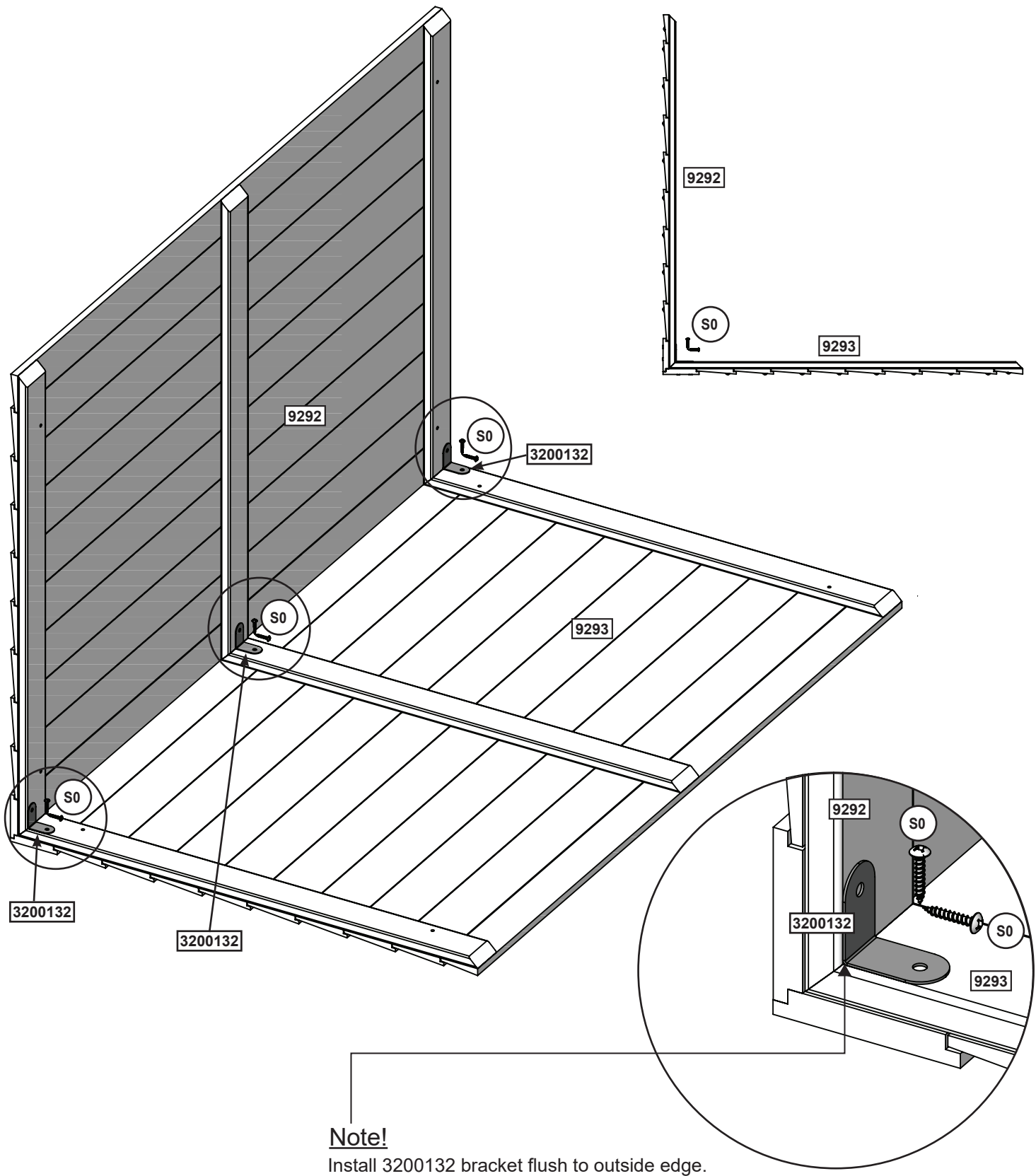

**Note!**  
Install 3200132 bracket flush to outside edge.

**Wood Parts**

- 1 x 9292 28.6 x 1270 x 801.7 mm (1-1/8" x 50" x 31-13/16")
- 1 x 9293 28.6 x 1270 x 801.7 mm (1-1/8" x 50" x 31-13/16")

**Hardware**

- 6 x S0 #8 x 22.2mm (#8 x 7/8")

**Other Parts**

- 3 x 3200132

# Step 45

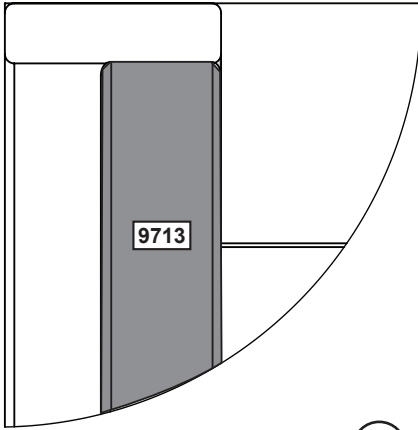

Gables should be flush to inside edges on both sides

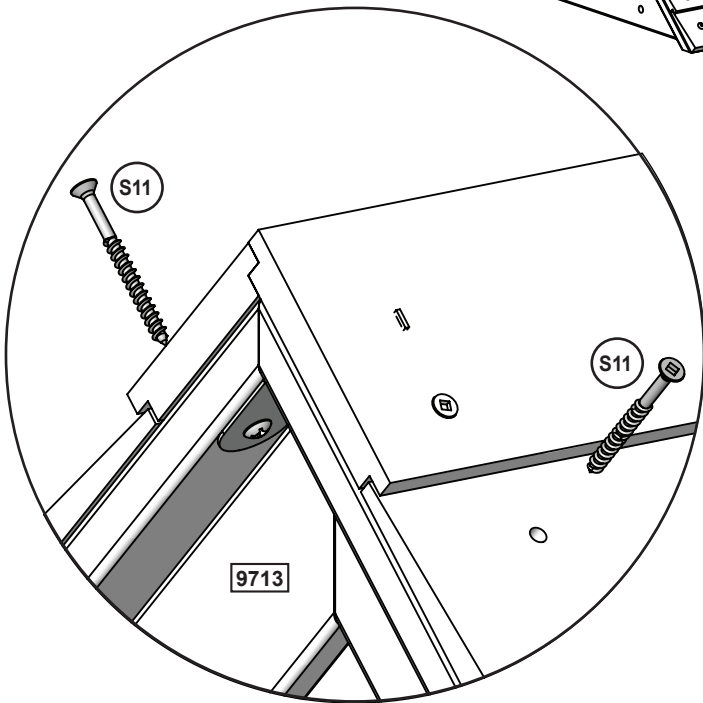
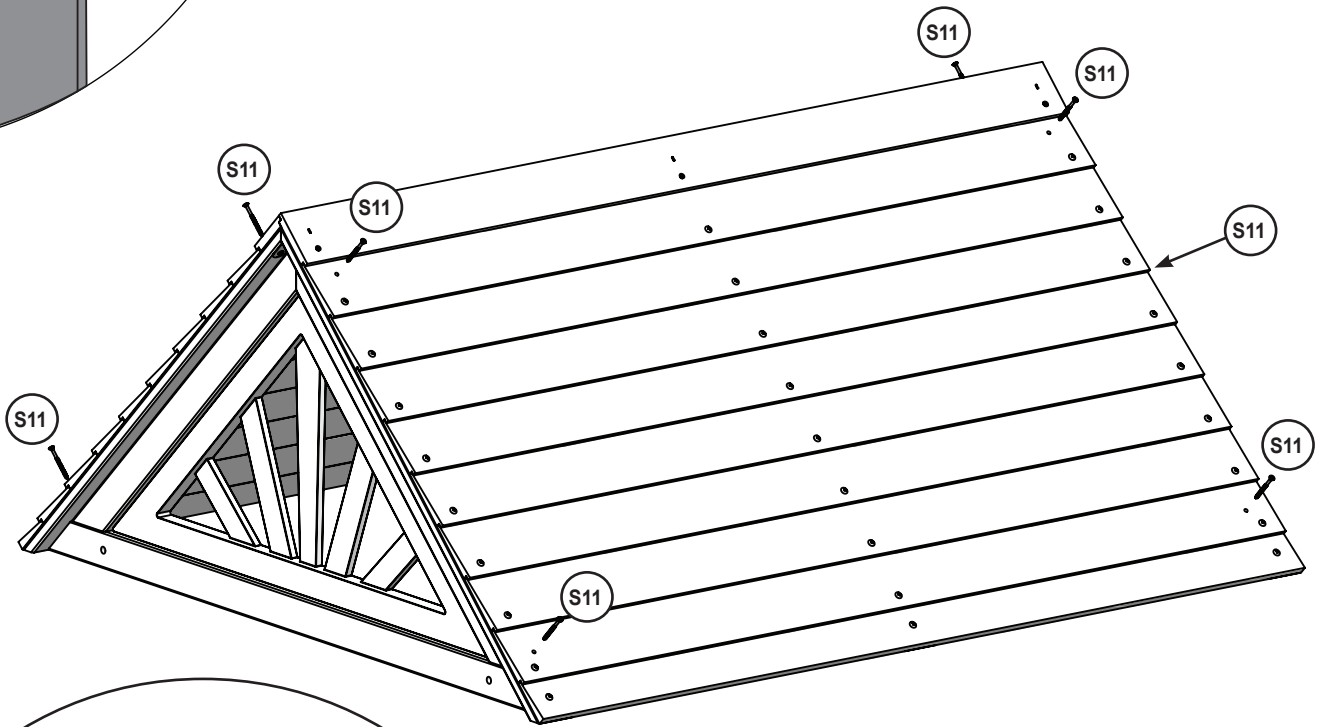

### Hardware

8 x  #8 x 50.8mm (#8 x 2")

# Step 46

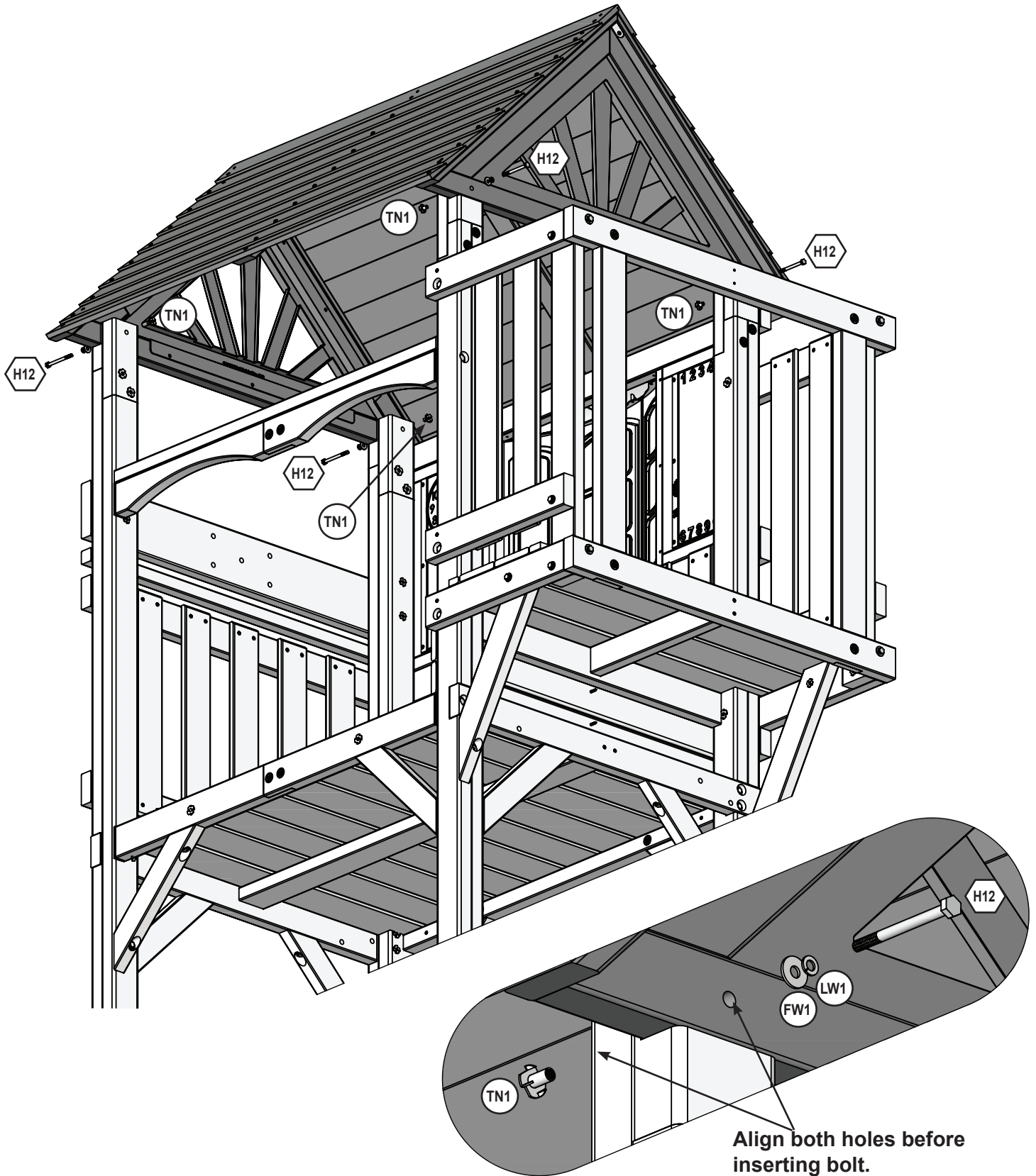

### Hardware

4 x  6.4mm x 76.2 mm (1/4 x 3") (FW1, LW1, TN1)

# Step 47



**IMPORTANT!**  
Follow hole pattern

**Do not attach**  
Put aside until  
Step 50

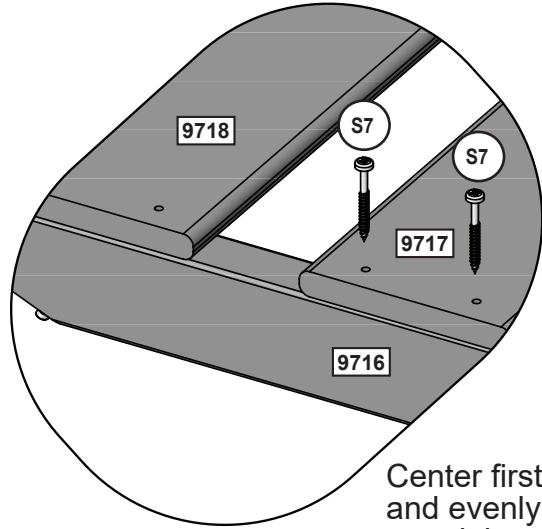

Center first board  
and evenly space  
remaining

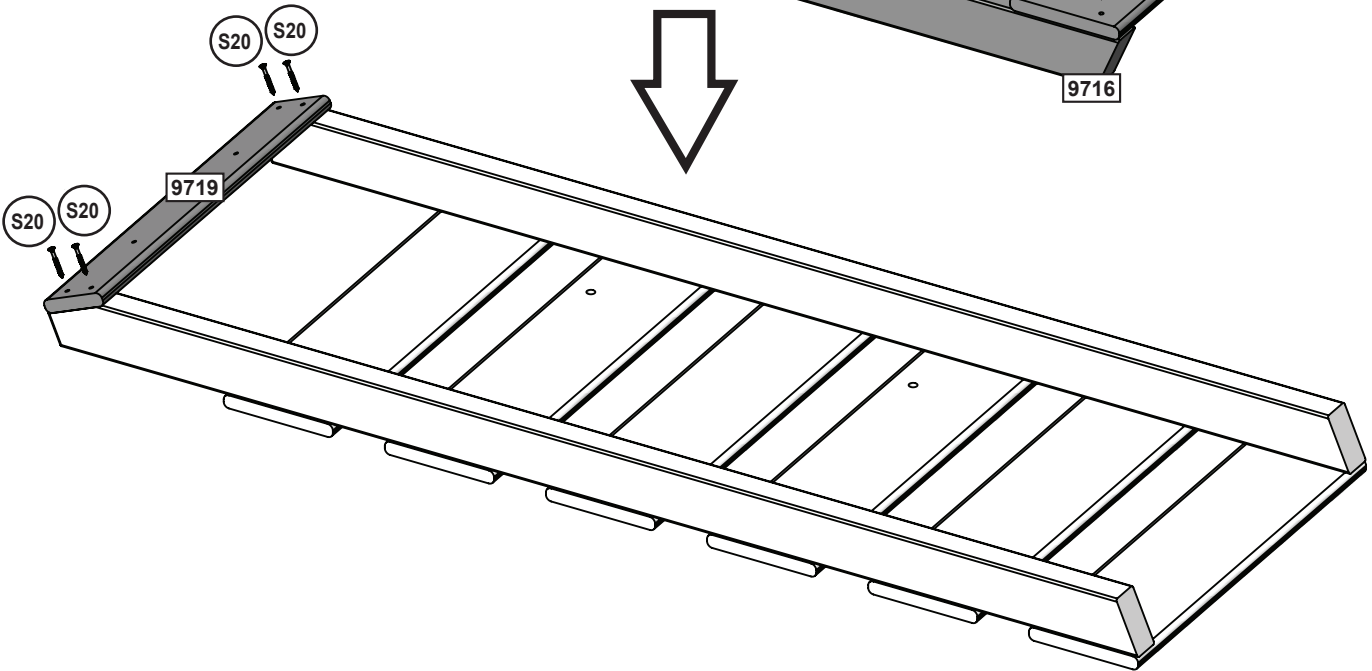
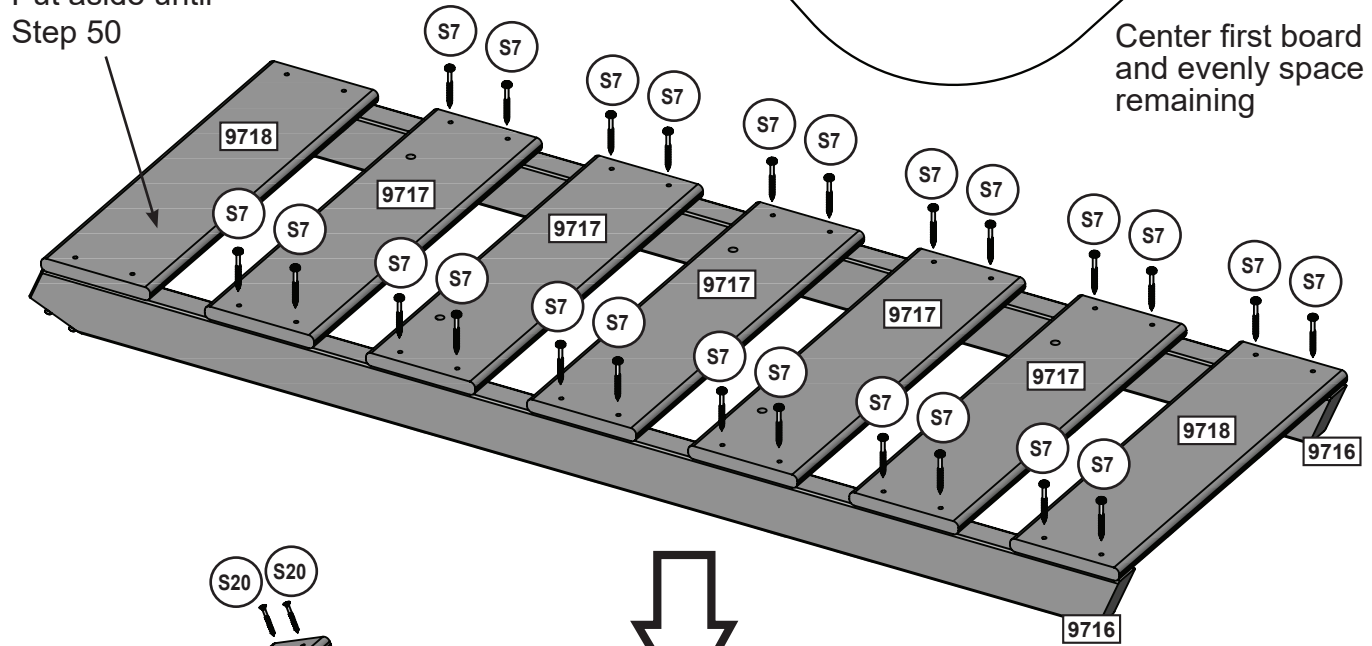

**Wood Parts**

- 2 x 34.9 x 63.5 x 1332.8 mm (1-3/8" x 2-1/2" x 52-1/2")
- 5 x 15.9 x 133.4 x 482.6 mm (5/8" x 5-1/4" x 19")
- 2 x 15.9 x 133.4 x 482.6 mm (5/8" x 5-1/4" x 19")
- 1 x 15.9 x 76.2 x 482.6 mm (5/8" x 3" x 19")

**Hardware**

- 24 x #12 x 50.8mm (#12 x 2")
- 4 x #8 x 35mm (#8 x 1-3/8")

# Step 48

Note: Make sure all hardware is used to properly secure each rock.

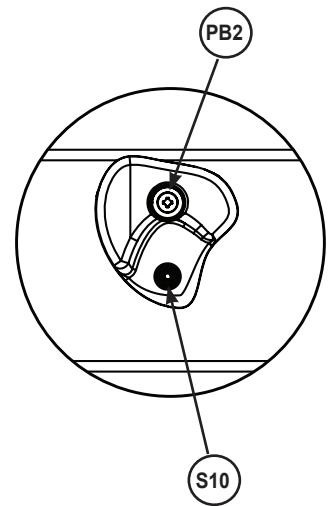
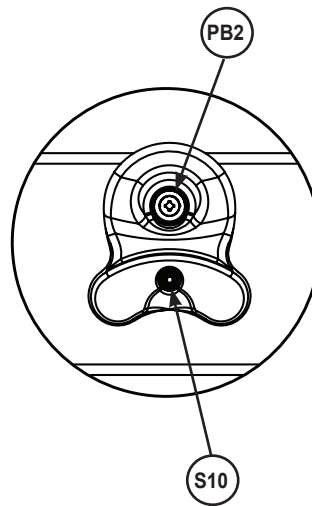
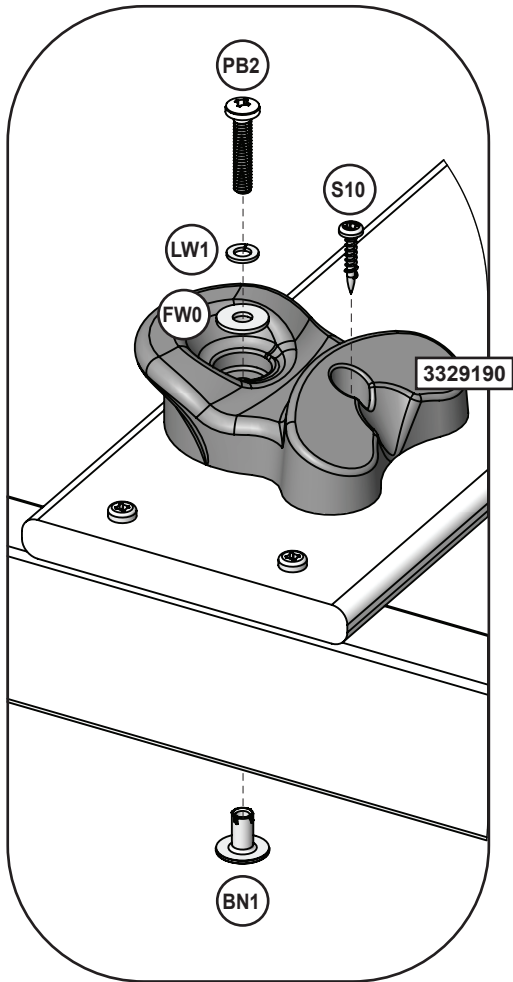
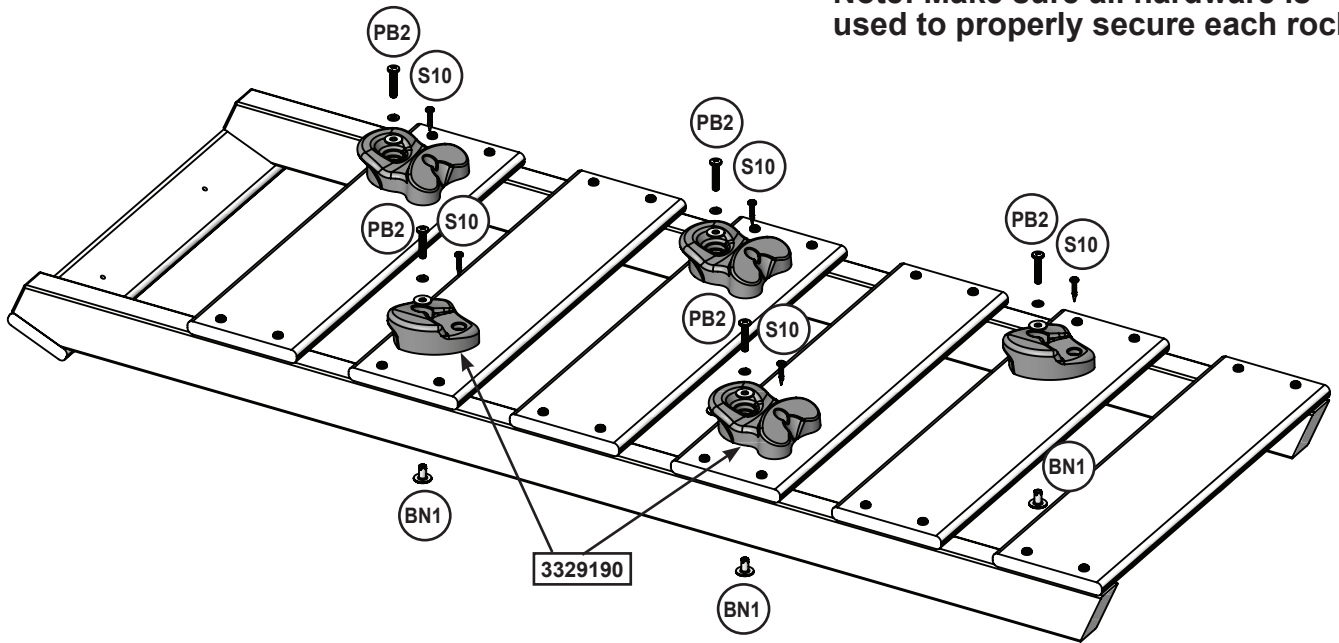

### Hardware

- 5 x (PB2) 7.9mm x 32 mm (5/16 x 1-1/4") (FW0,LW1,BN1)
- 5 x (S10) #8 x 25.4 mm (#8 x 1")

### Other Parts

- 1 x 3329190

# Step 49

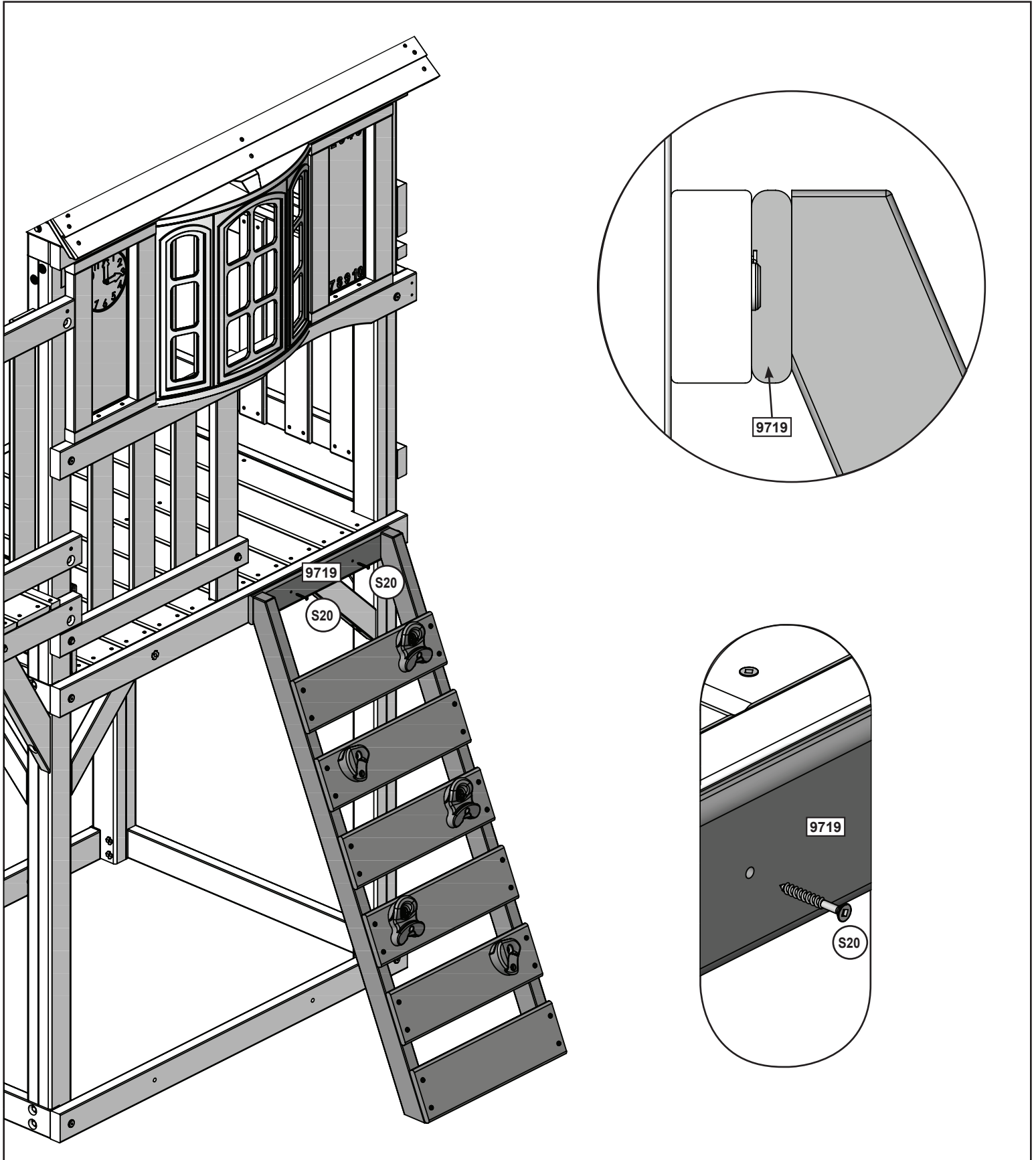

### Hardware

2 x (S20) #8 x 35mm (#8 x 1-3/8")

# Step 50

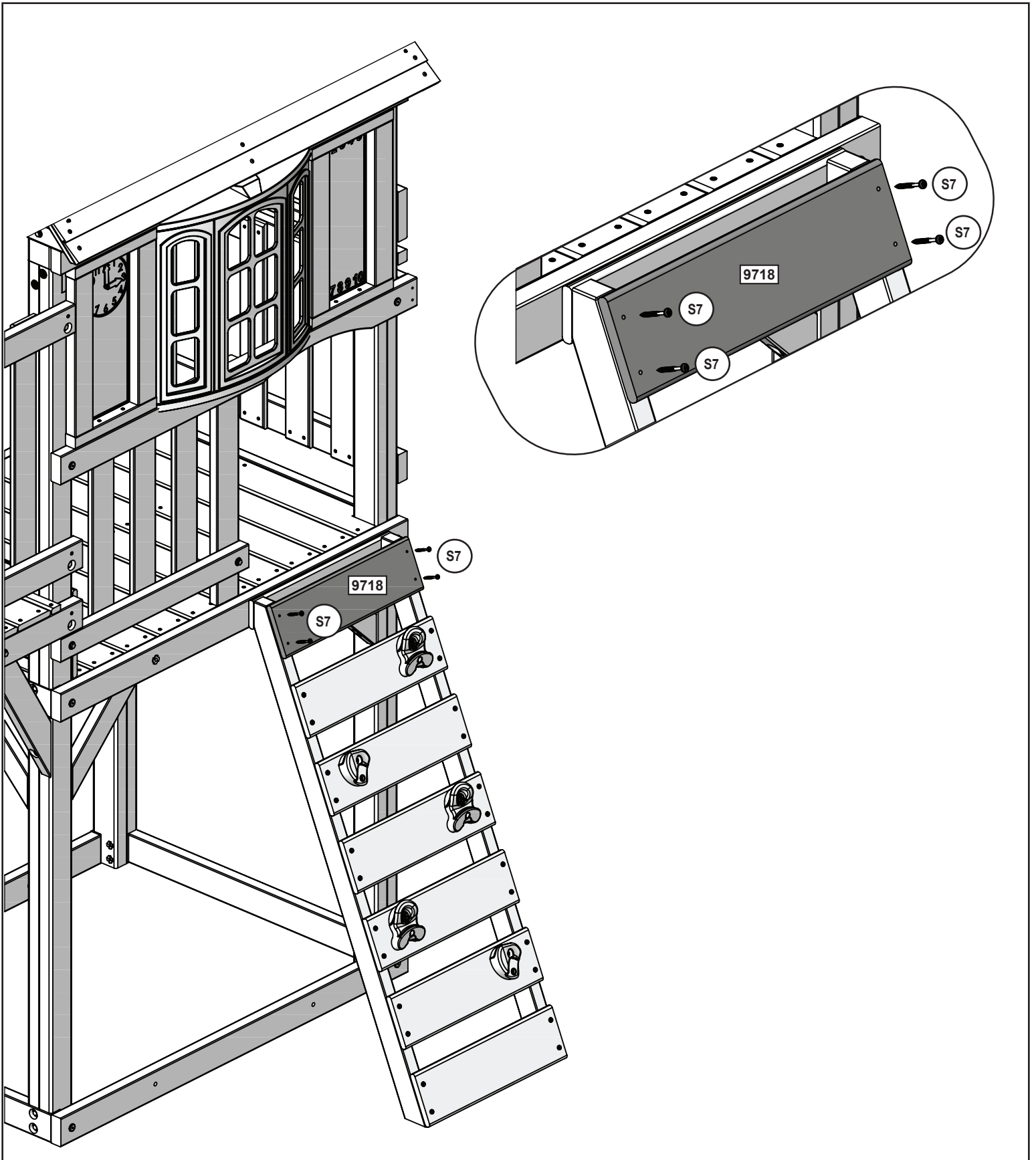

## Hardware

4 x  #12 x 50.8mm (#12 x 2")



# Step 51

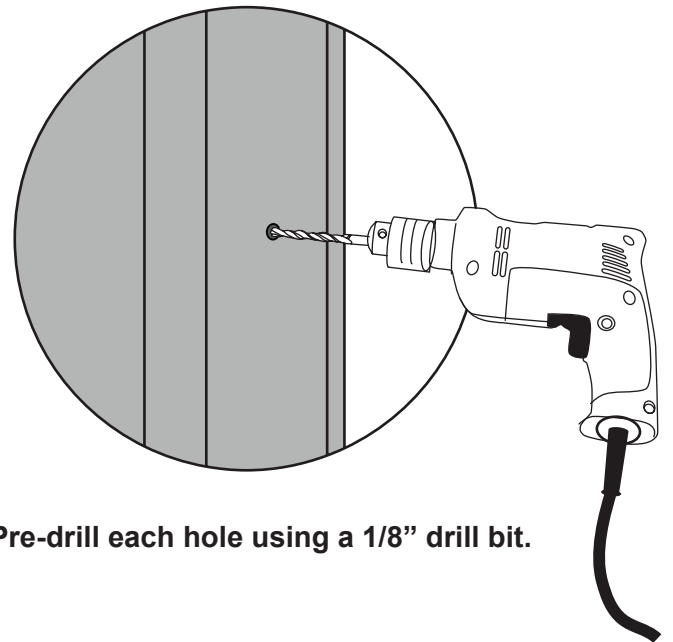
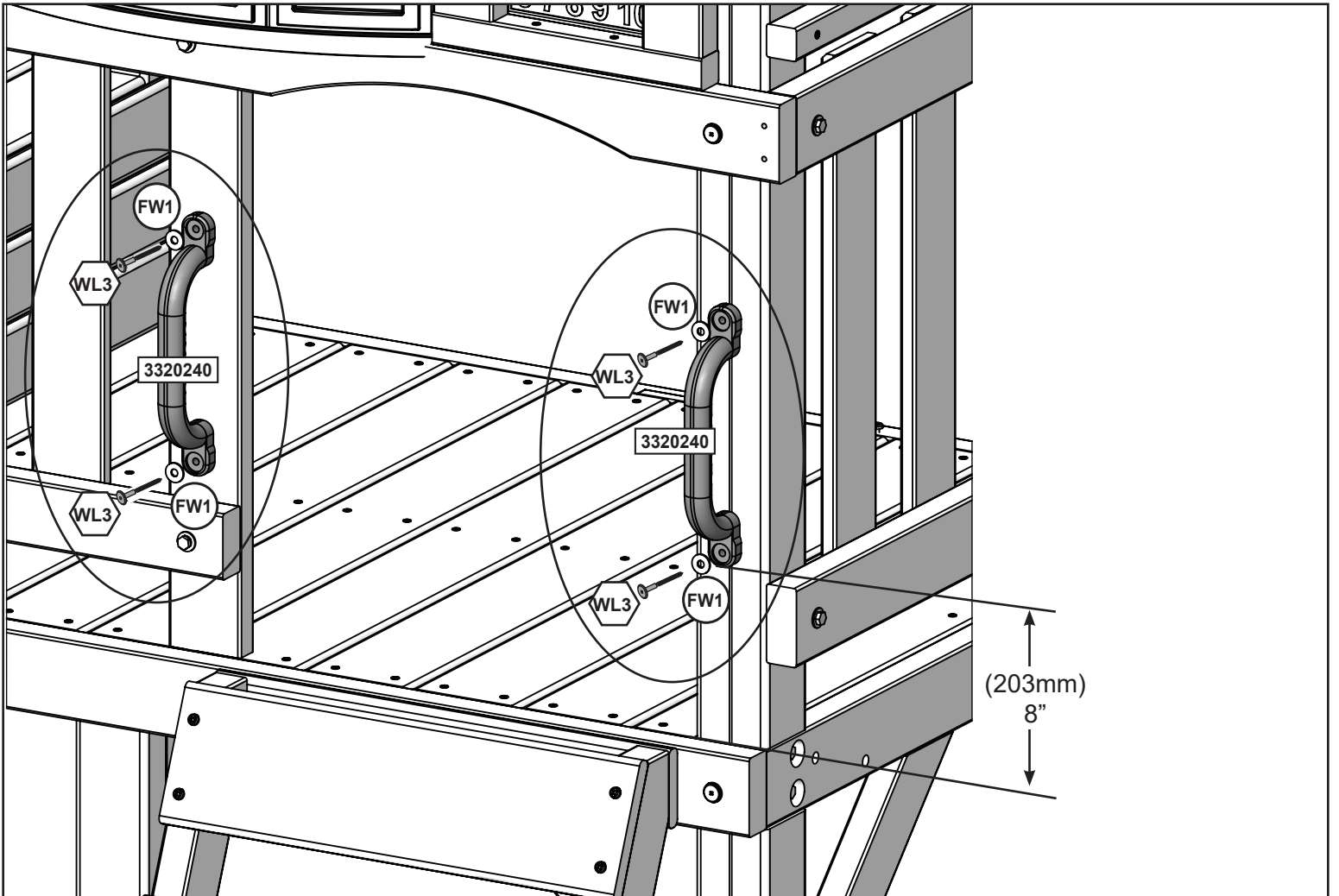

Pre-drill each hole using a 1/8" drill bit.

### Hardware

4 x  6.4mm x 35mm (1/4 x 1-3/8")(FW1)

### Other Parts

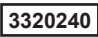
1 x 

# Step 52 x 4

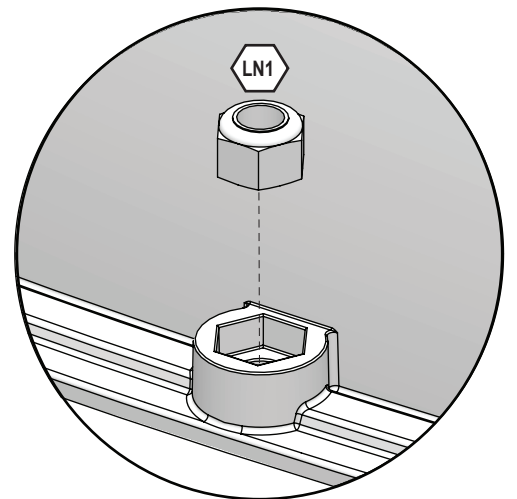
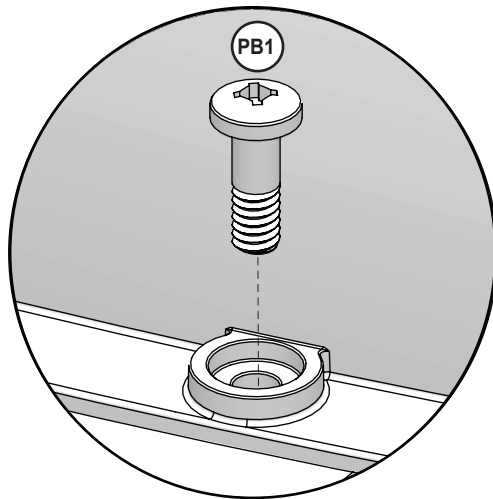
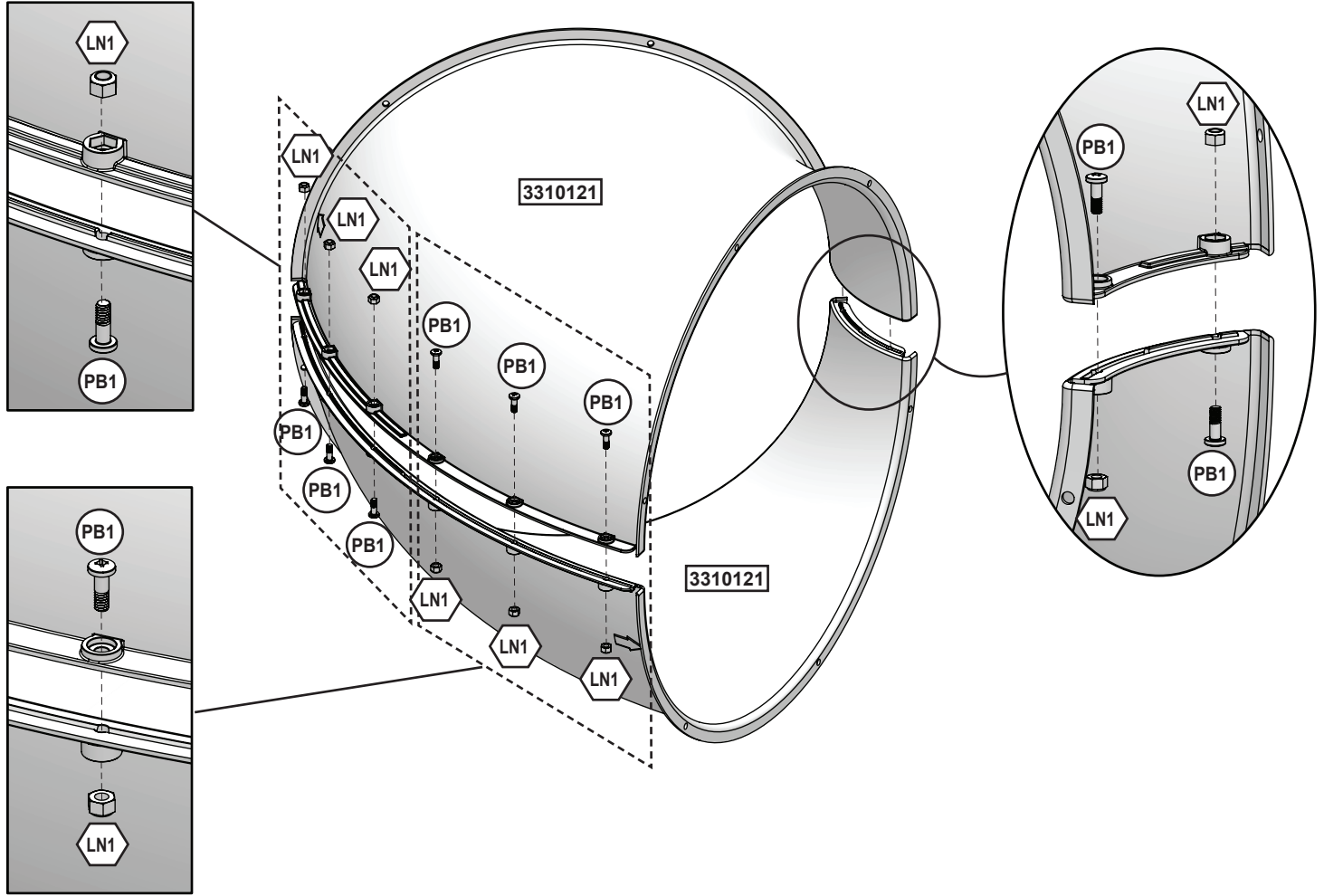

### Hardware

32 x (PB1) 6.3mm x 19 mm (1/4 x 3/4") (LN1)

### Other Parts

8 x 3310121

# Step 53

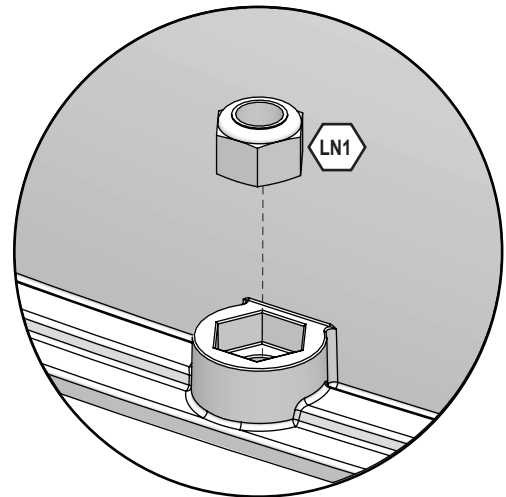
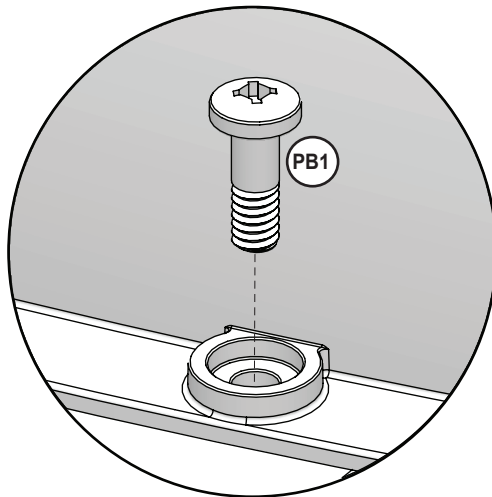
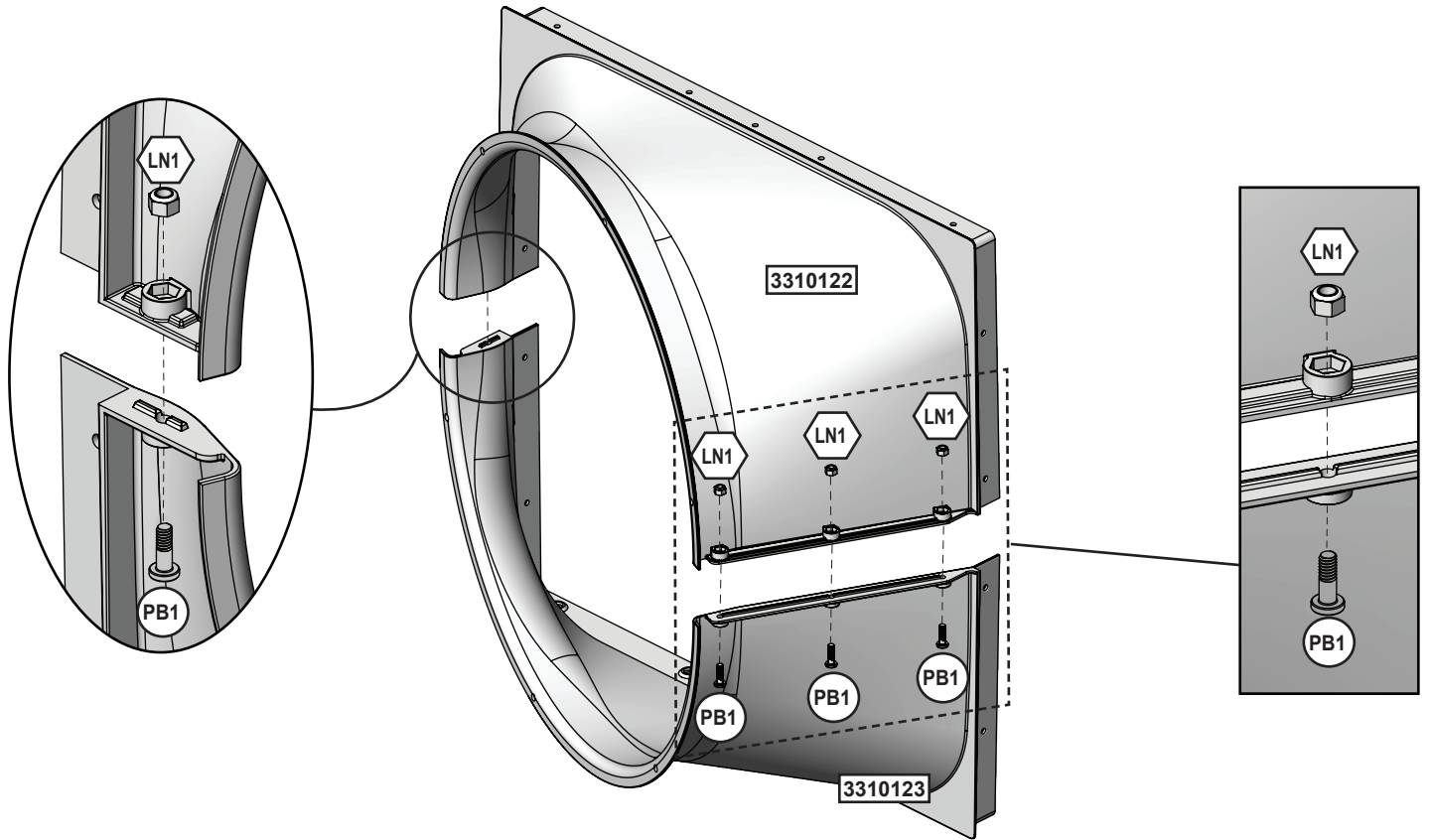

### Hardware

4 x  6.3mm x 19 mm (1/4 x 3/4") (LN1)

### Other Parts

1 x 

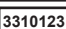
1 x 

# Step 54

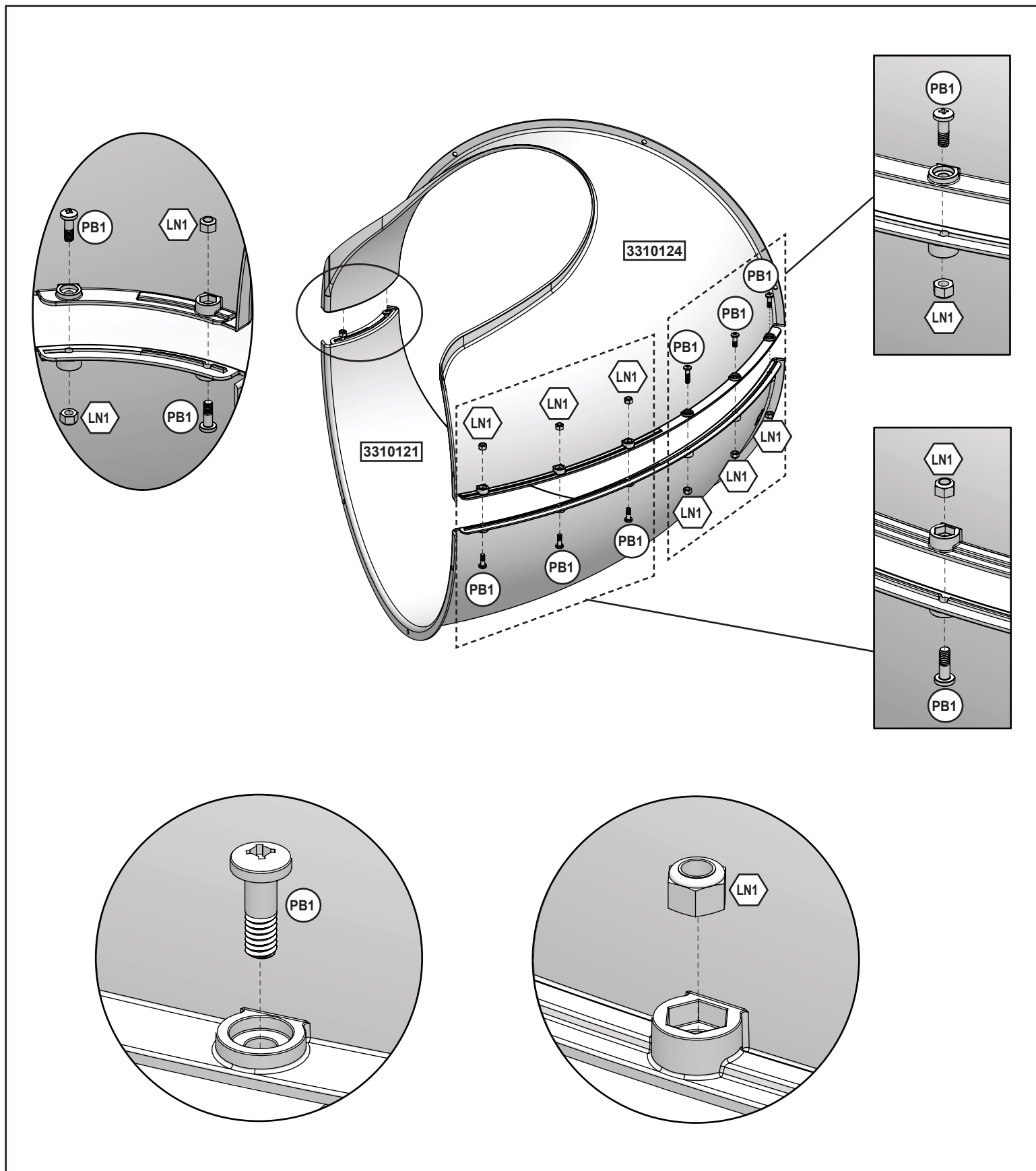

### Hardware

8 x 6.3mm x 19 mm (1/4 x 3/4") (LN1)

### Other Parts

1 x

1 x

# Step 55

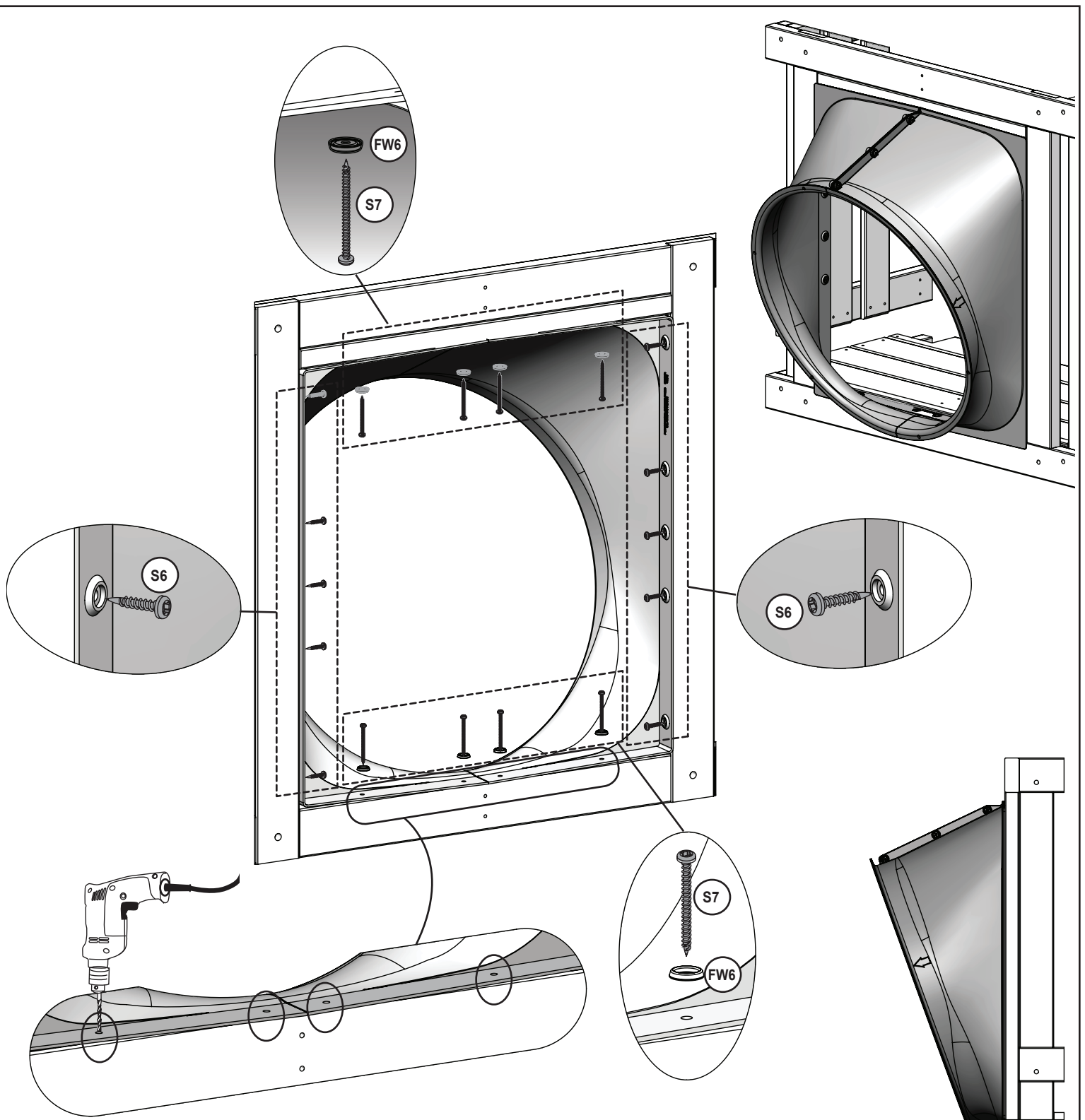

Pre-drill each hole using a 1/8" drill bit. Making sure the pre-drilled holes are a minimum of 1" deep.

### Hardware

- 10 x #12 x 25.4mm (#12 x 1")
- 8 x #12 x 50.8mm (#12 x 2")
- 8 x #12

# Step 56



**Note:** Keep all bolts loose until further step.  
Use Quadrex Driver as a guide pin for each hole before inserting bolt.  
Align each elbow using the molded arrows.

Quadrex Driver



Use special driver provided in locations where the curve of the elbow are difficult to reach with a standard driver.

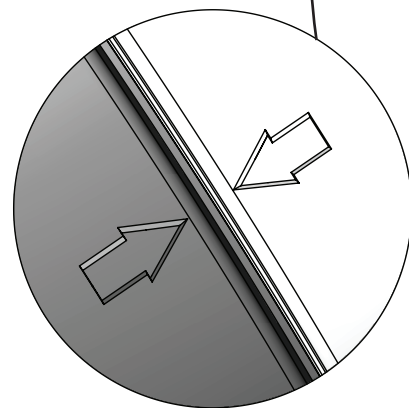
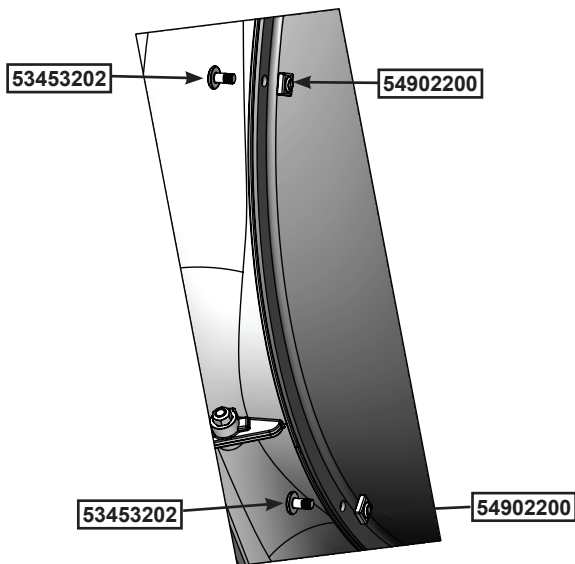
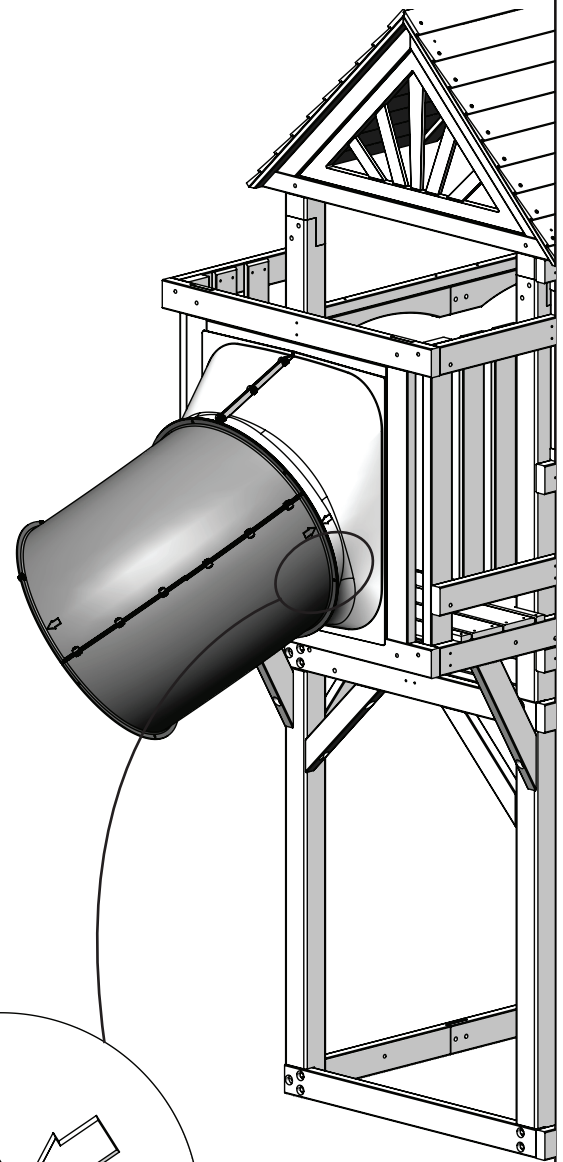
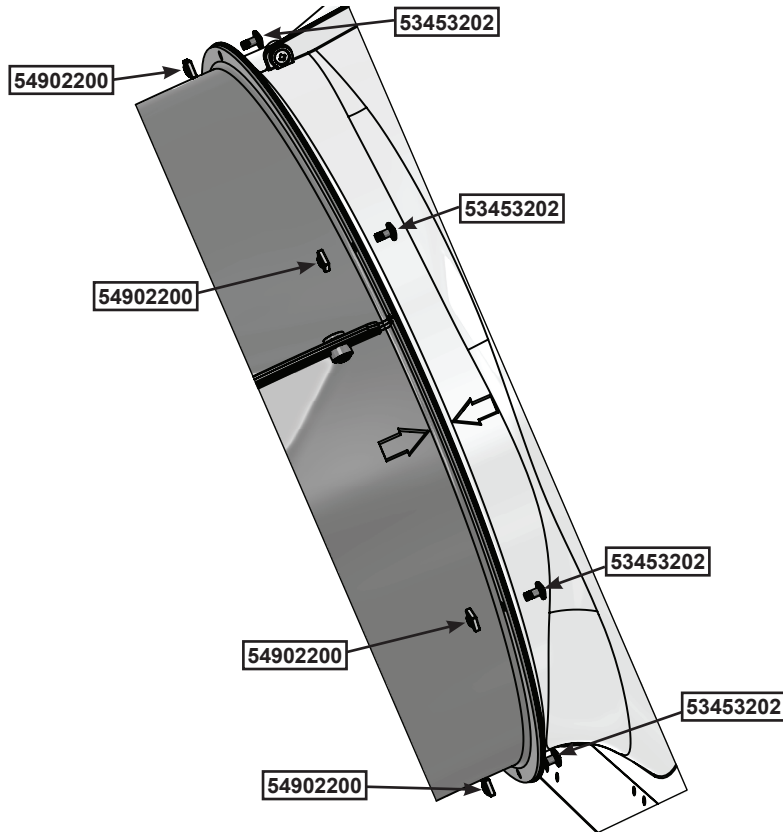

**Align each elbow using the molded arrows.**

### Other Parts

6 x 54902200

6 x 53453202 1/4" x 12.7mm

# Step 57 x 3

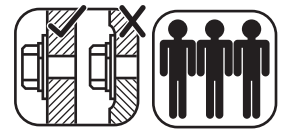

**Note: Keep all bolts loose until further step.  
Use Quadrex Driver as a guide pin for each hole before inserting bolt.**

Quadrex Driver



Use special driver provided in locations where the curve of the elbow are difficult to reach with a standard driver.

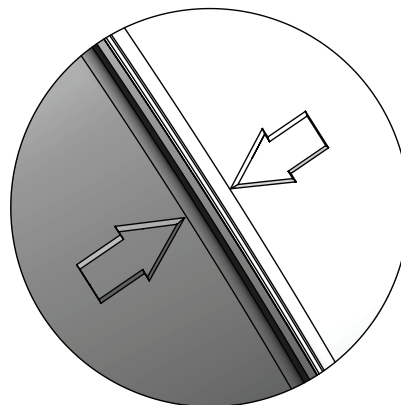
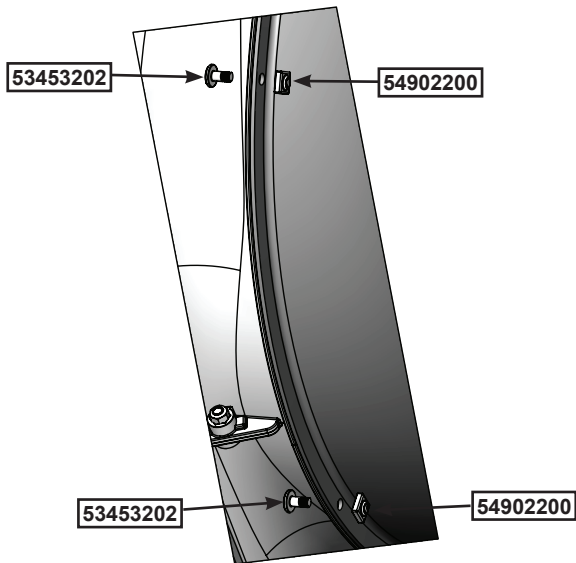
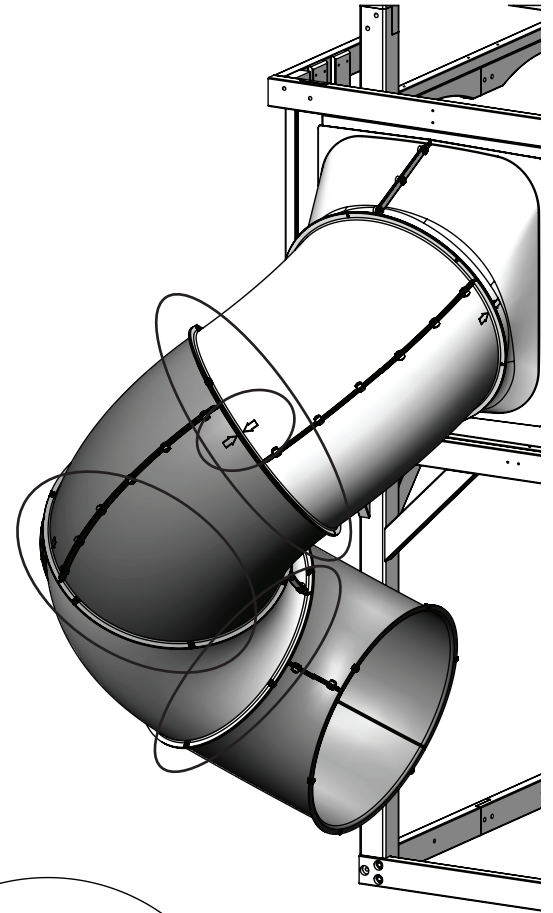
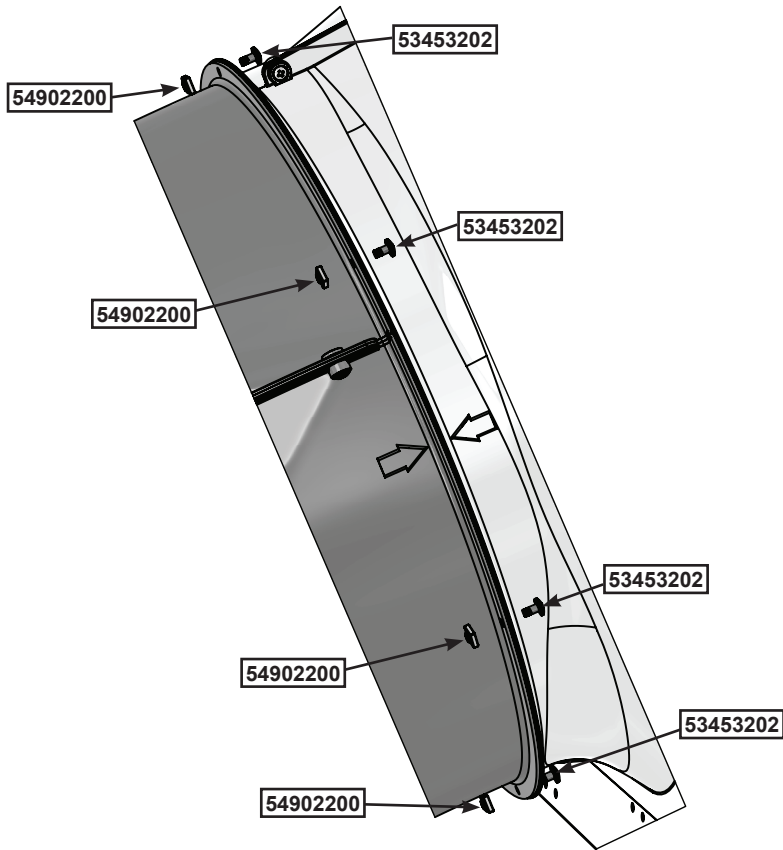

**Align each elbow using the molded arrows.**

### Other Parts

18 x 54902200

18 x 53453202 1/4" x 12.7mm

# Step 58



Use a 7/16" open end wrench to hold nut and then tighten bolt with Quadrex Driver.

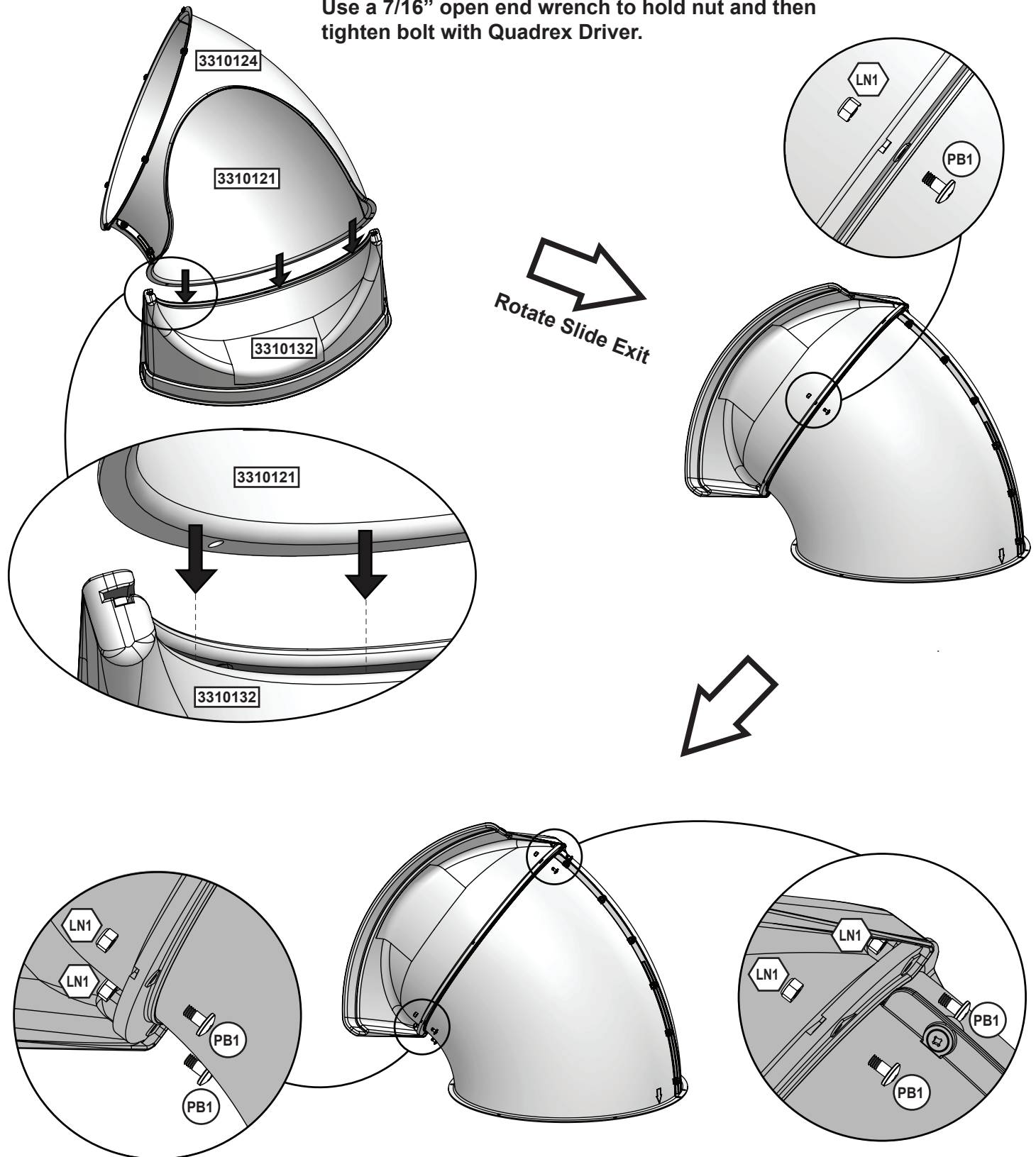

### Hardware

5 x (PB1) 6.4mm x 19 mm (1/4 x 3/4") (LN1)

### Other Parts

1 x 3310132



# Step 59



Tighten all slide bolts before the clamp rings go on in the next step.

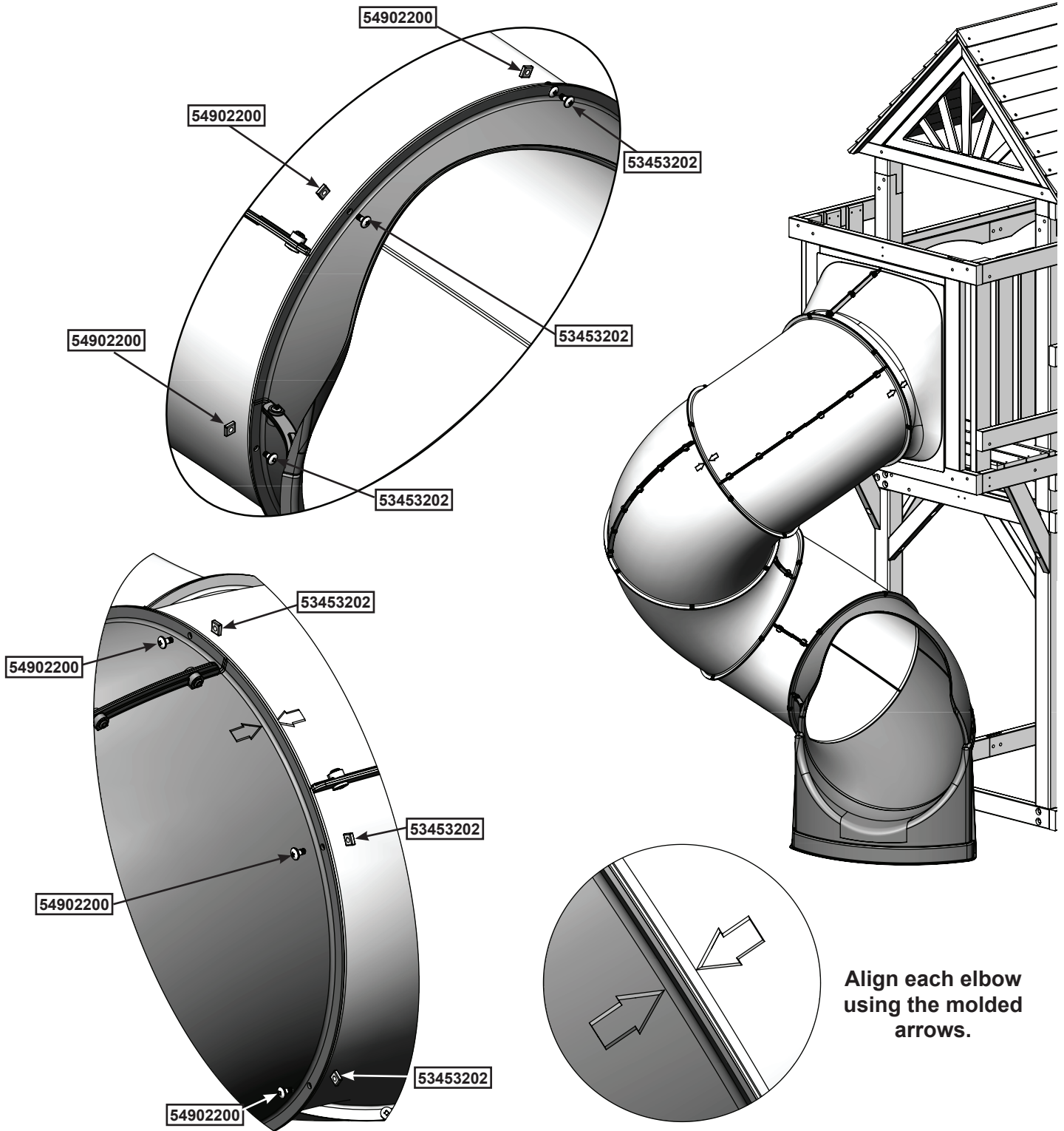

Align each elbow using the molded arrows.

### Other Parts

- 6 x 54902200
- 6 x 53453202 1/4" x 12.7mm



# Step 60

**Warning. Do not over tighten the clamp rings.**

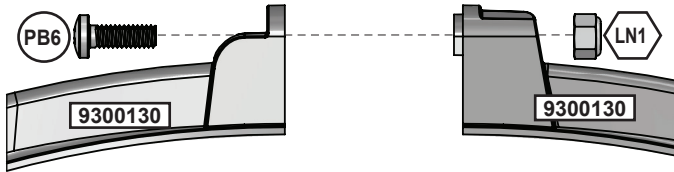

After the clamp rings are attached to the elbows, fasten them end to end with two pan bolts and lock nuts

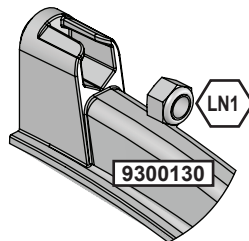
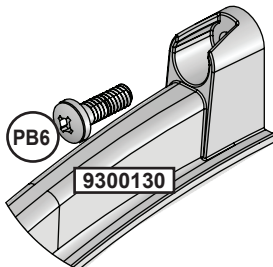
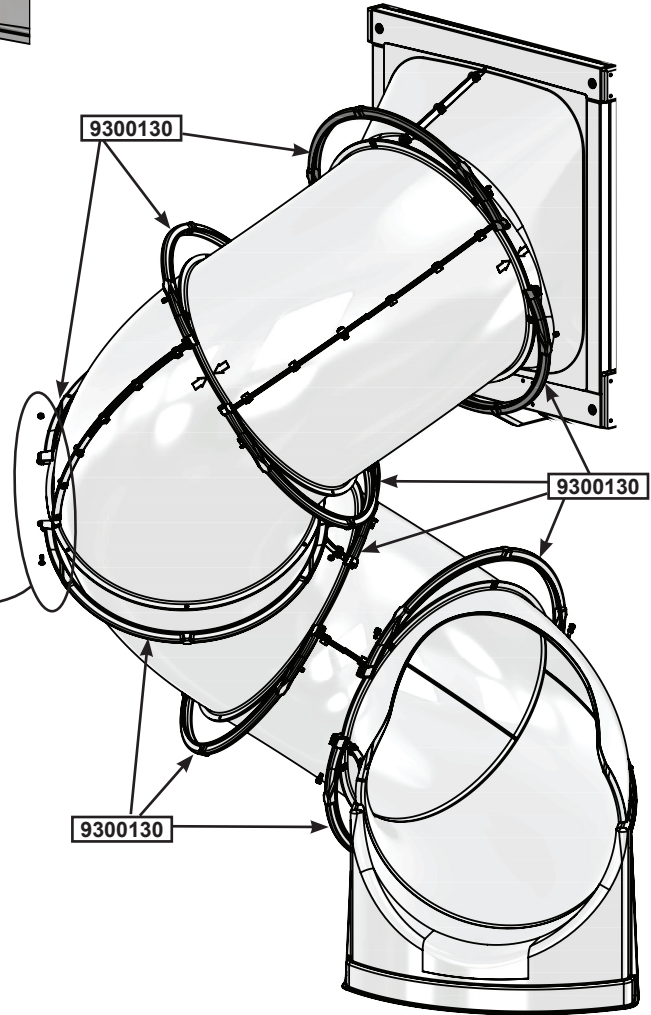
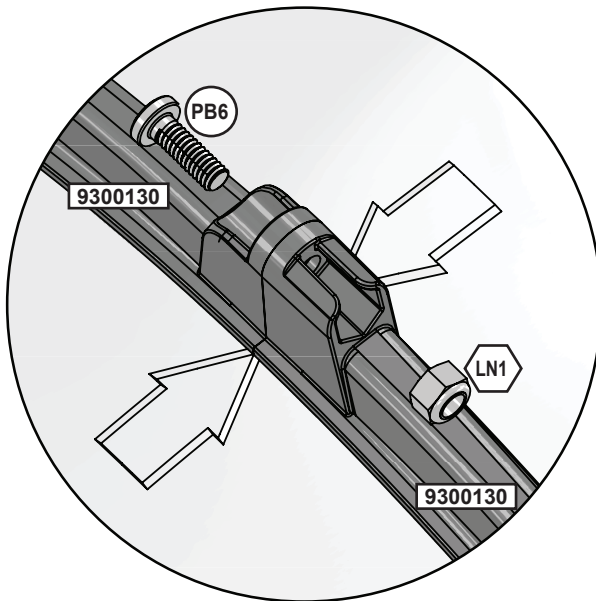

**Note: For ease of assembly bottom set of clamp rings can be rotated 90 degrees to install bolts.**

### Hardware

10 x (PB6) 6.4mm x 25.4 mm (1/4 x 1") (LN1)

### Other Parts

10 x 9300130

# Step 61

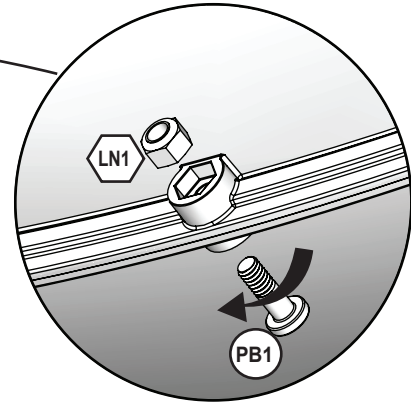
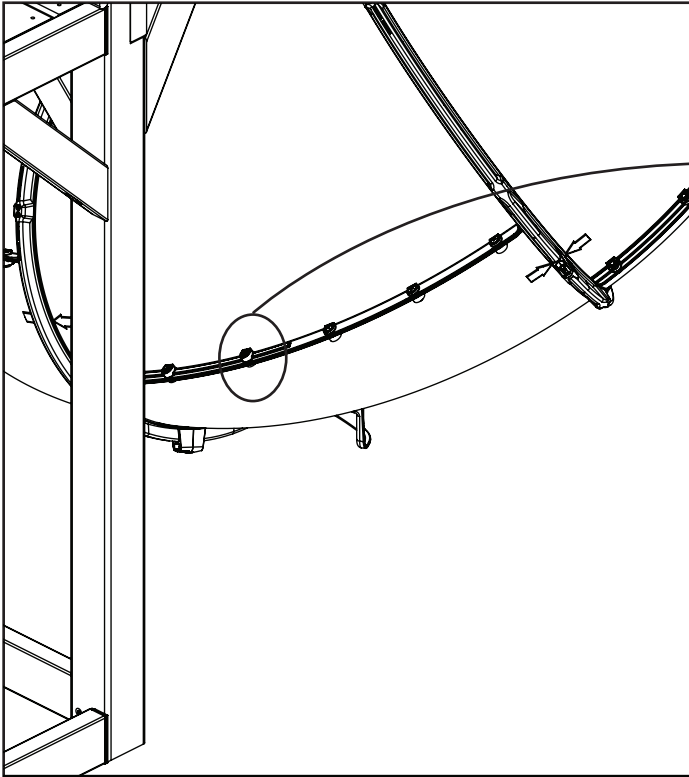

Remove PB1 (1/4 x 3/4" Pan Bolt),  
The bolt (PB1) will no longer be  
needed, but keep the lock nut (LN1)

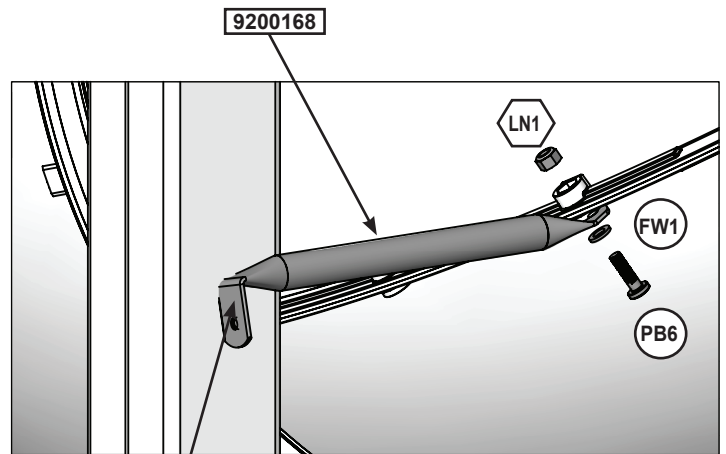
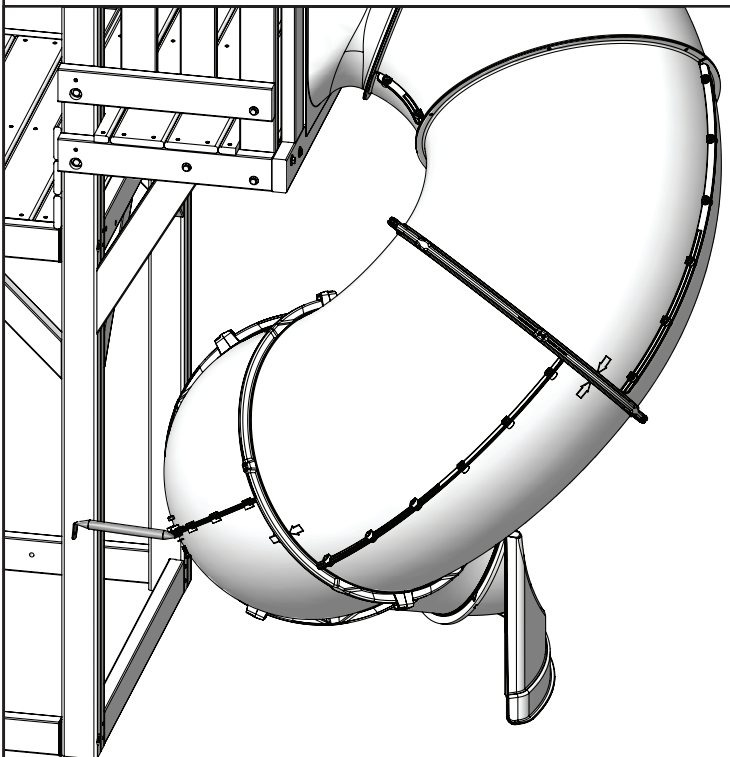

Note: Flat end down

Install PB6 (1/4 x 1" Pan Bolt  
with flat washer (FW1)

### Hardware

1 x (PB6) 6.4mm x 25.4 mm (1/4 x 1") (FW1)

### Other Parts

1 x 9200168

# Step 62

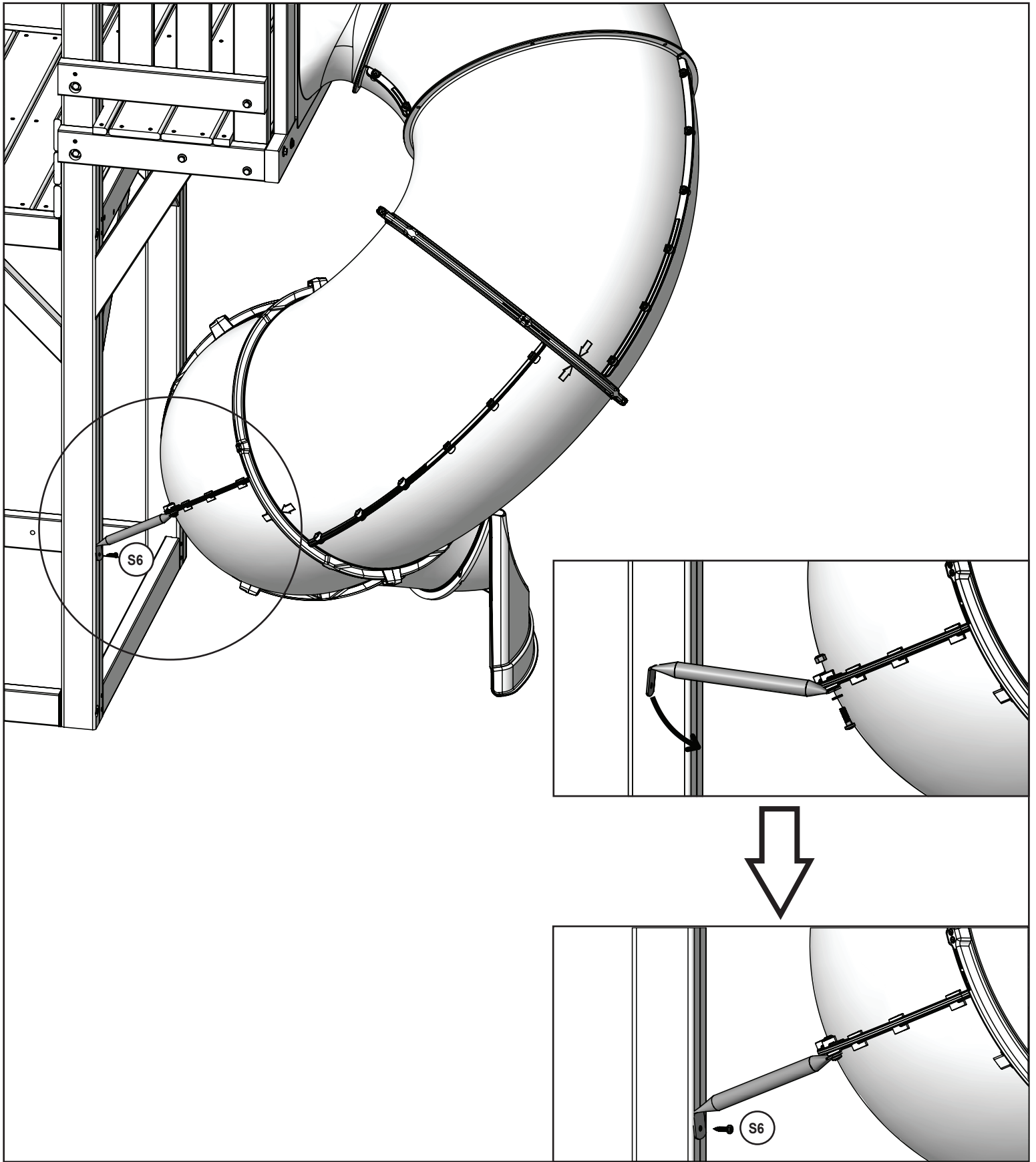

### Hardware

1 x  #12 x 25.4mm (#12 x 1")

# Step 63

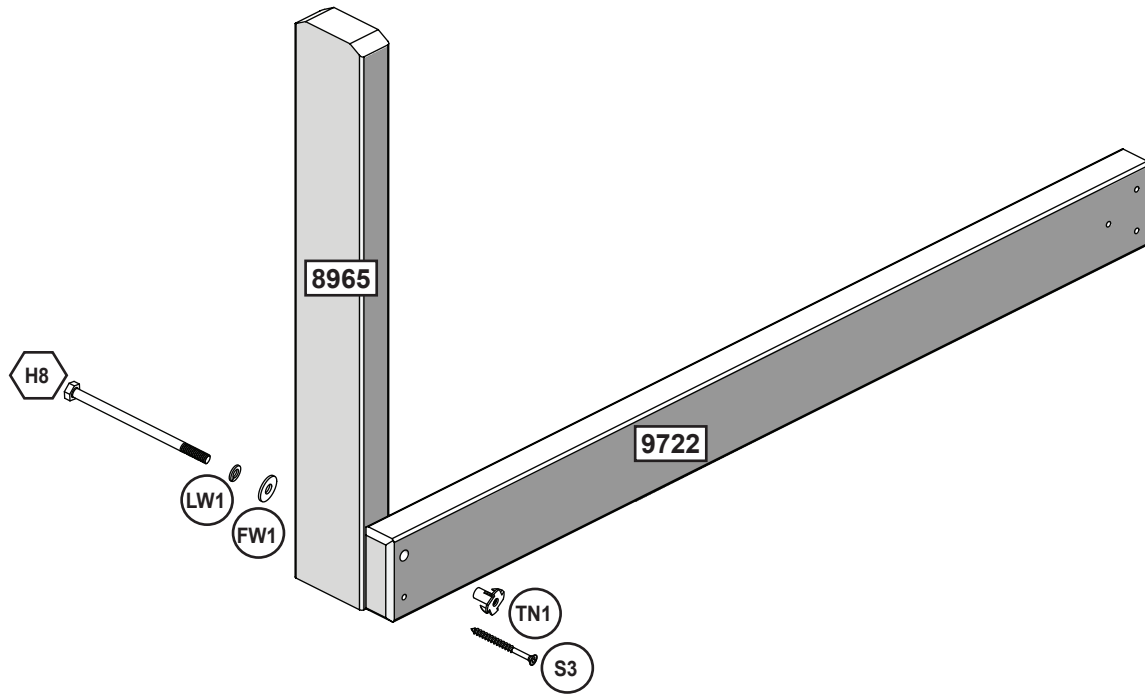
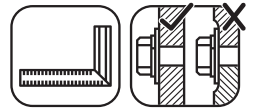

### Wood Parts

- 1 x **8965** 31.8 x 76.2 x 514.4 mm (1-1/4" x 3" x 20-1/4")
- 1 x **9722** 31.8 x 76.2 x 857.3 mm (1-1/4" x 3" x 33-3/4")

### Hardware

- 1 x **H8** 6.4mm x 108mm (1/4 x 4-1/4")(FW1, LW1, TN1)
- 1 x **S3** #8 x 64mm (#8 x 2-1/2")

# Step 64

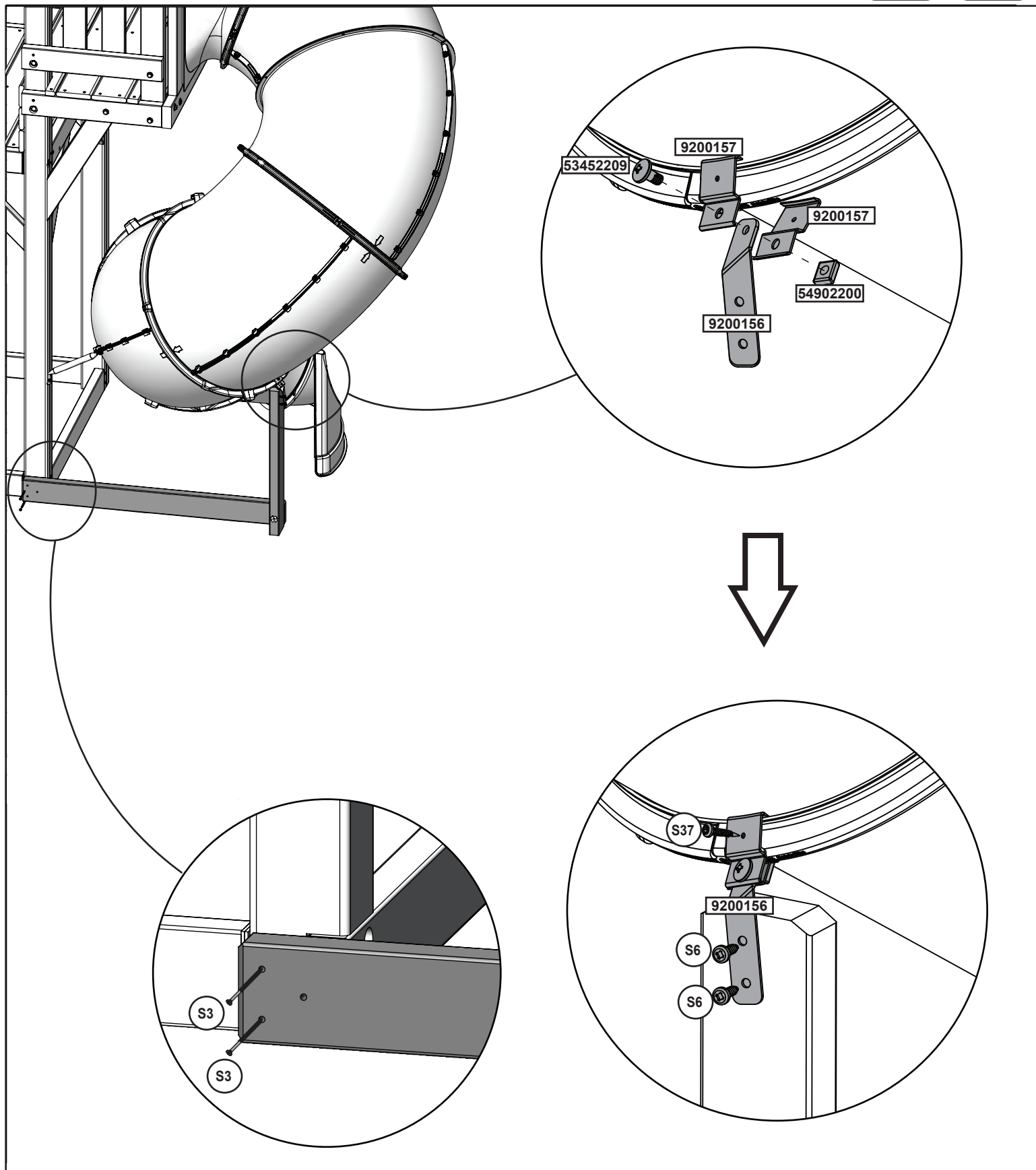

### Hardware

- 1 x **S37** #7 x 15.87mm (#7 x 5/8")
- 2 x **S6** #12 x 25.4mm (#12 x 1")
- 2 x **S3** #8 x 64mm (#8 x 2-1/2")

### Other Parts

- 1 x **54902200**    2 x **9200157**
- 1 x **9200156**    1 x **53452209** 1/4 x 14.5mm

# Step 65



**MOVE FORT TO FINAL LOCATION PRIOR TO STAKING  
FINAL LOCATION MUST BE LEVEL GROUND**

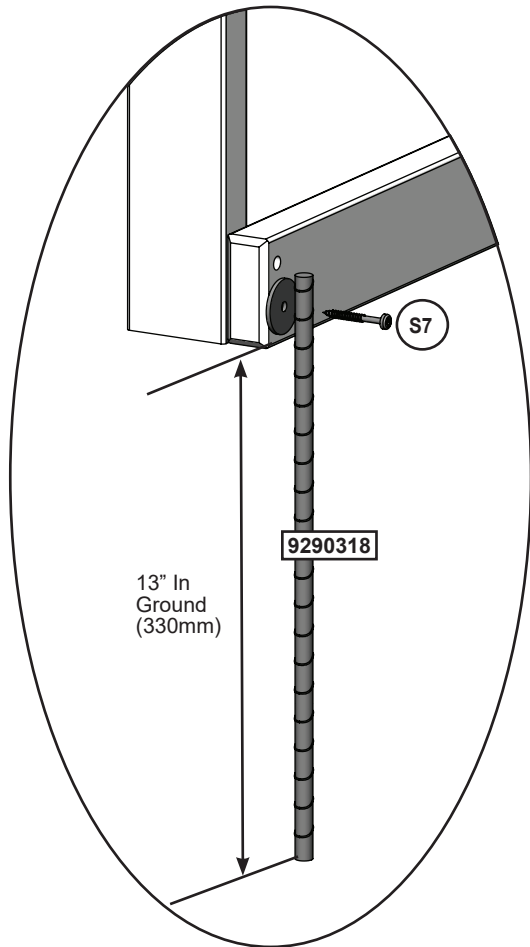
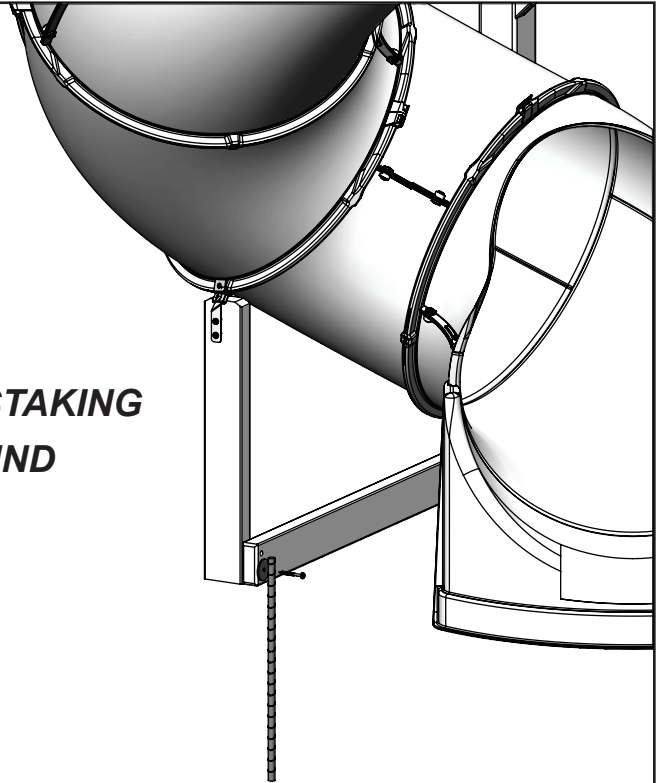

**Warning!** To prevent tipping and avoid potential injury, stakes must be driven 13”(330mm) into ground. Digging or driving stakes can be dangerous if you do not check first for underground wiring, cables or gas lines.

### Hardware

1 x (S7) #12 x 50.8mm (#12 x 2”)

### Other Parts

1 x 9290318

# Step 66

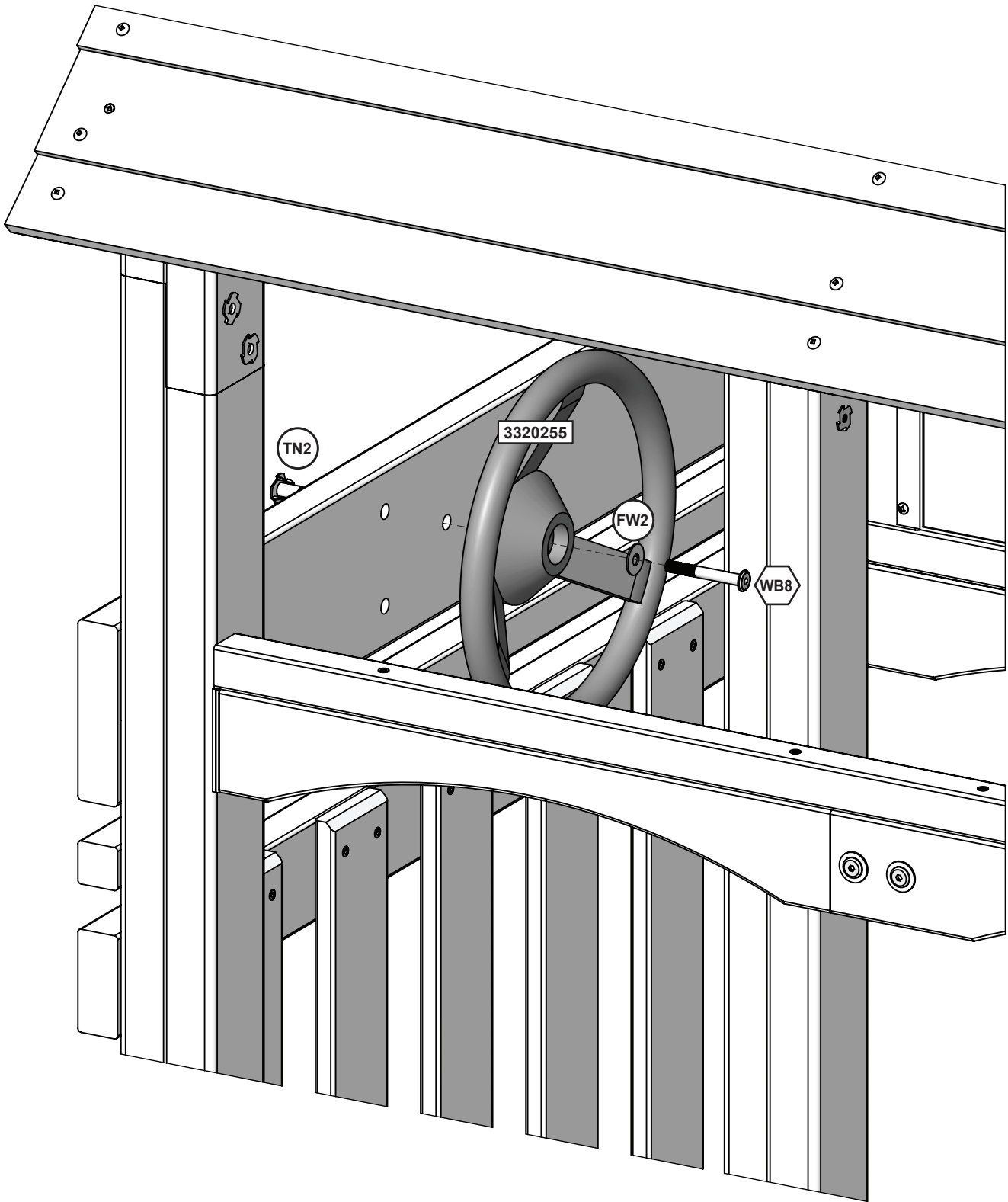

### Hardware

1 x  7.9mm x 60.3 mm (5/16 x 2-3/8") (FW2, TN2)

### Other Parts

1 x 



# Step 67

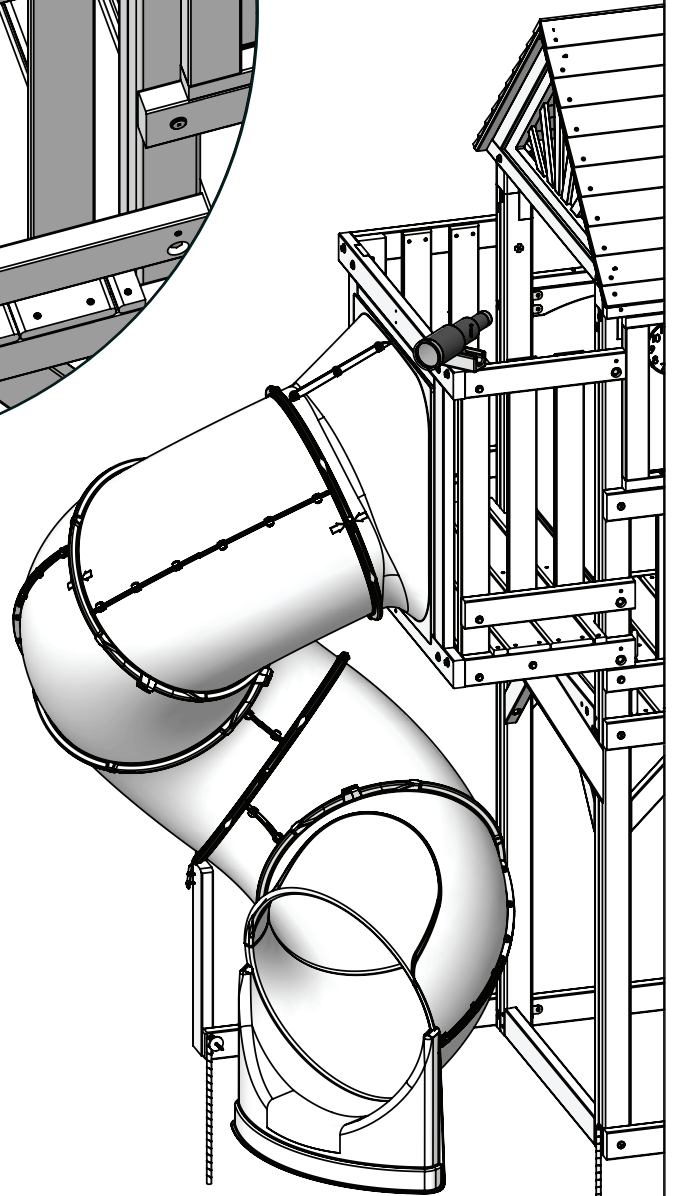
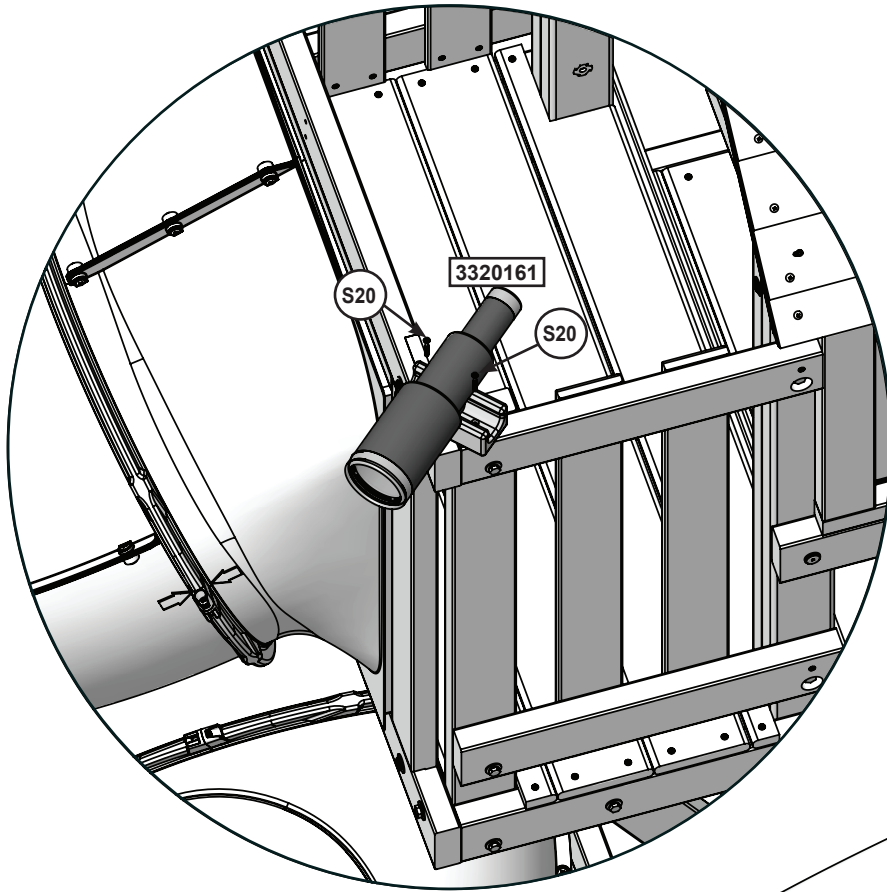

### Hardware

2 x  #8 x 35mm (#8 x 1-3/8")

### Other Parts

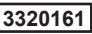
1 x 

# Step 68

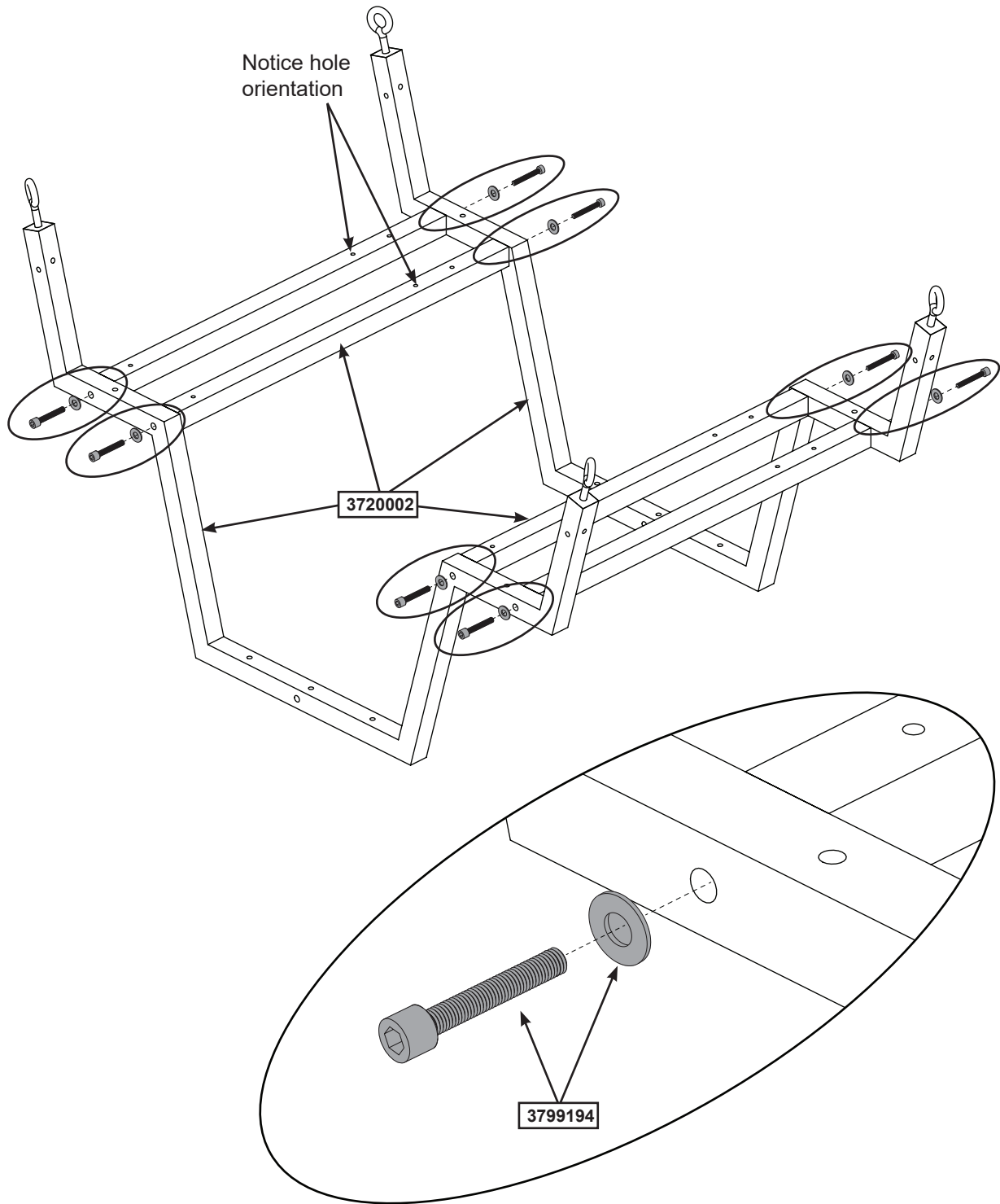

### Other Parts

8 x 3799194

1 x 3720002

# Step 69

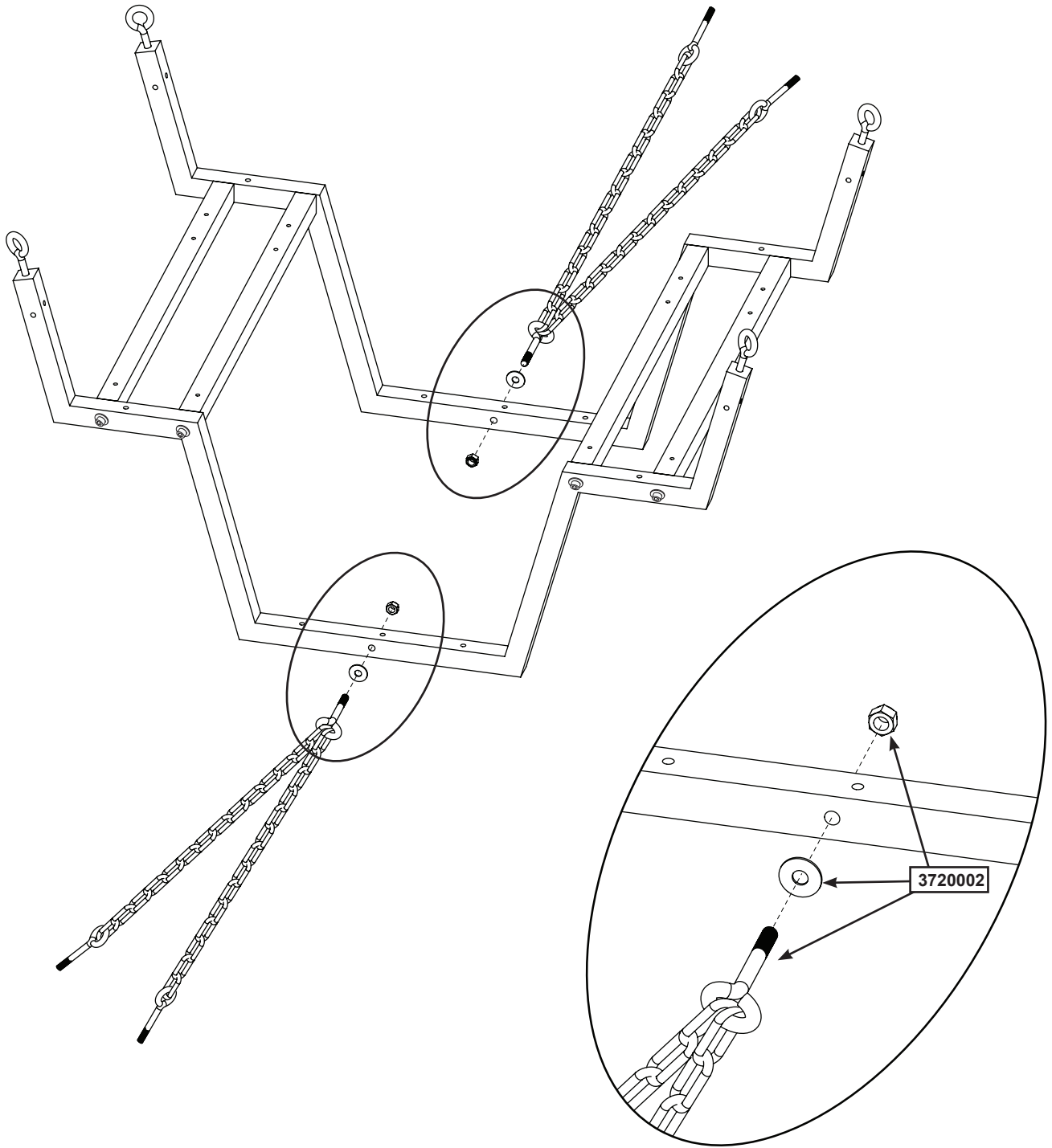

# Step 70

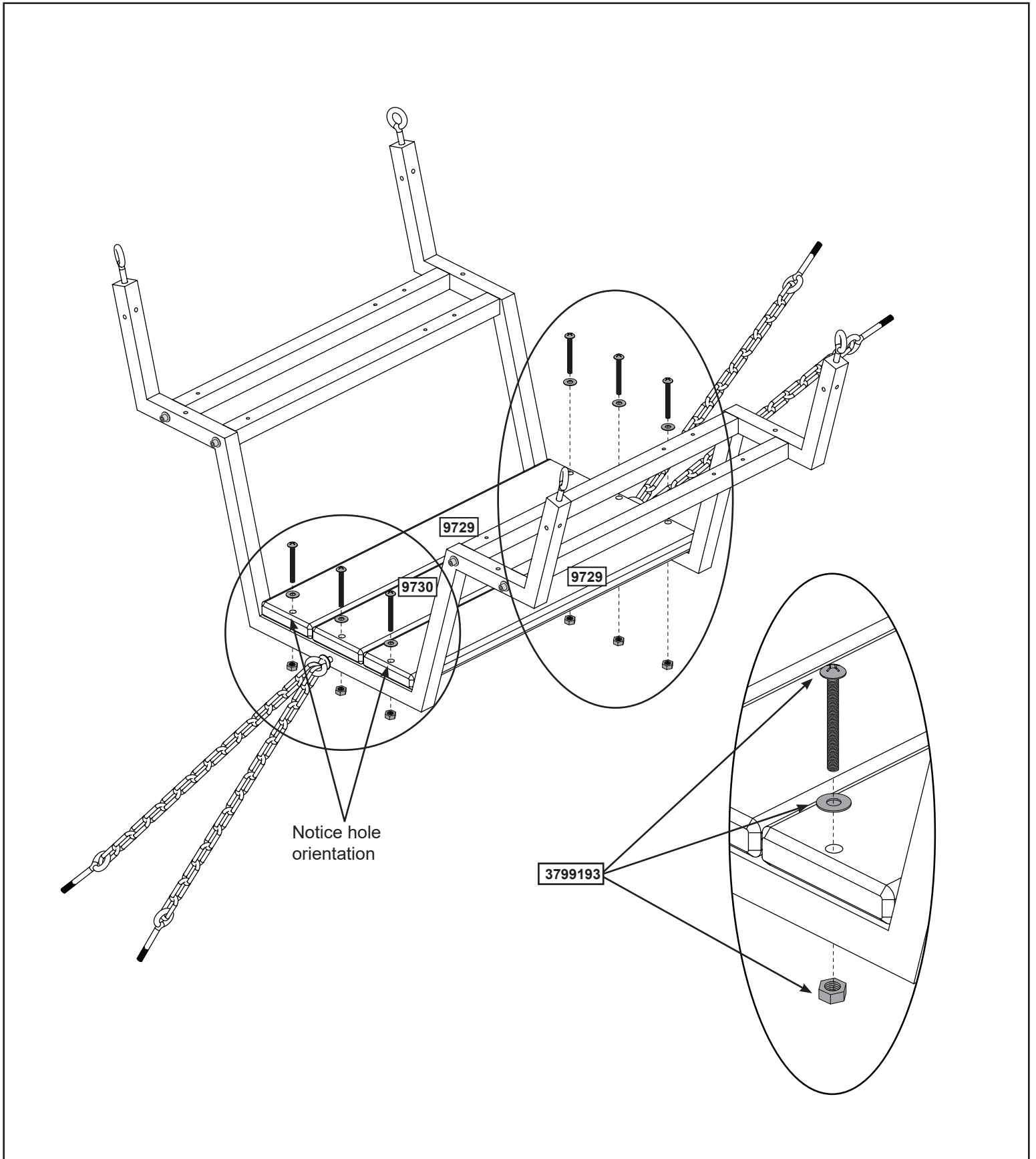

## Wood Parts

- 2 x **9729** 23.8 x 101.6 x 584.8 mm (15/16" x 4" x 23")
- 1 x **9730** 23.8 x 101.6 x 584.8 mm (15/16" x 4" x 23")

## Other Parts

- 6 x **3799193**

# Step 71

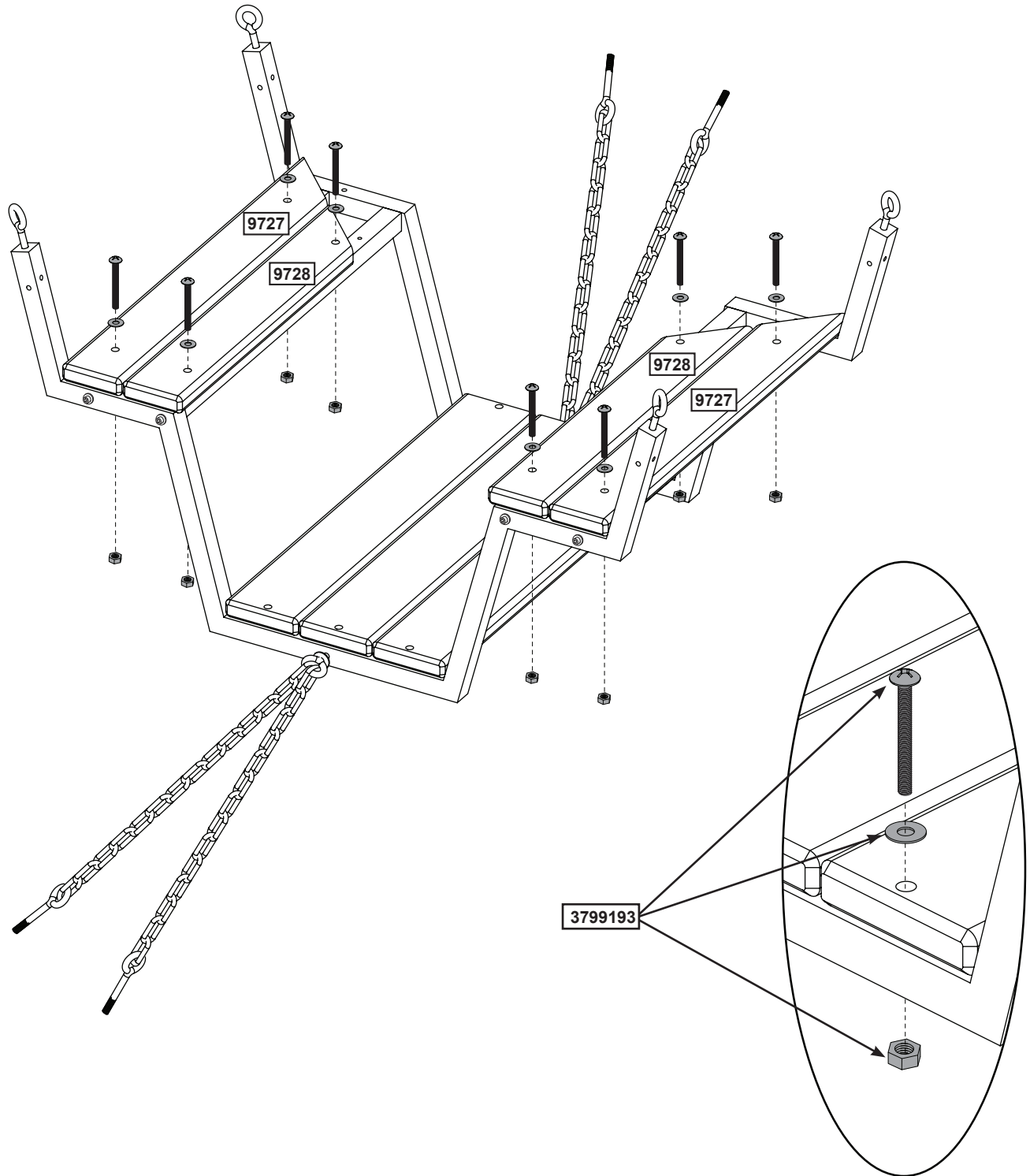

## Wood Parts

- 2 x 9727 23.8 x 82.6 x 584.8 mm (15/16" x 3-1/4" x 23")
- 2 x 9728 23.8 x 82.6 x 500.2 mm (15/16" x 3-1/4" x 19-11/16")

## Other Parts

- 8 x 3799193

# Step 72

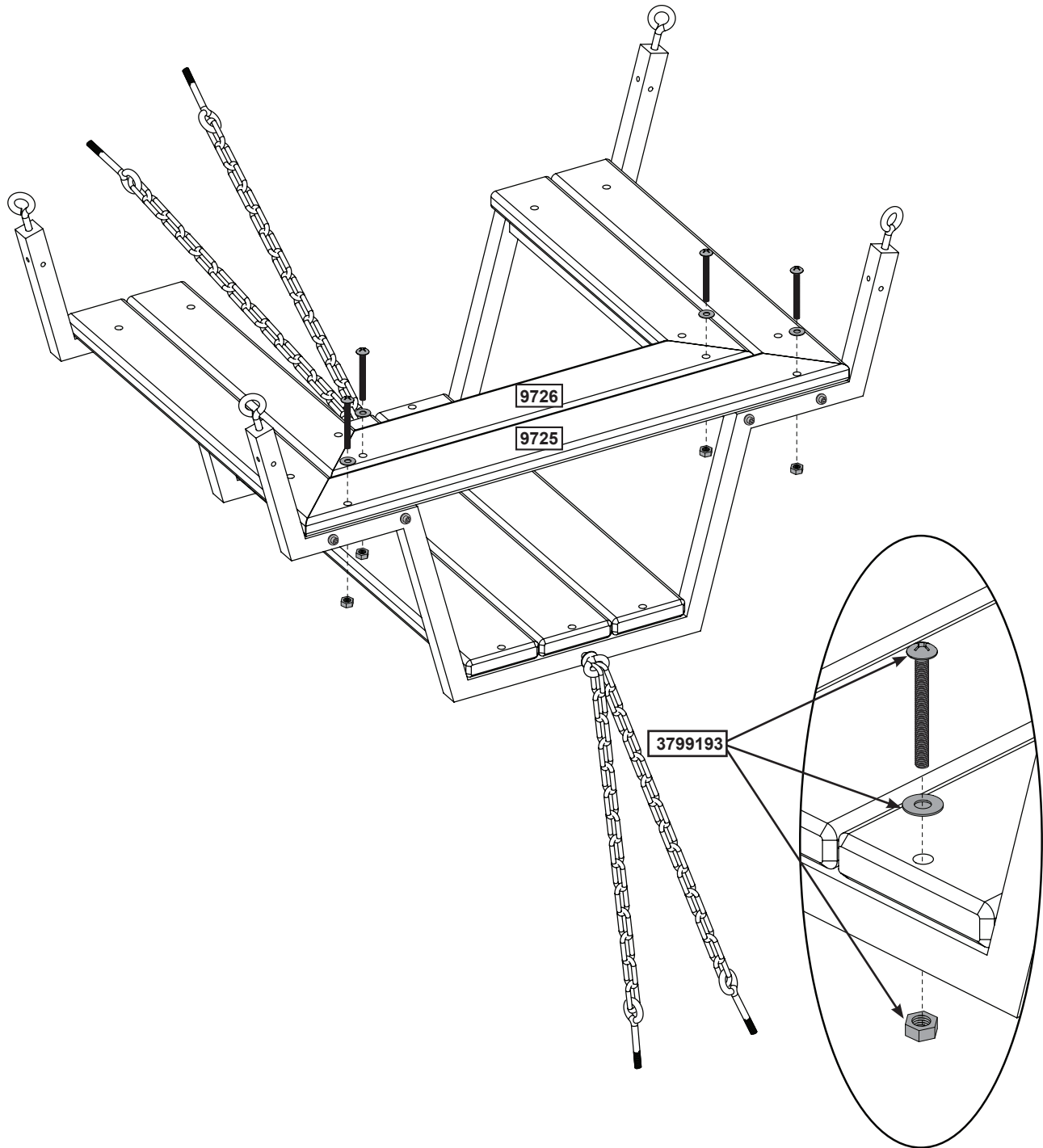

## Wood Parts

- 1 x **9725** 23.8 x 82.6 x 761.2 mm (15/16" x 3-1/4" x 30")
- 1 x **9726** 23.8 x 82.6 x 592.3 mm (15/16" x 3-1/4" x 23-5/16")

## Other Parts

- 4 x **3799193**