

Thank you for purchasing one of our Wall Shelving Option Kits. Please take the time to identify all the parts prior to assembly.

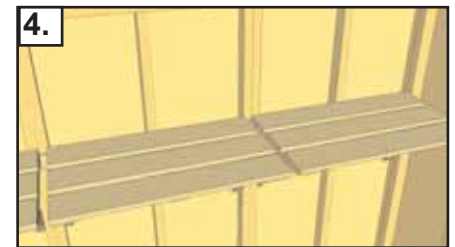
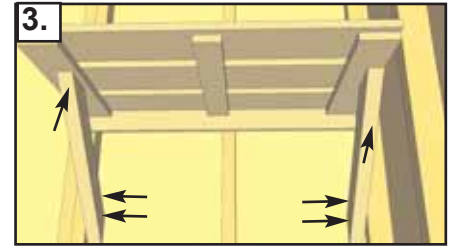
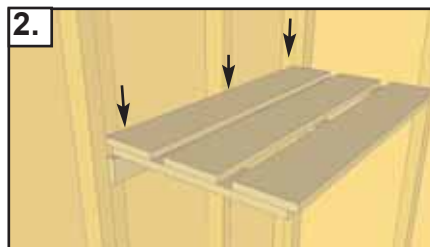
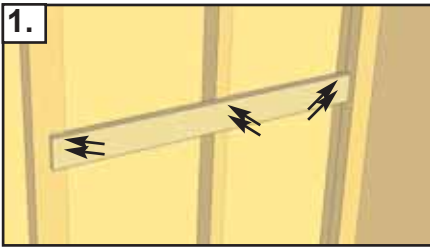
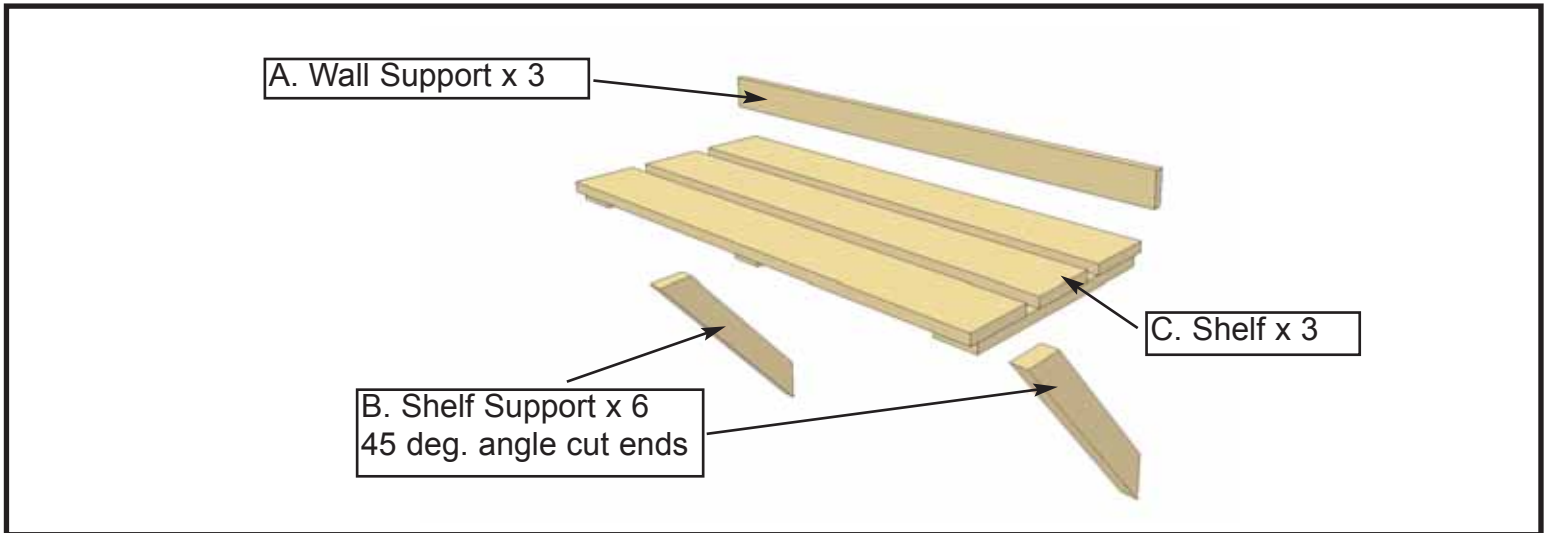

1. Install Wall Support (A) at desired height and attach to wall studs with 6- 1 1/4" screws. Pre-drill with 1/16" bit to prevent wood from splitting. In corner, pre-drill and angle screw into stud.
2. Place Shelf (C) on Wall Support and attach with 3- 1 1/4" screws. Pre-drill to prevent wood from splitting. Support Shelf until Shelf Supports are secured in Step 3.
3. Position Shelf Supports (B) against wall stud and screw with 2 - 2 1/2" screws. Angle screw Shelf Support into shelf cleat with 1 - 2 1/2" screw per piece. Pre-drill to prevent wood from splitting.
4. Secure remaining shelves as per Steps 1-3.

Parts Lists:	Finished Size			Qty.
	T	W	L	
A - Wall Support (3ft wall = 35" / 4ft wall = 45 1/2")	3/4"	3 1/2"	35" or 45 1/2"	3
B - Shelf Support	1 1/2"	2 1/2"	21"	6
C- Shelf (3ft wall = 32 1/2" / 4ft wall = 43")	1 1/2"	32 1/2" or 43"	16 1/2"	3
Hardware				
1 1/4" screws - 30 pcs				
2 1/2" screws - 18 pcs				

Important: When unpacking your Shelving Option Kit, be sure to inventory all parts. If you discover missing or damaged pieces, please call our Toll Free Customer Support Line @ 1-888-658-1658 for fast and courteous Customer Service.

In the event of a missing or broken piece, simply call the Outdoor Living Today Customer Support Line @ 1-888-658-1658 within 30 days of the delivery of your purchase. It is our commitment to you to courier replacement parts, free of charge, within 10 business days of this notification. Replacement parts will not be provided free of charge after the 30 day grace period.