



# 8x12 SunShed Greenhouse Building with Metal Roof Assembly Manual



**Stock Code:** SSGS812-Metal

**Thank you for purchasing an 8x12 SunShed Greenhouse Building from Outdoor Living Today. Please take the time to identify all the parts prior to assembly.**

### Safety Points and Other Considerations

Our products are built for use based on proper installation and normal residential use, on level ground. Please follow the instruction manual when building your shed and retain the manual for future maintenance purposes.

Some of the safety and usage measures you may wish to consider include:

- snow load ratings vary by geographical location. If heavy or wet snowfall occurs, it is advisable to sweep the snow off the roof(s).
- if the product is elevated, any structural and building code requirements are solely the customer's responsibility, and should be abided by.
- in high or gusty wind conditions it is advisable to keep the structure securely grounded.
- have a regular maintenance plan to ensure screws, doors, windows and parts are tight.

**Customer agrees to hold Outdoor Living Today Partnership and any Authorized Dealers free of any liability for improper installation, maintenance and repair.**

**In the event of a missing or broken piece, simply call the Outdoor Living Today Customer Support Line @ 1-888-658-1658 within 30 days of the delivery of your purchase. It is our commitment to you to courier replacement parts, free of charge, within 10 business days of this notification. Replacement parts will not be provided free of charge after the 30 day grace period.**

# What to do before my Shed arrives?



- Become familiar with this assembly manual and determine if you can complete the project yourself or will require a professional contractor.



- One helper is recommended to assist in constructing your shed. It generally takes two people over two days to assemble a shed. If you're hiring a contractor, their rate should be in line with that duration of work.



- Clear the construction area and ensure a clear pathway for delivery when the freight company arrives. Remove all debris: roots, grass, rocks, etc.



- Excavate the site. Contact your local utilities company to ensure there are no gas or electric lines buried in the area before digging.

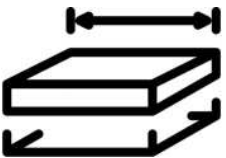

- Decide on the type of foundation you will be using:
  - Concrete slab, or
  - 4-6 inches of crushed gravel with paver stones or 4x4 stringers.

You can find the footprint for your shed on Page 3 of your Assembly Manual.



- If doing the assembly yourself, have all the necessary tools ready to go and in working condition. A list of required tools can be found after the parts list.

# Foundation Types for 8x12 Garden Shed

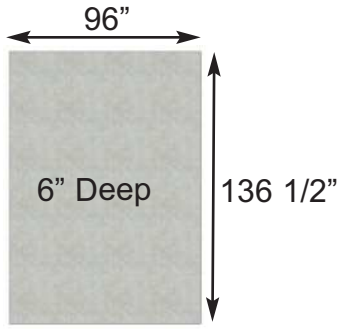

**Concrete Foundation**

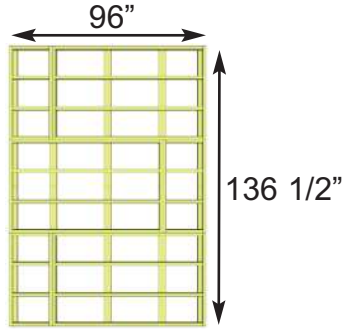

**Floor Frame**



**Completed Foundation**

**Concrete Slab Foundation:**

- Slab must be at least the same size as assembled floor frame (136 1/2" x 96") or larger.
- 6" Deep foundation.
- 1.7 Cubic Yards of concrete required.
- A concrete slab will have the longest durability out of your foundation options.

**Once level, a concrete slab is the easiest surface to build on.**

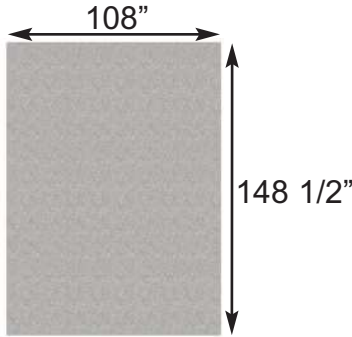

**Gravel Foundation**

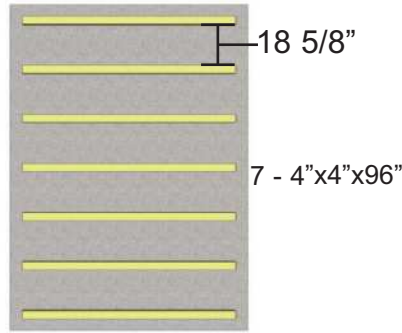

**Gravel Foundation with treated stringers**

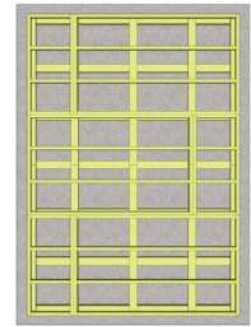

**Completed Foundation**

**Gravel with 4x4 Pressure Treated Stringers:**

- Excavate at least 6" deep, and 6" wider than floor frame on each side.
- 2.1 Cubic Yards of gravel required, approximately 19 wheelbarrows.
- 7 - 4x4 Pressure Treated Stringers 8' long required.
- Evenly spaced, with one at each end of floor frame.

**Saves money on materials, easy to level and work with.**

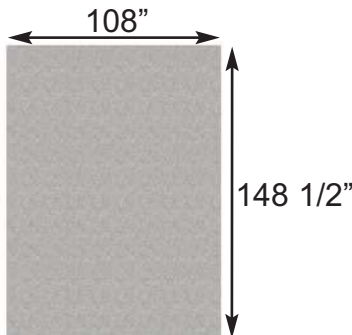

**Gravel Foundation**

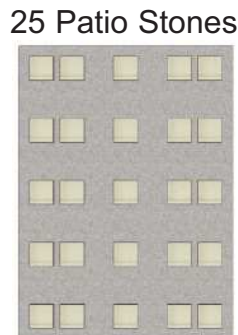

**Gravel Foundation with Patio Pavers**

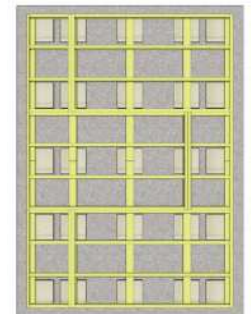

**Completed Foundation**

**Gravel with Patio Paver Stones:**

- Excavate at least 6" deep, and 6" wider than floor frame on each side.
- 2.1 Cubic Yards of gravel required, approximately 19 wheelbarrows.
- 25 patio pavers (8" x 8" or larger).
- Center patio paver stones underneath floor runners and underneath seams in floor joists.

**Patio paver stones are widely available from most landscape stores.**

**Thank you for purchasing our 8x12 SunShed Greenhouse Building.**  
**Please take the time to identify all the parts prior to assembly.**

**A. Floor Section**

- 3 - 45 1/2" x 75" - Floor Joist Frames (Interior Joist Unattached)
- 3 - 45 1/2" x 21" - Floor Joist Frames (Interior Joists Attached)
- 6 - 1 1/2" x 3 1/2" x 71 7/8" - Floor Joists
- 3 - 45 3/8" x 74 7/8" - Floor Plywood
- 3 - 45 3/8" x 20 7/8" - Floor Plywood
- 10- 1 1/2" x 3 1/2" x 68 3/16" - Floor Runners

**B. Wall Section**

**Main Wall Panels**

- 4 - 45 1/2" x 75" - Solid Wall Panels
- 4 - 1 1/2" x 2 1/2" x 45 1/2" - Wall Plates
- 2 - 45 1/2" x 75" - Window Wall Panels
- 3 - 45 1/2" x 75" - Double Window Walls
- 1 - 12" x 73" - Narrow Wall Panel
- 1 - 31 1/2" x 72" - Dutch Door - 2pcs (42" and 30" high)
- 5 - 45 1/2" x 9" - Wall Extenders
- 2 - 47 1/2" x 9" - Angle Wall Extenders for Front & Back - L/R
- 3 - 3/4" x 3 1/2" x 60" - Horizontal Wall Extender Brace
- 2 - 3/4" x 3 1/2" x 30" - Horizontal Wall Extender Brace (front/back)
- 1 - 3/4" x 3 1/2" x 71 1/2" - Horizontal Wall Extender Brace (side)

**Door Jamb, Header & Door Stops**

- 1 - 1 1/2" x 3" x 73" - Vertical Door Jamb
- 1 - 2" x 3" x 45 1/2" - Door Header
- 2 - 1/2" x 2 1/2" x 72" - Interior Vertical Door Stops

**Gable Walls**

- 2 - Front and Rear Gable Walls - Triangular shaped  
(33 3/4 degrees on 1 side / 22 1/2 degrees on other)

**Top Wall Plates**

- 2 - 3/4" x 2 1/2" x 65 3/4" - Short Side - 22 1/2 degree cut on edge
- 2 - 1 1/2" x 2 1/2" x 65 3/4" - Tall Side - 33 3/4 degree cut on edge
- 2 - 3/4" x 2 1/2" x 73 3/4" - Front & Rear  
(33 3/4 degrees on 1 end / 22 1/2 degrees on other)

**C. Rafter Section**

**Rafters**

- 9 - 1 1/2" x 3 1/2" x 77 3/4" - Long Roof Side Rafters (22 1/2 degrees)
- 9 - 1 1/2" x 3 1/2" x 37 3/4" - Short Roof Side Rafters (33 3/4 degrees)

**Ridge Boards & Gussets**

- 1 - 3/4" x 4 5/8" x 52 1/2" - Ridge Boards (long roof side)
- 1 - 3/4" x 4 5/8" x 84" - Ridge Boards (long roof side)
- 1 - 3/4" x 5 1/8" x 52 1/2" - Ridge Boards (short roof side)
- 1 - 3/4" x 5 1/8" x 84" - Ridge Boards (short roof side)
- 3 - 3/4" x 3 1/2" x 72" - Gussets (angle cut on both ends)

**Soffits**

- 2 - 1/2" x 3 1/2" x 68 1/4" - Short Roof Side
- 2 - 1/2" x 4 1/2" x 68 1/4" - Long Roof Side

**D. Roof Section**

**Battens**

- 2 - Bundles of Roof Battens (3/4" thick x 3 1/2")  
12 - 48 1/4" Outside  
6 - 45 1/2" Middle
- 4 - 3/4" x 1 1/2" x 13 1/2" - Batten Spacers Short
- 4 - 3/4" x 1 1/2" x 13 3/4" - Batten Spacers Long

**Metal Roof**

- 4 - (39"w x 41") - Metal Roof Panels Short
- 4 - (39"w x 43") - Metal Roof Panels Long
- 3 - 60" long - Metal Ridge Caps

**Polygal Sun Roof**

- 4 - 3/4" x 1 1/2" x 34" - F&R Facia Nailing Strips
- 12 - 3/4" x 3/4" x 44 1/2" - Polygal Support Cleats
- 3 - 1/2" x 2 1/2" x 41 1/2" - Caps for Polygal
- 2 - 1/2" x 5 1/2" x 41 1/2" - Outside Caps for Polygal (w nailing strip)
- 2 - 1/2" x 4 1/2" x 41 1/2" - Caps for Polygal
- 6 - 20 1/4"w x 44" - Polygal Panels

**E. Miscellaneous Section**

**Bottom Skirting**

- 10 - 1/2" x 4 1/2" x 45 1/4" - Bottom Skirting

**Corner & Wall Trim**

- 2 - 1/2" x 2 1/2" x 75" - Filler Trim Short Wall Side
- 2 - 1/2" x 2 1/2" x 84" - Filler Trim Tall Wall Side
- 2 - 1/2" x 4 1/2" x 82" - Corner Trim Short Wall Side
- 2 - 1/2" x 4 1/2" x 87" - Corner Trim Tall Wall Side
- 3 - 1/2" x 2 1/2" x 87" - Front Door Trim & Rear Wall Seam Trim
- 4 - 1/2" x 2 1/2" x 88" - Tall Wall Vertical Trim
- 4 - 1/2" x 2 1/2" x 79" - Short Wall Vertical Trim
- 1 - 1/2" x 2 1/2" x 32" - Horizontal Door Trim (above Door)
- 1 - 1/2" x 2 1/2" x 8 3/4" - Horizontal Narrow Wall Trim (above Wall)
- 2 - 1/2" x 4 1/2" x 85 1/2" - Hor.Gable Trim (F & R) Angle cut 1 end

**Facia Trim**

- 2 - 3/4" x 3 1/2" x 78 3/4" - Angle Cut Front/Rear Facia Trim
- 2 - 3/4" x 3 1/2" x 38 1/4" - Angle Cut Front/Rear Facia Trim
- 4 - 3/4" x 3 1/2" x 71 1/2" - Side Facia
- 2 - Facia Detail Plates (Sides)
- 2 - Pentagon Detail Plates (Front and Back Facia)
- 2 - Triangular Corner Gable Trim Pieces (L/R) Found in Gable - see step 76

**Flower Boxes**

- 5 - Flower Box Kits

**Potting Shelves**

- 3 - 45" - Long Potting Shelves
- 1 - 41" - Short Potting Shelf
- 4 - 1 1/2" x 2 1/2" x 38" - Potting Shelf Legs

**Window Inserts**

- 2 Reg. Window Inserts
- 6 Small Window Inserts
- 2 Reg. Window Trim Pkgs: 1 x 24 1/16" Top, 3 x 23" Side & Bottom
- 6 Narrow Window Trim Pkgs: 1 x 19 7/8" Top, 2 x 21 7/16" Sides,  
1 x 18 3/4" Bottom

**\*\*Miscellaneous Pieces**

- 1 pc - Spare Wall Siding
- 2 pcs - Spare Shingles- use to shim door, etc
- Several pcs - Foam Enclosures for Metal Roof (37" )

**Note: All Trim, Facia and Bottom Skirting pieces will be positioned rough face out when installed.**

# 8x12 SUNSHED - METAL ROOF - HARDWARE SHEET

## Hardware Kit (Provided)

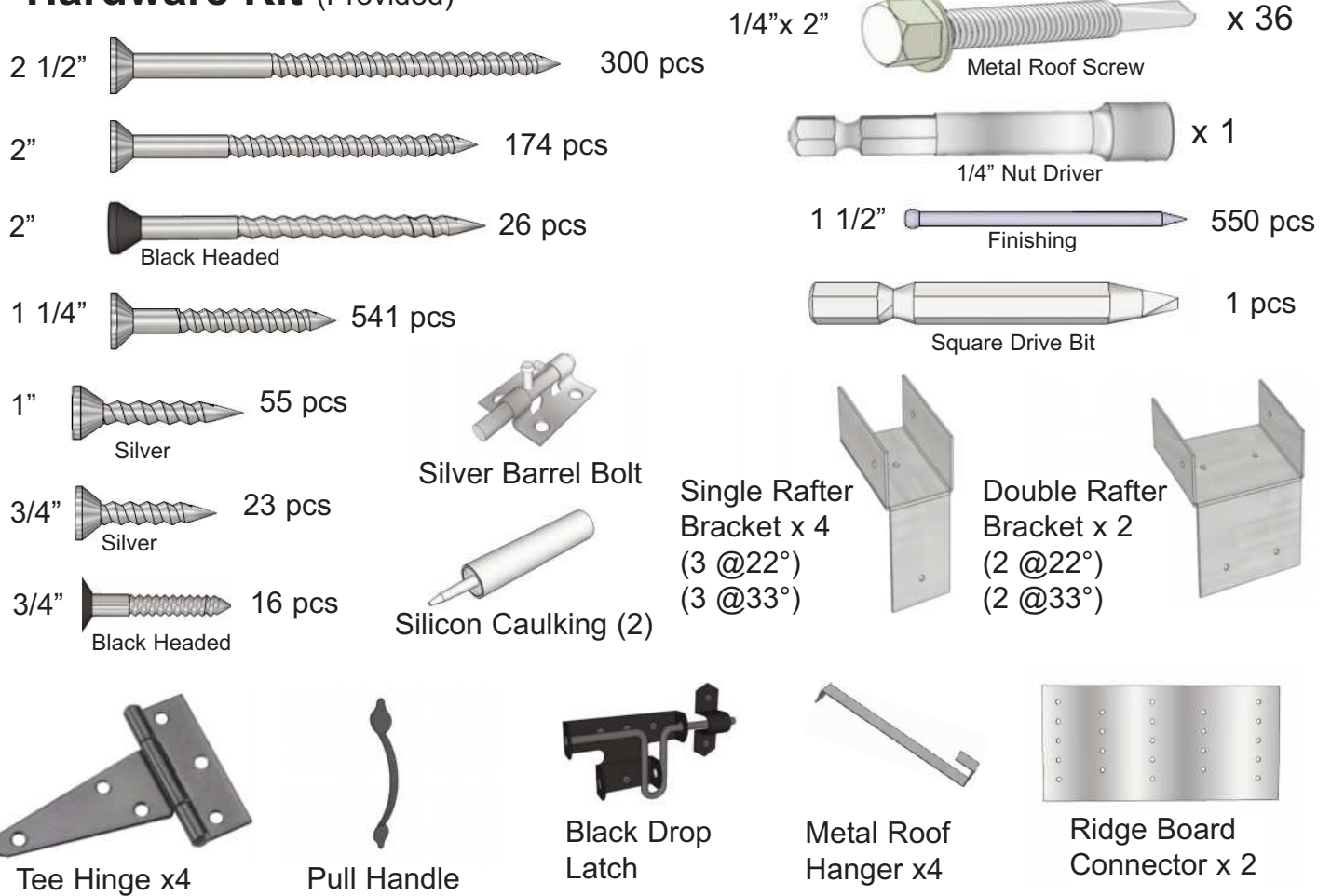

## Tools Required (Not Provided)



## Safety Equipment Required (Not Provided)



## Before/During Assembly:

- 1.) Paint each face and edge of your plywood floor with a latex exterior paint.
- 2.) Caulk wall seams if gaps appear.
- 3.) Caulk around window framing.
- 4.) Caulk perimeter between floor plywood and bottom wall plate.
- 5.) Caulk channels in lap siding at the top of your door above the trim, just a drop in each channel.
- 6.) Caulk edge of door threshold (if applicable).
- 7.) Optional: Install a Sill Gasket between floor runners and foundation.
- 8.) Optional: Install an 8" strip of roofing paper below Cedar Ridge Caps for Cedar Roof Sheds.

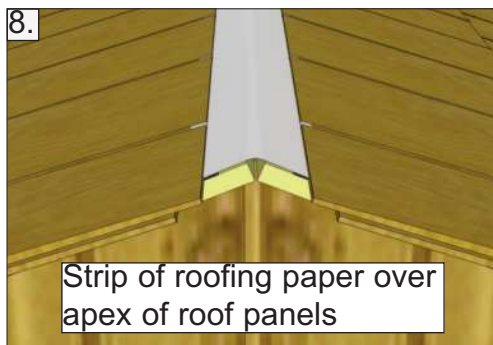
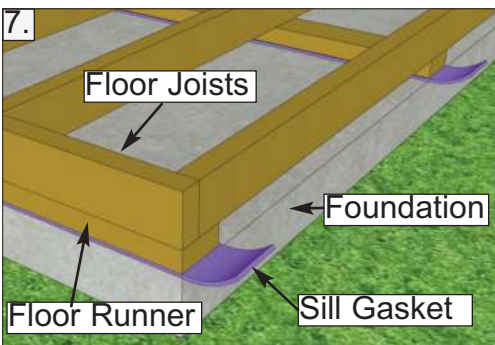
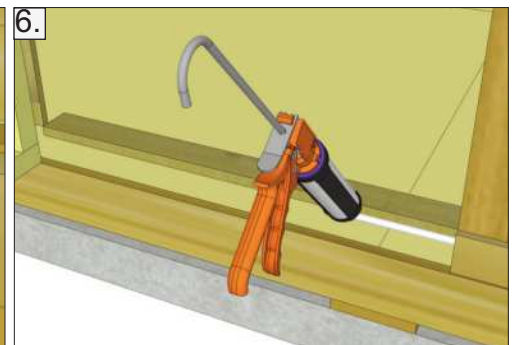
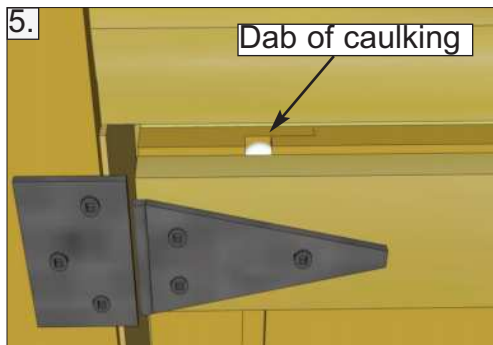
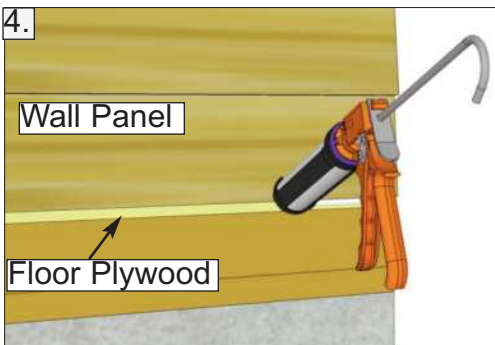
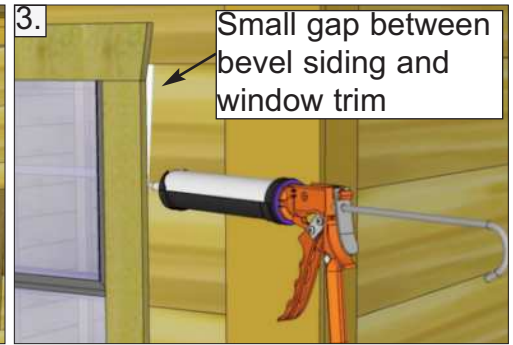
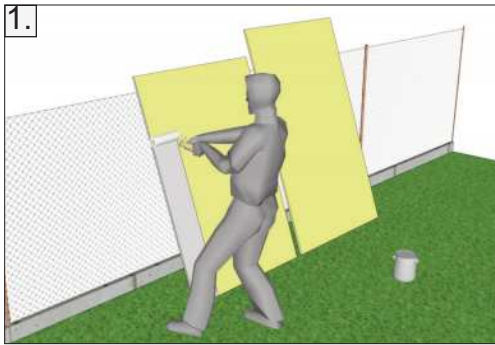

## Routine Maintenance:

- Routinely check all fasteners are tight (ex. Door Hinges, Nails)
- Brush off dirt from walls.
- Brush off snow from roof regularly.
- Routinely remove needles and leaves from roof.

## Painting/Staining

- Your cedar shed, if left untreated, will weather to a silvery grey colour.
- Painting or staining your structure is highly recommended and will prolong the life of your shed.
- You do not need to wait to paint or stain your shed, the wood in your kit has been dried and can be stained or painted immediately.
- Consult your local paint store for the best paint or stain for cedar.
- Optional: stain the inside of your shed. (Note: this will remove the fresh cedar smell.)

# A. Floor Section

Exploded view of all parts necessary to complete Floor Section. Identify all parts prior to starting. Note: Floor Footprint is 96" wide x 136 1/2" deep.

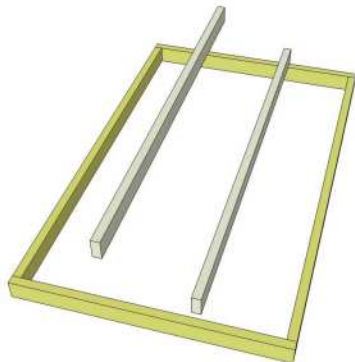
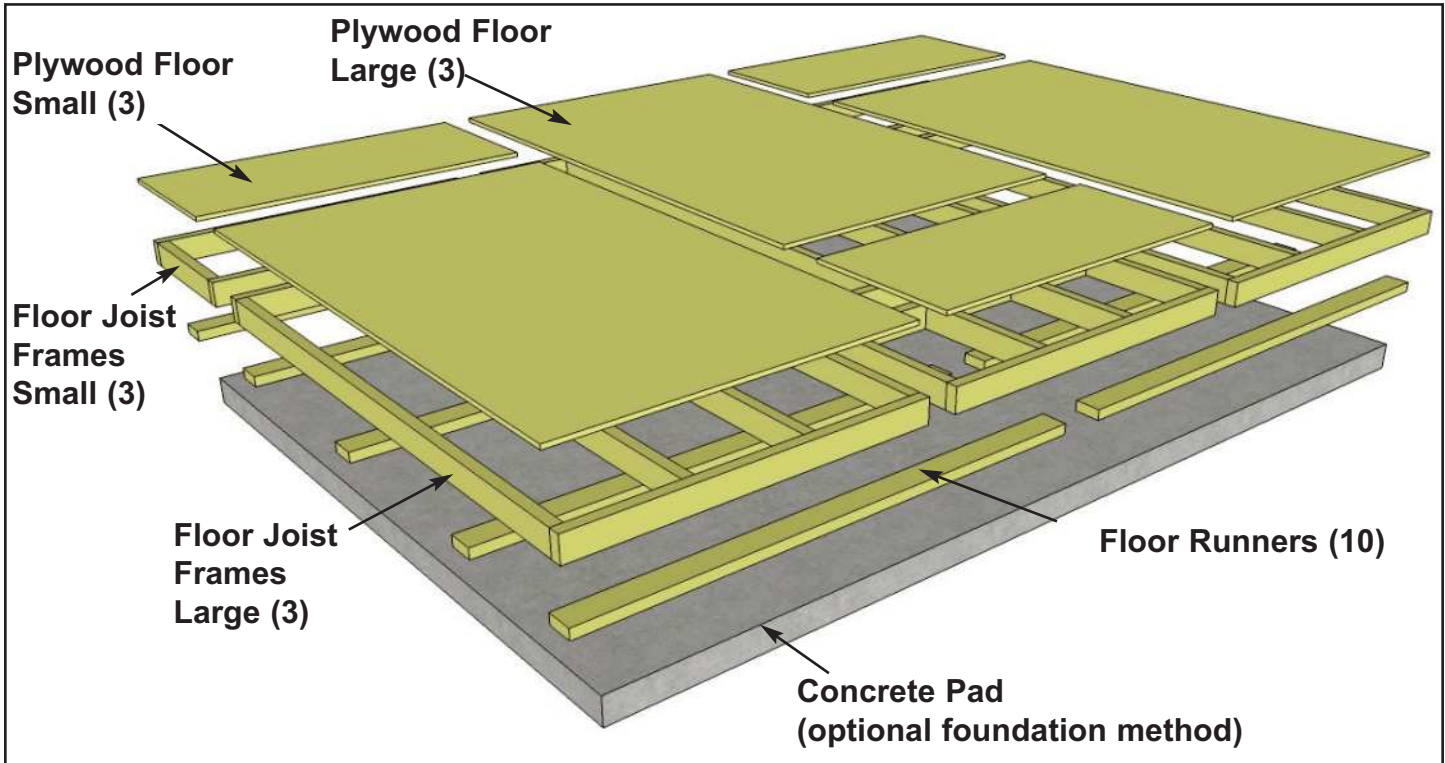

You can find the Square Drive Bit for the screws in with the Hardware Kit Bag.

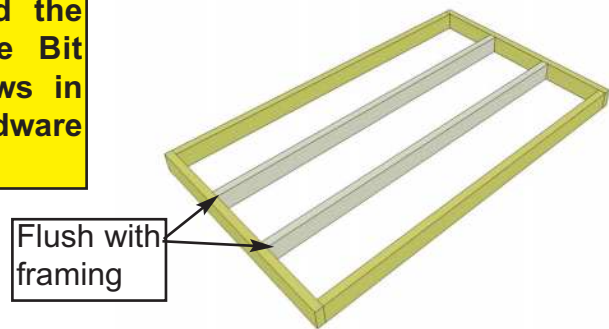

**1.** Lay out a **Large Floor Joist Frame** and 2 **Floor Joists** as illustrated above. Position Joists equally in Floor Joist Frame. Position Joists flush with framing.

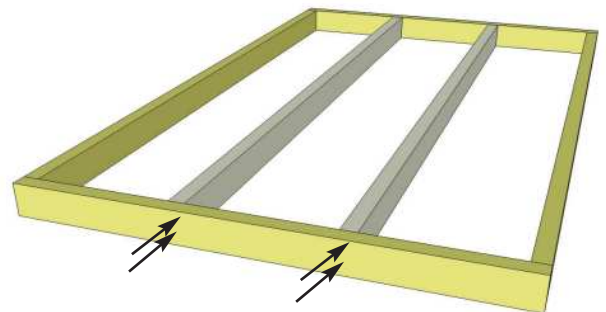
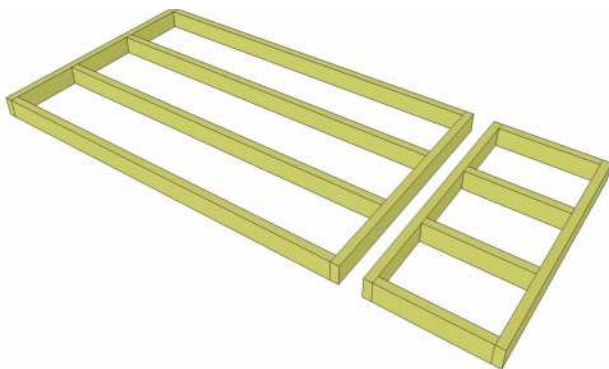

**2.** Use a Small Floor Joist Frame as a template to determine joist position. When correctly positioned, attach each Joist with 4 - 2 1/2" screws (2 per end). **You can find the Square Drive Bit for the screws in with the Hardware Kit Bag.**

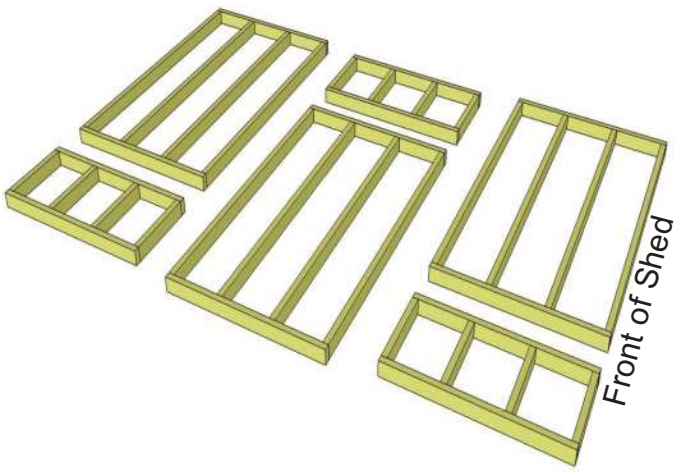

**3.** Lay out completed **Floor Joist Frames** as illustrated. There are 3 larger and 3 smaller Frame Sections. The Footprint for the floor when attached together will be 96" wide x 136 1/2" deep.

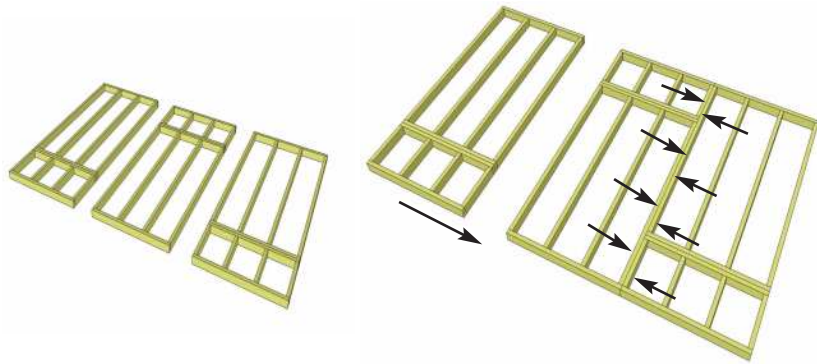

**5.** Complete all large and small frame attachments. Screw each completed section together with 8 - 2 1/2" screws.

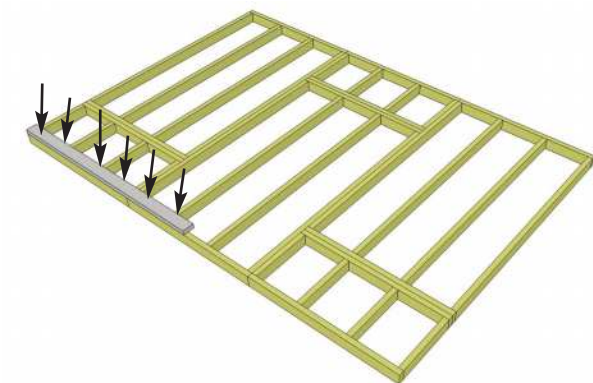

**7.** Attach **Floor Runners** to completed floor frame. There are 2 floor runners per 136 1/2" side and 5 completed runners in total. Use 6 - 2 1/2" screws per Runner.

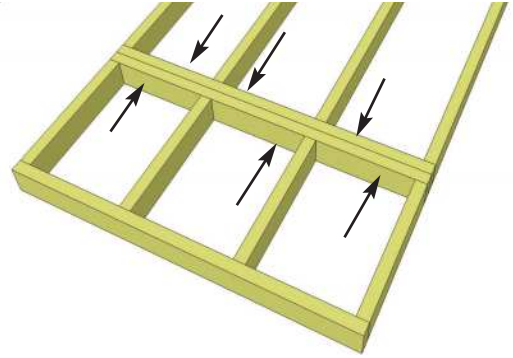

**4.** Attach each large and small floor joist frame together with 6 - 2 1/2" screws per section.

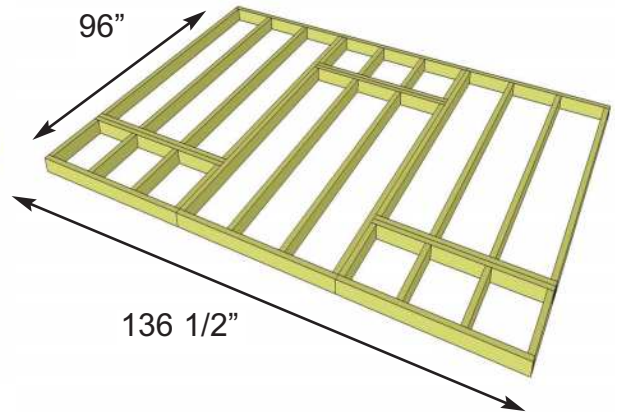

**6.** When completed, your floor footprint should be 96" wide x 136 1/2" deep.

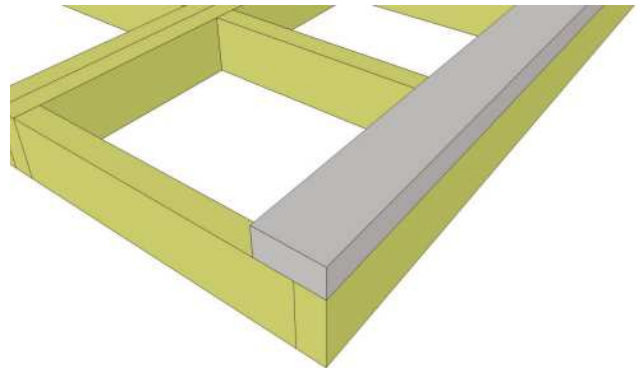

**8.** Make sure Runners are flush with outside of framing, not overhanging.



## Foundations



**Note:** The floor will be flipped over and floor runners will sit on your foundation. It is important to note that having a level foundation is critical. Choosing a foundation will vary between regions. Typical foundations can be concrete pads or patio stones positioned underneath the floor runners.

**9.** Complete all Floor Runners.

**10.** With Floor Runners attached, carefully flip the floor over and place on your foundation. **Caution:** you will need 2 people to assist you. Be careful when laying floor down not to bend or twist floor. When in place, level floor completely.

Concrete Slab Foundation

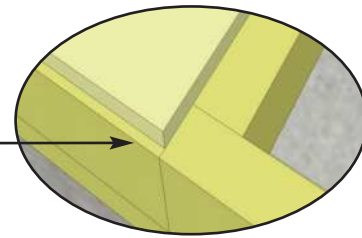
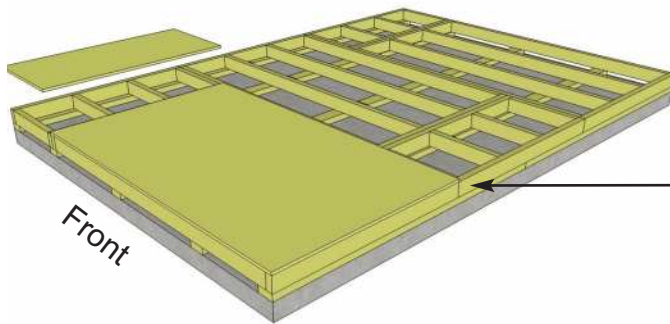
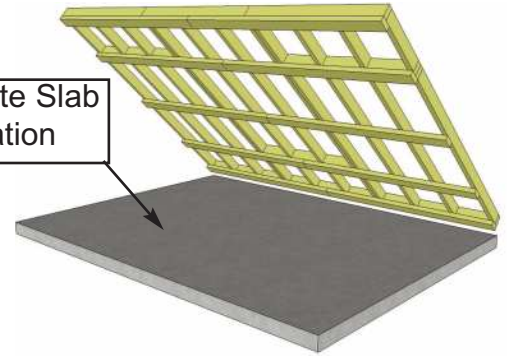

**11.** Position **Plywood Floor** pieces (6) on top of completed Floor Joists. The Plywood is cut slightly smaller than floor framing and will sit slightly back from outside edge. Keep plywood seams tight.

**12.** With Plywood positioned correctly on floor framing, attach with 1 1/4" screws. Use screws every 16".

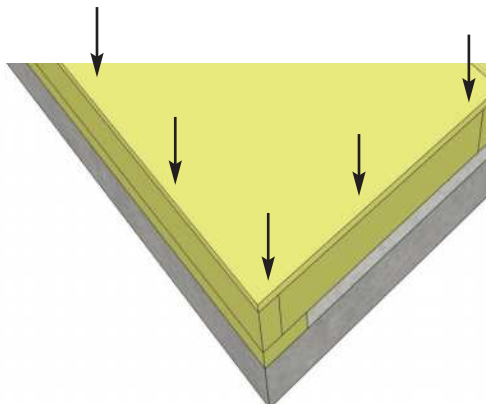
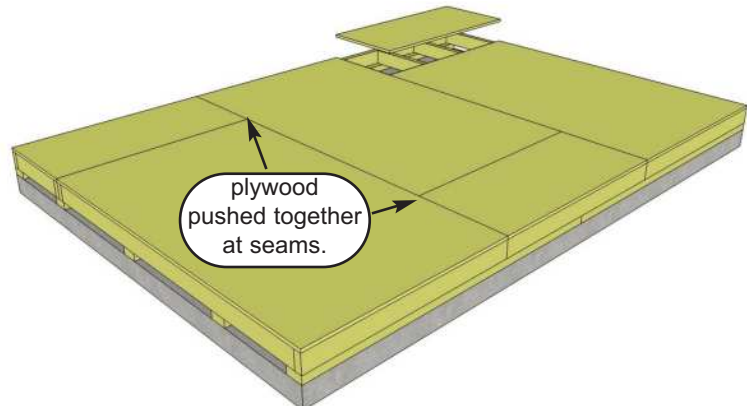

**Hint:** Use a chalk line to mark location of floor joists to determine screw placement.

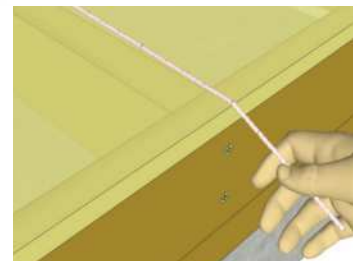

# B. Wall Section

Exploded view of all parts necessary to complete Wall Section. Identify all parts prior to starting.

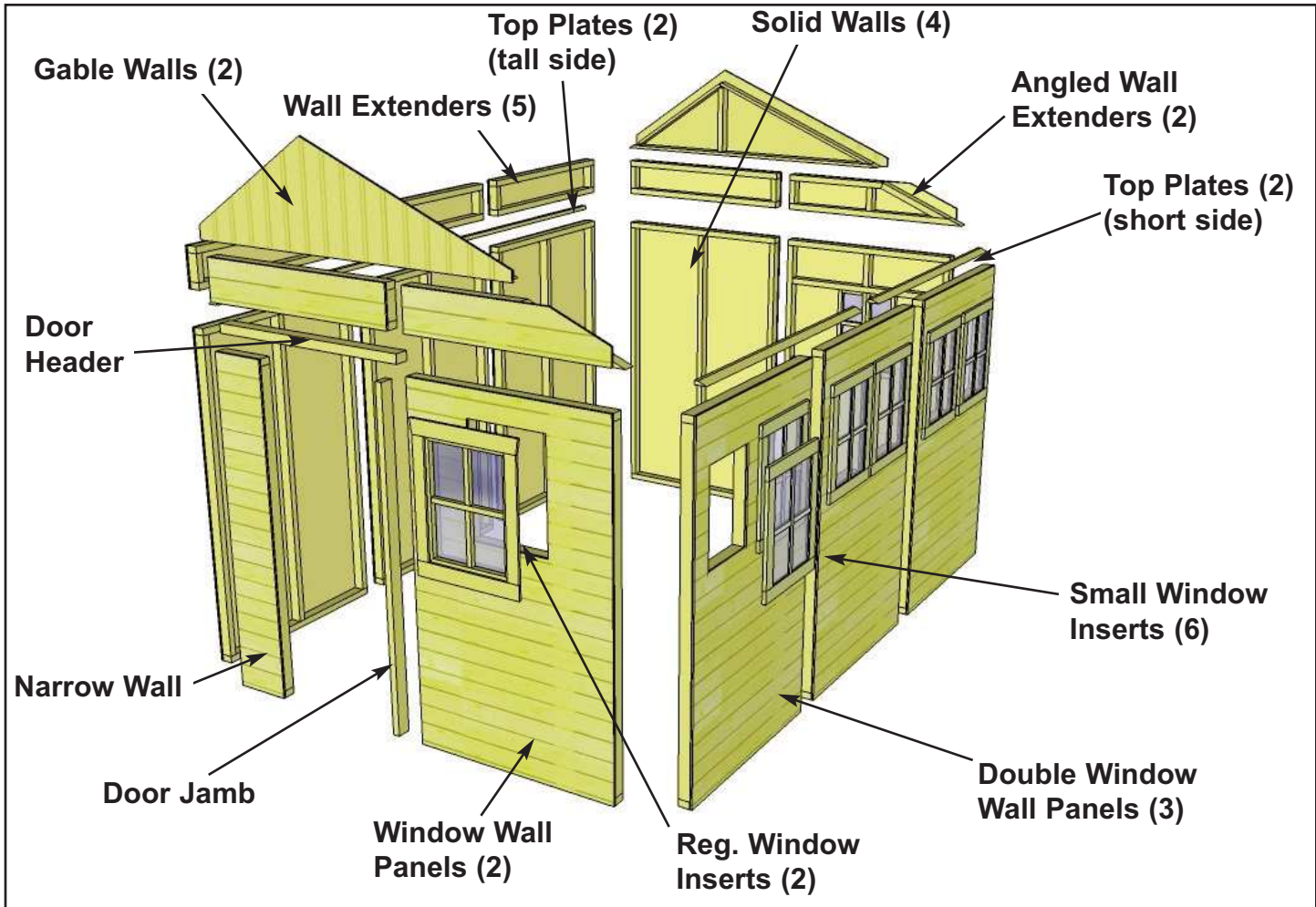

Lay out Panels and Pieces as illustrated below.

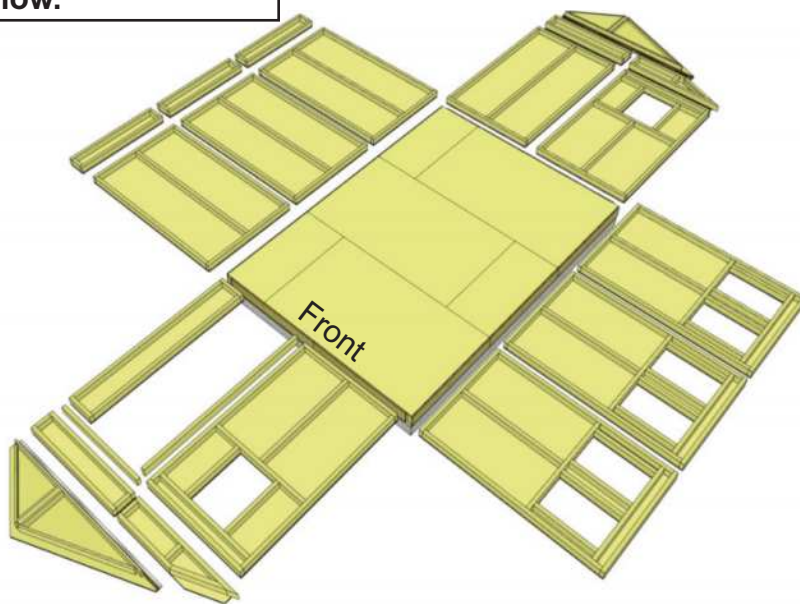

Left Side Polygal Roof Panel Orientation

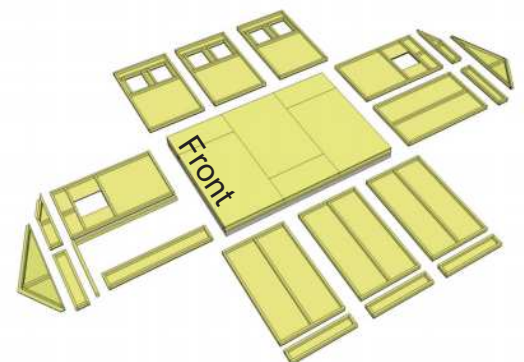

**Important:** If you prefer Polygal Roof Panels on left side when facing front, position wall panels as illustrated above. Follow general assembly directions but note opposite orientations.

**Important:**  
Pilot hole ALL 2x3 Wall Studs with 1/8" drill bit prior to screwing. This will make it much easier to attached together.

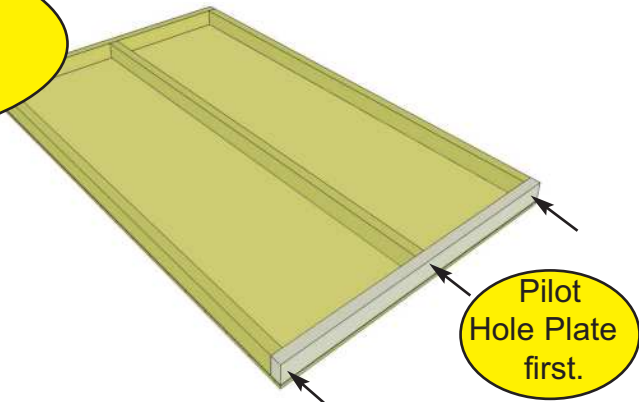
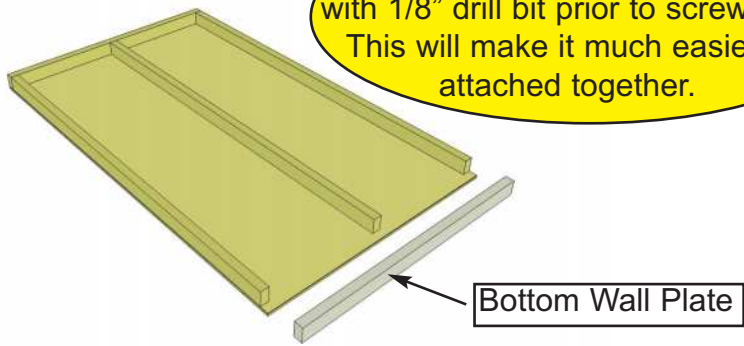

**13.** Starting with **Solid Wall Panels**, carefully lay panel face down. Position and attach **Wall Plate** (1 1/2" x 2 1/2" x 45 1/2") to bottom of studs of each wall panel with 3 - 2 1/2" screws. Position so plates are flush with framing.

**14.** Starting at the Rear Left Side, position a **Solid Wall Panel** on top of plywood floor. The Wall Panel bottom framing will sit flush with floor framing. Wall siding will overhang the floor.

**Important:** Make sure all walls are aligned in their upright position. If not, water may leak into your shed. Unsure if panel is facing up or down? check siding on window wall panel to match alignment, or keep track of your recently attached bottom plates.

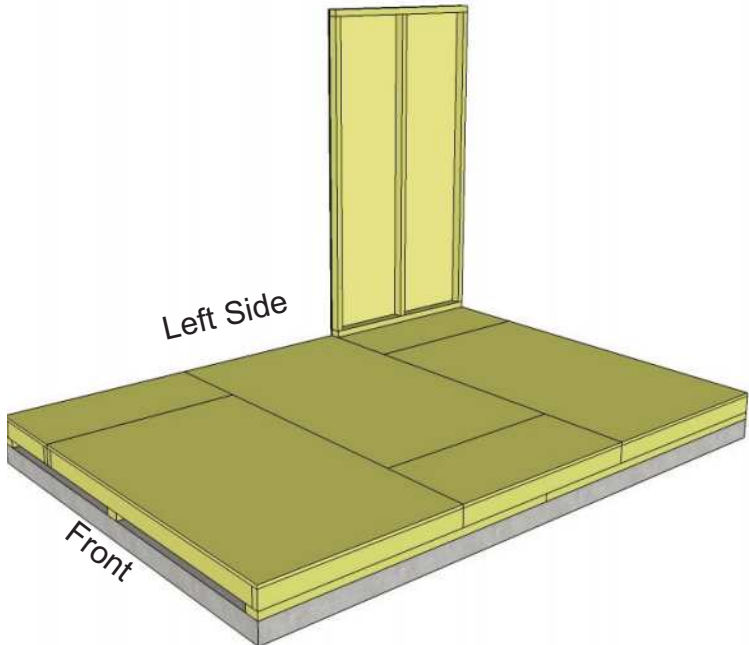

**Do Not Attach Walls To Floor until Step 29.**

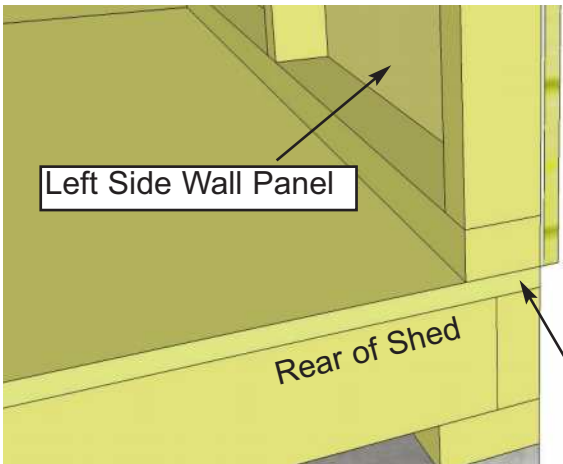

Outside 2x3 framing of wall panel is flush with outside of floor framing when properly aligned.

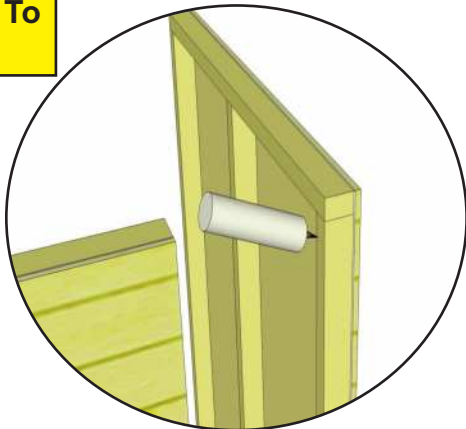

**Optional:** Caulking seams will help prevent moisture from entering your shed. Caulking is included to complete Polygal Windows only. Additional Caulking may be required.

**15.** The side panels will sit flush with floor framing in the corners, with the rear panels sandwiched between them. **Note:** Siding will overhang the floor by approx. 1/2".

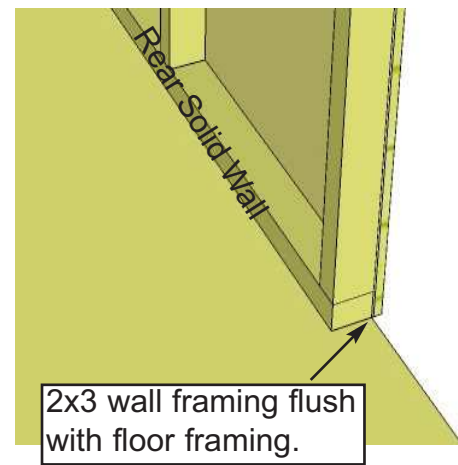
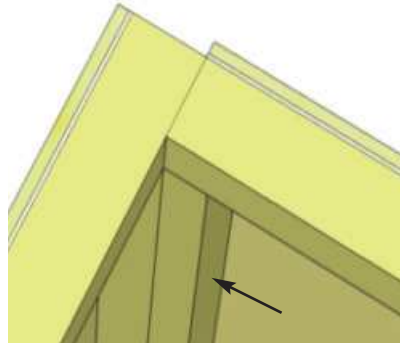
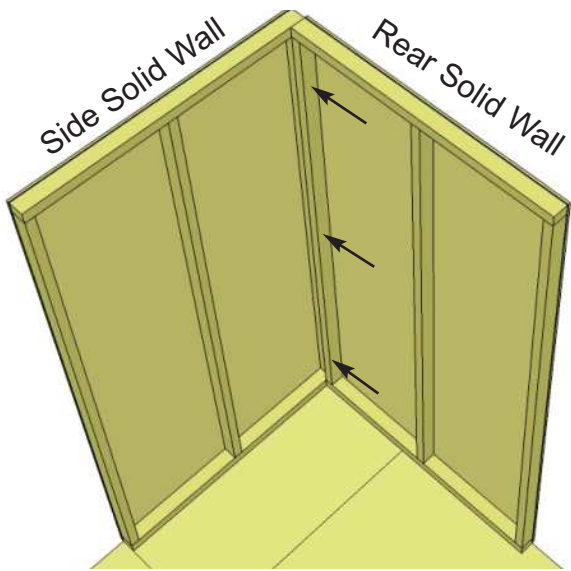

**16.** Position rear **Solid Wall** on plywood floor. Butt both vertical wall studs of side and rear walls together and attach with 3 - 2 1/2" screws. Screw at the bottom, middle and top of stud to secure.

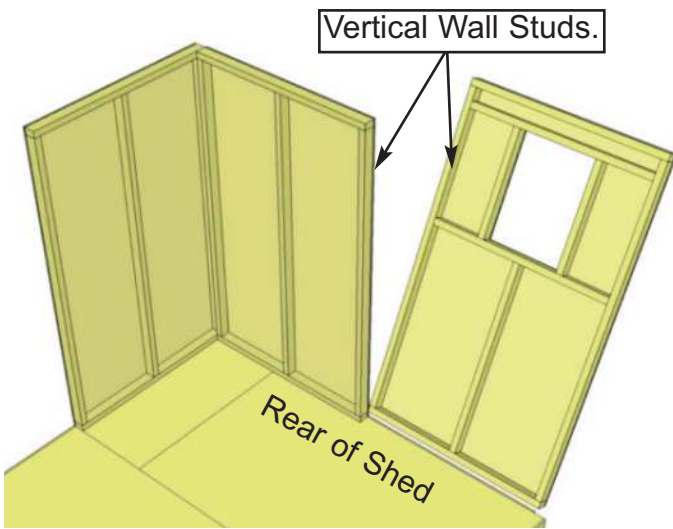

**17.** With the corner wall attachment complete, position the **Rear Window Wall Panel** so vertical wall studs line up evenly. Use a level to confirm solid and window walls are the same height.

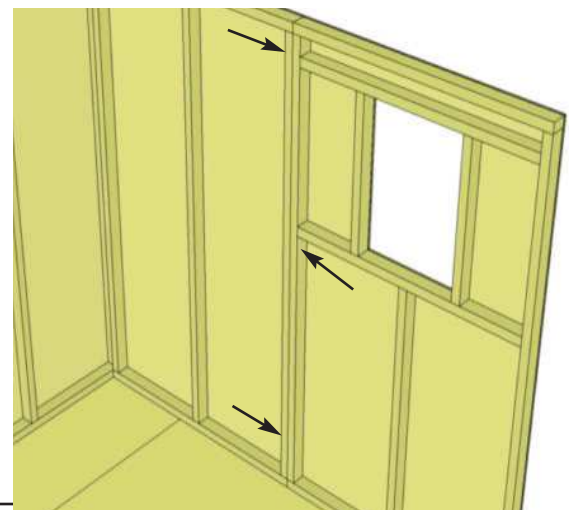
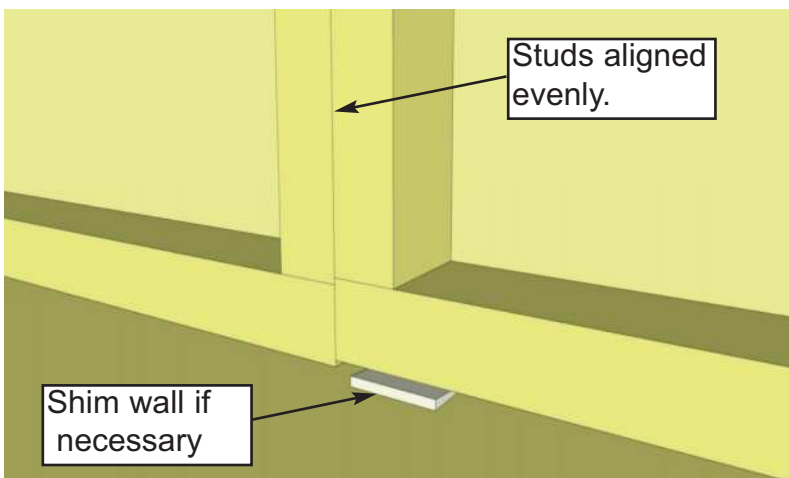

**18.** With walls positioned correctly, attach Rear Window Wall Panel to Solid Wall Panel as per **Step 16**.

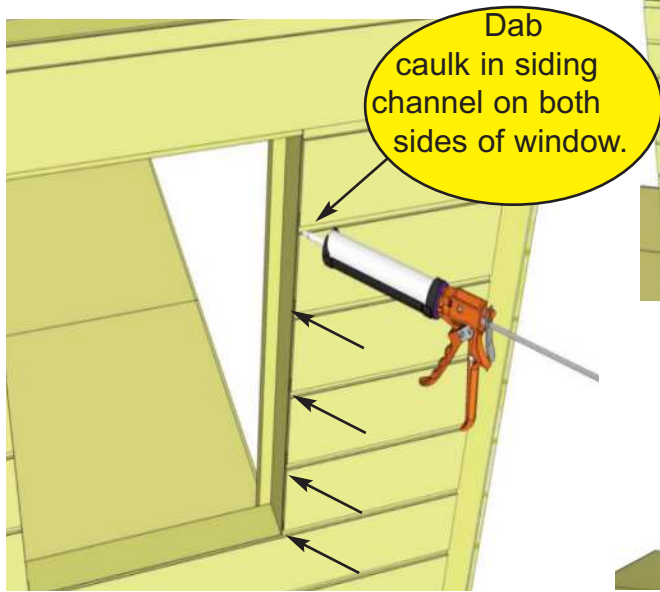

Dab caulk in siding channel on both sides of window.

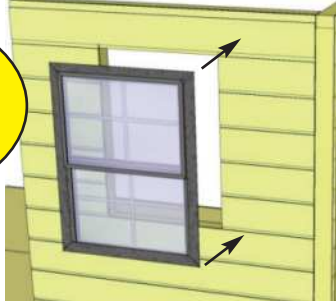

**Note:** We recommend you wait to install the windows last, so they don't get damaged during construction.

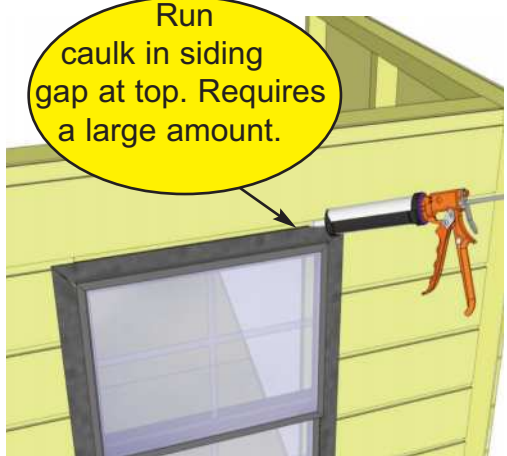
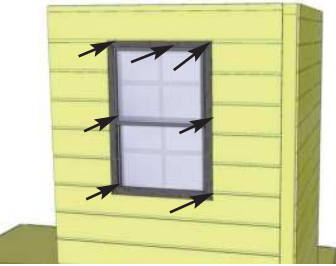

Run caulk in siding gap at top. Requires a large amount.

**19. Locate Window Inserts for Regular Window Walls.** Before installing, dab caulk in siding channel on both sides of window opening. This will prevent water from getting in behind window. Position window in cavity and secure with 8 - 1 1/4" screws. Caulk gap between siding and window at top. This requires a large amount of caulking but is important to fill. Later, Window Trims will be installed to hide caulking. Complete Window Inserts as walls are erected or complete in **Step 25**.

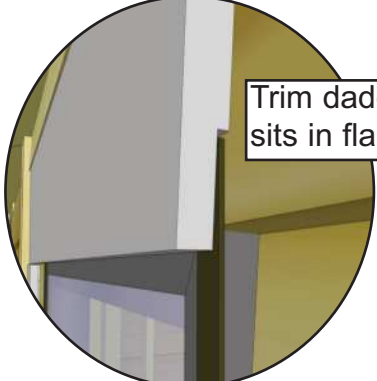

Trim dado sits in flange.



**19a.** Position Window Trim around window doing a dry run first and attach with 4 - 1 1/2" finishing nails per piece. There are two Trim Kits (Regular / Narrow). The regular window kit = 1 x 24 1/16" = top (angle cut on ends) / 3 x 23" = Sides & Bottom. Narrow window kit = 1 x 19 7/8" Top, 2 x 21 7/16" Sides, 1 x 18 3/4" Bottom. Window trim has a small dado on reverse face. Outside flange of window will roughly sit in the dado to give a better fit.

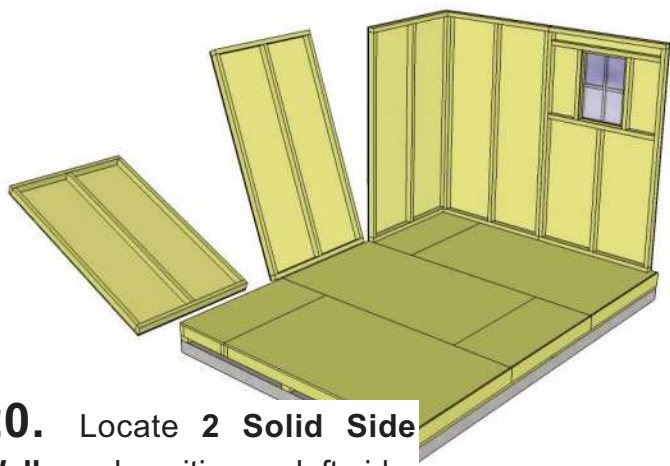

**20.** Locate 2 Solid Side Walls and position on left side.

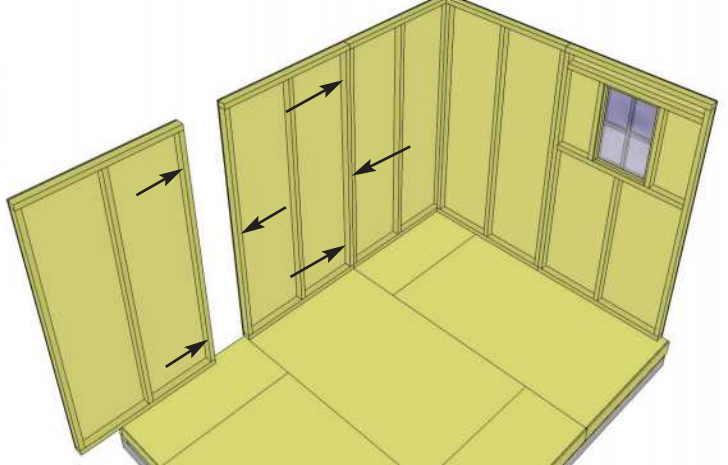

**21.** Position and secure Wall Panel studs together as per **Step 16**.

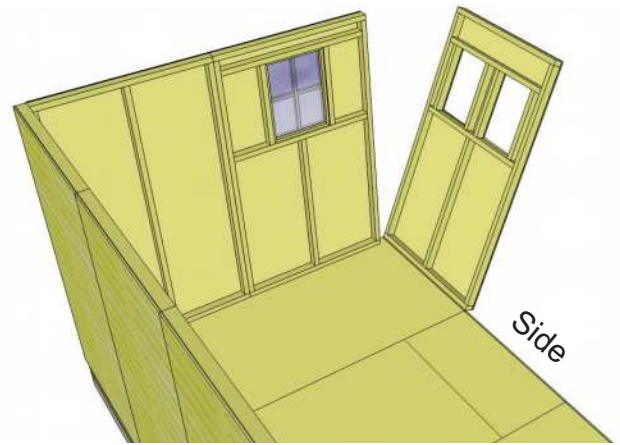
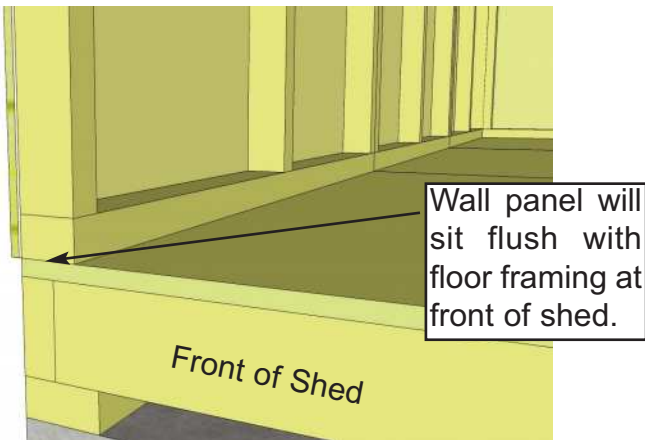

**22.** Front Side Wall Panel will sit flush with floor framing in corner when positioned correctly. Position Rear Side Double Window Wall on floor.

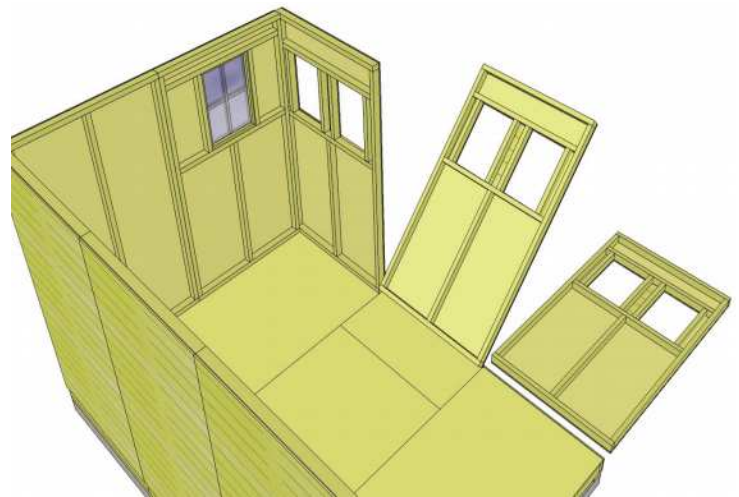
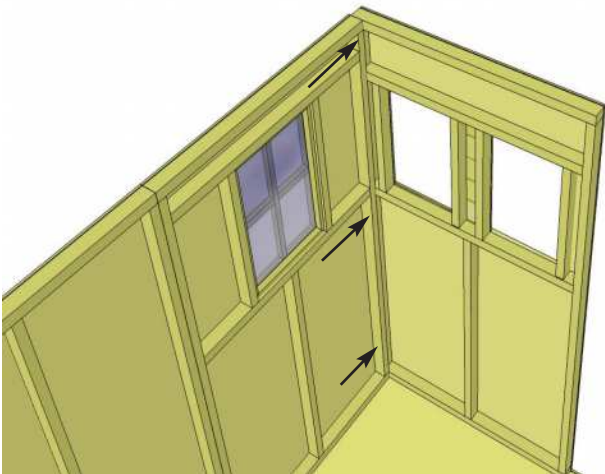

**23.** Position and secure Wall Panel studs together as per **Step 16**. Locate and position remaining Double Window Walls on floor.

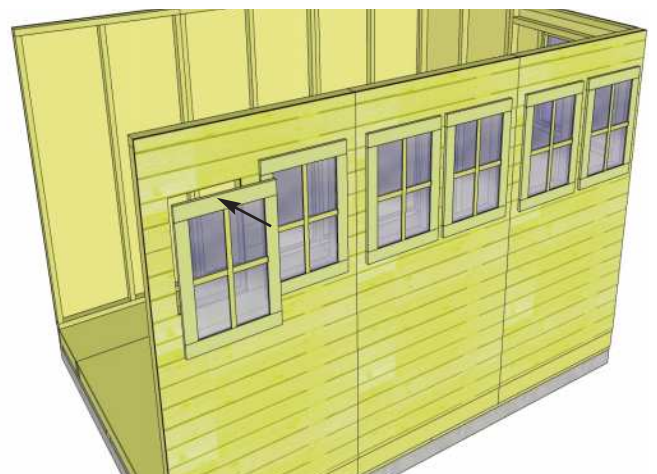
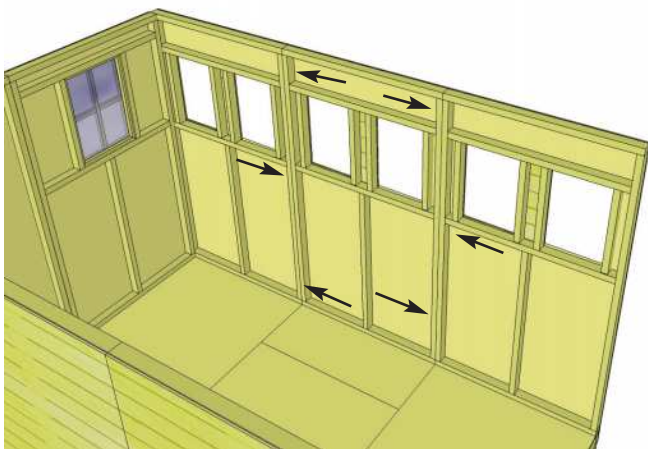

**24.** Position remaining Double Window Walls and attach as per **Step 16**. Place **Window Inserts** in window openings as per **Step 19**.

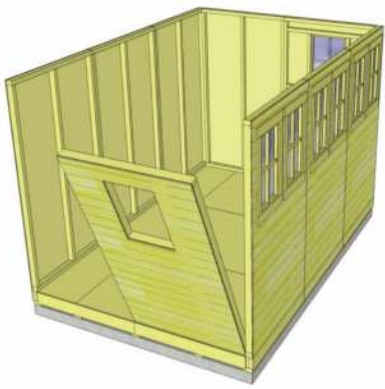

**25.** Place 2nd **Window Wall Panel** in front and attach as per **Step 16**. Install Window Insert as per **Step 19** .

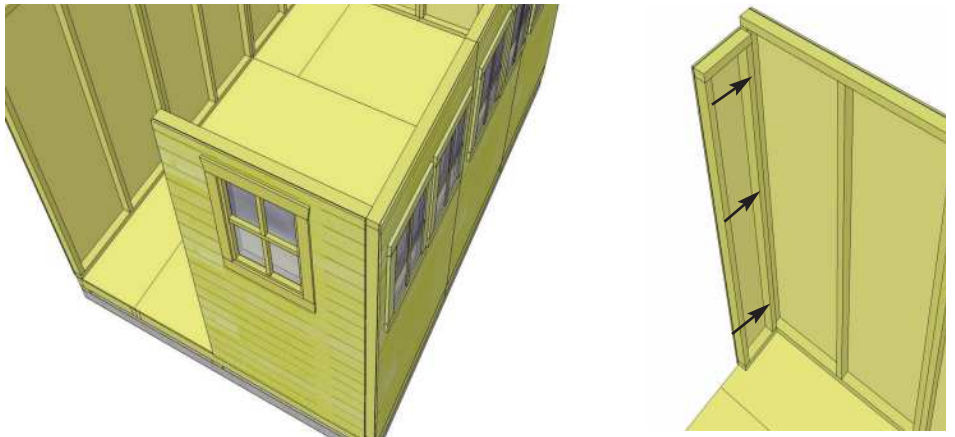

**26.** Position and attach **Narrow Wall Panel** to left side wall stud with 3 - 2 1/2" screws as per **Step 16**. **Note:** Narrow Wall is 73" high (2" shorter than regular walls).

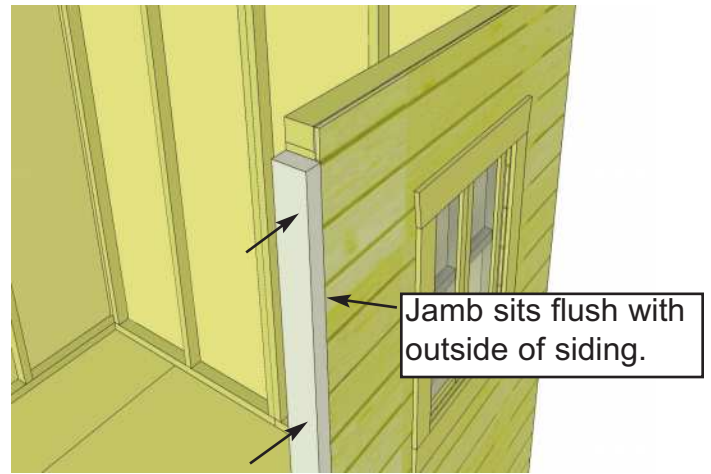
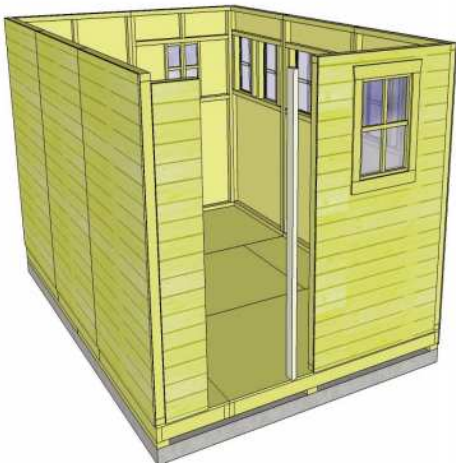

**27.** Locate **Vertical Door Jamb** (1 1/2" x 3" x 73") and position flush against right wall panel stud. The Jamb is 3" wide and will sit **flush to outside of wall siding**. When positioned correctly, secure Jamb using 4 - 2 1/2" screws.

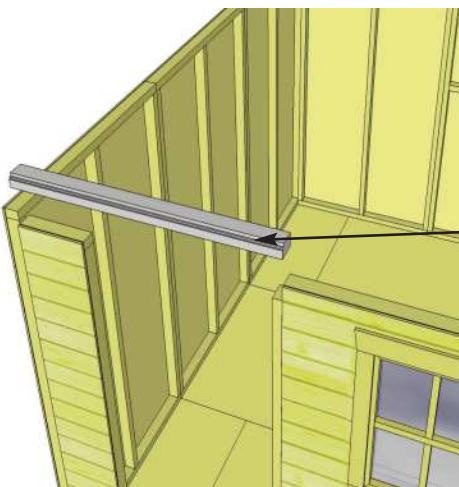

Dado cut on edge

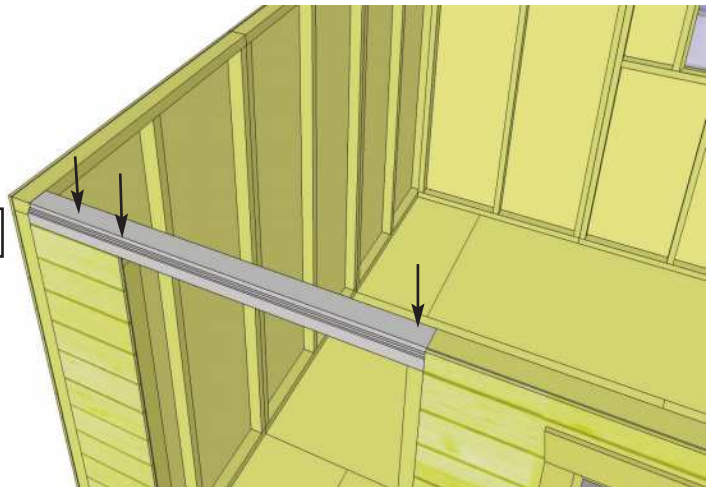

**28.** Position and attach the **Door Header** (2" x 3" x 45 1/2") to Door Jamb and Narrow Wall Panel top framing. Header should sit flush with Door Jamb and Outside of Narrow Wall Panel Siding. Attach with 3 - 2 1/2" screws.

Confirm 32" wide Door Opening at bottom.

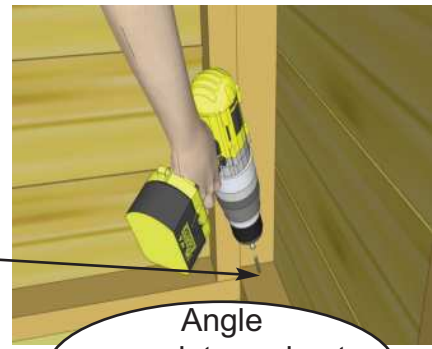
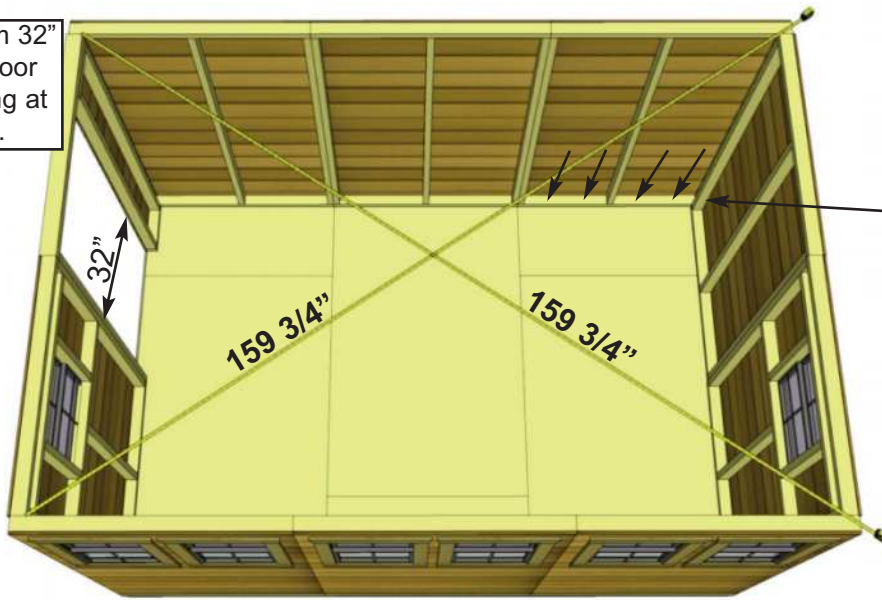

Angle screws into perimeter Floor Joists.

**Advice:** Prior to fastening walls and installing rafters, take time to confirm your walls are level, square and plumb.

Measure diagonal at top and bottom of walls corner-to-corner. This should be approximately 159 3/4". More importantly, if measurements are not within 1/4", your walls are not square. Adjusting now will make it easier to the roof section later.

**29.** When all walls are attached together, check alignment with the floor. Bottom wall framing should sit flush with outside of floor frame. When positioned correctly, fasten bottom wall plates to floor using 4 - 2 1/2" screws per wall panel.

**Important:** If walls are not lining up and appear higher or lower than each other, your floor may not be LEVEL. Please check the level of your floor. You may need to make slight adjustments to level your floor before proceeding.

**Optional:** Caulking seams will help prevent moisture from entering. Caulking is included to complete Polygal Windows only. Additional Caulking may be required.

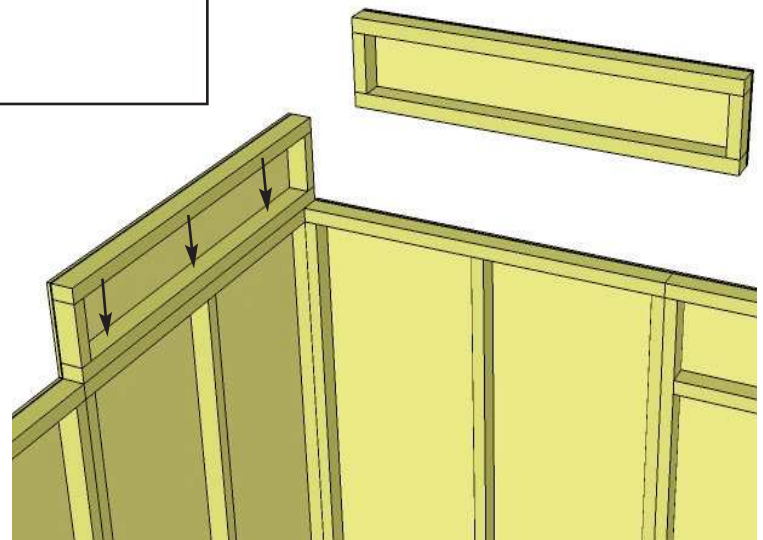
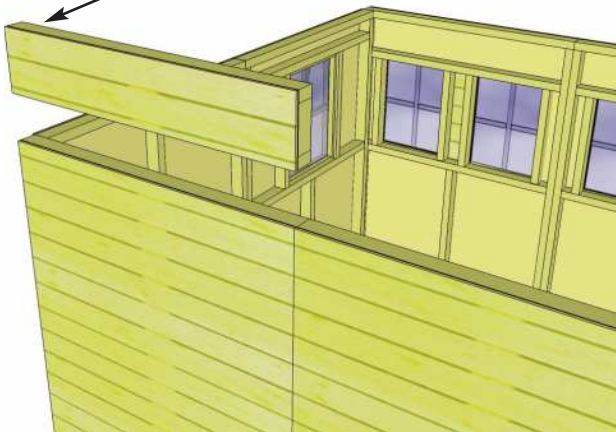
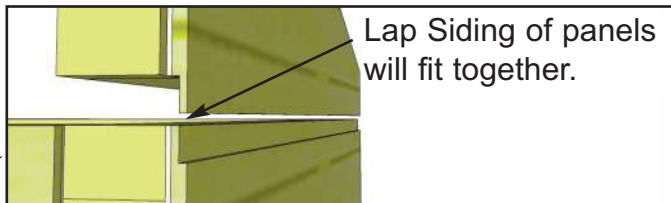
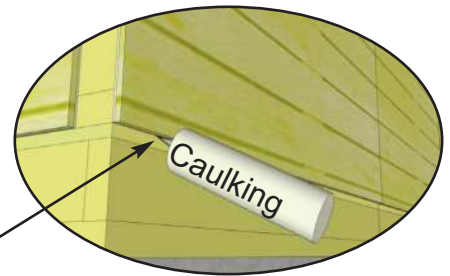

**30.** Locate and place **Side Extender Walls** on top of Side Walls in rear corner. Align so 2x3 framing lines up with framing of regular walls. When correctly in place, secure with 3 - 2 1/2" screws per piece.



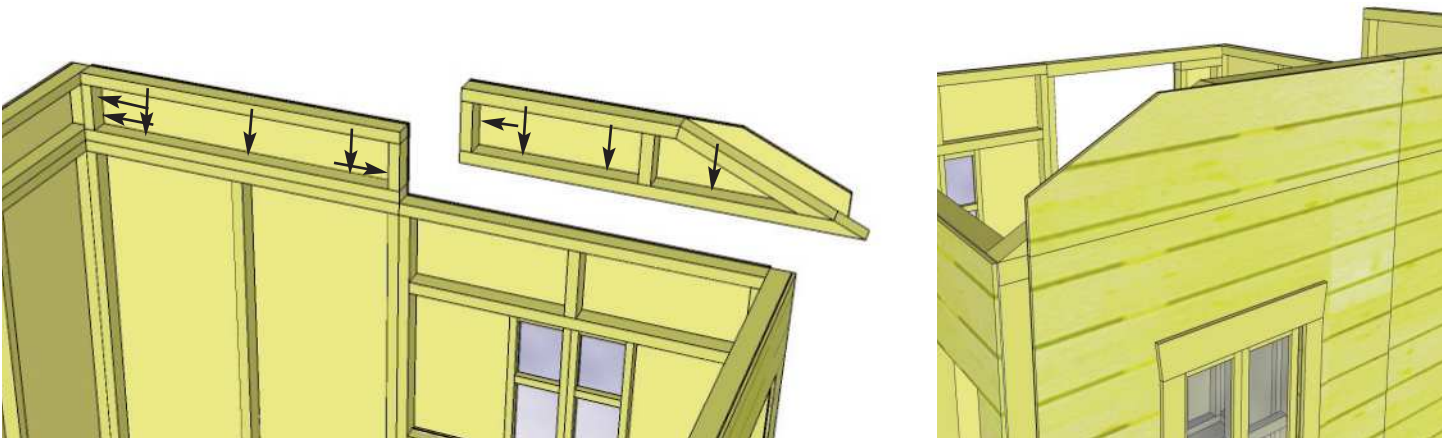

**31.** Screw vertical framing of corner extenders together with 2 - 2 1/2" screws. Locate and position an **Angle Extender Wall** on the rear wall of Sunshed. Align once again so 2x3 frame lines up with previously installed Wall Extender and regular wall panel. When correctly in place, secure with 3 - 2 1/2" screws into Window Wall framing, and 2 - 2 1/2" screws into adjacent extender.

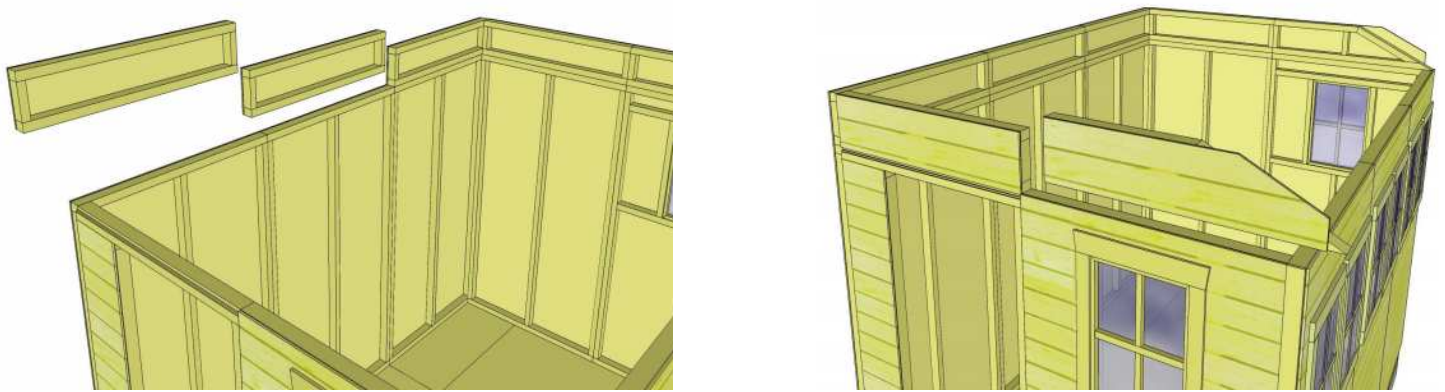

**32.** Align and attach remaining Wall Extenders as per **Step 30-31**. **Note:** Wall Extenders are not required for the Short Side walls.

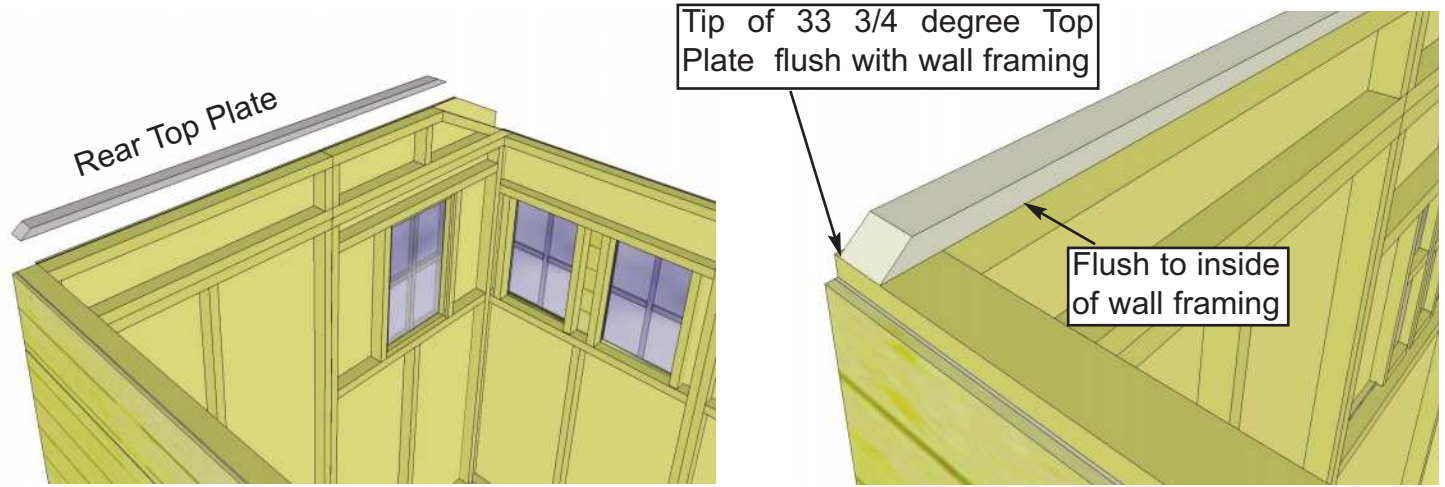

**33.** Locate **Rear Top Plate** (3/4" x 2 1/2" x 73 3/4") and position on wall framing flush on inside. Align so angle cut on 33 3/4 degree end is facing the high wall and 22 1/2 degree end is facing the short wall.

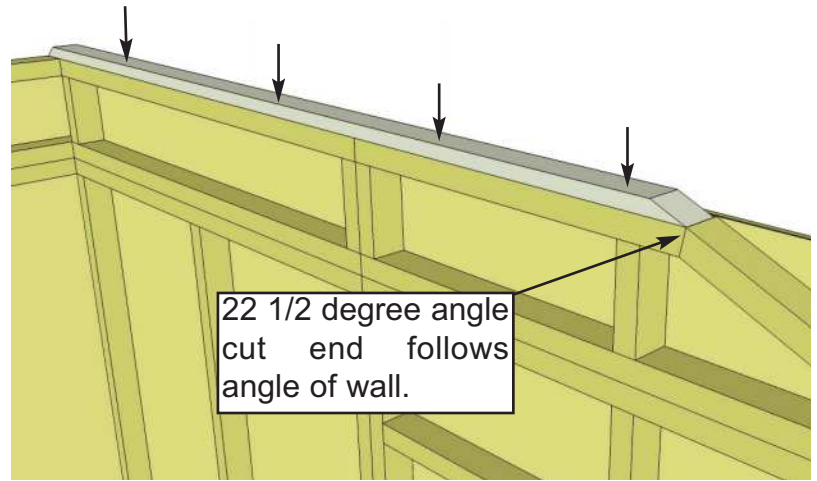
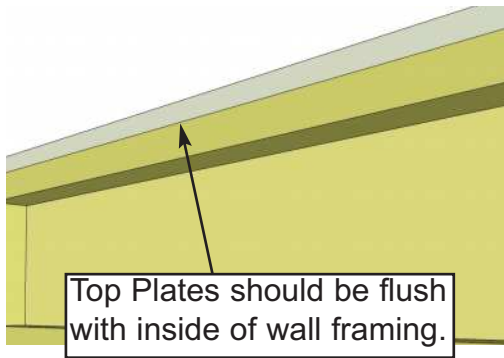

**34.** When properly positioned, attach by screwing down into top wall framing with 4 - 2" screws.

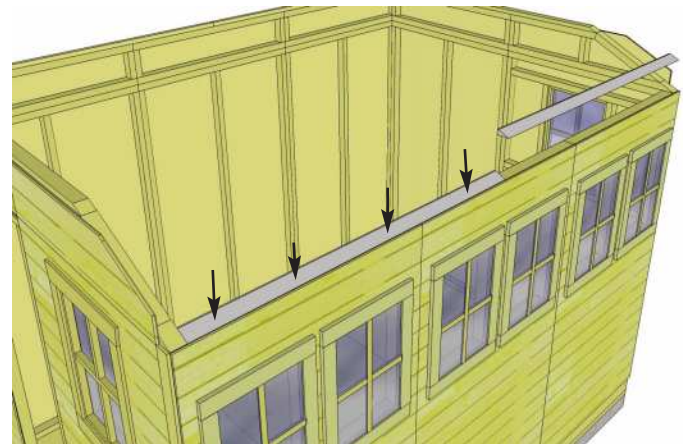
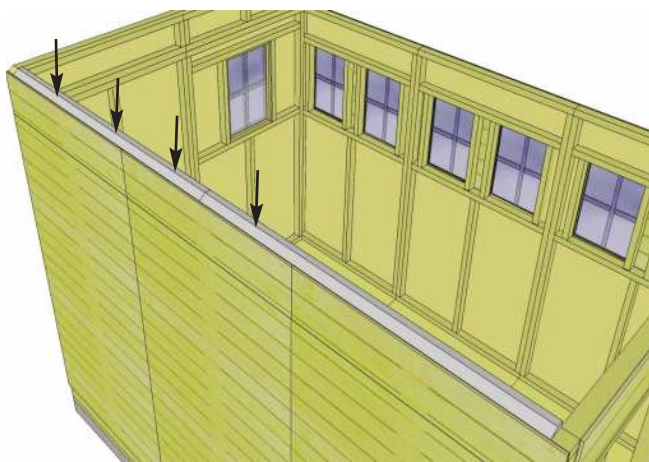

**35.** Next, attach the **Side Top Plates** (1 1/2" x 2 1/2" x 65 3/4" - 33 3/4 degree cut down edge) to high wall side. Once again, position top plate so it is flush with inside of wall plate. Side plate should also be flush with Rear Top Plate. Secure with 4 - 2 1/2" screws per piece. Complete Short Side Top Plates (3/4" x 2 1/2" x 65 3/4" - 22 1/2 degree cut down edge).

**36.** Position remaining **Front Top Plate** on wall framing and secure with 4 - 2" screws.

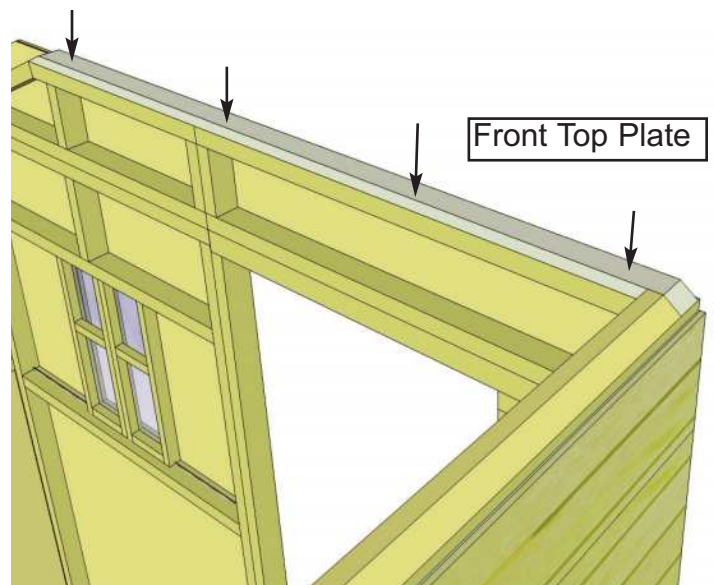

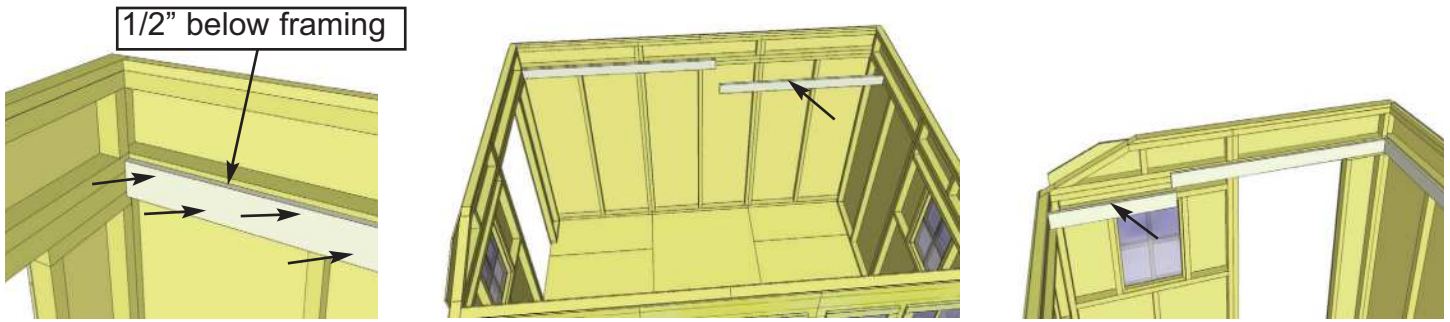

**37.** Attach **Horizontal Wall Extender Braces** (3/4" x 3 1/2" x 30"/60"/71 1/2") to Framing of Top and Bottom walls 1/2" below extender wall framing. Start with High Wall Side and attach 71 1/2" and 60" long pieces with 10 - 1 1/4" screws per piece. Alternate screws into both pieces of framing. Complete Front and Rear walls (60" and 30" long pieces) using the same alignment.

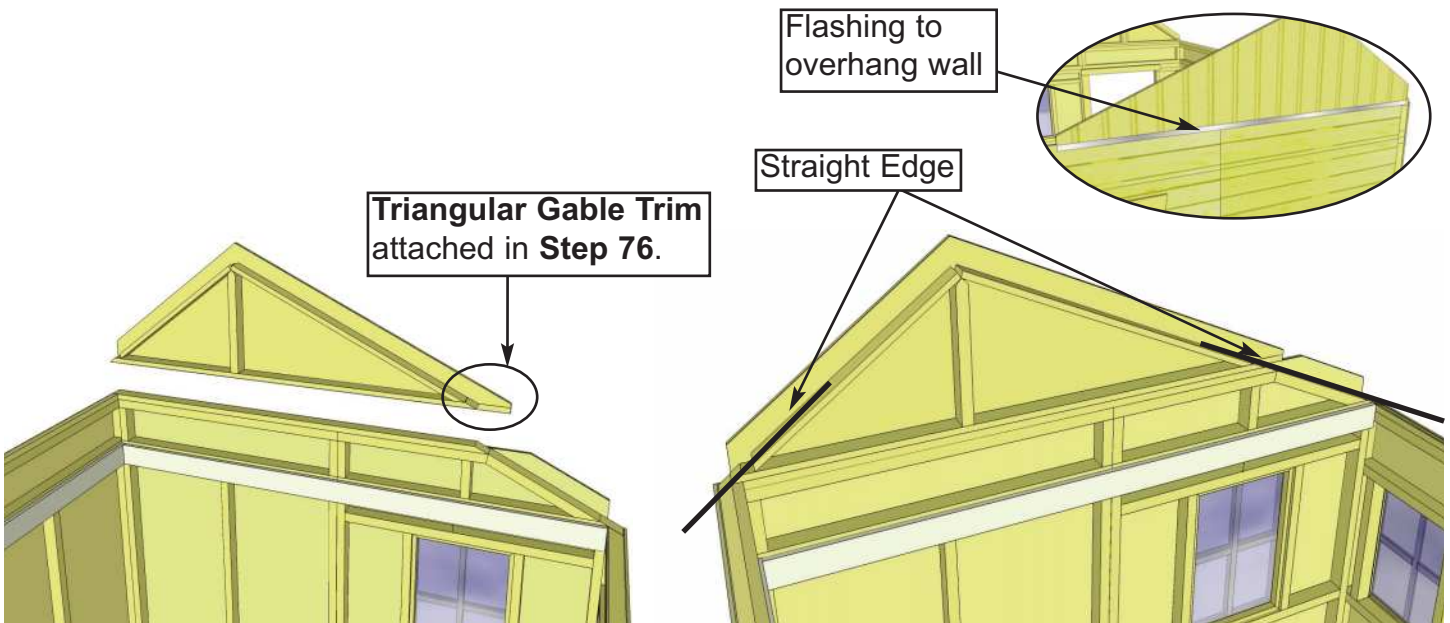

**38.** Lift up **Gable Wall** and place on top of rear wall. Gable side with 33 3/4" degree cut will be aligned on high wall side. Slide Gable Wall side to side and use a straight edge to line up angled framing of gable with Top Plates and Walls. There is some tolerance, try for best fit on both sides.

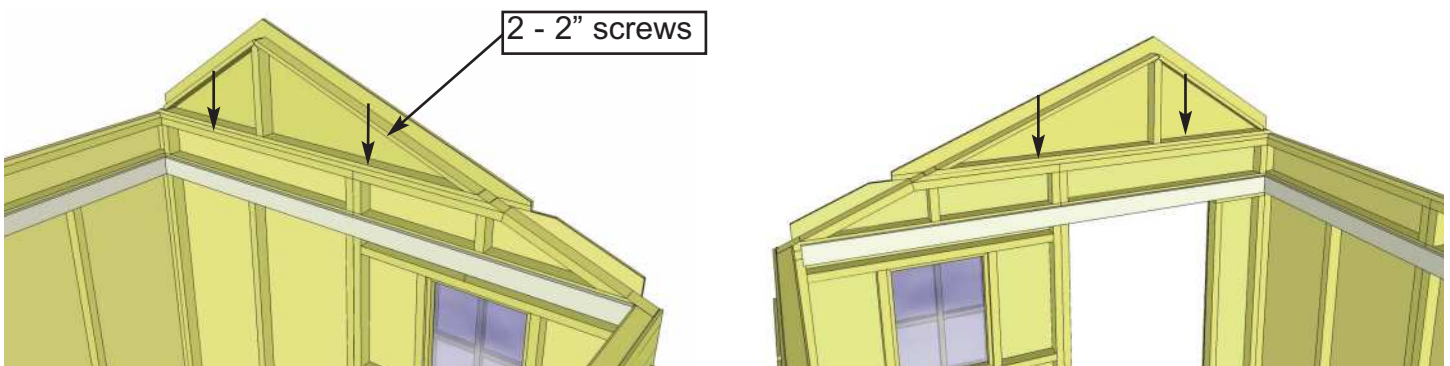

**39.** When Gable wall is positioned correctly, tack in place with 2 - 2" screws. Adjustment to Gable may be required in **Step 49**, where it will be further secured. Complete other Gable Wall.

# C. Rafter Section

Exploded view of all parts necessary to complete Rafter Section. Identify all parts prior to starting.

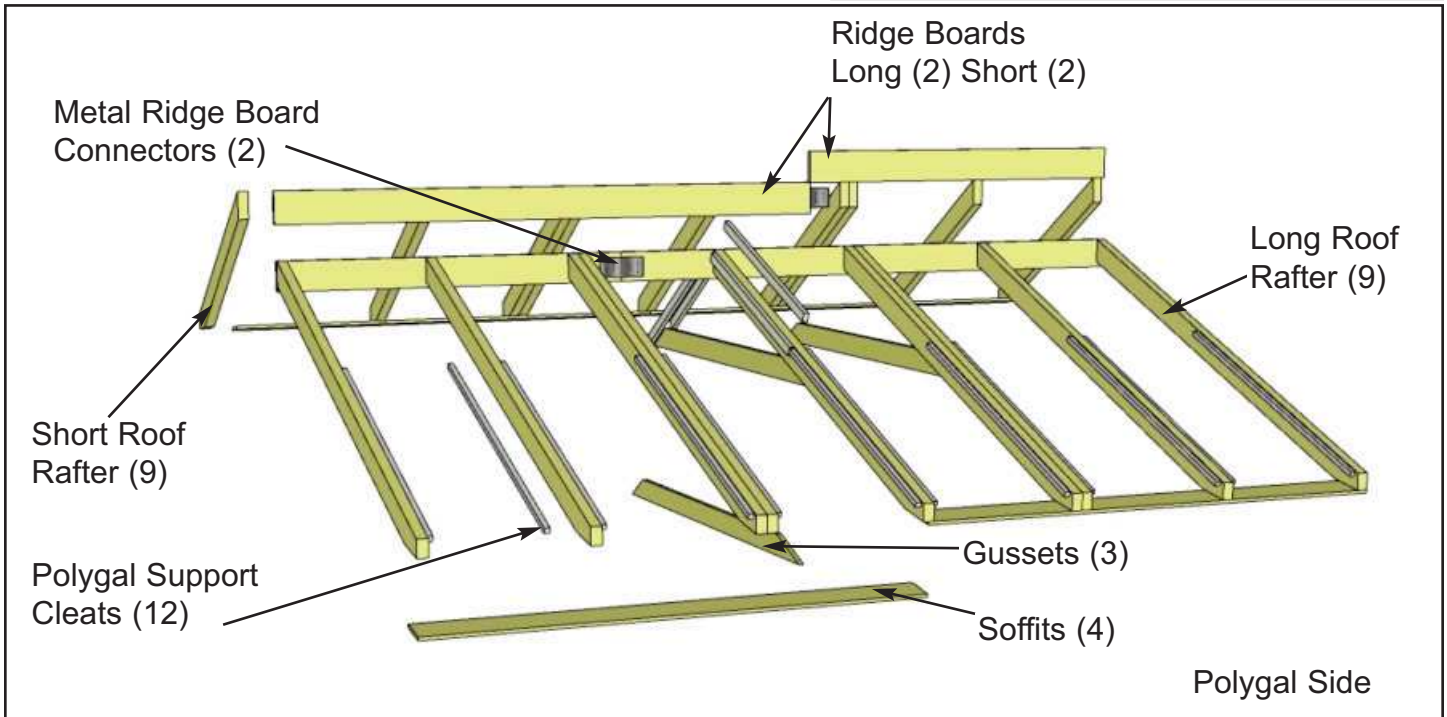

**Important:** Locate all parts necessary to assemble Long and Short Rafter Sections:

**Long Rafter Side:**  
 9 - 77 3/4" long 2x4 Rafters  
 1 - 3/4" x 4 5/8" x 52 1/2" - Ridge Board  
 1 - 3/4" x 4 5/8" x 84" - Ridge Board  
 1 - 1/16" x 3" x 7" - Metal Ridge Board Con.  
 2 - 1/2" x 4 1/2" x 68 1/4" - Soffits  
 12 - 3/4" x 3/4" x 44" - Polygal Support Cleats

**Short Rafter Side:**  
 9 - 37 3/4" long 2x4 Rafters  
 1 - 3/4" x 5 1/8" x 52 1/2" - Ridge Board  
 1 - 3/4" x 5 1/8" x 84" - Ridge Board  
 1 - 3/16" x 2 1/2" x 7" - Metal Ridge Board Con.  
 2 - 1/2" x 3 1/2" x 68 1/4" - Soffits

Follow **Steps 40 - 43** to Assemble Rafter Sections. Make sure to complete on a flat level surface. Please note the differences between the Long and Short Rafters Sides.

**Long Rafter Side**

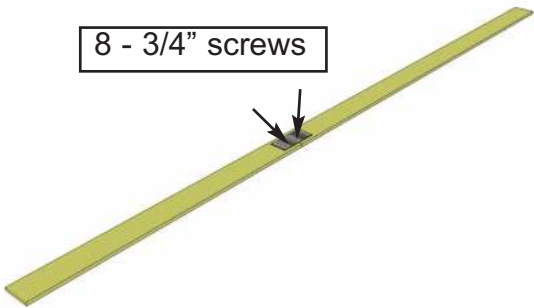
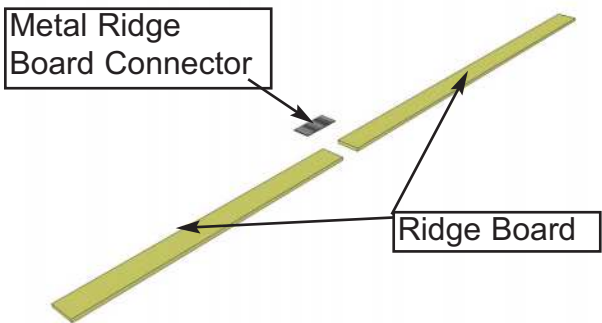

**40.** Locate both 3/4" x 4 5/8" x 84" & 52 1/2" Ridge Boards (Long Rafter Side) and attach together with Metal Ridge Board Connector using 8 - 3/4" screws evenly on boards. Total Length when connected is 136 1/2". Complete Short Rafter Side using same procedure only Ridge Boards are 5 1/8" wide.

**41.** Locate 9 **Rafters**, 2 **Soffits** and completed Ridge Board. Lay out on level ground as shown to the right. Double up Rafters as illustrated. Screw doubled up Rafters together with 3 - 2 1/2" screws per piece. **Note:** completed rafter section will be flipped over in **Step 43**.

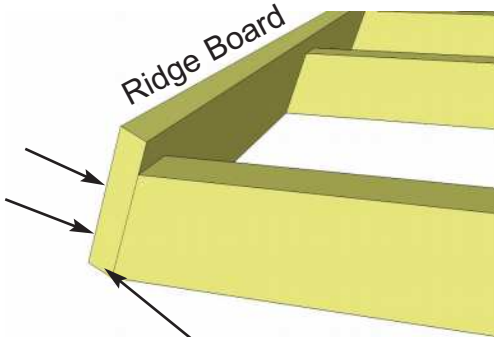
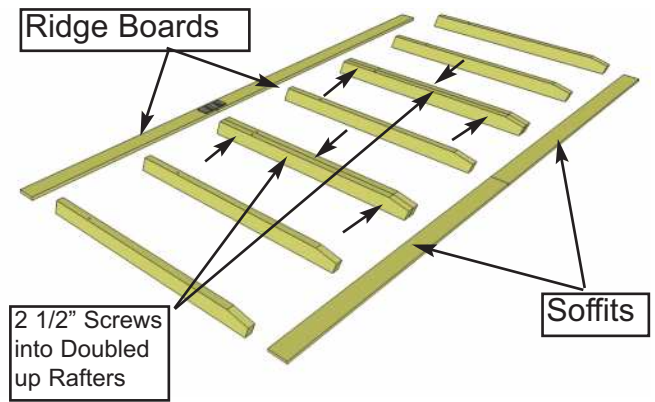

**42.** Attach completed Ridge Board to ends of both outside rafters with 2 - 2" screws per end. Measure and position interior Rafters as illustrated below. When positioned correctly, attach Ridge Board to remaining rafters with 2 - 2" screws /rafter end.

**Important:** Use one piece of Polygal to slide in between rafters to check that it fits between each pair of Rafters.

**Important:** Pilot Hole Ridge Board and Soffit to prevent splitting!

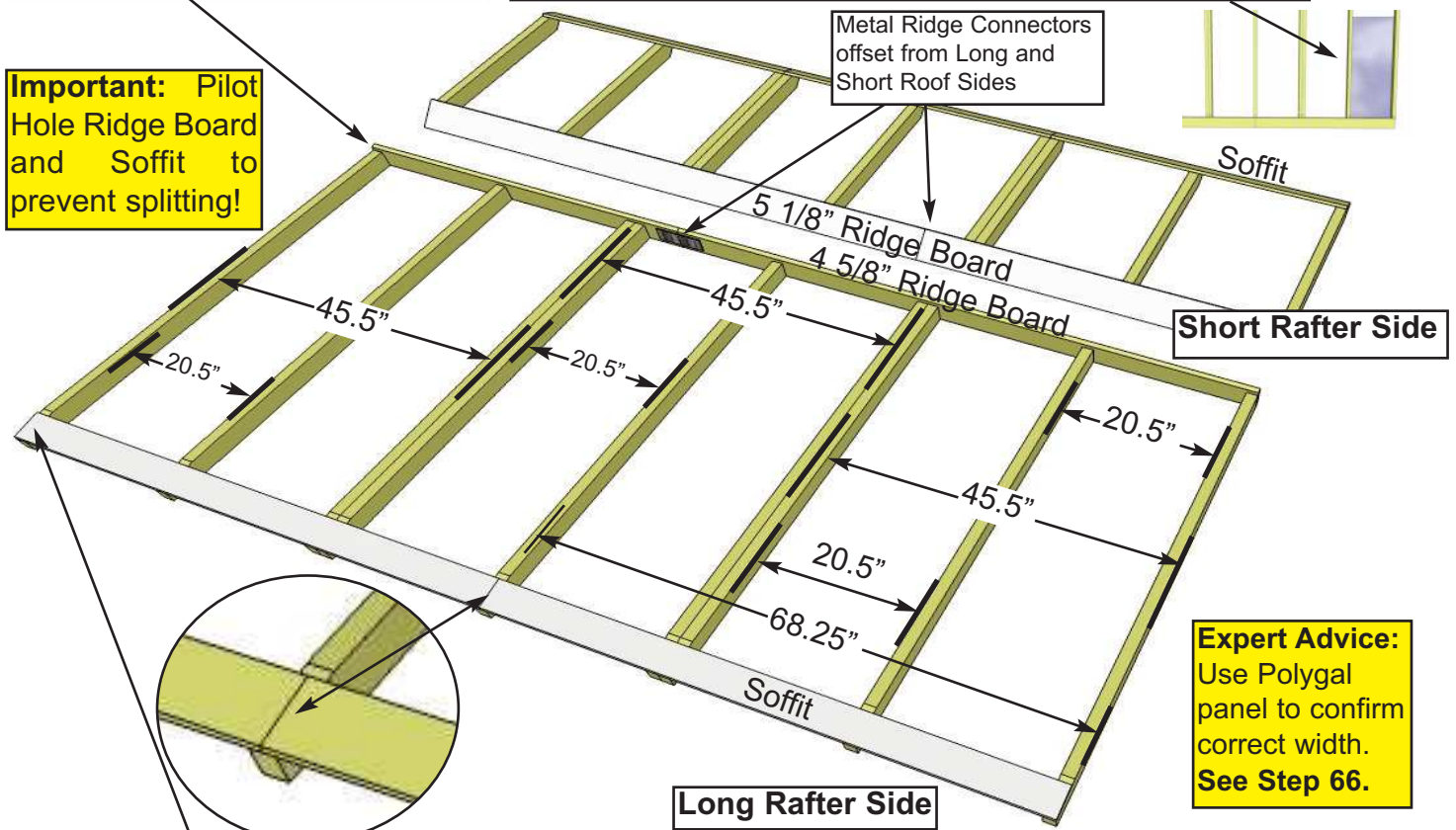

**Expert Advice:** Use Polygal panel to confirm correct width. See Step 66.

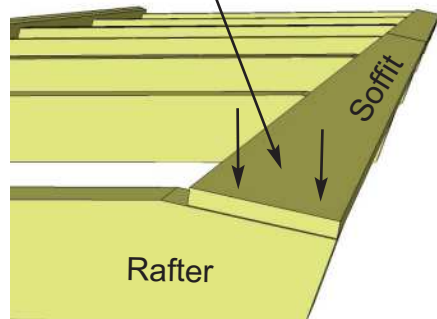

**43.** Attach end of a 68 1/4" long Soffit Board flush to ends of outside rafters with 2 - 1 1/4" screws per rafter end. **Drill pilot hole in Soffit ends to prevent splitting.** Complete both outside rafter / Soffit connections first. Measure and position interior Rafters as illustrated above. When positioned correctly, attach Soffits to remaining rafters with 2 - 1 1/4" screws /rafter. Flip completed rafter section over. Complete Short Rafter Side as per **Steps 41 - 43** with the following exception: **When attaching Ridge Board to Rafter ends, make sure Metal Ridge Board Connector is positioned so offset to first Rafter Section. See Step 48 for illustration.**

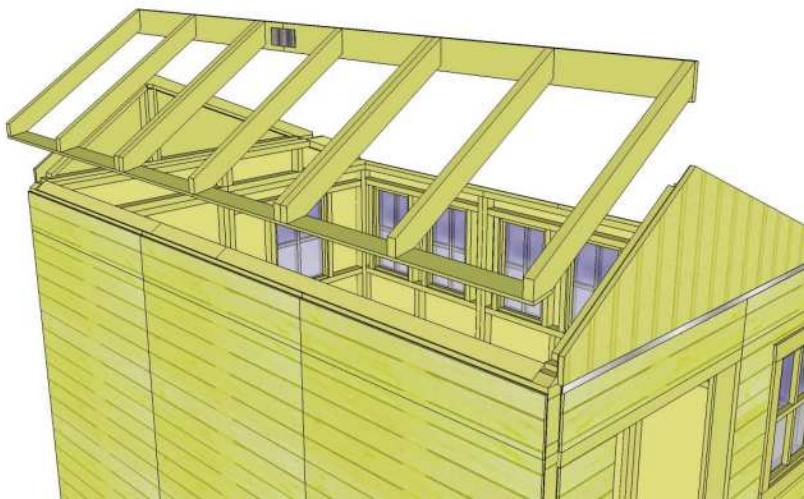

Slide Bottom of Ridge Board into notch of gable.

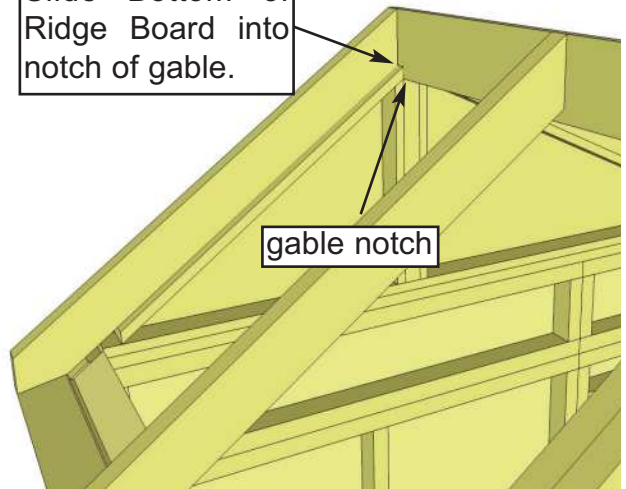

gable notch

**44.** Starting with the Short Rafter Side, lift and flip completed section over so Soffit is facing down. Slide rafter up on gable framing until bottom of Ridge Board slips into gable notch. Position rafters so they sit evenly on Gable framing from side to side.

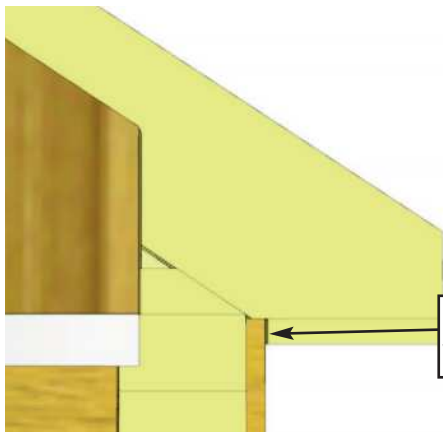

**Important:** make sure Metal Ridge Board Connectors on Long Roof Side and Short Roof side are offset. **See Step 48.**

Slight gap between wall and soffit.

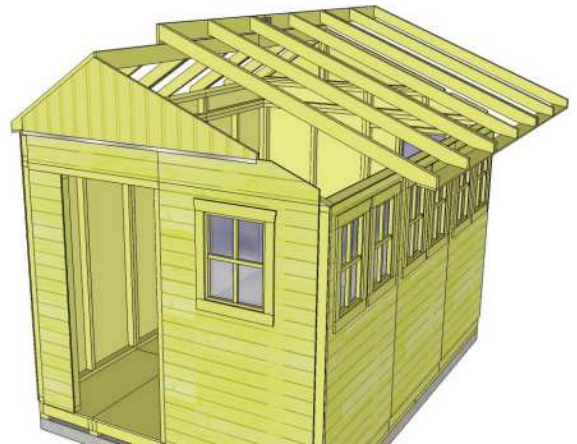

**45.** Where Wall and Soffit meet, a small gap may appear. Confirm all Rafters are resting on Top Plate.

**46.** Lift and flip Long Rafter Side up and place on Gable framing. **Make sure Metal Ridge Board Connectors of both Roof Sections are offset. See Step 48.**

Bottom of Ridge Board fits in gable notch. Top of Ridge Board will sit 1/2" lower than short rafter side ridge board.

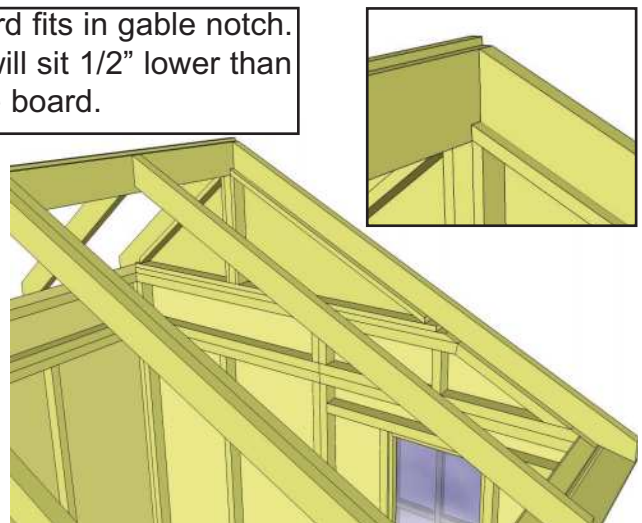
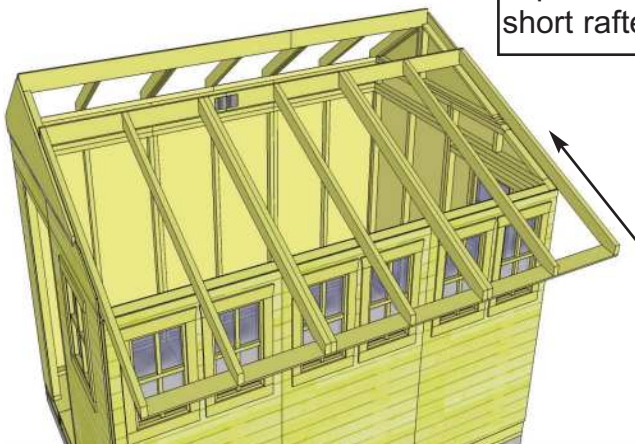

**47.** Slide Long Rafter Side on Gable framing so bottom of ridge board slips into Gable notch. Soffit will sit approximately 1/8" away from wall as per **Step 45.**

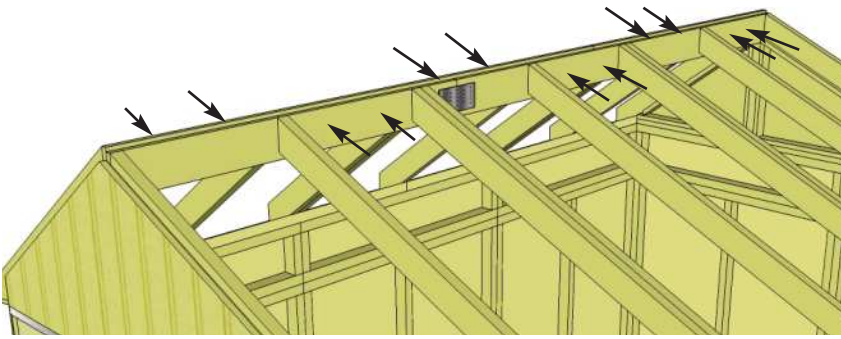

Offsetting Metal Ridge Board Connectors.

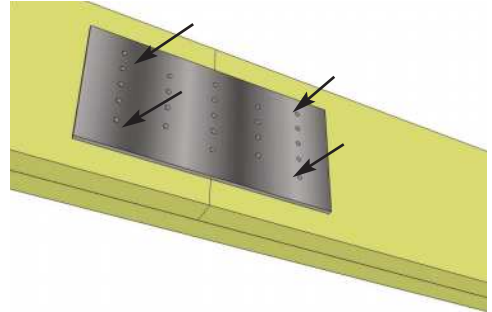
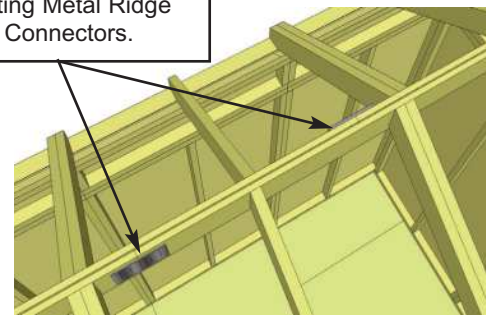

**48.** Where Ridge Boards meet, press together and secure with 12 - 1 1/4" screws. In addition, place 4 - 1 1/4" screws into any of the remaining Metal Ridge Board Connectors holes. Complete both sides.

**Important:** If Gable framing does not line up with Rafters, remove temporary 2" screws from gable framing (Step 39), re-align gable and proceed to step 49.

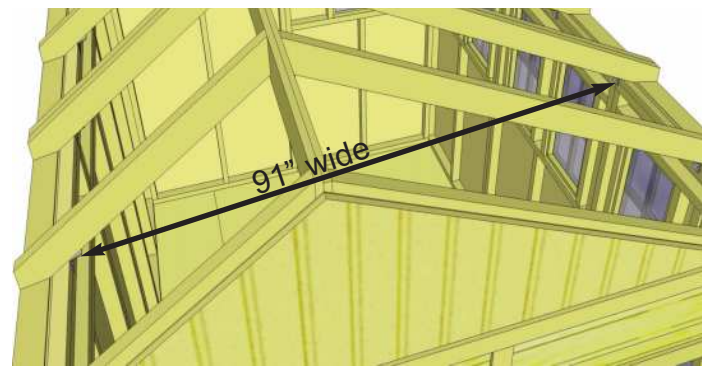
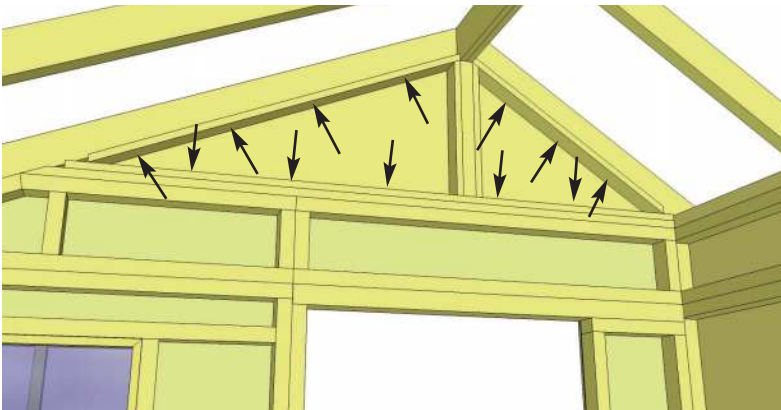

**49.** When aligned, secure Gable framing to rafters with 7 - 2" screws. Further secure to top plate with an additional 5 - 2" screws (7 in total). Secure other Gable.

**50.** Prior to securing the Long Rafter Side, make sure walls are aligned correctly. Have two helpers push on both side walls at the top from the outside until side top plates are 91" apart from the **inside**.

Rafter Brackets are bent to 22° and 33°. Use correct bracket for each side.

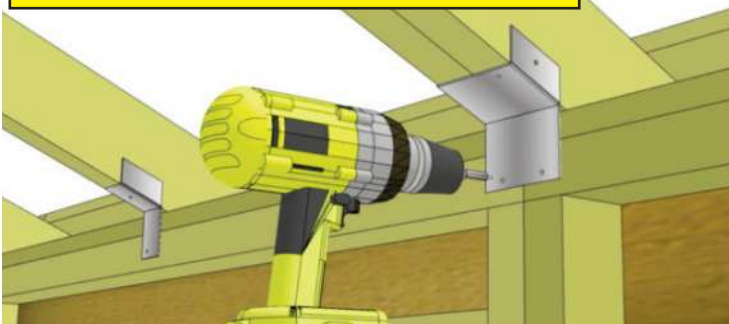

Leave a 1" gap from top of rafter

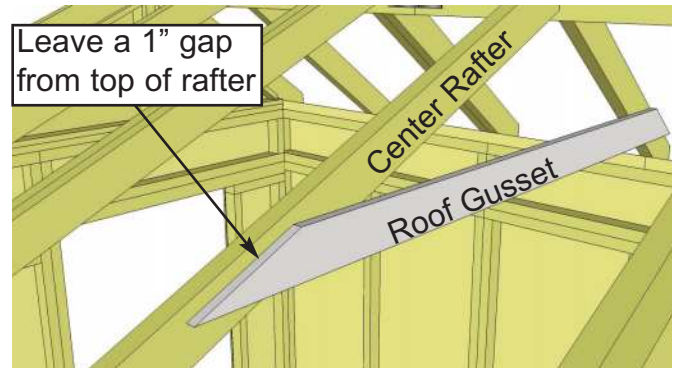

**51.** Attach all **Single** and **Double Rafter Brackets** where rafters meet Top Wall Plates inside of shed. Attach with 2 - 1 1/4" screws and 2 - 2" screws per Single Rafter Bracket and 6 - 2" screws per Double Rafter Bracket. Position a Roof Gusset on the Center Rafter. Leave a 1" gap from the top side of the rafter.

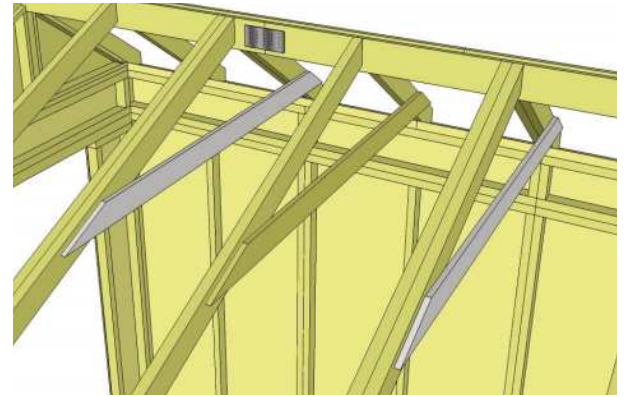

**52.** With Gusset correctly positioned, attach to Rafter with 4 - 2" screws per side. Use a level to check for square. Pilot hole end of Gussets to prevent splitting. Complete installation of remaining Gussets.

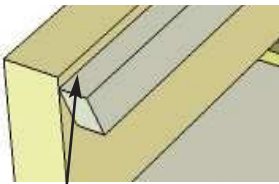

1/4" gap

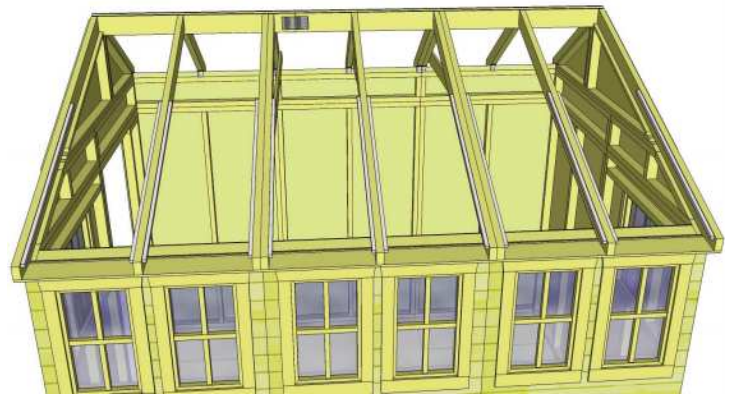
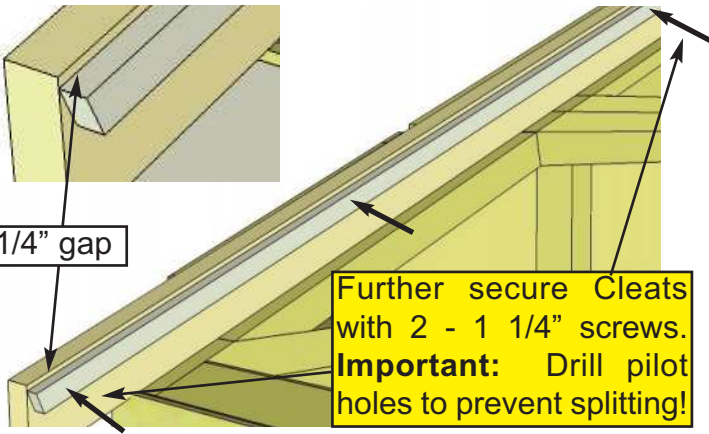

**53.** Position 3/4" x 3/4" x 44 1/2" long **Polygal Support Cleats** on each Long Rafter flush to end and recessed 1/4" down from top of rafter. Pilot hole 1/8" in both ends and center, then attach with 3 - 1 1/4" screws. Nail also to rafter using 4 - finishing nails. **Note:** Start nails in Supports on ground first. Complete remaining 11 Polygal Support Cleats.



# D. Roof Section

Exploded view of all parts necessary to complete Roof Section. Polygal panels shown later. Identify all parts prior to starting.

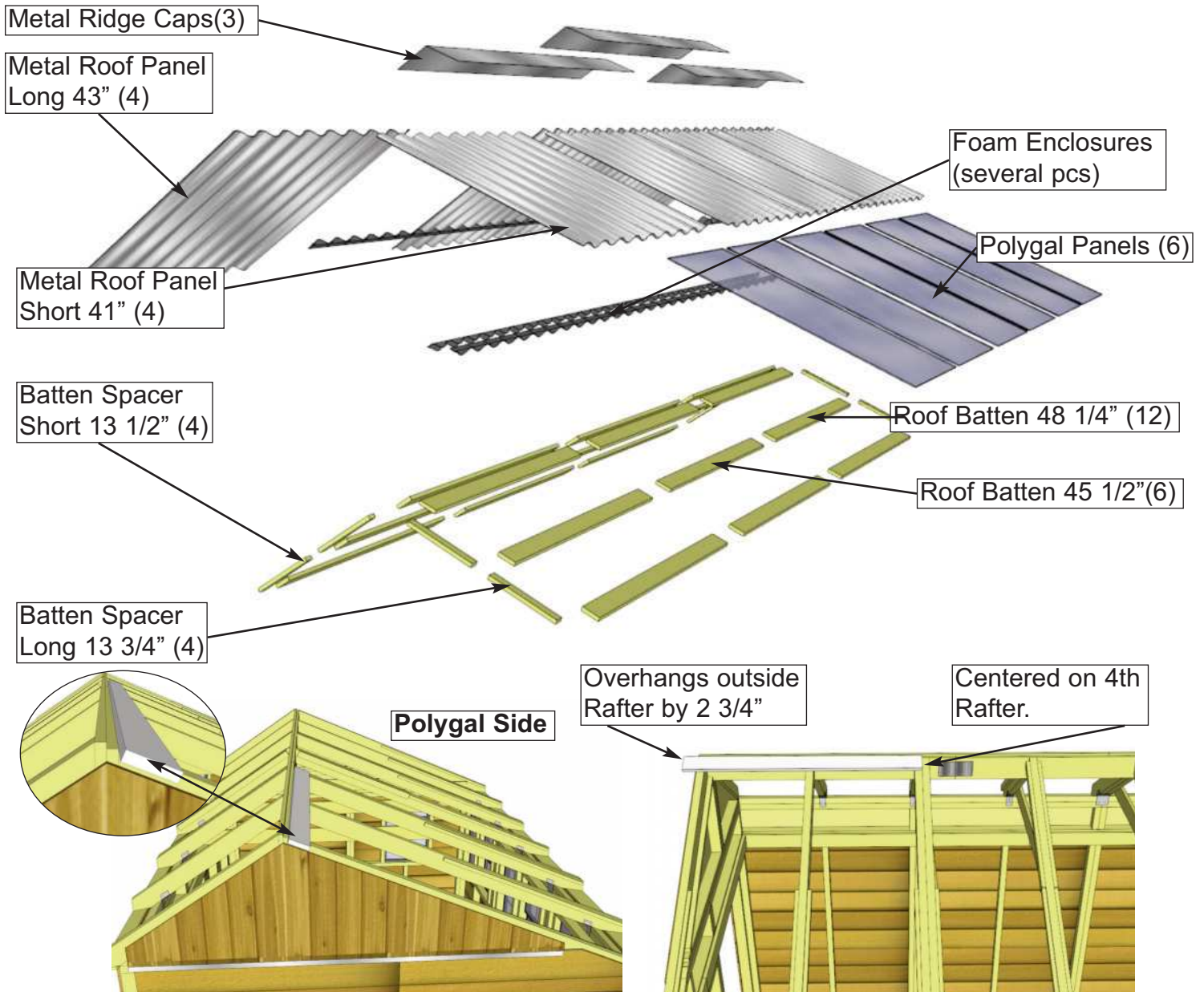

**55.** Starting on the polygal side locate an **Outside Roof Batten (48 1/4" Long)** and place on roof rafters. Place at top of Rafter section where Rafter and Ridge Boards meet. Batten should be positioned evenly on 3rd rafter. Batten will overhang outside Rafter by 2 3/4".

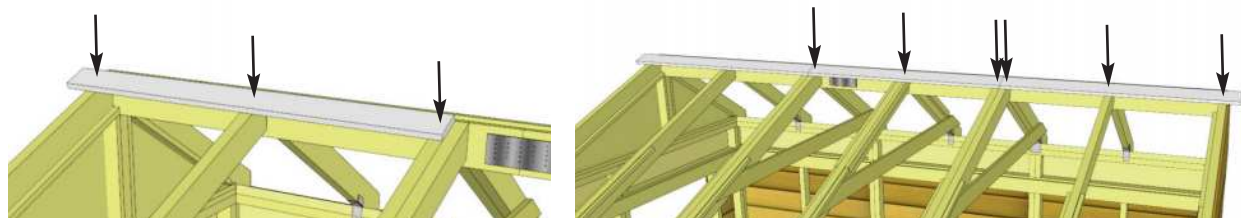

**56.** Attach **Batten** to Rafters with **3 - 1 1/4" screws** per Rafter section. **Important:** pre-drill pilot holes with 1/8" drill bit first to prevent splitting. Place **Middle Roof Batten (45 1/2" Long)** next to the first as per **Step 55** and attach with **3 - 1 1/4" screws**. Place **Outside Roof Batten (48 1/4" Long)** next to this middle batten as per **Step 55** and attach with **3 - 1 1/4" screws**.

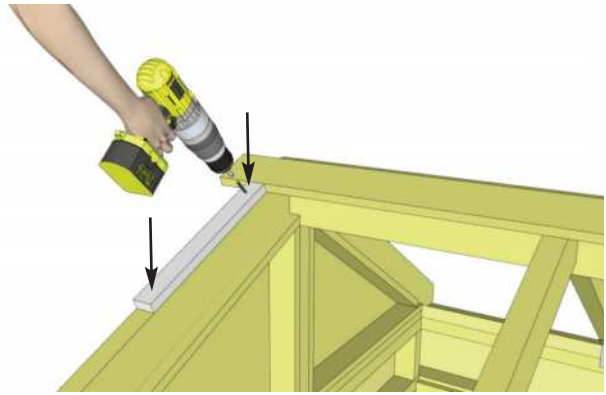
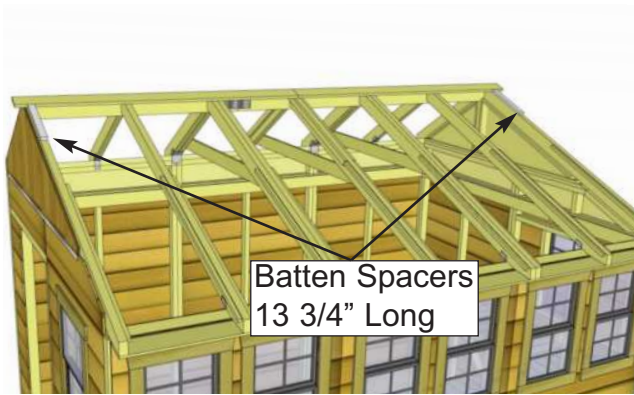

**57.** Locate **Batten Spacers Long (3/4" x 1 1/2" x 13 3/4")**. Place 1 spacer below each Batten lengthwise along outside Rafter. Attach each Spacer to Outside Rafter with **2 - 1 1/4" screws** per spacer (4 total).

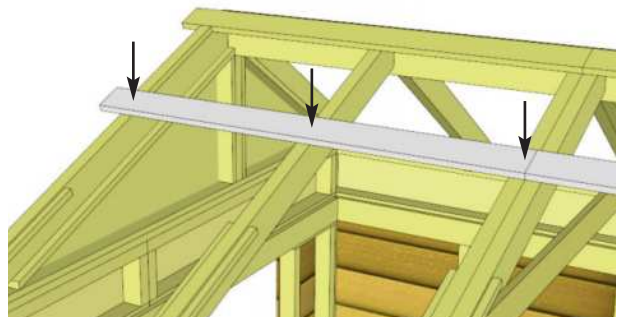
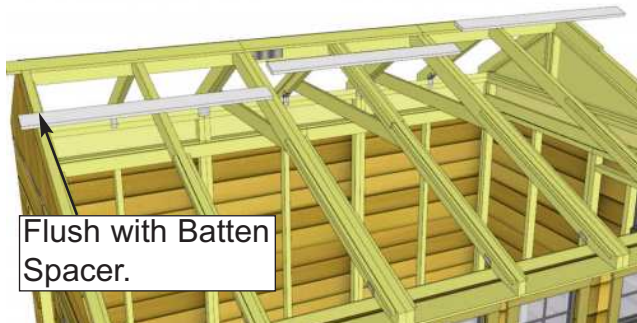

**58.** Locate 2 **Outside Roof Battens (3/4" x 3 1/2" x 48 1/4")** and 1 **Middle Roof Batten (3/4" x 3 1/2" x 45 1/2")**. Position and attach 2nd row of Battens 13 3/4" from first row of Battens flush against Batten Spacer. Outside Battens overhang Outside Rafter by 2 3/4" as per **Step 55**. Attach each Batten with **3 - 1 1/4" screws** (9 total for the row).

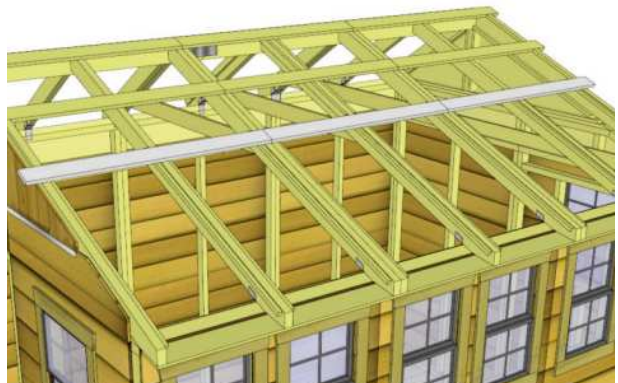
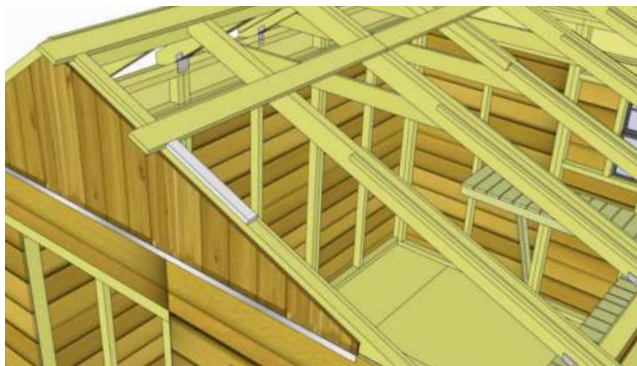

**59.** Locate 2 more 13 3/4" **Long Batten Spacers** and attach below 2nd row of Battens as per **Step 57** with **2 - 1 1/4" screws** per spacer (4 total). Then locate 2 more **Outside Roof Battens** and 1 more **Middle Roof Batten** and attach as per **Step 58** with **3 - 1 1/4" screws** per Batten (9 total).

**Short Roof Side**

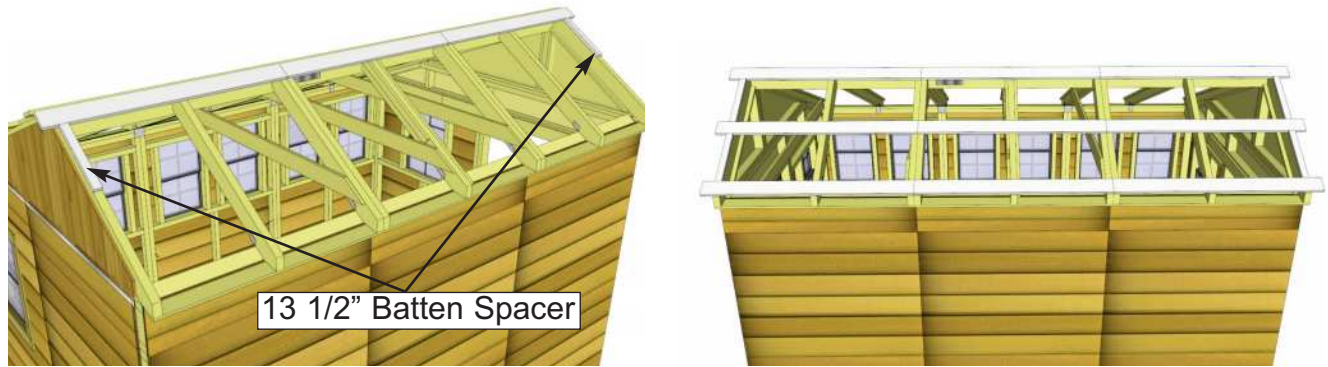

**60.** Position first row of **Outside Roof Battens** (3/4" x 3 1/2" x 48 1/4") and **Middle Roof Battens** (3/4" x 3 1/2" x 45 1/2") on short roof side and attach as per **Steps 55-56**. Attach **Batten Spacer Short** (3/4" x 1 1/2" x 13 1/2") below first row of Battens. Continue attaching Spacers and Battens as per **Steps 57 - 59** until you complete all 3 rows.

**Important:** Do not fasten down Roof Panels with Hangers still in place. Metal Roof Hangers will temporarily help keep Metal Roof Panels in place before they are fastened.

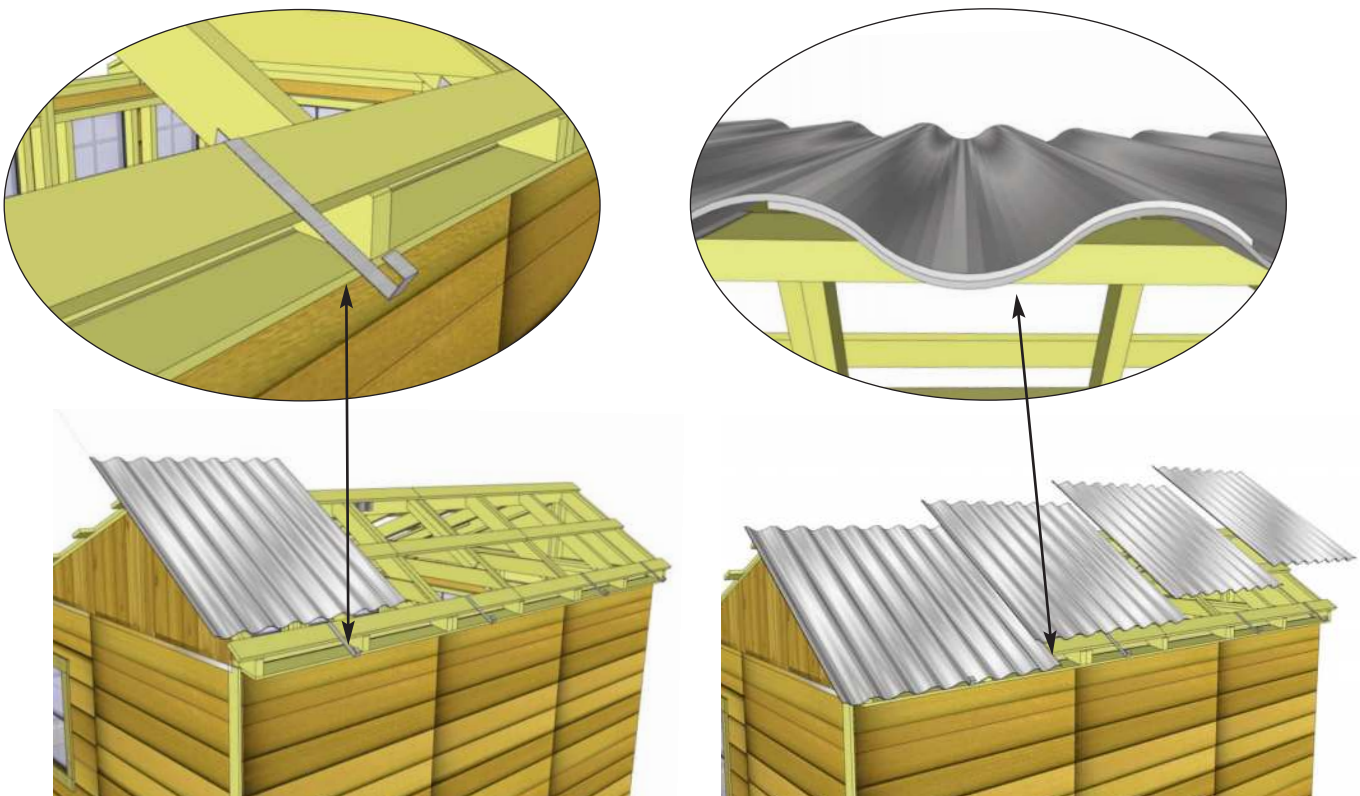

**61.** Starting on the short roof side, locate **4 Long Metal Roof Panels** (39" wide x 43" long) and **4 Metal Roof hangers**. To temporarily hold the Metal Roof Panels in place, hook a Metal Roof Hanger onto the lowest Batten approximately where the center of the first panel will be. Place the first Metal Roof Panel on Battens and into Hanger. Do not fasten Panels down until **Step 66**. Place remaining 3 Panels and Hangers on the same way. Metal Roof Panels overlap each other.

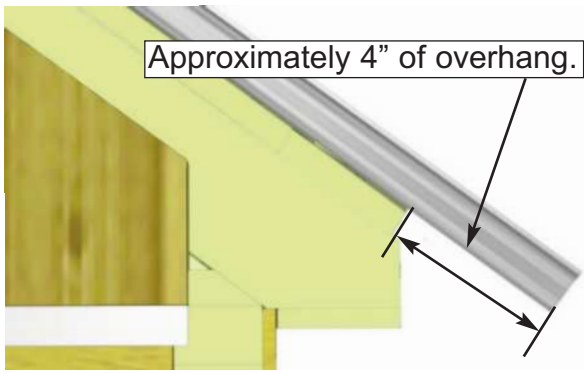

**62.** Overhang the **Metal Roof Panels** past the **Battens** on sides by approximately 1". Adjust panels side to side to achieve desired width. Overall width past the Battens can vary from 1"-3" depending on your preference. The overhang over the side of the shed will be set by the **Metal Roof Hangers**, but should be approximately 4" on the side of shed.

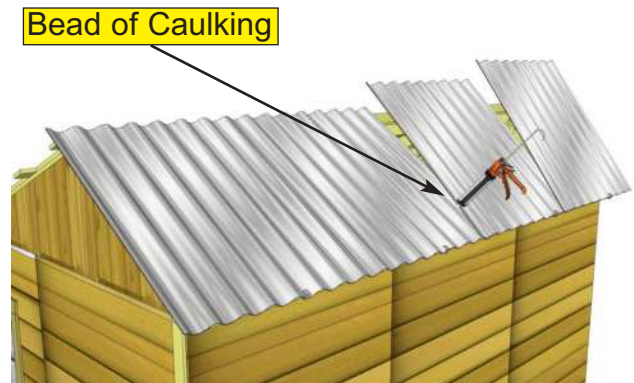

**63.** Once Metal Roof is spaced correctly from side-to-side and top-to-bottom, lift 3 panels up and run a bead of caulking down the overlapping seams of each panel to seal the joints. Place panels down one by one once seam is caulked. You will likely need assistance from a helper for this step. Caulk each seam.

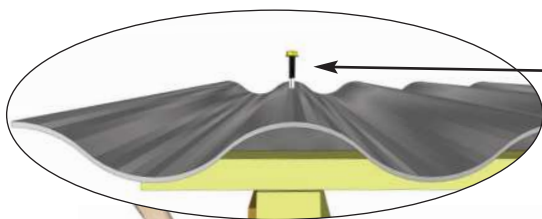

**Important:** When attaching metal roof panels, screw into peaks of roof panels and not valleys

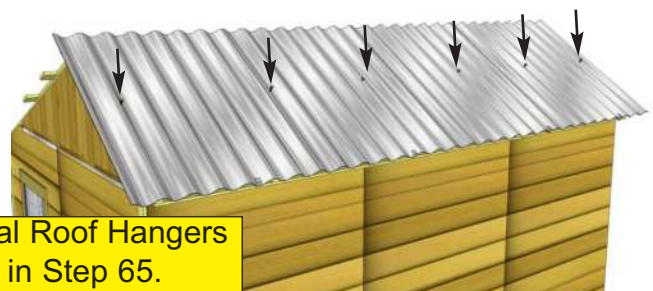

**Important:** Metal Roof Hangers will be removed in Step 65.

**64.** Using **6 - 2" Metal Screws** and 1/4" Nut Driver (included), partially secure Metal Roof Panels down to middle Batten row. Only fasten screws halfway so that Metal Roof Hangers can be removed. Metal screw is self-tapping, screw into center of Battens. Twelve more 2" Metal Screws will be required to further secure Metal Roof Panels and to complete Metal Ridge Caps in later steps once Metal Roof Hangers are removed.

**Important: Remove Metal Roof Hangers**

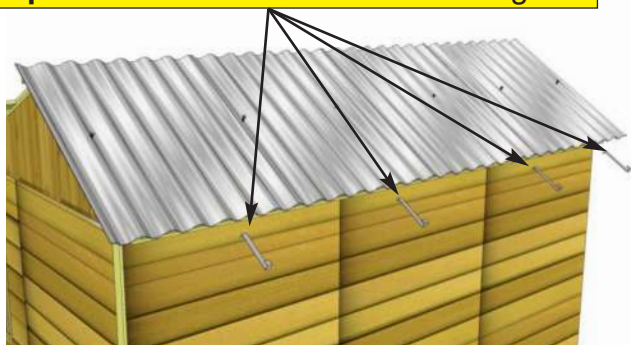

**65.** Before fully fastening **Metal Roof Panels** down, remove the **Metal Roof Hangers** and insert **Foam Enclosures** between **Metal Roof Panels** and **Battens** at the bottom of the roof. Enclosures will prevent moisture and unwanted bugs, etc from entering your shed through here.

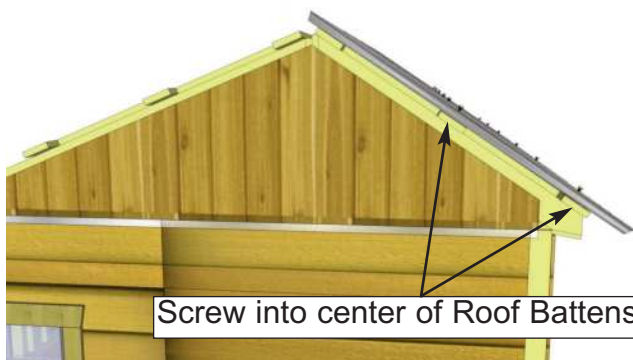
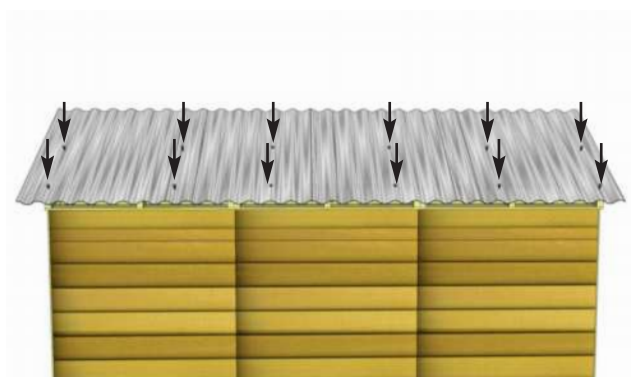

**66.** Using **6 - 2" Metal screws** and 1/4" Nut Driver, secure **Metal Roof Panels** down to remaining lowest row of Battens. Leave the top row unsecured for now to secure Ridge Cap in **Step 70**. Tighten screws in middle row that were partially attached in **Step 64**. Do not overtighten!

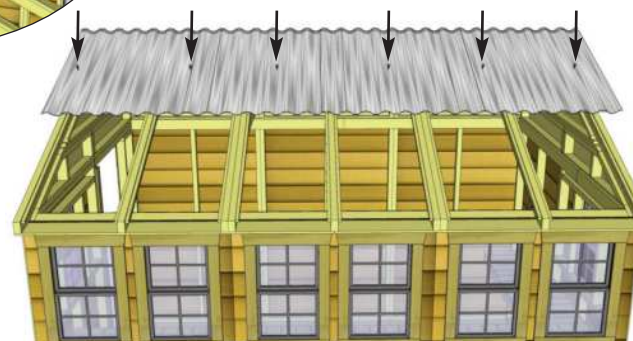
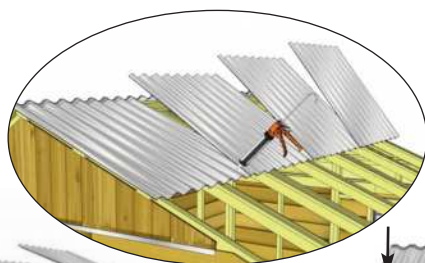

**67.** Move to polygal side of Roof and locate **Short Metal Roof Panels (39" wide x 41" long)**. Space panels apart as per **Step 62** to match opposite side. **Short Metal Roof Panels** will overhang lowest Batten by approximately 2 1/4". Caulk seams between panels before fastening. Attach Panels to Middle row of Battens with **6 - 2" Metal screws**. **Note:** Metal Hangers do not set length of short panel side. Use a helper to hold the short panels in place.

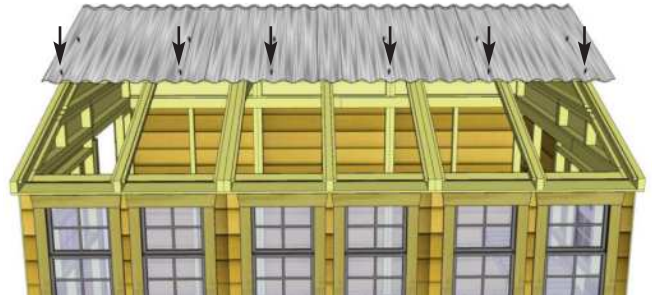
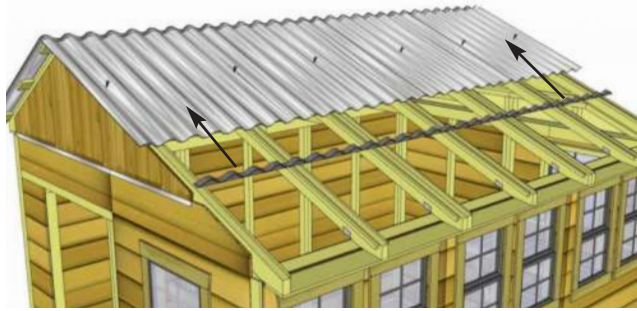

**68.** Locate **Foam Enclosures for Metal Roof**. Insert Foam Enclosures between lowest Batten and Metal Roof Panels. Attach Roof Panel to lowest batten with **6 - 2" Metal screws**.



**69.** Locate remaining **Foam Enclosures for Metal Roof and Metal Ridge Caps (60" long)**. Place Foam enclosures at the top of the roof panels. Foam Enclosures prevent moisture from coming in through the top of your shed. Place **3 - Metal Ridge Caps** onto apex of roof. Evenly space from front to back of shed. Caps will overlap each other. Overhang the cap approximately 1"-2" past each end.



**70.** When Ridge Cap is correctly positioned, secure with **12 - 2" metal screws (6 per side)**. Screw into final Batten. Do not overtighten!

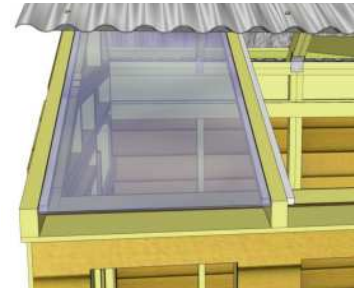
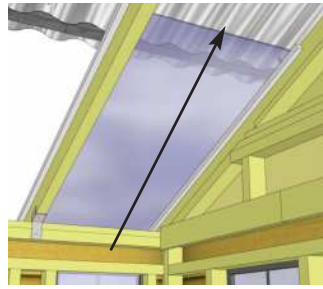
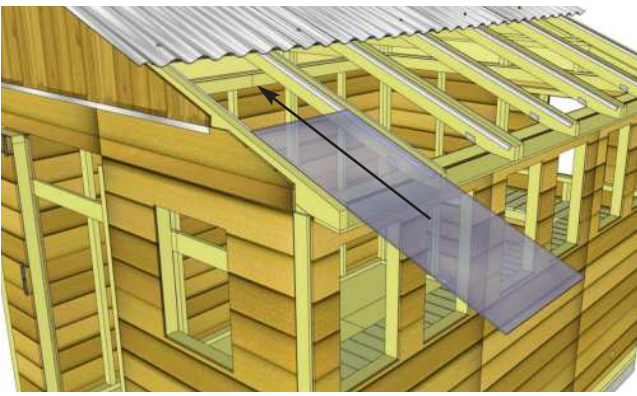

**71.** Installation of 6 **Polygal Panels** is next. Start by removing protective plastic layer from each panel. Exterior/interior side of protective polygal film is printed on film, be sure to note the side and install accordingly. Slide panel up between rafters so it rests on **Polygal Support Cleats**. From the inside, carefully slide end of **Polygal Panel** underneath roof. Position **Polygal Panel** equally between rafters and overhanging end of rafter by 1”.

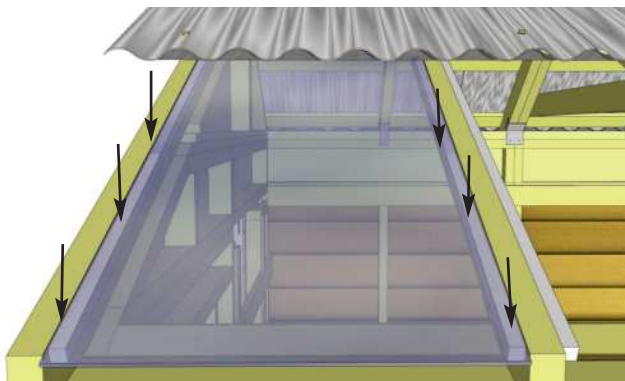

**72.** Drill pilot holes with 1/8” bit through **Polygal Panel** and **Polygal Support Cleat** once aligned. With 6 - 1” **screws**, secure panel to **Polygal Support Cleats**. Polygal is delicate, tighten screws a half turn at a time so screws are flush with top of **Polygal Panel**. Use 3 - 1” **screws** to secure **Polygal Panel** to underside of **Roof Batten**.

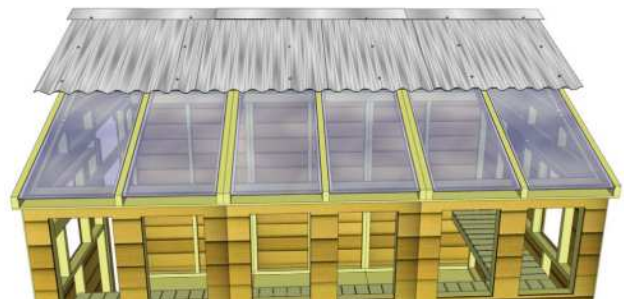

**73.** Position and secure remaining **Polygal Panels** as per **Steps 71 - 72**.

**74.** With a Caulking Gun, apply Silicon to seal gaps between **Rafters** and **Polygal Panels**. Apply Silicon down each side of **Rafter**. Use liberal amounts to properly seal. The Silicon will be covered by Polygal Ridge Caps in **Step 86**.

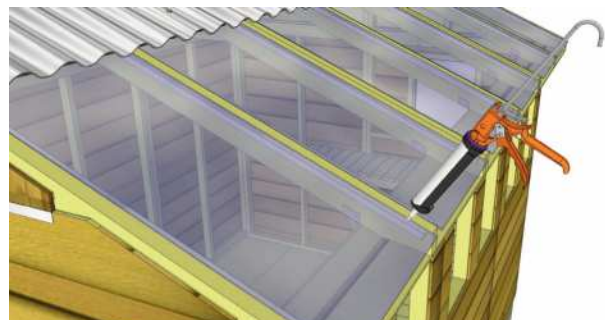

# E. Miscellaneous Section

Exploded view of all parts necessary to complete Trim Section. Identify all parts prior to starting.

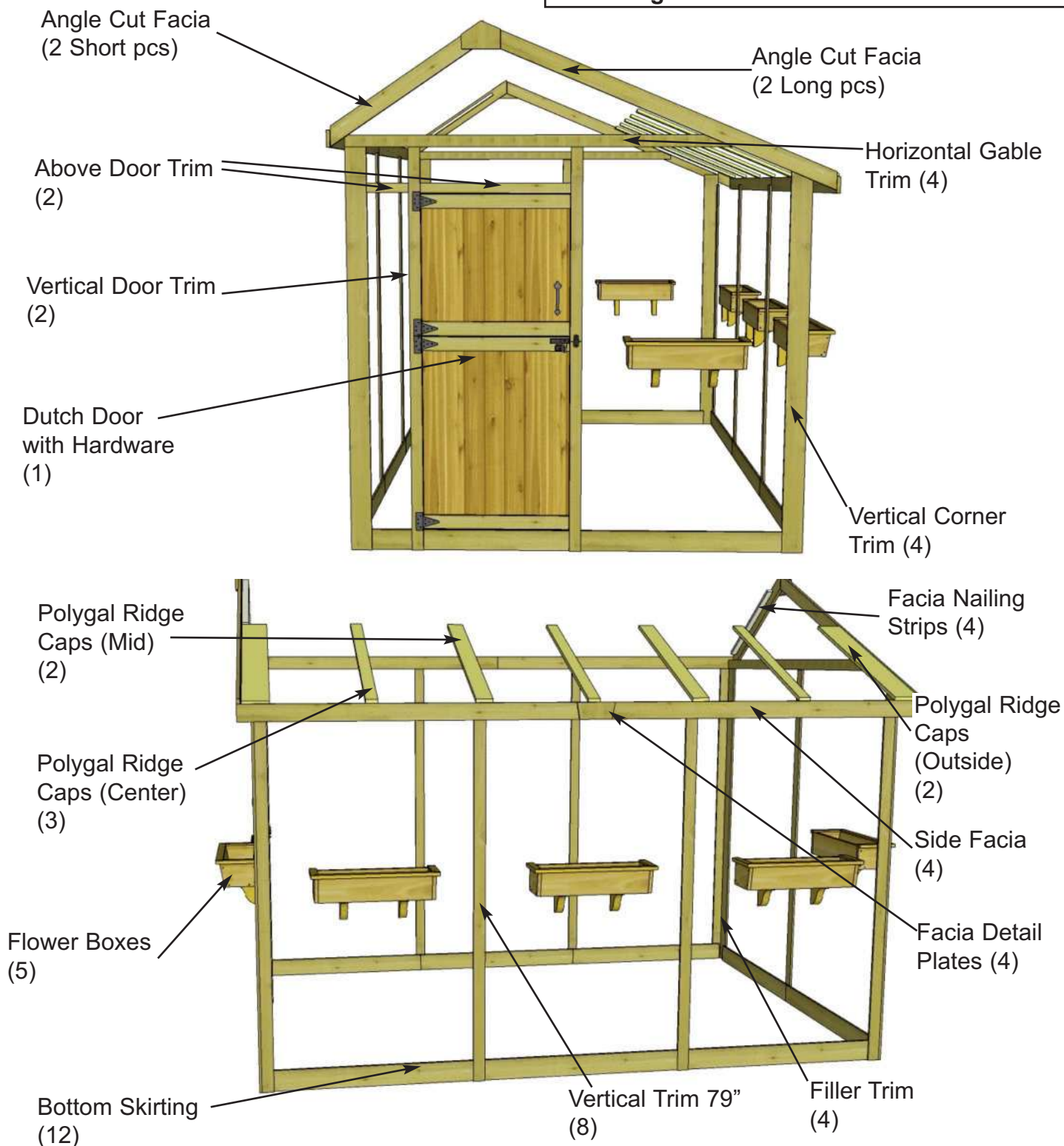

**Expert Advice:** When installing trim, sort pieces according to color and pieces that are most pleasing to the eye. Start with least visible side and use the least desirable pieces first. Install trim to most visible sides as your skill installing trim improves.



**75.** Attach **Bottom Skirting** (1/2" x 4 1/2" x 45 1/4") around the base of the shed. Skirting will hide floor framing. Gaps on outside of the front and rear walls will be covered by Wide Trim pieces later. Start with side pieces first and attach with 4 - 1 1/2" finishing nails per piece.

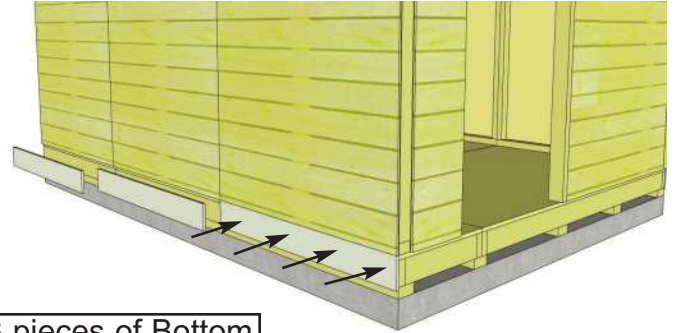

3 pieces of Bottom Skirting per side



Gap in corner

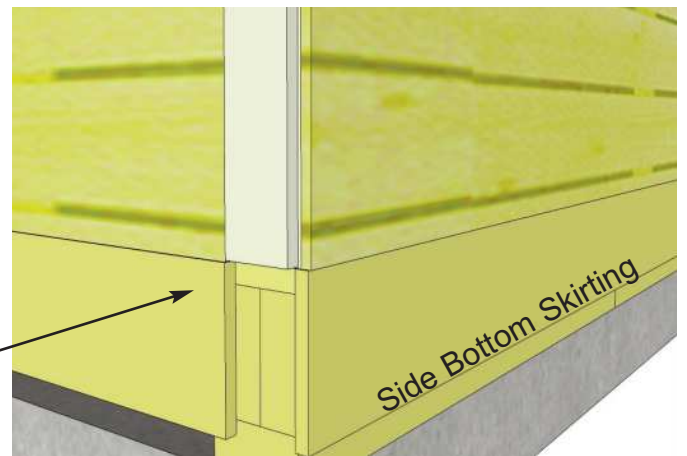

**76.** Attach **Filler Trim - Tall and Short** (2 @ 1/2" x 2 1/2" x 75" & 2 @ 84") to front and rear walls in each corner. Attach with 6 - 1 1/2" finishing nails. Strips are positioned flush with siding and bottom skirting.

**77.** Align and attach both **Narrow and Wide Trims** in each corner. Starting with a Narrow Trim (1/2" x 2 1/2" x (2 Short Wall @ 79") & (2 Tall Wall @ 88")), align tight underneath Soffit and Rafter. Position flush with Filler Trim so Wide Trim will cap it when attached in **Step 76**. Use 8 - 1 1/2" finishing nails to secure. Note that Narrow Trim will sit slightly below Bottom Skirting when correctly attached.

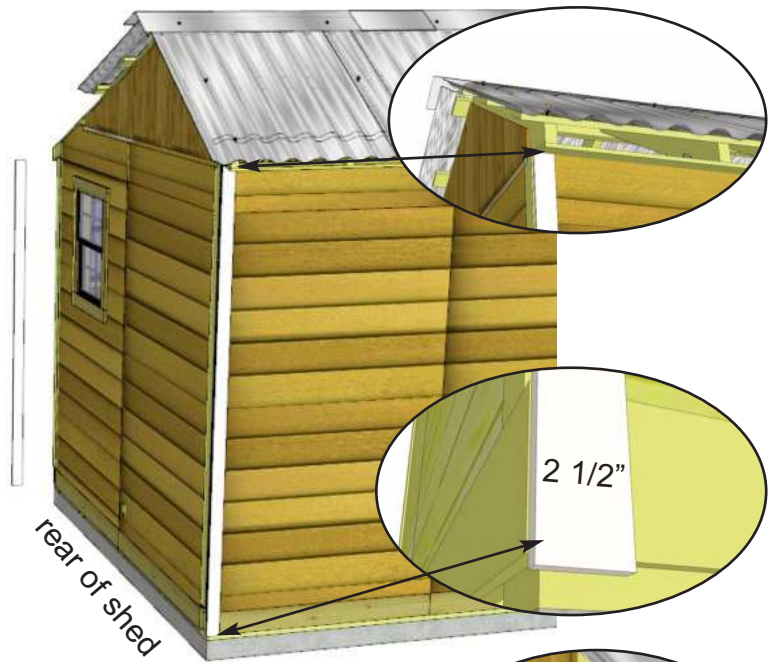
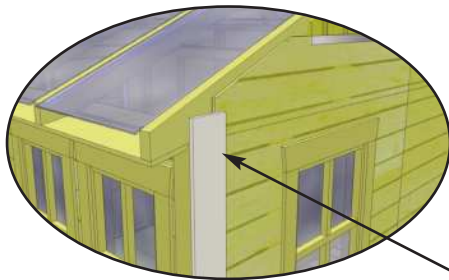

**78.** Position **Wide Trim** (1/2" x 4 1/2" x (2 Short Wall @ 82") & (2 Tall Wall @ 87")) over Filler Trim and to cap Narrow Trim. Align Wide Trim at bottom with Narrow Trim so flush with each other. Secure trim with 8 - 1 1/2" finishing nails. Complete remaining corner trims.

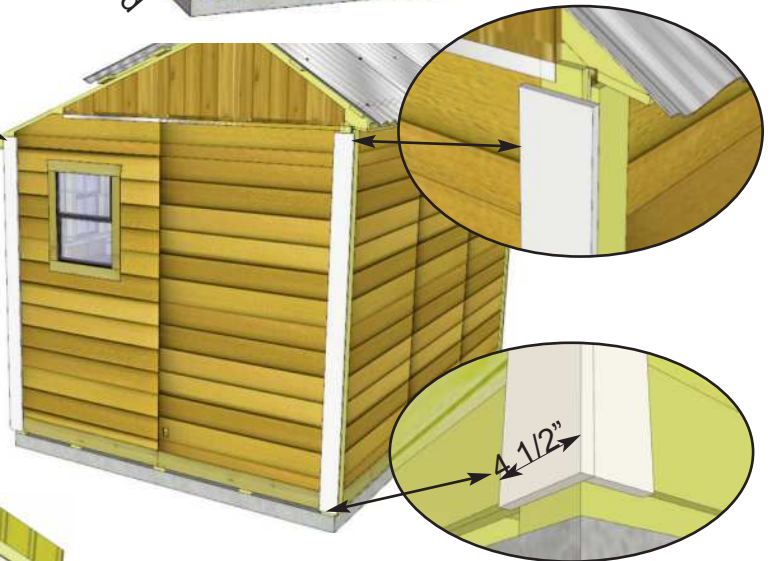

**Note:** Triangular Gable Trim is located inside gable corner behind scrap piece marked with "X"

Triangular Gable Trim

Same vertical height as Wide Corner Trim.

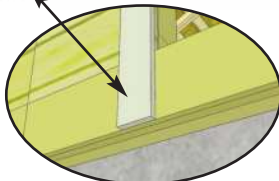

**79.** Position **2 Door Trims** (2 @ 1/2" x 2 1/2" x 87") on each side of door opening. Right side will sit flush with Door Jamb. Left side will sit flush on edge of Narrow wall. Attach with 8 - 1 1/2" finishing nails. Do a dry run with the **Horizontal Gable Trim** (Step 95 & 96) to confirm vertical location of Trims. Next, position **Triangular Gable Trim** over exposed cavity of Gable Wall on Long Roof Side. Use 2 finishing nails to secure into rafter. Complete for both front and rear Gables.

**Important** - Gable Trim will be found stapled in the corners on inside of gables.



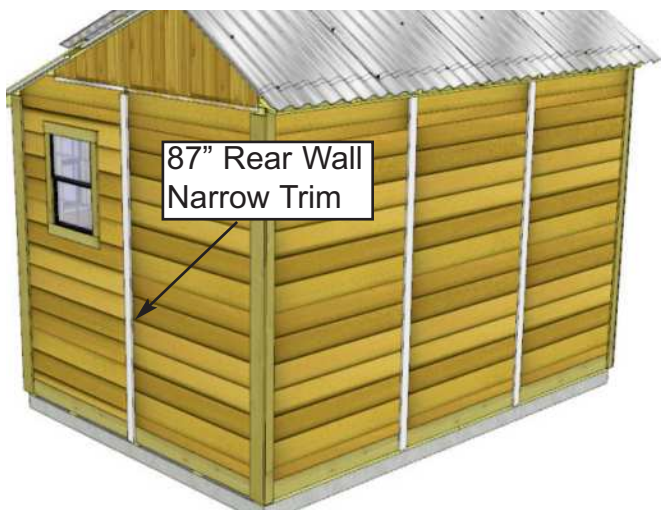

**80.** Attach remaining **Narrow Wall Trims** where wall panels come together and leave a seam.  
**Note:** the Narrow Trim is 79" long on the Short Wall Side, 88" long on the Tall Wall Side, and 87" on the Rear Wall. Align Side Trims tight underneath Soffit and Rafter. Attach with 8 - 1 1/2" finishing nails per piece. Align and attach Rear Trim as per Door Trims in **Step 79**.

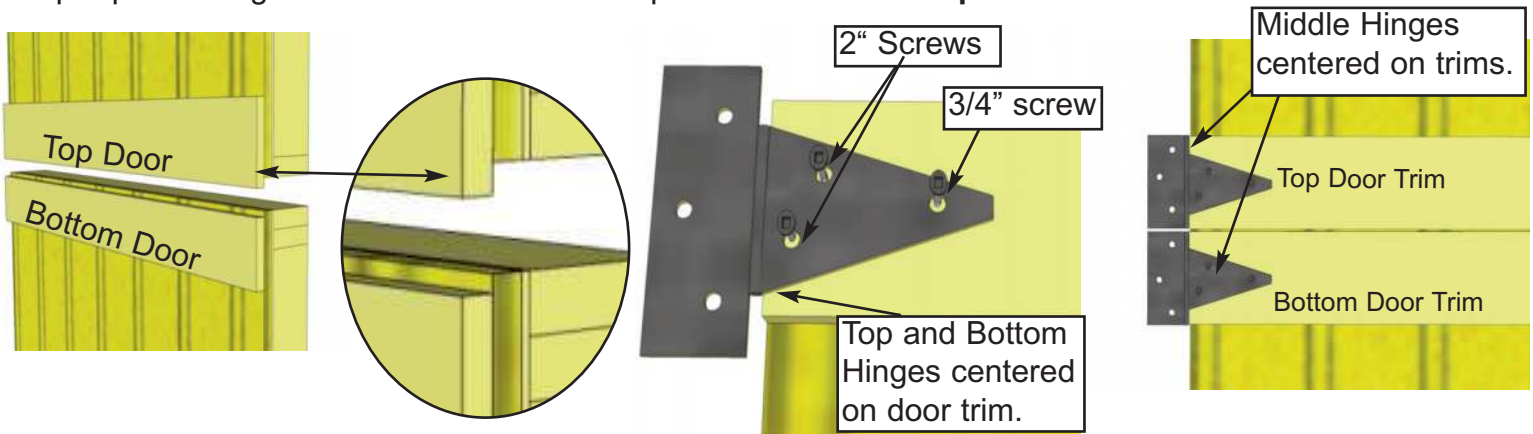

**81.** Attach Door Hinges to **Top** and **Bottom Dutch Door** sections. Top Door has trim overhanging door at bottom while bottom door has trim recessed slightly. Hinges should be centered on door trim with barrel nudged to end of trim. Use 2" & 3/4" black headed screws as shown above.

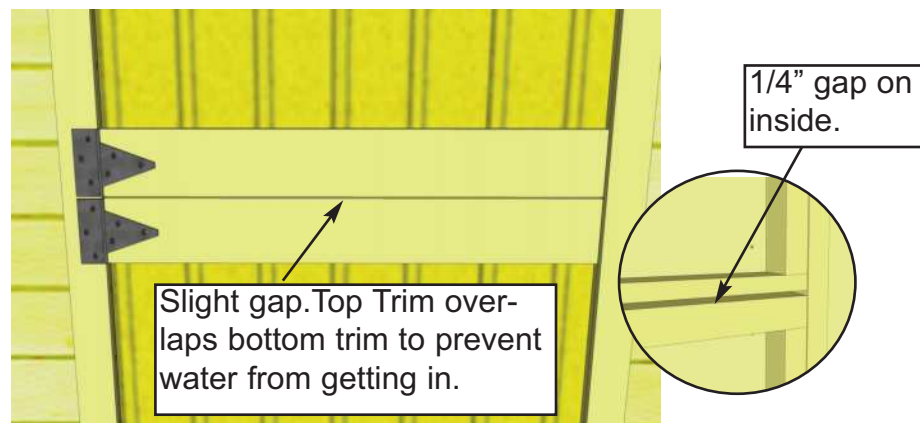
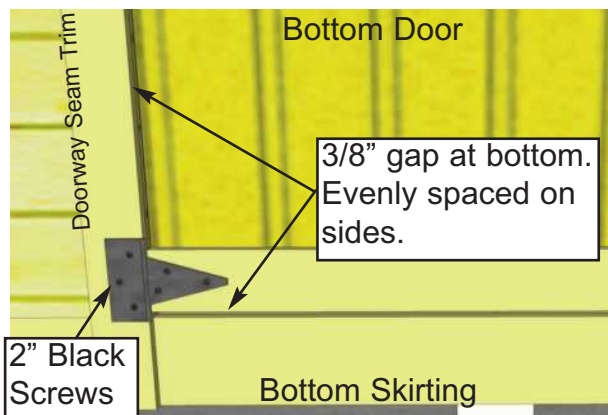

**82.** Place Bottom Dutch Door panel into position. Gap 3/8" on bottom, evenly space on sides, and attach hinge to doorway seam trim with 2" black headed screws. Use shim to help keep the door evenly spaced on bottom. One of the extra roof shingles (see parts list) can be used.

**83.** Place the Top Dutch Door Panel into place and gap top and bottom trims on the outside about 1/8" apart. On the inside, horizontal door frames should be about 1/4" apart. Use a shim once again to help you. Attach hinges to trim with 2" black headed screws provided.

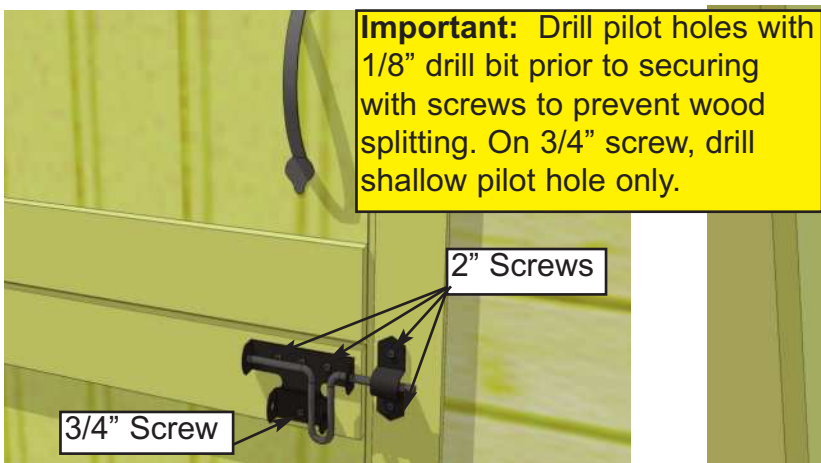

**84.** Attach **Door Handle and Exterior Black Drop Latch** to door. Handle is positioned on top door, Drop Latch on bottom door. Attach Black Drop Latch as illustrated above with 2" & 3/4" Black Screws. Note how female part of Drop Latch is positioned higher than male. Do a dry run first to position Drop Latch correctly.

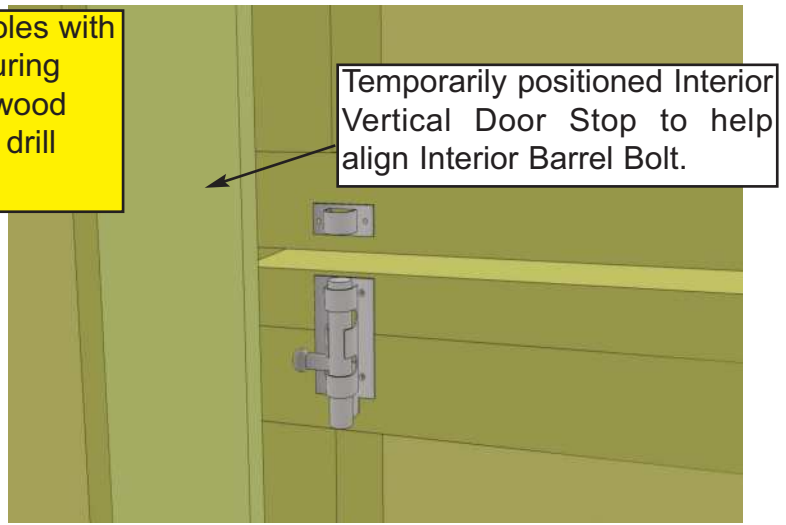

**85.** Attach **Interior Silver Barrel Bolt** to inside of door as illustrated above. Use 3/4" silver screws to secure. Refer to **Step 99** to allow for adequate clearance.

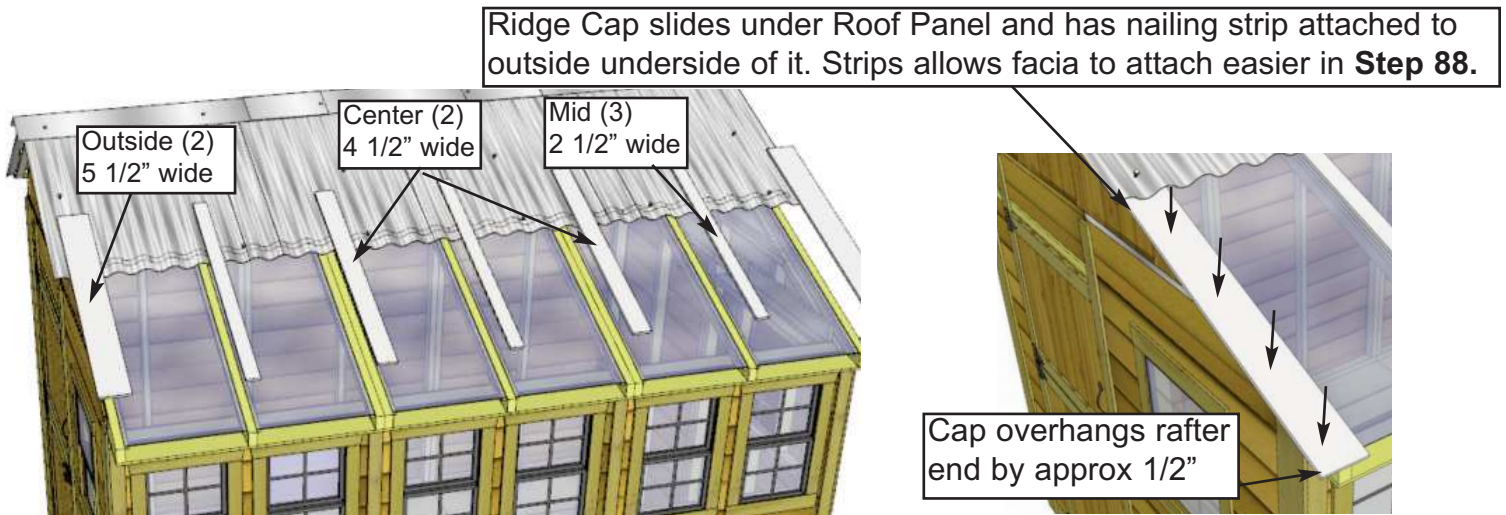

**86.** Locate all **Ridge Caps** for Polygal Panels (3 Mid / 2 Outside / 2 Center). Starting from the outside, position both 5 1/2" wide caps so outside edge is aligned with edge of metal roof and Cap end slides under roof. Use a straight edge to aid in alignment. **See below.** When correctly aligned, attach Caps to center of outside rafter with 6 - 1 1/2" finishing nails. Ridge Cap has nailing strip attached.

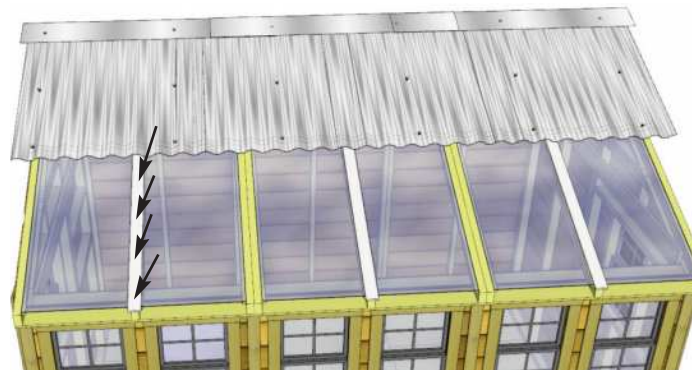
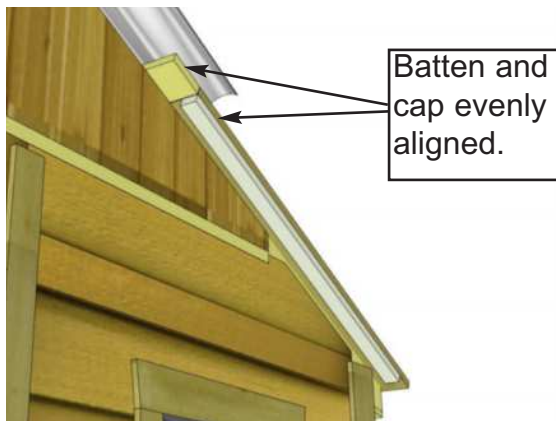

**87.** Position and attach Mid Ridge Caps evenly spaced on mid rafters. Align top to bottom as per **Step 86**.



**88.** Align and attach remaining Ridge Caps (4 1/2" wide) over Double Rafters as per **Steps 86 & 87.**



**89.** Attach **Facia Nailing Strips** (3/4" x 1 1/2" x 34") to the underside of **Battens** using 3- 1 1/4" screws per piece. Do all outside roof panels. Starting with the **Short Roof** side, attach **Front and Rear Facia** (3/4" x 3 1/2" x 38 1/4" angle cut on ends) to ends of battens with 5 - 1 1/2" finishing nails per side. Facia end lines up with rafter ends. Do a dry run with side facia in Step 87 before attaching.

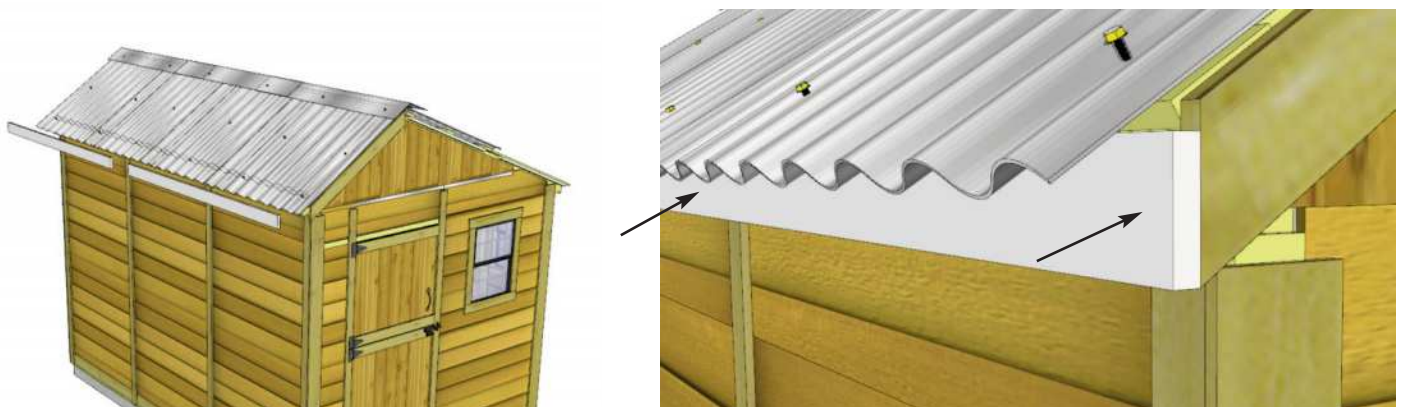

**90.** Attach **Side Facia** (3/4" x 3 1/2" x 72") to roof rafter ends. There are 2 pieces per side. Secure with 8 - 1 1/2" finishing nails per piece. Side Facia will sandwich Front and Rear Facia. Do a dry run with Front, Rear and Side Facia to confirm correct positioning prior to attaching.

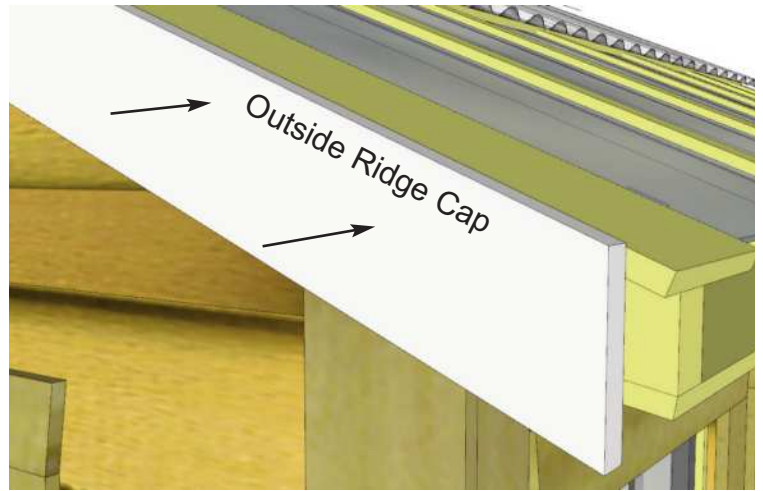

**91.** Attach **Long Front and Rear Facia** ( $3/4" \times 3 1/2" \times 78 3/4"$ ) to battens and Outside Ridge Cap edge with 10 -  $1 1/2"$  finishing nails and 2 -  $1 1/2"$  screws. Use screws where Outside Ridge Cap and Facia meet. Once again, Line Facia up so it is aligned with rafter ends. Do a dry run with Front, Rear and Side Facia to confirm correct positioning prior to attaching.

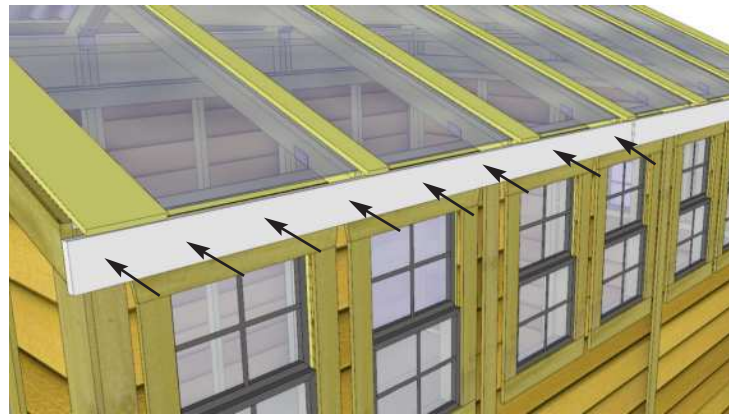

**92.** Attach remaining **Side Facia** to roof rafter ends as per **Step 91**.



**93.** Attach **Facia/Trim Detail Plates and Pentagon Plates** to cover seams where Facia Trim pieces come together. Secure each with 4 -  $1 1/2"$  finishing nails.



**94.** Attach both the **Horizontal Door Trim** (1/2" x 2 1/2" x 32") and **Horizontal Narrow Wall Trim** (1/2" x 2 1/2" x 8 3/4") with 4 and 2 finishing nails.



**95.** Locate **Horizontal Gable Trim** (1/2" x 4 1/2" x 85 1/2") for both front and rear of shed.



**96.** Position Horizontal Gable Trim so flush with outside edge of Wide Trim and top of Vertical Door Trim. Use 8 - 1 1/2" finishing nails per piece to secure. Complete both sides.



**97.** Assemble **Flower Box Kit** with Assembly Instructions included on Page 41. Position completed Flower Box below bottom of window trim and secure with 2 - 2 1/2" screws. Screw from inside of box into the center wall stud. Attach second screw 2" underneath first screw and once again into the wall stud. Install Flower Box Kits underneath each window.

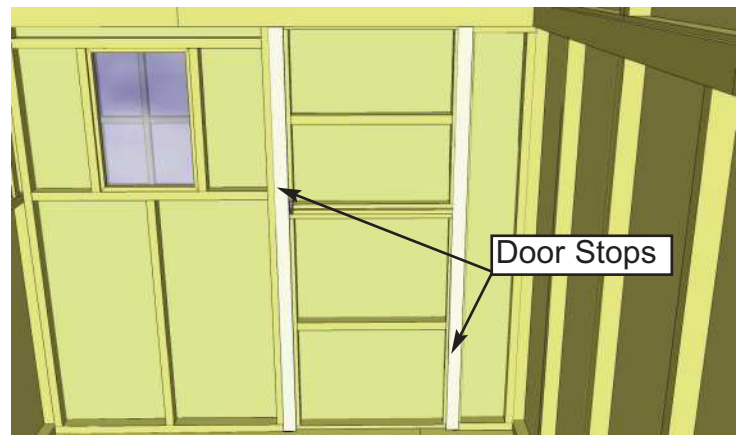

**98.** Attach Interior **Vertical Door Stops** (1/2" x 2 1/2" x 72") to door framing from inside of shed. Use 4 - 2" screws to secure each Stop. Stops should overlap door by approximately 1/2".

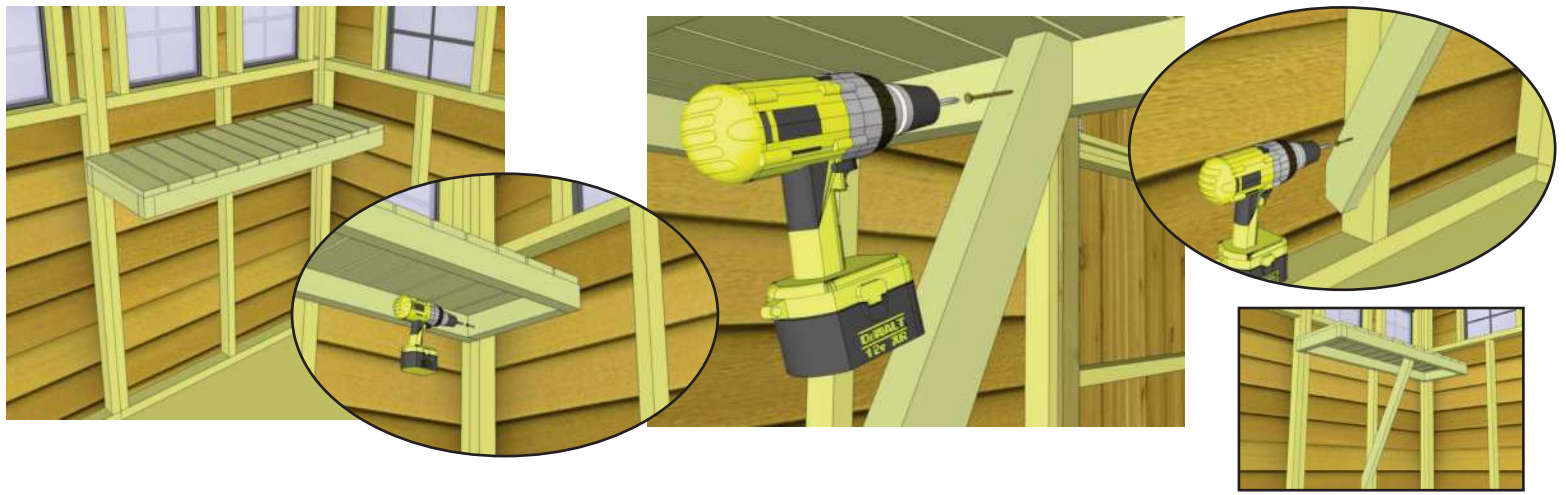

**99.** Locate 1 Long **Potting Shelf** and 1 **Leg**. Position shelf in corner tight against wall framing. While supporting the shelf, attach shelf with 2 1/2" screw. Place leg underneath shelf and attach to inside shelf frame and wall framing as illustrated above with 2 1/2" screws.

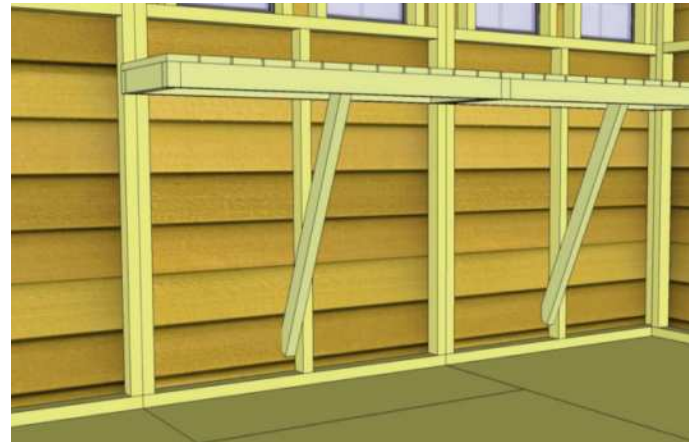

**100.** Place Short Potting Shelf against wall framing and end of long shelf framing. Attach with 2 1/2 " screws as per **Step 99**. Use a level to confirm shelving is square and level. Attach leg as previously illustrated. Screw to wall stud and up into the underside of the of shelf framing.

Complete attaching remaining long shelves as per **Steps 99 & 100**.



Completed  
Potting Shelf



# Outdoor Living Today Flower Box Assembly Instructions

## Parts Lists:

|  |               |                          |
|--|---------------|--------------------------|
| <b>A - Base, Rear &amp; Front Box Frames</b> | <b>(3pcs)</b> | 3/4" x 5 1/2" x 23"      |
| <b>B - End Cap Frames</b>                    | <b>(2pcs)</b> | 3/4" x 5 1/2" x 7" / 8"  |
| <b>C - Front Trim</b>                        | <b>(1 pc)</b> | 3/4" x 1 1/2" x 26"      |
| <b>D - Side Trims</b>                        | <b>(2 pc)</b> | 3/4" x 1 1/2" x 8 3/4"   |
| <b>E - Brackets</b>                          | <b>(2 pc)</b> | 1 1/2" x 5 1/2" x 5 1/2" |
| <b>F - 1 1/4" Screws</b>                     |               |                          |
| <b>G - 1 1/4" Nails</b>                      |               |                          |

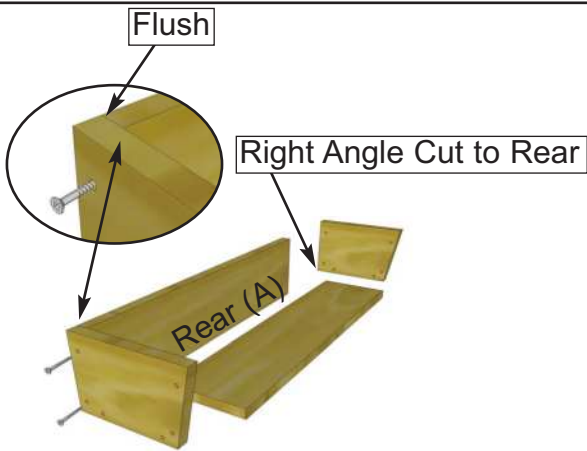
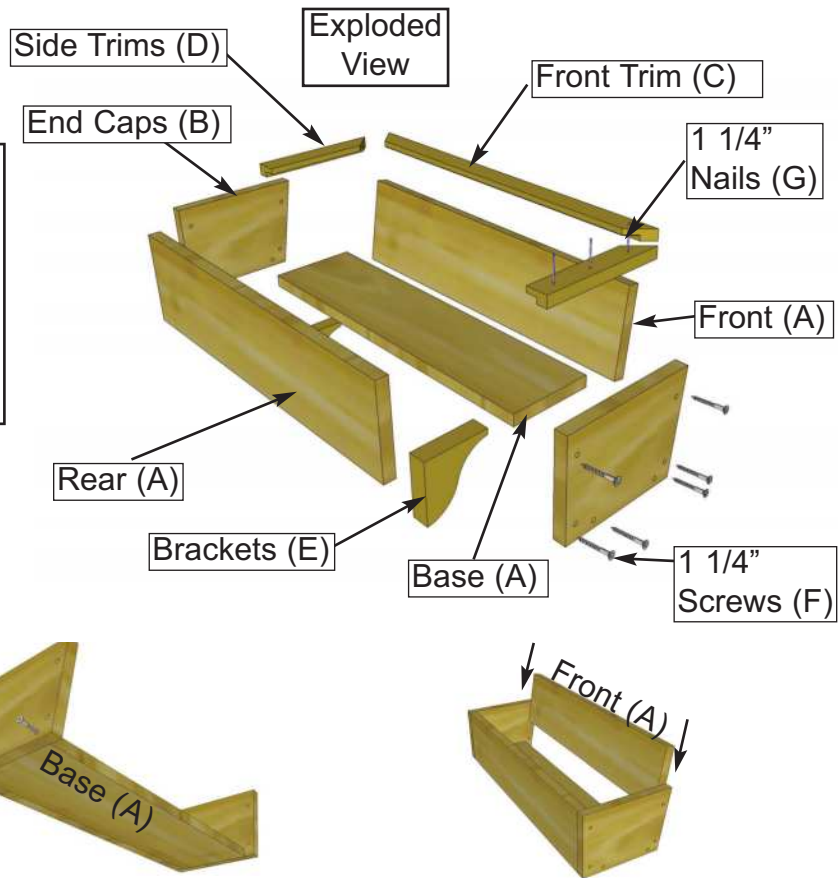

**1.** On a table position Rear Box and End Cap Frames together so flush at top. Fasten together with 2 - 1 1/4" screws. Place Base Frame tight against Rear and End Cap and flush at bottom. Secure with 2 - 1 1/4" screws. Complete attachment of remaining End Cap Frame. Slide Front Frame between End Caps.

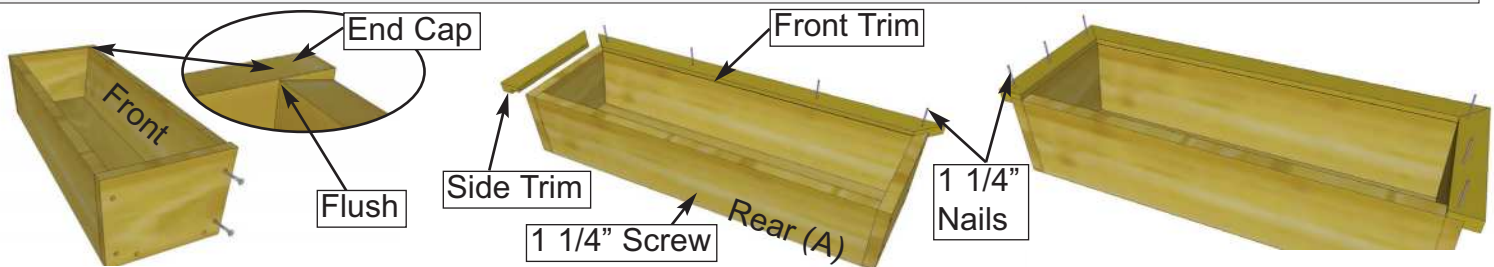

**2.** Position Front Frame Piece flush with End Cap. Attach both ends with 2 - 1 1/4" screws. Pilot hole Rear Box Frame near bottom center and secure to Base edge with 1 - 1 1/4" screw. Evenly position Front Trim (mitre cut on end and dado cut on inside bottom) tight against front frame and nail down with 4 - 1 1/4" nails. Position Side Trims as per Front and secure with 3 - 1 1/4" nails per side.

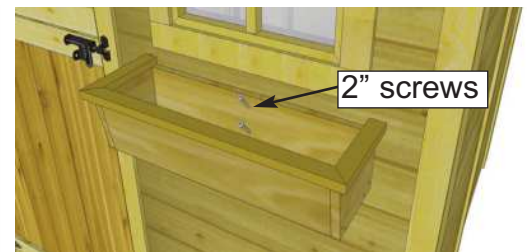
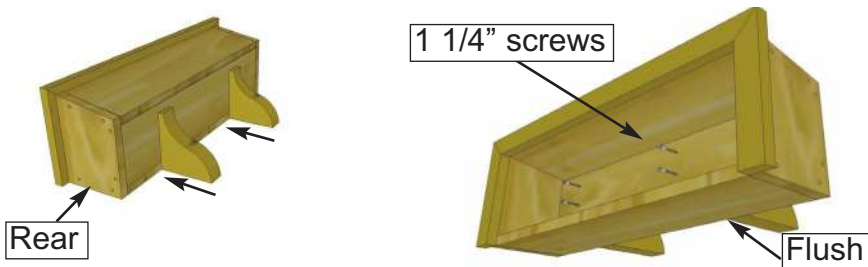

**3.** On a flat surface, flip Flower Box on it's rear face. Evenly space Brackets and secure through Base Frame and into the Brackets with 2 - 1 1/4" screws per Bracket. Position completed Flower Box beneath window trim and screw from inside of box into the center wall stud with 2 - 2" screws. (2" screws supplied with Base Kit.)



## Congratulations on Completing your 8 x 12 Sunshed!

**Note:** Our buildings are shipped as an unfinished product. If exposed to the elements, the western red cedar lumber will weather to a silvery-gray color. If you prefer to keep the cedar lumber looking closer to the original color, we suggest that you treat the wood with a good oil base wood stain. You may also wish to paint your new shed rather than stain it. In both cases we recommend that you consult with a paint and stain dealer in your area for their recommendations.



We hope your experience assembling your Sunshed has been both positive and rewarding.

We value your feedback and would like to hear back from you on how well we are doing in the following areas:

1. Customer Service
2. On Time Shipping
3. Motor Freight Delivery
4. Quality of Materials
5. Assembly Manual
6. Overall Satisfaction.

Please call, write or email us at:

Outdoor Living Today

Canadian Address  
9393 287th Street  
Maple Ridge, British Columbia  
Canada V2W 1L1

United States Address  
P.O. Box 96  
Sumas, Washington  
USA 98295



The materials contained in this Assembly Manual may be downloaded or copied provided that **ALL** copies retain the copyright and any other proprietary notices contained on the materials. No material may be modified, edited or taken out of context such that its use creates a false or misleading statement or impression as to the positions, statements or actions.