



12x4 SpaceSaver

Sliding Doors - Metal Roof - AK Siding

Assembly Manual

Stock Code:
SS124-SLIDER-METAL-AK

Version #1.18
Apr 4, 2022

Thank you for purchasing a 12x4 SpaceSaver Shed with Sliding Doors. Please take the time to identify all the parts prior to assembly.

Safety Points and Other Considerations
Our products are built for use based on proper installation on level ground and normal residential use. Please follow the instruction manual when building your shed and retain the manual for future maintenance purposes.

Customers are responsible for ensuring a solid, level, well-draining site for construction.

Please check with your local municipal or county by-laws before ordering this product to confirm it complies with building codes.



- Snow load ratings vary by geographical location. If heavy or wet snowfall occurs, it is advisable to sweep snow off roof frequently.
- If the product is elevated, any structural and building code requirements are solely the customer's responsibility, and should be abided by.
- In areas with high or gusty wind conditions, it is advisable to install the structure securely to the ground.
- Have a regular maintenance plan to ensure screws, doors, windows and parts are tightly affixed.

Customer agrees to hold Outdoor Living Today and any Authorized Dealers free of any liability for improper installation, maintenance and repair.

In the event of a missing or broken piece, call the Outdoor Living Today Customer Support Line @ 1-888-658-1658 within 30 days of the delivery of your purchase. It is our commitment to you to courier replacement parts, free of charge, within 10 business days of this notification. Replacement parts will not be provided free of charge after the 30 day grace period.

All structures purchased from Outdoor Living Today are covered for a period of one year for defects in manufacturing and workmanship. Costs incurred for customer installations are not included.

Failure to use supplied parts included in this kit could result in poor product performance and may void your warranty. Please contact Outdoor Living Today's Customer Toll Free Line if you plan to deviate from our written instructions.

What to do before my Shed arrives?



- Become familiar with this assembly manual and determine if you can complete the project yourself or will require a professional contractor.



- One helper is recommended to assist in constructing your shed. It generally takes two people over two days to assemble a shed. If you're hiring a contractor, their rate should be in line with that duration of work.



- Clear the construction area and ensure a clear pathway for delivery when the freight company arrives. Remove all debris: roots, grass, rocks, etc.



- Excavate the site. Contact your local utilities company to ensure there are no gas or electric lines buried in the area before digging.



- Decide on the type of foundation you will be using:
 - Concrete slab, or
 - 4-6 inches of crushed gravel with paver stones or 4x4 stringers.

You can find the footprint for your shed on Page 3 of your Assembly Manual.



- If doing the assembly yourself, have all the necessary tools ready to go and in working condition. A list of required tools can be found after the parts list.

Foundation Types for 12x4 Garden Shed

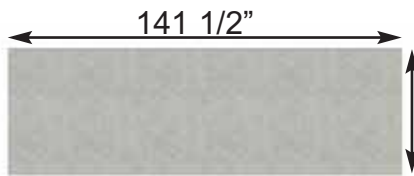

Concrete Foundation

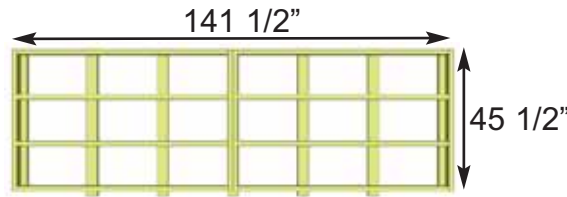

Floor Frame

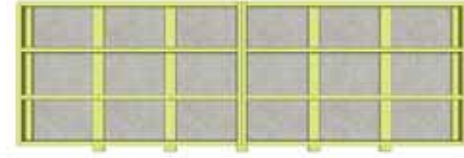

Completed Foundation

Concrete Slab Foundation:

- Slab must be at least the same size as assembled floor frame (45 1/2" x 141 1/2") or larger.
- 6" Deep foundation.
- 0.9 Cubic Yards of concrete required.
- A concrete slab will have the longest durability out of your foundation options.

Once level, a concrete slab is the easiest surface to build on.

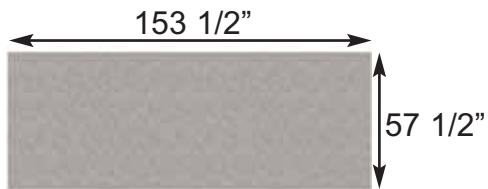

Gravel Foundation



Gravel Foundation with treated stringers

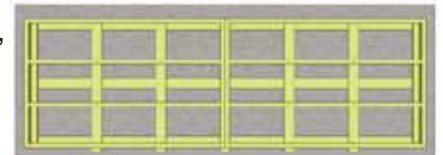

Completed Foundation

Gravel with 4x4 Pressure Treated Stringers:

- Excavate at least 6" deep, and 6" wider than floor frame on each side.
- 1.2 Cubic Yards of gravel required, approximately 11 wheelbarrows.
- 3 - 4x4 Pressure Treated Stringers 12' long required.
- Evenly spaced, with one at each end of floor frame.

Saves money on materials, easy to level and work with.

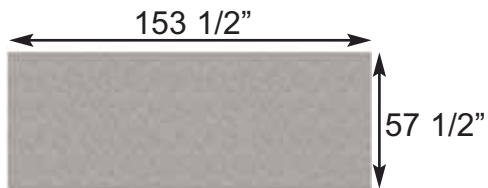

Gravel Foundation

21 Patio Stones



Gravel Foundation with Patio Pavers

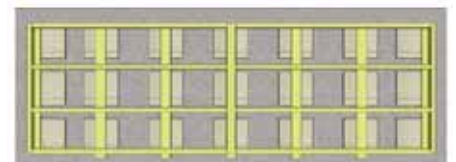

Completed Foundation

Gravel with Patio Paver Stones:

- Excavate at least 6" deep, and 6" wider than floor frame on each side.
- 1.2 Cubic Yards of gravel required, approximately 11 wheelbarrows.
- 21 patio pavers (8" x 8" or larger).
- Center patio paver stones underneath floor runners and underneath seams in floor joists.

Patio paver stones are widely available from most landscape stores.

Thank you for purchasing our 12x4 SpaceSaver Sliding Door Shed.
Please take the time to identify all the parts prior to assembly.

1. Floor Section	Parts List - Pages 4 and 5	Steps ↓
Floors -----		1-6
1A: 2 - 45 1/2" x 70 3/4" - Floor Frames		
1B: 4 - 1 1/2" x 3 1/2" x 67 3/4" - Floor Joists		
1C: 2 - 1 1/2" x 3 1/2" x 45 1/2" - Floor Runners Short		
1CC: 5 - 1 1/2" x 3 1/2" x 47 1/2" - Floor Runners Long		
1D: 2 - 5/8" x 45 3/8" x 70 5/8" - Plywood Floor		
2. Wall Section		Steps ↓
Main Wall Panels -----		7-13
2A: 5 - 45 1/2" x 75" - Side/Rear Wall Panels		
2B: 5 - 1 5/8" x 2 1/2" x 45 1/2" - Bottom Wall Plates - Side/Rear Walls		
2BB: 2 - 1 5/8" x 2 1/2" x 35" - Bottom Wall Plates - Front Walls		
2C: 2 - 35" x 73" - Front Wall Panels		
Door Headers -----		14-15, 23
2D: 2 - 2" x 3 1/2" x 26 1/4" - Door Headers - Short		
2E: 1 - 2" x 3 1/2" x 84" - Door Header - Long (88" Aluminum Strip Attached)		
2EE: 1 - 1 1/2" x 3" x 66 1/2" - Interior Door Header		
Extender Walls -----		16-21
2F: 2 - Top Triangular Siding Pc for Angle Wall Extenders		
2G: 2 - 45 1/4" - Angle Wall Extenders - Left/Right		
2H: 3 - 9" x 45 1/2" - Wall Extenders		
Wall Cleats -----		22
2I: 1 - 3/4" x 3 1/2" x 84" - Horizontal Wall Cleat - Long		
2J: 2 - 3/4" x 3 1/2" x 26 1/4" - Horizontal Wall Cleats - Short		
3. Rafter and Roof Section		Steps ↓
Rafters -----		24-29
3A: 9 - 1 1/2" x 2 1/2" x 54" - Rafters		
3B: 2 - 1" x 3 1/2" x 48" - Front Soffits - Left/Right		
3C: 1 - 1" x 3 1/2" x 45 1/2" - Front Soffit - Center		
3D: 2 - 1/2" x 3 1/2" x 48" - Rear Soffits - Left/Right		
3E: 1 - 1/2" x 3 1/2" x 45 1/2" - Rear Soffit - Center		
Roofs -----		30-42
3G: 3 - 3/4" x 3 1/2" x 45 1/2" - Roof Battens Center		
3H: 6 - 3/4" x 3 1/2" x 50" - Roof Battens Outside		
3J: 2 - 3/4" x 3/4" x 51" - Facia Nailing Strips		
3K: 5 - Metal Roof Panels - 39" wide x 58 1/2" long		
3L: 4 - 3/4" x 1 1/2" x 21 5/8" - Batten Spacers		
Note: there are no parts 3I or 3F on this list		
4. Trim & Miscellaneous Section		Steps ↓
Bottom Skirting -----		43-45
4A: 5 - 3/4" x 4 1/2" x 45 1/4" - Side/Rear Bottom Skirting (Bevel Siding)		
4B: 3 - 1/2" x 4" x 45 1/4" - Front Bottom Skirting		
Filler Trim -----		46-47
4C: 4 - 1/2" x 2 1/2" x 38" - Front Corner Filler Trims		
4D: 4 - 7/8" x 2 1/2" x 42" - Rear Corner Filler Trims		
Door System -----		48-52
4E: 2 - Aluminum Door Tracks		
4F: 2 - 36" x 73" - Sliding Doors		
4G: 1 - 3/4" x 3 1/2" x 71 1/2" - Interior Door Flange		
4H: 2 - 1 1/2" x 1 5/8" x 61 1/8" - Lower Door Track		
4I: 3 - 3/4" x 3 1/2" x 44 1/4" - Lower Door Track Cover		
4J: 3 - 1 1/2" x 2 1/4" x 3 1/2" - Sliding Door Track Stop		
Note: there are no parts 4K or 4L in this list.		
Outer Wall Trim -----		53-55
4M: 2 - 1/2" x 5 1/2" x 78 1/2" - Front Corner Trims		
4N: 2 - 1/2" x 2 1/2" x 80" - Side Front Corner Trims		
4O: 2 - 1/2" x 5 1/2" x 88 3/4" - Rear Corner Trims		
4P: 4 - 1/2" x 2 1/2" x 88 3/4" - Side Rear Corner & Middle Trims		

Continued on next page

Note: All Trim, Facia, and Bottom Skirting pieces will be positioned rough face out when installed.

4. Trim & Miscellaneous Section Cont.

Facia

- 4Q:** 2 - 1/2" x 5 1/2" x 54 1/8" - Side Facia (Angle Cut Ends)
- 4R:** 4 - 1/2" x 5 1/2" x 50 1/2" - Front and Rear Facia - Left/Right
- 4S:** 2 - 1/2" x 5 1/2" x 45 1/2" - Front and Rear Facia - Center
- 4T:** 2 - Facia Detail Plates (5 1/2" high)

Rear Metal Drip Caps

- 4U:** 3 - 6" x 60" angled - **Rear Metal Drip Caps**

Windows

- 4V:** 2 - Window Inserts 18 1/4"w x 23"h
- 4W:** 2 - Window Trim Kits
 - 1 - Top pc - 24 1/16" Length - Angle Cut Ends
 - 3 - Side/Bottom pcs - 23" Length

Miscellaneous

- 4X:** 1 - 45 1/4" - Extra Piece of Bevel Wall Siding
 - Use if side/rear wall panel siding is damaged or to shim floor or door.
- 4Y:** 1 - 36" - Extra Piece of Lap Siding
 - Use if front wall panel siding is damaged

Foam Enclosures - Several Strips (Step 41)

Steps ↓

56-60

61

62-64

12X4 SpaceSaver Sliding Door Shed with Metal Roof HARDWARE PACKAGE

BR1 - Square Drive Bit  x 2

Nut Driver  x 1
1/4" Nut Driver

N1 - 1 1/2" Finishing Nails  x 305

S4 - 3" Screws  x 44

S1 - 2 1/2" Screws  x 234

1/4" x 2" long  x 20
Metal Roof Screw

S2 - 1 1/4" Screws  x 190

SB1 - 3/4" Screws  x 20
Black Headed



Y35 - Roller Assembly x 4



Y2 - 90° Metal Bracket (Roof) x 4



Y38 - Metal Roof Hanger x 5



Silicon Caulking (1)



Y11 - Black Hasp x 1



Y3 - Black Handle x 2

Tools Required (Not Provided)



Hammer



Utility Knife



Pliers



Tape Measure



Silicone Caulking



Level



Wood Clamp



Ladder



1/8" Drill Bit



Screw Gun/Drill

Safety Equipment Required

(Not Provided)



Safety Glasses



Work Gloves

Before/During Assembly:

- 1.) Paint each face and edge of your plywood floor with a latex exterior paint.
- 2.) Caulk wall seams if gaps appear.
- 3.) Caulk around window framing.
- 4.) Caulk perimeter between floor plywood and bottom wall plate.
- 5.) Caulk channels in lap siding at the top of your door above the trim, just a drop in each channel.
- 6.) Caulk edge of door threshold (if applicable).
- 7.) Optional: Install a Sill Gasket between floor runners and foundation.
- 8.) Optional: Install an 8" strip of roofing paper below Cedar Ridge Caps for Cedar Roof Sheds.

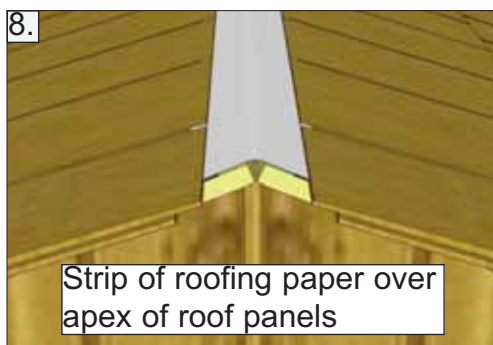
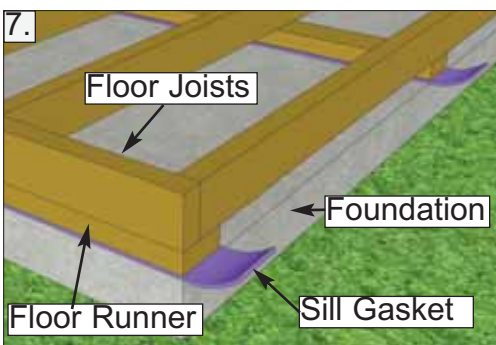
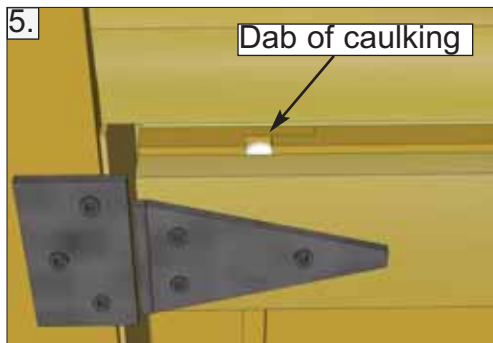
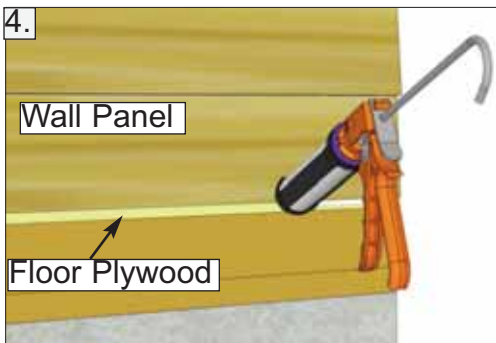
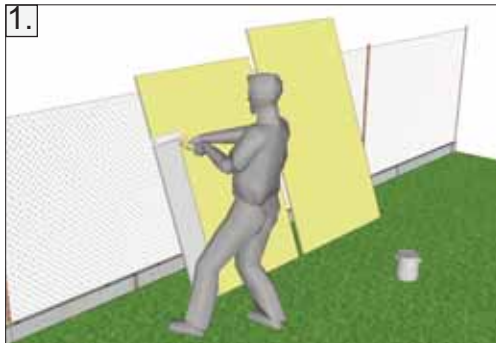

Routine Maintenance:

- Routinely check all fasteners are tight (ex. Door Hinges, Nails)
- Brush off dirt from walls.
- Brush off snow from roof regularly.
- Routinely remove needles and leaves from roof.

Painting/Staining

- Your cedar shed, if left untreated, will weather to a silvery grey colour.
- Painting or staining your structure is highly recommended and will prolong the life of your shed.
- You do not need to wait to paint or stain your shed, the wood in your kit has been dried and can be stained or painted immediately.
- Consult your local paint store for the best paint or stain for cedar.
- Optional: stain the inside of your shed. (Note: this will remove the fresh cedar smell.)

1. Floor Section

Exploded view of all parts necessary to complete Floor Section. Identify all parts prior to starting.
 Note: Floor Footprint is 141 1/2" wide x 45 1/2" deep.

Floor Frames - 2pcs.
 (Part 1A)

Plywood Floor - 2pcs.
 (Part 1D)

Center Floor
 Joists - 4pcs.
 (Part 1B)

Floor Runners - 7pcs.
 (Part 1C)

Concrete Pad
 (optional foundation method)

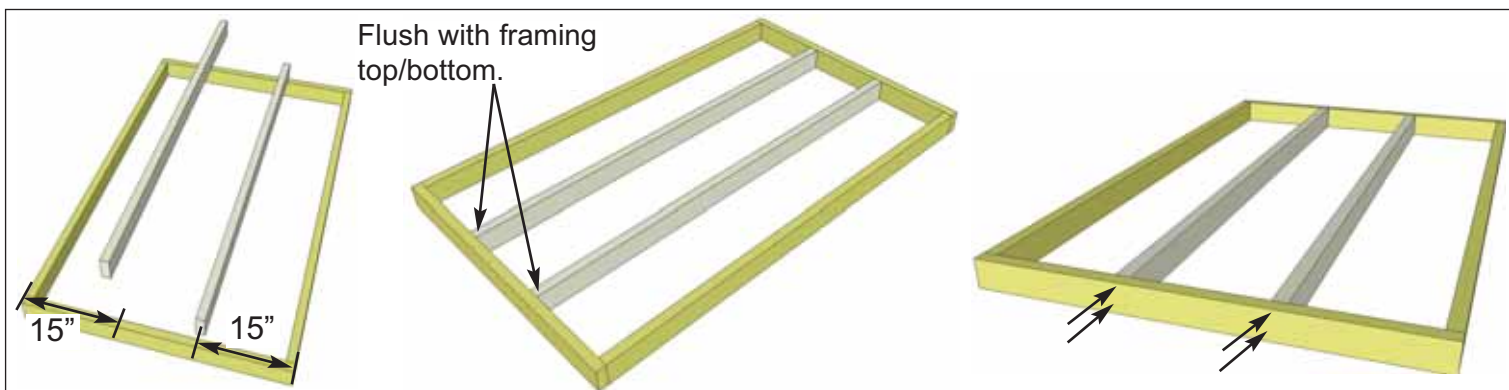

1. Lay out **1A - Floor Frame** and two **1B - Floor Joists** as illustrated above. Position the center of each Joist 15" from the outer edge of Floor Frame. When correctly positioned, attach each Joist with **4 - 2 1/2" Screws** (2 per end). **You can find the Square Drive Screw Bit in the Hardware Kit Bag.** Complete remaining Floor Frame the same.

<u>Parts</u>	
1A - Floor Joist Frames (45 1/2" x 70 3/4") x 2	
1B - Floor Joists (1 1/2" x 3 1/2" x 67 3/4") x 4	
<u>Hardware</u>	
S1 - 2 1/2" Screws x 16 total	

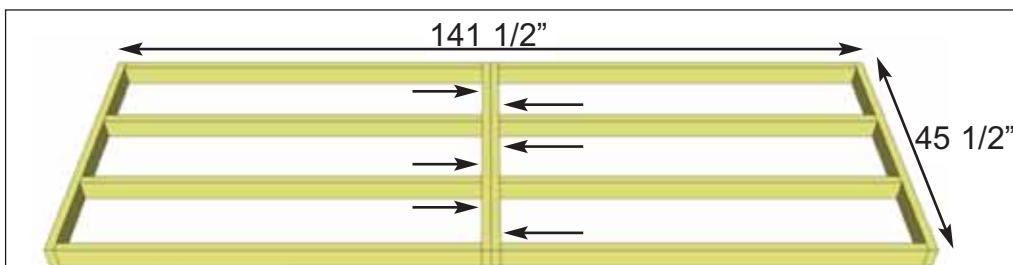

You can find BR1 - Square Drive Bit for the screws in with the Hardware Kit Bag.

2. Lay out both complete floor joist frames as illustrated. The footprint for the floor when attached together will be 141 1/2" wide x 45 1/2" deep. Attach frames together with **6 - 2 1/2" Screws**.

<u>Hardware</u>	
S1 - 2 1/2" Screws x 6 total	

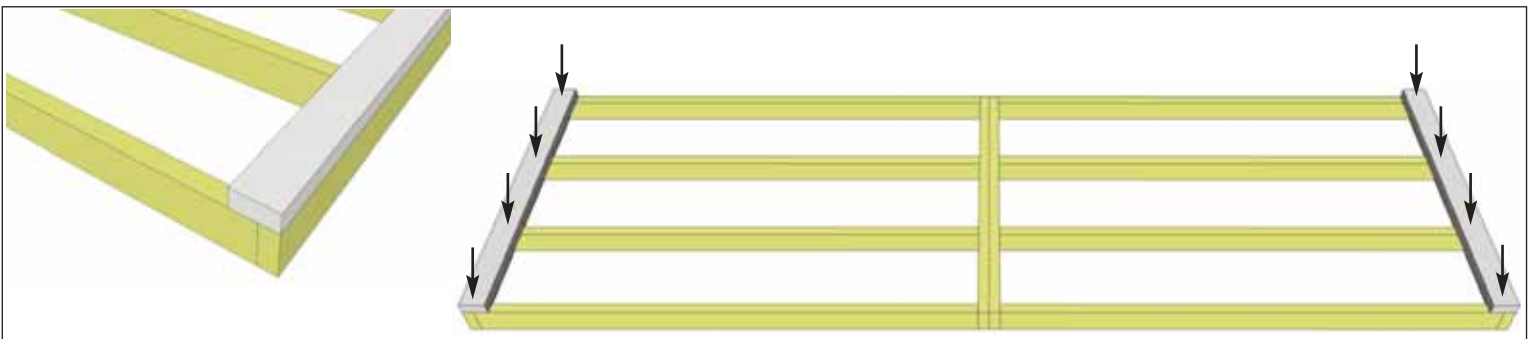

3. Position **1C - Floor Runners - Short** on each side of the completed floor frame. Runners should be flush with corners but not overhanging. Attach with **4 - 2 1/2" Screws** per Runner.

Parts
1C - Floor Runners - Short
 (1 1/2" x 3 1/2" x 45 1/2") x 2

Hardware
S1 - 2 1/2" Screws
 x 8 total

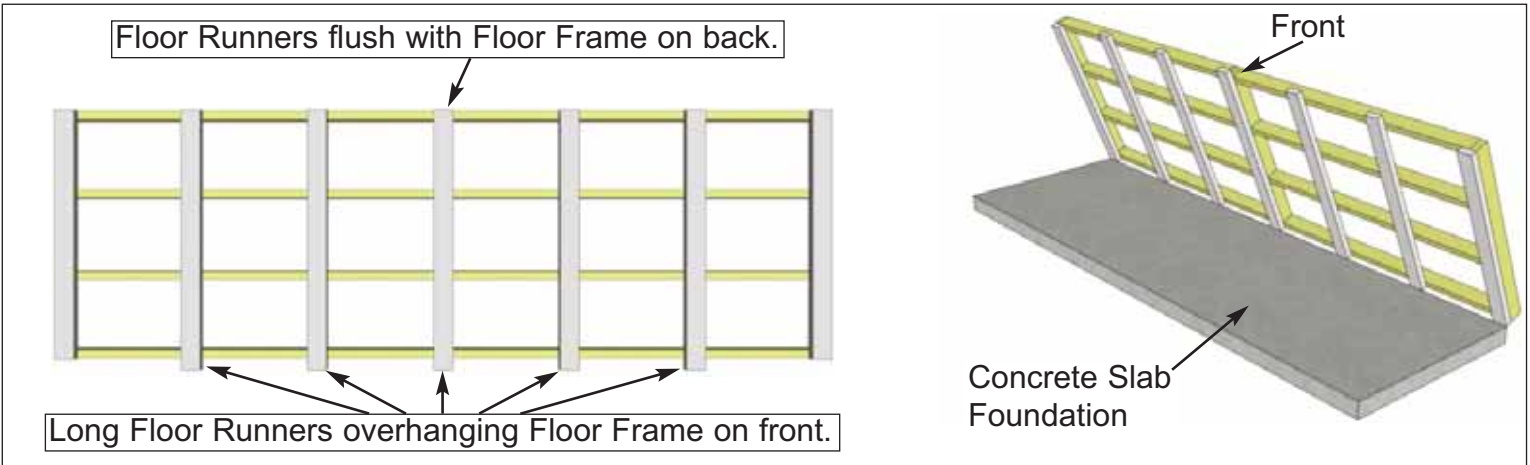

4. Align **1CC - Floor Runners - Long** evenly spaced as shown above and flush with the back of the Floor Frame. On the front, Runners will extend 2" past the Floor Frame to provide support for the Sliding Door Track later in the Assembly. Attach with **4 - 2 1/2" Screws** per Runner. With Floor Runners attached, carefully flip the floor over and place on your foundation. **Caution** - Be careful when laying floor down not to bend or twist floor. **Note:** Having a level foundation is critical. Choosing a foundation will vary between regions. Typical foundations can be concrete pads or patio stones positioned underneath the floor runners.

Parts
1CC - Floor Runners - Long
 (1 1/2" x 3 1/2" x 47 1/2") x 5

Hardware
S1 - 2 1/2" Screws
 x 20 total

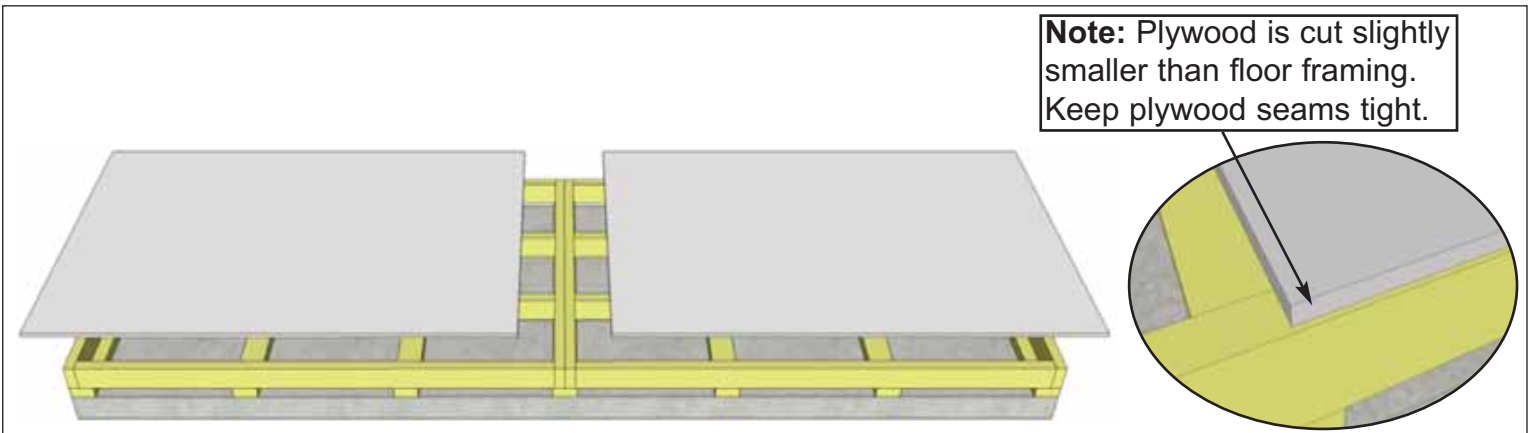

5. Position **1D - Plywood Floor** on top of completed floor frames. Plywood will sit slightly inset from outside of floor frame.

Parts
1D - Plywood Floor
 (5/8" x 45 3/8" x 70 5/8") x 2

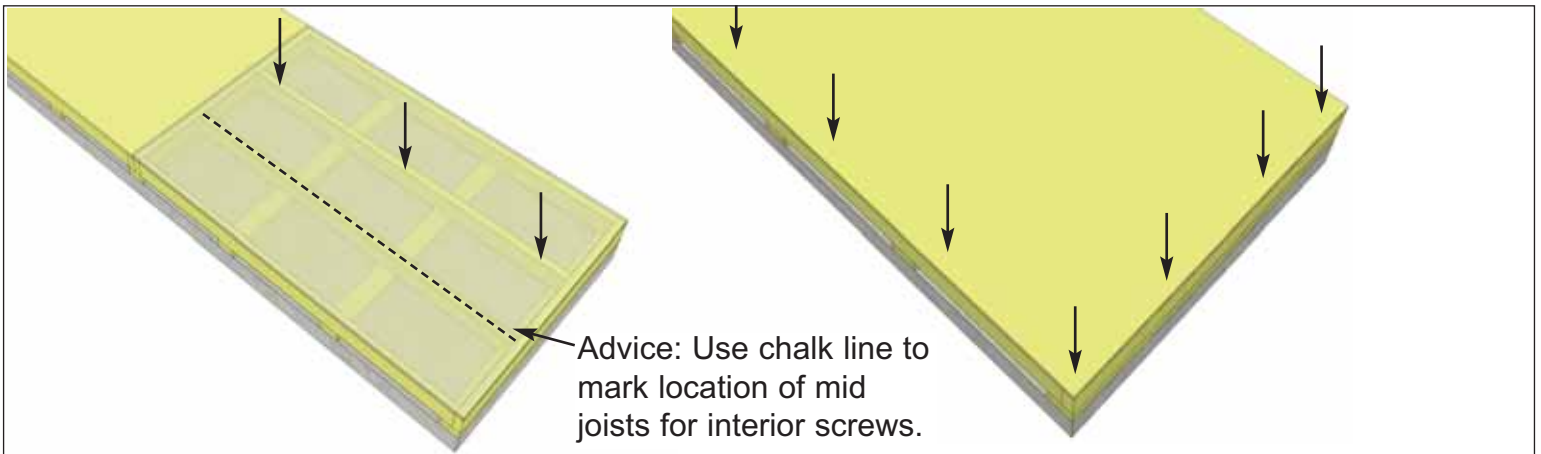

6. With Plywood positioned correctly on floor framing, attach with **1 1/4" Screws**. Use screws every 16" around perimeter of each floor section and 3 screws through each mid joists.

Hardware
S2 - 1 1/4" Screws
 x 40 total (approx.)

2. Wall Section

Exploded view of all parts necessary to complete the Wall Section. Identify all parts prior to starting.

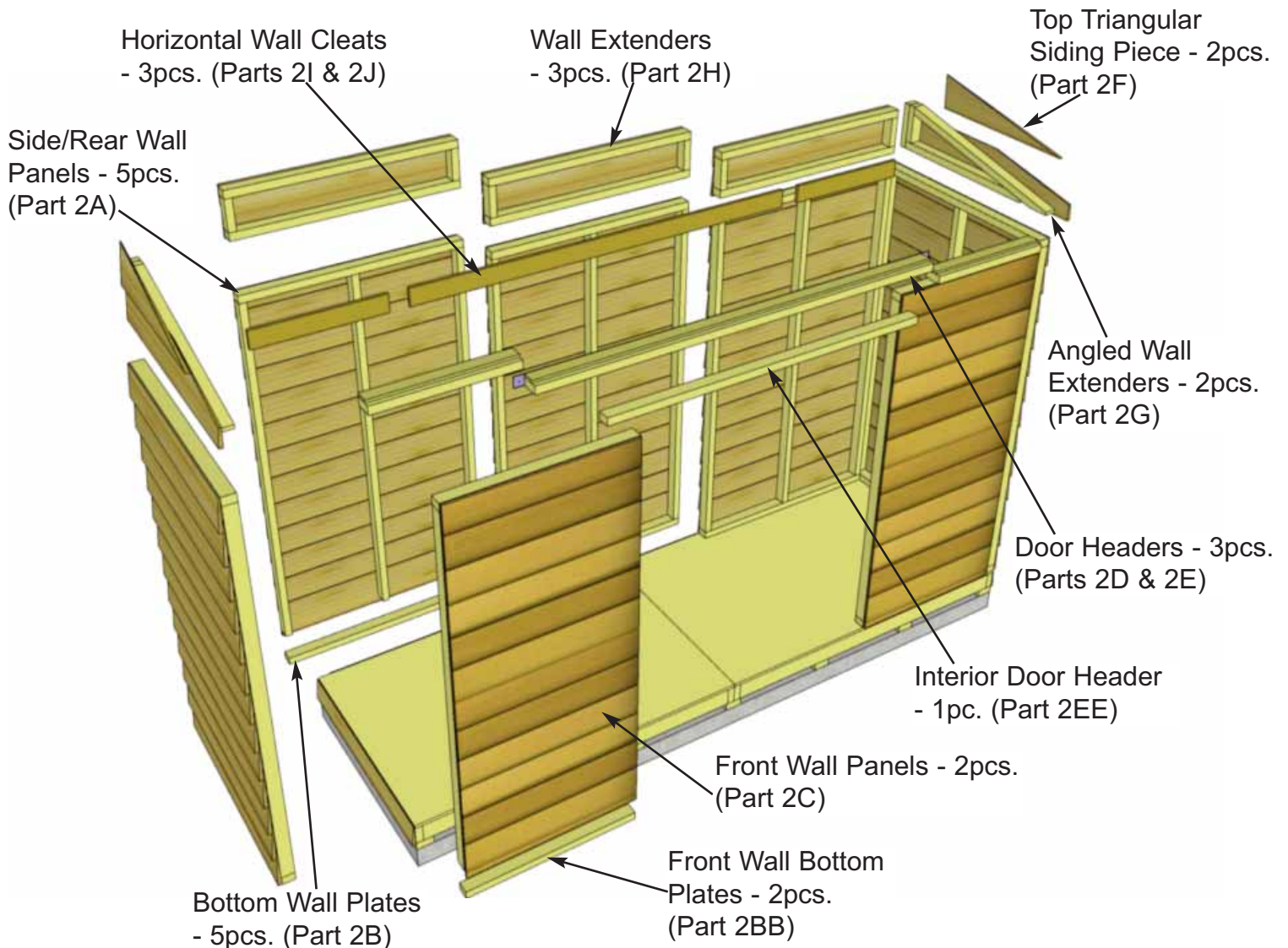

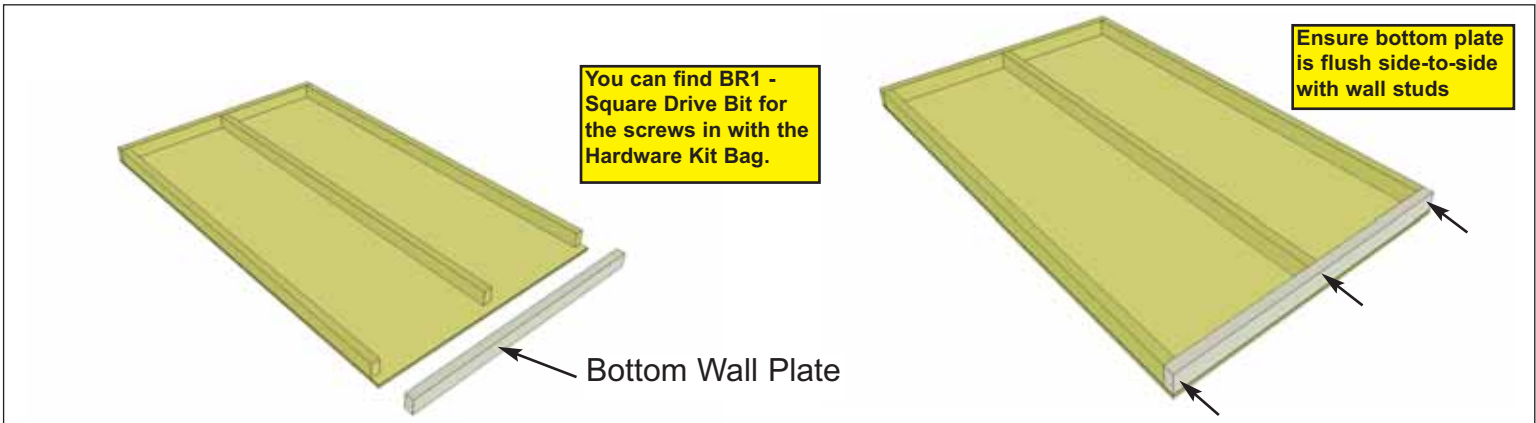

7. Carefully lay **2A - Side/Rear Wall Panels** face down. Position and attach **2B - Bottom Wall Plates** to bottom of wall studs of each wall panel with **3 - 2 1/2" Screws**. Position so plates are flush with framing. Complete 4 remaining solid walls.

Parts
2A - Side/Rear Wall Panels (45 1/2" wide x 75" high) x 5
2B - Bottom Wall Plates (1 5/8" x 2 1/2" x 45 1/2") x 5

Hardware
S1 - 2 1/2" Screws x 15 total

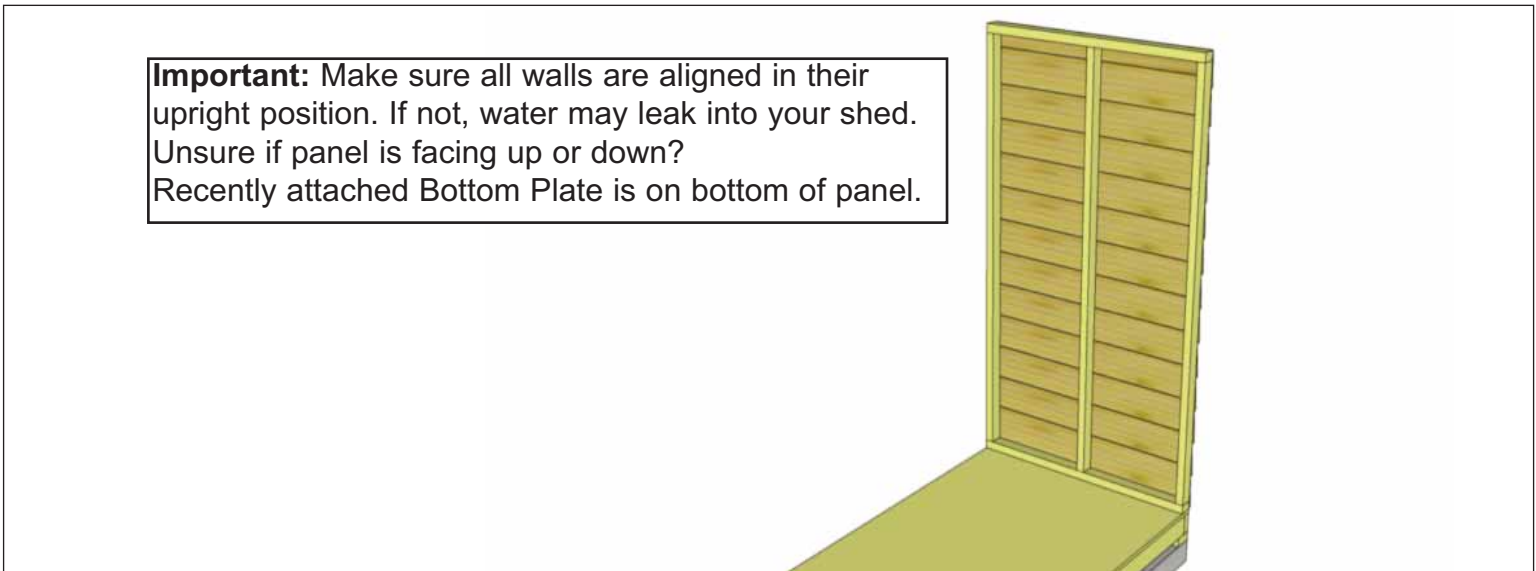

8. Starting on one side, position a Solid Wall Panel on top of plywood floor. The Wall Panel bottom framing will sit flush with the outside of the floor frame. Wall siding will overhang the floor.

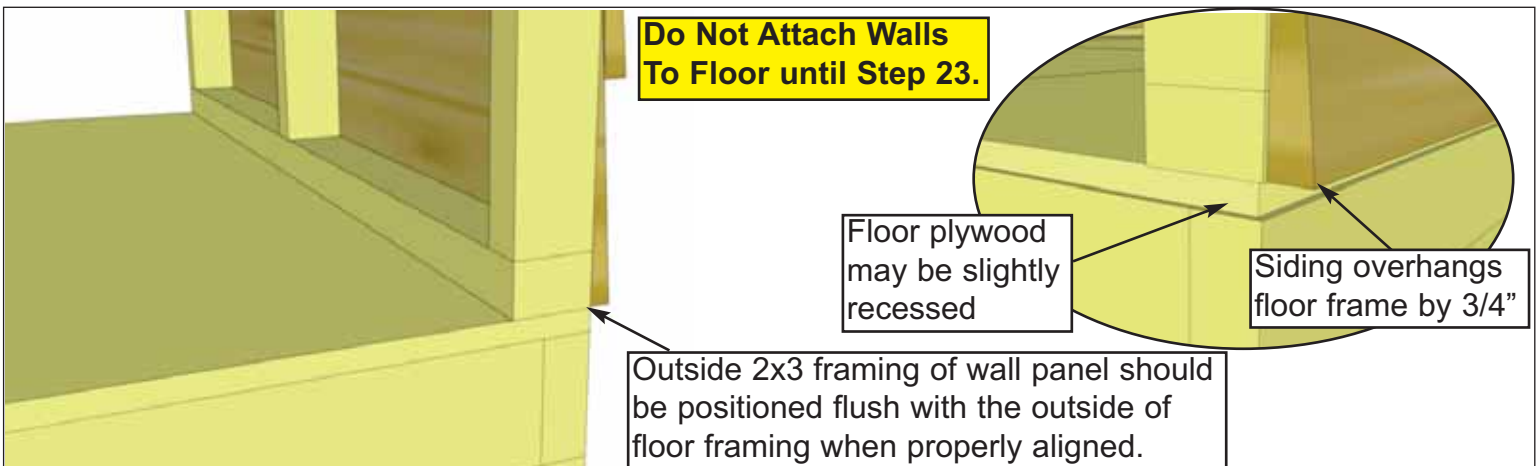

9. The side wall panels will sit even with the floor frame and the rear wall panels will be sandwiched between the side wall panels. The floor plywood may be slightly recessed.
Note: Siding will overhang the floor frame by approximately 3/4".

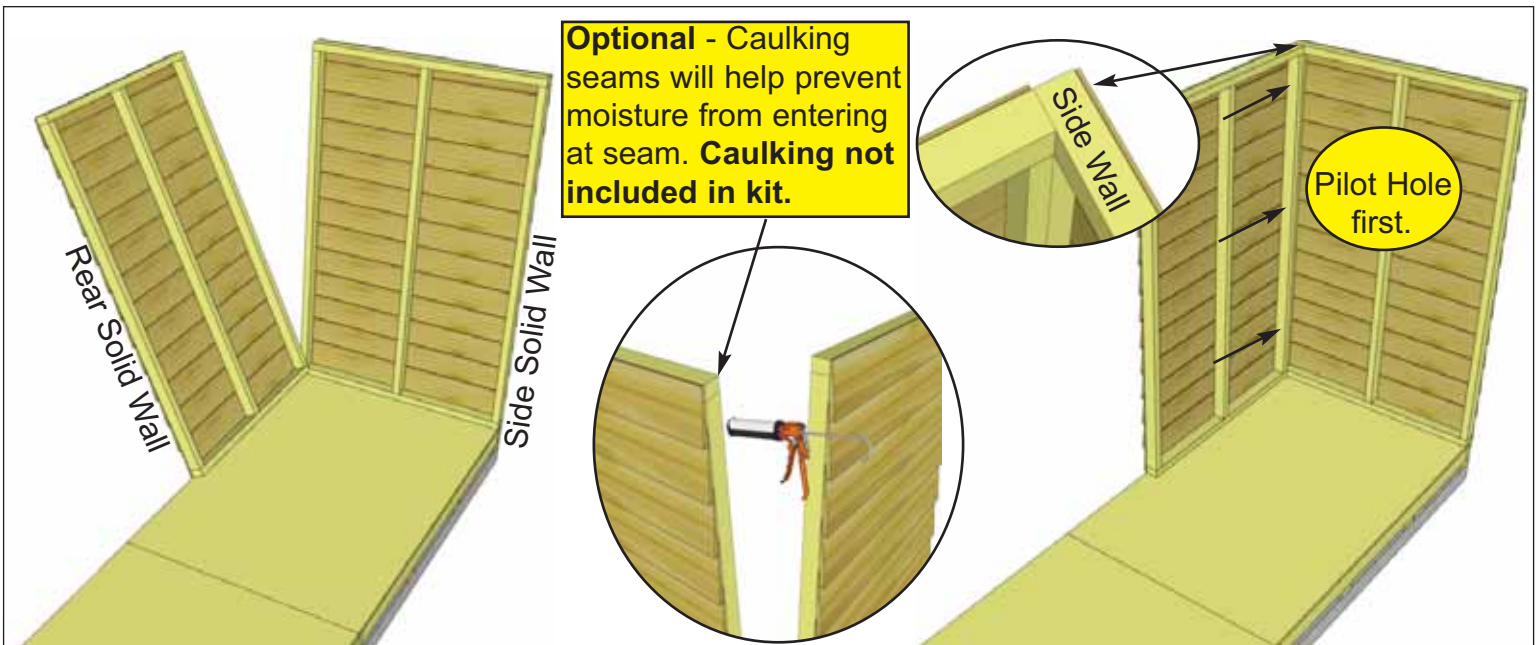

10. Position rear solid wall into place on plywood floor. Butt both vertical wall studs of side and rear walls together and attach with **3 - 2 1/2" Screws**. Screw at the bottom, middle and top of stud to secure properly.
Note: Drill pilot holes in studs to prevent splitting.

Hardware (Steps 10 - 12)
S1 - 2 1/2" Screws
 x 12 total

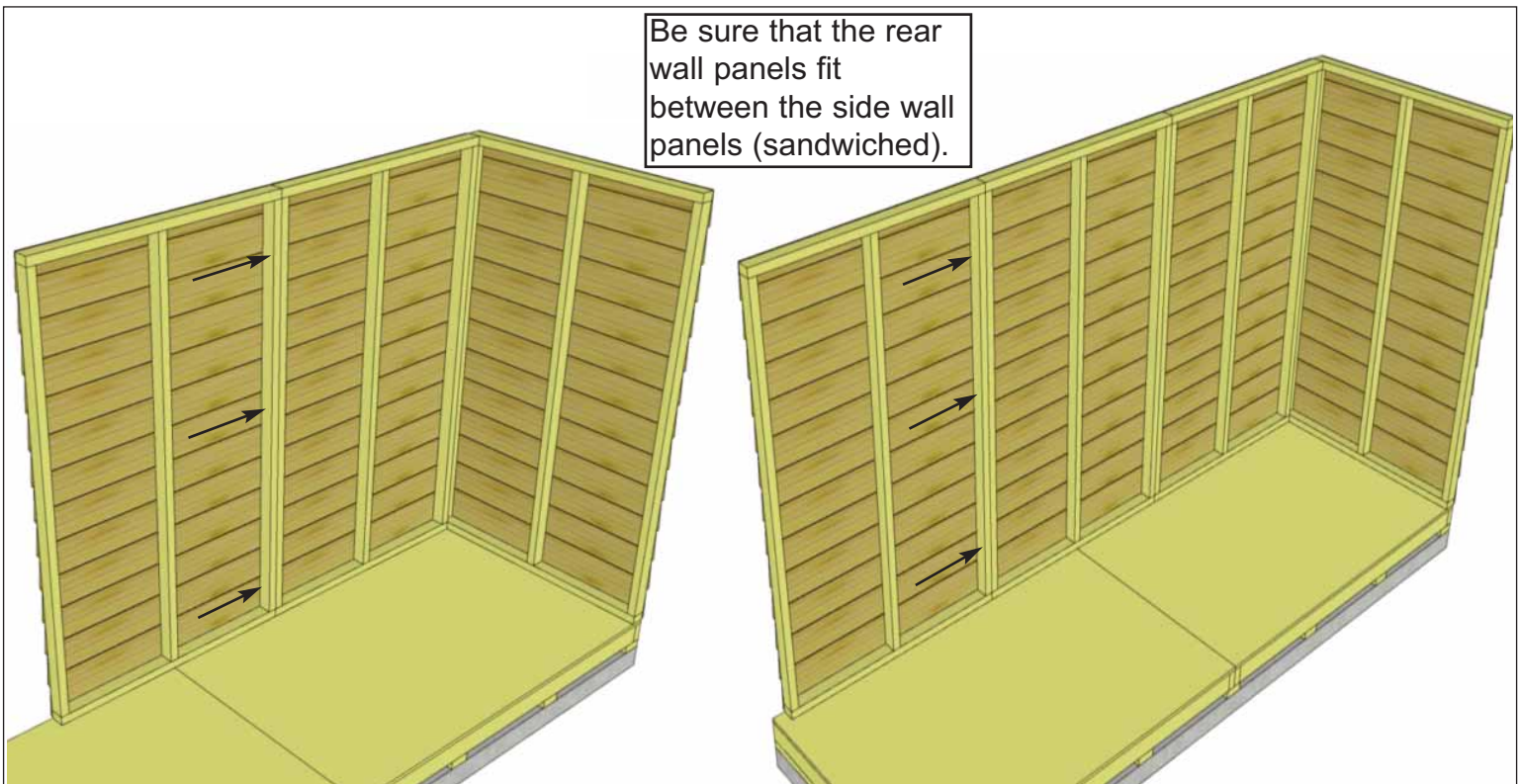

11. With the corner wall attachment complete, position a second rear wall panel in place so bottom 2x3 wall framing is sitting flush with outside floor joists. Wall siding should overhang floor by approximately 3/4". When positioned correctly, attach both side wall panel studs together as per **Step 10**.



12. Complete remaining side wall attachment as per **Steps 10 - 11.**

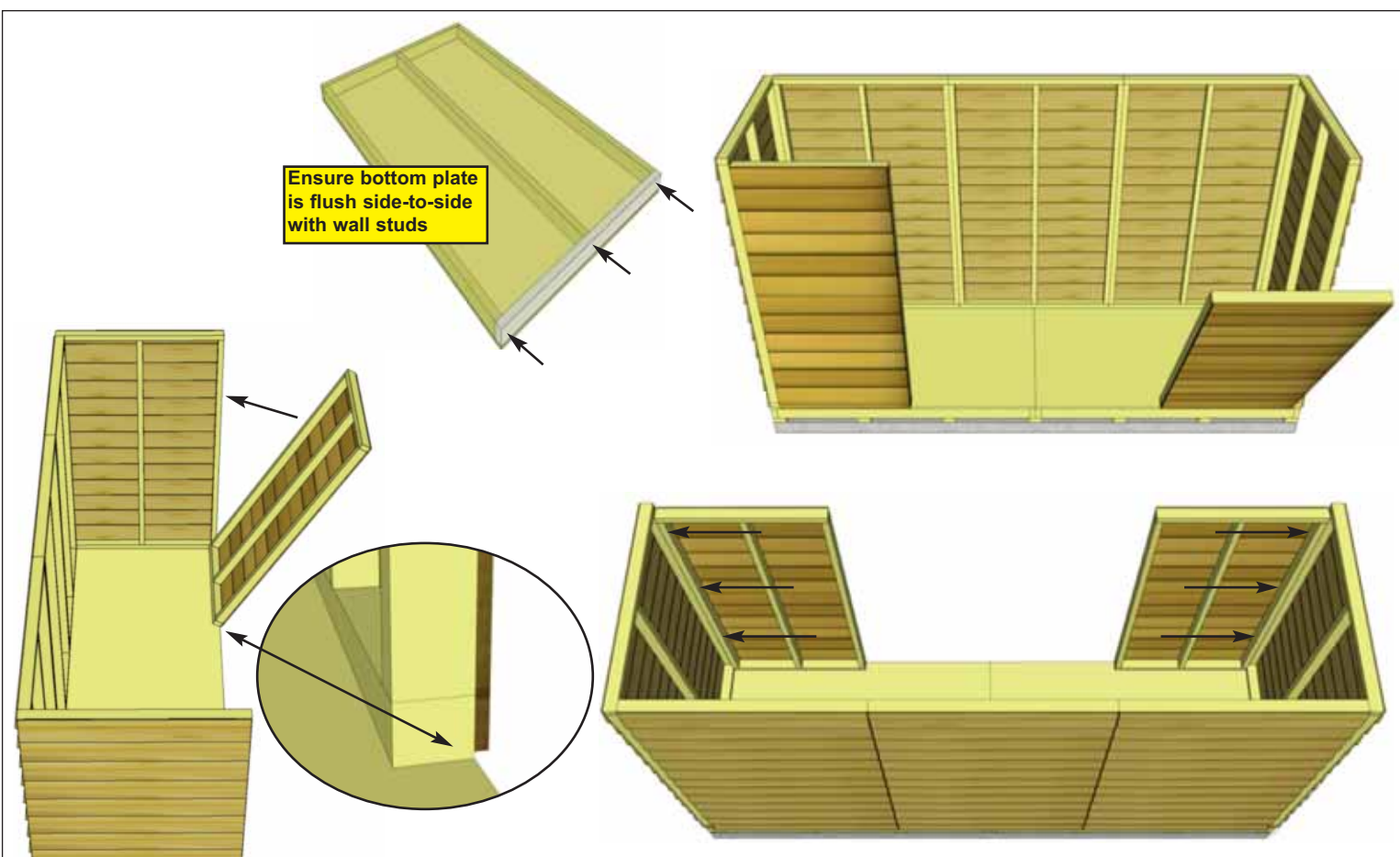

13. Carefully lay **2C - Front Wall Panels** face down. Position and attach **2BB - Bottom Wall Plates** to bottom of wall studs of each wall panel with **3 - 2 1/2" Screws** as per **Step 7**. Complete other remaining Front Wall.

Place Front Walls so wall framing is flush with floor frame and siding overhangs. Attach with **3 - 2 1/2" Screws** per panel as per **Steps 10 - 12.**

Parts

- 2C - Front Wall Panels**
(35" wide x 73" high) x 2
- 2BB - Bottom Wall Plates**
(1 5/8" x 2 1/2" x 35") x 2

Hardware

- S1 - 2 1/2" Screws** x 12 total

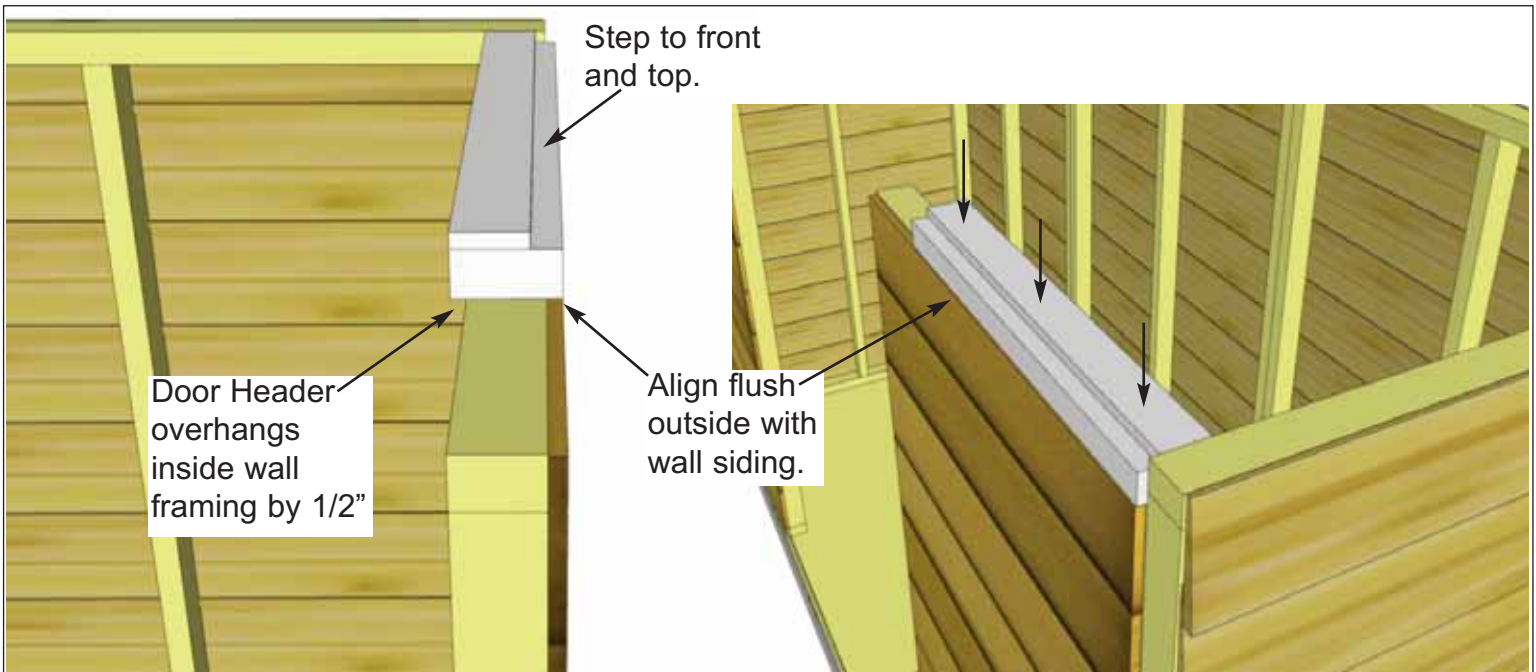

14. Position **2D - Door Header - Short** on top of wall stud so it is flush on the outside with the wall siding. Attach by screwing down into top wall framing with **3 - 3" Screws**.

Parts (Step 14 - 15)
2D - Door Headers - Short
 (2" x 3 1/2" x 26 1/4") x 2
2E - Door Header - Long
 (2" x 3 1/2" x 84") x 1

Hardware (Step 14 - 15)
S4 - 3" Screws
 x 10 total
S2 - 1 1/4" Screws
 x 4 total

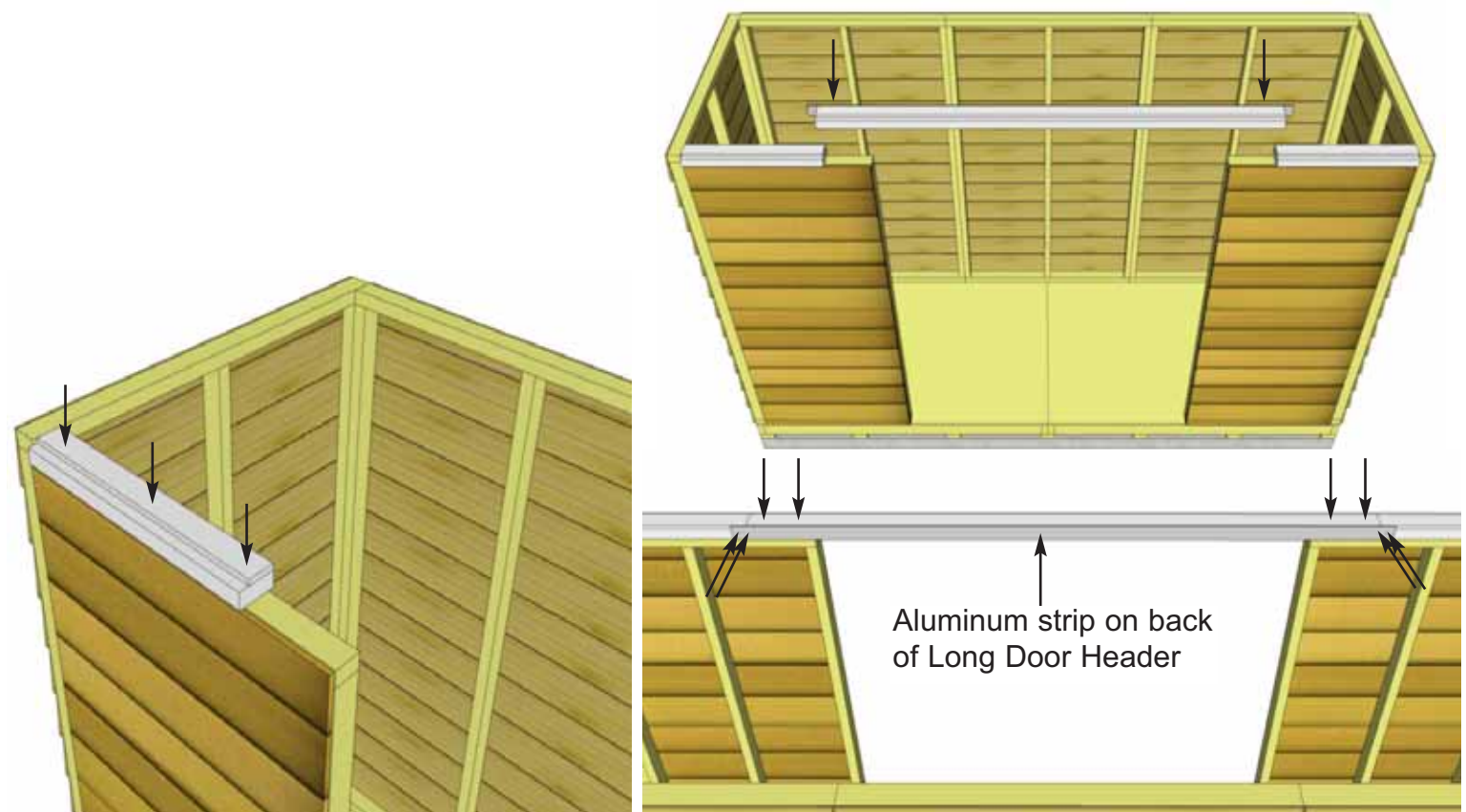

15. Attach **2D - Door Header - Short** to other side. Position and attach **2E - Door Header - Long** between short door headers. The Long Door Header has an aluminum strip attached to the back for added support. Attach by screwing down into wall framing with **2 - 3" Screws** per side. Fasten aluminum strip to short headers with **2 - 1 1/4" Screws** per side.

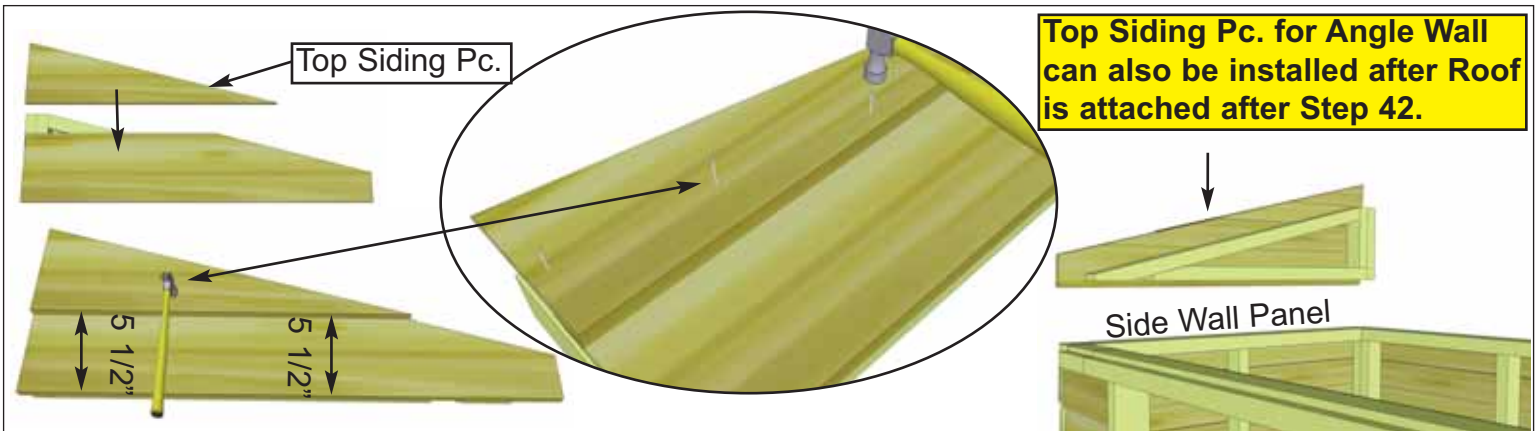

Top Siding Pc. for Angle Wall can also be installed after Roof is attached after Step 42.

16. Position **2F - Top Triangular Siding Piece** onto **2G - Angle Wall Extender** and align as shown above. Attach with **3 - 1 1/2" Finishing Nails** to top frame of extender wall. There are left/right top siding pieces. Use rough surface side out. Place finished wall extender on side wall panel frame. Complete both sides now.
Note: Bottom siding of wall extender will overhang and cover siding of side wall.

- Parts
2G - Angle Wall Extenders - L/R
 (2G - 45 1/2" wide) x 2
2F - Top Triangular Siding Piece
 (2F - Left/Right) x 2
- Hardware
N1 - 1 1/2" Finishing Nails x 6 total

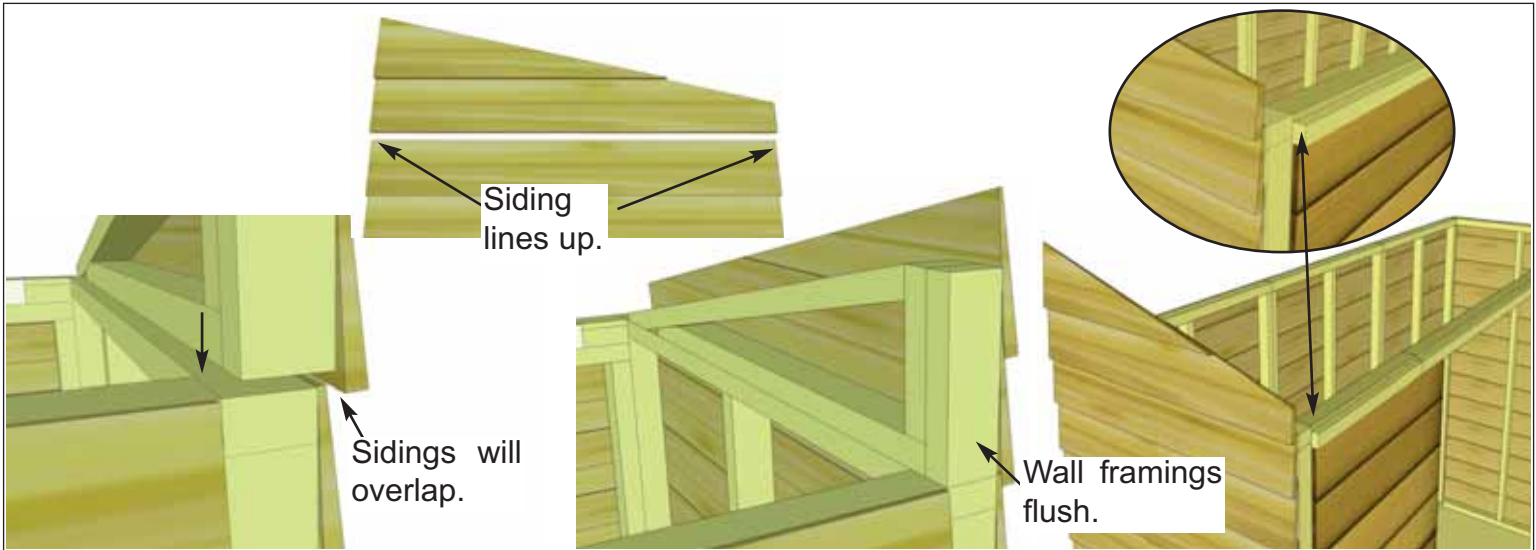

17. Align wall framing of Angled Wall Extender and Side Wall so they are flush at the back. The siding for both walls should also align evenly from front to back.



18. With Angled Wall Extender and Side Wall aligned correctly, secure together from the inside with **4 - 2 1/2" Screws**.

- Hardware (Steps 18 - 19)
S1 - 2 1/2" Screws x 8 total

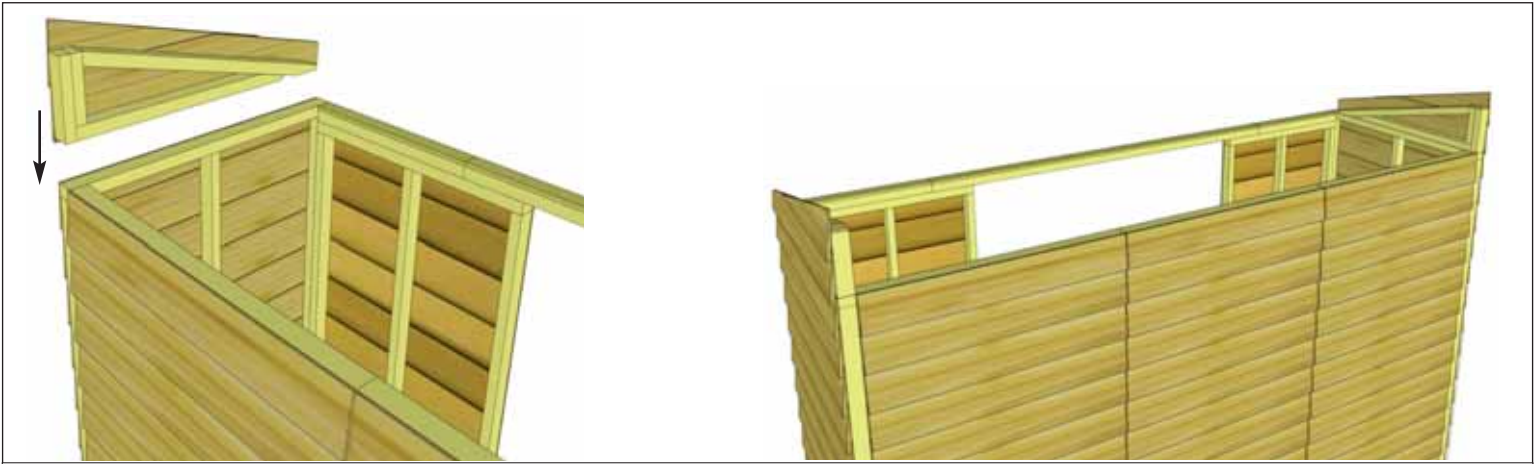

19. Complete opposite Angled Wall Extender positioning and attachment as per **Step 18**.

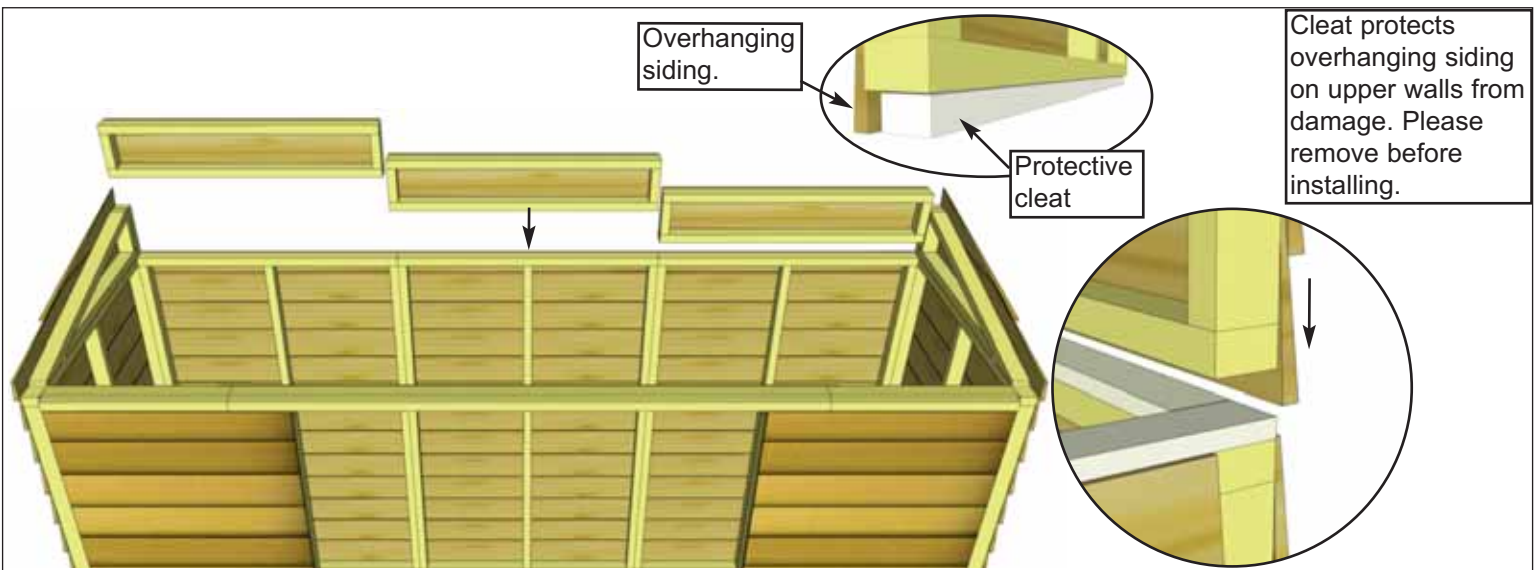

20. Place **2H - Rear Extender Walls** top framing of rear wall with bottom siding overlapping that of the rear wall.

Parts (Steps 20 - 21)
2H - Rear Extender Walls
 (2H - 45 1/2" wide) x 3

Hardware (Steps 20 - 21)
S1 - 2 1/2" Screws
 x 12 total

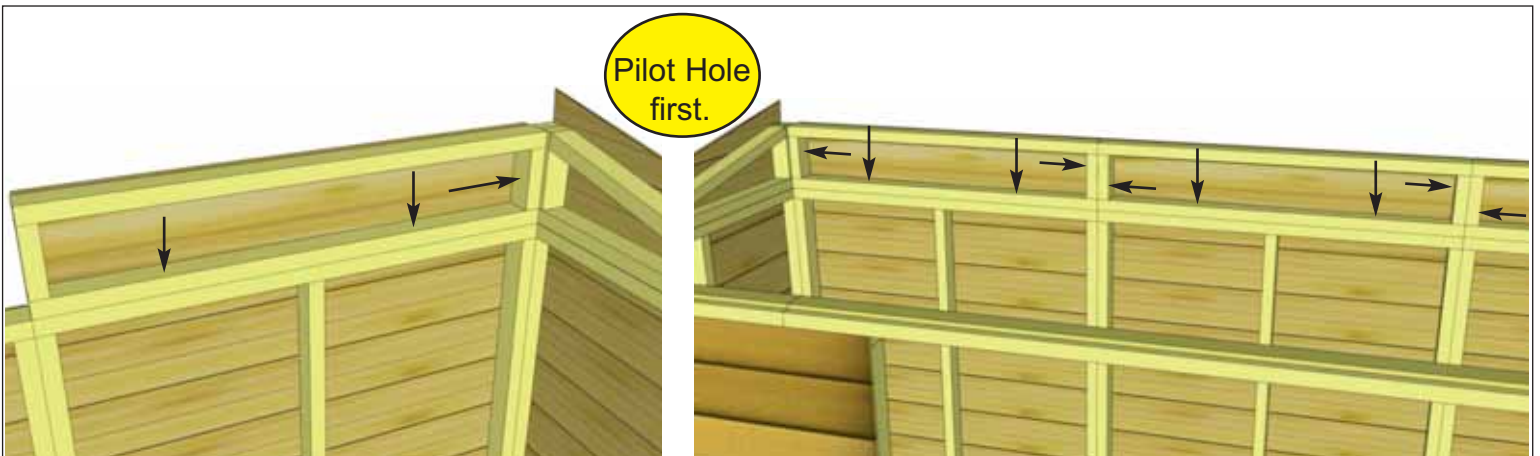

21. With 2x3 wall framing aligned, attach extender walls to rear wall top plate with **4 - 2 1/2" Screws** per wall.

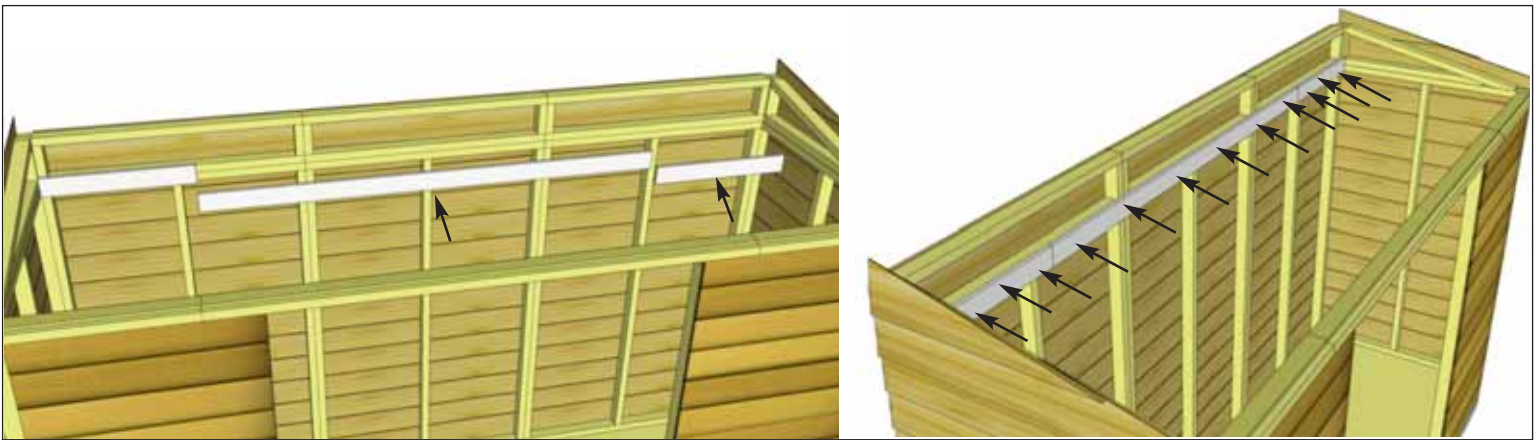

22. Attach **2I & 2J - Horizontal Wall Cleats** to Wall Extender bottom framing and Rear Wall top framing so that cleat is flush with extender framing. There are two short cleats and one long cleat. Alternate alignment of screws, so half screw into Wall Extender Framing and half into Rear Wall Top Framing. Use **3 - 1 1/4" Screws** per short cleat and **6 - 1 1/4" Screws** on the long cleat.

<u>Parts</u>	
2I - Horizontal Wall Cleat - Long (3/4" x 3 1/2" x 84") x 1	
2J - Horizontal Wall Cleats - Short (3/4" x 3 1/2" x 26 1/4") x 2	
<u>Hardware</u>	
S2 - 1 1/4" Screws x 12 total	

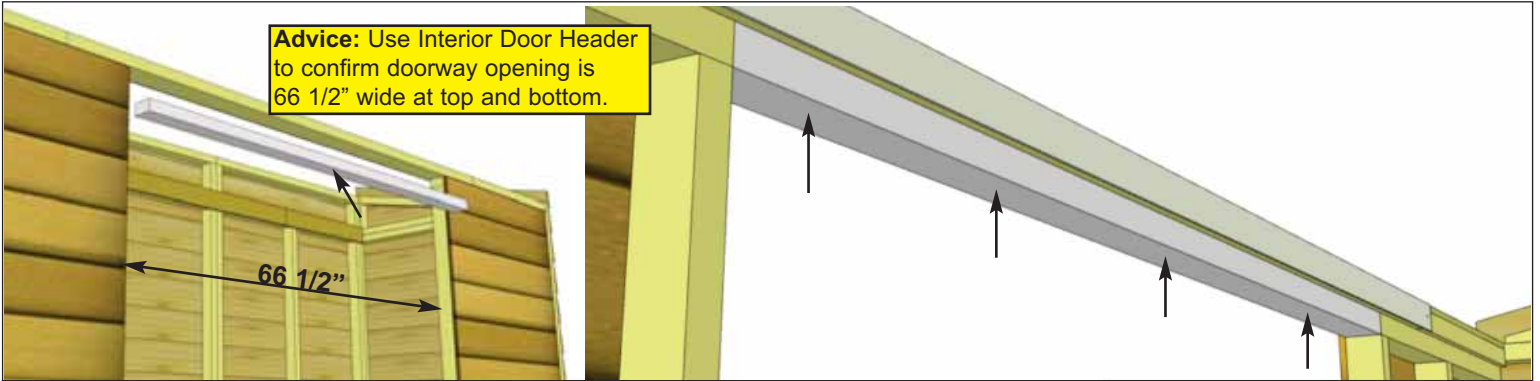

23. Attach **2EE - Interior Door Header** as shown above. Align with top framing of front walls. Attach with **4 - 2 1/2" Screws**. To complete Wall Section, attach bottom 2x3 wall plates to plywood floor with **2 - 2 1/2" Screws** per wall section. Prior to securing, make sure wall panels are aligned correctly on the floor. Refer to **Step 9**. Wall siding should overhang floor while 2x3 wall plates should sit flush with floor.

<u>Parts</u>	
2EE - Interior Door Header (1 1/2" x 3" x 66 1/2") x 1	
<u>Hardware</u>	
S1 - 2 1/2" Screws x 32 total	

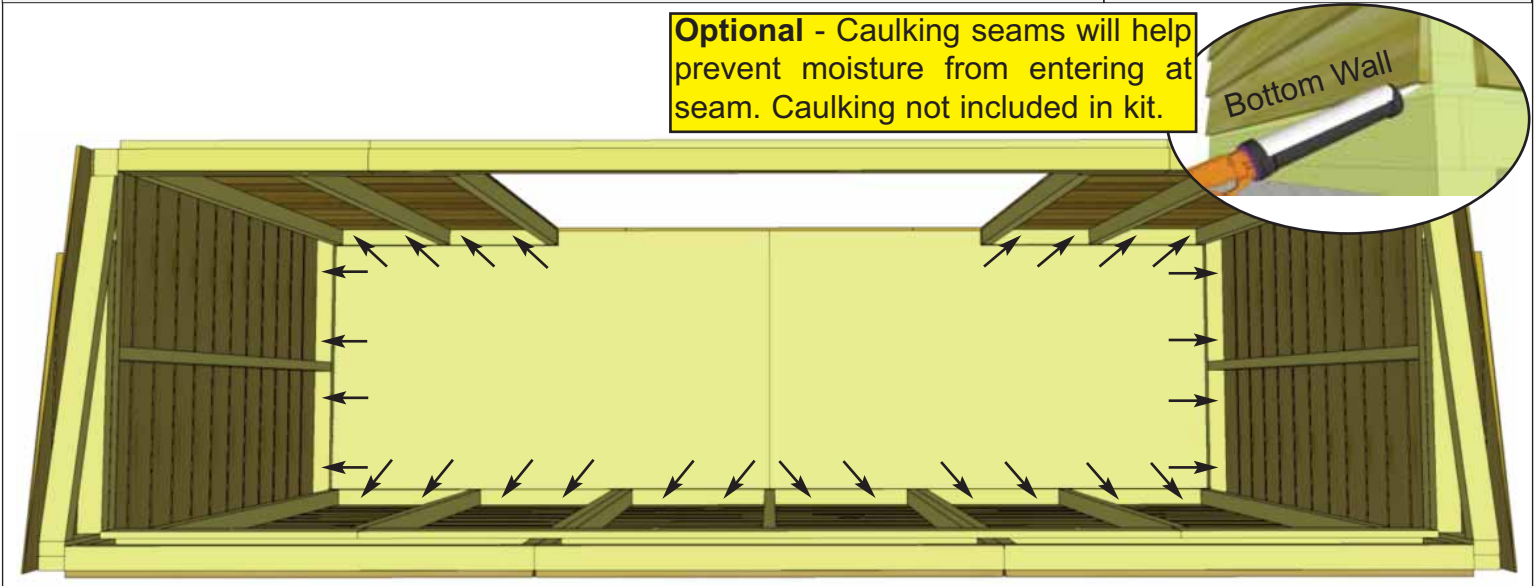

3. Rafter and Roof Section

Exploded view of all parts necessary to complete the Rafter and Roof Section. Identify all parts prior to starting.

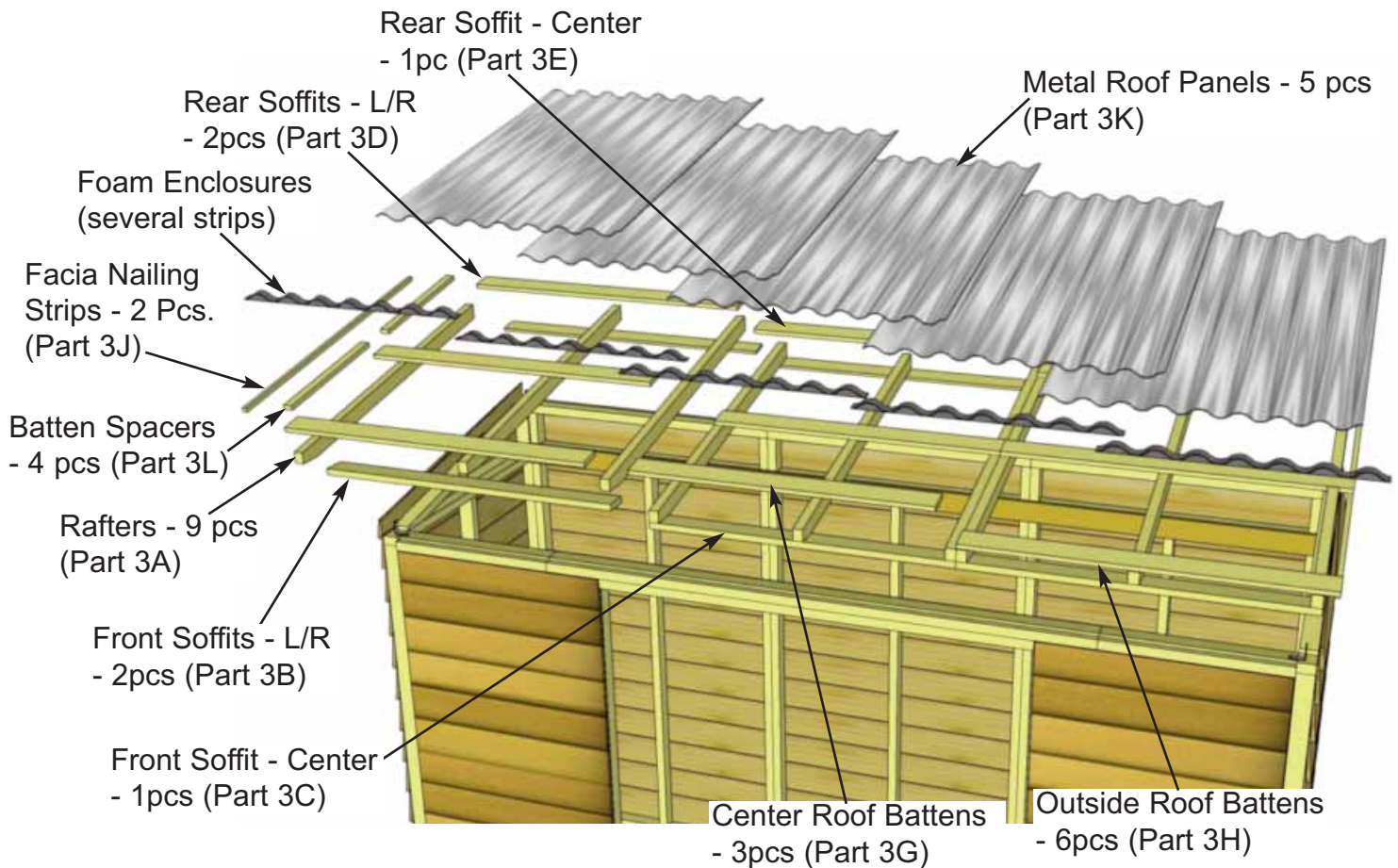

Advice: Prior to installing rafters, take time to confirm your walls are level, square and plumb.

Measure diagonal at top and bottom of walls corner-to-corner. This should be approximately 142 1/4". More importantly, if measurements are not within 1/4", your walls are not square.

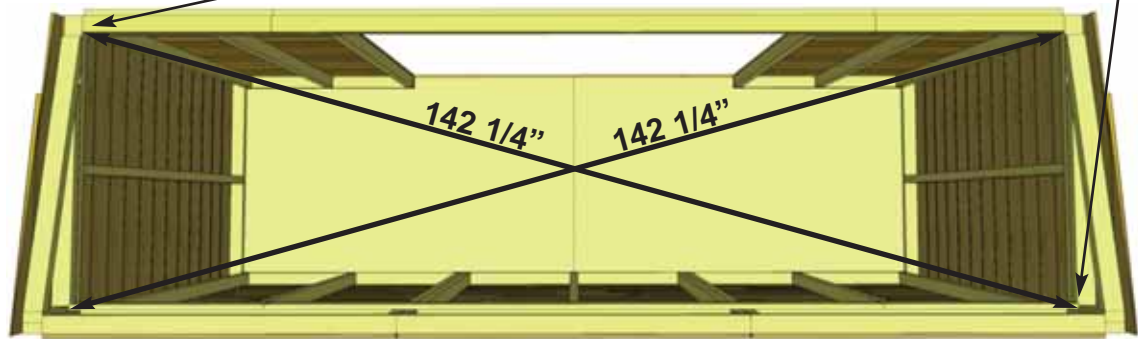
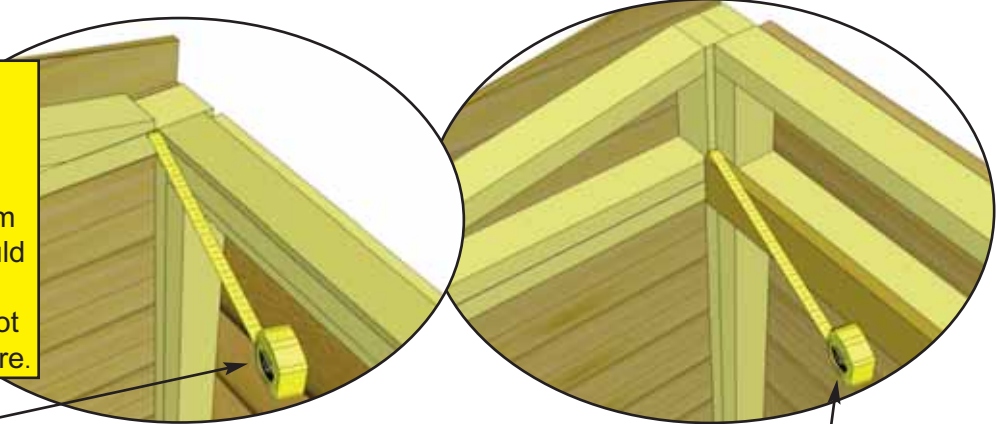

Note: We recommend you drill a 1/8" pilot hole for each screw, to avoid splitting wood. The hole depth should be equal to 3/4 the length of screw.

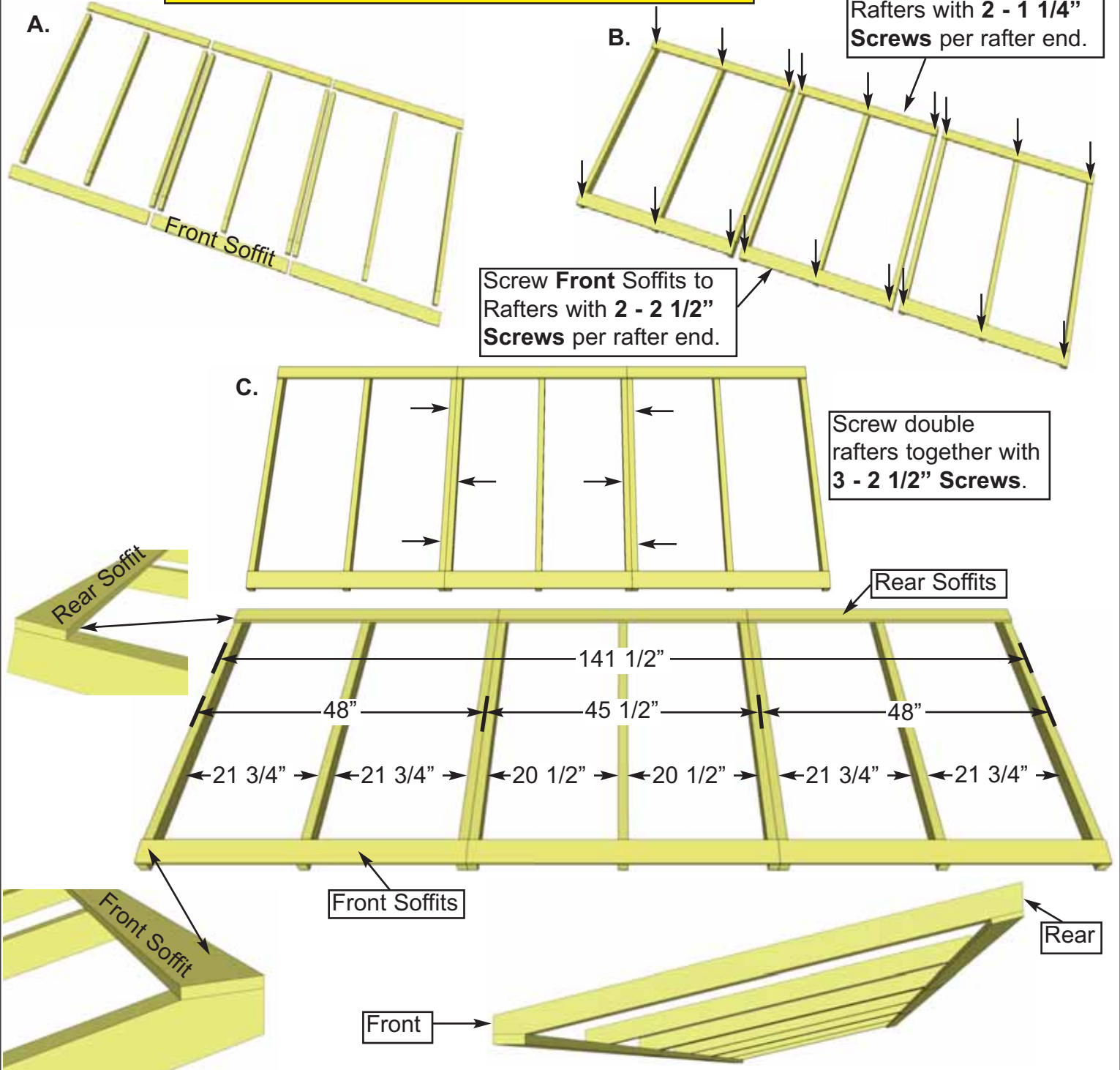

24. Locate **3A - Rafters**, **3B & 3C - Front Soffits** and **3D & 3E - Rear Soffits**. Lay out on level ground and assemble as shown above in Illustrations **A** through **C** below. Attach Soffit Boards flush to end of outside rafters. Attach Front Soffits with **2 - 2 1/2" Screws** per rafter end. Attach Rear Soffits with **2 - 1 1/4" Screws** per rafter end.

Important: Drill pilot holes in Soffit ends to prevent splitting. Attach double rafters as illustrated above with **3 - 2 1/2" Screws** per rafter/rafter connection.

Parts	
3A - Rafters	(1 1/2" x 2 1/2" x 54") x 9
3B - Front Soffits - Sides	(1" x 3 1/2" x 48") x 2
3C - Front Soffit - Center	(1" x 3 1/2" x 45 1/2") x 1
3D - Rear Soffits - Sides	(1/2" x 3 1/2" x 48") x 2
3E - Rear Soffit - Center	(1/2" x 3 1/2" x 45 1/2") x 1

Hardware	
S1 - 2 1/2" Screws	x 24 total
S2 - 1 1/4" Screws	x 18 total

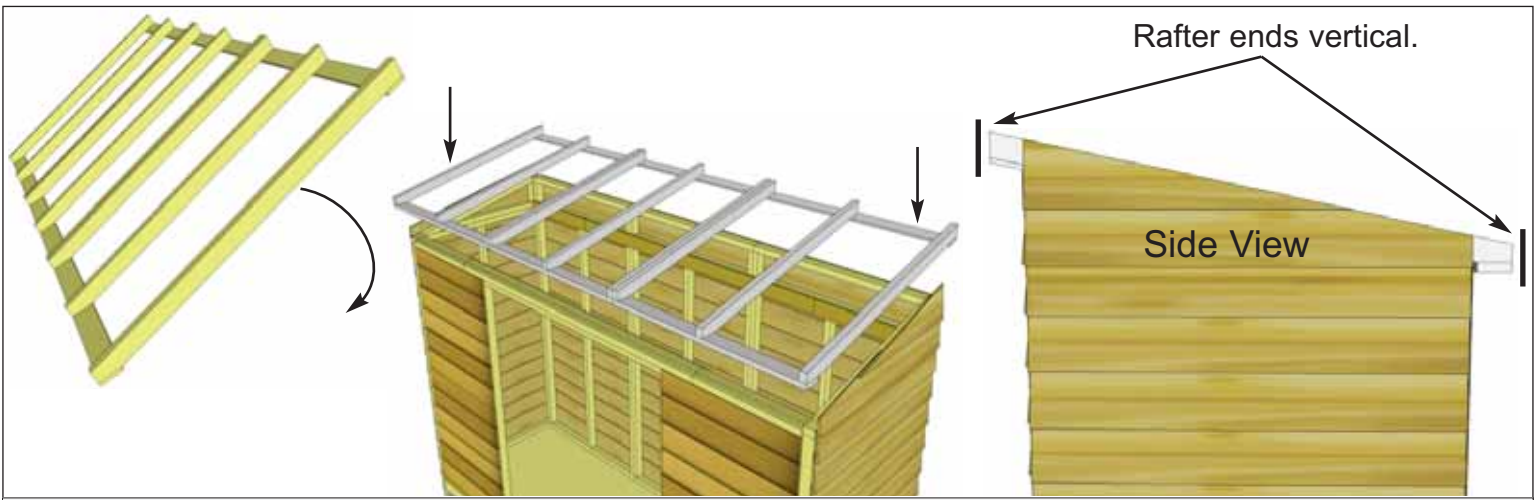

25. Carefully flip completed Rafter Section over so Front Soffit is facing the front and place on SpaceSaver walls. **Note:** Double check that your Rafter Section is positioned correctly by ensuring the ends of the Rafters are sloped vertically as shown above.

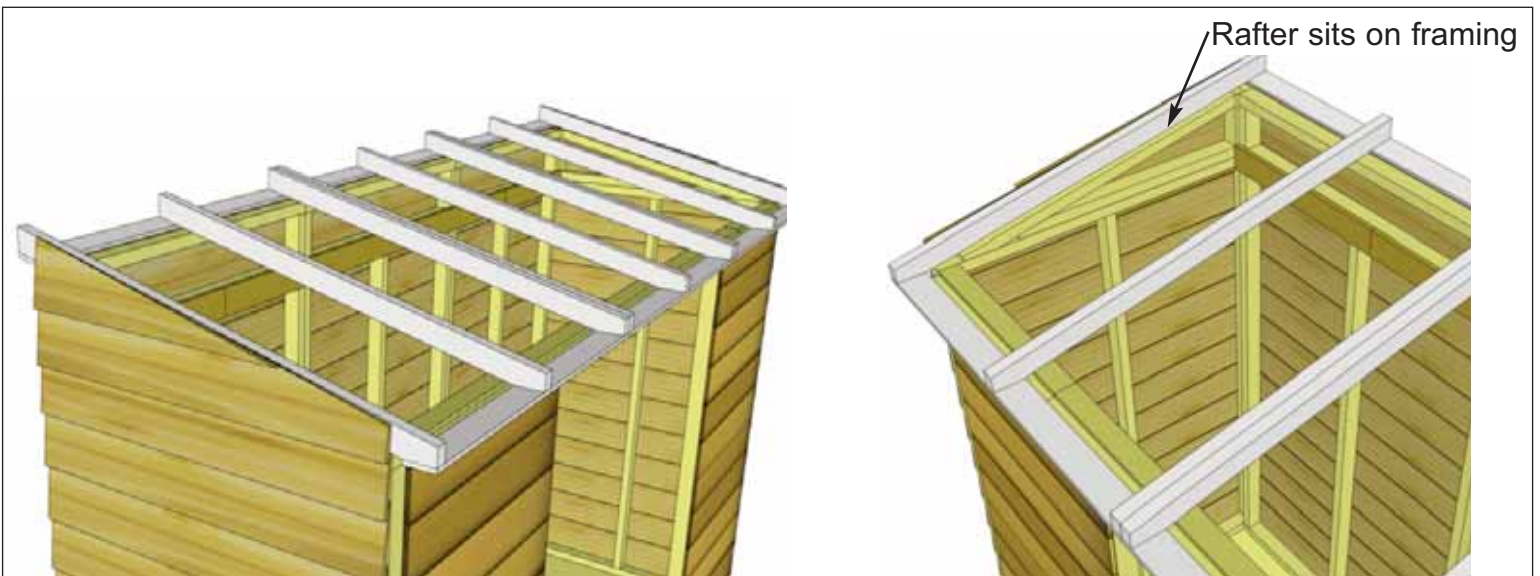

26. Position completed Rafter Section on top of walls. Outside Rafters will sit on Extension Wall framing and be positioned equally from side to side.



27. When Rafter Section is positioned correctly, both Front and Rear Soffits will sit approximately 1/8" away from wall siding. This can vary slightly.

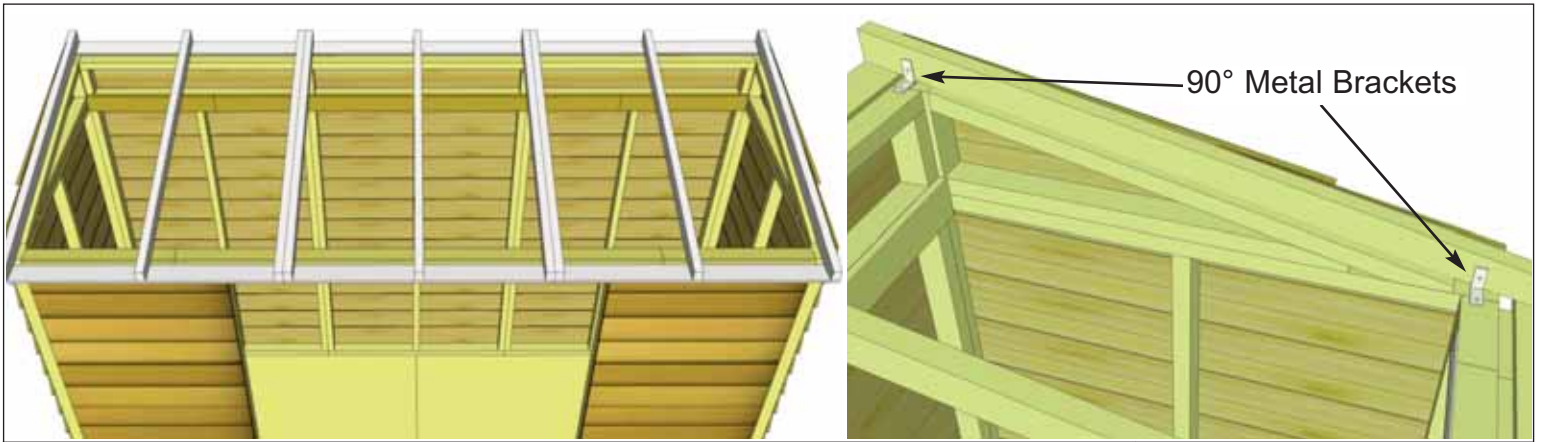

28. With Rafter Section correctly aligned, secure rafters to walls using **2 - 90° Metal Brackets** per side. Attach each brackets with **4 - 1 1/4" Screws**. Screw into Wall Extension Framing at the rear and Wall Panel top framing at the front. Complete both sides.

Hardware
Y2 - 90° Metal Bracket
 x 4 total
S2 - 1 1/4" Screws
 x 16 total

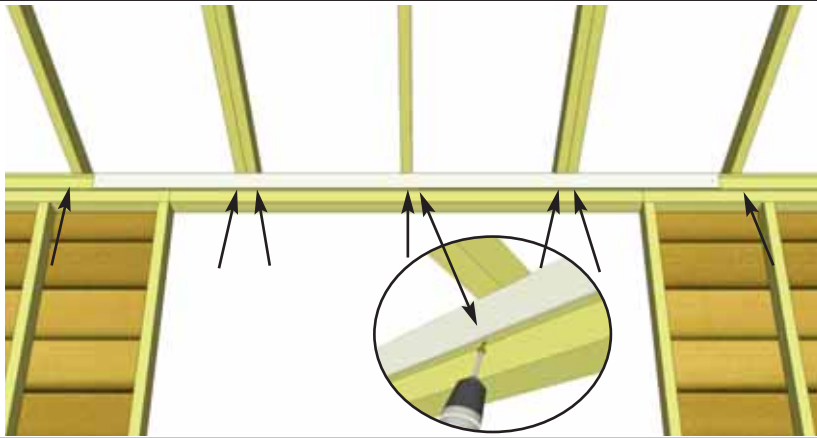

29. With outside rafters properly secured, attach remaining interior rafters using **1 - 3" Screw** per rafter end at the front of the shed. Screw into rafters from inside of Header on an angle.

Hardware
S4 - 3" Screws
 x 7 total

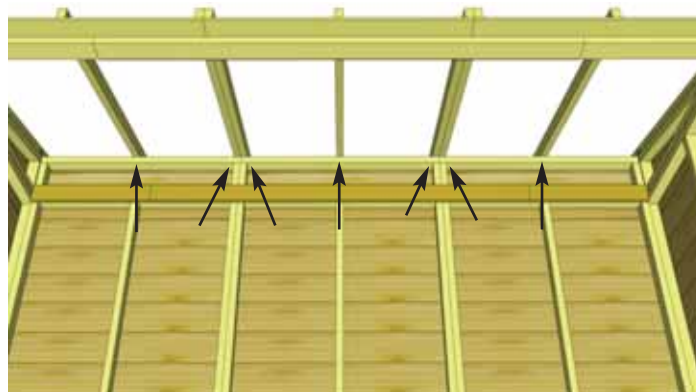

30. With outside rafters properly secured, attach remaining interior rafters using **1 - 3" Screw** per rafter end at the rear of the shed. Screw into rafters from inside of Extender Wall Framing.

Hardware
S4 - 3" Screws
 x 7 total

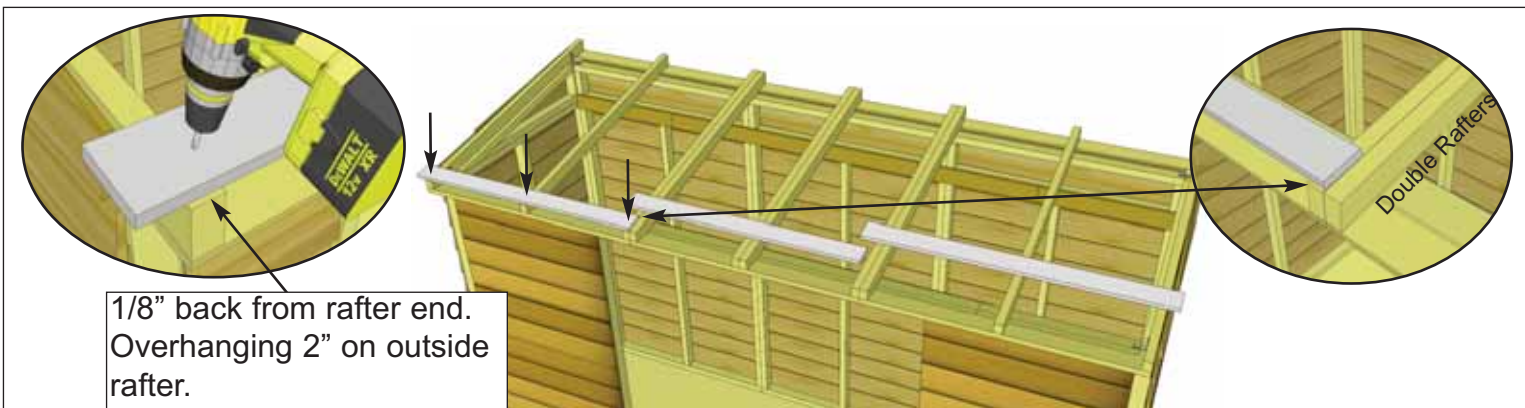

1/8" back from rafter end.
Overhanging 2" on outside rafter.

31. Locate first row of Roof Battens (**3/4" thick x 3 1/2" wide x 50" long x 2 - Outside & 1 @ 45 1/2" - Center**). Position on front of roof rafters. Place 1/8" back from end of rafter. Batten will sit evenly on center rafters overhanging 2" on the outside rafters. Attach batten with **1 - 1 1/4" Screw** per each rafter. Pre-drill with 1/8" drill bit first to prevent end from splitting.

Parts (Steps 31 - 34)
3H - Roof Batten - Out
 (3/4" x 3 1/5" x 50") x 6
3G - Roof Batten - Ctr
 (3/4" x 3 1/5" x 45 1/2") x 3
3L - Batten Spacers
 (3/4" x 1 1/2" x 21 5/8") x 4
 Hardware (Steps 31 - 34)
S2 - 1 1/4" Screws x 27 total

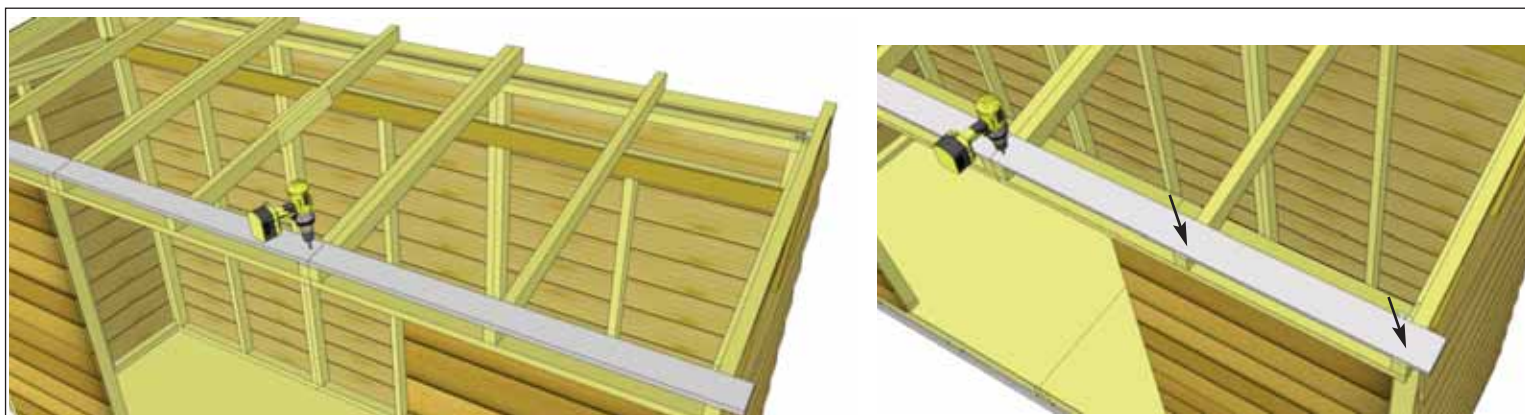

32. Position and attach Center Roof Batten (45 1/2" long) and Outside 50" long batten as per **Step 31**.

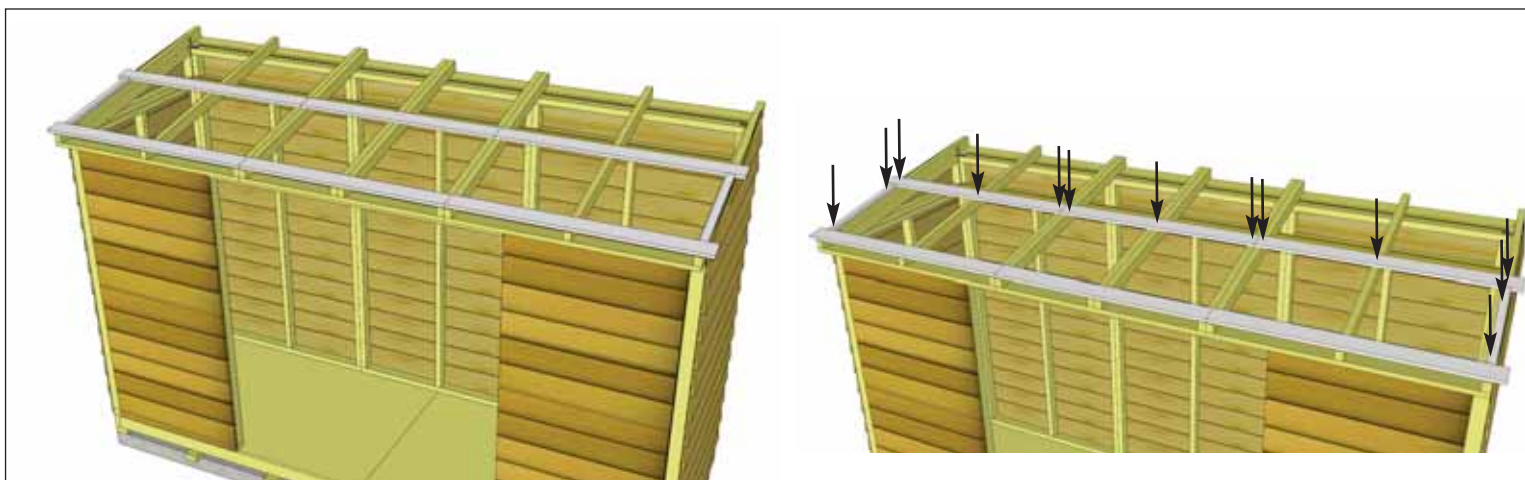

33. Locate **Batten Spacers**. Place one **Batten Spacer** above each Batten lengthwise along outside Rafter. Attach each Batten Spacer to outside Rafter with **2 - 1 1/4" screws** per Batten Spacer (4 total). Position and attach 2nd row of battens flush with Batten Spacers following **Step 31-32**.

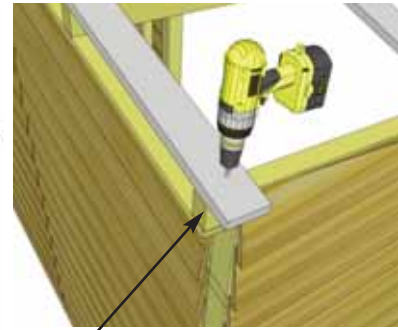
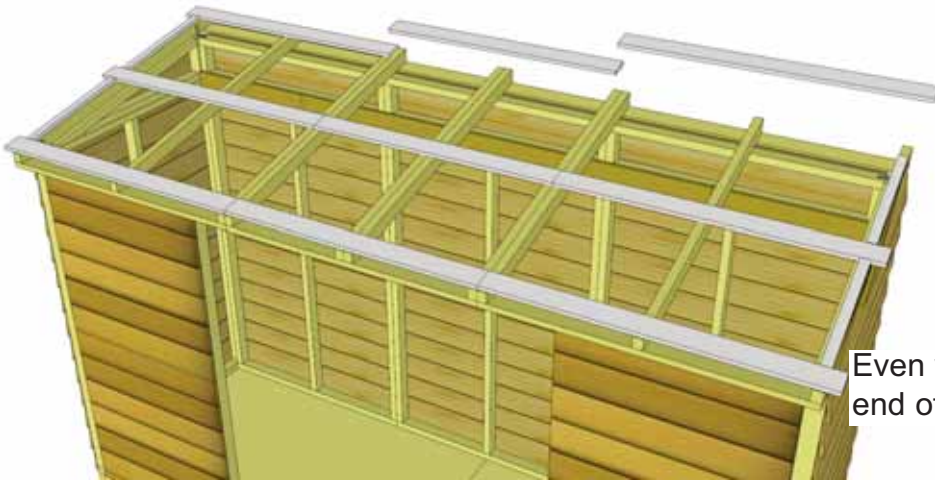

Even with
end of rafter.

34. Position and attach 3rd row of Battens (3G) and Batten Spacers following **Steps 31-33**. Space battens such that they are flush with the previous row of Batten Spacers as shown above.

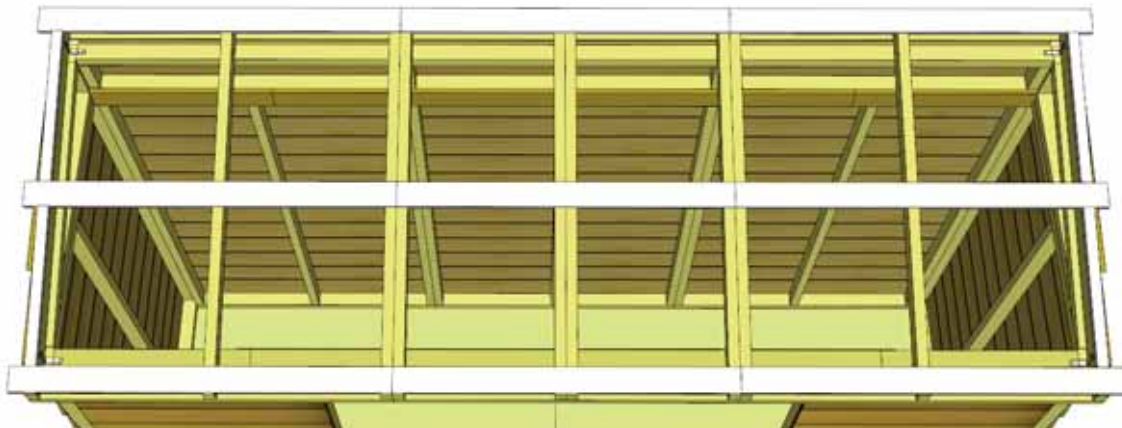

Top View of Roof Battens

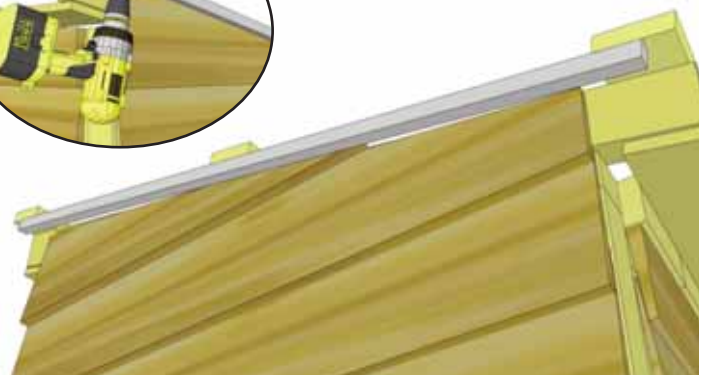

35. Center **Rafter/Facia Nailing Plates** (2) (3/4" x 3/4" x 51") underneath outside of each batten. Attach with 3 - 1 1/4" screws evenly spaced into the batten. The Rafter/Facia Nailing Plate provides for a greater nailing surface later when you attach side facia.

<u>Parts</u>
3J - Nailing Strips (3/4" x 3/4" x 51") x 2
<u>Hardware</u>
S2 - 1 1/4" Screws x 6 total

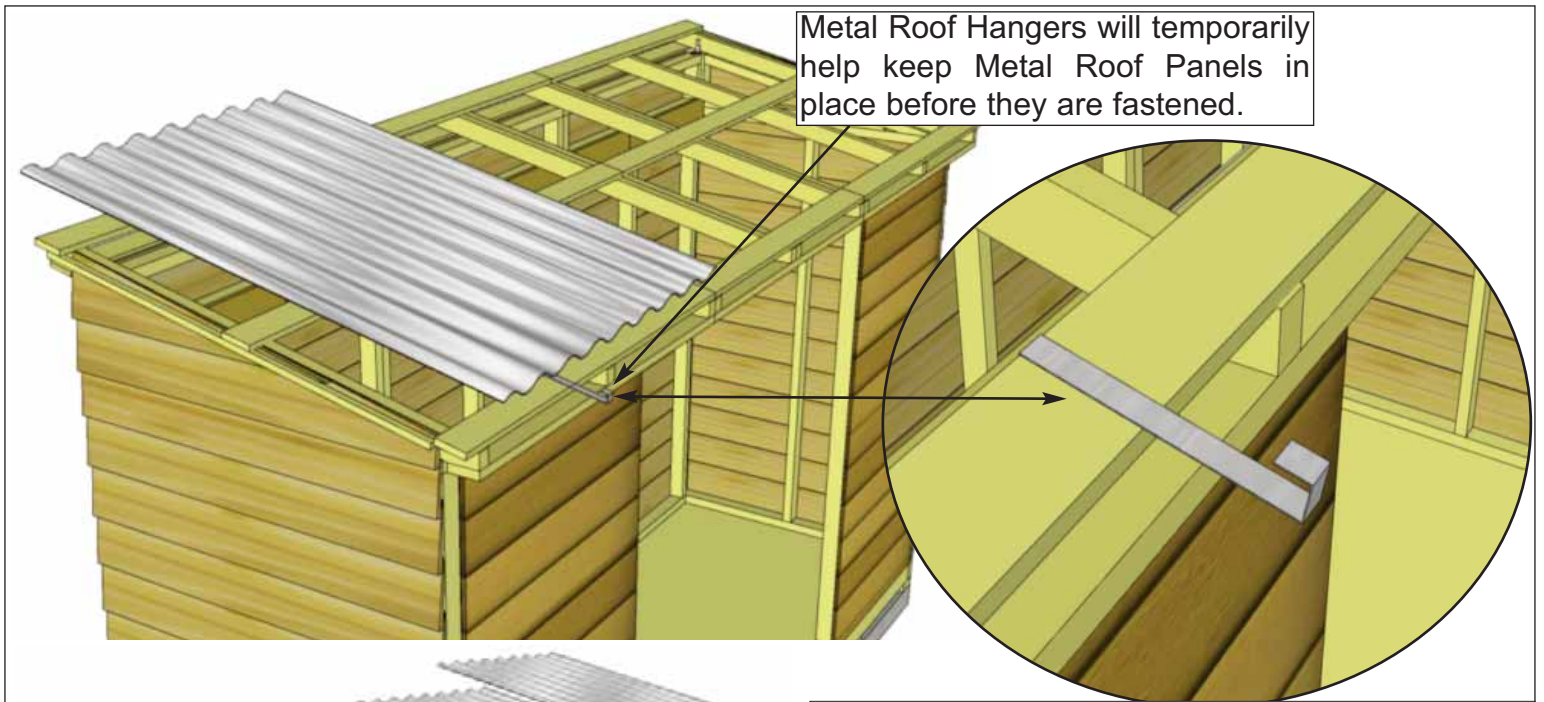

Metal Roof Hangers will temporarily help keep Metal Roof Panels in place before they are fastened.



36. Locate all **Metal Roof Hangers** and **Metal Roof Panels** (Identical). To temporarily help hold the **Metal Roof Panel** in place, hook a **Metal Roof Hanger** onto the lower **Batten** approximately where the center of the first **Panel** will be. Place the first **Metal Roof Panel** on **Battens**. Do not fasten **Panels** down until **Steps 40 & 42**. Place other two **Metal Roof Panels** with **Hangers** the same way.

<u>Parts</u>	<u>Hardware</u>
3K - Metal Roof Panels (39" x 58 1/2") x 5	Y38 - Metal Roof Hangers x 5 total

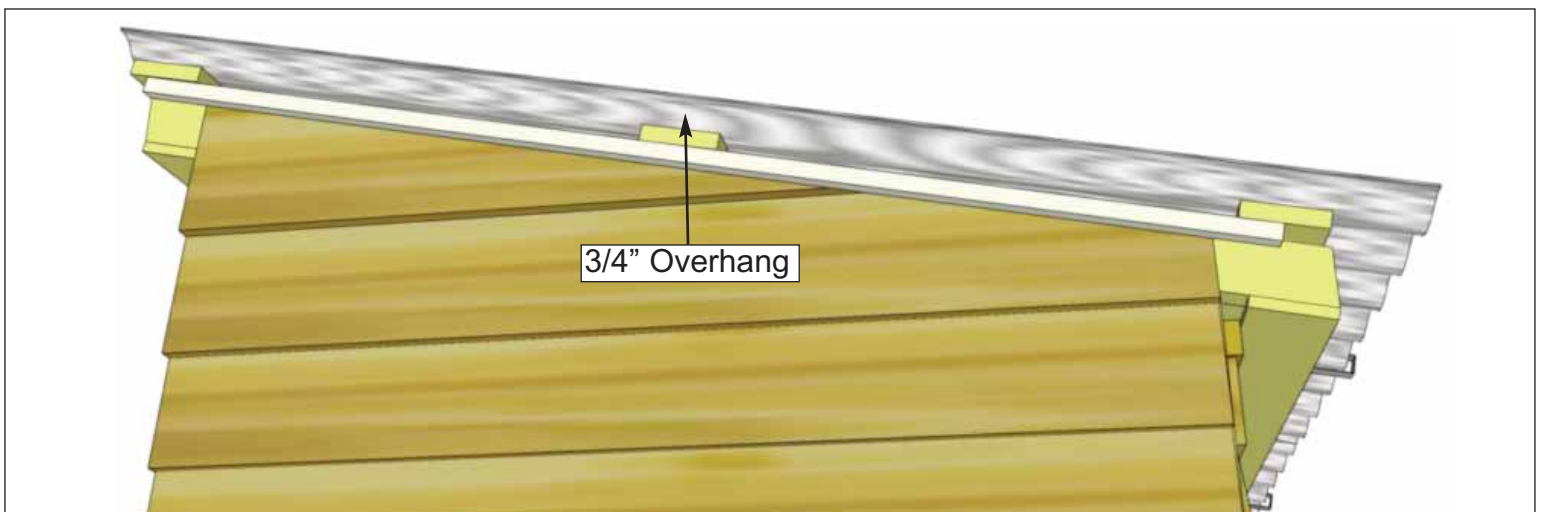

37. Overhang the **Metal Roof Panels** past the **Battens** on the sides by approximately 3/4". The overhang on front and back will be set by the **Metal Roof Hangers**, but should be approximately 1" on the back and approximately 4" on the front.

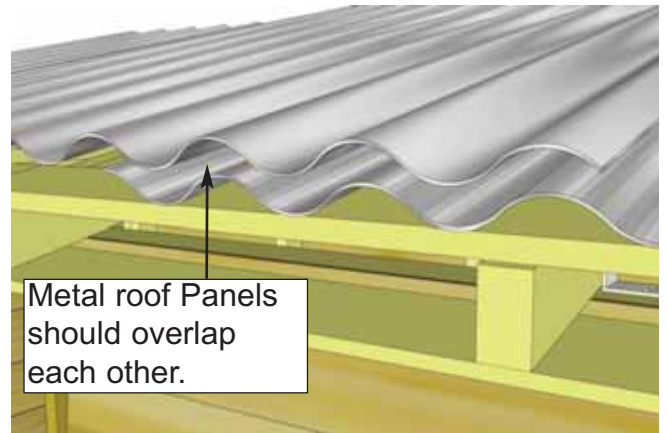
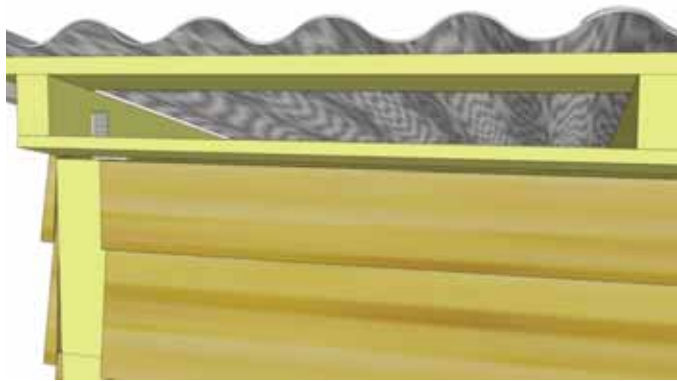

38. Adjust the position of remaining **Metal Roof Panels** on **Battens** as per **Step 37**. Overlap **Metal Roof Panels** to achieve the desired overall width. Overall width past the end of **Battens** can vary from 1" - 3", depending on your personal preference.

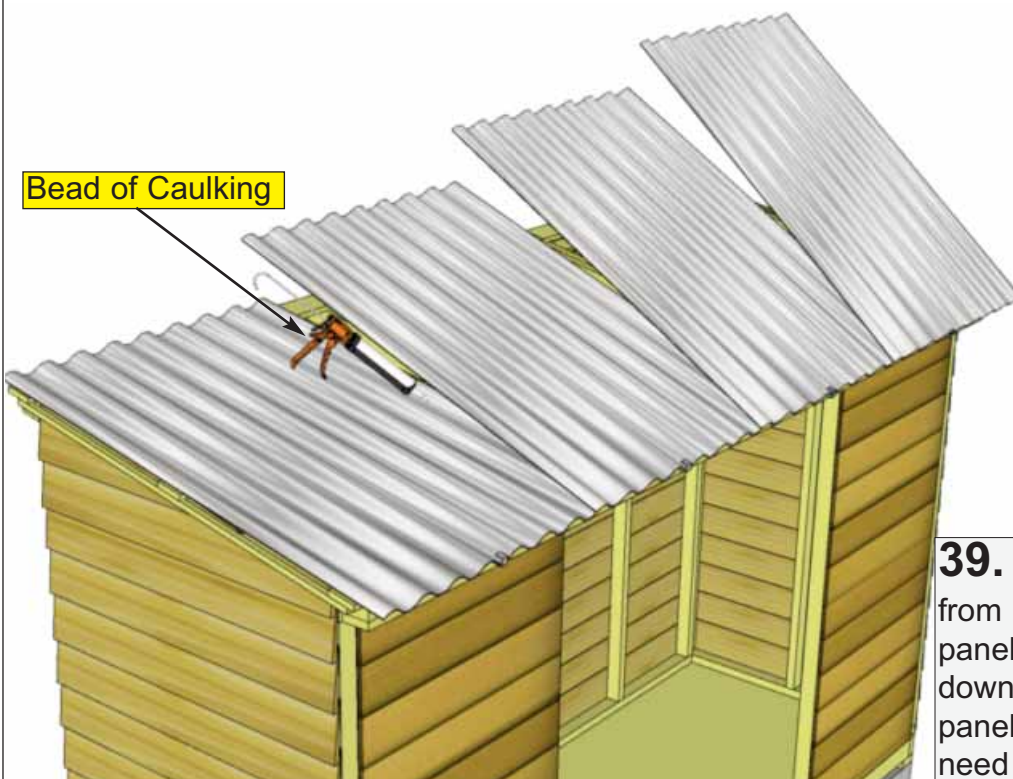

39. Once Metal Roof is spaced correctly from side-to-side and top-to-bottom, lift panels up and run a bead of caulking down the overlapping seams of each panel to seal the joints. You will likely need assistance from a helper in this step.

Loosely attach middle row before removing Metal Roof Hangers. Screw into center of Battens.

Note: Metal Roof Hangers will need to be removed in **Step 41**.

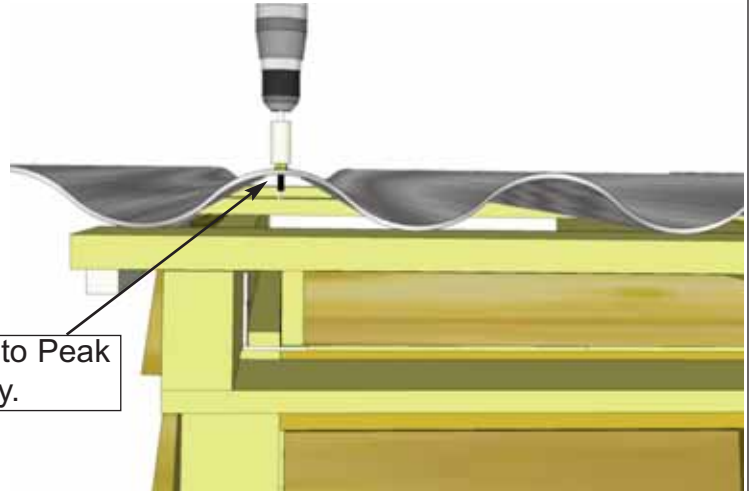
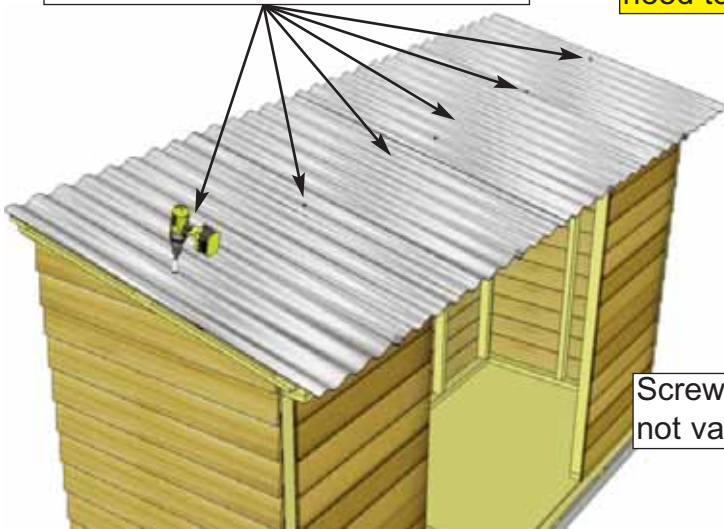

Screw into Peak not valley.

40. Using 5 - 2" Metal Screws and 1/4" Nut Driver (included), partially secure Metal Roof Panels down to the middle Batten row. Only fasten screws half way so the Metal Roof Hangers can be removed. Metal screw is self-tapping, screw into the center of Battens.

Hardware
2" Metal Roof Screws
 x 6 total

Ten more 2" Metal Screws will be required to further secure Metal Roof Panels and to complete Metal Ridge Caps in later steps.

Remove Metal Roof Hangers

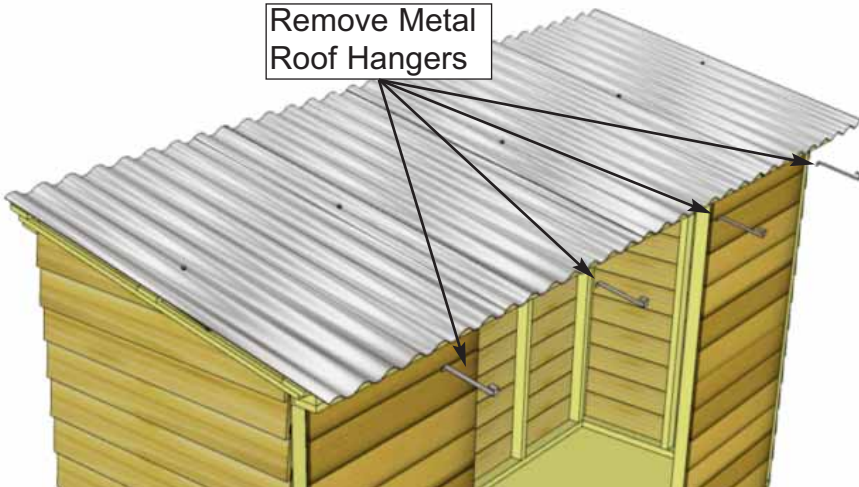

41. Before fully fastening Metal Roof Panels down, remove the Metal Roof Hangers and insert Foam Enclosures between Metal Roof Panels and Battens at the front/bottom. Enclosures will prevent moisture and unwanted bugs, etc from entering your shed from here.

Parts
Foam Enclosures x 4 total



Insert Foam Enclosures

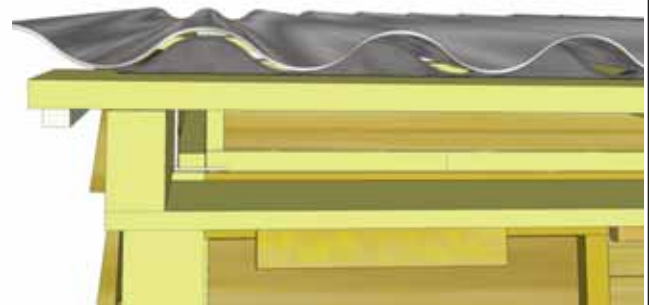

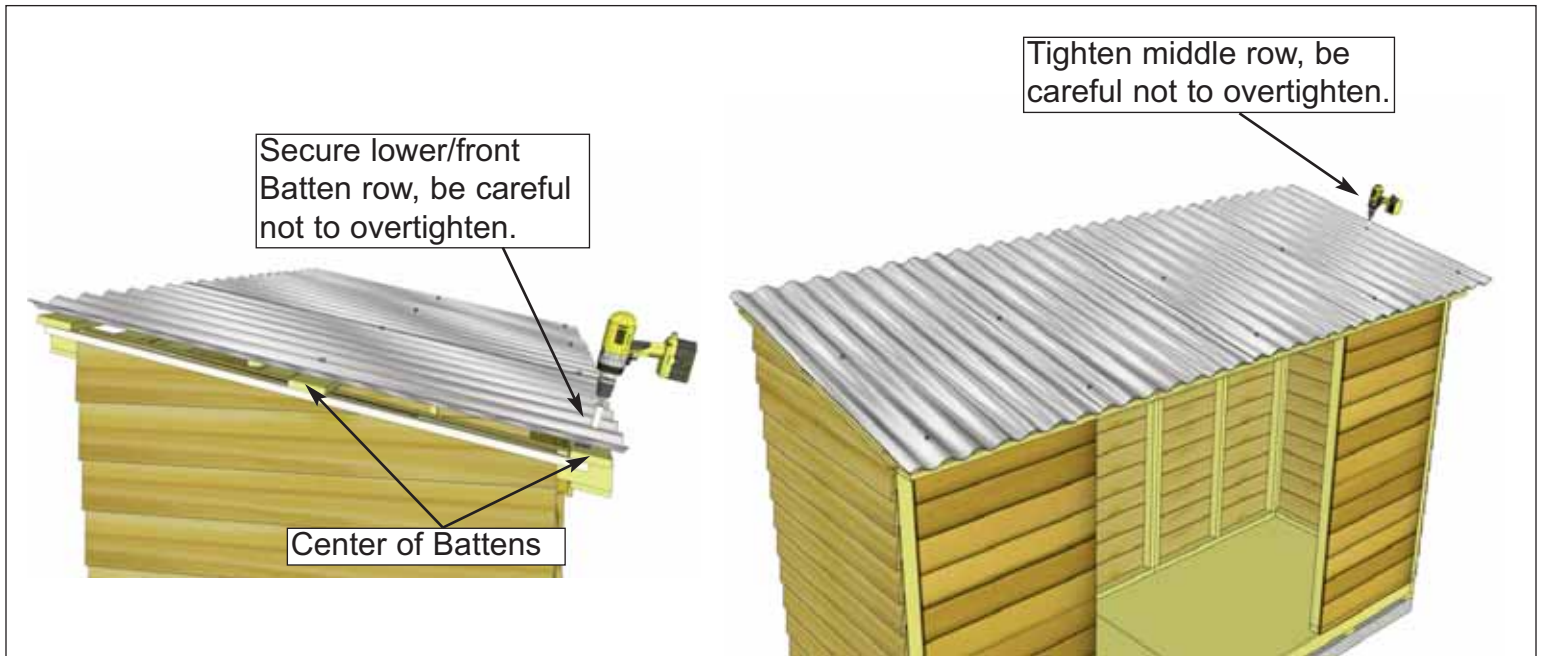

42. Using 5 - 2" Metal Screws and 1/4" Nut Driver, secure Metal Roof Panels down to lower/front Batten row. Tighten screws in middle Batten row which were partially attached in Step 40. Do not overtighten!

Hardware
2" Metal Roof Screws
 x 6 total

Note: If Top Siding Pc. for Angle Wall was not installed in Step 16 it can be done now. Attach with 3 - 1 1/2" Finishing Nails per piece.

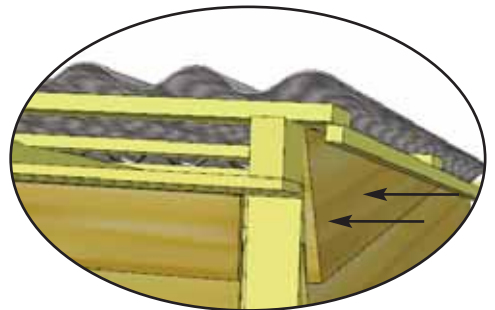
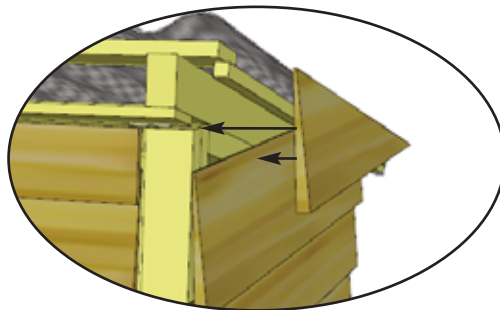

4. Trim & Miscellaneous Section

Exploded view of all parts necessary to complete the Skirting, Trim, Facia and Miscellaneous Pieces. Identify all parts prior to starting.

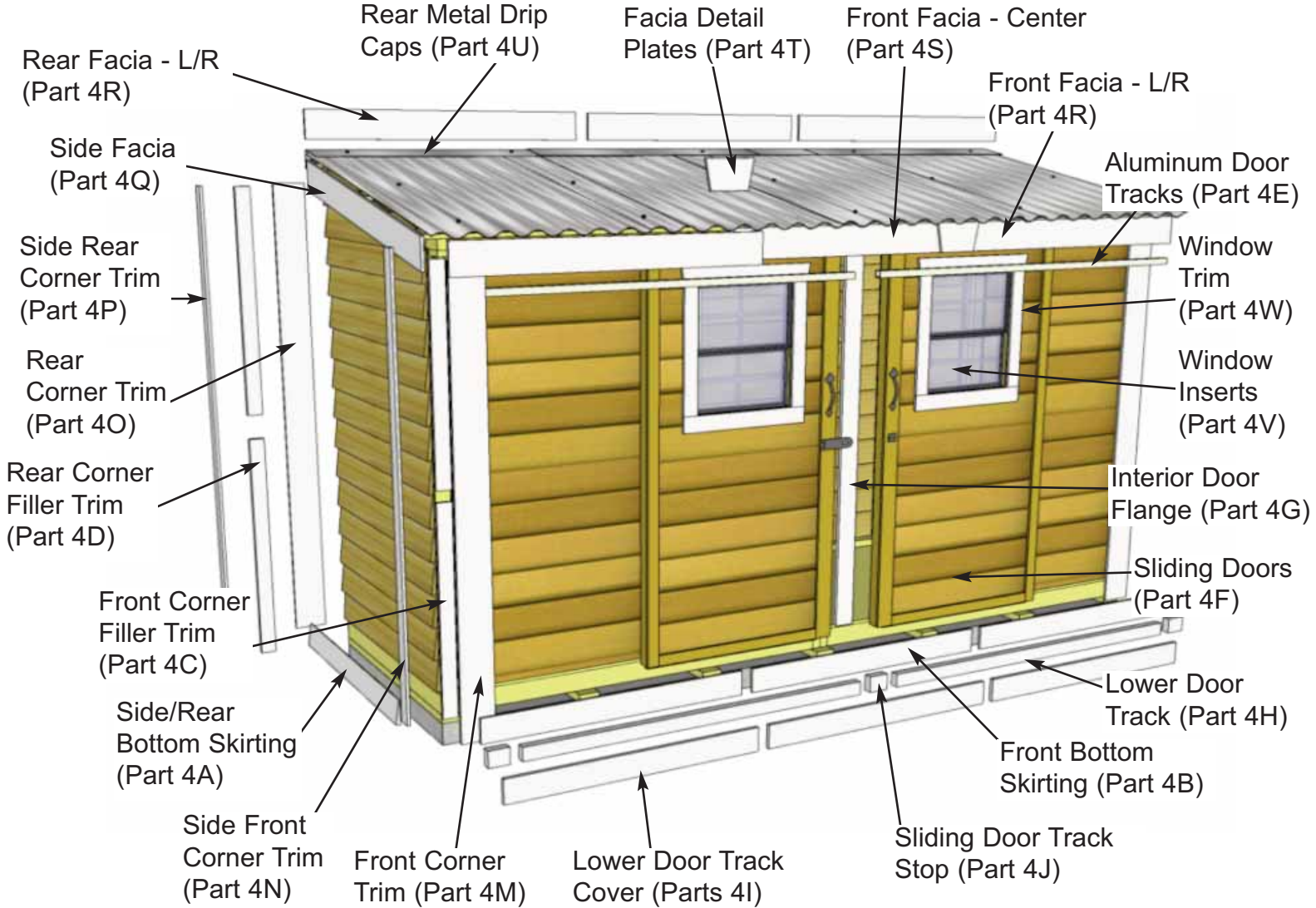

Note: All Trim, Facia, and Bottom Skirting pieces will be positioned rough face out when installed.

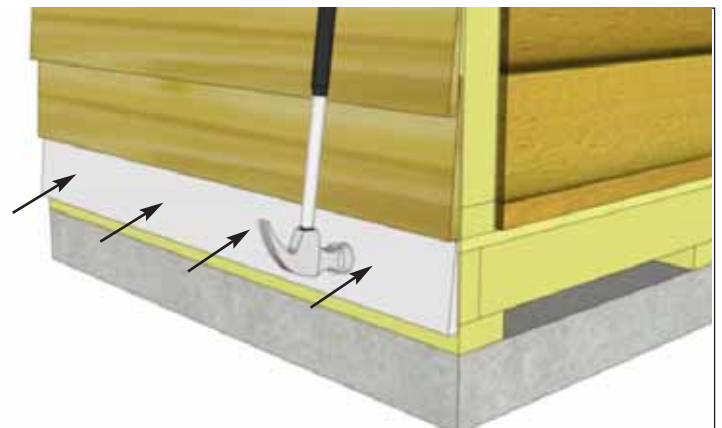
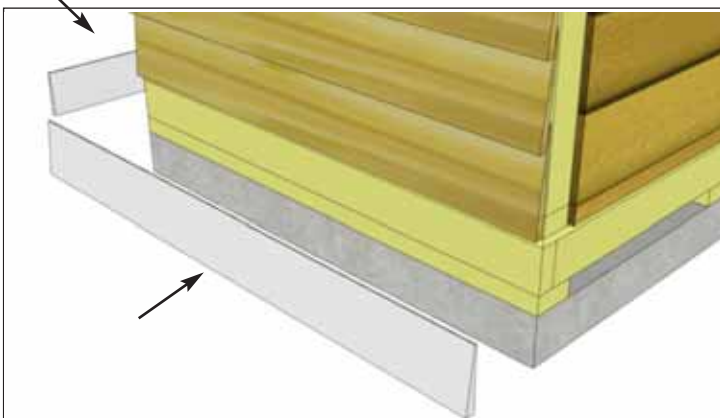

43. Attach **4A - Bottom Skirting** around the base of the shed. Skirting will hide floor framing. Start with side skirting pieces first and attach with **4 - 1 1/2" Finishing Nails** per piece.

Parts (Steps 43 - 44)

4A - Side/Rear Bottom Skirting - Bevel
(3/4" x 4 1/2" x 45 1/4") x 5

Hardware (Steps 43 - 44)

N1 - 1 1/2" Finishing Nails x 20 total

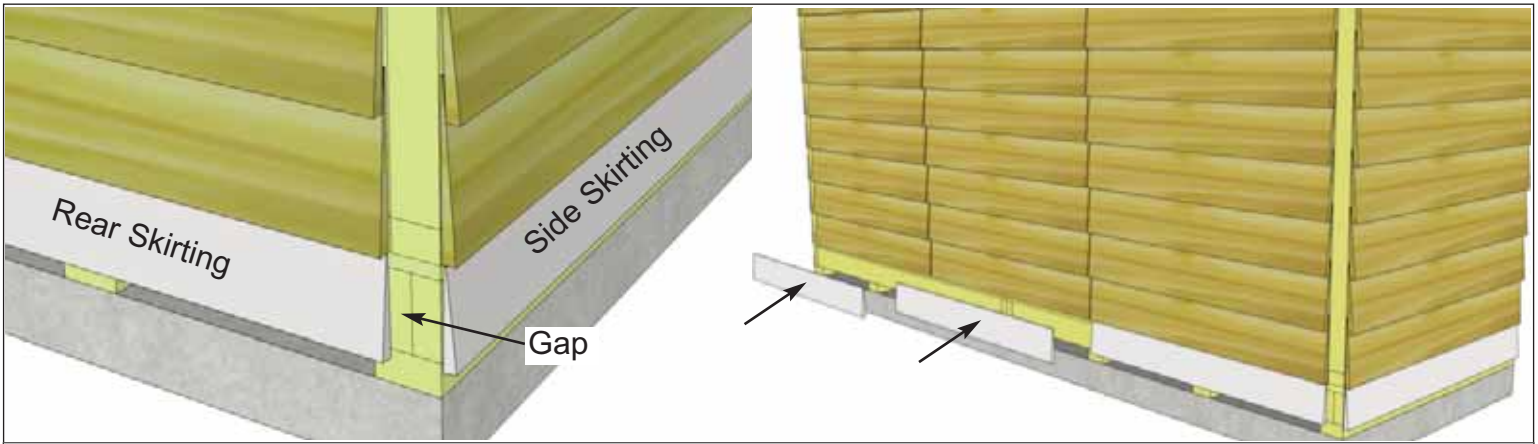

44. Gaps on outside will be covered by Corner Trim later. Complete side and rear skirting attachments.

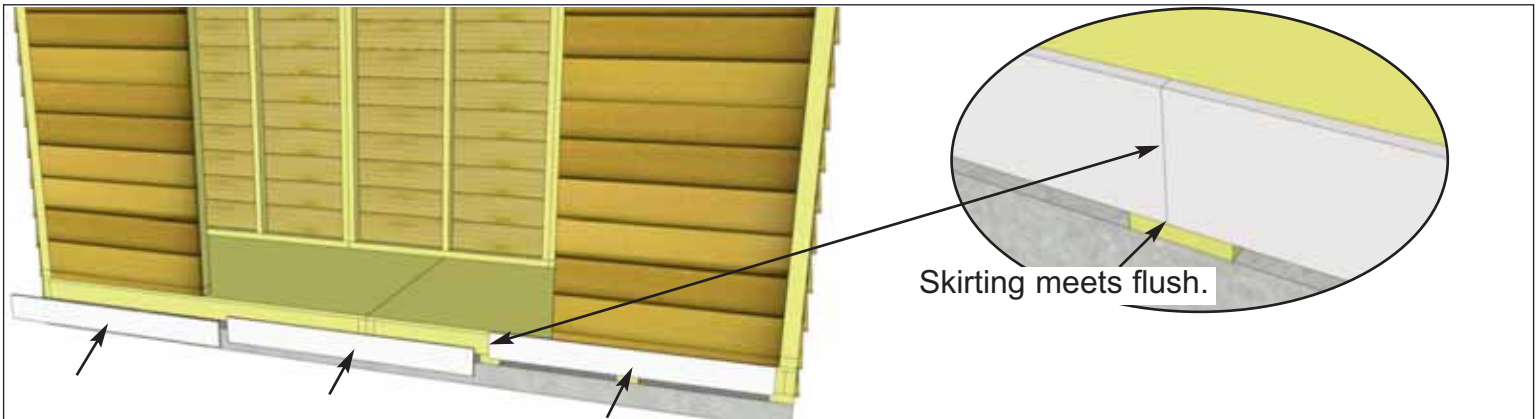

45. Attach **4B - Front Bottom Skirting** with **4 - 1 1/2" Finishing Nails** per piece as per **Steps 43 - 44.**

Parts
4B - Front Bottom Skirting
(1/2" x 4" x 45 1/4") x 3

Hardware
N1 - 1 1/2" Finishing Nails
x 12 total



46. Position and attach **4C - Front Corner Filler Trim** with **4 - 1 1/2" Finishing Nails** per piece. Filler trims won't be visible because they serve as nailing strips for the Corner Trims which will be attached later.

Parts
4C - Front Corner Filler Trim
(1/2" x 2 1/2" x 38") x 4

Hardware
N1 - 1 1/2" Finishing Nails x 16 total

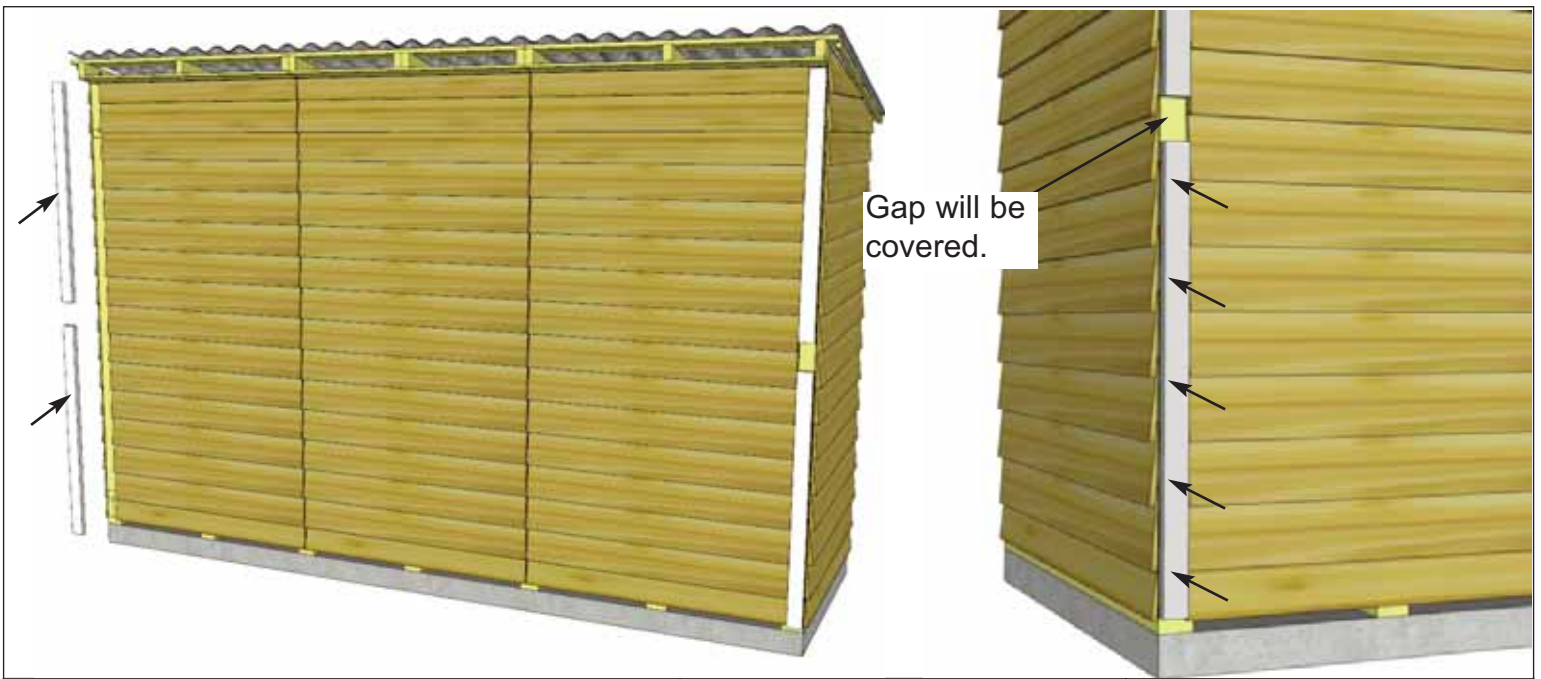

<p>47. Position and attach 4D - Rear Corner Filler Trim with 5 - 1 1/2" Finishing Nails per piece as per Step 46.</p>	<p><u>Parts</u> 4D - Rear Corner Filler Trim (7/8" x 2 1/2" x 42") x 4</p>	<p><u>Hardware</u> N1 - 1 1/2" Finishing Nails x 20 total</p>
---	---	--



<p>48. Position 4E - Aluminum Door Tracks on bottom of Front Soffits, spaced approximately 3/8" from Door Header. 4Y - Extra Piece Lap Siding can be used as a spacer for track. Tracks should meet at the center of the door opening below middle rafter. Attach with 8 - 1 1/4" Screws per track.</p>	<p><u>Parts</u> 4E - Aluminum Door Track x 2</p> <p><u>Hardware</u> S2 - 1 1/4" Screws x 16 total</p>
---	--

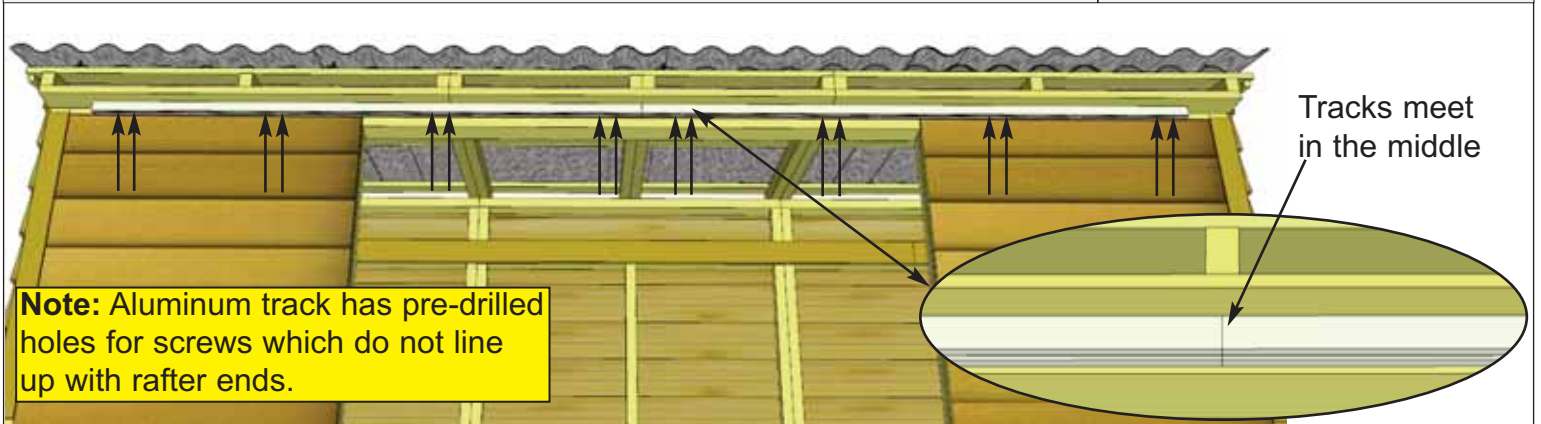

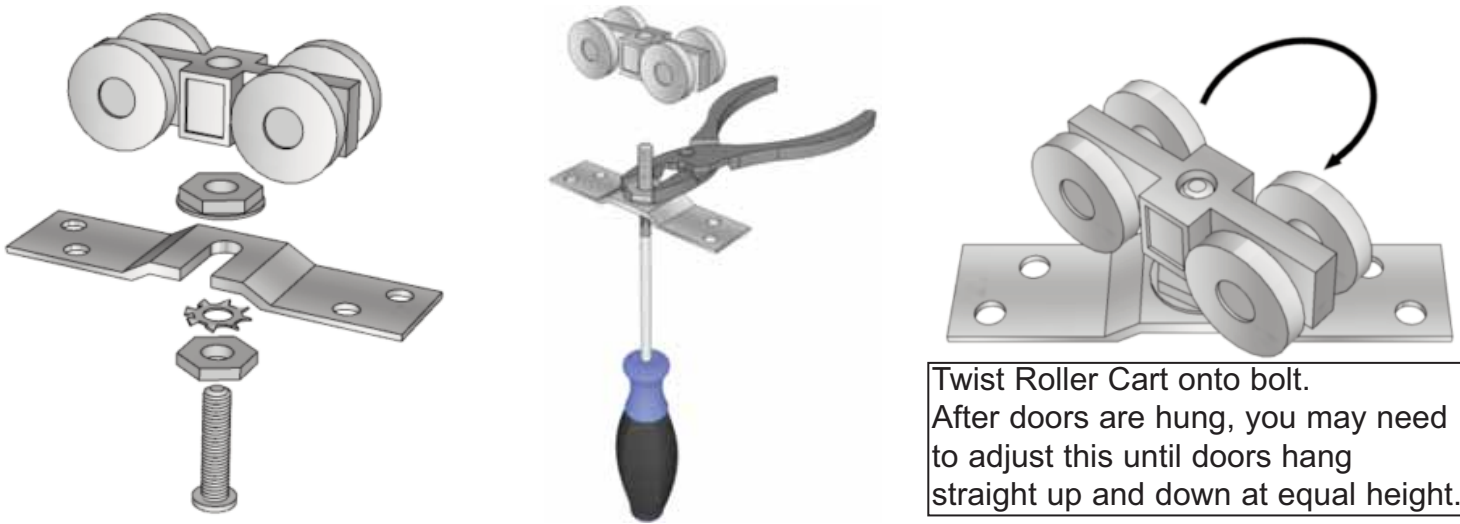

Twist Roller Cart onto bolt.
After doors are hung, you may need to adjust this until doors hang straight up and down at equal height.

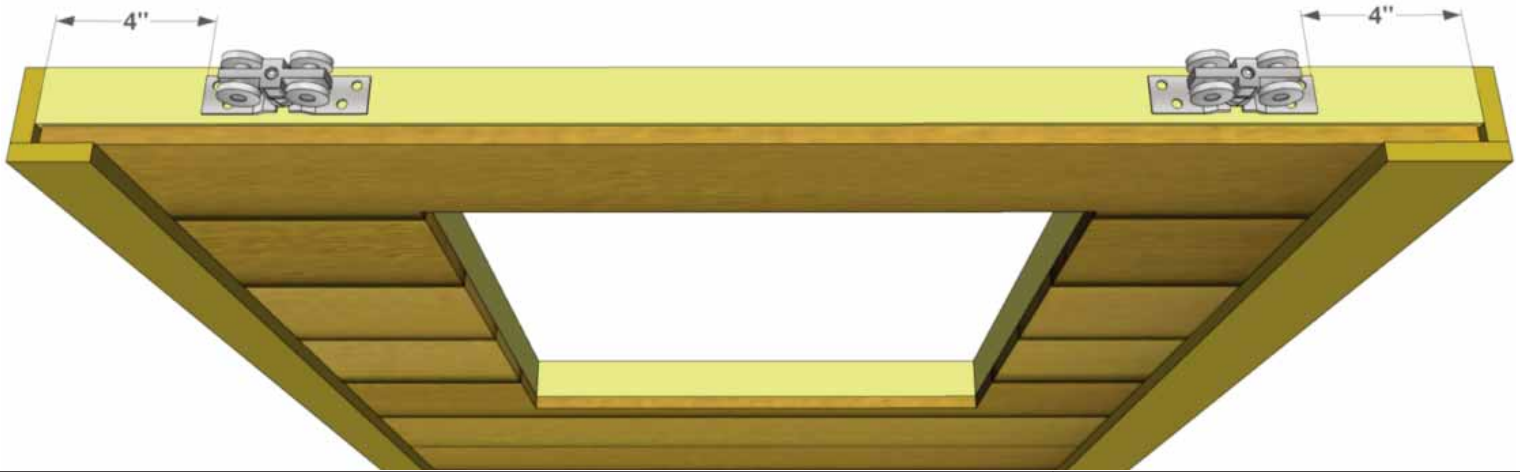

49. Locate all four **Y35 - Roller Assemblies**. Before attaching to top of doors, assemble the units as shown above. Attach two Roller Assemblies to each door with **4 - 1 1/4" Screws** per Assembly, center on the door framing **4"** from each end as shown above.

Next, take Left Side Door and slide Rollers into the Aluminum Door Track. Repeat with Right Side Door and slide until doors meet in the middle.

Parts
4F - Sliding Doors
(36" x 73") x 2

Hardware
S2 - 1 1/4" Screws x 16 total
Y35 - Roller Assembly x 4 total

Note: If there is a gap between your doors at the top or bottom, remove the door and twist the Roller Assemblies to adjust the height until they hang parallel.

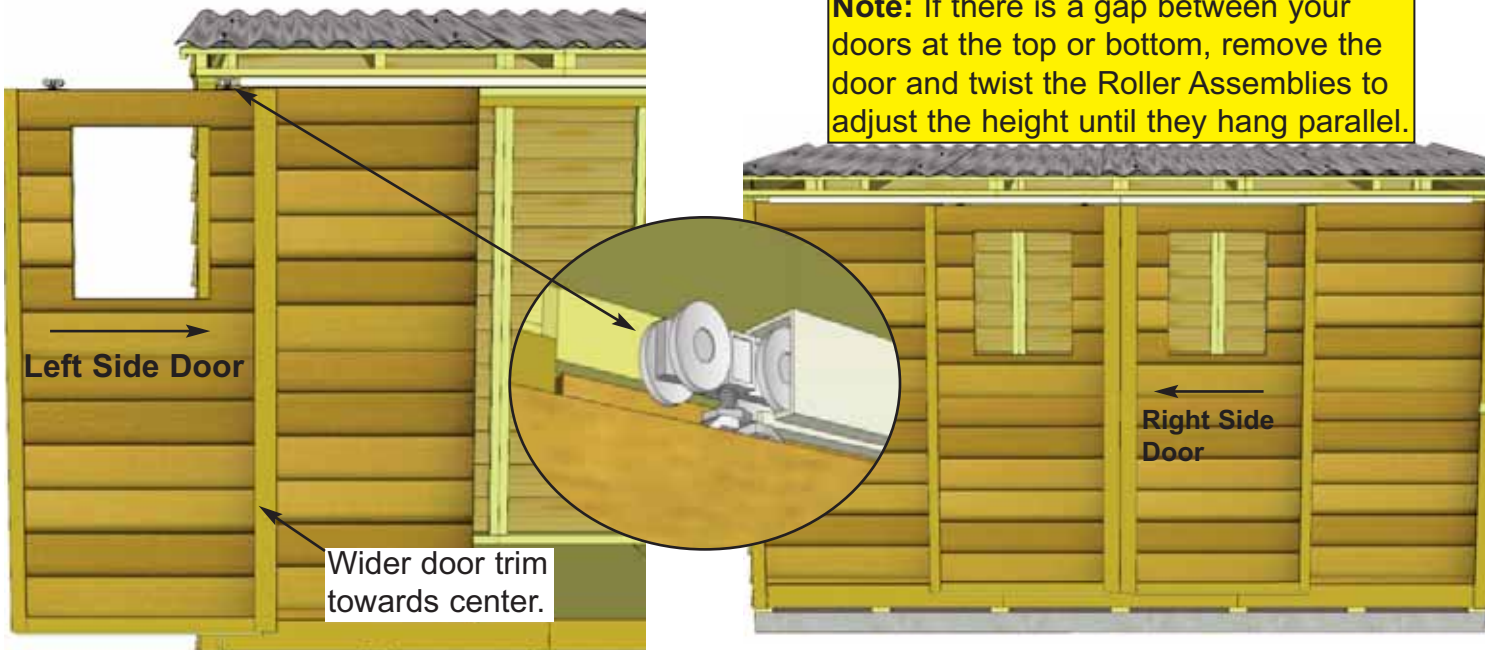

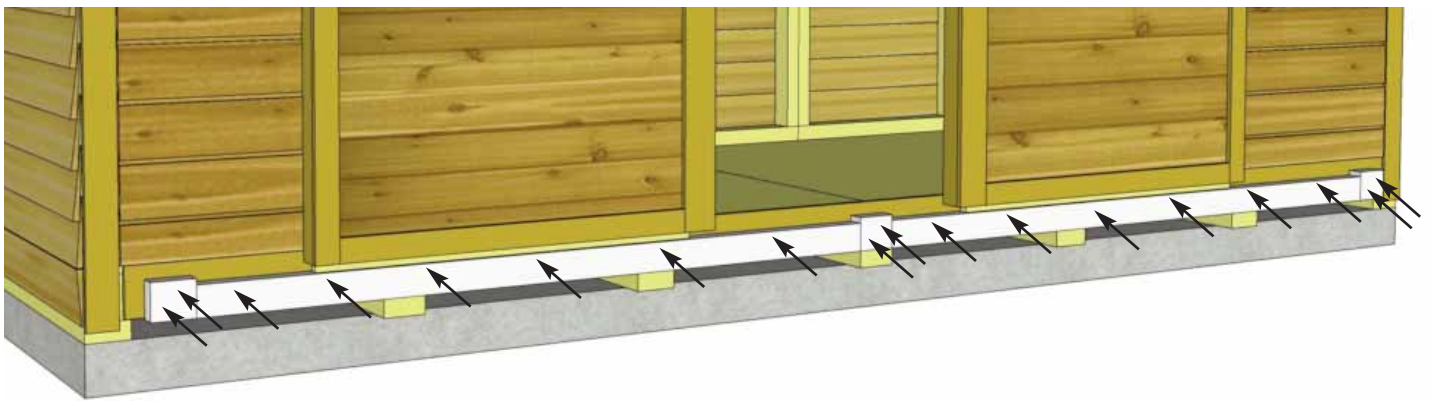
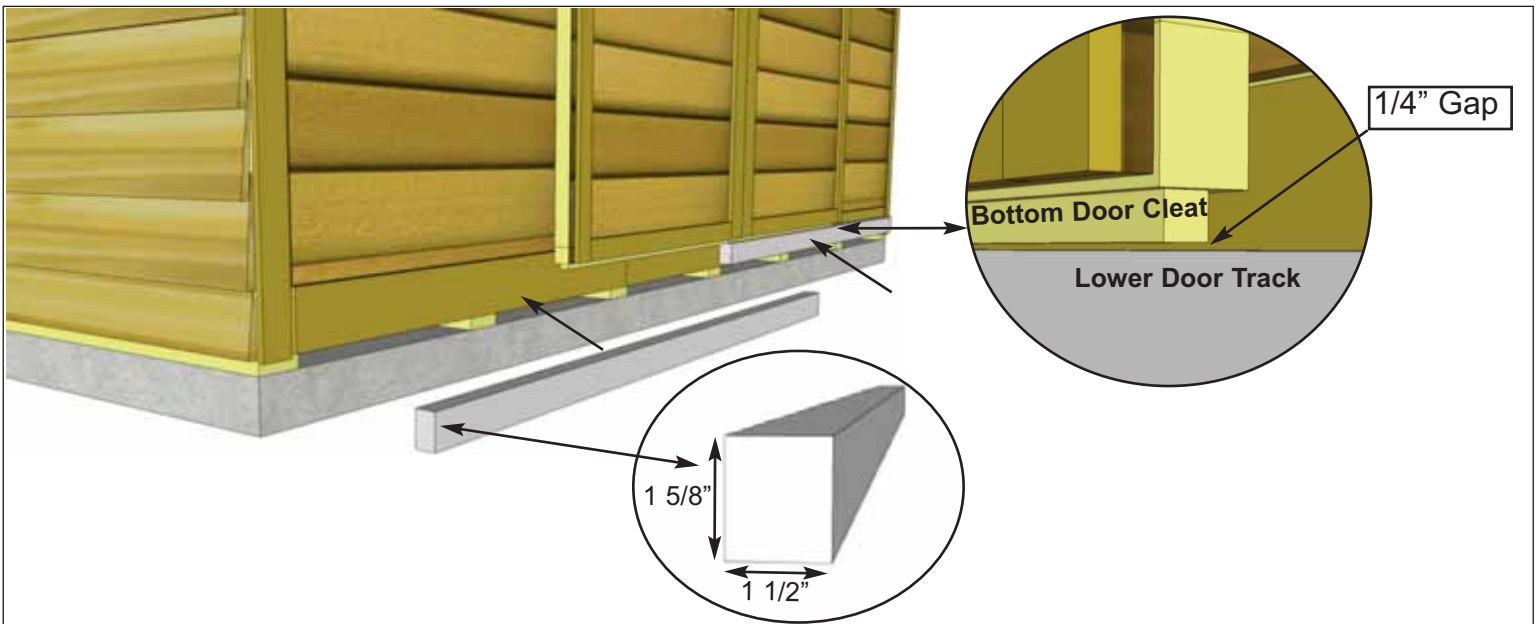

50. Locate **4H - Door Tracks** and **4J - Door Stops**. Middle Door Stop should be centered on shed and outer Door Stops should be 1 1/2" from edge of bottom skirting. Door Tracks rest on Long Floor Runners. Bottom of Door Stops and Door Tracks should be flush with each other. Secure Door Tracks to shed with **6 - 3" screws** per piece. Secure Door Stops with **2 - 3" screws** per piece.

- Parts
- 4H - Lower Door Track**
(1 1/2" x 1 5/8" x 61 1/8") x 2
 - 4J - Door Track Stops**
(1 1/2" x 2 1/4" x 3 1/2") x 3

- Hardware
- S4 - 3" Screws** x 18 total

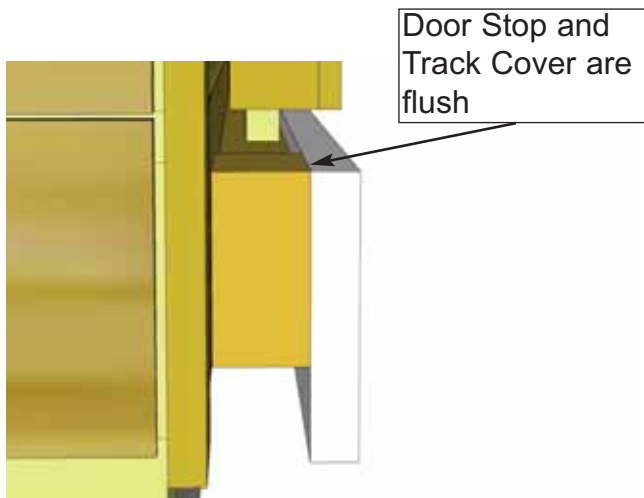
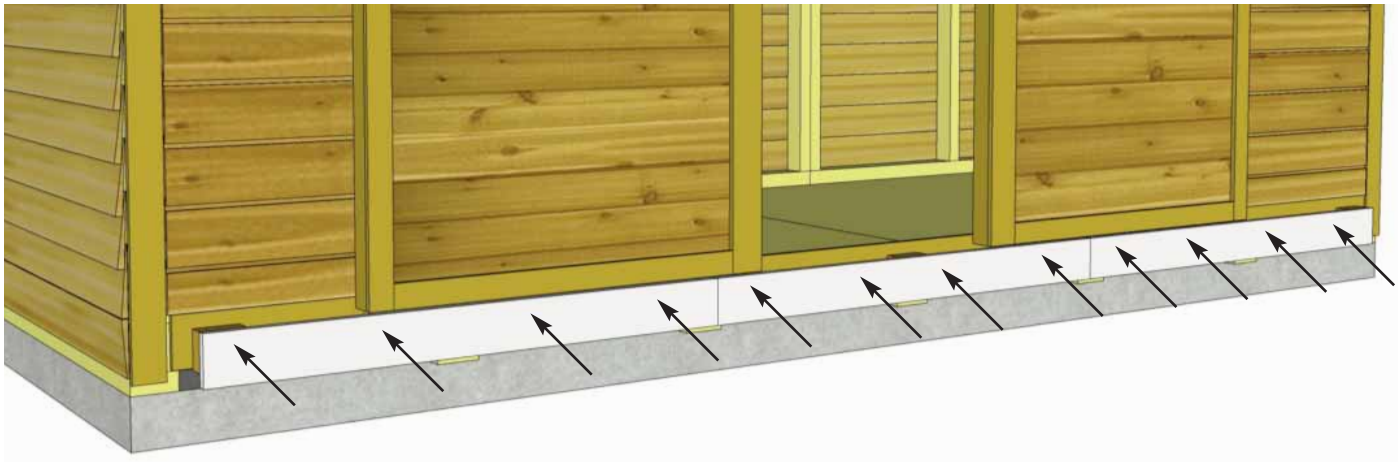

51. Locate **4I - Door Track Covers**. Lineup so Track Covers are flush with Door Stops. This creates an enclosure so doors can not slide out of the track. Secure each piece of Track Cover with **4 - 2 1/2" screws**.

Parts
4I - Lower Door Track Cover
 (3/4" x 3 1/2" x 44 1/4") x 3

Hardware
S1 - 2 1/2" Screws
 x 12 total

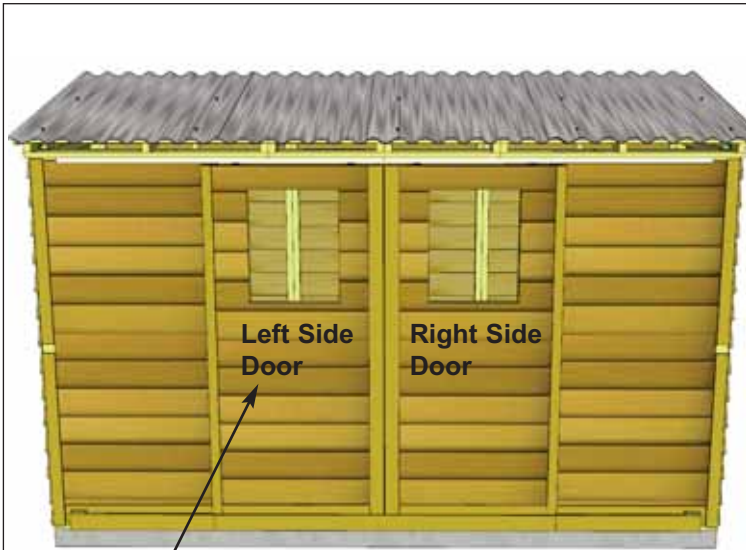

Door Flange attaches to Left Side Door.

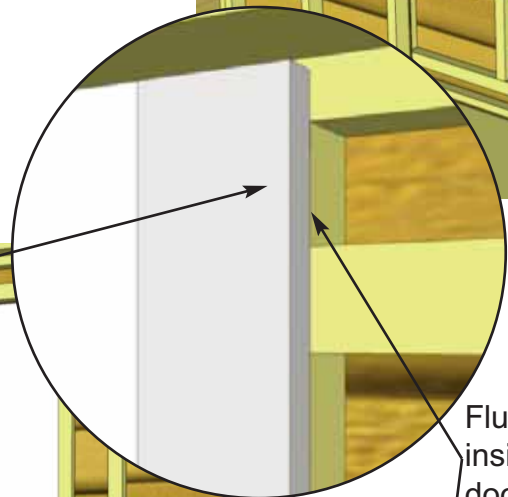

Flush with inside of door frame.

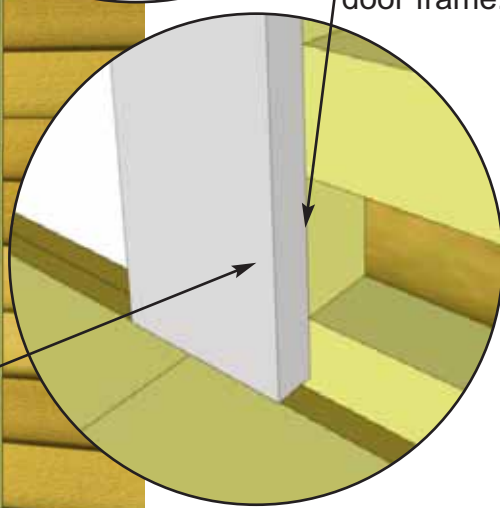

52. Position **4G - Interior Door Flange** on the rear of the left side door (when viewed from the front of the shed). Ensure flange is flush with the inside of the door frame and attach with **5 - 1 1/4" Screws**.

<u>Parts</u>
4G - Interior Door Flange (3/4" x 3 1/2" x 71 1/2") x 1
<u>Hardware</u>
S2 - 1 1/4" Screws x 5 total

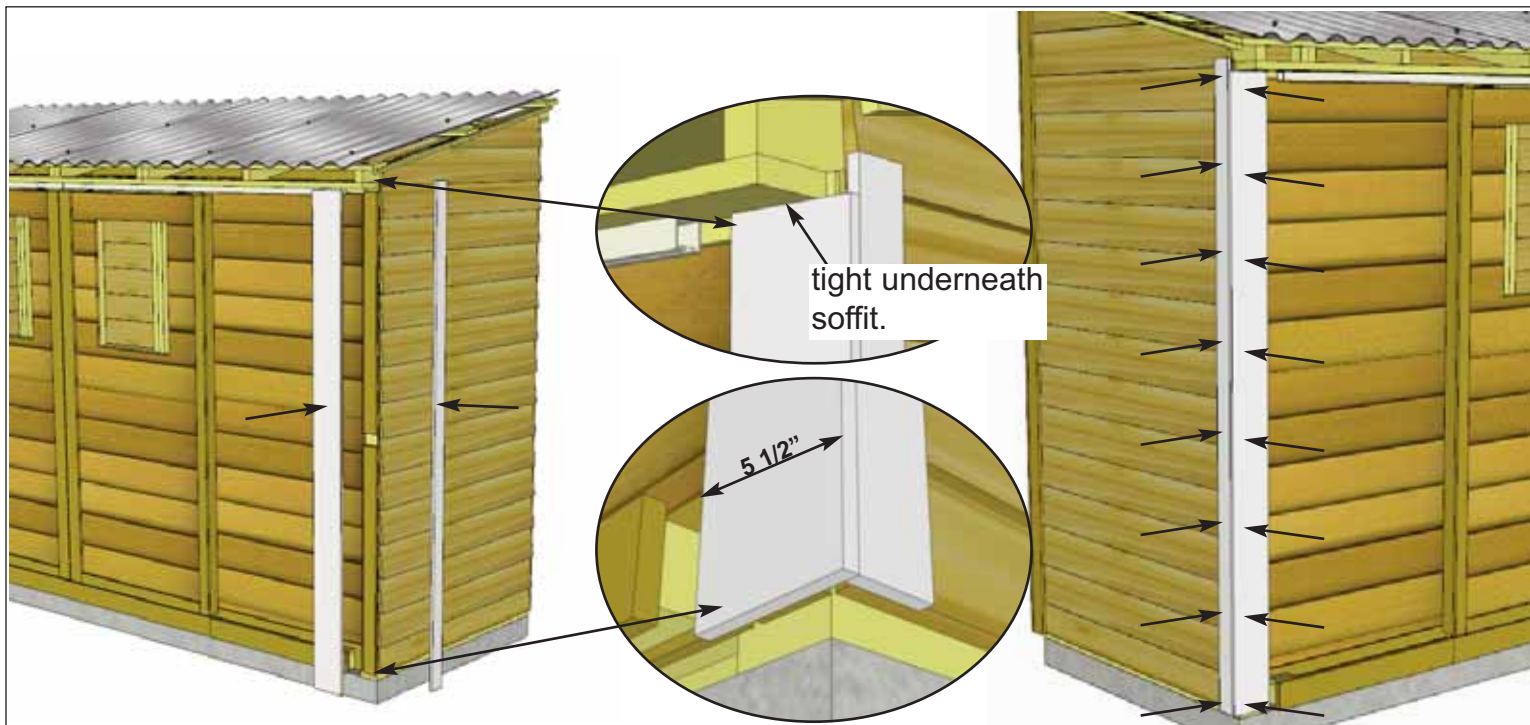

53. Place **4M & 4N - Front Corner Trims** in front corner and align as illustrated above. Do a dry run prior to attaching to achieve best fit. Start with 5 1/2" wide Front Corner Trim and align tight underneath soffit to determine vertical height. Attach with **8 - 1 1/2" Finishing Nails** per piece. Position and attach Side Front Corner Trim (2 1/2" wide) using **8 - 1 1/2" Finishing Nails**, aligning at bottom with wide trim.

Parts
4M - Front Corner Trims
 (1/2" x 5 1/2" x 78 1/2") x 2
4N - Side Front Corner Trims
 (1/2" x 2 1/2" x 80") x 2

Hardware
N1 - 1 1/2" Finishing Nails
 x 32 total

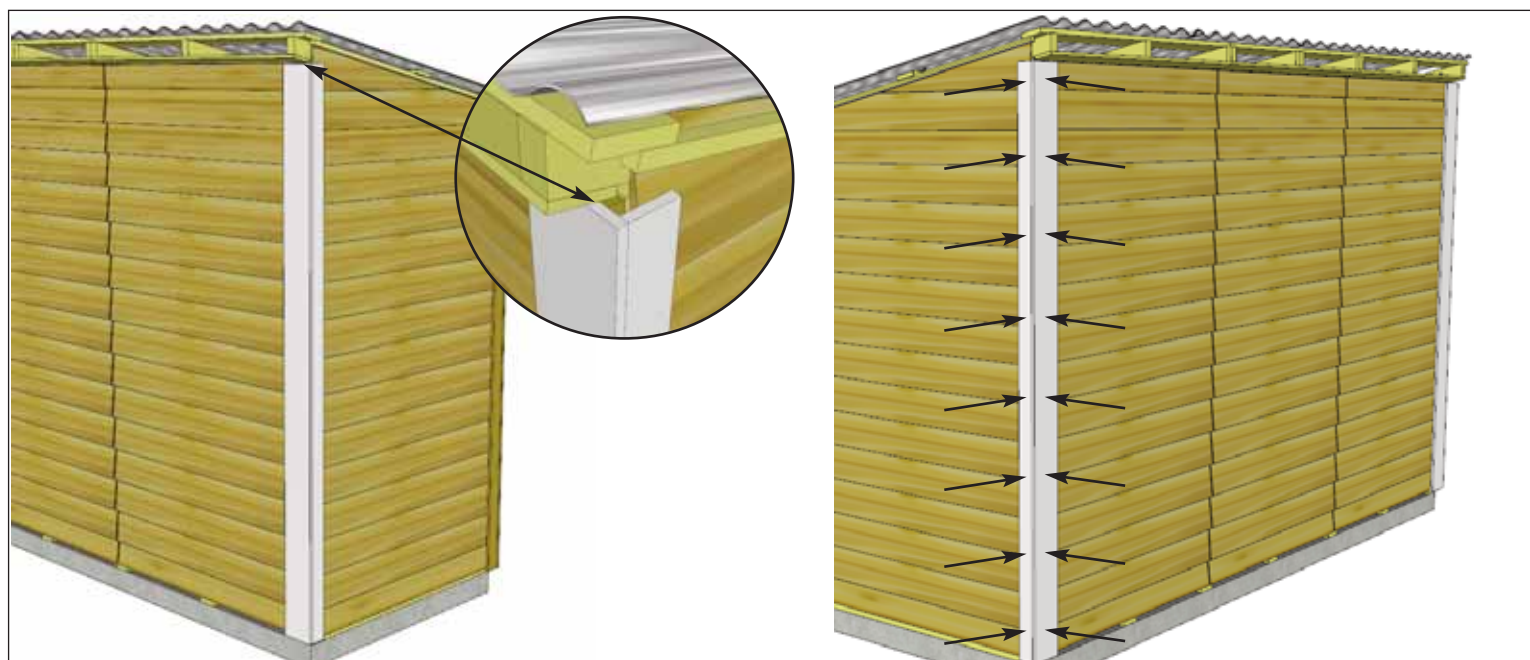

54. To complete trimming out rear corners, locate **4O & 4P - Rear Corner Trims**. Align and attach as per **Step 53**.

Parts
4O - Rear Corner Trims
 (1/2" x 5 1/2" x 88 3/4") x 2
4P - Side Rear Corner Trims
 (1/2" x 2 1/2" x 88 3/4") x 2

Hardware
N1 - 1 1/2" Finishing Nails
 x 32 total



55. Attach **4P - Rear Middle Trims** where wall panels come together at rear seam. Attach with **8 - 1 1/2" Finishing Nails** aligning tight underneath soffit and center on seam.

Parts
4P - Rear Middle Trim
 (1/2" x 2 1/2" x 88 3/4") x 2

Hardware
N1 - 1 1/2" Finishing Nails
 x 16 total

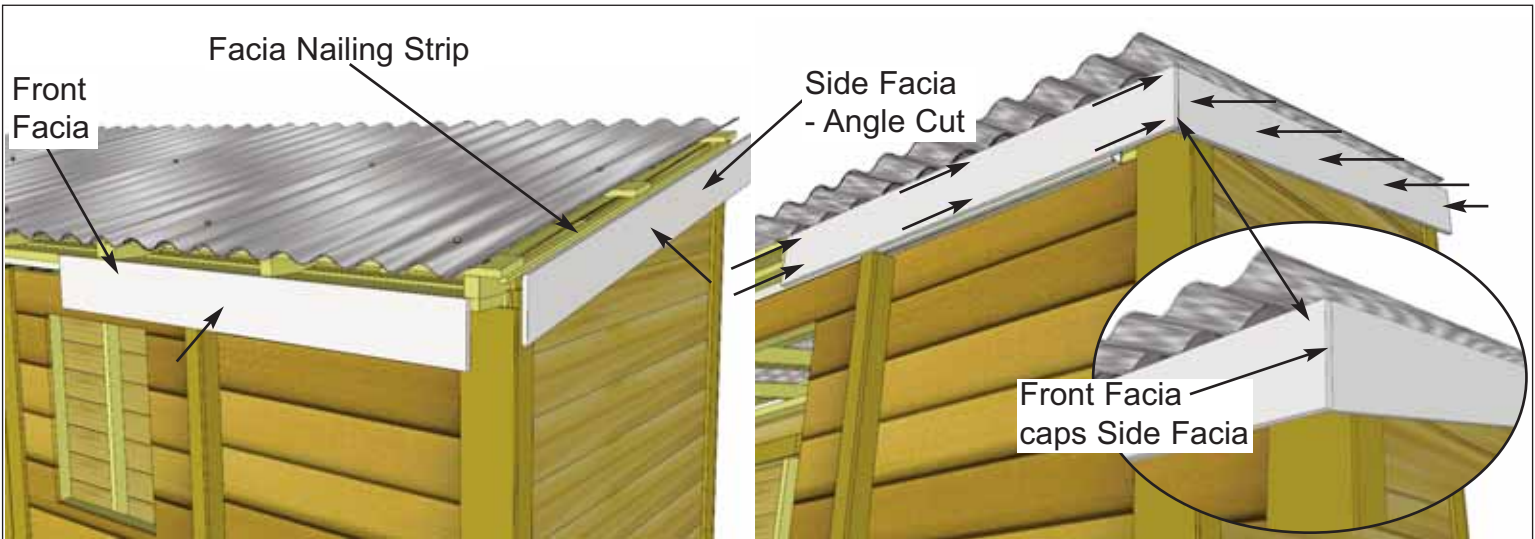

56. Locate one **4Q - Side Facia** and one **4R - Front Facia** and align in front corner. Position facias underneath roof panel, doing a dry run first before securing. Front Facia goes against rafter ends and Side Facia goes against Facia Nailing Strip. Align so the Front Facia caps the Side Facia. Attach Front Facia with **2 - 1 1/2" Finishing Nails** per rafter end. Attach Side Facia to the Facia Nailing Strip with **5 - 1 1/2" Finishing Nails**.

Parts (Steps 56 - 59)
4Q - Side Facia - Angle Cut Ends
 (1/2" x 5 1/2" x 54 1/8") x 2
4R - Front & Rear Facia - L/R
 (1/2" x 5 1/2" x 50 1/2") x 4
4S - Front & Rear Facia - Center
 (1/2" x 5 1/2" x 45 1/2") x 2

Hardware (Steps 56 - 59)
N1 - 1 1/2" Finishing Nails x 46 total

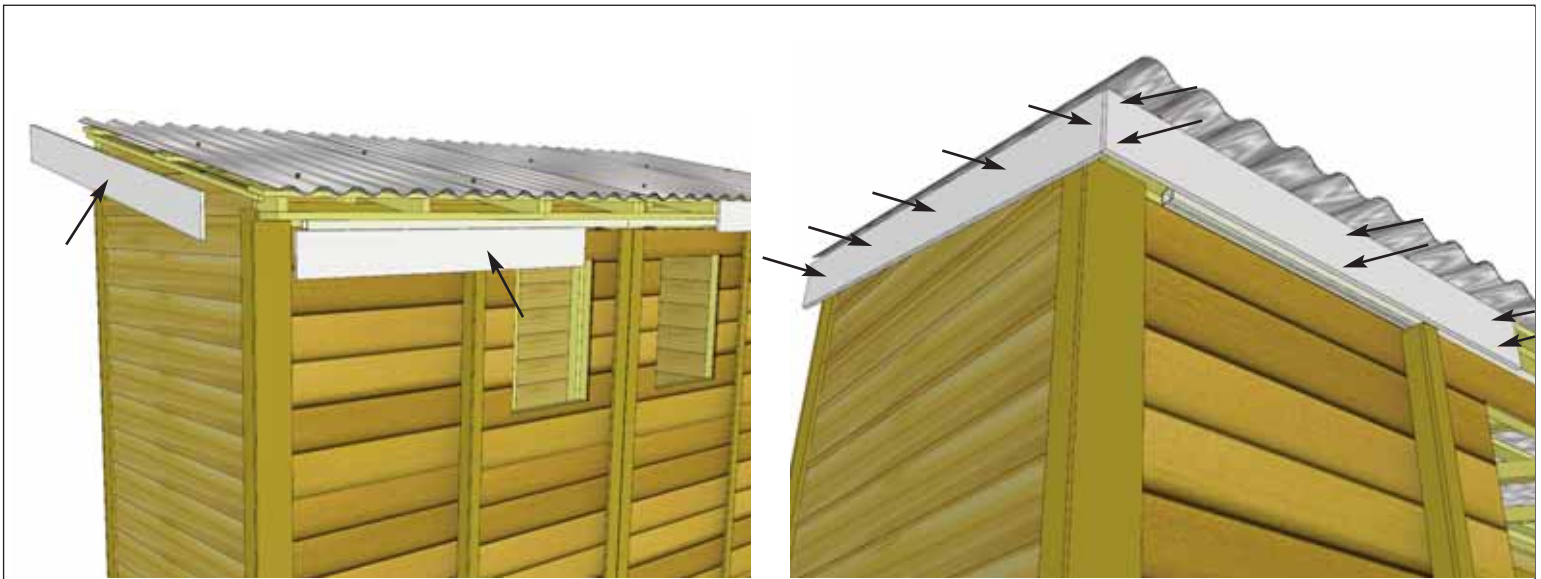

57. Attach other Front and Side Fascia to opposite corner as per **Step 56**.

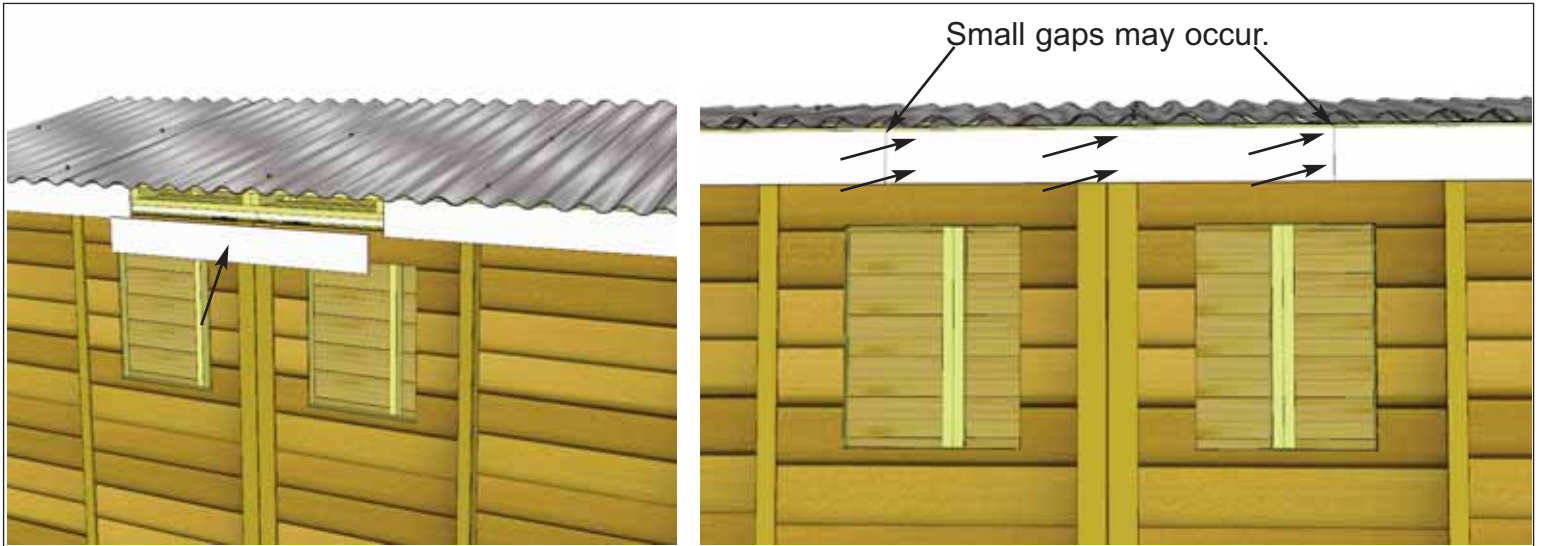

58. Attach **4S - Front Fascia - Center** to rafter ends as shown above. Small gaps may occur between the Center and Left/Right Fascia, but these will be covered by Fascia Detail Plates in **Step 60**. Attach with **2 - 1 1/2" Finishing Nails** per rafter end.

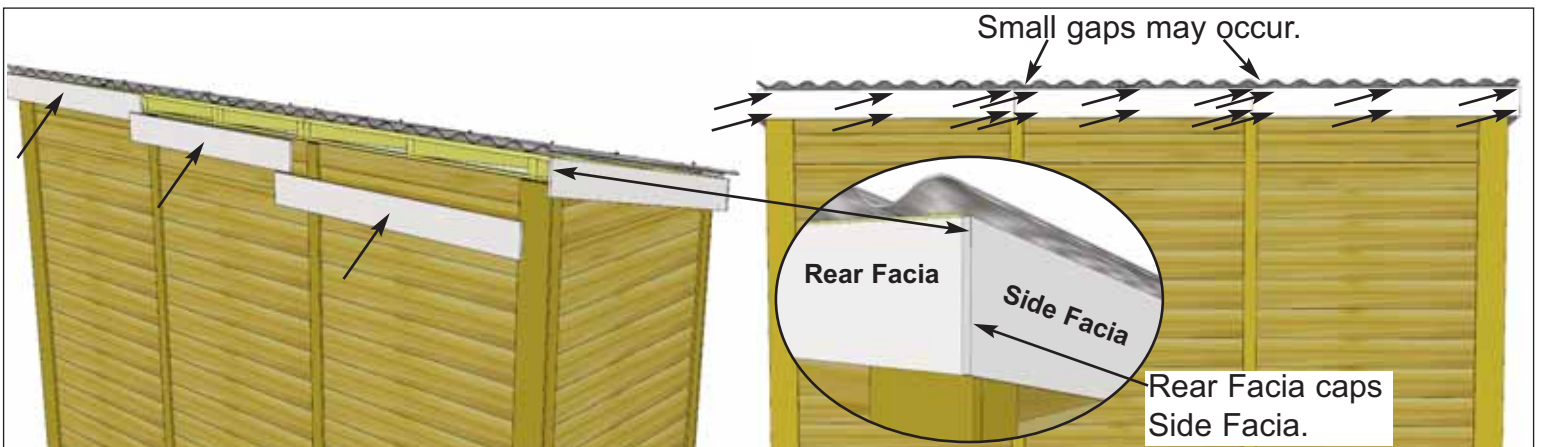

59. Attach **4R & 4S - Rear Fascia** onto rafter ends as per **Steps 56 - 58**. Small gaps may occur between the Center and Left/Right Fascia, these will be covered by Rear Metal Drip Caps in **Step 61**. Rear Fascia will cap the side Fascia. Attach Rear Fascia to rafter ends with **2 - 1 1/2" Finishing Nails** per rafter end.

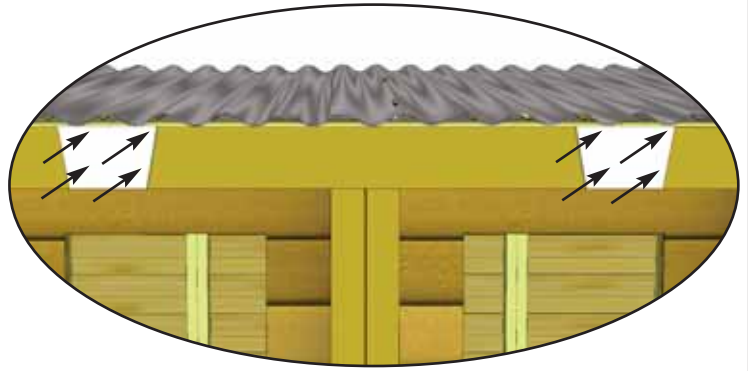
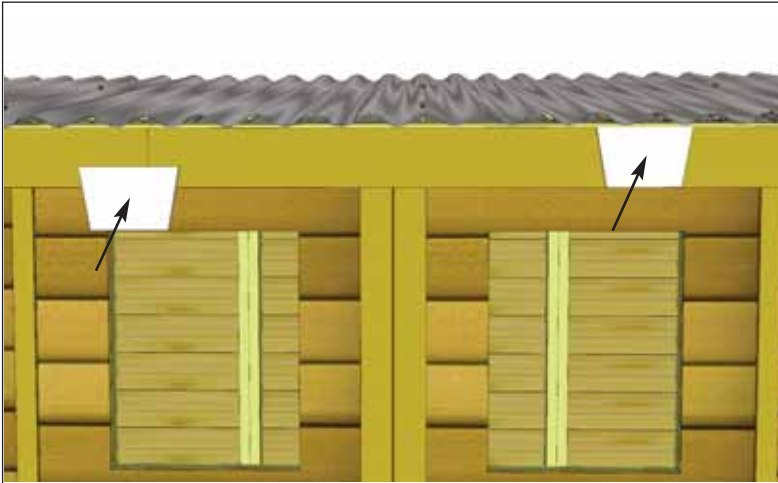

60. Attach **4T - Facia Detail Plates** to cover seams where Front Facia pieces meet. Secure with **4 - 1 1/2" Finishing Nails** per piece.

Parts
4T - Facia Detail Plates
 (5 1/2" high) x 2

Hardware
N1 - 1 1/2" Finishing Nails
 x 8 total

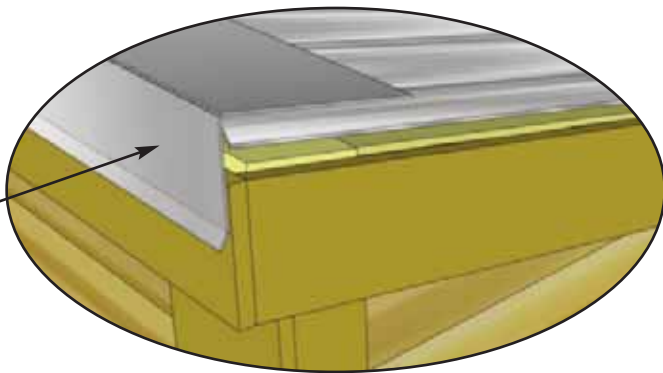
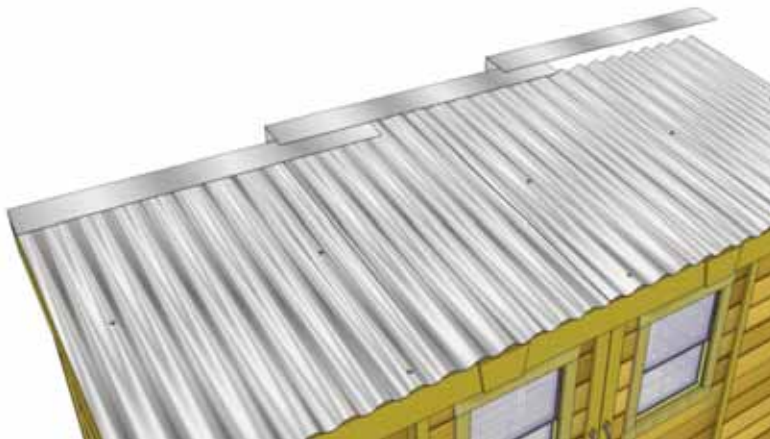

Rear Metal Drip Cap.

1/4" Nut Driver and 2" long Metal Drip Cap Screw.

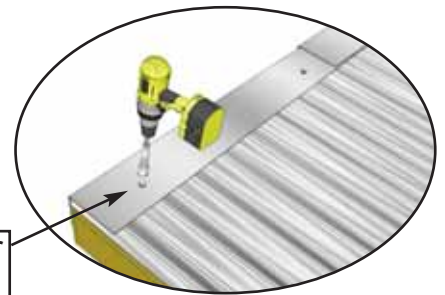

61. Place **Rear Metal Drip Caps (3 pieces - 60" long)** on top of metal roof at rear. Evenly space from side-to-side allowing caps to overlap each other. Overhang the cap approximately 1" past each end. When ridge cap is correctly positioned, secure with **5 - 2" long Self Tapping Metal Screws** as per **Step 42**. Screw into to top batten. Do not overtighten.

Parts
4U - Rear Metal Drip Caps
 (6" x 60" -angled) x 3

Hardware
5 - 2" long Metal Roof Screws x 6 total

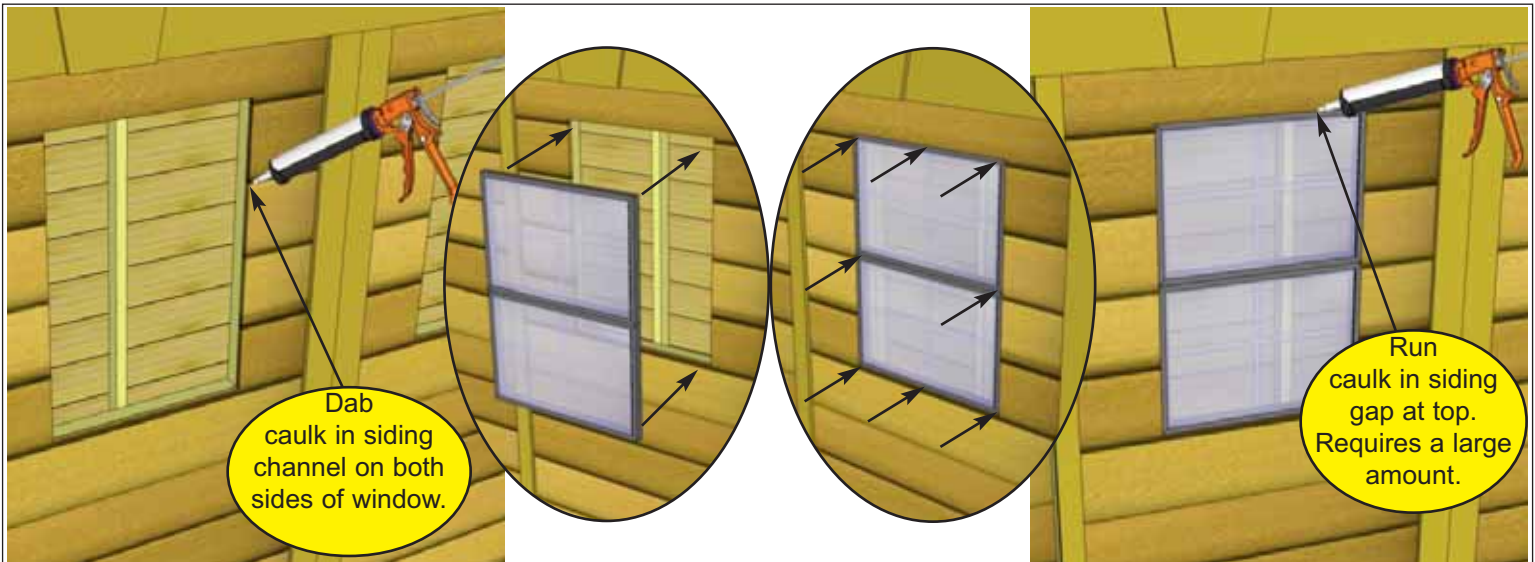

Dab caulk in siding channel on both sides of window.

Run caulk in siding gap at top. Requires a large amount.

62. Locate **4V - Window Inserts**. Before installing, dab caulk in siding channel on both sides of window opening. This will prevent water from getting in behind window. Position window in cavity and secure with **8 - 1 1/4" Screws**. Caulk gap between siding and window at top. This requires a large amount of caulking but is important to fill. Later, Window Trims will be installed to hide caulking. Complete second Window Insert the same.

- Parts
4V - Window Inserts
 (18 1/4" x 23") x 2
- Hardware
S2 - 1 1/4" Screws
 x 16 total

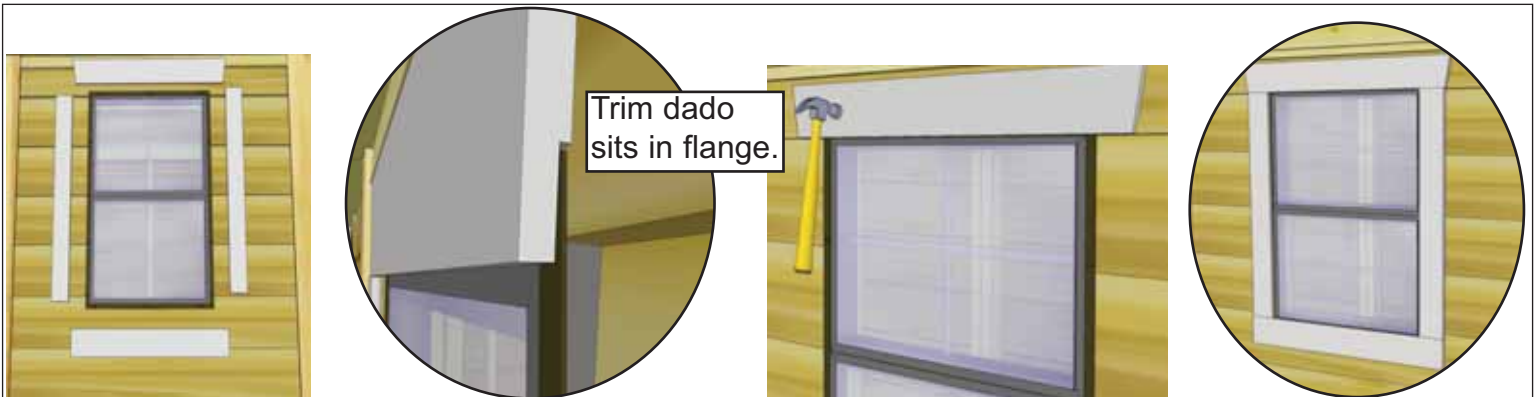

Trim dado sits in flange.

63. Position **4W - Window Trim** around window doing a dry run first and attach with **4 - 1 1/2" Finishing Nails** per piece. Window trim has a small dado on reverse face. Outside flange of window will roughly sit in the dado to give a better fit. Complete both windows the same.

- Parts
4W - Window Trim Kit x 2
 (Top pc - 24 1/16") x **1- Angle Ends**
 (Side/Bottom pcs - 23") x 3
- Hardware
N1 - 1 1/2" Finishing Nails x 32 total

64. Attach **Y3 - Door Handles** and **Y11 - Black Hasp**. Handles and Hasp are positioned on wide door trim and mounted with **3/4" Black Screws**.

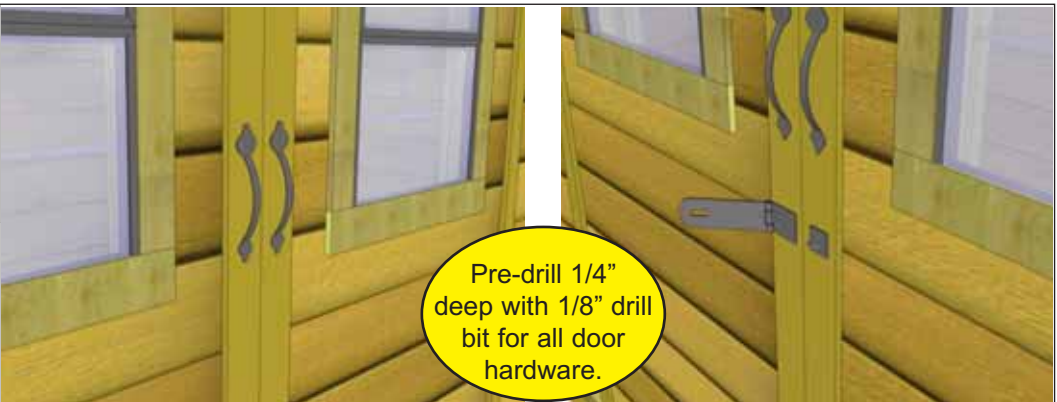

Pre-drill 1/4" deep with 1/8" drill bit for all door hardware.

- Hardware
Y3 - Door Handles x 2 total
Y11 - Black Hasp x 1 total
SB1 - 3/4" Screws x 16 total



Congratulations on assembling your 12x4 SpaceSaver Shed with Sliding Doors! (Metal Roof Model)

Note: Our Sheds are shipped as unfinished products. If exposed to the elements, the western red cedar lumber will weather to a silvery-gray color. If you prefer to keep the cedar lumber looking closer to the original color, we suggest that you treat the wood with a good oil base wood stain. You may also wish to paint your new shed rather than stain it. In both cases we recommend that you consult with a paint and stain dealer in your area for their recommendations.

We hope your experience assembling your 12x4 Slider Lean-To Storage Shed has been both positive and rewarding.

We value your feedback and would like to hear back from you on how well we are doing in the following areas:

1. Customer Service
2. On Time Shipping
3. Motor Freight Delivery
4. Quality of Materials
5. Assembly Manual
6. Overall Satisfaction.



Please call, write or email us at:

Outdoor Living Today

Canadian Address
9393 287th Street
Maple Ridge, British Columbia
Canada V2W 1L1

United States Address
P.O. Box 96
Sumas, Washington
USA 98295



The materials contained in this Assembly Manual may be downloaded or copied provided that ALL copies retain the copyright and any other proprietary notices contained on the materials. No material may be modified, edited or taken out of context such that its use creates a false or misleading statement or impression as to the positions, statements or actions.