

Gambrel Barn Construction Manual

8x8 through 16x24 Units



Tools Needed:

- Cordless drill (12V or higher)
- #2 square drive bit
- Hammer
- 6' step ladder
- Tape measure
- Square utility knife w/ blade & hook blade



Little Cottage Co.
PO Box 455
Berlin OH 44601
330-893-4212

© 2007 *Little Cottage Co.*

Gambrel Barn Units- 8x8 through 16x24



1



Thank you for purchasing from Little Cottage Co!
As shown above, all building materials necessary to construct your playhouse or storage barn are included in the materials skid.

2

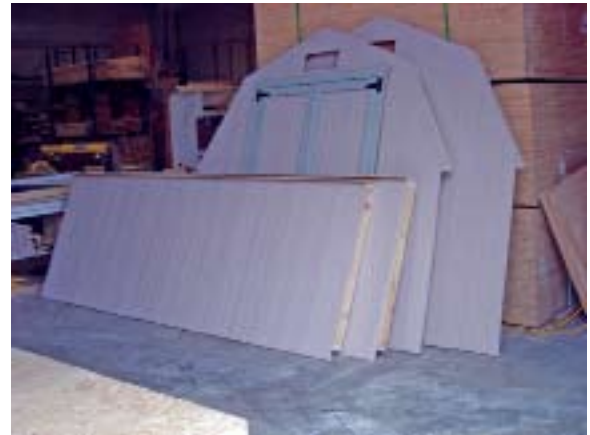

Place your materials skid in the exact location at which your building will be located. Remove the end and side wall sections from the materials and locate them close to your construction site.

3

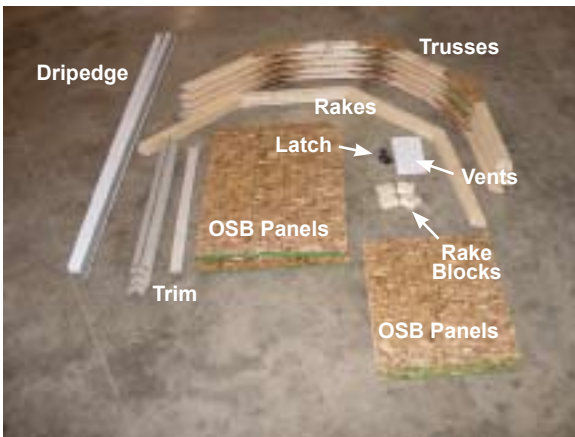

Now locate and review your packaging list and identify all construction materials. In the event that something is missing or damaged, please contact us immediately. Quantities may vary by unit size.

4



With the floor unit in its desired location, set the first side wall in place. The side wall's base 2X should set on top of the floor with it's siding overhanging the edge.

5



Apply pressure to the outside wall to keep the unit in place.

6



Use an angle square to ensure the end of wall is flush with the end of floor. Once flush and starting at one end, secure the wall to the floor using 2-2½" screws every 16."

Gambrel Barn Units- 8x8 through 16x24



7



Install the remaining wall section(s) in a similar manner.

8



Locate the end wall section (without doors) and slide into place.

9



Note that the end wall section's base 2X will rest on the floor while the remaining 2X's will abut with the vertical 2X's on the side wall sections.

10



From the outside, hold the end wall section firmly in place.

11



While holding the end wall in place, use an angle square to ensure that the end wall and side wall sections are flush. Then drive a 2½" screw through the 2X eave and into the side wall.

12



From below, drive a 2½" screw through the overhang and into the end wall's 2X eave. Then, repeat steps #11 and #12 on the opposite corner.

Gambrel Barn Units- 8x8 through 16x24



13



With the corners secure, now drive 2½" screws through the end wall's base 2X and into the floor every 16."

14



Locate the remaining end wall section with the door and set in place.

15



From the outside, hold the end wall section firmly in place.

16



From the inside, drive a 2½" screws through the base 2X and into the floor at one corner.

17



Remove spacer after wall is in place

Then, drive a 2½" screw through the base 2X and into the floor at the opposite corner. Repeat steps #11 and #12. After wall is in place, remove spacer.

18



Locate the siding strip that fits below the door opening. Position as shown above and attach using 2½" screws every 8-12." Use a straight edge to ensure that the top of siding is flush with floor.

Gambrel Barn Units- 8x8 through 16x24



19



Hold the door in place (i.e., with door aligned to end wall and floor) and mark around the barrel bolt as shown.

20



Drill hole using a 5/16" drill bit to accommodate the barrel bolt. Slide bolt into hole and verify (when closed) both doors are aligned with end wall.

21



Next, locate the door latch as shown above.

22



Position outside latch in alignment with drill points. Secure handle using two 2½" screws.

23



Align and tighten inside latch using the hex head wrench.

24



Align ridge vents around vent cutouts and secure using 1" screws.

Gambrel Barn Units- 8x8 through 16x24



25



Locate the wall brace and secure to the center most 2X on one side wall. Note that the brace must be flush against the wall's vertical 2X and siding.

26



Push the side walls inward against the wall brace. Then, secure the wall brace to the opposite side wall in a similar manner.

27

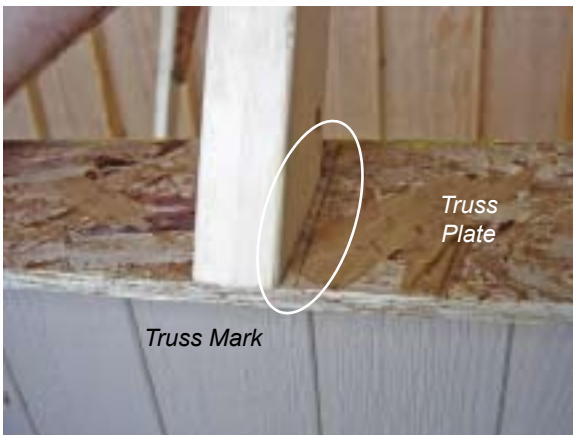

Now locate the first set of truss marks and truss plate (as above) and set the first truss in place (i.e., against the mark).

28



Use the angle square to ensure the cornered edge of truss and the edge of truss plate are flush. Then, drive a 2½" screw through the underside of truss plate and into the truss.

29



Drive a 2½" screw through the top of truss and into truss plate and 2X below.

30



Toenail a third 2½" screw through truss and into plate below.

Gambrel Barn Units- 8x8 through 16x24



31



Repeat on opposite side and install remaining trusses.

32



Secure the bottom of the end wall (w/o door) with 2½" screws every 12" (or every other board).

33



Next, secure the edges of the end wall with 2½" screws every 12."

34



Then attach trim along corners.

Gambrel Barn Units- 8x8 through 16x24



35



Beginning on one side of structure and consistent with layout diagram provided, situate the OSB roofing panels consistent with their designated locations.

36



Raise the first OSB panel to position. Use an angle square to ensure that it's edge is flush with the corner of truss. Note that the edge of OSB panel must be centered along the truss' edge.

37



Secure the base of the OSB panel to truss using a 1 1/4". At this point, attach only the bottom edge of OSB panel to each truss. Adjustments may be necessary.

38



Using a tape measure, adjust the truss to a 24" center and secure the bottom of OSB.

39



At the end wall, use a tape measure and adjust the OSB to allow a 6" overhang. Secure OSB to end wall using a 1 1/4" screw.

40



At the top, measure to a 6" overhang, adjust OSB as needed, and secure the OSB to end wall using a 1 1/4" screw. Repeat on the opposite end of structure. Then attach remaining top (then bottom) OSB panels.

Gambrel Barn Units- 8x8 through 16x24



41



With all OSB panels in place, locate the rake block. Insert as shown above, using a angle square to ensure that it is level with the OSB and trim. Secure to wall using a 2½" screw. Repeat on opposite side.

42



Raise the rake and set in place underneath the OSB sheeting and abutted against the 2X frame and rake block.

43



Use an angle square to square the rake with the rake block. Drive two (2) 2½" screws through rake and into 2X framing.

45



Secure ends of OSB to the rakes using 2½" screws.

44



Repeat on the opposite end of rake. Then, attach the rake on the opposite end of structure.

46



Gambrel Barn Units- 8x8 through 16x24



47



Install dripedge along sides of roof using 1¼" screws every 1'.

48



Then, install dripedge along the ends of structure using 1¼" screws, beginning at the front corner.

49



Continue to attach dripedge using 1¼" screws to the first bend.

50



Snip the dripedge as shown to accommodate bend.

51



Bend the dripedge along the edge of roof, securing it to the roof with a 1¼" screw just after the bend. Attach dripedge every 1'.

52



Once at the ridge of roof, again snip the dripedge to accommodate bend.

Gambrel Barn Units- 8x8 through 16x24



53



Secure the dripegdge with a 1/4" screw just before the bend. Then, bend dripegdge (along roof line) and attach along the remaining roof. Complete on the opposite end of structure.

54



Snap a chalk line along the OSB consistent with the width of the starter strip. Consult the instructions provided with your shingle package.

55



Align the top of starter shingles with the chalk line and attach.

56



Add the second section of starter shingles. Then, stagger the next rows of shingles as shown.

57



Continue to install shingles in a staggered manner.

58



Install shingles across the entire lower section of roof.

Gambrel Barn Units- 8x8 through 16x24



59



Once at the end of roof, use a metal square and carefully trim off excess shingles from the edge.

60



Now begin attaching shingles to the upper section. As shown above, fold shingle over the bottom section.

61



Continue attaching shingles to the top roof section, staggering in a shown.

62



Continue attaching shingles to top roof section until reaching the ridge.

63



Once at the ridge, carefully trim excess shingle to expose ridge opening.

64



Complete the remainder of the top section. Then, install shingles to the opposite side of roof.

Gambrel Barn Units- 8x8 through 16x24



65



Beginning above the door, cut the ridge cap (as shown) and attach to roof.

66



Continue capping off roof until reaching the opposite edge of structure.

67



Once at the end of structure, finish the cap with a no adhesion strip.

68



Once capped, staple shingles along the corners of roof line.

69



Your structure is now complete!