

The Breeze is versatile enough to be enjoyed by the pool, on your deck or at a place in your backyard that you would love to escape to.

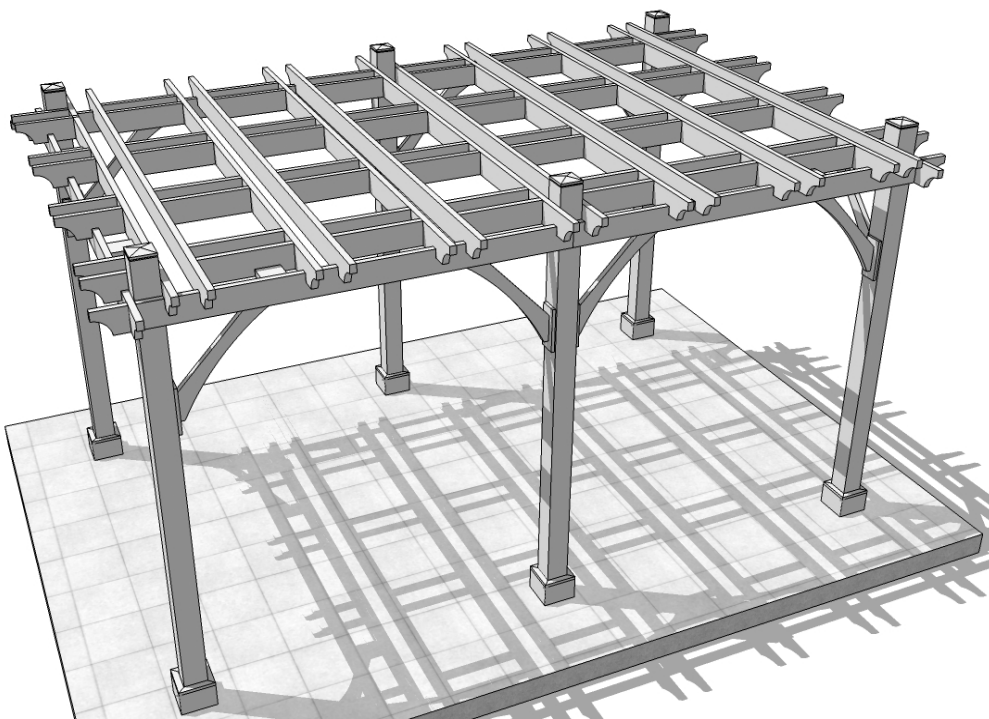

### The 10'x16' Breeze Kit Includes:

- Notched and Pre-drilled Girders
- Notched and Pre-marked Joists
- 6 - 5 1/2" x 5 1/2" Engineered Cedar Posts
- Western Red Cedar Construction
- Hardware Included (screws, nails and lag bolts)
- Step by Step Detailed Assembly Manual.
- \* Post Mounts not included.

### Specifications:

#### Dimensions:

- A: Outside Height = 108"
- B: Total Outside Width = 210"
- C: Total Outside Depth = 138"
- D: Outside Post to Post Width = 192"
- E: Outside Post to Post Depth = 120"
- F: Height to Underside of Girder = 94"

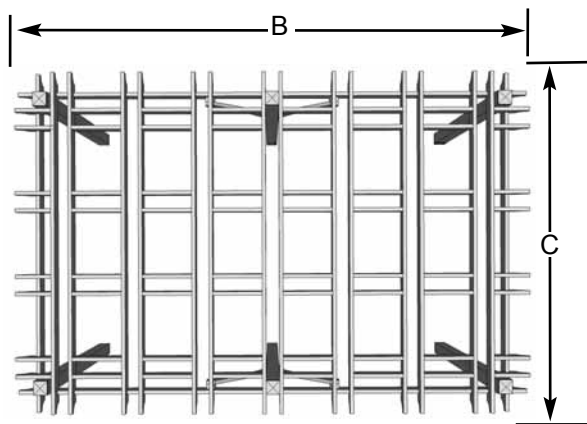

#### Materials List:

- 5 1/2" x 5 1/2" Engineered Western Red Cedar Posts
- 1 1/2"t x 5 1/2"w Architect Knotty Cedar Girders & Joists
- (All pieces are surfaced smooth)

\*Post Mounts not Included in kit.

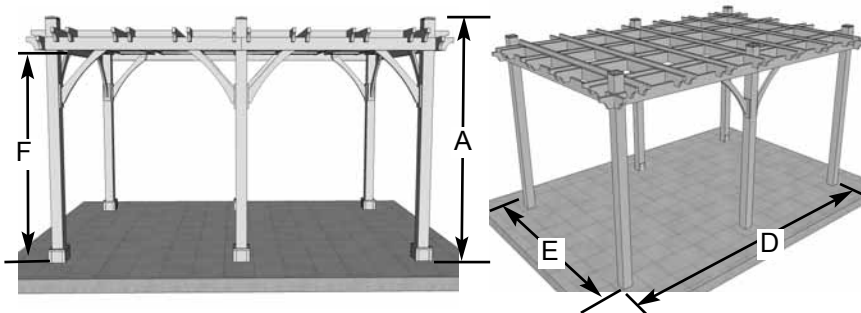

Shipping Pkg. Size: 41"w x 143"l x 19"h  
Shipping Weight: = 950 lbs