

# SO WATT

## Shim Handles

DESIGN

MFG

Designed + Made by So Watt

The PULL Handle Range is the easiest way to add style and character to your cabinets.

Available in a range of sizes and finishes, The PULL Shim Handles can be easily fixed to any cupboard door, drawer front, kitchen cabinet or storage unit.

Made from high grade Birch Plywood, the PULL Shim Handles are finished in low VOC natural water based durable finish in natural clear, black, white or sanded and left raw (with no finish) to allow you to paint them any colour you like!

We encourage you to get creative with the orientation and position on your doors.

Each pair of handles comes with two different screw lengths to suit multiple door thicknesses, plus a mounting template which you can also download below.

More info at - [sowatt.com.au](http://sowatt.com.au)

Lead Time: 1-2 weeks including delivery within Australia.



2 Year Commercial Warranty



Fast and Easy Assembly



Dimensions:

200mm x 100mm x 24mm thick (each half)

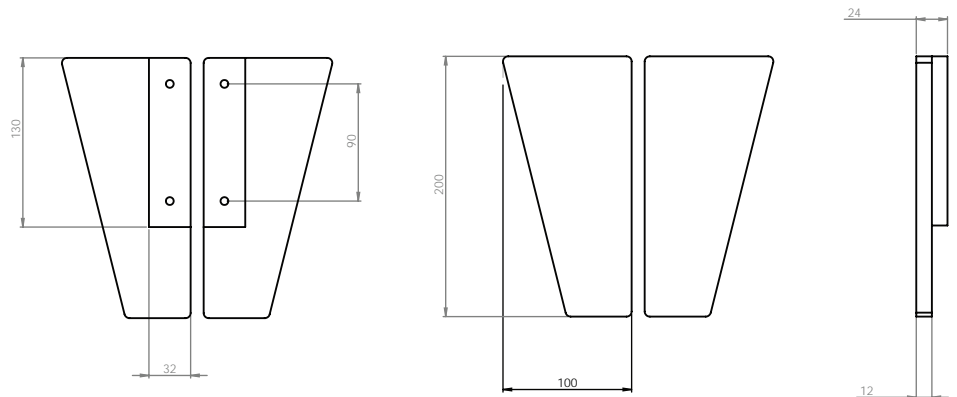

Black and white finishes show some wood grain and texture through the coated layer allowing some resemblance of the ply to show through

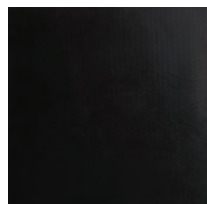

Black



White

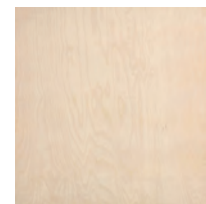

Clear

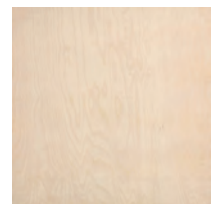

Raw

Copper and Brass 1mm plates attached to the front faces of the handles come sealed with a metal specific wax that is invisible to prevent the metal from oxidizing and corroding



Sealed Copper



Sealed Brass



**Custom Design**  
Our pieces are hand made to order. Custom sizes and finishes are available. Phone or email the team for custom requests.  
[info@sowatt.com.au](mailto:info@sowatt.com.au)  
(02) 8960 5756



**International Orders**  
International Shipping is available on request. Please contact the team for a quote.  
[info@sowatt.com.au](mailto:info@sowatt.com.au)



**Sustainability**  
We encourage re-use and recycling of our Pieces. New components are available to extend the life of your So Watt piece and we accept returns for conscious disposal and donation.