

EST.
1877

Buffet

High Chair

Silver Cross[®]

IMPORTANT – READ THE INSTRUCTIONS CAREFULLY BEFORE USE AND KEEP FOR FUTURE REFERENCE

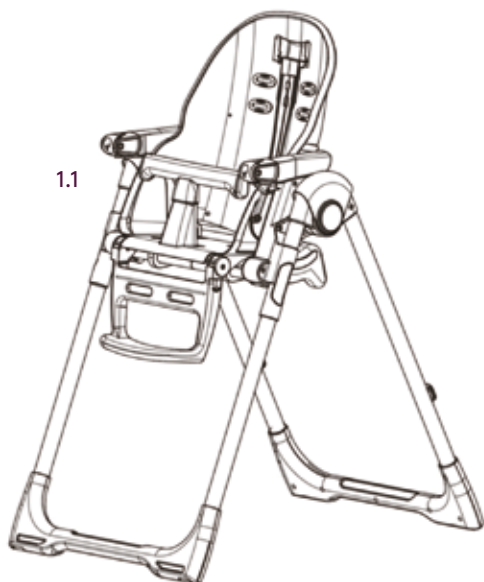
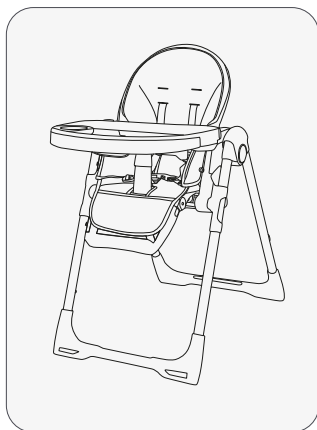

1.2



1.3



1.4



1.5



1.6



1.7



1.8

Contents

First check all your parts have been supplied.
Your High Chair includes:

- | | |
|-----------------|---|
| 1.1 High chair | 1.5 Tray |
| 1.2 Seat fabric | 1.6 Leg divider |
| 1.3 Harness | 1.7 Cover (when leg divider is removed) |
| 1.4 Tray cover | 1.8 T-bar |

2.1

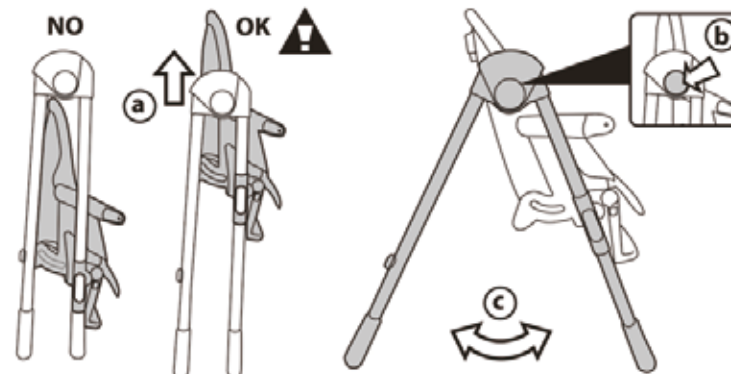

Opening the high chair

- 2.1 Lift the seat (fig_a), press the side buttons (fig_b) and open the high chair (fig_c).

3.1

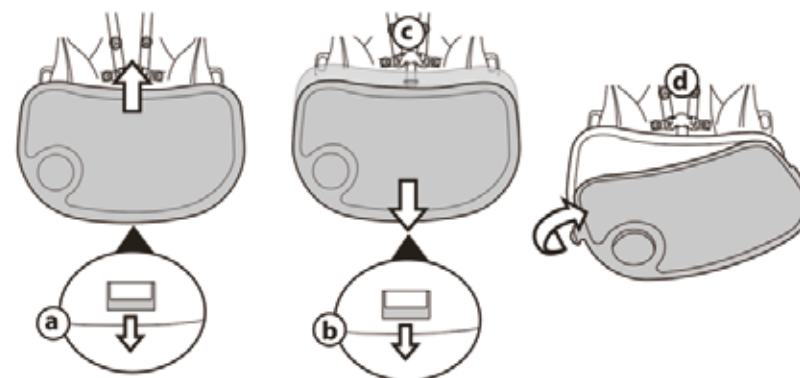

Fitting the tray

- 3.1 To fit the tray, pull the central lever underneath it towards you while at the same time pushing it all the way into the armrests (fig_a). To extend or remove the tray, pull the central lever underneath it towards you (fig_b) and move it outwards (fig_c). To remove the tray, pull the side levers outwards and pull the tray towards you. The high chair has a double tray. The top tray can be easily washed in a dishwasher. To remove it, detach it from the lower tray and lift it up (fig. d).

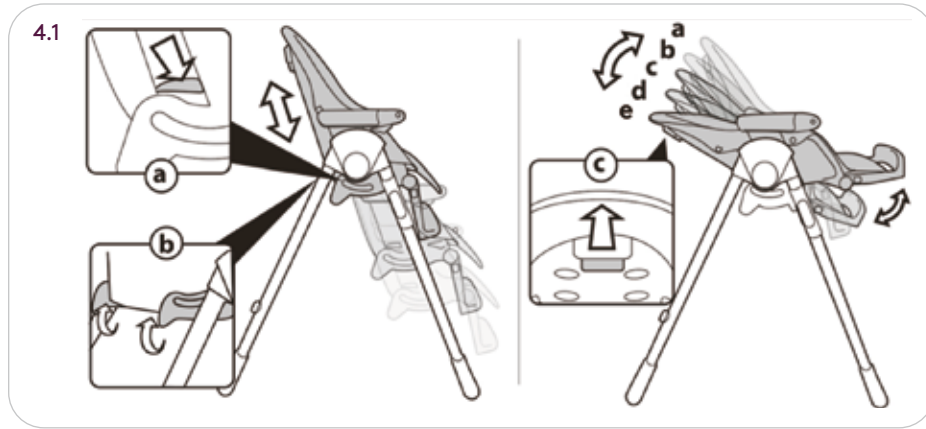

Adjusting the height & reclining the backrest

4.1 Adjusting the height: The chair can be set at 5 different heights. To lower the seat, pull the two levers downwards (fig. a) and move it to the required position. Holding the handle behind the backrest (fig. b) can also be used to raise the seat.

WARNING: Fall Hazard: This can't be done with the child in the high chair. Don't use when the horizontal height of the high chair is inconsistent.

Reclining backrest: The seat can be reclined in 5 positions. To adjust it, raise the handle behind the backrest (fig. c) and lock it in the required position.

WARNING: Fall Hazard: Be sure to check that the backrest is fully locked after adjustment.

High chair with tray and T-bar	6m to 15kg	backrest angle: 105 degrees	position: a
High chair without tray, with or without T-bar	12m to 15kg	backrest angle: 105 degrees	position: a
Cradle without tray and T-bar	0-6 m (months)	backrest angle: 120-150 degrees	position: b, c, d, e

WARNING: When the tray is used, T-bar must be used.

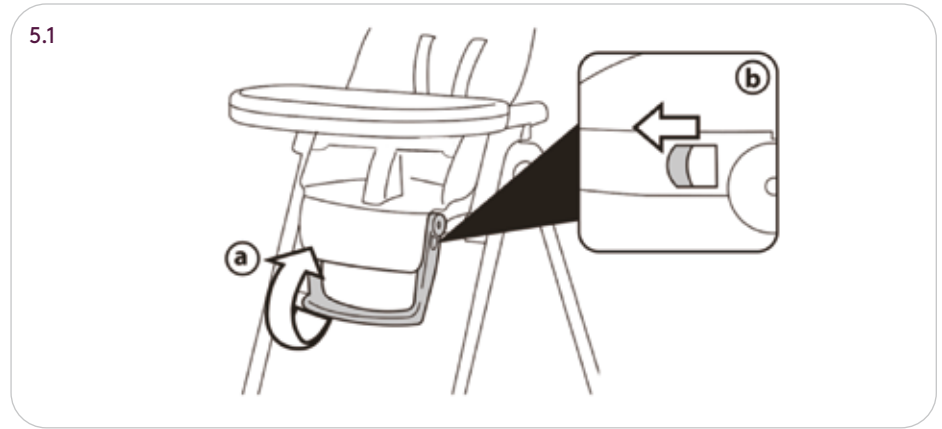

Adjusting the footrest

5.1 The footrest can be set in 3 positions. To raise it, push the footrest upwards (fig. a). To lower it, press the two side buttons at the same time (fig. b) and select one of the three available heights.

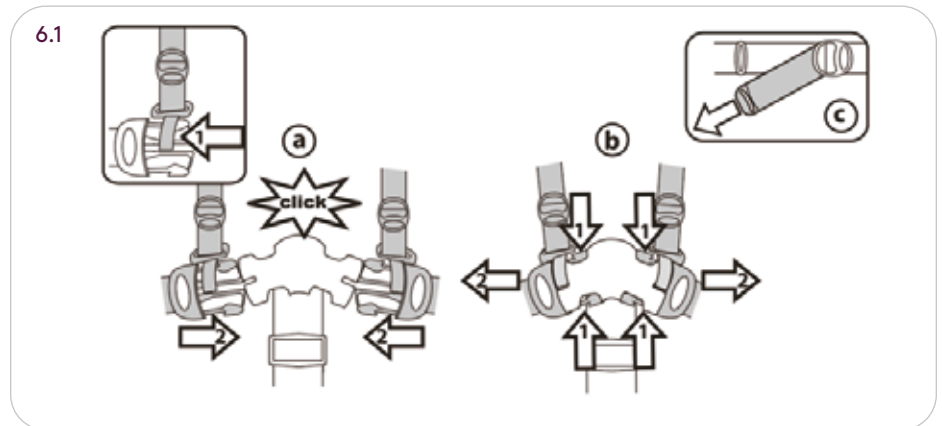

Five point safety harness:

6.1 To close it, insert the two waist strap buckles (with attached shoulder straps) into the crotch strap until they click into position (fig_a). To release it, press the two sides of the buckles and at the same time pull the waist strap outwards (fig_b). To tighten the waist strap, pull from both sides in the direction of the arrow (fig_c), to loosen do the opposite.

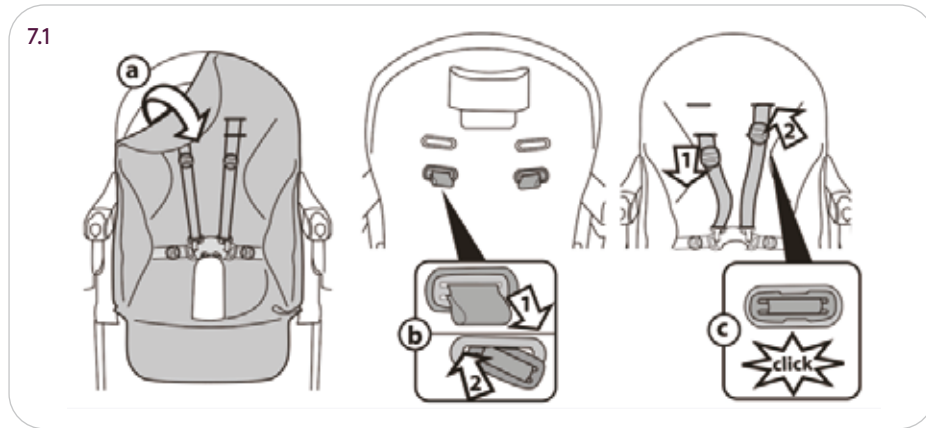

Adjusting the shoulder straps

7.1 The shoulder straps of the harness can be set at two different heights. Partially remove the fabric (fig_a), release the shoulder straps from the backrest (fig_b1) and pull them out from the fabric (fig_b2). Insert the ends of the shoulder straps in the other slots in the fabric and the backrest (fig_c), then put the fabric back into the right position on the backrest.

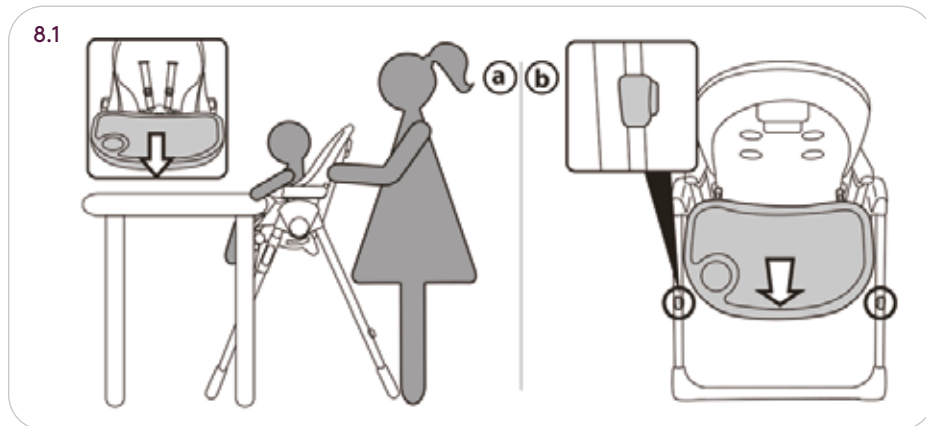

Using the high chair without the tray

8.1 To use the seat at the table, remove the tray (fig_a). To clip the tray on the rear supports of the high chair, align and engage it with the attachments (fig_b).

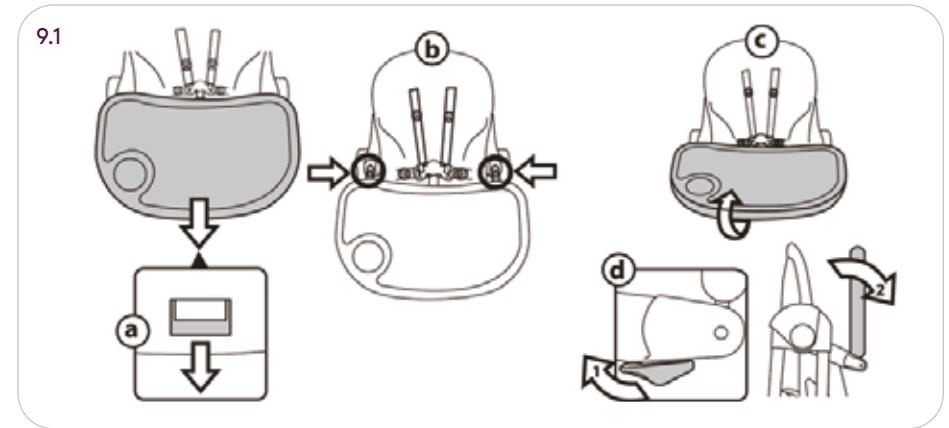

Closing and reopening the tray

9.1 Pull the central lever underneath the tray towards you (fig_a) and extend it as far as the red markers (fig_b), then swing it upwards to lock it in place (fig_c). To reopen the tray, press the lever under the armrest (fig_d), swing it downwards, then pull the central lever towards you and put the tray in one of the positions for use. **WARNING:** When the tray is turned up, make sure that the chair is placed in a safe position where the child can not reach it to prevent the tray from falling.

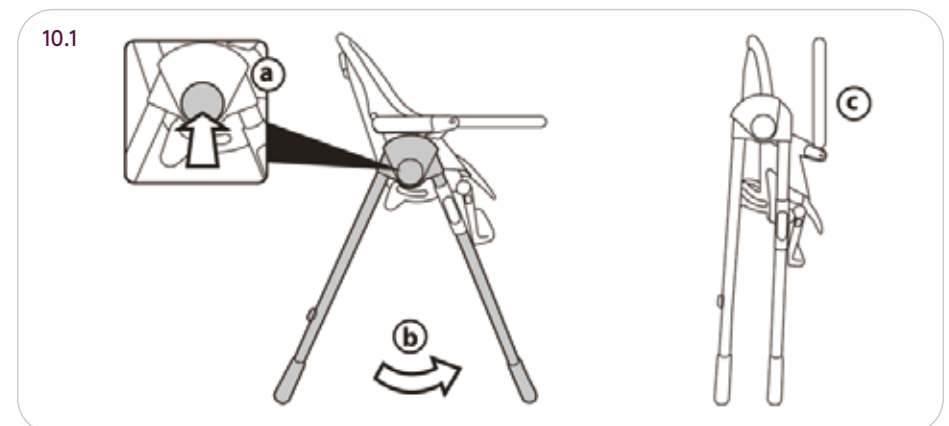

Folding the high chair up

10.1 Press the side buttons (fig_a) and fold up the high chair (fig_b). Fig_c shows a folded-up high chair.

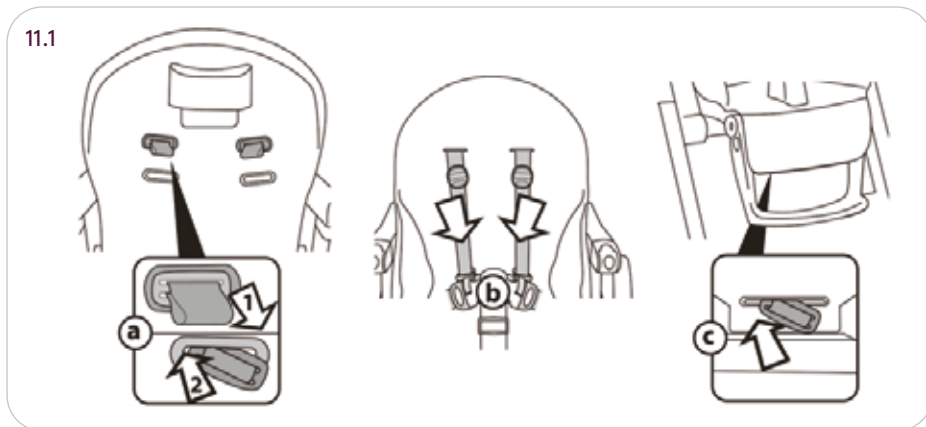

Removing the covers

11.1 To remove the covers of the seat, pull off the upper part of the fabric covering and pull the harness straps through the backrest (fig_a) and the fabric covering (fig_b). Lower the backrest and pull out the leg divider strap from under the seat (fig_c).

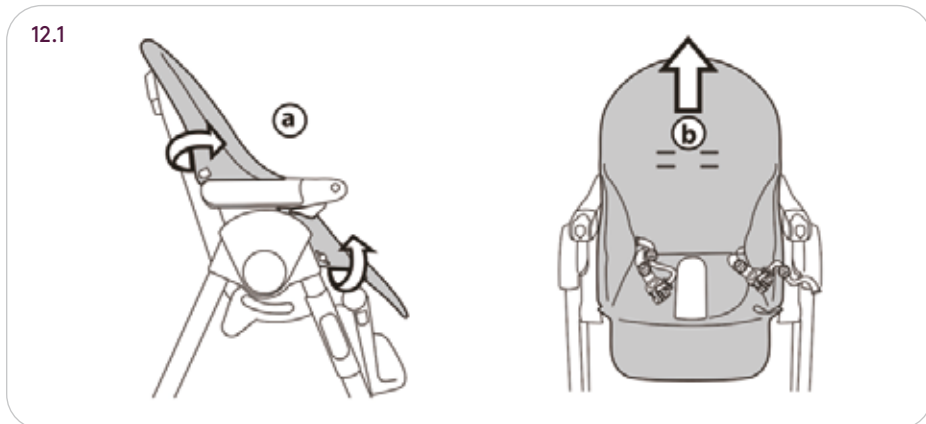

Removing the covers (continued)

12.1 Unbutton the fabric at the sides (fig. a) and pull up to remove it (fig. b).

13.1

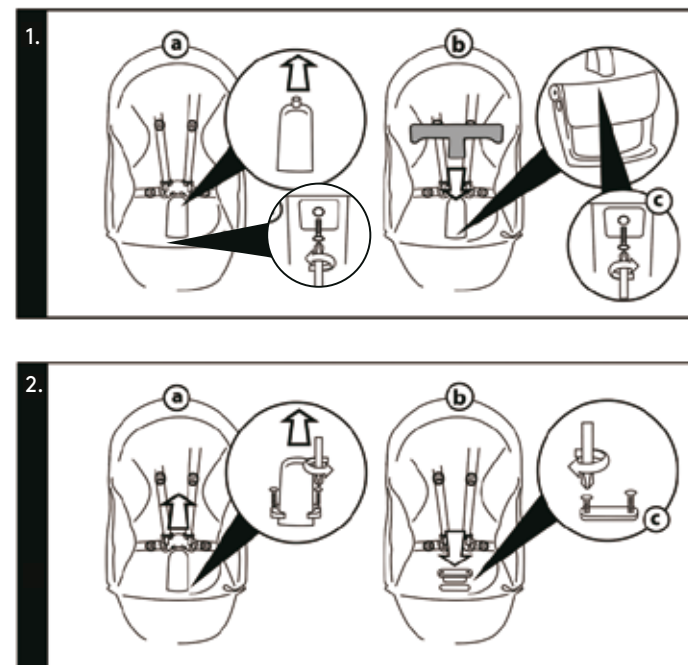

Removing the leg divider

13.1

1. Using T-bar: Please use a screwdriver to remove the white stopper from the leg divider (fig_a), then insert the T-bar into the leg divider (fig_b). Finally, use a screwdriver to tighten the screws to secure the T-bar (fig_c).
2. Using cover: Turn over the cushion and loosen the screws at two sides of the leg divider, then take off the leg divider (fig_a), press the small white cover into the seat (fig_b) and tighten the screws on both sides (fig_c).

WARNING: Never leave the child unattended!

WARNING: Always use the restraint system, and adjust to fit snugly.

WARNING: Please keep accessories away from babies and children to avoid harms from eating by mistake.

Safety Notes

These instructions are important.

Read these instructions before use and keep them for future reference. Your child's safety may be affected if you do not follow these instructions.

RECLINED CRADLE MODE

This mode is suitable from birth up to 9kg or 6 months old, whichever comes first. It complies with EN12790:2009.

WARNING:

NEVER LEAVE THE CHILD UNATTENDED.

DO NOT USE THE RECLINED CRADLE ONCE YOUR CHILD CAN SIT UNAIDED.

THE RECLINED CRADLE IS NOT INTENDED FOR PROLONGED PERIODS OF SLEEPING.

IT IS DANGEROUS TO USE THE RECLINED CRADLE ON AN ELEVATED SURFACE, E.G. A TABLE.

ALWAYS USE THE RESTRAINT SYSTEM.

NEVER USE THE TOY BAR TO CARRY THE RECLINED CRADLE.

MAXIMUM WEIGHT: 9KG

THIS RECLINED CRADLE DOES NOT REPLACE A COT OR A BED. SHOULD YOUR CHILD NEED TO SLEEP, THEN IT SHOULD BE PLACED IN A SUITABLE COT OR BED.

DO NOT USE THE RECLINED CRADLE IF ANY COMPONENTS ARE BROKEN OR MISSING.

DO NOT USE ACCESSORIES OR REPLACEMENT PARTS OTHER THAN THOSE APPROVED BY THE MANUFACTURER.

HIGH CHAIR MODE

This mode with tray is suitable from 6 months to 15 kg or 3 years old, whichever comes first.

This mode without tray is suitable from 12 months to 15 kg or 3 years old, whichever comes first. It complies with EN14988:2017+A1:2020.

WARNING:

NEVER LEAVE THE CHILD UNATTENDED.

ALWAYS USE THE RESTRAINT SYSTEM.

FALLING HAZARD: PREVENT YOUR CHILD FROM CLIMBING ON THE PRODUCT.

DO NOT USE THE PRODUCT UNLESS ALL COMPONENTS ARE CORRECTLY FITTED AND ADJUSTED.

BE AWARE OF THE RISK OF OPEN FIRES AND OTHER SOURCES OF STRONG HEAT IN THE VICINITY OF THE PRODUCT.

BE AWARE OF THE RISK OF TILTING WHEN YOUR CHILD CAN PUSH ITS FEET AGAINST A TABLE OR ANY OTHER STRUCTURE.

NOT TO USE THE PRODUCT UNTIL THE CHILD CAN SIT UP UNAIDED.

NOT TO USE THE PRODUCT IF ANY PART IS BROKEN, TORN OR MISSING.

KEEP CHILDREN AWAY WHEN UNFOLDING AND FOLDING THE PRODUCT TO AVOID INJURY.

THIS HIGH CHAIR IS INTENDED FOR CHILDREN ABLE TO SIT UP UNAIDED AND UP TO 3 YEARS OR A MAXIMUM WEIGHT OF 15 KG.

Cleaning and maintenance

PRODUCT MAINTENANCE:

Protect from the weather: water, rain, or snow; prolonged and continuous exposure to bright sunlight may give rise to colour changes of various different materials; store this product in a dry place. The maintenance have to be regularly.

CLEANING THE CHASSIS:

Periodically clean all plastic parts with a damp cloth. Do not use solvent or similar cleaning products; keep all metal parts dry to prevent rusting; keep moving parts clean (adjustment mechanisms, locking mechanisms, wheels, etc) and free of dust and sand and if necessary, lubricate with light machine oil all metallic moving parts. Check all nuts and bolts for tightness and tighten when required. Check all coverings for bolts and sharp edges and replace when required. Check slightly swing seat and attachments for evidence of deterioration. Replace when required in accordance with the manufacturer's instructions.

CLEANING THE FABRIC:

Wash with a damp cloth and neutral detergent. Do not wring. Do not use chlorine bleach. Do not iron. Do not dry clean. Do not use solvents for stain removal. Do not spin dry.



Silver Cross®