

peachtree

shift™



Made for



iPod



iPhone

Made for

iPhone 6 Plus, iPhone 6, iPhone 5s, iPhone 5c, iPhone 5, iPod touch (5th generation).

Important Information



The exclamation point within an equilateral triangle is intended to alert the user to the presence of important operation and maintenance (servicing) instruction in the literature accompanying the appliance.

WARNING: TO REDUCE THE RISK OF FIRE OR ELECTRIC SHOCK, DO NOT EXPOSE THIS APPLIANCE TO RAIN OR MOISTURE. DO NOT OPEN THE CABINET. REFER SERVICING TO QUALIFIED PERSONNEL ONLY. THE APPARATUS SHALL NOT BE EXPOSED TO DRIPPING OR SPLASHING AND THAT NO OBJECTS FILLED WITH LIQUIDS, SUCH AS VASES SHALL BE PLACED ON THE APPARATUS.

- 1 Read these instructions.
- 2 Keep these instructions.
- 3 Heed all warnings.
- 4 Follow all instructions.
- 5 Do not use this device near water.
- 6 Clean only with a dry cloth.
- 7 Do not install near any heat sources such as radiators, heat registers, stoves, or other apparatuses (including amplifiers) that produce heat.
- 8 Only use attachments and accessories specified by the manufacturer.
- 9 Refer all servicing to qualified service personnel. Servicing is required when the apparatus has been damaged in any way, such as when the power supply cord or plug is damaged, liquid has been spilled or objects have fallen into the apparatus, the apparatus has been exposed to rain or moisture, does not operate normally, or has been dropped.



WARNING: To prevent possible hearing damage, do not listen at high volume levels for long periods. Caution should be taken when using earphones or headphones with the product because excessive sound pressure (volume) from earphones or headphones can cause hearing loss.

FCC Statement

This equipment has been tested and found to comply with the limits for a Class B digital device, pursuant to Part 15 of the FCC Rules. These limits are designed to provide reasonable protection against harmful interference in a residential installation. This equipment generates, uses, and can radiate radio frequency energy and, if not installed and used in accordance with the instructions, may cause harmful interference to radio communications. However, there is no guarantee that interference will not occur in a particular installation. If this equipment does cause harmful interference to radio or television reception, which can be determined by turning the equipment off and on, the user is encouraged to try to correct the interference by one or more of the following measures:

- Reorient or relocate the receiving antenna.
- Increase the separation between the equipment and receiver.
- Connect the equipment into an outlet on a circuit different from that to which the receiver is connected.
- Consult the dealer or an experienced radio or TV technician for help.
- This device complies with FCC radiation exposure limits set forth for an uncontrolled environment.

CAUTION: Any changes or modifications not expressly approved by the party responsible for compliance could void the user's authority to operate the equipment.

This device complies with Part 15 of the FCC Rules. Operation is subject to the following two conditions: (1) This device may not cause harmful interference, and (2) this device must accept any interference received, including interference that may cause undesired operation.

DECLARATION OF CONFORMITY

We, Peachtree Audio located at 2045 120th NE, Bellevue, WA 98005, declare that the Peachtree Audio product described in this manual is in compliance with the corresponding technical standards.



For European Customers

Disposal of electrical and electronic equipment:

- (a) All electrical and electronic equipment should be disposed of separately from the municipal waste stream via collection facilities designated by the government or local authorities.
- (b) By disposing of electrical and electronic equipment correctly, you will help save valuable resources and prevent any potential negative effects on human health and the environment.
- (c) Improper disposal of waste electrical and electronic equipment can have serious effects on the environment and human health because of the presence of hazardous substances in the equipment.
- (d) The Waste Electrical and Electronic Equipment (WEEE) symbol, which shows a wheeled bin that has been crossed out, indicates that electrical and electronic equipment must be collected and disposed of separately from household waste.
- (e) Return and collection systems are available to end users. For more detailed information about the disposal of old electrical and electronic equipment, please contact your city office, waste disposal service or the shop where you purchased the equipment.



Pb, Hg, Cd

For Canada

Industry Canada's Compliance Statement:

This Class B digital apparatus complies with Canadian ICES-003.

Cet appareil numérique de la classe B est conforme à la norme NMB-003 du Canada.

Legal Notice

"Made for iPod" and "Made for iPhone" mean that an electronic accessory has been designed to connect specifically to iPod or iPhone respectively, and has been certified by the developer to meet Apple performance standards. Apple is not responsible for the operation of this device or its compliance with safety and regulatory standards. Please note that the use of this accessory with iPod or iPhone may affect wireless performance.

Compatible iPod/iPhone Models

Made for

iPhone 6 Plus, iPhone 6, iPhone 5s, iPhone 5c, iPhone 5, iPod touch (5th generation).



iPhone and iPod touch are trademarks of Apple Inc., registered in the U.S. and other countries. Lightning is a trademark of Apple Inc.

Android™ Compatibility

shift USB input B works with Android devices that support USB OTG (USB On-The-Go) and USB Audio Class 2.0. Not all devices are compatible. Android is a trademark of Google Inc.

peachtree

shift™

- ▶ **Introduction**
- ▶ **Contents and Controls**
- ▶ **Battery**
- ▶ **Indicators**
- ▶ **Apple iOS Device**
- ▶ **Android OS Device**
- ▶ **Technical Specifications**
- ▶ **Product Warranty and Service**

▶▶▶ INTRODUCTION

Congratulations on purchasing shift and thank you for supporting Peachtree Audio! shift is a portable Digital-to-Analog Converter (DAC), headphone amplifier and mobile device battery charger housed in a small, beautiful case finished in premium quality leather and aluminum. shift is designed to connect your mobile phone, tablet or PC/Mac and provide an exceptional listening experience through your headphones (or connected audio system) with all of your music including PCM files up to 32-bit/384 kHz and DSD files up to 5.6 MHz.

shift delivers the same world-class sound quality and ease-of-use our home products are known for in a form-factor specifically designed to enhance your on-the-go listening experience. The DAC creates a pure analog signal and the amplifier provides plenty of clean power to drive virtually any type of headphone. The built-in battery will keep shift running for hours on end and can also charge the battery in your mobile device.*

Thank you again for your purchase and for supporting Peachtree Audio. We hope shift brings you many years of listening enjoyment and makes all of your travels that much more enjoyable!

- The Peachtree Audio Team

***Not all mobile device are compatible. See specifications for more details.**

▶▶▶ CONTENTS

Contents of Packaging:

- ① Manual
- ② shift
- ③ Leather Case
- ④ Lighting Cable
- ⑤ Android Cable
- ⑥ PC/Mac Cable

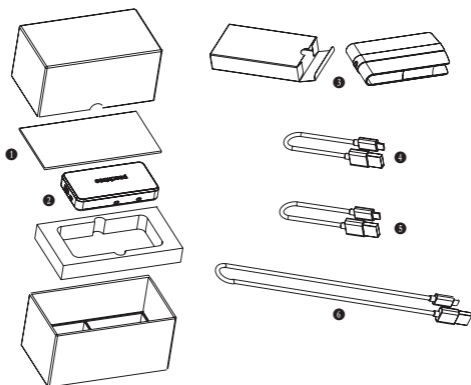

▶▶▶ CONTROLS

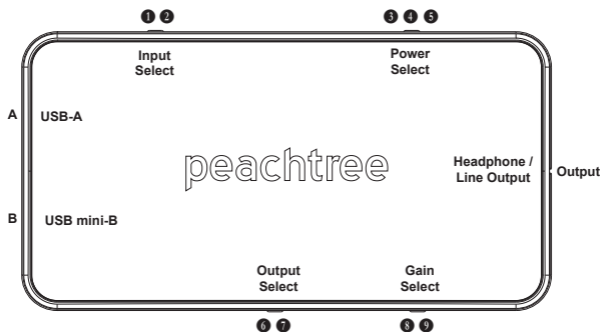

Input Select

Note: shift will charge itself whenever 5V is present on the USB mini-B connector regardless of the position of this switch.



- ① **B** Selects the USB mini-B connector (B) to play audio from a compatible PC/Mac or Android device.
- ② **A** Selects the USB-A connector (A) to play audio from a compatible Apple device.

Power Select



- ③  Unit on and the internal battery charging the connected device.
- ④ **|** Unit on and NOT charging the connected device.
- ⑤ **○** Unit off.

Output Select

Note: This switch is only “read” at power up. Be sure to lower system volume when switching to line out!

- ⑥  Utilizes the internal volume control for use with headphones.
- ⑦  Bypasses the internal volume control and provides maximum output level for use with a connected device that also controls volume.

Gain Select

- ⑧  Sets the output level for low impedance (<math><100\Omega</math>) headphones. Recommended for “in-ear” headphones.
- ⑨  Sets the output level for high impedance (>math>>100\Omega</math>) headphones. Recommended for “on-ear” headphones.

▶▶▶ BATTERY

The primary use of the built-in battery is to power shift for listening to audio. In this mode, several hours of high-quality audio can be enjoyed by connecting to a mobile device.

A secondary function of shift's internal battery is to allow a mobile device's battery to be topped-up from time to time. By following a few simple recommendations, shift's battery can provide a long and trouble free life.

- Avoid completely discharging the battery on a regular basis. Keeping the battery charged (battery indicator LED Green or Yellow) will prolong battery life.
- It is not recommended for shift to charge a mobile device if the mobile device's battery is less than 50% full; the combination of battery charging and shift's internal power consumption will quickly deplete shift's internal battery reducing available listening time.
- If the mobile device battery is less than 50% it is recommended that the device manufacturer's power supply is used to charge the battery.
- It is not recommended to use shift to charge a portable device if shift's LED Battery Indicator is Red. This action will quickly deplete shift's internal battery reducing available listening time.



Charging shift

Connect the USB-B mini port of shift to a USB 5V wall charger (not included) using the included USB PC/Mac cable. Plugging the charger into a power outlet will begin charging shift's battery. The Charging Indicator on the end of the unit will display the battery level as per the table below. shift's battery will also charge when shift is connected to a PC/Mac.

Charging Mobile Devices

When battery charging a mobile device, shift's Battery Indicator LED can transition from OFF to Blinking RED over a period of time. A short elapsed time indicates a) shift's battery needs re-charged and/or b) the mobile device battery is significantly depleted. In both cases, charging the mobile device battery with shift should be stopped and shift's battery re-charged.

▶▶▶ INDICATORS

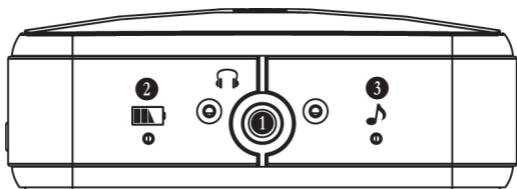

1 Headphone / Line Output

2 LED indicator while charging shift: LED Indicates the battery level while charging shift:

Green	Yellow	Red	Blinking Red (slow) (1 blink every 5 seconds)	Blinking Red (fast) (1 blink every 2 seconds)
100% to 90%	90% to 50%	50% to 20%	20% to 5%	less than 5%

 **LED indicator while not charging shift:** At power on, shift will display the battery level using the scale above for 3 seconds after initial calibration state (solid White LED). If the battery is less than 20% charged, the LED will continue blinking Red, shift should be re-charged as soon as possible.

3 LED indicator of the audio signal input: LED indicates the format of the signal and sampling rate.

Blue	Light Blue	White	Magenta
PCM	PCM	PCM	DSD
44.1 or 48 kHz	88.2 or 96 kHz	176.4, 192, 352.8 or 384 kHz	2.6 or 5.2 MHz

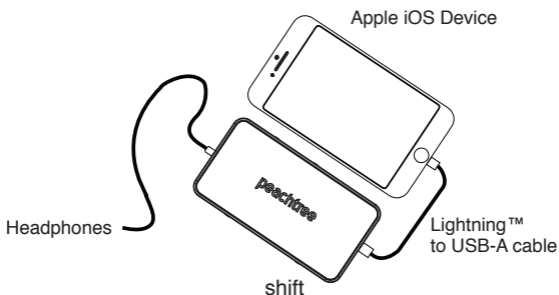

Connecting to an Apple iOS Device



Using the supplied Lightning™ to USB-A cable, connect the USB-A connector to shift and the Lightning connector to the iOS device.

Make sure the power switch on shift is set to on “**I**” or on+charge “”.

Make sure the input switch is set to **A**.

Make sure the output switch is set to the  and the gain switch is set according to the impedance of the connected headphones.  provides greater output capability for headphones with high impedance (>100 Ω).

Control the volume level and music playback from the connected iOS device.

▶▶▶ ANDROID CONNECTION

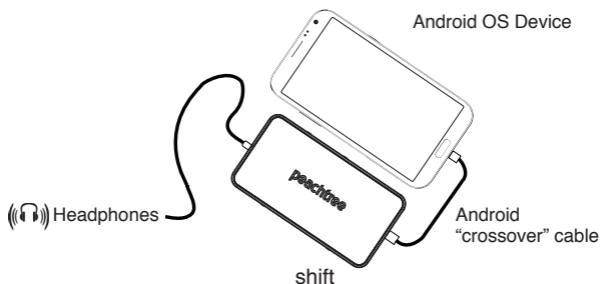

Connecting to an Android OS Device



Using the supplied Android "crossover" cable, connect the USB-B mini connector to shift and the USB-B micro connector to the Android device.

Make sure the input switch is set to **B**.

Make sure the power switch on shift is set to on "I".

Make sure the output switch is set to the  and the gain switch is set according to the impedance of the connected headphones.  provides greater output capability for headphones with high impedance ($>100 \Omega$).

Control the volume level and music playback from the connected Android device.

▶▶▶ PERSONAL COMPUTER CONNECTION

Connecting to a PC (OSX or Windows)

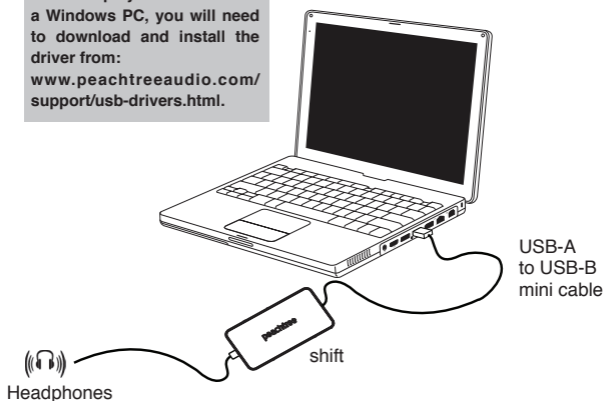

Note: To play back files from a Windows PC, you will need to download and install the driver from:
www.peachtreeaudio.com/support/usb-drivers.html.



Using the supplied USB-A to USB-B mini cable, connect the USB-B mini connector to shift and the USB-A connector to the PC.

Make sure the A/B input switch is set to **B**.

Make sure the power switch on shift is set to on “**I**”.

Make sure the output switch is set to the  and the gain switch is set according to the impedance of the connected headphones.  provides greater output capability for headphones with high impedance (>100 Ω).

Control the volume level and music playback from the connected PC/Mac. Note: there may be two volume controls in use; one in the music management program and another in the PC/Mac operating system.

▶▶▶ TECHNICAL SPECIFICATIONS

Device Compatibility

Made for

- iPhone 6 Plus
- iPhone 6
- iPhone 5s
- iPhone 5c
- iPhone 5
- iPod touch (5th generation)

Android™ Compatibility

shift's USB input B works with Android devices that support USB OTG (USB On-The-Go) and USB Audio Class 2.0. Not all devices are compatible.

Android is a trademark of Google Inc.

Mac OSX 10.6.4 and later

Windows XP and later

Audio Signal Compatibility

PCM 16 - 32-bit, 44.1 - 384kHz

DSD 2.8 - 5.6MHz

Frequency Response:

8Hz – 20kHz, < 0.4dB

8Hz – 70kHz, < 3dB

Output Impedance: 1Ω

Maximum Output Level: 1.8Vrms

Gain Range: -100dB to +4dB

Signal-to-Noise Ratio: 103dB unweighted (20Hz-22kHz, measured at the headphone / line out)

Continuous Output Power (both channels driven):

79mW rms per channel into 16Ω

57mW rms per channel into 32Ω

12mW rms per channel into 300Ω

Battery

Type: Li-ion polymer

Charge Time: ~4 hours

Run time (On mode): ~8 hours

Charge time for connected phone: ~2 hours

Note: Times provided are estimates and actual times will vary. When charging a mobile device battery using shift, it is recommended that the device's battery level is more than 50%.

International Warranty

shift has a 1 year parts and labor warranty from the date of purchase from an authorized Peachtree Audio dealer or distributor. Peachtree Audio takes no responsibility for failures caused by accident, misuse, abuse, unusual wear and tear, neglect, unauthorized adjustment or repair. This warranty does not cover shipping costs. Visit www.peachtreeaudio.com for a copy of the complete warranty.

Claims Under Warranty

In the event you experience a product failure, please contact your dealer or distributor or email service@peachtreeaudio.com for a Return Authorization (RA) number **PRIOR** to shipping the product to a service center. Any product received without a RA number may be misdirected.

Please pack the unit in its original shipping carton and packaging (or similar if not available) and return it to the dealer or distributor from whom it was purchased, or if unavailable, directly to a service center as directed by Peachtree Audio. Please use a suitable carrier such as FedEx or UPS. **DO NOT SEND BY POSTAL SERVICE.** Peachtree Audio does not accept responsibility for products while they are in transit. Please insure the product against potential damage or loss with the carrier.

For technical support please call or email:

+1-704-391-9337 (M-F, 9-5 PST)

service@peachtreeaudio.com

Peachtree Audio

2045 120th Avenue NE

Bellevue, WA 98005

USA

www.peachtreeaudio.com

peachtree

shift™

