



PENTAIR STARLINE

CENTRIFUGAL PUMP TECHNICAL DATA

MOTORPUMPS
50Hz PERFORMANCE

PUMP DIMENSIONS

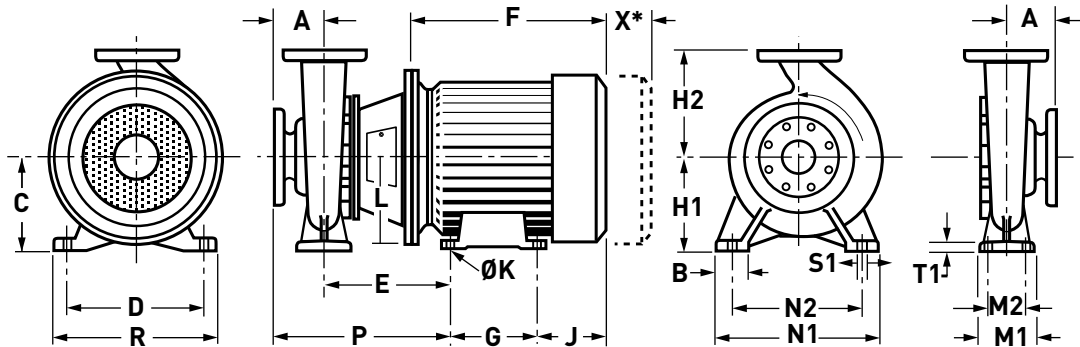

Pumps with **2900 RPM** (Nominal Speed) TEFC Motors

PUMP SIZE					PUMP DIMENSIONS																				WEIGHT (KG)				
INLET	OUTLET	IMP DIA	SHAFT NO.	MOTOR KW	FRAME SIZE	A	B	C	D	E	F	G	H1	H2	J	K	L	M1	M2	N1	N2	P	R	ST1		T1	GAP X*		
50	32 SEA	160	1	2.2	90L			90	140	205	290	125		109	10	100		70	240	190		285	180				57		
				3	100L	80	50	100	160	225	325	140	132	160	122	12	125	100	70	240	190		305	205	14	12	100	65	
				4	112M			112	190	232	340	140			130	12	125							312	230				77
				5.5	132S			132	216	271	390	140			161	12	150								351	270			
65	50 SEB	160	1	4	112M			112	190	232	340	140		130	12	125		70	240	190		312	230				78		
				5.5	132S	80	50	132	216	271	390	140	132	160	161	12	150	100	70	240	190		351	270	14	12	100	99	
				7.5	132S			132	216	271	390	140			161	12	150							351	270				105
80	65 SEC	160	1	5.5	132S			132	216	271	390	140		161	12	150		70	265	212		371	270				104		
				7.5	132S	100	50	132	216	271	390	140	160	180	161	12	150	100	70	265	212		371	270	14	13	100	110	
				11	160M			160	254	325	505	210			187	15	175							425	320				162
				15	160M			160	254	325	505	210			187	15	175							425	320				170
100	80 SED	160	2	11	160M			160	254	329	505	210		187	15	175		95	280	212		429	320				172		
				15	160M	100	65	160	254	329	505	210	160	200	187	15	175	125	95	280	212		429	320	14	14	100	180	
				18.5	160L			160	254	329	560	254			198	15	175						429	320				202	
50	32 SFA	200	1	5.5	132S			132	216	271	390	140		161	12	150		70	240	190		351	270				105		
				7.5	132S	80	50	132	216	271	390	140	160	180	161	12	150	100	70	240	190		351	270	14	13	100	111	
				11	160M			160	254	326	505	210			187	15	175						406	320				163	
65	40 SFB	200	1	7.5	132S			132	216	271	390	140		161	12	150		70	265	212		371	270				112		
				11	160M	100	50	160	254	326	505	210	160	180	187	15	175	100	70	265	212		426	320	14	13	100	164	
				15	160M			160	254	326	505	210			187	15	175						426	320				172	
80	50 SFC	200	1	11	160M			160	254	326	505	210		187	15	175		70	265	212		426	320				170		
				15	160M	100	50	160	254	326	505	210	160	200	187	15	175	100	70	265	212		426	320	14	13	100	178	
				18.5	160L			160	254	326	560	254			198	15	175						426	320				200	
				22	180M			180	279	339	575	241			213	15	175							439	355				233
100	65 SFD	200	2	18.5	160L			160	254	329	560	254		198	15	175		95	320	250		429	320				208		
				22	180M	100	65	180	279	342	575	241	180	225	213	15	175	125	95	320	250		442	355	14	15	140	241	
				30	200L			200	318	354	643	305			205	19	200						454	395				304	
125	80 SFE	200	2	22	180M			180	279	342	575	241		213	15	175		95	345	280		467	355				249		
				30	200L	125	65	200	318	354	643	305	180	250	205	19	200	125	95	345	280		479	395	14	16	140	312	
				37	200L			200	318	354	643	305			205	19	200						479	395				327	
45	225M			225	356	370	685	311			225	19	225							495	435				384				

* Gap necessary for the withdrawal or bearing housing, backplate and impeller assembly towards the drive end.





PENTAIR STARLINE

MOTORPUMPS
50Hz PERFORMANCE

PUMP DIMENSIONS

CENTRIFUGAL PUMP TECHNICAL DATA

Pumps with **2900 RPM** (Nominal Speed) TEFC Motors (CONTINUED)

PUMP SIZE			SHAFT NO.	MOTOR KW	FRAME SIZE	PUMP DIMENSIONS																WEIGHT (KG)									
INLET	OUTLET	IMP DIA				A	B	C	D	E	F	G	H1	H2	J	K	L	M1	M2	N1	N2		P	R	ST1	T1	GAP X*				
125	100 SFF	200	2	30	200L	125	80	200	318	354	643	305			205	19	200				479	395				318					
				37	200L			200	318	354	643	305			205	19	200						479	395					333		
				45	225M			225	356	370	685	311	200	280	225	19	225	160	120	360	280			495	435	18	17	140		390	
				55	250M			250	406	419	748	349			231	24	275								544	490					501
				75	280S			280	457	441	823	368			265	24	275								566	550					642
65	40 SGB	250	2	11	160M	100	65	160	254	329	505	210			187	15	175				429	320				181					
				15	160M			160	254	329	505	210			187	15	175						429	320					189		
				18.5	160L			160	254	329	560	254	180	225	198	15	175	125	95	320	250			429	320	14	14	100		211	
				22	180M			180	279	342	575	241			213	15	175								442	355					244
				30	200L			200	318	354	643	305			205	19	200								454	395					307
80	50 SGC	250	2	22	180M	125	65	180	279	342	575	241			213	15	175				467	355				243					
				30	200L			200	318	354	643	305	180	225	205	19	200	125	95	320	250			479	395	14	15	100		306	
				37	200L			200	318	354	643	305			205	19	200							479	395					321	
				45	225M			225	356	370	685	311			225	19	225								495	435					378
100	65 SGD	250	2	30	200L	125	80	200	318	354	643	305			205	19	200				479	395				315					
				37	200L			200	318	354	643	305			205	19	200							479	395					330	
				45	225M			225	356	370	685	311	200	250	225	19	225	160	120	360	280			495	435	18	16	140		387	
				55	250M			250	406	419	748	349			231	24	275								544	490					498
				75	280S			280	457	441	823	368			265	24	275								566	550					639
125	80 SGE	250	2	45	225M	125	80	225	356	370	685	311			225	19	225				495	435				398					
				55	250M			250	406	419	748	349	225	280	231	24	275	160	120	400	315			544	490	18	18	140		509	
				75	280S			280	457	441	823	368			265	24	275							566	550					650	
				90	280M			280	457	441	873	419			264	24	275							566	550					726	
125	100 SGF	250	3	55	250M	140	80	250	406	439	748	349			231	24	275				579	490				518					
				75	280S			280	457	461	823	368	225	280	265	24	275	160	120	400	315			601	550	18	18	140		659	
				90	280M			280	457	461	873	419			264	24	275							601	550					735	
				110	315S			315	508	487	1038	406			416	28	330							627	628					1099	
65	40 SHB	315	2	22	180M	125	65	180	279	342	575	241			213	15	175				467	355				251					
				30	200L			200	318	354	643	305	200	250	205	19	200	125	95	345	280			479	395	14	16	100		314	
				37	200L			200	318	354	643	305			205	19	200							479	395					329	
				45	225M			225	356	370	685	311			225	19	225							495	435					386	
80	50 SHC	315	2	30	200L	125	65	200	318	354	643	305			205	19	200				479	395				318					
				37	200L			200	318	354	643	305			205	19	200							479	395					333	
				45	225M			225	356	370	685	311	225	280	225	19	225	125	95	345	280			495	435	14	18	100		390	
				55	250M			250	406	419	748	349			231	24	275								544	490					501
100	65 SHD	315	3	30	200L	125	80	200	318	354	643	305			205	19	200				479	395				318					
				37	200L			200	318	354	643	305			205	19	200							479	395					333	
				45	225M			225	356	370	685	311	225	280	225	19	225	125	95	345	280			495	435	14	18	100		390	
				55	250M			250	406	419	748	349			231	24	275								544	490					501
125	80 SHE	315	3	75	280S	125	80	280	457	461	823	368			265	24	275				586	550				669					
				90	280M			280	457	461	873	419	250	315	264	24	275	160	120	400	315			586	550	18	20	140		745	
				110	315S			315	508	514	1038	406			416	28	330							639	628					1109	
				132	315M			315	508	514	1098	457			425	28	330							639	628					1209	
125	100 SHF	315	3	90	280M	140	80	280	457	461	873	419			264	24	275				601	550				754					
				110	315S			315	508	514	1038	406	250	315	416	28	330	160	120	400	315			654	628	18	19	140		1118	
				132	315M			315	508	514	1098	457			425	28	330							654	628					1218	

* Gap necessary for the withdrawal or bearing housing, backplate and impeller assembly towards the drive end.





PENTAIR STARLINE

MOTORPUMPS

50Hz PERFORMANCE

PUMP DIMENSIONS

CENTRIFUGAL PUMP TECHNICAL DATA

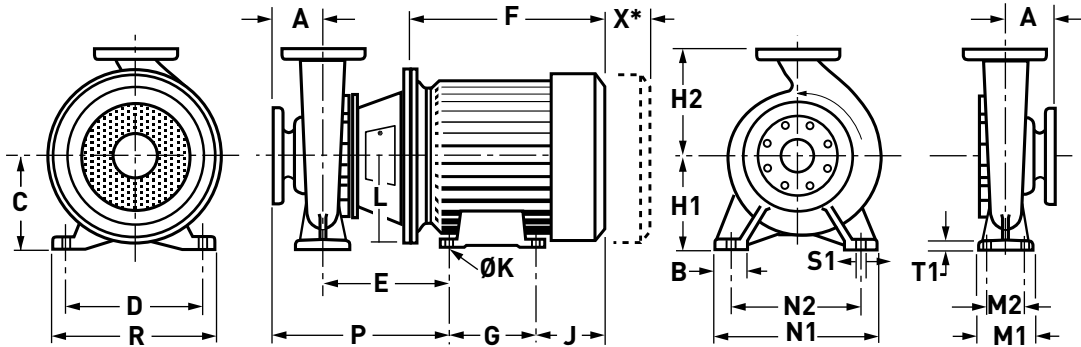

Pumps with **1450 RPM** (Nominal Speed) TEFC Motors

PUMP SIZE			SHAFT NO.	MOTOR KW	FRAME SIZE	PUMP DIMENSIONS																			WEIGHT (KG)				
INLET	OUTLET	IMP DIA				A	B	C	D	E	F	G	H1	H2	J	K	L	M1	M2	N1	N2	P	R	ST1		T1	GAP X*		
50	32 SEA	160	1	0.55	80	80	50	80	125	205	255	100	132	160	105	10	100	100	70	240	190	285	165	14	12	100	49		
				0.75	80			80	125	205	255	100			105	10	100						285	165					50
65	50 SEB	160	1	0.55	80	80	50	80	125	205	255	100	132	160	105	10	100		70	240	190	285	165	14	12	100	50		
				0.75	80			80	125	205	255	100	132	160	105	10	100	100	70	240	190	285	165					51	
				1.1	90S			90	140	211	265	100			109	10	100						291	180					55
80	65 SEC	160	1	0.75	80	100	50	80	125	205	255	100		160	180	105	10	100		70	265	212	305	165	14	13	100	56	
				1.1	90S			90	140	211	265	100			109	10	100	100	70	265	212	311	180					60	
				1.5	90L			90	140	211	290	125			109	10	100					311	180					65	
100	80 SED	160	2	1.1	90S			90	140	215	265	100			109	10	100		70	280	212	315	180	14	14	100	70		
				1.5	90L	100	65	90	140	215	290	125	160	200	109	10	100	125	95	280	212	315	180					75	
				2.2	100L			100	160	229	325	140			122	12	125					329	205						82
				3	100L			100	160	229	325	140			122	12	125					329	205						86
50	32 SFA	200	1	0.75	80	80	50	80	125	205	255	100		160	180	105	10	100		70	240	190	285	165	14	13	100	57	
				1.1	90S			90	140	211	265	100	160	180	109	10	100	100	70	240	190	291	180					61	
				1.5	90L			90	140	211	290	125			109	10	100					291	180						66
65	40 SFB	200	1	1.1	90S			90	140	211	265	100			109	10	100		70	265	212	311	180				62		
				1.5	90L	100	50	90	140	211	290	125	160	180	109	10	100	100	70	265	212	311	180	14	13	100	67		
				2.2	100L			100	160	225	325	140			122	12	125				325	205						74	
80	50 SFC	200	1	1.5	90L			90	140	211	290	125			109	10	100		70	265	212	311	180				73		
				2.2	100L	100	50	100	160	225	325	140	160	200	122	12	125	100	70	265	212	325	205	14	13	100	80		
				3	100L			100	160	225	325	140			122	12	125				325	205						84	
100	65 SFD	200	2	2.2	100L			100	160	229	325	140			122	12	125		70	320	250	329	205				88		
				3	100L	100	65	100	160	229	325	140	180	225	122	12	125	125	95	320	250	329	205	14	15	140	92		
				4	112M			112	190	236	340	140			130	12	125					336	230						97
				5.5	132S			132	216	275	390	140			161	12	150					375	270						124
125	80 SFE	200	2	3	100L			100	160	228	325	140			122	12	125		70	345	280	353	205				100		
				4	112M	125	65	112	190	235	340	140	180	250	130	12	125	125	95	345	280	360	230	14	16	140	105		
				5.5	132S			132	216	274	390	140			161	12	150					399	270						132
				7.5	132M			132	216	274	430	178			163	12	150					399	270						145
125	100 SFF	200	2	4	112M			112	190	236	340	140			130	12	125		70	360	280	361	230				111		
				5.5	132S	125	80	132	216	275	390	140	200	280	161	12	150	160	120	360	280	400	270	18	17	140	138		
				7.5	132M			132	216	275	430	178			163	12	150					400	270						151

* Gap necessary for the withdrawal or bearing housing, backplate and impeller assembly towards the drive end.





PENTAIR STARLINE

MOTORPUMPS
50Hz PERFORMANCE

PUMP DIMENSIONS

CENTRIFUGAL PUMP TECHNICAL DATA

Pumps with **1450 RPM** (Nominal Speed) TEFC Motors (CONTINUED)

PUMP SIZE			SHAFT NO.	MOTOR KW	FRAME SIZE	PUMP DIMENSIONS																		WEIGHT (KG)				
INLET	OUTLET	IMP DIA				A	B	C	D	E	F	G	H1	H2	J	K	L	M1	M2	N1	N2	P	R		ST1	T1	GAP X*	
65	40	250	2	1.5	90L			90	140	215	290	125			109	10	100					315	180				84	
				2.2	100L	100	65	100	160	229	325	140	180	225	122	12	125	125	95	320	250	329	205	14	14	100	91	
				3	100L			100	160	229	325	140			122	12	125					329	205					95
80	50	250	2	3	100L			100	160	229	325	140			122	12	125					354	205				94	
				4	112M	125	65	112	190	236	340	140	180	225	130	12	125	125	95	320	250	361	230	14	15	100	99	
				5.5	132S			132	216	275	390	140			161	12	150					400	270					126
100	65	250	2	4	112M			112	190	236	340	140			130	12	125					361	230				108	
				5.5	132S	125	80	132	216	275	390	140	200	250	161	12	150	160	120	360	280	400	270	18	16	140	135	
				7.5	132M			132	216	275	430	178			163	12	150					400	270					148
125	80	250	2	5.5	132S			132	216	274	390	140			161	12	150					399	270				146	
				7.5	132M	125	80	132	216	274	430	178	225	280	163	12	150	160	120	400	315	399	270	18	18	140	159	
				11	160M			160	254	329	505	210			187	15	175					454	320					206
125	100	250	3	7.5	132M			132	216	295	430	178			163	12	150					435	270				177	
				11	160M	140	80	160	254	349	505	210	225	280	187	15	175	160	120	400	315	489	320	18	18	140	223	
				15	160L			160	254	349	560	254			198	15	175					489	320					244
150	125	250	3	11	160M			160	254	349	505	210			187	15	175					489	320				241	
				15	160L	140	80	160	254	349	560	254	250	355	198	15	175	160	120	400	315	489	320	18	19	140	262	
				18.5	180M			180	279	362	575	241			213	15	175					502	355					300
				22	180L			180	279	362	615	279			215	15	175					502	355					308
65	40	315	2	3	100L			100	160	229	325	140			122	12	125					354	205				102	
				4	112M	125	65	112	190	236	340	140	200	250	130	12	125	125	95	345	280	361	230	14	16	100	107	
				5.5	132S			132	216	275	390	140			161	12	150					400	270					134
80	50	315	2	4	112M			112	190	236	340	140			130	12	125					361	230				111	
				5.5	132S	125	65	132	216	275	390	140	225	280	161	12	150	125	95	345	280	400	270	14	18	100	138	
				7.5	132M			132	216	275	430	178			163	12	150					400	270					151
100	65	315	3	7.5	132M			132	216	294	430	178			163	12	150					419	270				178	
				11	160M	125	80	160	254	349	505	210	225	280	187	15	175	160	120	400	315	474	320	18	18	140	224	
				15	160L			160	254	349	560	254			198	15	175					474	320					245
125	80	315	3	11	160M			160	254	349	505	210			187	15	175					474	320				233	
				15	160L	125	80	160	254	349	560	254	250	315	198	15	175	160	120	400	315	474	320	18	20	140	254	
				18.5	180M			180	279	362	575	241			213	15	175					487	355					292
125	100	315	3	11	160M			160	254	349	505	210			187	15	175					489	320				242	
				15	160L	140	80	160	254	349	560	254	250	315	198	15	175	160	120	400	315	489	320	18	19	140	263	
				18.5	180M			180	279	362	575	241			213	15	175					502	355					301
				22	180L			180	279	362	615	279			215	15	175					502	355					309
150	125	315	3	18.5	180M			180	279	362	575	241			213	15	175					502	355				319	
				22	180L			180	279	362	615	279			215	15	175					502	355					327
				30	200L	140	100	200	318	374	643	305	280	355	205	19	200	200	150	500	400	514	395	22	20	140	410	
				37	225S			225	356	420	660	286			225	19	225					560	435					429
				45	225M			225	356	420	685	311			225	19	225					560	435					465
200	150	315	4	22	180L			180	279	461	615	279			215	15	175					621	355				463	
				30	200L	160	100	200	318	473	643	305	315	400	205	19	200	210	150	540	450	633	395	22	20	180	543	
				37	225S			225	356	489	660	286			225	19	225					649	435					557
				45	225M			225	356	489	685	311			225	19	225					649	435					593

* Gap necessary for the withdrawal or bearing housing, backplate and impeller assembly towards the drive end.





PENTAIR STARLINE

MOTORPUMPS

50Hz PERFORMANCE

PUMP DIMENSIONS

CENTRIFUGAL PUMP TECHNICAL DATA

Pumps with **1450 RPM** (Nominal Speed) TEFC Motors (CONTINUED)

PUMP SIZE			SHAFT NO.	MOTOR KW	FRAME SIZE	PUMP DIMENSIONS																			WEIGHT (KG)		
INLET	OUTLET	IMP DIA				A	B	C	D	E	F	G	H1	H2	J	K	L	M1	M2	N1	N2	P	R	ST1		T1	GAP X*
250	200 SHJ	315	4	37	225S	180	100	225	356	489	660	286	315	450	225	19	225	210	150	540	450	669	435	22	25	180	597
				45	225M			225	356	489	685	311			225	19	225					669	435				633
				55	250M			250	406	508	748	349			231	24	275					688	490				740
				75	280S			280	457	530	823	368			265	24	275					710	550				875
125	80 SJE	400	3	15	160L	125	80	160	254	349	560	254	280	355	198	15	175	160	120	435	355	474	320	18	20	140	292
				18.5	180M			180	279	362	575	241			213	15	175					487	355				330
				22	180L			180	279	362	615	279			215	15	175					487	355				338
				30	200L			200	318	374	643	305			205	19	200					499	395				421
125	100 SJF	400	3	22	180L	140	100	180	279	362	615	279	280	355	215	15	175	200	150	500	400	502	355	22	20	140	347
				30	200L			200	318	374	643	305			205	19	200					514	395				430
				37	225S			225	356	420	660	286			225	19	225					560	435				449
				45	225M			225	356	420	685	311			225	19	225					560	435				485
150	125 SJG	400	3	37	225S	140	100	225	356	420	660	286	315	400	225	19	225	200	150	500	400	560	435	22	21	140	463
				45	225M			225	356	420	685	311			225	19	225					560	435				499
				55	250M			250	406	439	748	349			231	24	275					579	490				613
200	150 SJH	400	4	45	225M	160	100	225	356	489	685	311	315	450	225	19	225	210	150	540	450	649	435	22	25	180	658
				55	250M			250	406	508	748	349			231	24	275					668	490				765
				75	280S			280	457	530	823	368			265	24	275					690	550				900
				90	280M			280	457	530	873	419			265	24	275					690	550				1005
				110	315S			315	508	586	1038	406			416	28	330					746	628				1338
125	100 SKF	500	4	55	250M	160	100	250	406	508	748	349	355	450	231	24	275	210	150	540	450	668	490	22	25	180	804
				75	280S			280	457	530	823	368			265	24	275					690	550				939
				90	280M			280	457	530	873	419			265	24	275					690	550				1044
				110	315S			315	508	586	1038	406			416	28	330					746	628				1377
150	125 SKG	500	4	75	280S	160	100	280	457	530	823	368	355	450	265	24	275	210	150	540	450	690	550	22	25	180	963
				90	280M			280	457	530	873	419			265	24	275					690	550				1068
				110	315S			315	508	586	1038	406			416	28	330					746	628				1401
200	150 SKH	500	4	90	280M	160	100	280	457	530	873	419	400	500	265	24	275	210	150	540	450	690	550	22	25	180	1092
				110	315S			315	508	586	1038	406			416	28	330					746	628				1425
				132	315M			315	508	586	1098	457			425	28	330					746	628				1525
				160	315L			315	508	586	1148	508			425	28	330					746	628				1585
				200	315L			315	508	586	1148	508			425	28	330										1615

* Gap necessary for the withdrawal or bearing housing, backplate and impeller assembly towards the drive end.





PENTAIR STARLINE

MOTORPUMPS
50Hz PERFORMANCE

PUMP DIMENSIONS

CENTRIFUGAL PUMP TECHNICAL DATA

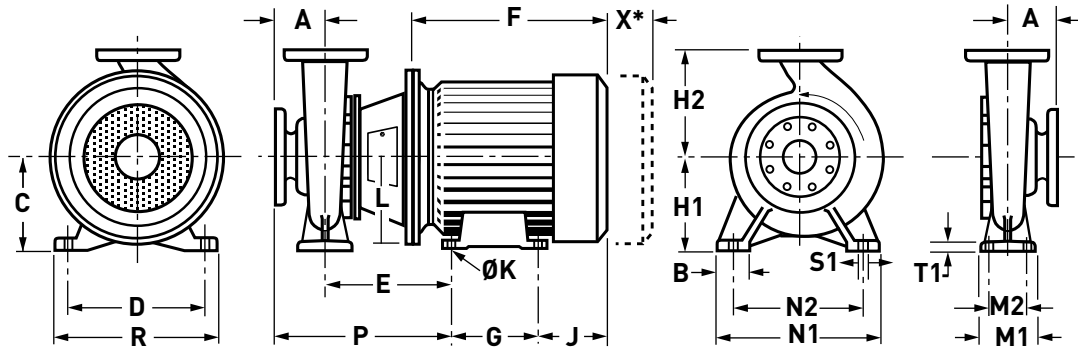

Pumps with 970 RPM (Nominal Speed) TEFC Motors

PUMP SIZE			SHAFT NO.	MOTOR KW	FRAME SIZE	PUMP DIMENSIONS																	WEIGHT (KG)					
INLET	OUTLET	IMP DIA				A	B	C	D	E	F	G	H1	H2	J	K	L	M1	M2	N1	N2	P		R	ST1	T1	GAP X*	
200	150	315	4	7.5	160M			160	254	448	505	210			187	15	175			608	320				392			
				11	160L	160	100	160	254	448	560	254	315	400	198	15	175	210	150	540	450	608	320	22	20	180	420	
				15	180L	180		180	279	461	615	279			215	15	175					621	355					468
250	200	315	4	11	160L			160	254	448	560	254		198	15	175			628	320					460			
				15	180L	180	100	180	279	461	615	279	315	450	215	15	175	210	150	540	450	641	355	22	25	180	508	
				18.5	200L			200	318	473	643	305			205	19	200					653	395					533
			22	200L			200	318	473	643	305			205	19	200				653	395					563		
200	150	400	4	15	180L			180	279	461	615	279		215	15	175			621	355					533			
				18.5	200L	160	100	200	318	473	643	305	315	450	205	19	200	210	150	540	450	633	395	22	25	180	558	
				22	200L			200	318	473	643	305			205	19	200					633	395					588
				30	225M			225	356	489	685	311			225	19	225						649	435				
125	100	500	4	18.5	200L			200	318	473	643	305		205	19	200			633	395					597			
				22	200L	160	100	200	318	473	643	305	355	450	205	19	200	210	150	540	450	633	395	22	25	180	627	
				30	225M			225	356	489	685	311			225	19	225					649	435					669
				37	250M			250	406	508	748	349			231	24	275						668	490				
150	125	500	4	22	200L			200	318	473	643	305		205	19	200			633	395					651			
				30	225M	160	100	225	356	489	685	311	355	450	225	19	225	210	150	540	450	649	435	22	25	180	693	
				37	250M			250	406	508	748	349			231	24	275					668	490					809
200	150	500	4	30	225M			225	356	489	685	311		225	19	225			649	435					717			
				37	250M	160	100	250	406	508	748	349	400	500	231	24	275	210	150	540	450	668	490	22	25	180	833	
				45	280S			280	457	530	823	368			265	24	275					690	550					961
				55	280M			280	457	530	873	419			265	24	275					690	550					1020

* Gap necessary for the withdrawal of bearing housing, backplate and impeller assembly towards the drive end.



PENTAIR STARLINE

MOTORPUMPS

50Hz PERFORMANCE

PUMP DIMENSIONS

CENTRIFUGAL PUMP TECHNICAL DATA

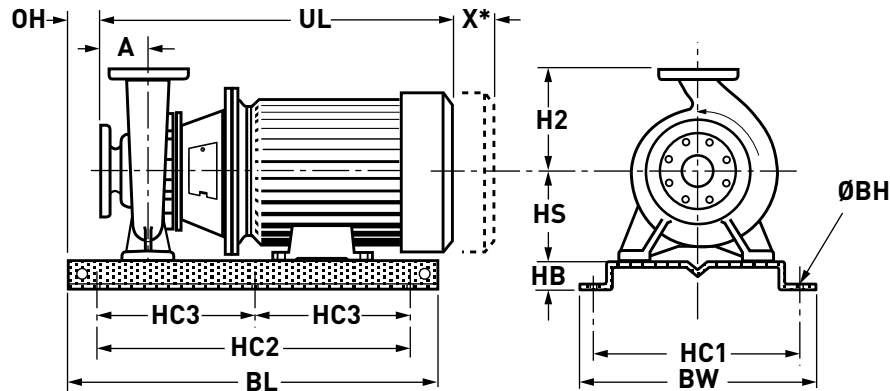

Pumps with **2900 RPM** (Nominal Speed) TEFC Motors and Pressed Steel Base Plates

PUMP SIZE			SHAFT NO.	MOTOR KW	FRAME SIZE	PUMP DIMENSIONS												WEIGHT (KG)	
INLET	OUTLET	IMP DIA				BL	BW	HC1	HC2	HC3	HB	BH	OH	A	UL	HS	H2		GAP X*
50	32 SEA	160	1	2.2	90L	600	426	396	400	-	40	15			519	132			71
				3	100L	600	426	396	400	-	40	15			567	132			80
				4	112M	600	426	396	400	-	40	15	20	80	582	132	160	100	91
				5.5	132S	750	520	470	450	-	74	15			652	132			121
65	50 SEB	160	1	4	112M	600	426	396	400	-	40	15			582	132			92
				5.5	132S	750	520	470	450	-	74	15	20	80	652	157	160	100	122
				7.5	132S	750	520	470	450	-	74	15			652	157			128
80	65 SEC	160	1	5.5	132S	750	520	470	450	-	74	15			672	160			126
				7.5	132S	750	520	470	450	-	74	15	20	100	672	160	180	100	132
				11	160M	750	520	470	450	-	74	15			822	180			186
				15	160M	900	572	522	600	-	93	19			822	180			207
100	80 SED	160	2	11	160M	750	520	470	450	-	74	15			826	180			196
				15	160M	900	572	522	600	-	93	19	19.5	100	826	180	200	100	217
				18.5	160L	900	572	522	600	-	93	19			881	180			239
50	32 SFA	200	1	5.5	132S	750	520	470	450	-	74	15			652	160			127
				7.5	132S	750	520	470	450	-	74	15	20	80	652	160	180	100	133
				11	160M	750	520	470	450	-	74	15			803	180			187
65	40 SFB	200	1	7.5	132S	750	520	470	450	-	74	15			672	160			134
				11	160M	750	520	470	450	-	74	15	20	100	823	180	180	100	188
				15	160M	900	572	522	600	-	93	19			823	180			209
80	50 SFC	200	1	11	160M	750	520	470	450	-	74	15			823	180			194
				15	160M	900	572	522	600	-	93	19	20	100	823	180	200	100	215
				18.5	160L	900	572	522	600	-	93	19			878	180			237
				22	180M	900	572	522	600	-	93	19			893	180			268
100	65 SFD	200	2	18.5	160L	900	572	522	600	-	93	19			881	180			243
				22	180M	900	572	522	600	-	93	19	19.5	100	896	180	225	140	274
				30	200L	900	572	522	600	-	93	19			964	200			339
				37	200L	900	572	522	600	-	93	19			964	200			354
125	80 SFE	200	2	22	180M	900	572	522	600	-	93	19			921	180			282
				30	200L	900	572	522	600	-	93	19	20.5	125	989	200	250	140	347
				37	200L	900	572	522	600	-	93	19			989	200			362
				45	225M	1100	622	572	800	-	68	19			1031	225			427

* Gap necessary for the withdrawal or bearing housing, backplate and impeller assembly towards the drive end.





PENTAIR STARLINE

MOTORPUMPS
50Hz PERFORMANCE

PUMP DIMENSIONS

CENTRIFUGAL PUMP TECHNICAL DATA

Pumps with **2900 RPM** (Nominal Speed) TEFC Motors and Pressed Steel Base Plates (CONTINUED)

PUMP SIZE			SHAFT NO.	MOTOR KW	FRAME SIZE	PUMP DIMENSIONS													WEIGHT (KG)
INLET	OUTLET	IMP DIA				BL	BW	HC1	HC2	HC3	HB	BH	OH	A	UL	HS	H2	GAP X*	
125	100 SFF	200	2	30	200L	900	572	522	600	-	93	19			989	200			351
				37	200L	900	572	522	600	-	93	19			989	200			366
				45	225M	1100	622	572	800	-	68	19	20	125	1031	225	280	140	432
				55	250M	1100	622	572	800	-	68	19			1124	280			553
				75	280S	1200	676	626	800	-	120	24			1199	280			725
65	40 SGB	250	2	11	160M	750	520	470	450	-	74	15			826	180			203
				15	160M	900	572	522	600	-	93	19			826	180			224
				18.5	160L	900	572	522	600	-	93	19	19.5	100	881	180	225	100	246
				22	180M	900	572	522	600	-	93	19			896	180			277
				30	200L	900	572	522	600	-	93	19			964	200			342
80	50 SGC	250	2	22	180M	900	572	522	600	-	93	19			921	180			276
				30	200L	900	572	522	600	-	93	19	20.5	125	989	200	225	100	341
				37	200L	900	572	522	600	-	93	19			989	200			356
				45	225M	1100	622	572	800	-	68	19			1031	225			421
100	65 SGD	250	2	30	200L	900	572	522	600	-	93	19			989	200			348
				37	200L	900	572	522	600	-	93	19			989	200			363
				45	225M	1100	622	572	800	-	68	19	20	125	1031	225	250	140	429
				55	250M	1100	622	572	800	-	68	19			1124	280			550
				75	280S	1200	676	626	800	-	120	24			1199	280			722
125	80 SGE	250	2	45	225M	1100	622	572	800	-	68	19			1031	225			438
				55	250M	1100	622	572	800	-	68	19	20	125	1124	280	280	140	561
				75	280S	1200	676	626	800	-	120	24			1199	280			726
				90	280M	1200	676	626	800	-	120	24			1249	280			802
125	100 SGF	250	3	55	250M	1100	622	572	800	-	68	19			1159	280			570
				75	280S	1200	676	626	800	-	120	24	20	140	1234	280	280	140	735
				90	280M	1200	676	626	800	-	120	24			1284	280			811
				110	315S	1500	775	725	1100	550	120	24			1449	330			1303
65	40 SHB	315	2	22	180M	900	572	522	600	-	93	19			921	200			286
				30	200L	900	572	522	600	-	93	19	20.5	125	989	200	250	100	347
				37	200L	900	572	522	600	-	93	19			989	200			362
				45	225M	1100	622	572	800	-	68	19			1031	225			428
80	50 SHC	315	2	30	200L	900	572	522	600	-	93	19			989	225			353
				37	200L	900	572	522	600	-	93	19			989	225			368
				45	225M	1100	622	572	800	-	68	19	20.5	125	1031	225	280	100	430
				55	250M	1100	622	572	800	-	68	19			1124	280			553
				75	280S	1200	676	626	800	-	120	24			1199	280			718
100	65 SHD	315	3	55	250M	1100	622	572	800	-	68	19			1144	280			571
				75	280S	1200	676	626	800	-	120	24	20	125	1219	280	280	140	736
				90	280M	1200	676	626	800	-	120	24			1269	280			812
				110	315S	1500	775	725	1100	550	120	24			1461	330			1304
125	80 SHE	315	3	75	280S	1200	676	626	800	-	120	24			1219	280			743
				90	280M	1200	676	626	800	-	120	24	20	125	1269	280	315	140	819
				110	315S	1500	775	725	1100	550	120	24			1461	330			1310
				132	315M	1500	775	725	1100	550	120	24			1521	330			1410
125	100 SHF	315	3	90	280M	1200	676	626	800	-	120	24			1284	280			828
				110	315S	1500	775	725	1100	550	120	24	20	140	1476	330	315	140	1319
				132	315M	1500	775	725	1100	550	120	24			1536	330			1419

* Gap necessary for the withdrawal or bearing housing, backplate and impeller assembly towards the drive end.





PENTAIR STARLINE

CENTRIFUGAL PUMP TECHNICAL DATA

MOTORPUMPS
50Hz PERFORMANCE

PUMP DIMENSIONS

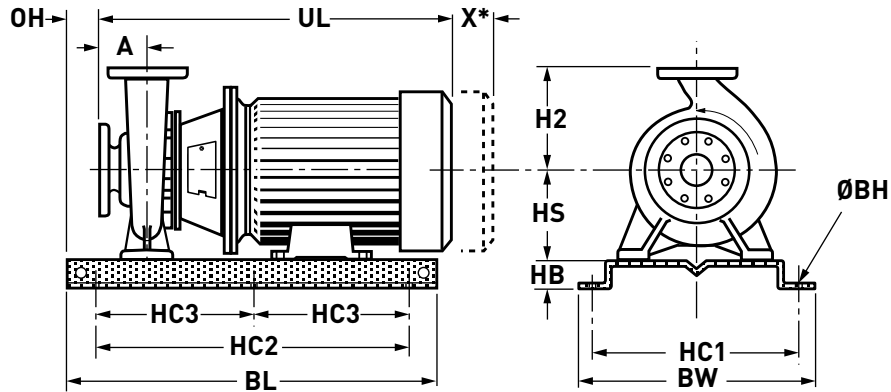

Pumps with **1450 RPM** (Nominal Speed) TEFC Motors and Pressed Steel Base Plates

PUMP SIZE			SHAFT NO.	MOTOR KW	FRAME SIZE	PUMP DIMENSIONS														WEIGHT (KG)
INLET	OUTLET	IMP DIA				BL	BW	HC1	HC2	HC3	HB	BH	OH	A	UL	HS	H2	GAP X*		
50	32 SEA	160	1	0.55	80	600	426	396	400	-	40	15	20	80	490	132	160	100	63	
				0.75	80	600	426	396	400	-	40	15		490						64
65	50 SEB	160	1	0.55	80	600	426	396	400	-	40	15			490				64	
				0.75	80	600	426	396	400	-	40	15	20	80	490	132	160	100	65	
				1.1	90S	600	426	396	400	-	40	15			500					69
80	65 SEC	160	1	0.75	80	600	426	396	400	-	40	15			510				71	
				1.1	90S	600	426	396	400	-	40	15	20	100	520	160	180	100	75	
				1.5	90L	600	426	396	400	-	40	15			545					80
100	80 SED	160	2	1.1	90S	600	426	396	400	-	40	15			524				85	
				1.5	90L	600	426	396	400	-	40	15	19.5	100	549	160	200	100	90	
				2.2	100L	600	426	396	400	-	40	15			591					99
				3	100L	600	426	396	400	-	40	15			591					103
50	32 SFA	200	1	0.75	80	600	426	396	400	-	40	15			490				72	
				1.1	90S	600	426	396	400	-	40	15	20	80	500	160	180	100	76	
				1.5	90L	600	426	396	400	-	40	15			525					81
65	40 SFB	200	1	1.1	90S	600	426	396	400	-	40	15			520				77	
				1.5	90L	600	426	396	400	-	40	15	20	100	545	160	180	100	82	
				2.2	100L	600	426	396	400	-	40	15			587					91
80	50 SFC	200	1	1.5	90L	600	426	396	400	-	40	15			545				88	
				2.2	100L	600	426	396	400	-	40	15	20	100	587	160	200	100	97	
				3	100L	600	426	396	400	-	40	15			587					101
100	65 SFD	200	2	2.2	100L	600	426	396	400	-	40	15			591				106	
				3	100L	600	426	396	400	-	40	15	19.5	100	591	180	225	140	110	
				4	112M	600	426	396	400	-	40	15			606					114
				5.5	132S	750	520	470	450	-	74	15			676					147
125	80 SFE	200	2	3	100L	600	426	396	400	-	40	15			615				118	
				4	112M	600	426	396	400	-	40	15	20.5	125	630	180	250	140	122	
				5.5	132S	750	520	470	450	-	74	15			700					155
				7.5	132M	750	520	470	450	-	74	15			740					168
125	100 SFF	200	2	4	112M	600	426	396	400	-	40	15			631				130	
				5.5	132S	750	520	470	450	-	74	15	20	125	701	200	280	140	162	
				7.5	132M	750	520	470	450	-	74	15			741					175

* Gap necessary for the withdrawal or bearing housing, backplate and impeller assembly towards the drive end.





PENTAIR STARLINE

MOTORPUMPS
50Hz PERFORMANCE

PUMP DIMENSIONS

CENTRIFUGAL PUMP TECHNICAL DATA

Pumps with **1450 RPM** (Nominal Speed) TEFC Motors and Pressed Steel Base Plates (CONTINUED)

PUMP SIZE			SHAFT NO.	MOTOR KW	FRAME SIZE	PUMP DIMENSIONS													WEIGHT (KG)	
INLET	OUTLET	IMP DIA				BL	BW	HC1	HC2	HC3	HB	BH	OH	A	UL	HS	H2	GAP X*		
65	40 SGB	250	2	1.5	90L	600	426	396	400	-	40	15			549				99	
				2.2	100L	600	426	396	400	-	40	15	19.5	100	591	180	225	100	109	
				3	100L	600	426	396	400	-	40	15			591					113
80	50 SGC	250	2	3	100L	600	426	396	400	-	40	15			616				112	
				4	112M	600	426	396	400	-	40	15	20.5	125	631	180	225	100	116	
				5.5	132S	750	520	470	450	-	74	15			701					149
100	65 SGD	250	2	4	112M	600	426	396	400	-	40	15			631				127	
				5.5	132S	750	520	470	450	-	74	15	20	125	701	200	250	140	159	
				7.5	132M	750	520	470	450	-	74	15			741					172
125	80 SGE	250	2	5.5	132S	750	520	470	450	-	74	15			700				172	
				7.5	132M	750	520	470	450	-	74	15	20	125	740	225	280	140	185	
				11	160M	900	572	522	600	-	93	19			851					243
125	100 SGF	250	3	7.5	132M	750	520	470	450	-	74	15			776				203	
				11	160M	750	520	470	450	-	74	15	20	140	886	225	280	140	247	
				15	160L	900	572	522	600	-	93	19			941					281
150	125 SGG	250	3	11	160M	750	520	470	450	-	74	15			886				267	
				15	160L	900	572	522	600	-	93	19	20	140	941	250	355	140	301	
				18.5	180M	900	572	522	600	-	93	19			956					337
				22	180L	900	572	522	600	-	93	19			996					345
65	40 SHB	315	2	3	100L	600	426	396	400	-	40	15			616				121	
				4	112M	600	426	396	400	-	40	15	20.5	125	631	200	250	100	126	
				5.5	132S	750	520	470	450	-	74	15			701					158
80	50 SHC	315	2	4	112M	600	426	396	400	-	40	15			631				128	
				5.5	132S	750	520	470	450	-	74	15	20.5	125	701	225	280	100	164	
				7.5	132M	750	520	470	450	-	74	15			741					177
100	65 SHD	315	3	7.5	132M	750	520	470	450	-	74	15			760				204	
				11	160M	750	520	470	450	-	74	15	20	125	871	225	280	140	248	
				15	160L	900	572	522	600	-	93	19			926					282
125	80 SHE	315	3	11	160M	750	520	470	450	-	74	15			871				259	
				15	160L	900	572	522	600	-	93	19	20	125	926	250	315	140	293	
				18.5	180M	900	572	522	600	-	93	19			941					329
125	100 SHF	315	3	11	160M	750	520	470	450	-	74	15			886				268	
				15	160L	900	572	522	600	-	93	19	20	140	941	250	315	140	302	
				18.5	180M	900	572	522	600	-	93	19			956					338
				22	180L	900	572	522	600	-	93	19			996					346
150	125 SHG	315	3	18.5	180M	900	572	522	600	-	93	19			956				358	
				22	180L	900	572	522	600	-	93	19			996					366
				30	200L	1100	622	572	800	-	68	19	20	140	1024	280	355	140	458	
				37	225S	1100	622	572	800	-	68	19			1071					474
				45	225M	1100	622	572	800	-	68	19			1096					513
200	150 SHH	315	4	22	180L	1200	676	626	800	-	120	24			1115				539	
				30	200L	1200	676	626	800	-	120	24	20	160	1143	315	400	180	620	
				37	225S	1200	676	626	800	-	120	24			1160					635
				45	225M	1200	676	626	800	-	120	24			1185					671

* Gap necessary for the withdrawal or bearing housing, backplate and impeller assembly towards the drive end.





PENTAIR STARLINE

MOTORPUMPS

50Hz PERFORMANCE

CENTRIFUGAL PUMP TECHNICAL DATA

PUMP DIMENSIONS

Pumps with **1450 RPM** (Nominal Speed) TEFC Motors and Pressed Steel Base Plates (CONTINUED)

PUMP SIZE			SHAFT NO.	MOTOR KW	FRAME SIZE	PUMP DIMENSIONS													WEIGHT (KG)	
INLET	OUTLET	IMP DIA				BL	BW	HC1	HC2	HC3	HB	BH	OH	A	UL	HS	H2	GAP X*		
250	200 SHJ	315	4	37	225S	1200	676	626	800	-	120	24								675
				45	225M	1200	676	626	800	-	120	24	20	180	1205	315	450	180	711	
				55	250M	1200	676	626	800	-	120	24			1268					819
				75	280S	1200	676	626	800	-	120	24			1343					955
125	80 SJE	400	3	15	160L	900	572	522	600	-	93	19			926					332
				18.5	180M	900	572	522	600	-	93	19	20	125	941	280	355	140	369	
				22	180L	900	572	522	600	-	93	19			981					377
				30	200L	1100	622	572	800	-	68	19			1009					469
125	100 SJF	400	3	22	180L	900	572	522	600	-	93	19			996					386
				30	200L	1100	622	572	800	-	68	19	20	140	1024	280	355	140	478	
				37	225S	1100	622	572	800	-	68	19			1071					497
				45	225M	1100	622	572	800	-	68	19			1096					533
150	125 SJG	400	3	37	225S	1100	622	572	800	-	68	19			1071					511
				45	225M	1100	622	572	800	-	68	19	20	140	1096	315	400	140	547	
				55	250M	1100	622	572	800	-	68	19			1138					662
200	150 SJH	400	4	45	225M	1200	676	626	800	-	120	24			1185					735
				55	250M	1200	676	626	800	-	120	24			1248					844
				75	280S	1200	676	626	800	-	120	24	20	160	1323	315	450	180	980	
				90	280M	1200	676	626	800	-	120	24			1374					1085
				110	315S	1500	775	725	1100	550	120	24			1568					
125	100 SKF	500	4	55	250M	1200	676	626	800	-	120	24			1248					883
				75	280S	1200	676	626	800	-	120	24	20	160	1323	355	450	180	1019	
				90	280M	1200	676	626	800	-	120	24			1374					1124
				110	315S	1500	775	725	1100	550	120	24			1568					1577
150	125 SKG	500	4	75	280S	1200	676	626	800	-	120	24			1323					1043
				90	280M	1200	676	626	800	-	120	24	20	160	1374	355	450	180	1148	
				110	315S	1500	775	725	1100	550	120	24			1568					1601
				132	315M	1500	775	725	1100	550	120	24			1628					1701
200	150 SKH	500	4	90	280M	1200	676	626	800	-	120	24			1374					1172
				110	315S	1500	775	725	1100	550	120	24			1568					1630
				132	315M	1500	775	725	1100	550	120	24	20	160	1628	400	500	180	1730	
				160	315L	1500	775	725	1100	550	120	24			1679					1790
				200	315L	1500	775	725	1100	550	120	24			1679					1820

* Gap necessary for the withdrawal or bearing housing, backplate and impeller assembly towards the drive end.





PENTAIR STARLINE

MOTORPUMPS
50Hz PERFORMANCE

PUMP DIMENSIONS

CENTRIFUGAL PUMP TECHNICAL DATA

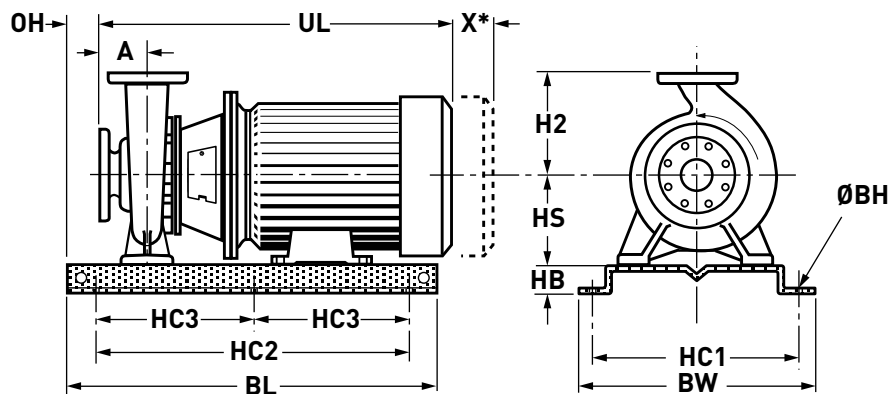

Pumps with **970 RPM** (Nominal Speed) TEFC Motors and Pressed Steel Base Plates

PUMP SIZE			SHAFT NO.	MOTOR KW	FRAME SIZE	PUMP DIMENSIONS												WEIGHT (KG)	
INLET	OUTLET	IMP DIA				BL	BW	HC1	HC2	HC3	HB	BH	OH	A	UL	HS	H2		GAP X*
200	150 SHH	315	4	7.5	160M	1200	676	626	800	-	120	24	20	160	1005	315	400	180	472
				11	160L										1060				500
				15	180L										1115				547
250	200 SHJ	315	4	11	160L	1200	676	626	800	-	120	24	20	180	1080	315	450	180	540
				15	180L										1135				587
				18.5	200L										1163				611
				22	200L										1163				641
200	150 SJH	400	4	15	180L	1200	676	626	800	-	120	24	20	160	1115	315	450	180	612
				18.5	200L										1143				636
				22	200L										1143				666
				30	225M										1185				707
125	100 SKF	500	4	18.5	200L	1200	676	626	800	-	120	24	20	160	1143	355	450	180	675
				22	200L										1143				705
				30	225M										1185				746
				37	250M										1248				861
150	125 SKG	500	4	22	200L	1200	676	626	800	-	120	24	20	160	1143	355	450	180	729
				30	225M										1185				770
				37	250M										1248				885
200	150 SKH	500	4	30	225M	1200	676	626	800	-	120	24	20	160	1185	400	500	180	794
				37	250M										1248				909
				45	280S										1323				1036
				55	280M										1374				1095

* Gap necessary for the withdrawal or bearing housing, backplate and impeller assembly towards the drive end.



PENTAIR STARLINE

MOTORPUMPS

50Hz PERFORMANCE

CENTRIFUGAL PUMP TECHNICAL DATA

IMPELLER CLEARANCES

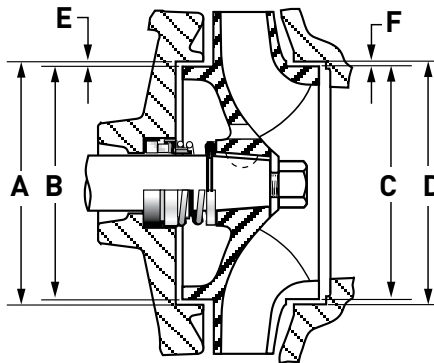

PUMP SIZE	IMPELLER AND CASING SEALING DIAMETERS						RADIAL CLEARANCE			
	A	B		C		D	E		F	
		CI/ZF	SS	CI/ZF	SS		CI/ZF	SS	CI/ZF	SS
50 x 32-160 65 x 50-160	92.05	91.76	91.63	91.76	91.63	92.05	0.12	0.18	0.12	0.18
	92.00	91.71	91.58	91.71	91.58	92.00	0.17	0.23	0.17	0.23
80 x 65-160	92.05	91.76	91.63	104.72	104.57	105.05	0.12	0.18	0.14	0.21
	92.00	91.71	91.58	104.67	104.52	105.00	0.17	0.23	0.19	0.26
100x 80-160	132.05	131.68	131.51	131.68	131.51	132.05	0.16	0.24	0.16	0.24
	132.00	131.61	131.44	131.61	131.44	132.00	0.22	0.30	0.22	0.30
50 x 32-200 65 x 40-200	105.05	104.72	104.57	91.76	91.63	92.05	0.14	0.21	0.12	0.18
	105.00	104.67	104.52	91.71	91.58	92.00	0.19	0.26	0.17	0.23
80 x 50-200	105.05	104.72	104.57	104.72	104.57	105.05	0.14	0.21	0.14	0.21
	105.00	104.67	104.52	104.67	104.52	105.00	0.19	0.26	0.19	0.26
100 x 65-200	132.05	131.68	131.51	131.68	131.51	132.05	0.16	0.24	0.16	0.24
	132.00	131.61	131.44	131.61	131.44	132.00	0.22	0.30	0.22	0.30
125 x 80-200 125 x 100-200	160.05	159.66	159.49	159.66	159.49	160.05	0.17	0.25	0.17	0.25
	160.00	159.59	159.42	159.59	159.42	160.00	0.23	0.31	0.23	0.31
65 x 40-250 80 x 50-250	115.05	114.70	114.55	114.70	114.55	115.05	0.15	0.22	0.15	0.22
	115.00	114.65	114.50	114.65	114.50	115.00	0.20	0.27	0.20	0.27
100 x 65-250	132.05	131.68	131.51	131.68	131.51	132.05	0.16	0.24	0.16	0.24
	132.00	131.61	131.44	131.61	131.44	132.00	0.22	0.30	0.22	0.30
125 x 80-250	132.05	131.68	131.51	159.66	159.49	160.05	0.16	0.24	0.17	0.25
	132.00	131.61	131.44	159.59	159.42	160.00	0.22	0.30	0.23	0.31
65 x 40-315	115.05	114.70	114.55	104.72	104.57	105.05	0.15	0.22	0.14	0.21
	115.00	114.65	114.50	104.67	104.52	105.00	0.20	0.27	0.19	0.26
80 x 50-315	115.05	114.70	114.55	114.70	114.55	115.05	0.15	0.22	0.15	0.22
	115.00	114.65	114.50	114.65	114.50	115.00	0.20	0.27	0.20	0.27
125 x 100-250 150 x 125-250 150 x 125-315 125 x 80-400 125 x 100-400 150 x 125-400	186.05	185.66	185.48	185.66	185.48	186.05	0.17	0.26	0.17	0.26
	186.00	185.59	185.41	185.59	185.41	186.00	0.23	0.32	0.23	0.32
100 x 65-315 125 x 80-315 125 x 100-315	160.05	159.66	159.49	159.66	159.49	160.05	0.17	0.25	0.17	0.25
	160.00	159.59	159.42	159.59	159.42	160.00	0.23	0.31	0.23	0.31
200 x 150-315	265.66	265.11	264.97	235.09	234.93	235.59	0.24	0.31	0.22	0.30
	265.60	265.05	264.91	235.03	234.87	235.53	0.30	0.37	0.28	0.36
250 x 200-315	265.66	265.11	264.97	265.11	264.97	265.66	0.24	0.31	0.24	0.31
	265.60	265.05	264.91	265.05	264.91	265.60	0.30	0.37	0.30	0.37
125 x 100-500	235.59	235.09	234.93	170.09	169.90	170.51	0.22	0.30	0.18	0.27
	235.53	235.03	234.87	170.03	169.84	170.45	0.28	0.36	0.24	0.33
150 x 125-500 200x150-500	235.59	235.09	234.93	200.10	199.90	200.55	0.22	0.30	0.19	0.29
	235.53	235.03	234.87	200.04	199.84	200.49	0.28	0.36	0.25	0.35
200x150-400	235.59	235.09	234.93	235.09	234.93	235.59	0.22	0.30	0.22	0.30
	235.53	235.03	234.87	235.03	234.87	235.53	0.28	0.36	0.28	0.36



Machining Sizes to Retrofit Wear Rings to Casings and Impellers

NOMINAL SIZE	IMPELLER WEAR RING	IMPELLER TURN SIZE	CASING WEAR RING	CASING BORE SIZE
92mm	SEA026	Ø 84.830 / 84.795	SEA027	Ø 99.000 / 99.035
105mm	SEC026	Ø 97.830 / 97.795	SEC027	Ø 112.000 / 112.035
115mm	SGB026	Ø 106.800 / 106.765	SGB027	Ø 123.000 / 123.035
132mm	SED026	Ø 123.77 / 123.73	SED027	Ø 140.000 / 140.040
160mm	SFF026	Ø 151.770 / 151.730	SFF027	Ø 168.000 / 168.040
170mm	SKF026	Ø 158.08 / 158.03	SKF027	Ø 182.46 / 182.51
185mm	SGF026	Ø 177.770 / 177.730	SGF027	Ø 194.000 / 194.040
200mm	SKG026	Ø 188.10 / 188.05	SKG027	Ø 210.50 / 210.55
235mm	SHH026	Ø 223.09 / 223.04	SHH027	Ø 247.55 / 247.60
265mm	SHJ026	Ø 253.10 / 253.05	SHJ027	Ø 277.62 / 277.67



PENTAIR

CENTRIFUGAL PUMP TECHNICAL DATA

STARLINE

MOTORPUMPS
50Hz PERFORMANCE

**FLANGE
DIMENSIONS**

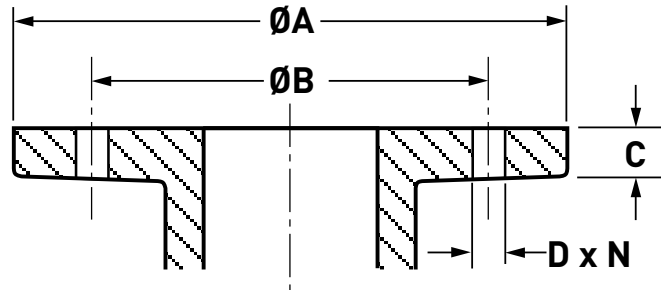

NOMINAL FLANGE SIZE		32	40	50	65	80	100*	125*	150*	200*	250*
FLANGE DIAMETER	A	140	150	165	185	200	220	250	285	340	405
HOLE P.C.D.	B	87	98	114	127	146	178	210	235	292	356
FLANGE THICKNESS	C	18	18	20	20	22	24	26	26	30	32
HOLE DIAMETER	D	14	14	18	18	18	18	18	22	22	22
NUMBER OF HOLES	N	4	4	4	4	4	8	8	8	8	12

NOTE:

- Holes machined off centrelines.
- Flange drilling as shown below conforms to AS2129 - 1982 Table 'E' for cast iron flanges.
- Flange drilling to ANSI B16.1.1975 Class 125 (ISO7005 - PN20) PN16 are available options.

* Discharge flanges on No. 4 shaft pumps are tapped as follows:

125x100-500 and 150x125-500 tapped M16 x 2mm

200x150-315, 200x150-400, 200x150-500 and 250x200-315 tapped M20 x 2.5mm





PENTAIR

CENTRIFUGAL PUMP TECHNICAL DATA

STARLINE

MOTORPUMPS
50Hz PERFORMANCE

**SECTIONAL
ARRANGEMENT**

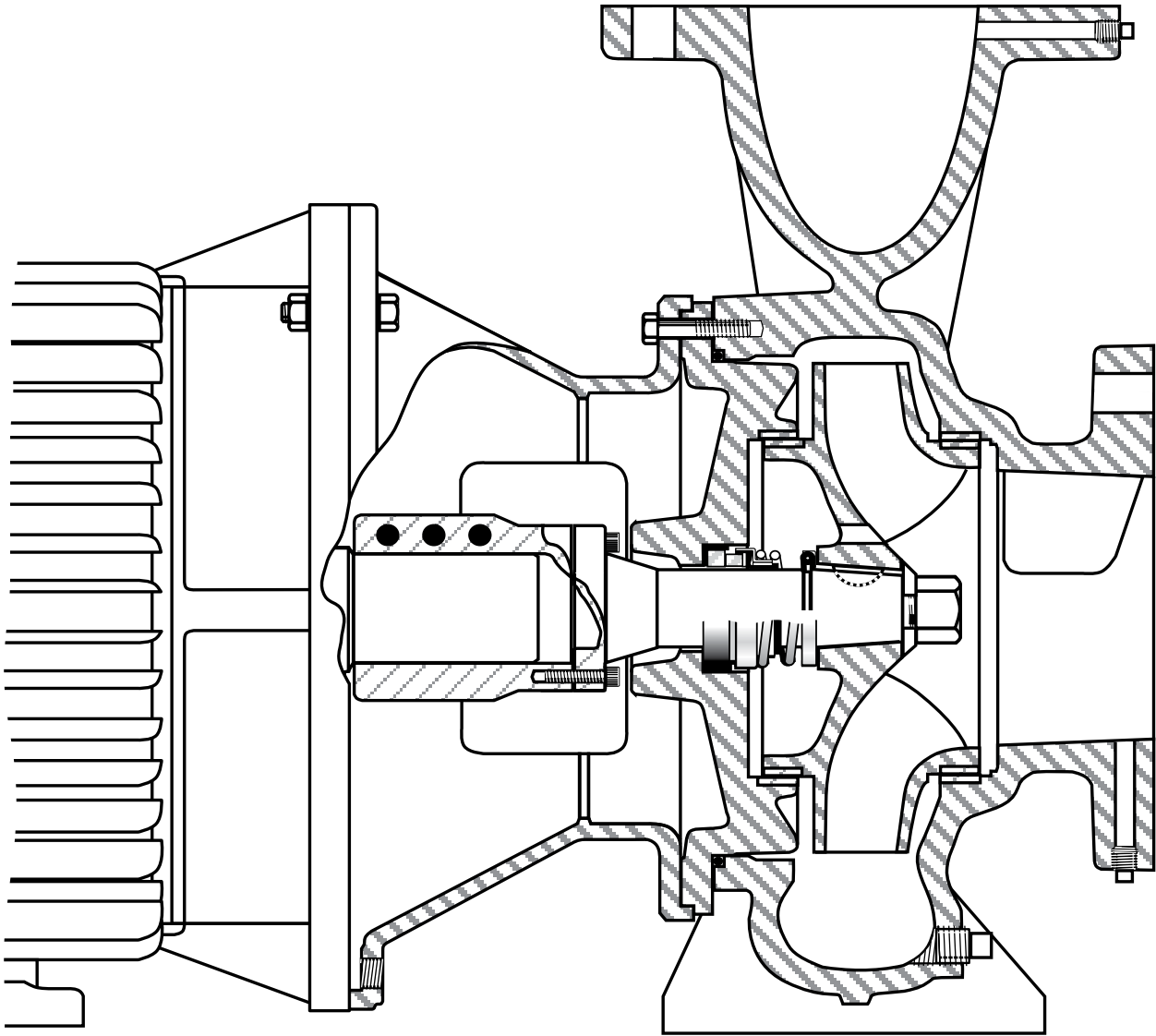



PENTAIR

STARLINE

MOTORPUMPS

50Hz PERFORMANCE

**MISC. PUMP
DATA**

CENTRIFUGAL PUMP TECHNICAL DATA

PUMP SIZE	CI IMPELLER (kg)	IMPELLER ROTATIONAL INERTIA (kg.m ²)	MIN. CASING THICKNESS (mm)	CI / ZF IMPELLER		SHAFT CRITICAL SPEED (r.p.m.)	MAX OPERATING SPEED (r.p.m.)	IMPELLER	
				HYDROSTATIC TEST PRESSURE (kPa)	MAX. WORKING PRESSURE (kPa)			No. of VANES	MAX SPHERE SIZE (mm)
50 x 32 - 160	2.7	0.008	9	3800	2500	14,600	3600	6	5
65 x 50 - 160	2.6	0.008	9	3800	2500	14,600	3600	6	7
80 x 65 - 160	2.8	0.01	10	3800	2500	14,600	3600	6	11
100 x 80 - 160	4.2	0.014	10	3800	2500	16,700	3600	6	12
50 x 32 - 200	3.7	0.018	9	3300	2200	12,400	3600	6	4
65 x 40 - 200	4	0.019	9	3800	2500	12,400	3600	6	5
80 x 50 - 200	4	0.021	10	3800	2500	12,400	3600	6	9
100 x 65 - 200	6	0.033	10	2800	1850	14,900	3600	6	14
125 x 80 - 200	6.5	0.037	11.5	2620	1750	13,900	3000	6	15
125 x 100 - 200	6.4	0.036	13	3000	2000	14,400	3000	6	17
65 x 40 - 250	6	0.042	10	3300	2200	14,900	3600	5	5
80 x 50 - 250	6	0.042	10	2800	1900	14,900	3600	6	6
100 x 65 - 250	7	0.052	11	2600	1700	13,600	3000	6	9
125 x 80 - 250	8	0.061	12.5	2620	1750	12,600	3000	6	15
125 x 100 - 250	9.5	0.077	12	2400	1600	14,450	3000	6	23
150 x 125 - 250	10	0.088	14	2470	1650	13,970	2600	6	33
65 x 40 - 315	10.1	0.128	11	2800	1900	12,600	3000	5	5
80 x 50 - 315	9.2	0.112	12	3300	2200	11,800	3000	5	7
100 x 65 - 315	12.3	0.139	13	2700	1800	12,820	3000	6	9.5
125 x 80 - 315	13	0.152	14	2620	1750	12,300	3000	6	11.5
125 x 100 - 315	13.2	0.157	16	3070	2050	12,250	2800	6	14.5
150 x 125 - 315	13.4	0.164	16	2470	1650	12,160	2300	6	26
200 x 150 - 315	20	0.285	17	2400	1600	8660	1800	6	23
250 x 200 - 315	24	0.36	18	2400	1600	7480	1800	6	29
125 x 80 - 400	20.5	0.422	15	2400	1600	9990	2300	5	9.5
125 x 100 - 400	19.9	0.389	16	2400	1600	10,140	2100	6	12
150 x 125 - 400	20.6	0.427	17	2400	1600	9970	2000	6	18
200 x 150 - 400	30	0.704	20	2400	1600	7380	1800	6	31
125 x 100 - 500	39	1.233	20	2400	1600	6710	1600	9	21
150 x 125 - 500	41	1.392	21	2400	1600	6510	1600	7	20
200 x 150 - 500	42	1.546	22	2400	1600	6360	1600	6	21.5





PENTAIR STARLINE

MOTORPUMPS
50Hz PERFORMANCE

MATERIAL SPECIFICATIONS

CENTRIFUGAL PUMP TECHNICAL DATA

SYMBOL	MATERIAL	SPECIFICATIONS	COMPONENT WHERE USED
CI	Cast Iron	AS1830/T260 Equivalent Standards: BS 1452 (1977) Grade 260 ANSI. 625.1 Class 40 ASTM A48 Class 40	Bell Housing Volute Casing Backplate Impeller
ZF		AS 1565/ C90250 Equivalent Standards: BS 1400 PB3, ISO 1338 CU SN 10	Volute Casing Backplate Impeller Wear rings
SS	Cast Stainless Steel	AS2074/H6B Equivalent Standards BS 3100 (1976) Grade 316C16 ASTM A296 Grade CF8M	Volute Casing Backplate Impeller Wear rings
	Wrought Stainless Steel	BS 970 Grade 316 S31 Equivalent Standards: ASTM A276-986 316 JIS G4303 SUS 316	Impeller Washer Impeller Nut Casing & Discharge Flange Plugs
	316 Stainless Steel	AS 2548 Gr. A4-80	Bolts & Setscrews (ZF & SS Only)
	2205 Duplex Stainless Steel	UNS S31803 ASTM A276-98b	Impeller key
SGL	S.G. Iron	AS1831/ 400 - 12	Motor Shaft Clamp Volute Casing Backplate Impeller
HT	High Tensile Steel	AS 1110 Gr. 8.8	All Bolts and Setscrews
	Mild Steel Zinc Plated		Casing and Discharge Flange Plugs
	Key Steel		Impeller key

PAINTING

One Coat - WattyL Super Etch Grey Primer (WattyL Part No. 123907)

Two Coats - WattyL Hammer Finish Green (WattyL Part no. 151741)

Colour - Hammer Finish Green



PENTAIR

CENTRIFUGAL PUMP TECHNICAL DATA

STARLINE

MOTORPUMPS
50Hz PERFORMANCE

**SHAFT GROUP
ASSEMBLY**

**No. 1
SHAFT GROUP
ASSEMBLY**

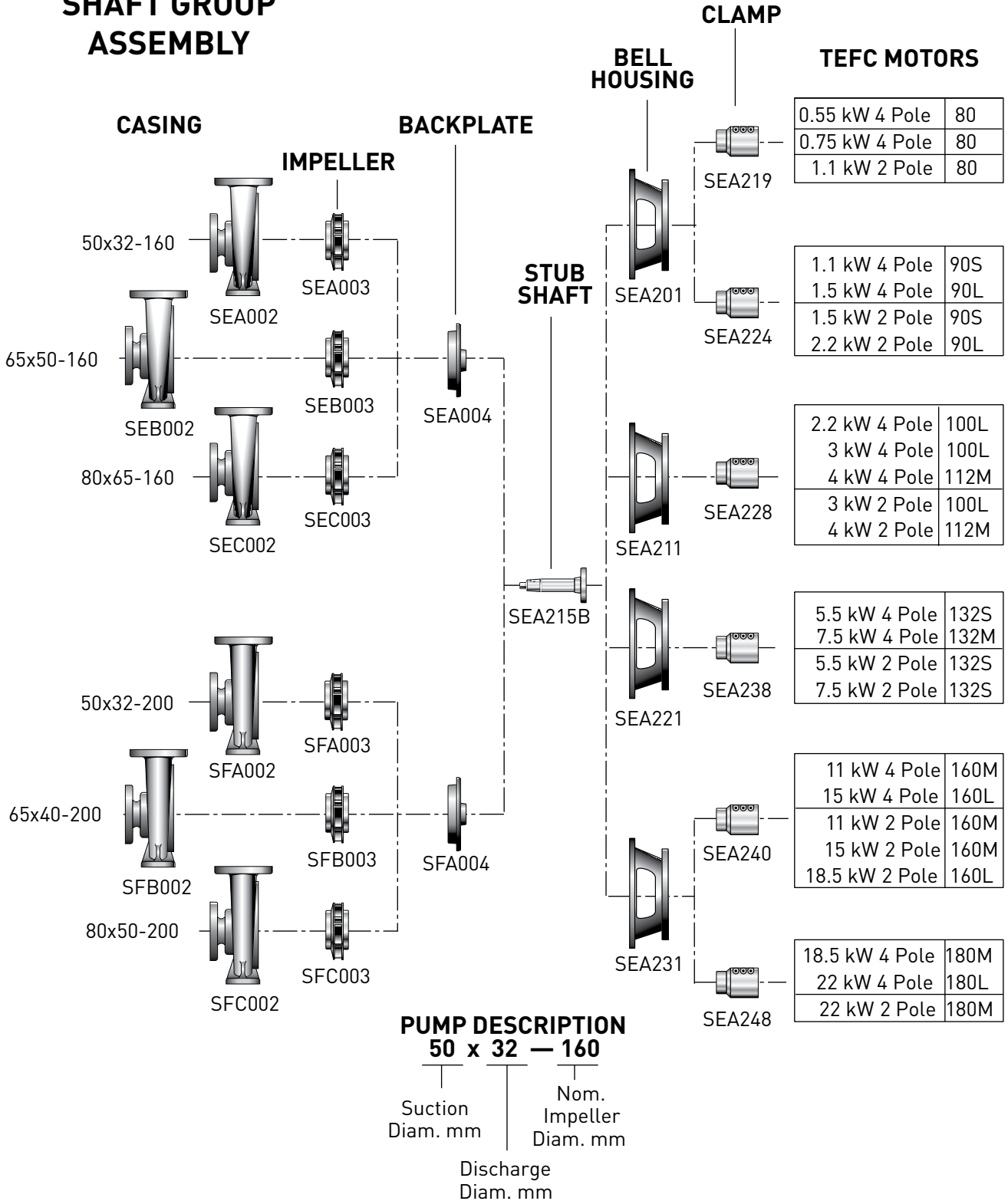



PENTAIR

STARLINE

MOTORPUMPS
50Hz PERFORMANCE

SHAFT GROUP ASSEMBLY

CENTRIFUGAL PUMP TECHNICAL DATA

No. 2 SHAFT GROUP ASSEMBLY

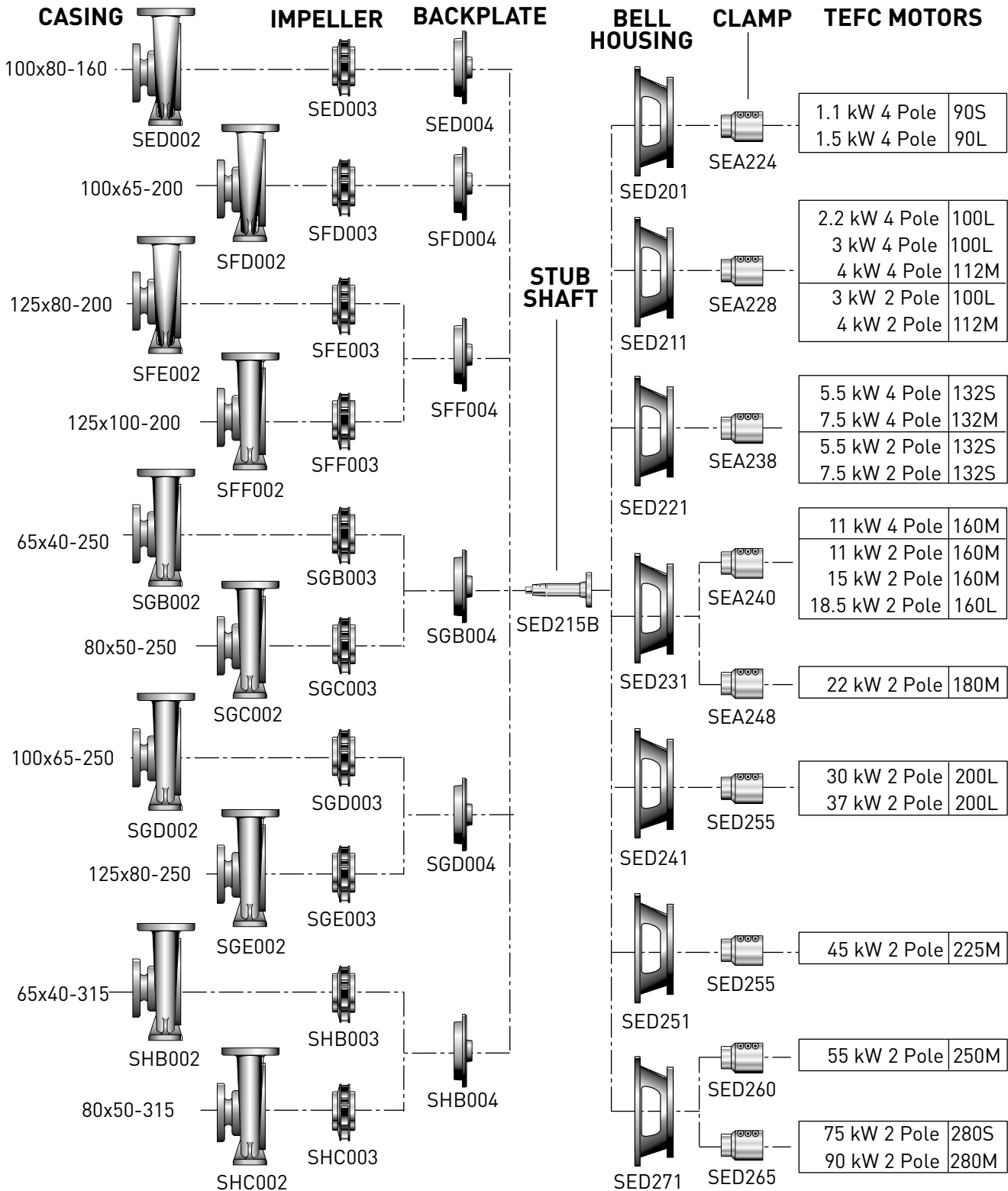



PENTAIR

CENTRIFUGAL PUMP TECHNICAL DATA

STARLINE

MOTORPUMPS
50Hz PERFORMANCE

SHAFT GROUP ASSEMBLY

No. 3

SHAFT GROUP ASSEMBLY

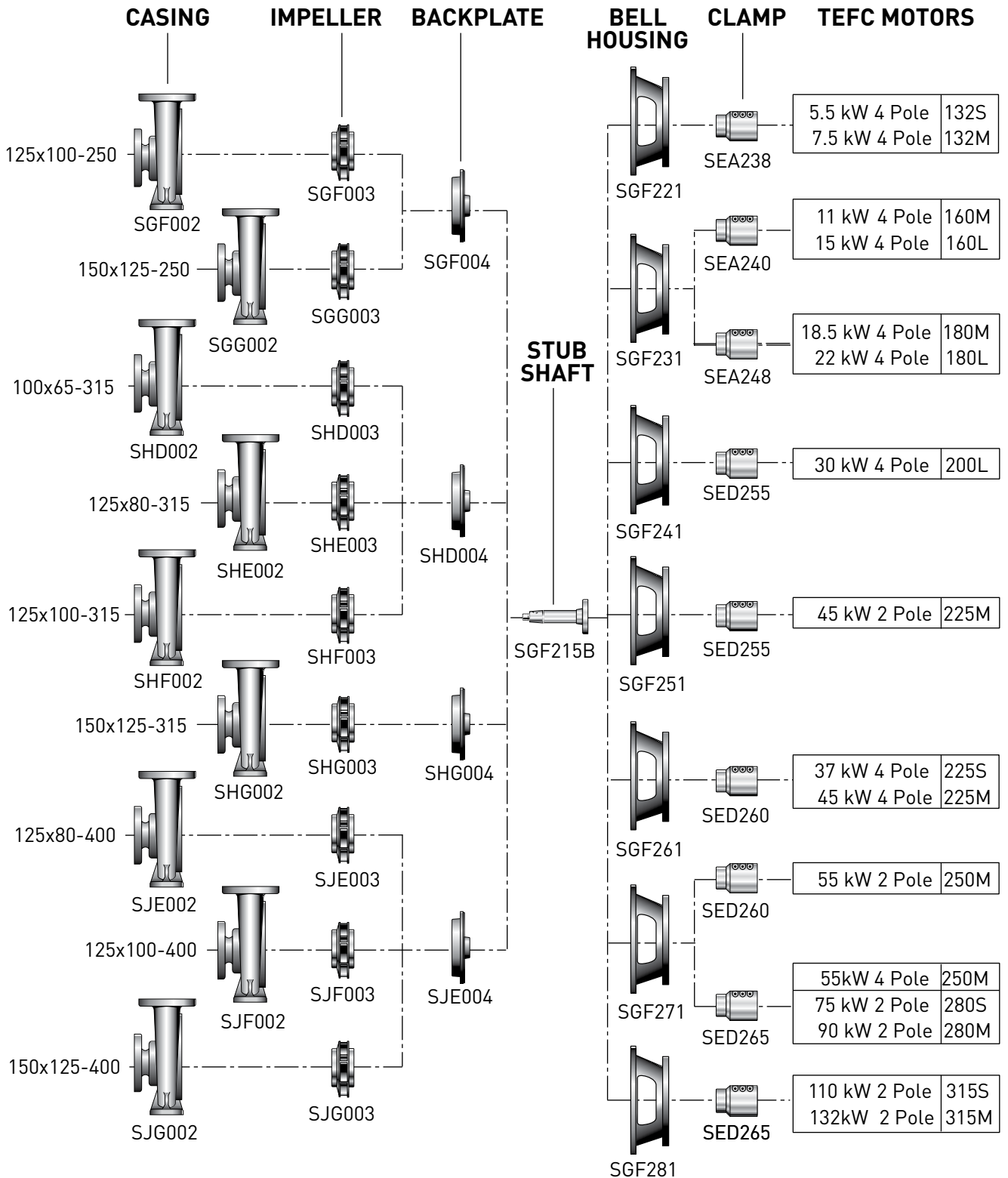

No. 4
SHAFT GROUP ASSEMBLY

