

## 14 SERIES

### MOULDED WATER TRANSFER PUMPS CENTRIFUGAL PUMPS



#### FEATURES

- High grade corrosion resistant materials.
- Award winning high flow impeller.
- Strong and durable construction.
- Max. head - 41m.
- Max. flow - 455lpm.



#### APPLICATIONS

- Domestic, industrial or rural water transfer.
- Typical uses include wash down, tank filling, general water transfer and circulation, irrigation and gardening.

#### PUMP INFORMATION

Horizontal, single-stage, surface mounted centrifugal pump with closed impeller for pumping debris free water coupled to a cool running Totally Enclosed Fan Cooled 2 pole motor with external thermal overload. (single phase only, three phase units require separate quick trip overload supplied by electrical contractor).

#### OPERATING CONDITIONS

Suitable for pumping clean non-aggressive liquids without solids or fibres in suspension.

Fluid:	Water
Maximum water temperature:	70°C
Manimum water temperature:	1°C
Maximum ambient temperature:	55°C
Maximum working pressure:	630kPa

\* For liquids outside of this range please consult your local 43South representative for product suitability.

# 14 SERIES - Technical Data

## PERFORMANCE CURVE NPSHR

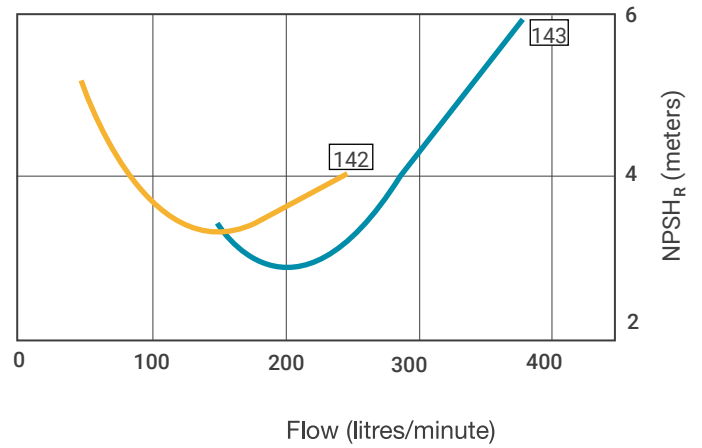
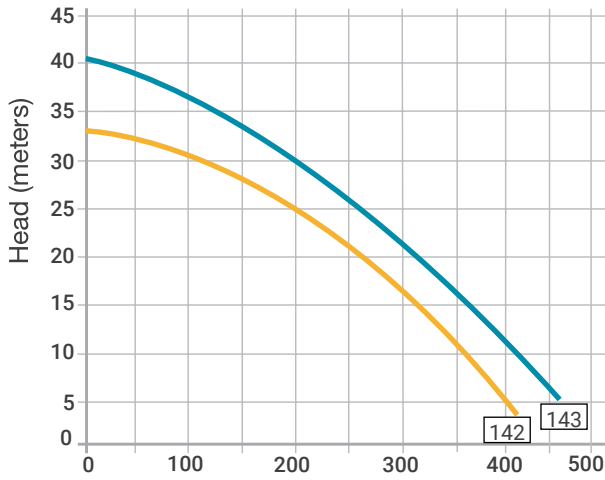

## PERFORMANCE

Type	P/No	Delivery head [m]	5	10	15	20	25	30	35	40
142	314200 (1-phase) / 314230 (3-phase)	Capacity [litre per minute]	406	366	316	262	195	102	-	-
143	314300 (1-phase) / 314330 (3-phase)		441	403	358	308	252	197	123	22

## ELECTRICAL DATA

Type	Type of current	Voltage ± 10%	Frequency Hz	Motor rating kW P2	RPM	Current ampere	Locked rotor current	Motor protection	Insulation class	IP rating
142	1-phase	230	50	1.8	2900	10.8 A	38.8 A	External	B	IP44
142	3-phase	400	50	1.8	2900	3.3 A	23.6 A	-	B	IP44
143	1-phase	230/460	50	2.4	2900	14 A / 7 A	71 A / 37 A	External	B	IP44
143	3-phase	400	50	2.4	2900	6 A	48 A	-	B	IP44

## DIMENSIONS

Type	Maximum L x W x H	Weight approx	Inlet	Pump outlet	Carton L x W x H	Packed weight
142/1	405 x 269 x 298 mm	16.5kg	1 1/2" BSP (male)	1 1/2" BSP (male)	560 x 360 x 460 mm	18kg
142/3	411 x 269 x 305 mm	25.5kg	1 1/2" BSP (male)	1 1/2" BSP (male)	560 x 360 x 460 mm	27kg
143/1	446 x 269 x 303 mm	37.5kg	1 1/2" BSP (male)	1 1/2" BSP (male)	560 x 360 x 460 mm	39kg
143/3	446 x 269 x 303mm	35.5kg	1 1/2" BSP (male)	1 1/2" BSP (male)	560 x 360 x 460 mm	37kg

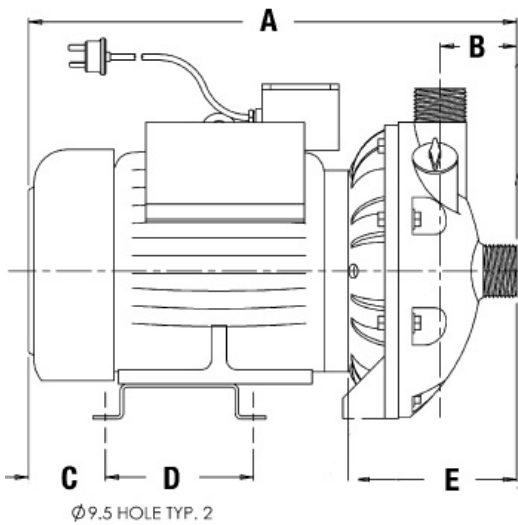

Type	A (mm)	B (mm)	C (mm)	D (mm)	E (mm)	F (mm)	G (mm)	H (mm)	I (mm)
142/1	405	70	157	-	154	269	298	134	114
142/3	411	70	145	-	154	269	305	134	114
143/1	446	70	70	135	154	269	303	134	114
143/3	446	70	70	135	154	269	303	134	114

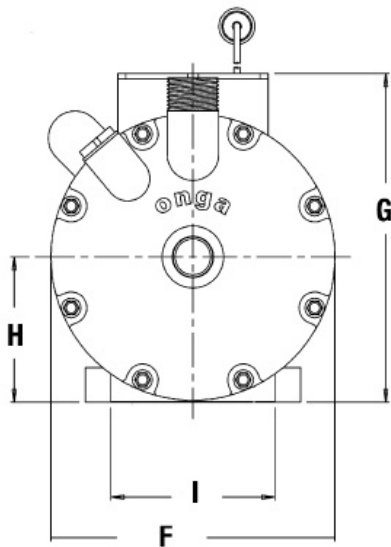

## PUMP CONSTRUCTION MATERIALS

Component	Material
Pump casing	20% Glass Filled Noryl
Baffle	20% Glass Filled Noryl
Priming cap	Acetyl
Impeller	20% Glass Filled Polycarbonate
Diffuser	20% Glass Glass Filled Noryl
Shaft sleeve	1-phase = Nylon 3-phase = Stainless Steel
Seal flexible bellows	Nitrile
Seal stationary face	Ceramic
Seal rotating face	Carbon
Seal spring	18-8 Stainless Steel
Motor shaft	Mild Steel
O'Rings	Nitrile