

ASSEMBLY INSTRUCTIONS

NOTE: Some parts shown in the diagram are pre-assembled.

- Slide the armature spacer (23) onto the front axle of the armature (22). Slide an armature bushing (24) on the front and the back of the armature axle.
- Slide the 7-tooth pinion gear (25) onto the back of the armature axle. Insert this motor assembly into the center of the chassis (21) with the 7-tooth pinion gear in the back.
- Slide the right side motor magnet (3), with the convexed curved side facing out, into the right side recess of the chassis next to the motor. Slide the left side motor magnet (26), with its concaved curve facing the motor assembly into left side recess of the chassis.
- Place the body mount clip (2) over the motor assembly and snap the notch on each side into the slots on the chassis.
- Attach the traction magnet/rear armature bushing retainer clip (1) into the notches on both sides of the chassis, snapping into place.
- Flip the chassis over. Push the traction magnets (12) into the two recesses in the chassis, behind the motor magnets.
- Take the front edge of a pick-up shoe (11) and lightly snap it over the locating tab on the front edge of the chassis, and let the back of the shoe lay in the slot in front of the motor magnet. Repeat this procedure for the other side using the second pick-up shoe.
- Slide the brush barrel set screw (13) through the brush spring (14) through the motor brush (15) and into a threaded brush barrel (16). Put this assembly through the pick-up shoe spring (17), through the hole in the chassis and over the back of the pick-up shoe, continuing through the next large hole in the chassis. Repeat for the other side.
- Flip the chassis back over so it is no longer upside down.
- Carefully insert the right pick-up shoe retainer (27) in the orientation as shown into the chassis slot above the narrow hooked end of the right pick-up shoe (11) where it hooks over the brush barrel. Take special note to make the longer upper "T" section point inward toward the center of the chassis.
- For the left pick-up shoe retainer (28), repeat step 10 for the left side.
- To secure the front armature, motor assembly, and the pick-up shoe retainers in place, slip one side of the front armature bushing retainer clip (4) around the left side of the chassis positioned between the bushing barrel and the tab on the side of the chassis, hooking it underneath the bottom edge. Spread the clip slightly and snap it over the other side of chassis and under the edge.
- Slide the rear axle (18) through the 23-tooth crown gear (20) and through the gear spacer (19). Snap the axle into slots in the sides of rear chassis.
- Slide a rear tire (5) onto each rear hub/rim (6).
- Slide a front tire (7) onto each front hub/rim (8). Slide the front axle (9) through the chosen front holes and attach the front wheels.
- Snap the guide pin (10) into the front center of the chassis (21).
- Holding the body upside down, lower the chassis into the body on an angle, inserting the tab on one side of the chassis into the notch inside the body. Lightly spread the body open enough to snap the other side of the chassis into the body.

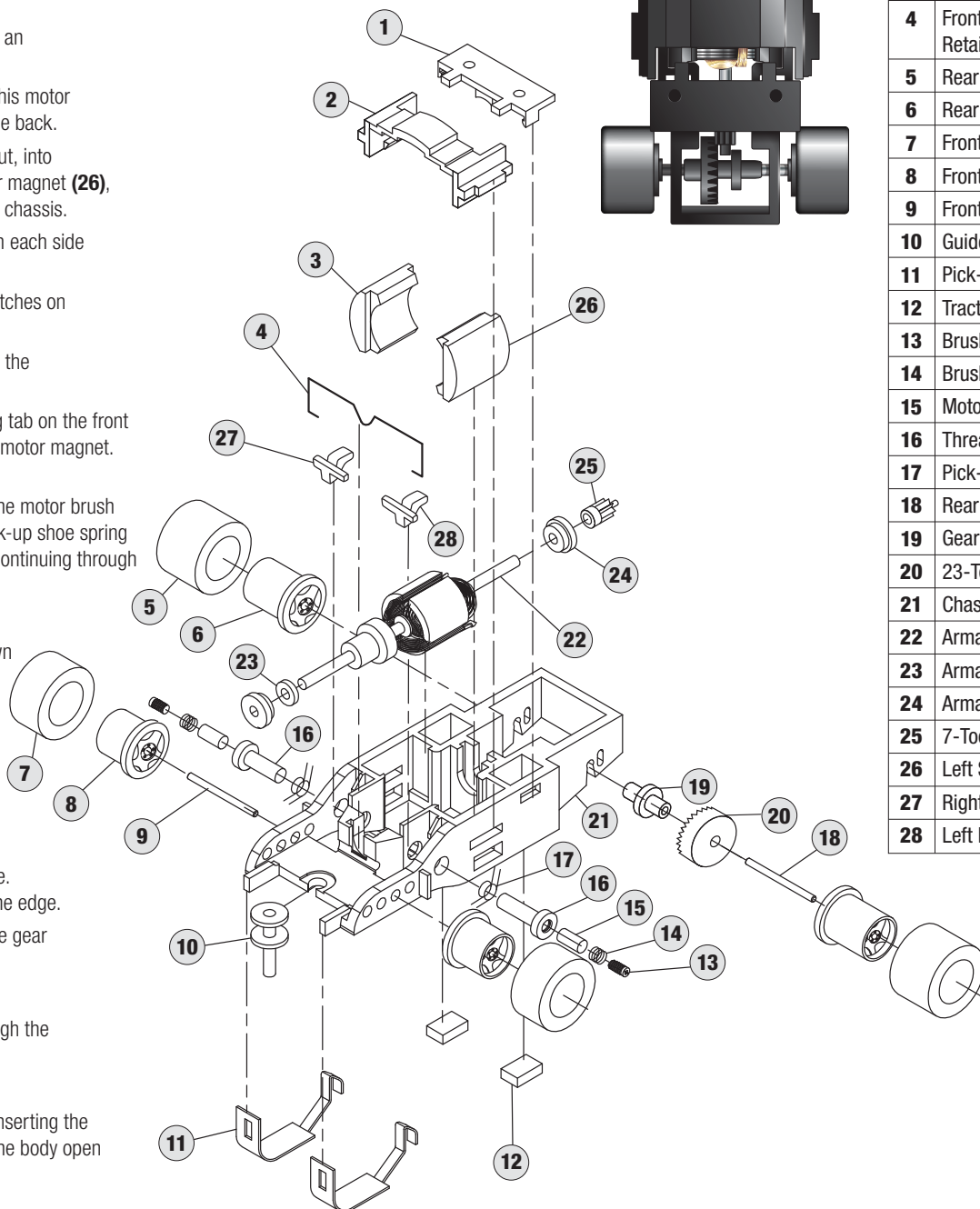

PARTS LIST

1	Traction Magnet/Rear Armature Bushing Retainer Clip
2	Body Mount Clip
3	Right Side Motor Magnet
4	Front Armature Bushing Retainer Clip
5	Rear Tire
6	Rear Hub/Rim
7	Front Tire
8	Front Hub/Rim
9	Front Axle
10	Guide Pin
11	Pick-up Shoes
12	Traction Magnets
13	Brush Barrel Set Screw
14	Brush Spring
15	Motor Brush
16	Threaded Brush Barrel
17	Pick-up Shoe Spring
18	Rear Axle
19	Gear Spacer
20	23-Tooth Crown Gear
21	Chassis
22	Armature
23	Armature Spacer
24	Armature Bushing
25	7-Tooth Pinion Gear
26	Left Side Motor Magnet
27	Right Pick-up Shoe Retainer
28	Left Pick-up Shoe Retainer

Your Super III slot car should now be ready to race!