

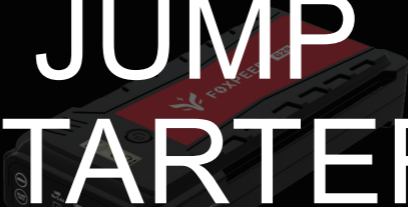

FOXPEED

G29

JUMP STARTER



THE KING OF POWER

User Manual

Portable Car Jump Starter 2500A 21000mAh

For up to 8.0L GAS and 6.5L Diesel

12V for Various Vehicles

Please carefully read the instructions before using!

Perhaps there is small difference between the photo and actual product, so please turn to the actual product for detail information



NOTE

1. DO NOT start any engines that exceed the maximum displacement the jump starter can bear.
2. DO NOT crank the engine for more than 3 seconds.
3. Allow the jump starter to cool down for at least 1 minute between each start attempt.
4. Please ensure the device is at least 50% charged before use.

 service@foxpeed.com  foxpeed.com

A Big Thank You

We're thrilled that you have chosen **FOXPEED** jump starter. We're committed to providing you with high quality products that bring more convenience and enjoyment to your daily life. We also spare no effort to provide you excellent customer support. Should you have any questions or feedback about your new product, please get in touch with us any time! Email at service@foxpeed.com

PACKAGE CONTENT



1 x Intelligent Jumper Clamps



1 x DC Cigarette Lighter Charger



1 x Jump Starter

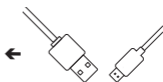

1 x USB Type-C Cable



1 x User Manual



1 x A/C Adapter

AT A GLANCE

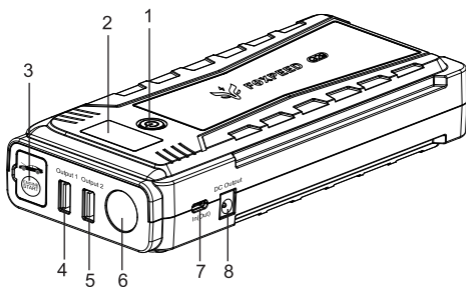

1. Power Button
2. LED Display
3. Smart Jump Clamps Port
4. Output 1 (5V/ 3A 9V/ 2A 12V/ 1.5A)
5. Output 2 (5V/ 2.1A)
6. LED light / Torch light / SOS
7. Power Input / Output (5V/ 3A)
8. DC Output Port (12V/ 10A)

PARAMETER

Model	G29
Capacity	21000mAh / 77.7Wh
Size	195*88*38mm
Input(Output)	5V/3A
Output 1	5V/ 3A 9V/ 2A 12V/ 1.5A
Output 2	5V/ 2.1A
Start Current	1000A
Peak Current	2500A
DC Output	12V/10A
Circle Life	1000 times
Operating Temperature	-20 ~ 60 °C

HOW TO JUMP START YOUR CAR

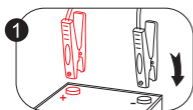

1 Connect the jumper clamps to the car battery (Red is positive and Black is negative)

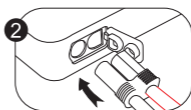

2 Plug the jumper cable into the battery pack

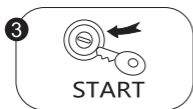

3 Start the car by turning on the ignition key

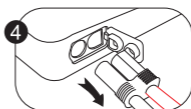

4 After the car has been started, remove the plug from the battery pack and remove the clamps from the car battery

Note: Ensure the jump starter power level is 50% or more before jumping your car. Connect the positive(+)(red) clamp from the jump starter to the positive terminal of the car battery, and connect the negative (-)(black) clamp to the negative terminal of the car battery.

Apart from jump starting a car, this product can also supply power for a mobile phone, laptop, PSP, MP3/MP4, camera and other consumer electronics, and with different lighting modes.



Jump start a car



Charge cell phone / Tablet



Charge PSP



Outdoor travel flashlight



Charge camera / Video

HOW TO CHARGE CELLPHONES OR OTHER DIGITAL PRODUCTS

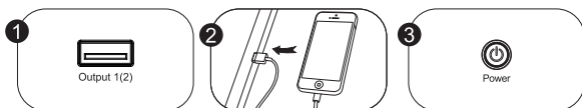





Plug the USB Port of the charging cable into the product USB interface

Inset the other side into the input port of the mobile phone

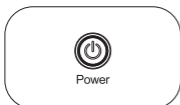
When connected OK, press then you can use it to charge now

HOW TO USE THE LED EMERGENCY LIGHT



Hold  for 3 seconds to turn light on, then press  lightly, led light will shift to flashing, SOS then press  for seconds, the led light will be off

HOW TO RECHARGE THE DEVICE

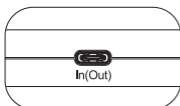

Plug the charging cable Type-C In (Out)

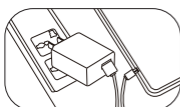

Inset the other side into the 220W(110V) power, the indication light will be flicking, which shows it is under charging

ATTENTION

- 1.This device is suitable for petrol engines up to **8L** and diesel engines up to **6.5L**. To avoid damage to the device and potential injury, do not attempt to start an engine exceeding this capacity.
- 2.Don't crank the engine for more than 3 seconds. Allow the jump starter to cool down for at least 1 minute after each 3-second start attempt.
- 3.Your jump starter will work best when it is fully charged. If it is less than 50% charged, it will be have insufficient charge to start the engine.
- 4.Clear the car battery's electrodes of dust and debris before jump starting.
- 5.If the instructions are followed correctly but your vehicle still doesn't start, please wait for 5-10 minutes and try again. Do not make repeated attempts to jump starter the engine without allowing time for the device to cool down.
- 6.Do not connect the positive and negative polarity clamps together when the device is powered on.
- 7.Disconnect the cables from the jump starter when not in use.
- 8.Do not charge the device immediately after jump starting your vehicle. Wait **at least 30 minutes** before charging the device after a jump starter.
- 9.To preserve longevity, discharge and recharge the device at least once **every 3 months**.
- 10.Only use the cables provided with the jump starter or other certified cables.
- 11.Do not expose the jump starter to liquids. Do not disassemble.
- 12.Avoid dropping the device and exposing it to extreme temperatures.

ADVICE WARNINGS INDICATED ON THE DISPLAY

- **LOW VOLTAGE**

The characters "LV" appear on the screen and the warning plays once per second. The screen will show a voltage lower than 14V.



- **HIGH VOLTAGE**

The characters "888" appear on the screen and the warning tone plays.

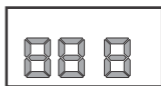

- **REVERSE CHARGE**

The characters "RC" appear on the screen. The symbol "—" flashes and the warning tone plays once per second. Standby mode will resume immediately once the error is corrected.

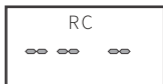

- **REVERSE POLARITY OR SHORT CIRCUIT**

The character "R&SC" appears on the screen. The "—" symbol flashes and the warning tone plays once per second. Standby mode will resume immediately once the error is corrected.

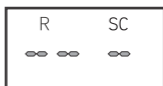

- **HIGH TEMPERATURE**

The characters "HT" appear on the screen. The "—" symbol flashes and the warning tone plays once per second. Normal operation will resume once the device temperature lowers.

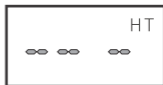

- **EXCESS CONNECTION TIME**

When connection time is too long for the clamps, the "—" symbol will flash on the screen, try step 2&3 of jump start again.

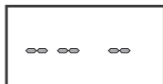

EXEMPTION FROM WARRANTY

1. On more than manual outside the problem caused by wrong operation, our company does not undertake any responsibility.
2. After the self-disassemble, our company does not undertake any responsibility.
3. The problem caused by wrong charger does not match the product, our company does not undertake any responsibility.
4. Beyond the shelf life of products, our company does not undertake any responsibility.

WARRANTY CARD

We offer 12 months warranty service from the date of purchase.

WARRANTY CONDITIONS:

When you need warranty service, please drop an email to service@foxpeed.com with the following information.

1. Order receipt.
2. Recording a short video showing the problem of the product.
3. Product serial number.

WARRANTY RANGE:

1. Quality problems under normal use.
2. Damage caused by incorrect operations does not covered by warranty.
3. Damage caused by self-disassembled, no warranty.
4. No labels on the product, no warranty.



Thank you very much for choosing to buy a Foxpeed product. We hope that it will bring more convenience and enjoyment to your life.

[Foxpeed.com](https://www.foxpeed.com)



24/7 Messenger
Support

To learn more about FOXPEED,
please visit us at



or

Scan QR Code & Start Chatting



FC CE RoHS  

Made In China

 m.me/foxpeed

 service@foxpeed.com

 foxpeed.com