

Let's set up your 2 seat sofa

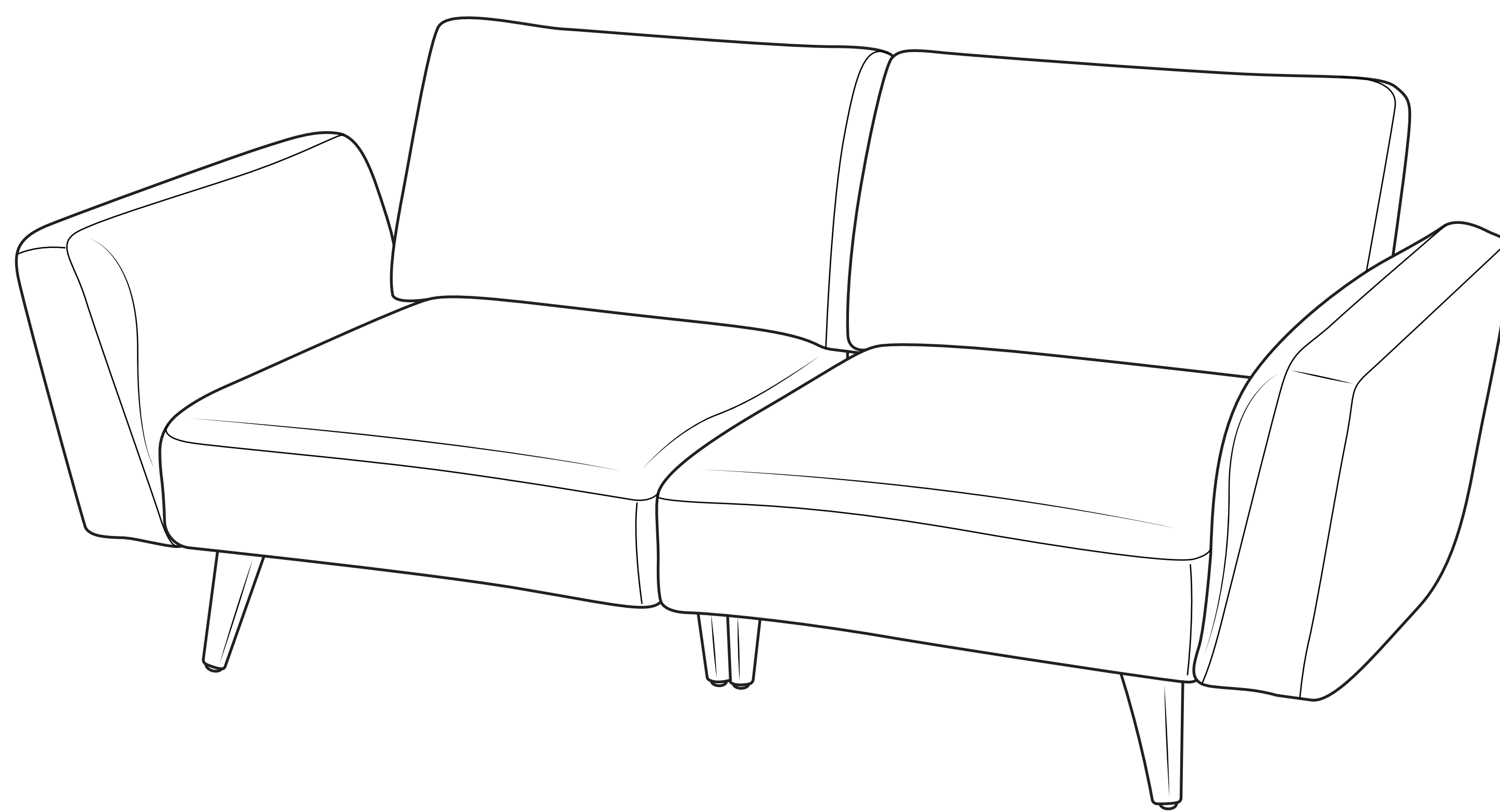

1 Unbox seats and align the holes

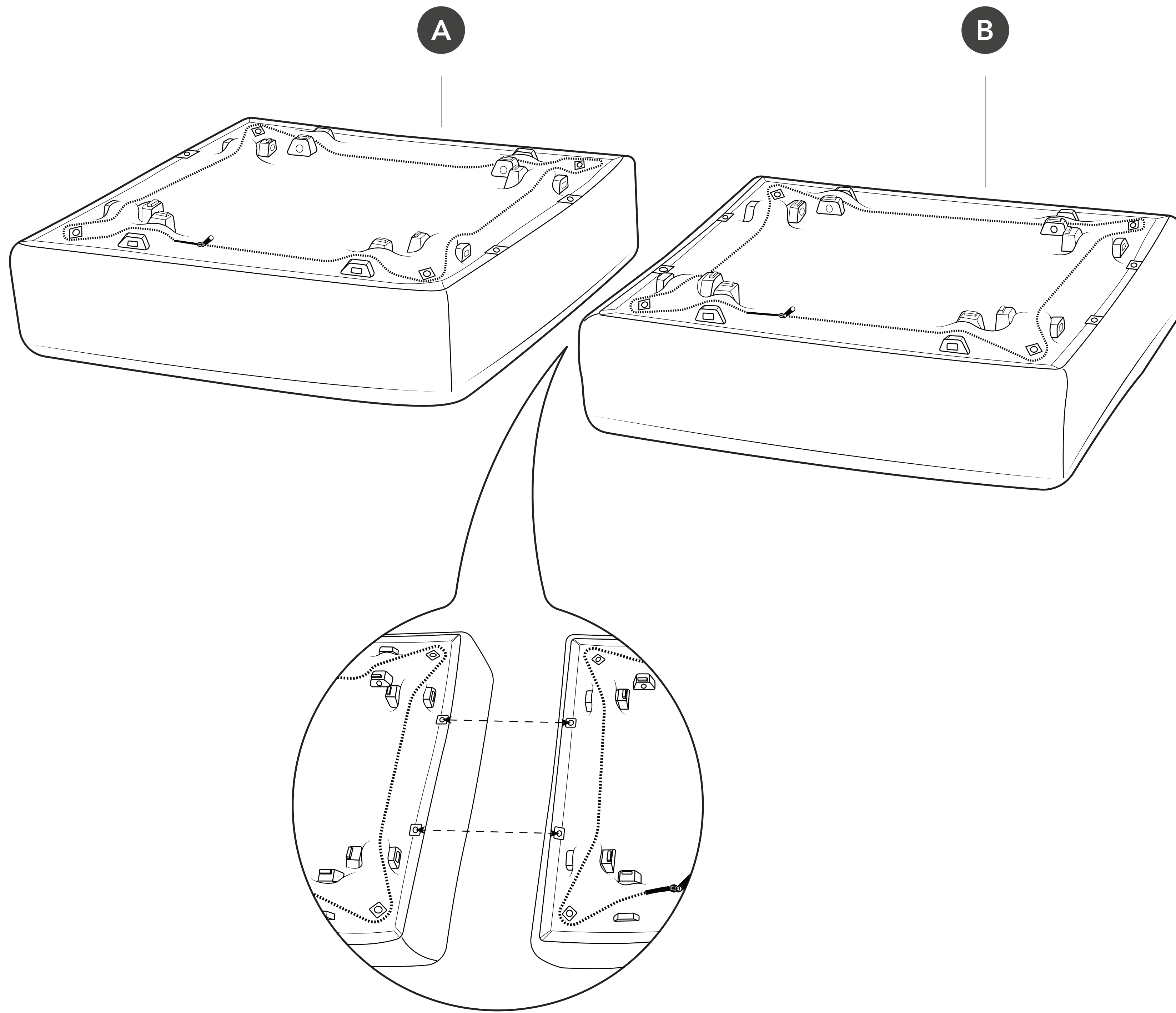

2 Remove legs and brackets
Unzip pocket underneath the seat and remove the legs, felt pads and brackets

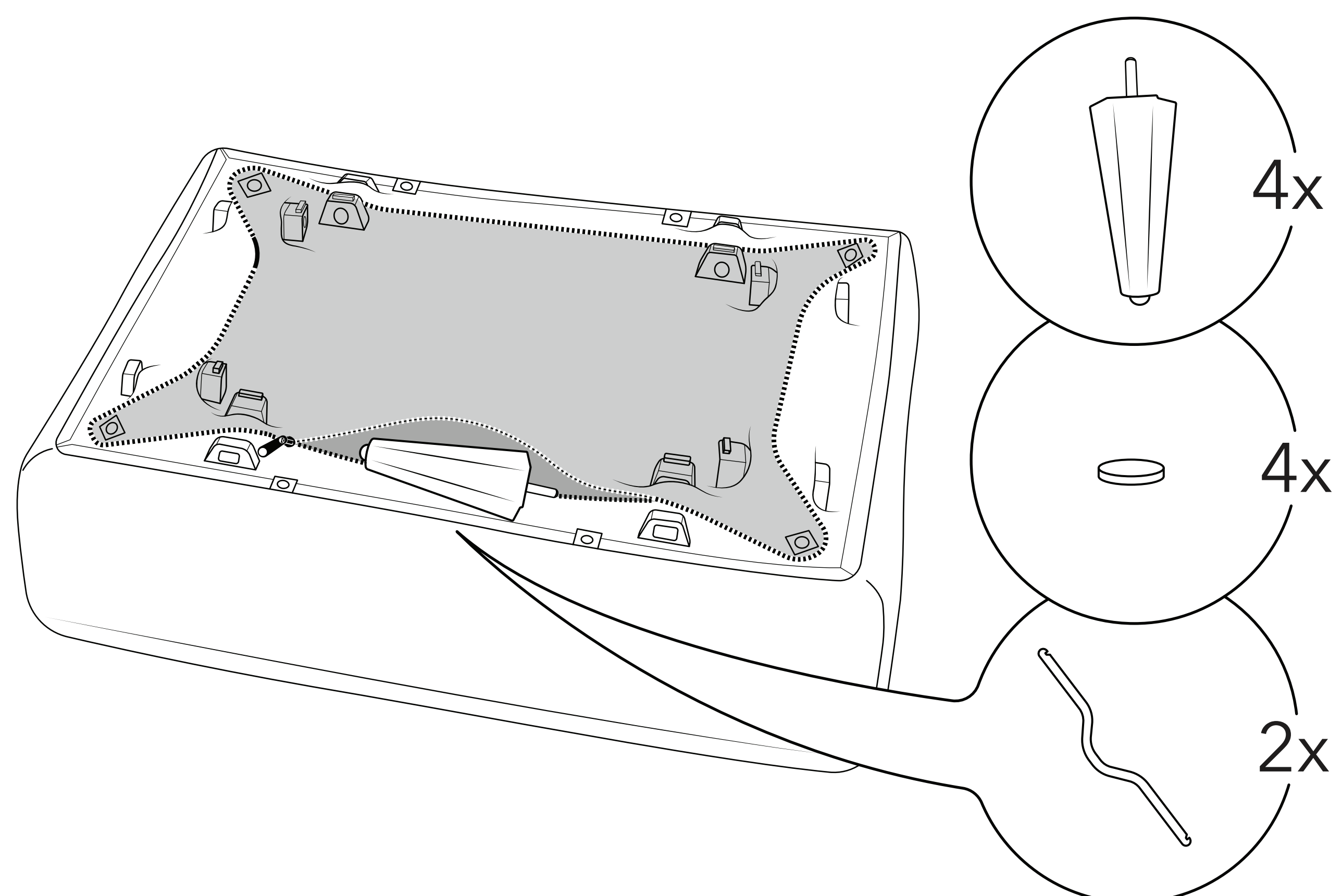

3

Insert legs into seat A

If you're unable to fully insert the legs with your hands, tap with a mallet.

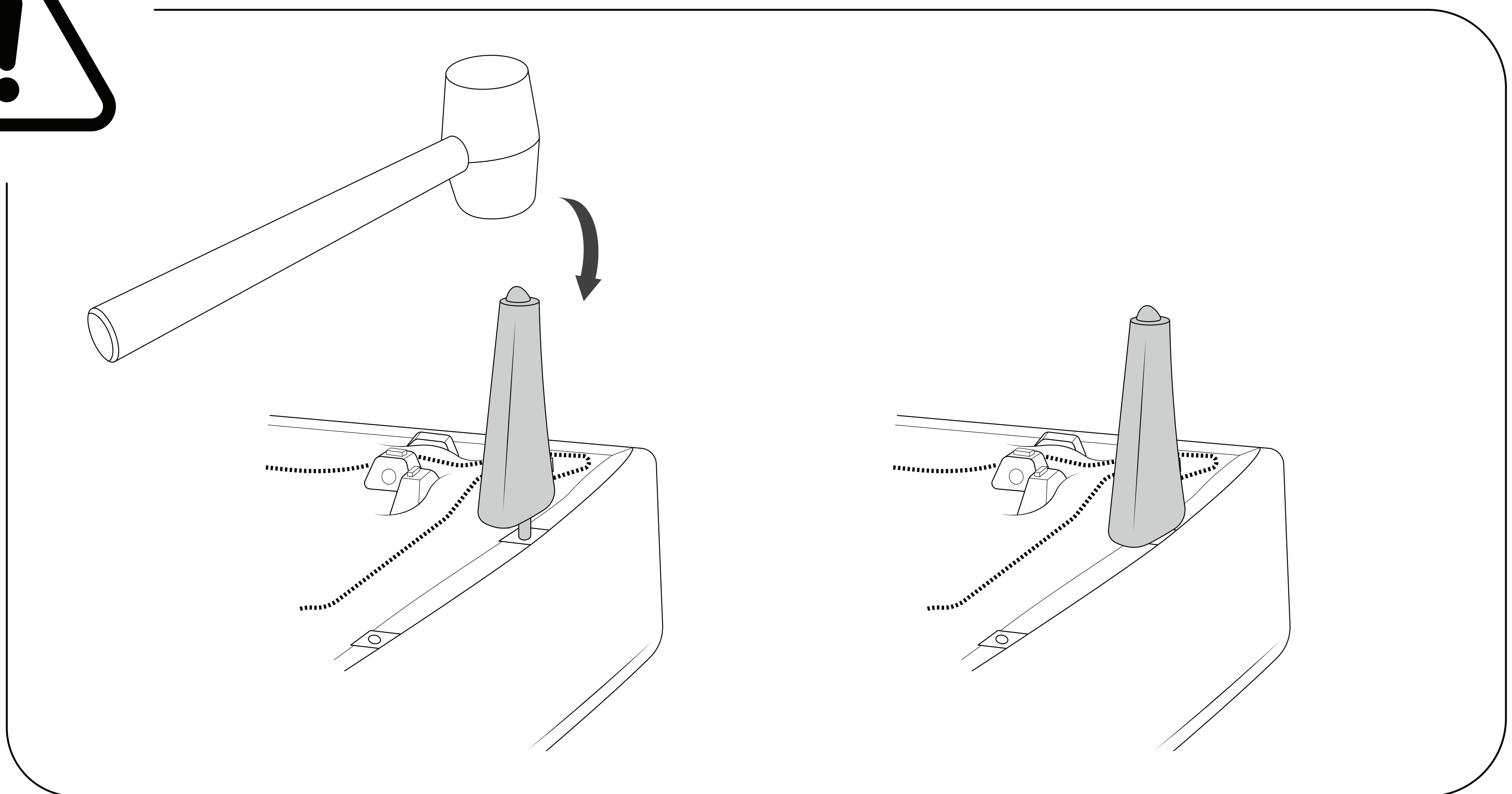
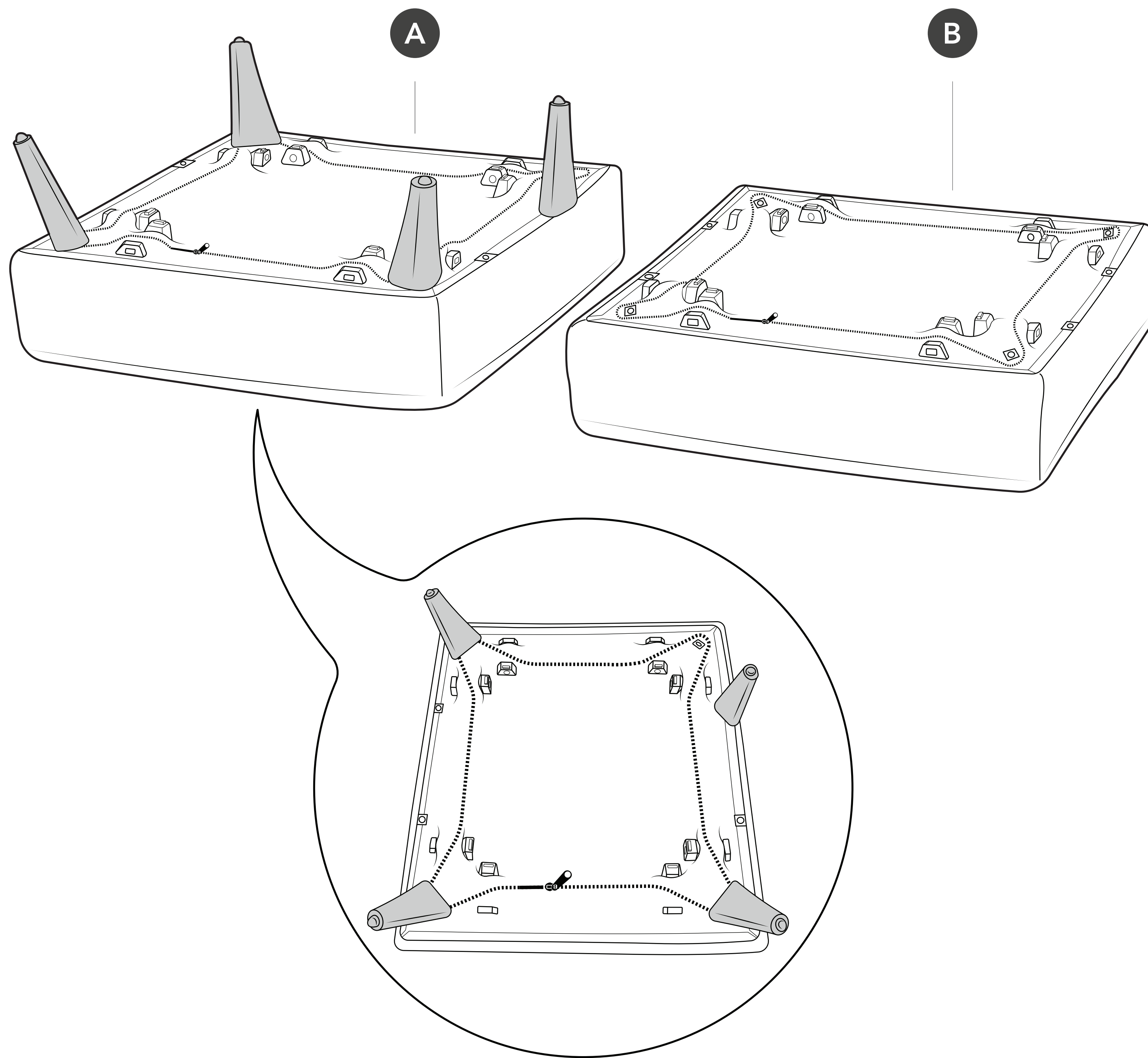

4 Insert legs into seat B

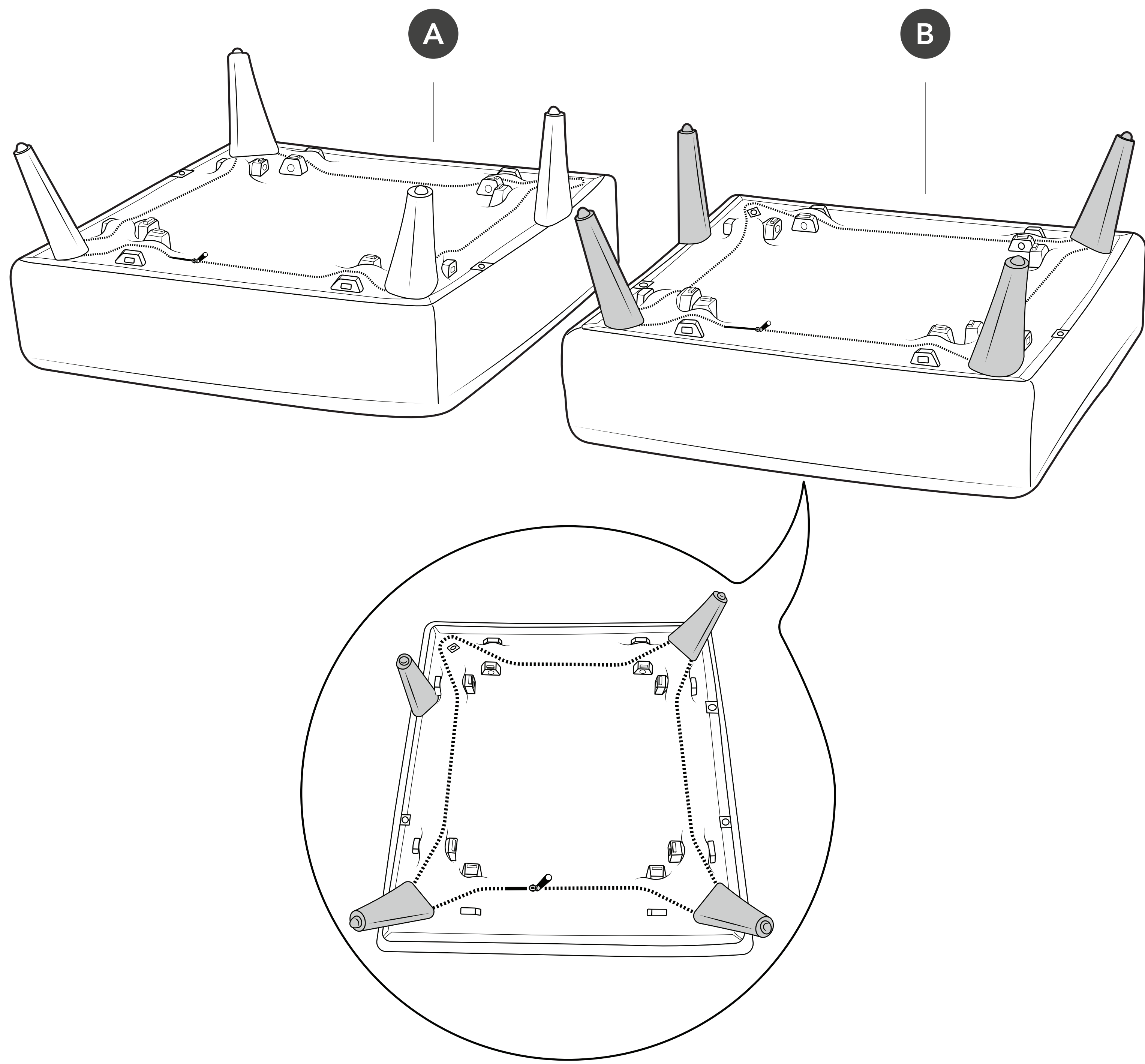

5 Attach felt pads to the legs

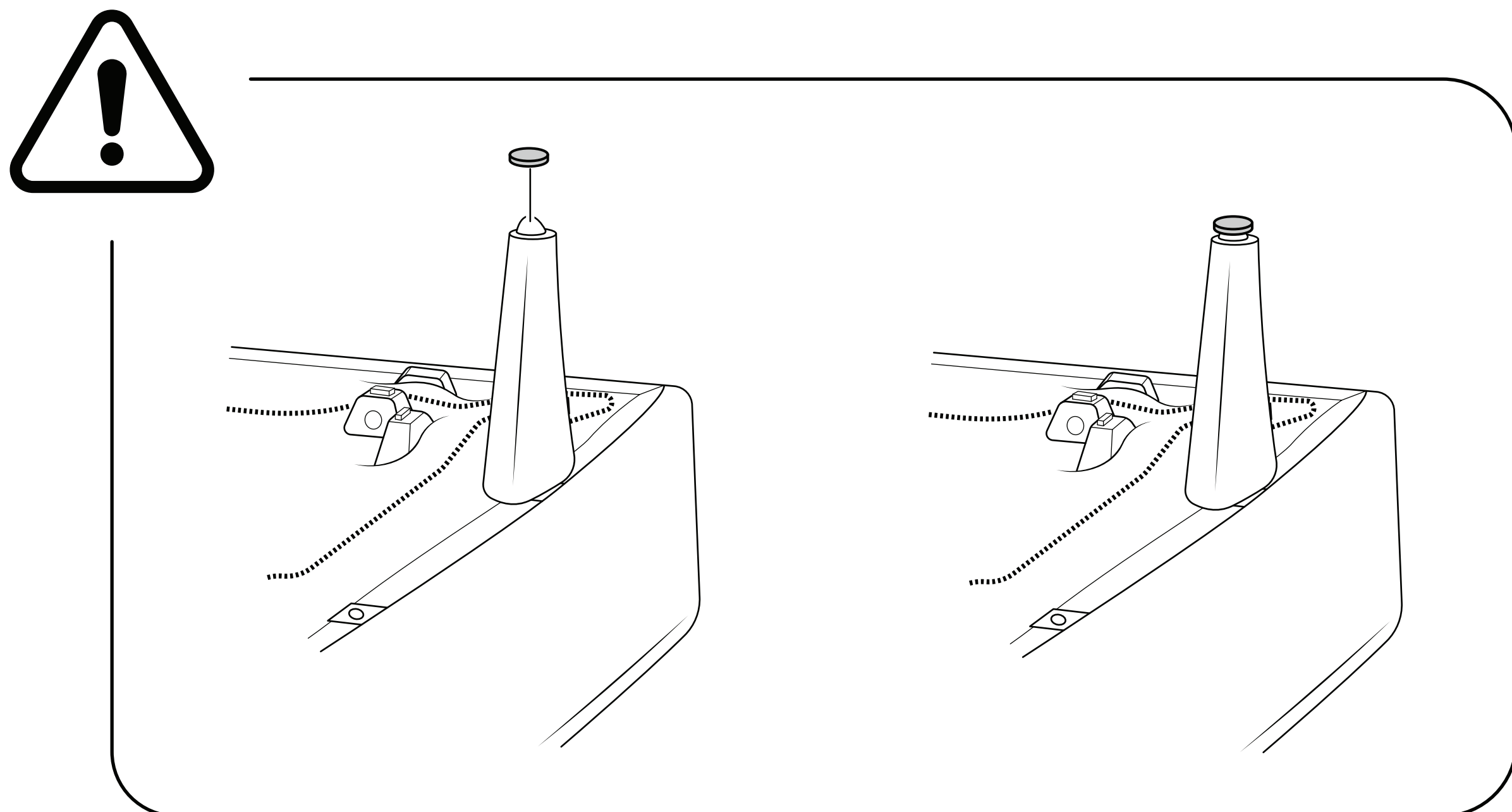
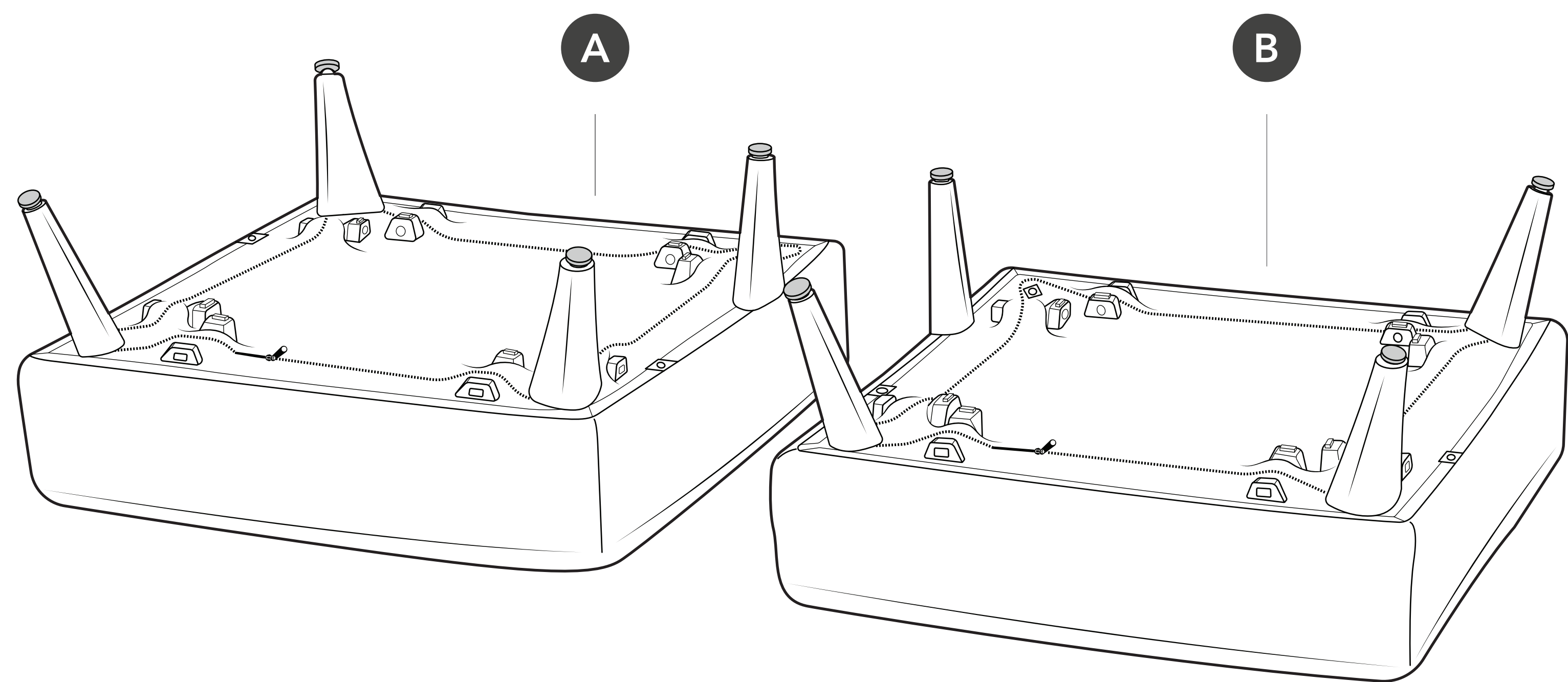

6 Rotate seat A 90°

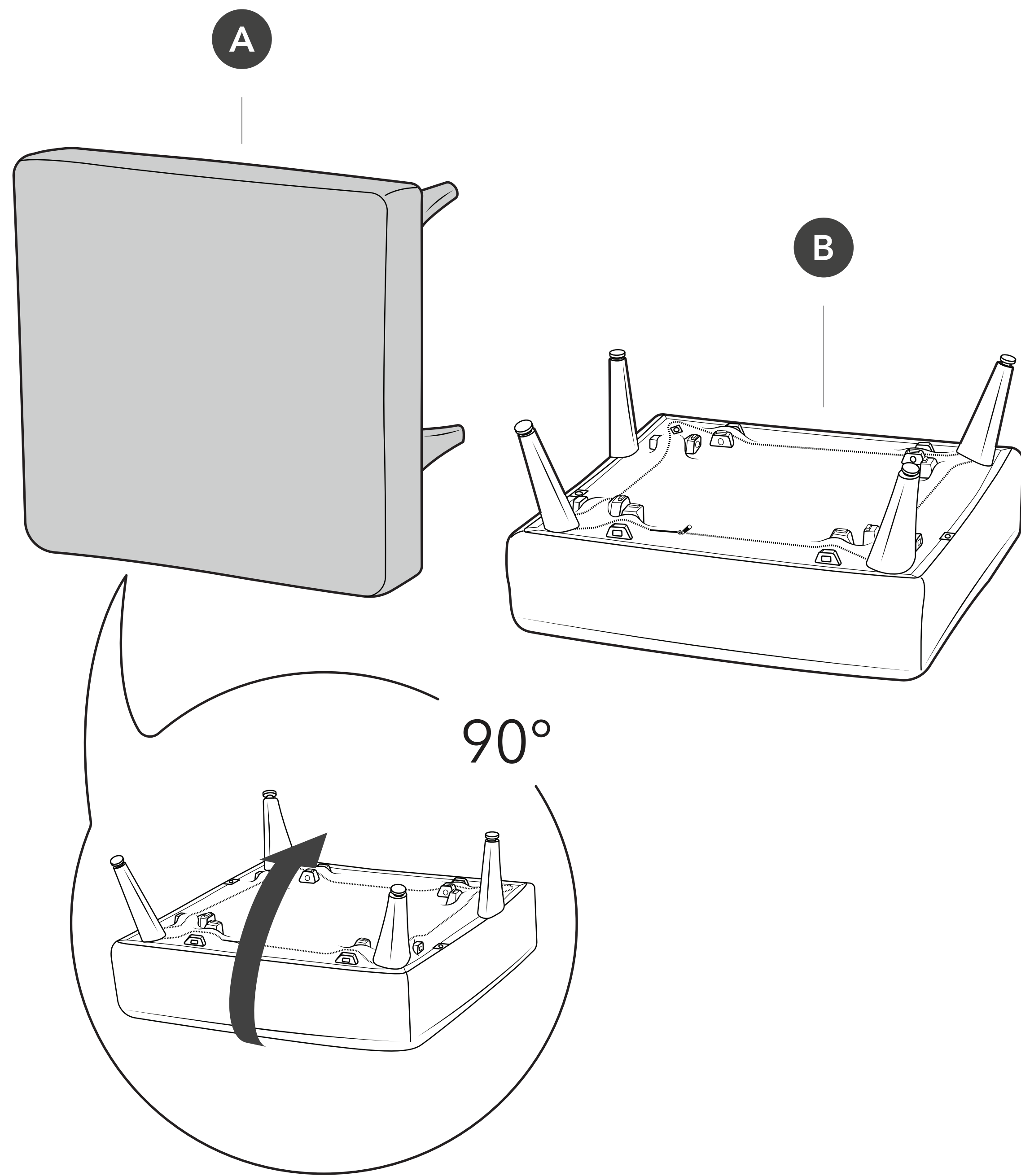

7 Insert L brackets into cushion
Insert end with one groove into black hole

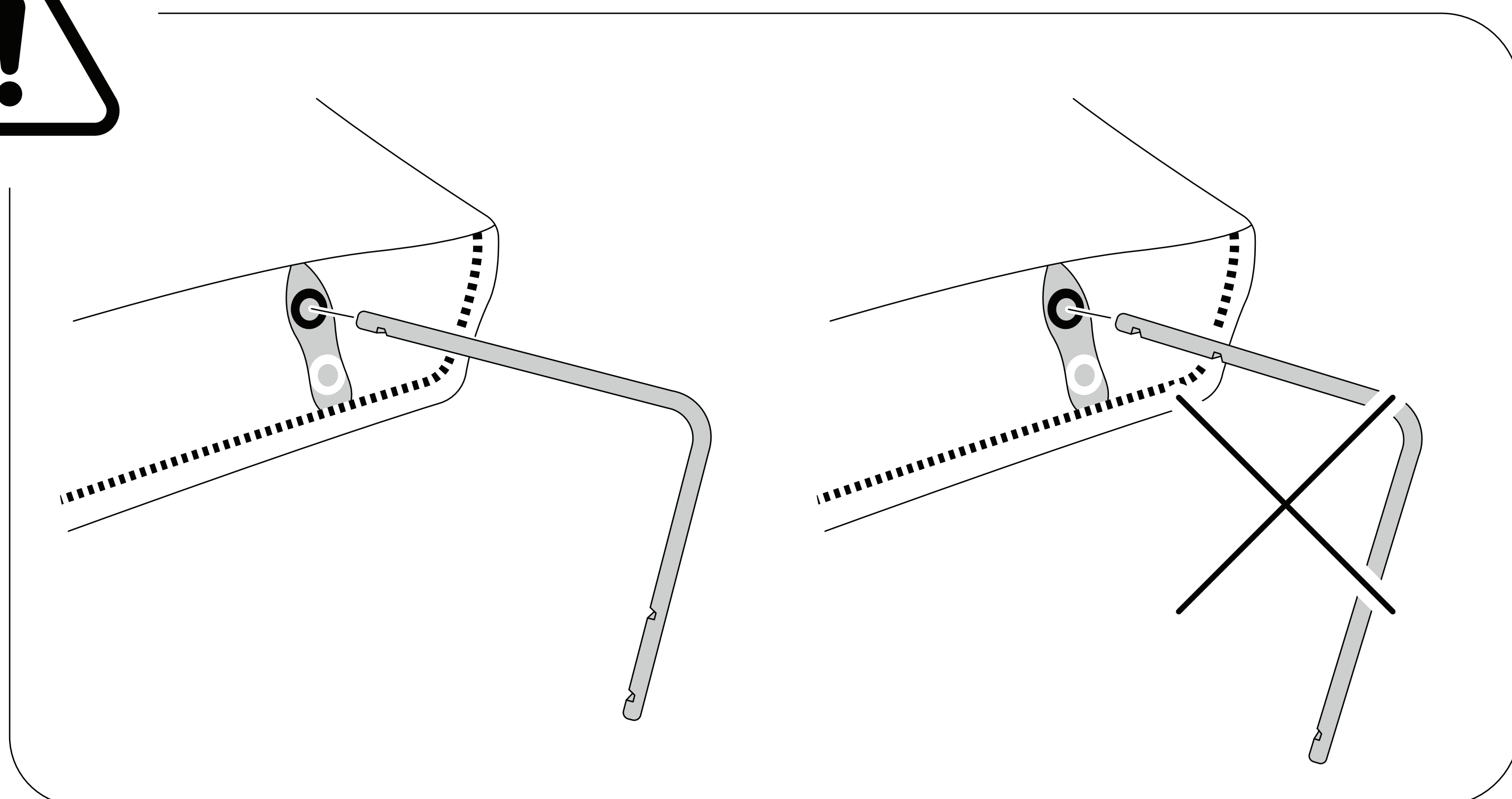
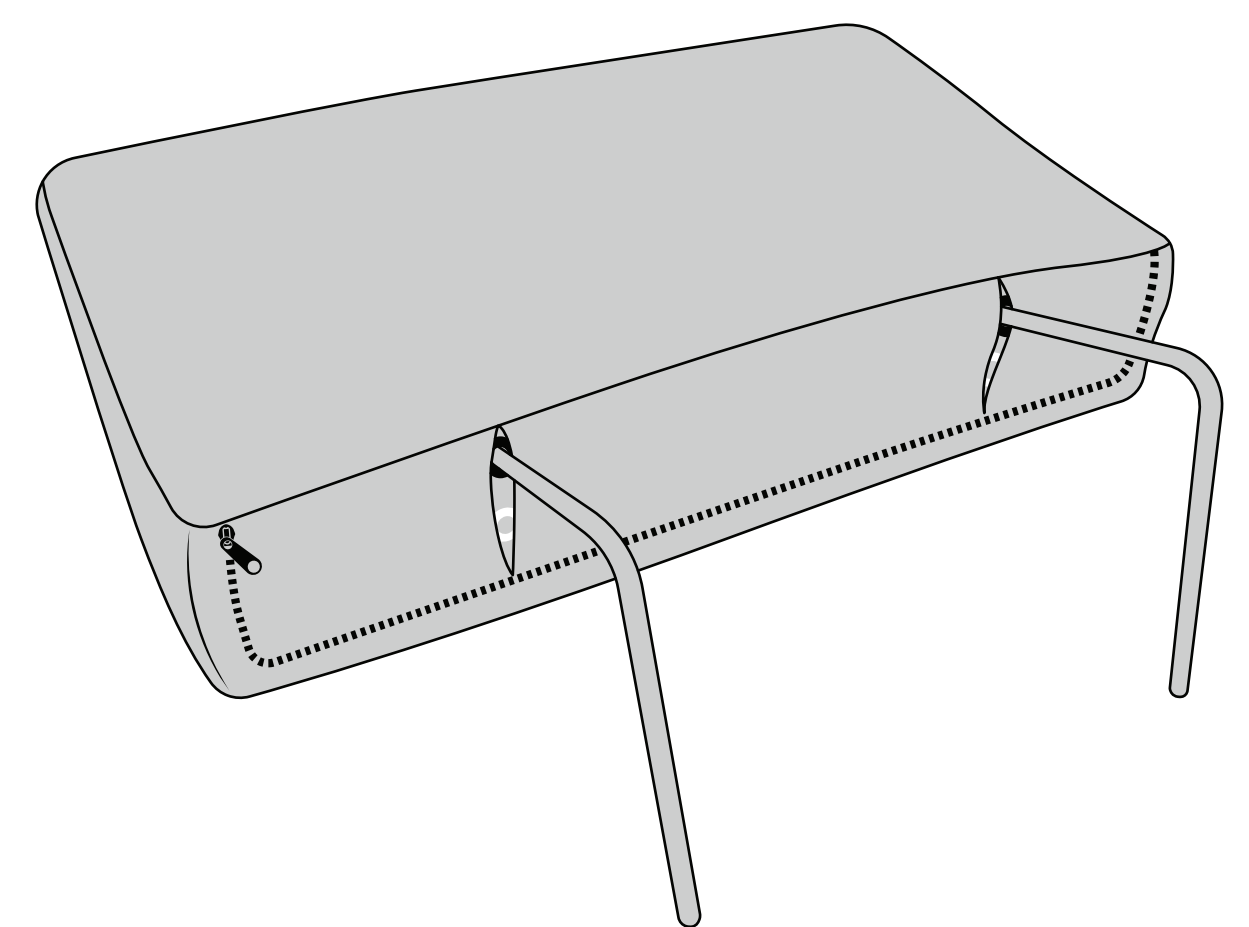
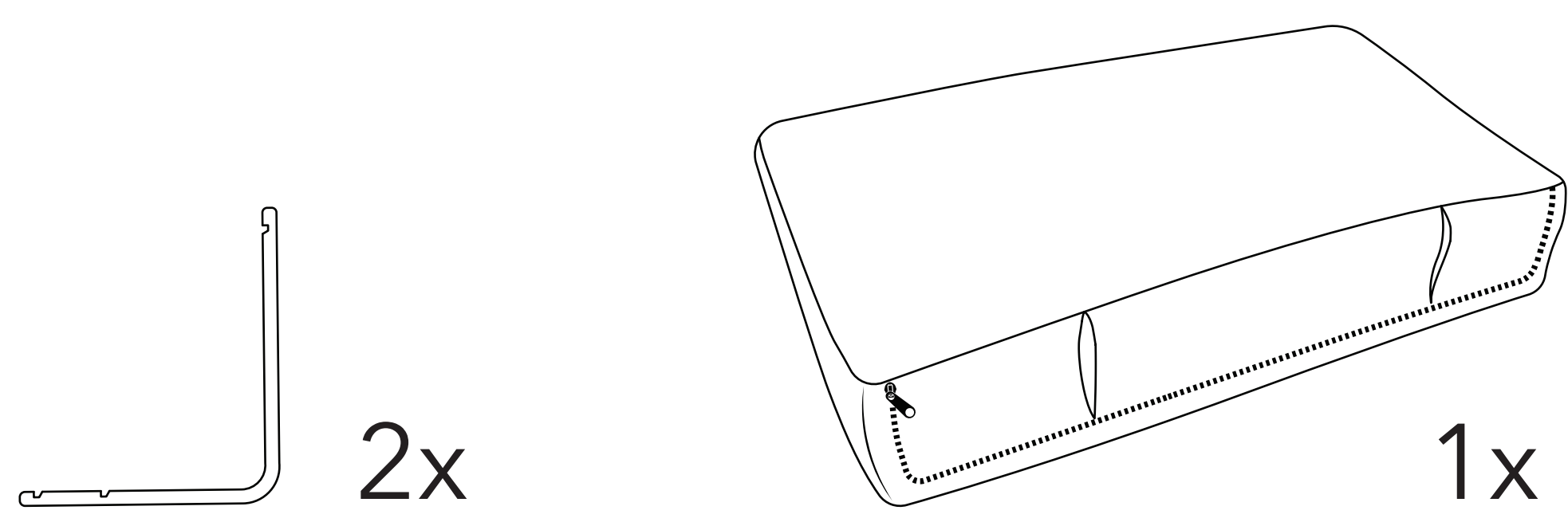

8

Attach cushion to seat A

Insert brackets into seat. Listen for the clicks.

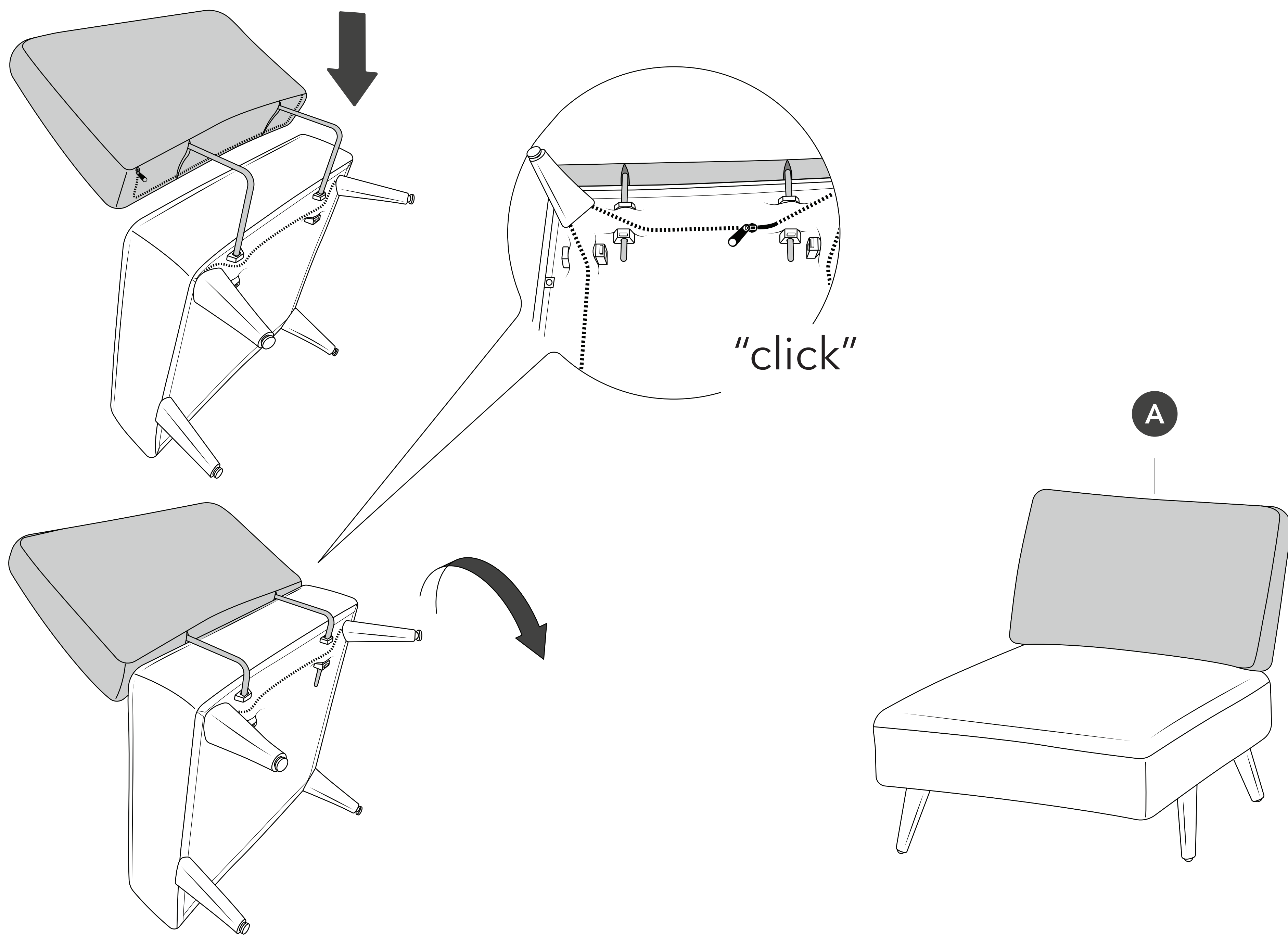

9

Repeat for cushion B

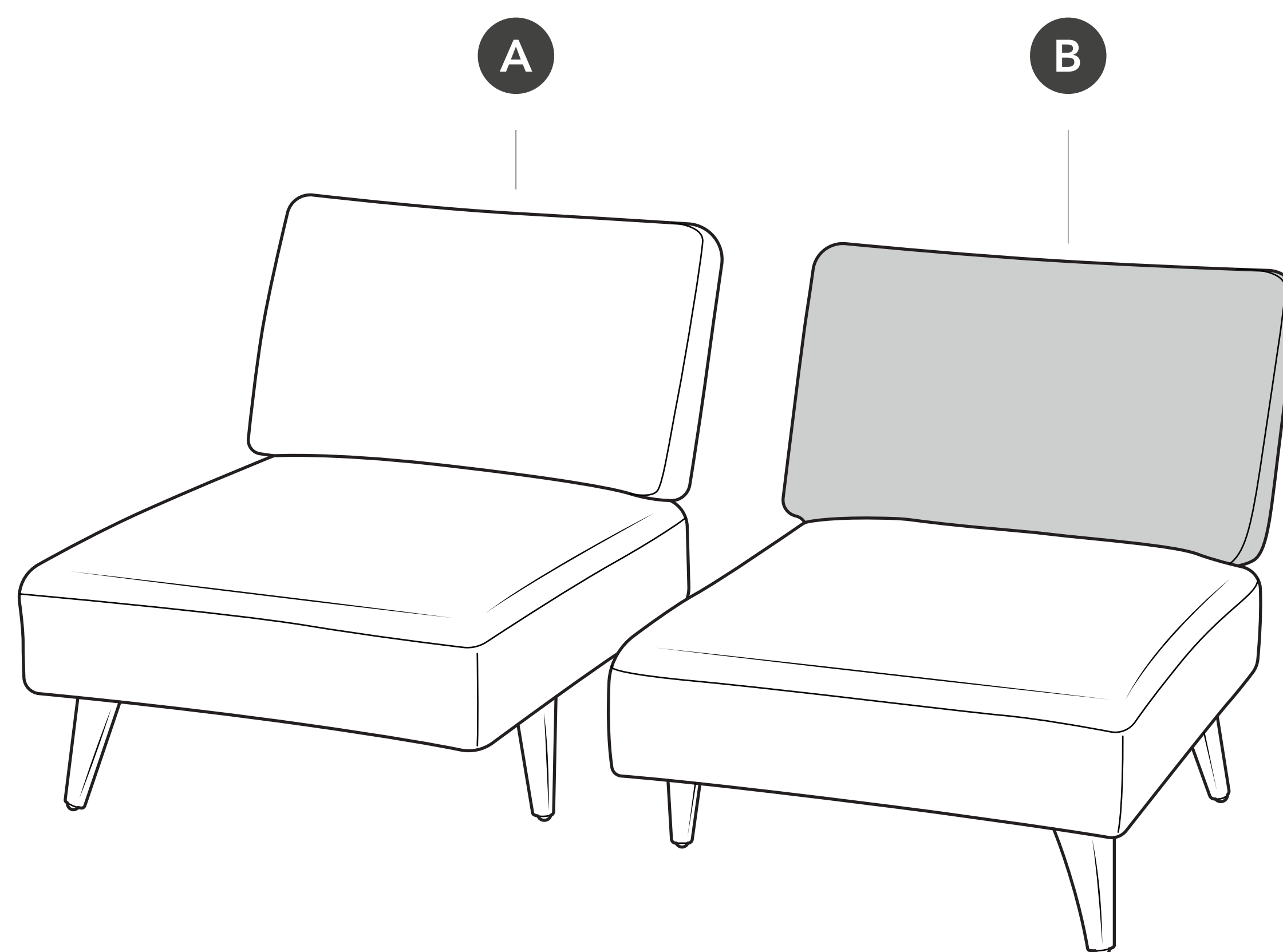

10

Join seats A and B

Insert joiner brackets into seat A and then slide seat B onto joiner brackets. Listen for the clicks.

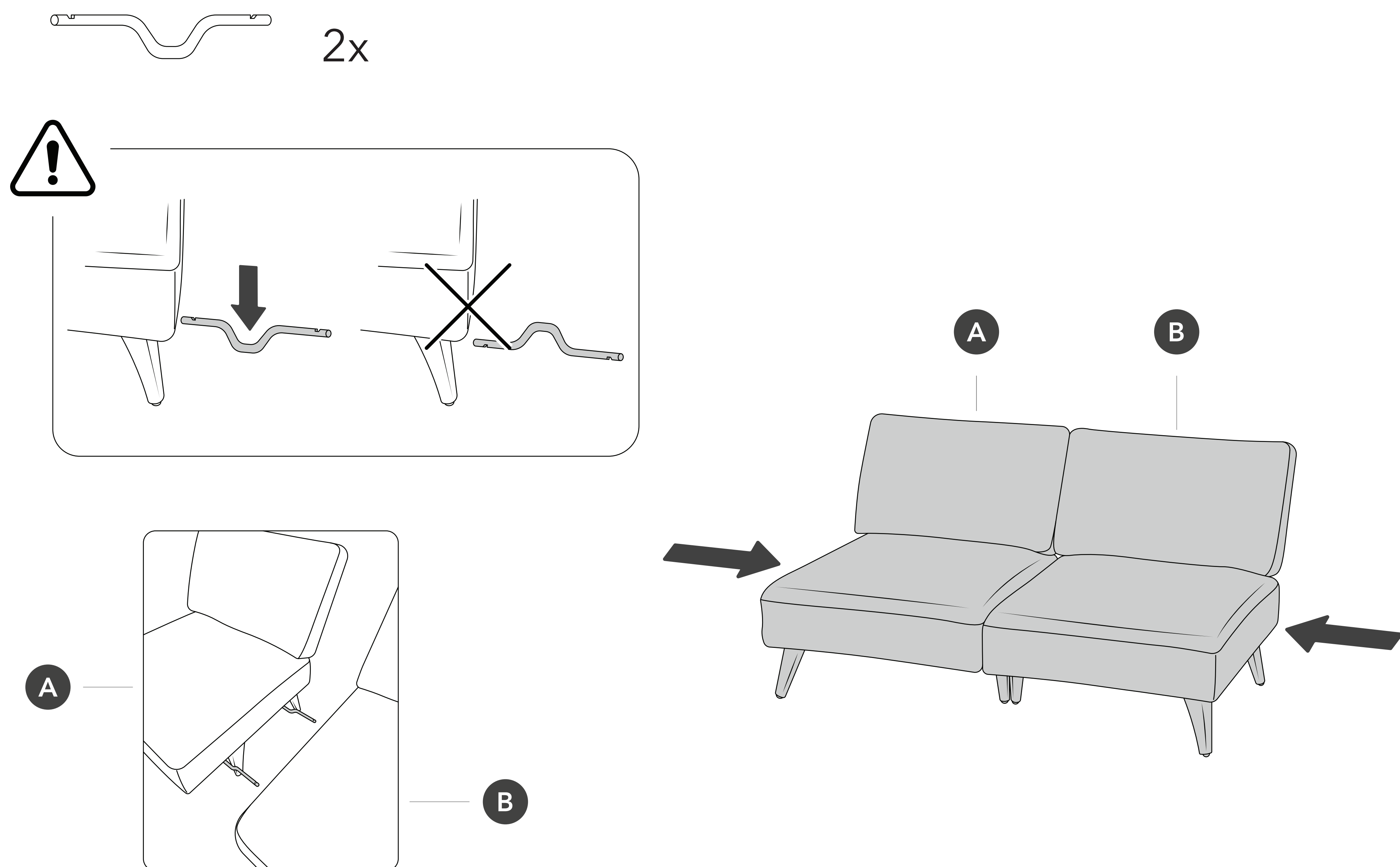

11

Adjust cushion for use as an arm

Unzip cover and swing black brackets 90°. Zip cover closed.

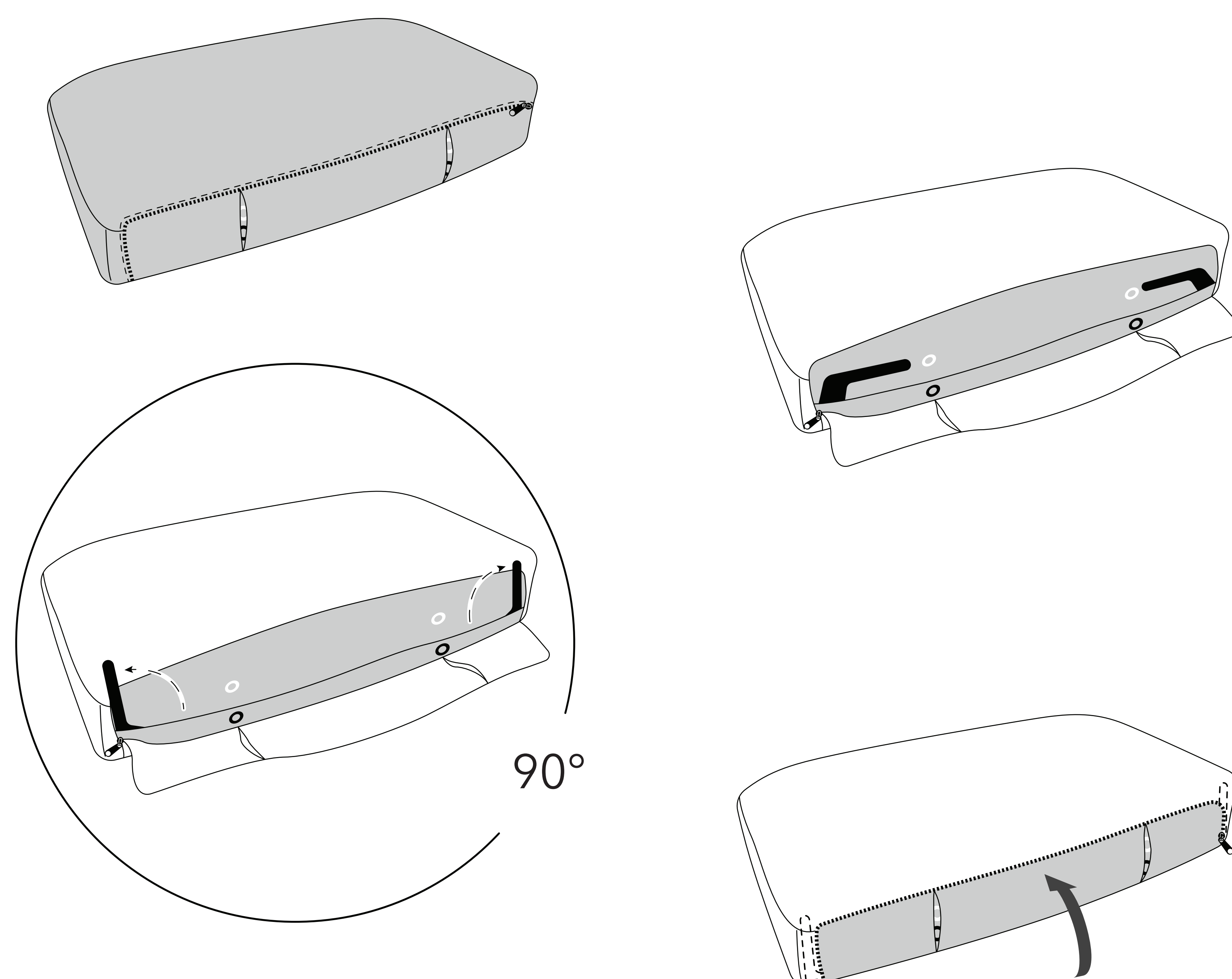

12 **Insert L brackets into cushion**
Insert end with two grooves into white hole

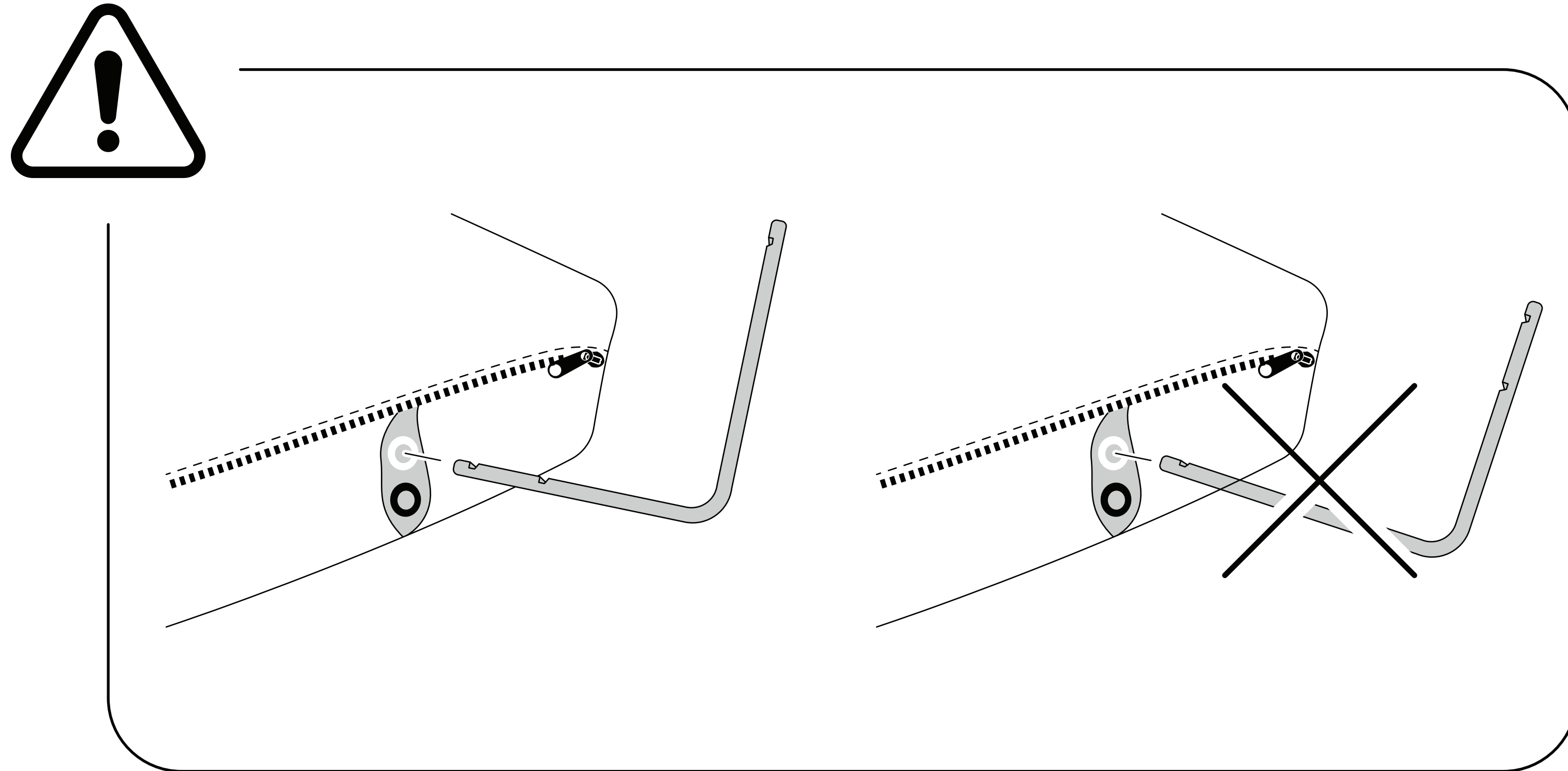
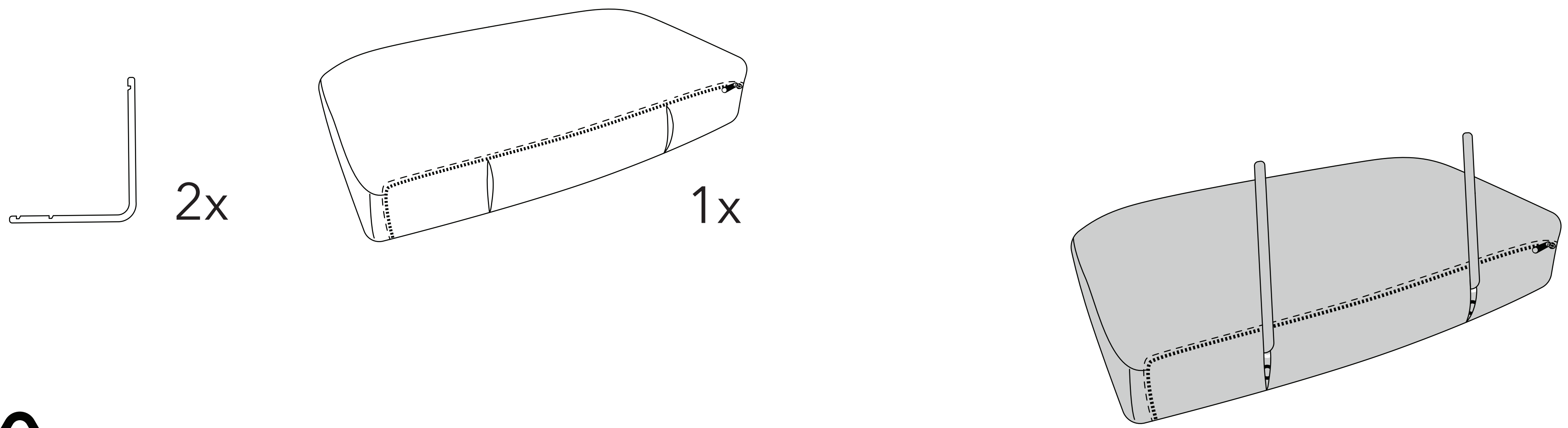

13 **Attach cushion to seat B**
Insert brackets into seat. Listen for the clicks.

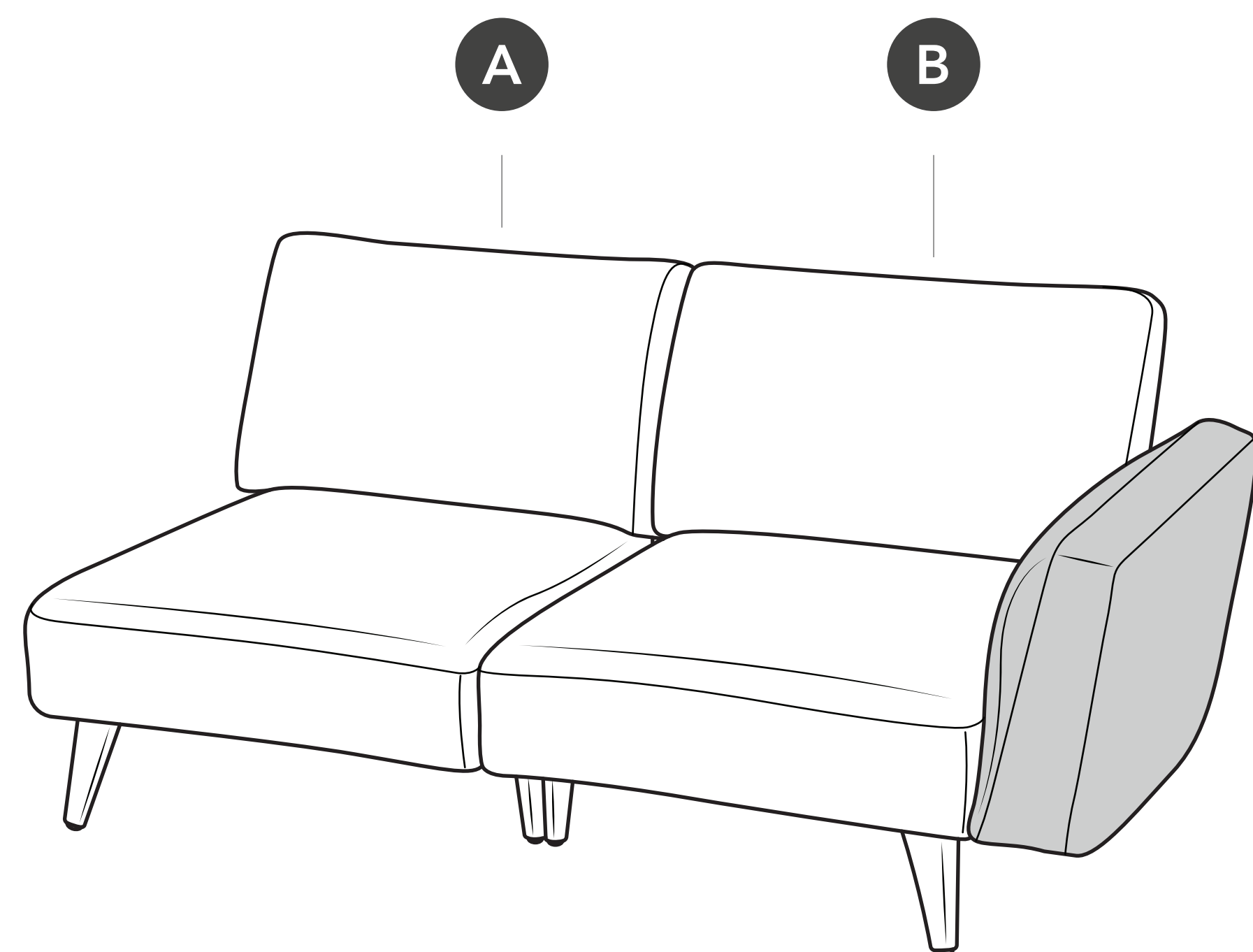
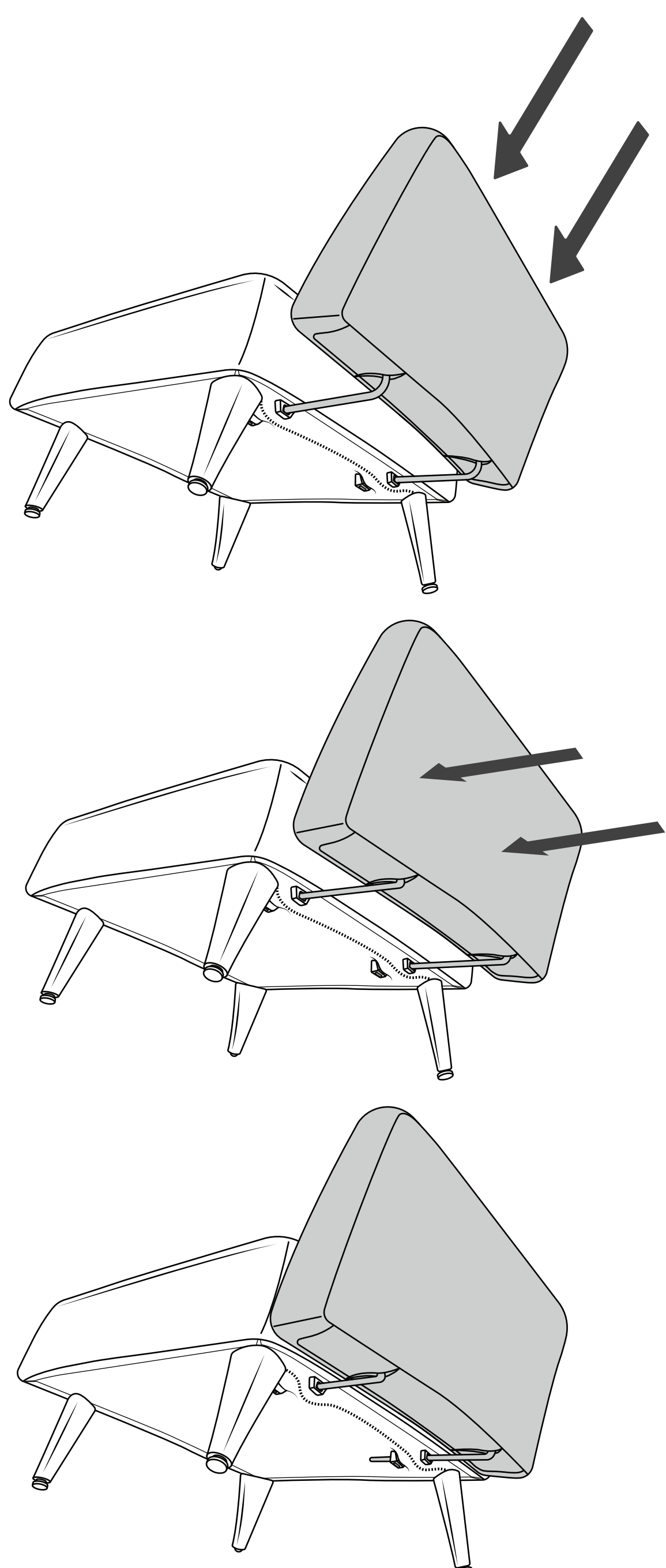

14

Attach remaining cushion

Insert brackets into seat. Listen for the clicks.

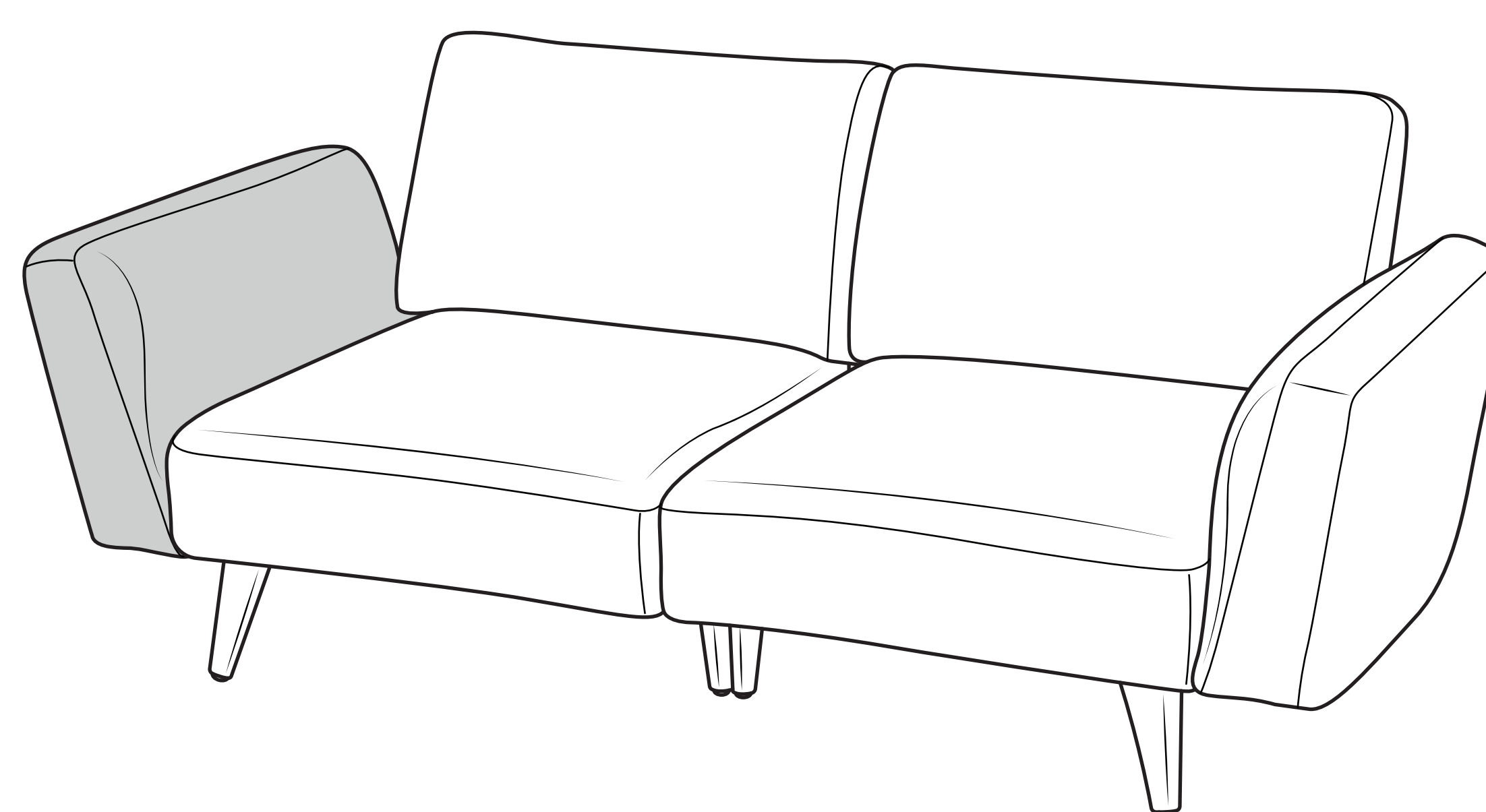

15

Enjoy

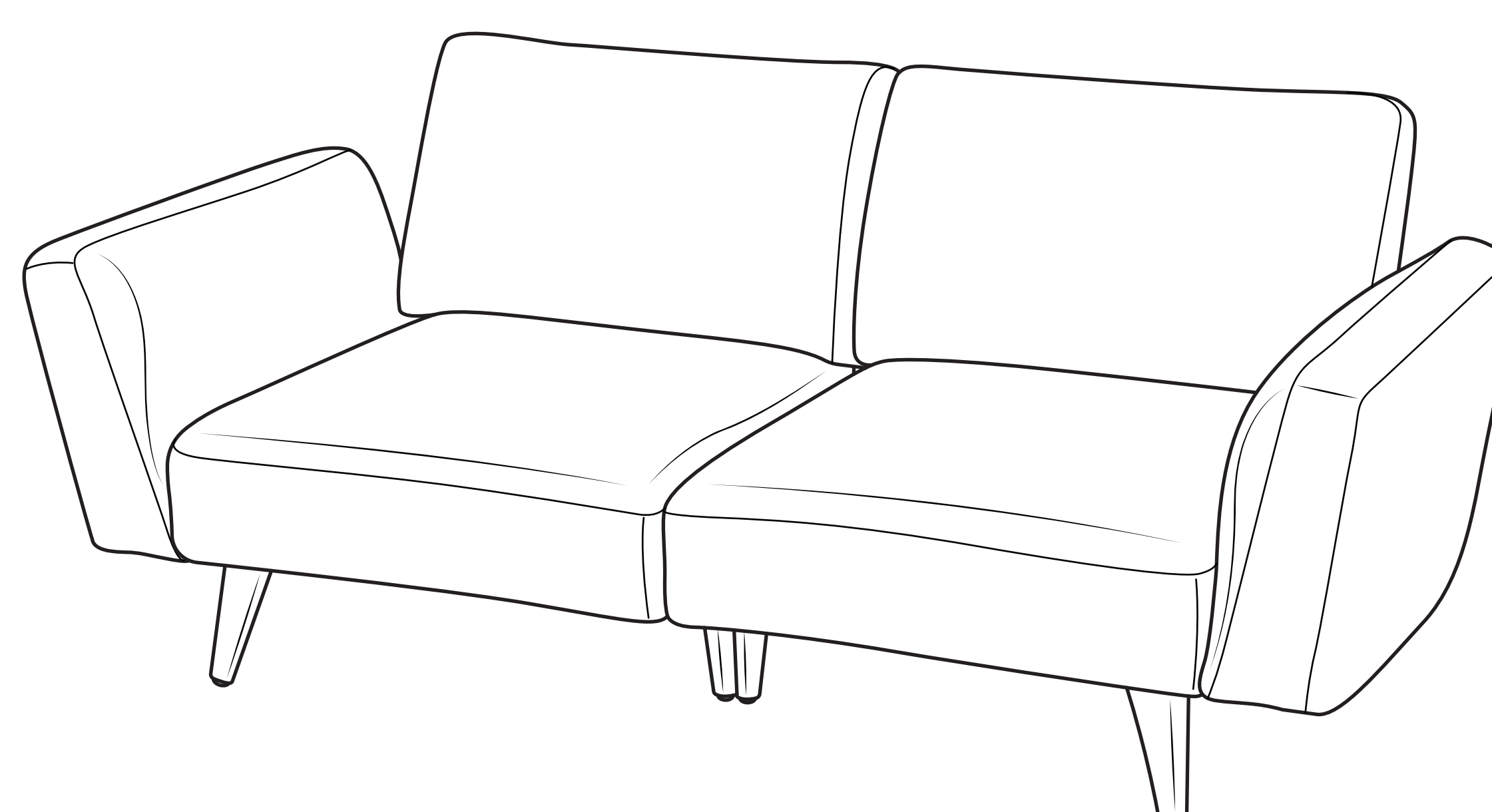

We're here to help

For help and support contact us live on chat or email us at support@wattleliving.com