

Let's set up your 1 seat module

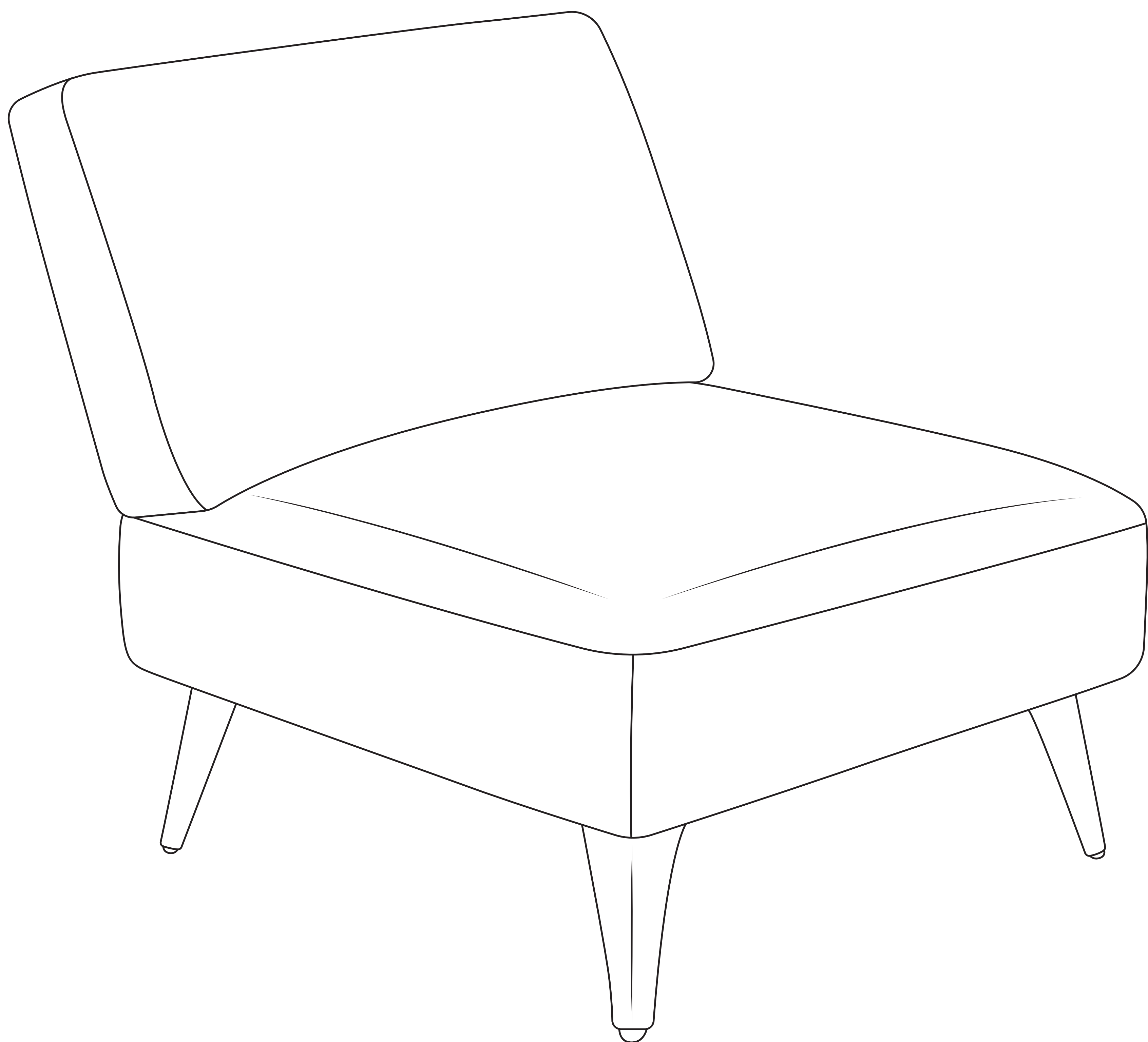

WATTLE.

- 1 Unbox and locate the front of the seat**
Peel back velcro at arrows to locate the fabric care label X. The fabric care label indicates the front of the seat.

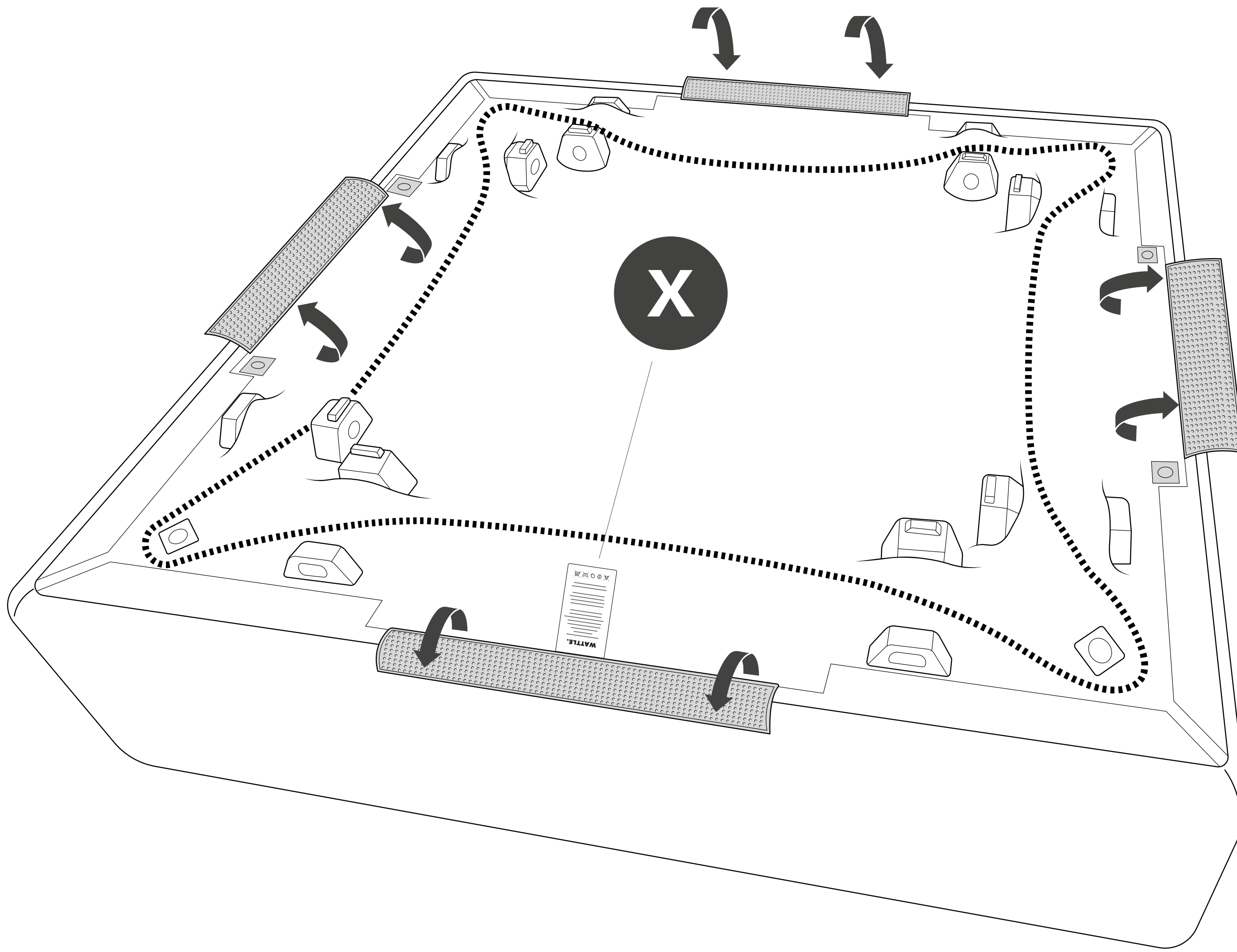

- 2 Refasten velcro**

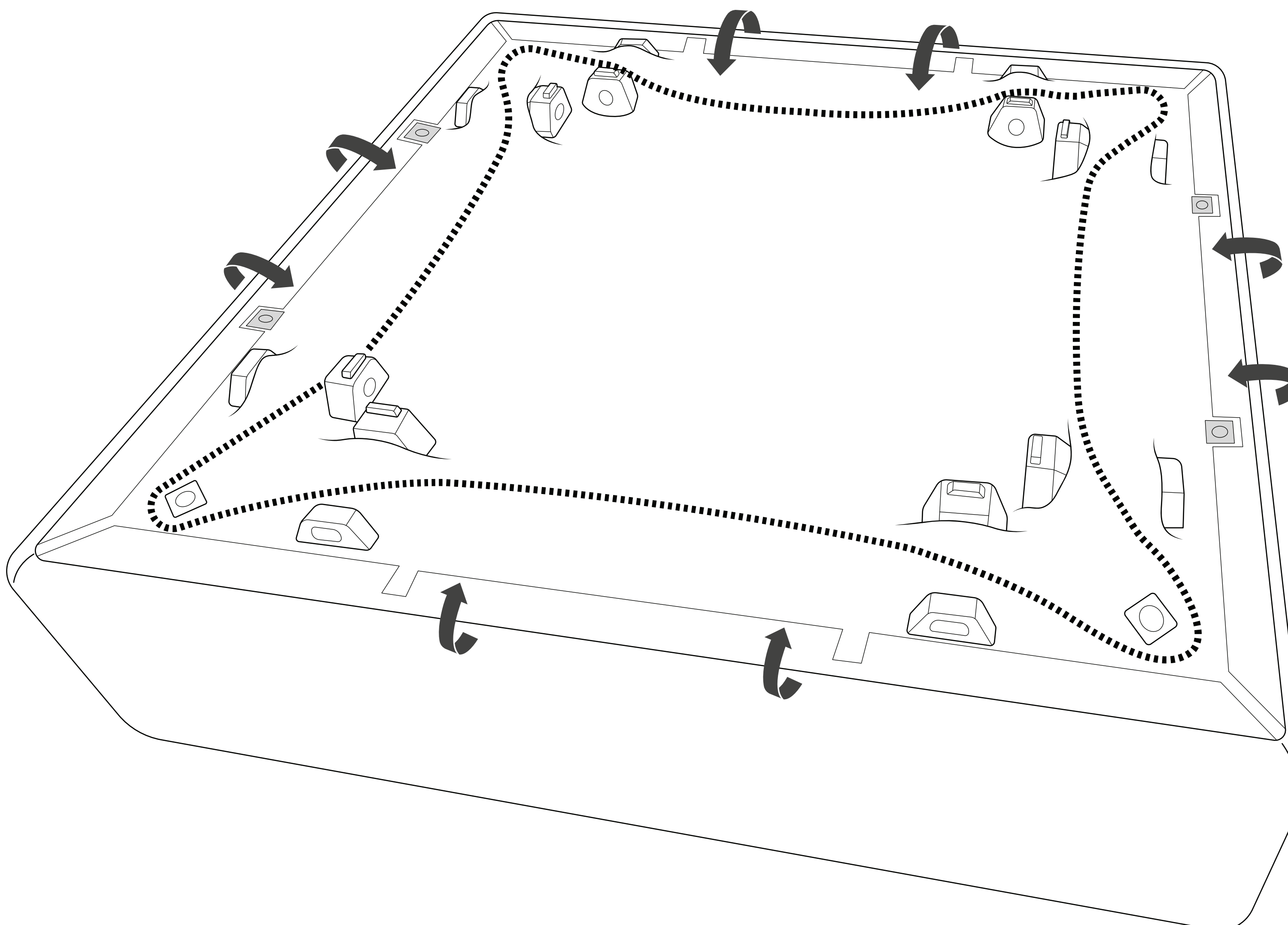

3

Remove legs and brackets

The legs will either be secured in the zip pocket under the seat, or packed separately in their own box. Joiner brackets are always secured in the zip pocket under the seat

Deliveries with
separate leg boxes

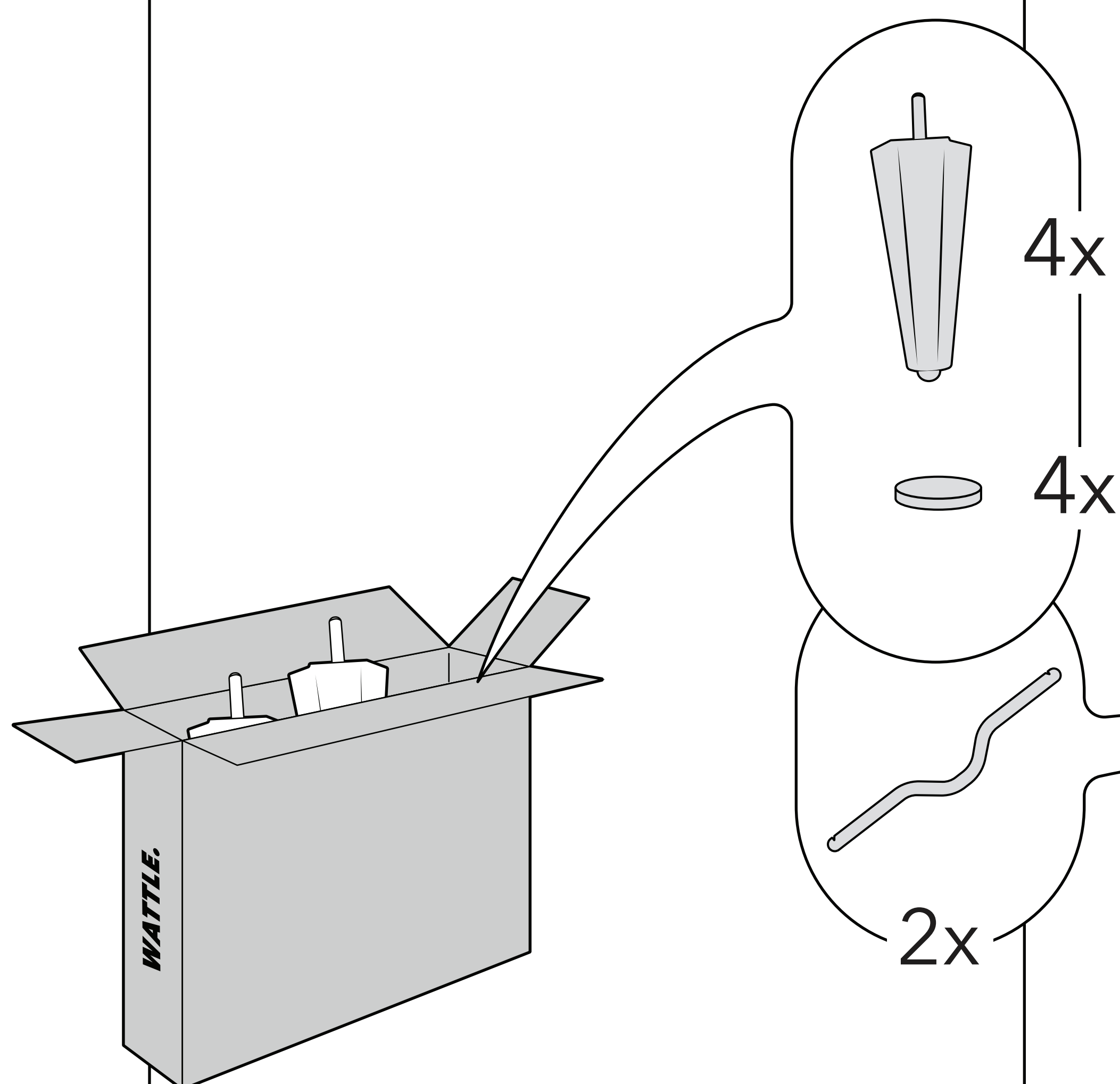

Deliveries without
separate leg boxes

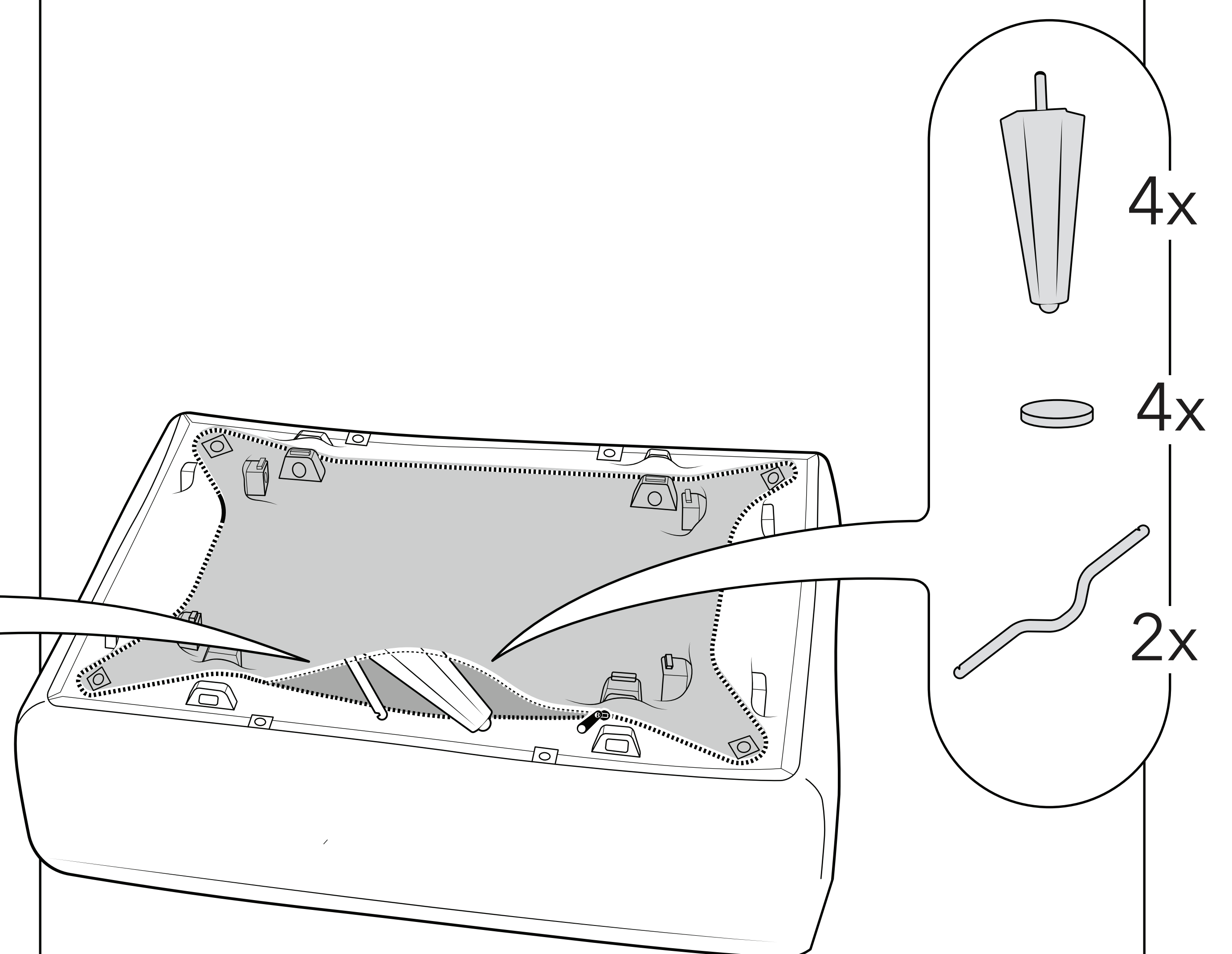

Do not open zip more than 30cm

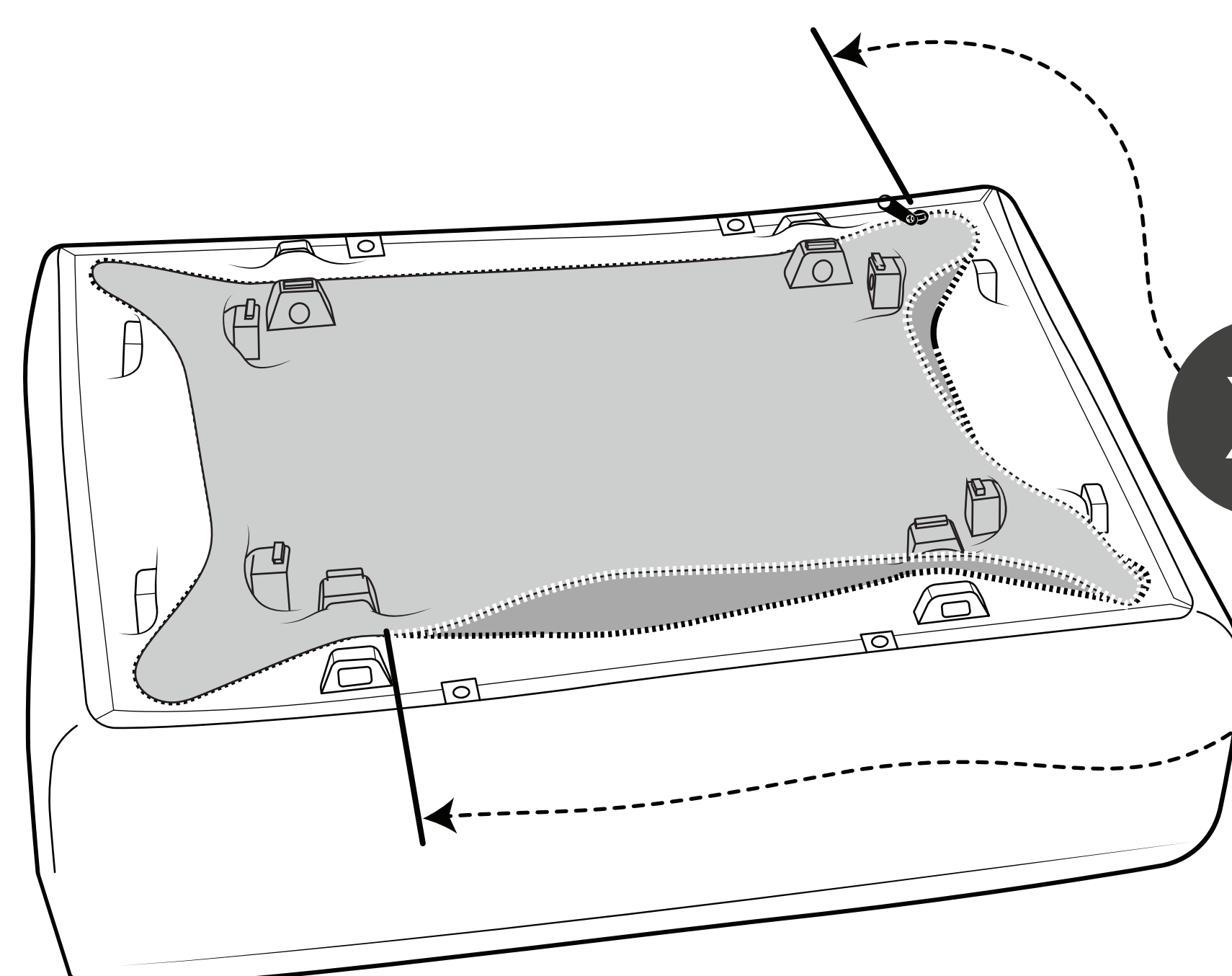
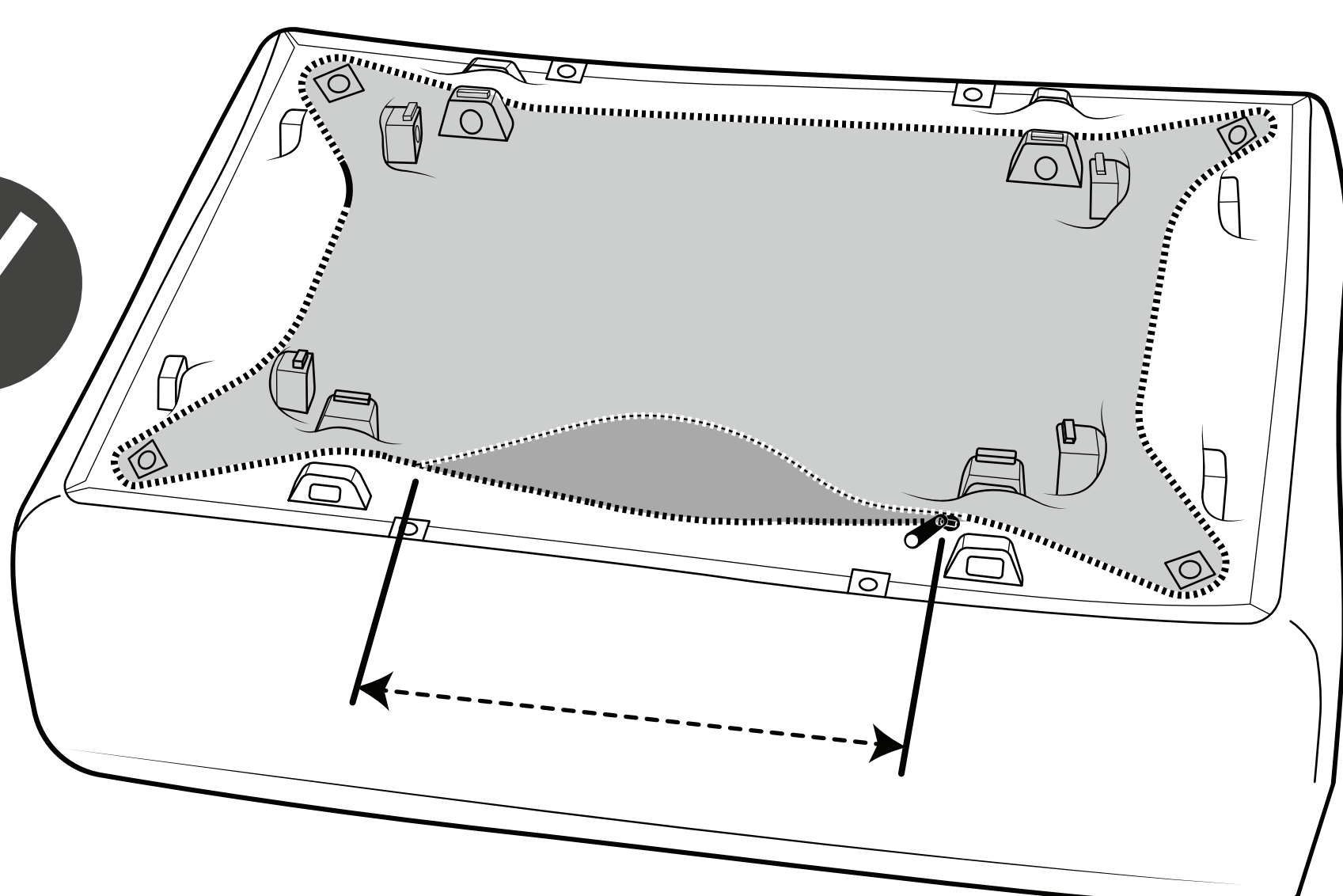

4 **Insert legs into seat**
If you're unable to fully insert the legs with your hands, tap with a mallet.

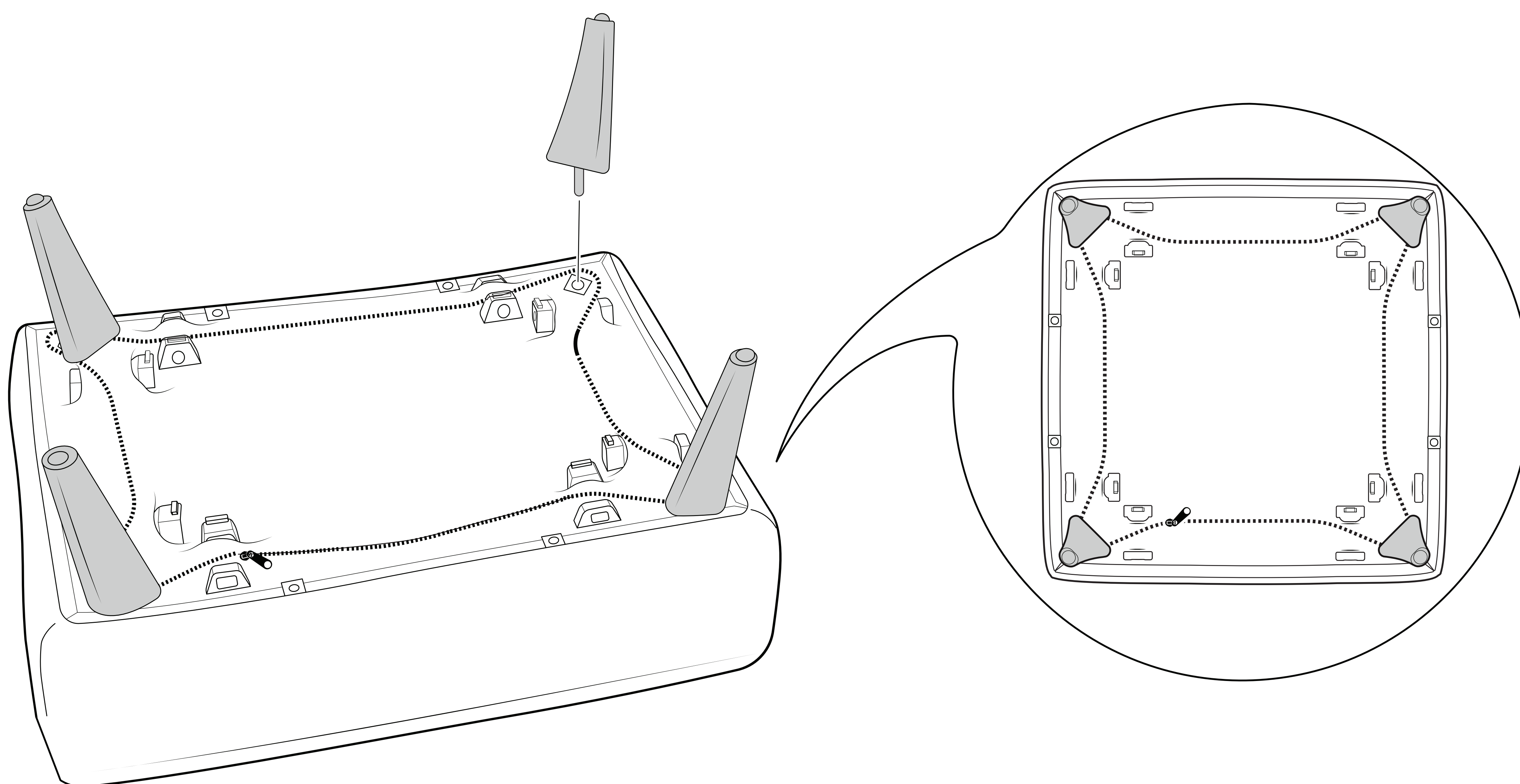

Flat surface of leg faces
inwards in corner position

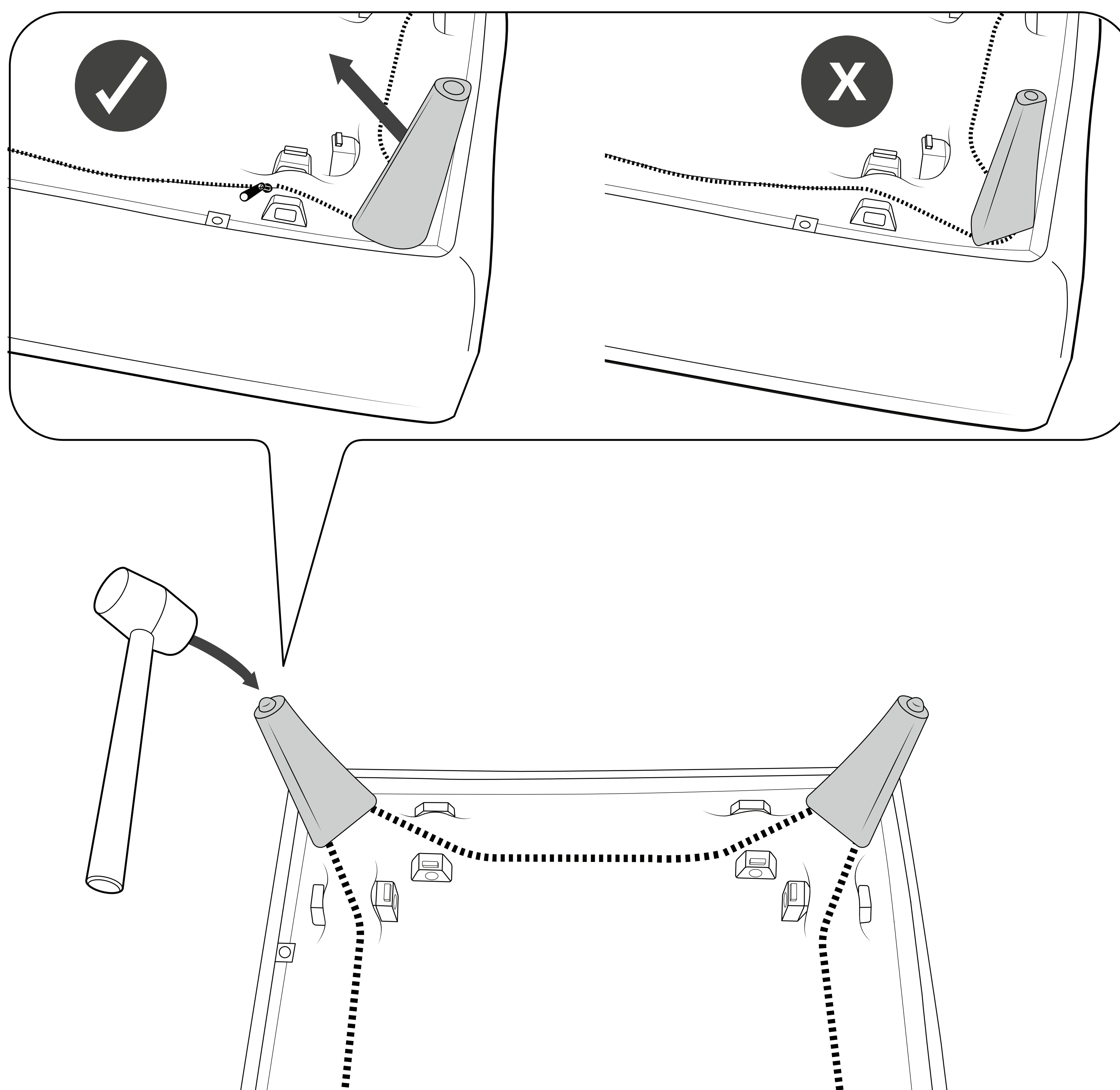

5 Attach felt pads to the legs

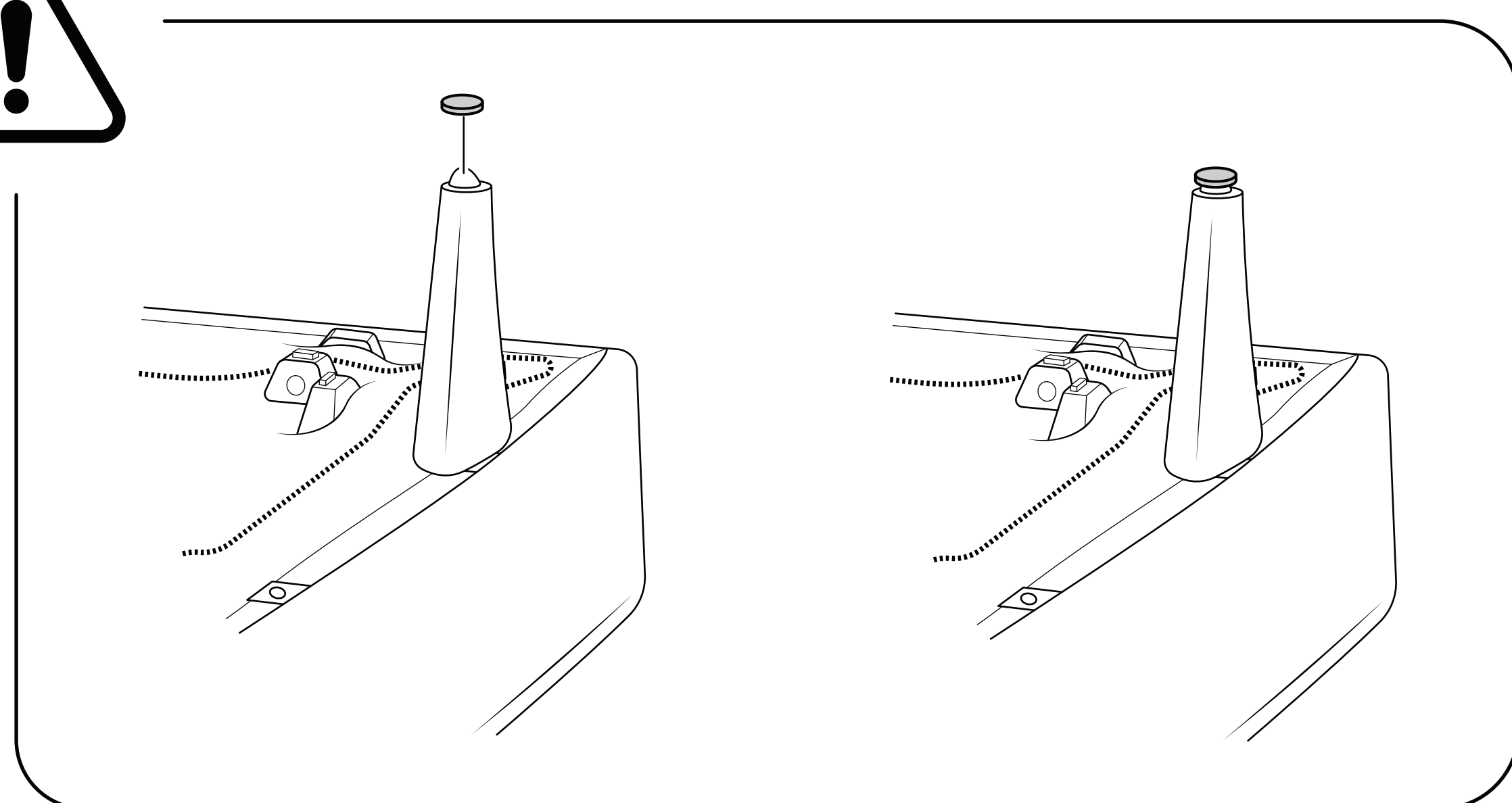
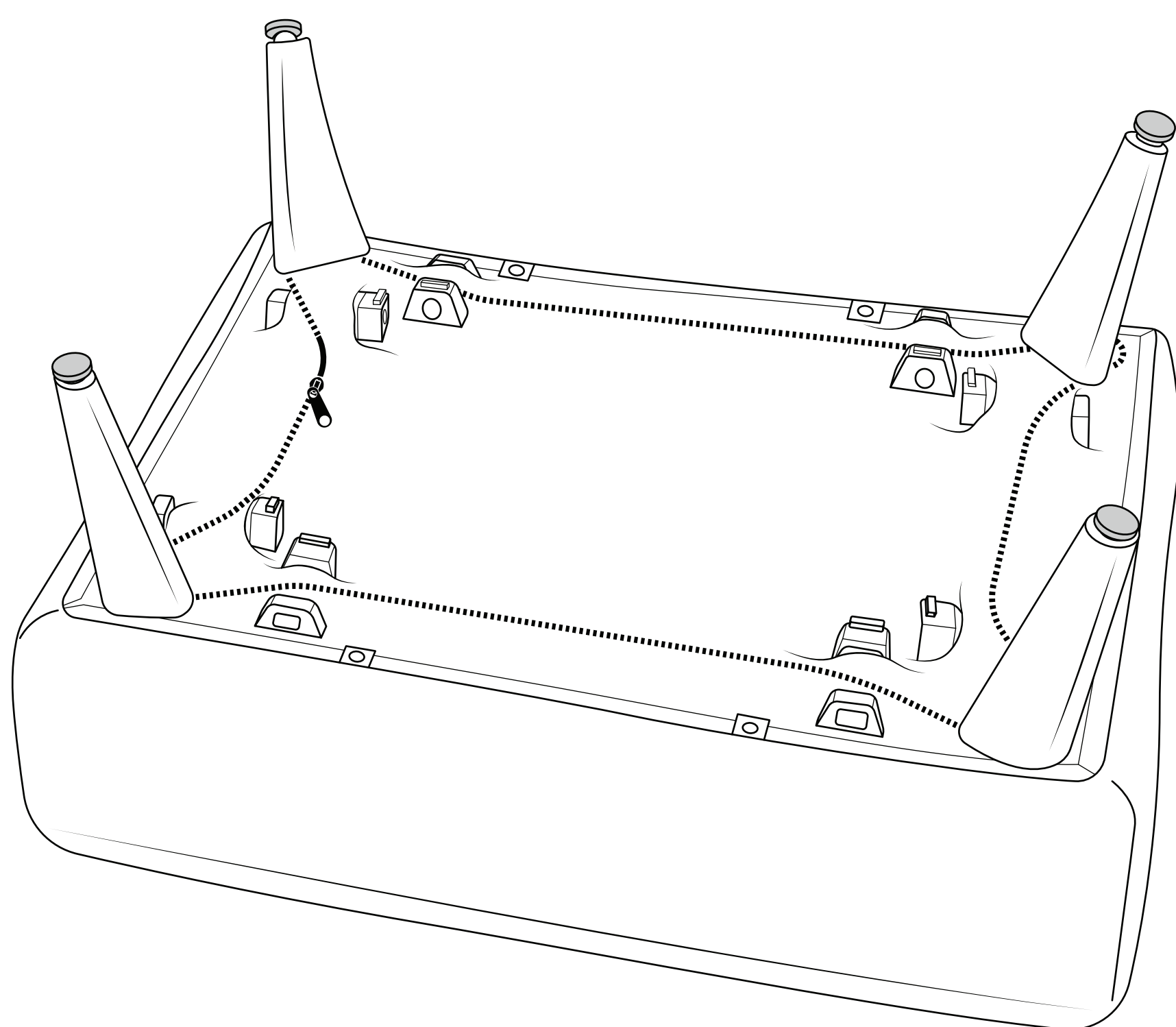

6 Rotate seat 90°

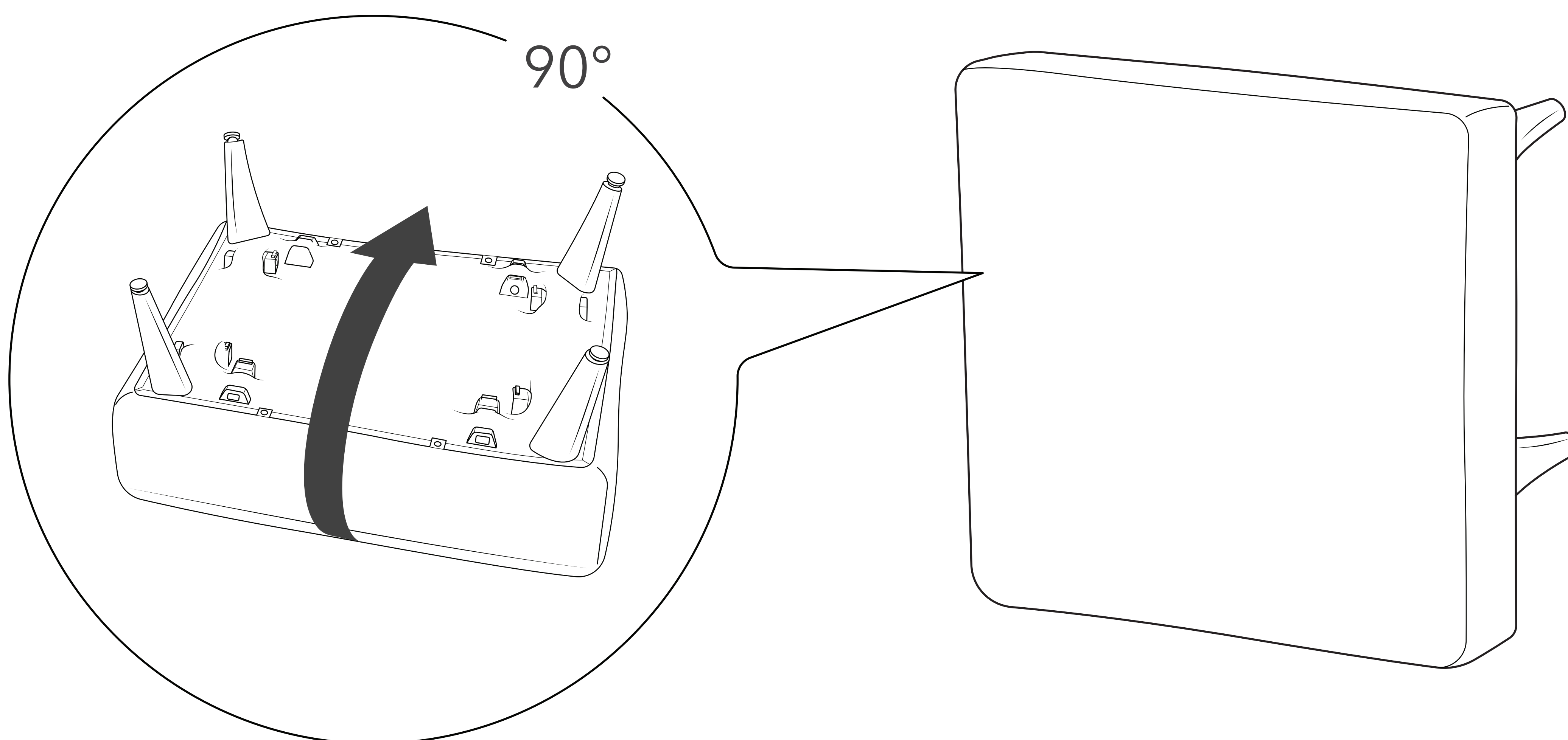

7

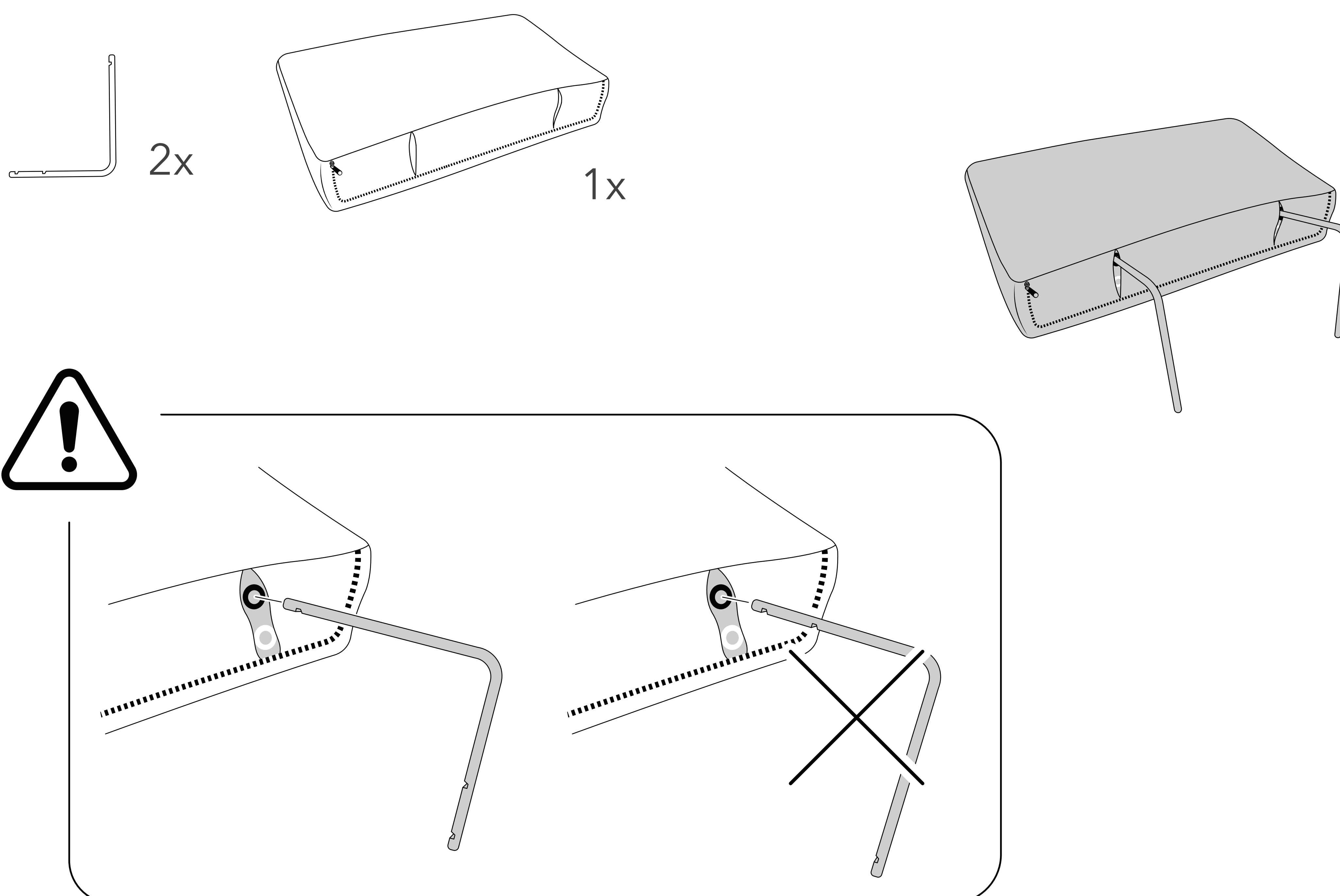
Insert L brackets into cushionInsert end with one groove into black hole

8

Attach cushion to seat A

Insert brackets into seat. Listen for the clicks.

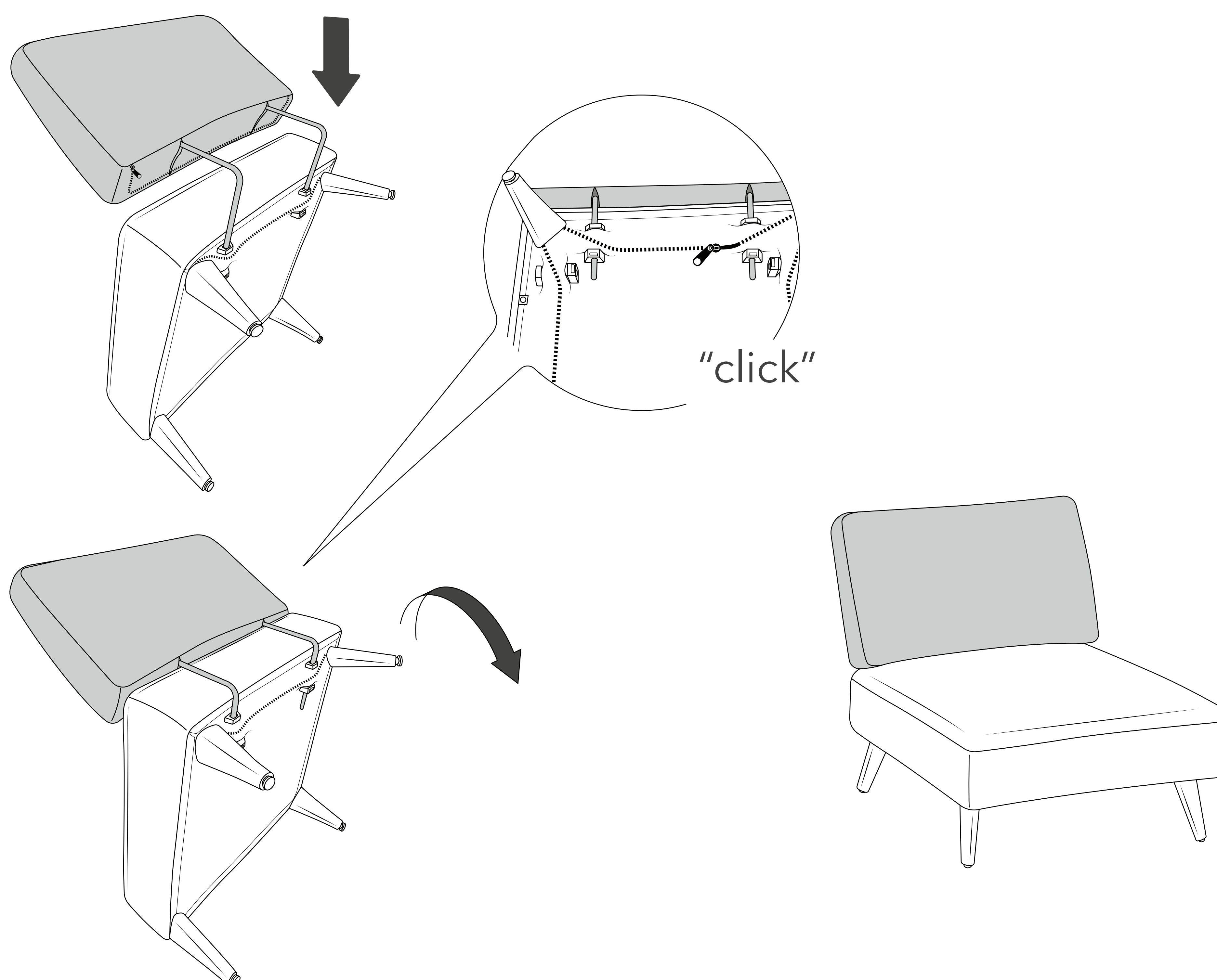

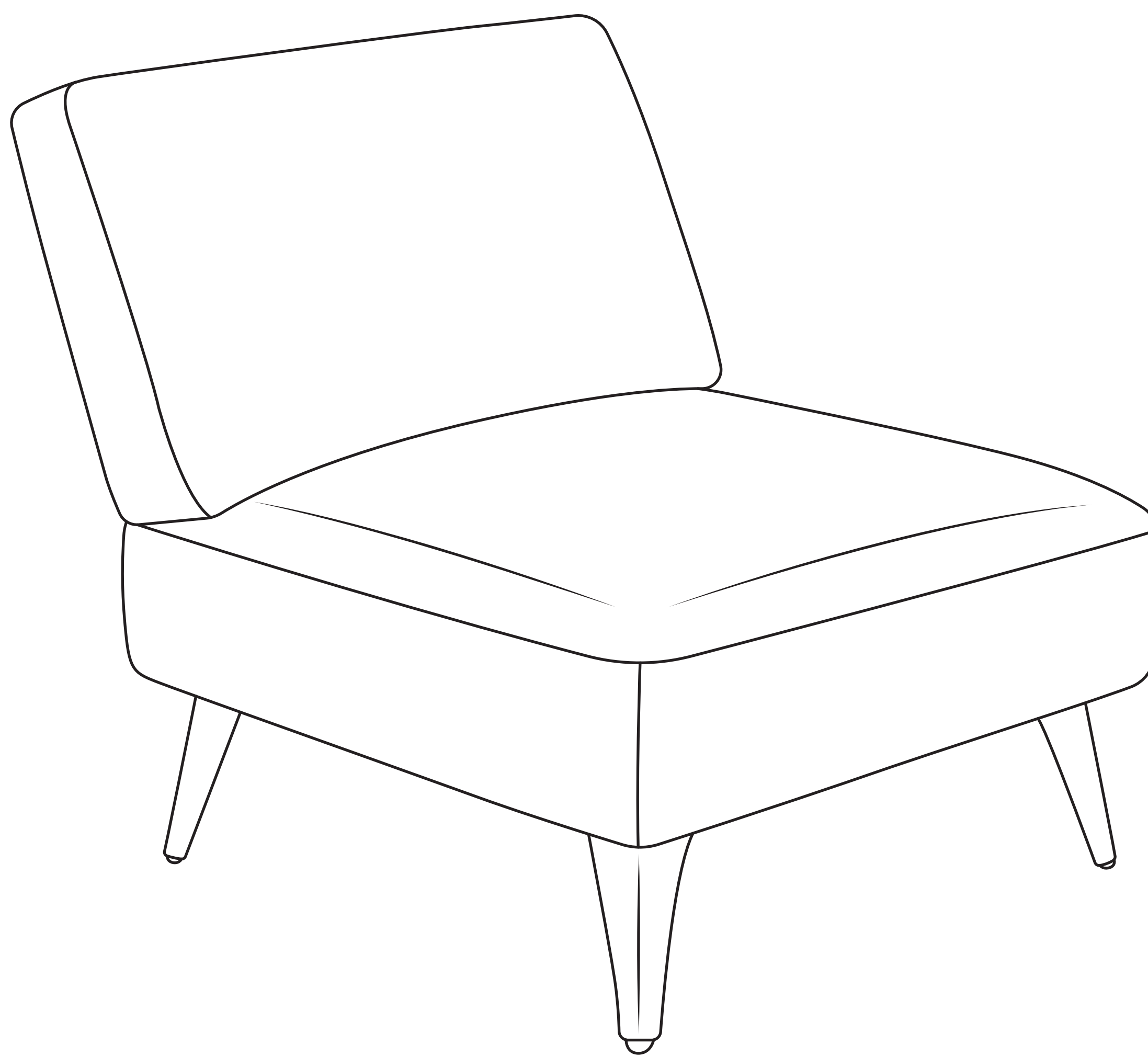

We're here to help

For help and support contact us live on chat or email us at support@wattleliving.com