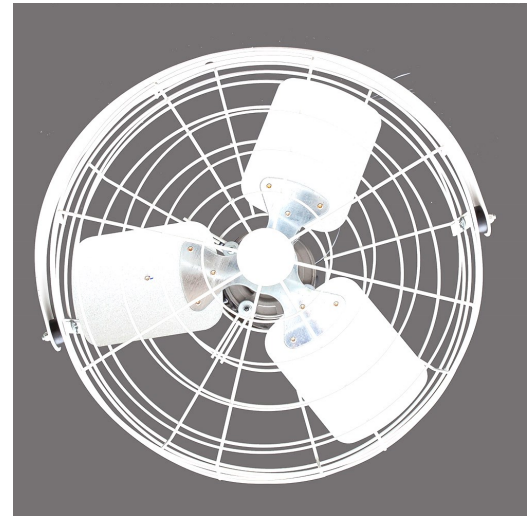
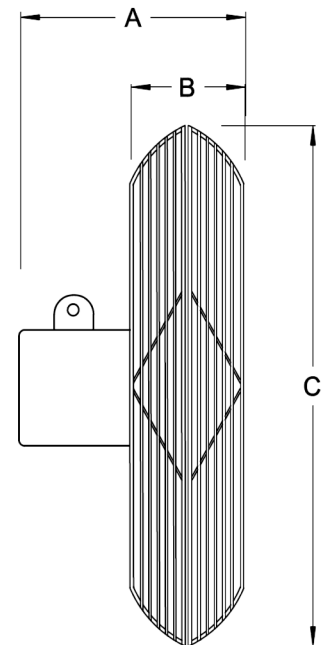

**Features:**

- Pre-Wired with 9ft cord, 115v or 230v molded plug
- Guards powder coated, not OSHA spaced. Mount at least 8ft high.
- Wide guard spacing allows for less air obstructions, greater efficiencies
- Motors
  - TEAO(IP55 rating)
  - Permanently sealed ball bearings
  - Permanent split capacitor
  - Class B insulation
  - Automatic thermal overload protection
  - UL recognized in US & Canada
- “C” style hanging mount included

**Specifications:**

Model #	Blade Dia.	HP	Spd	High CFM	High RPM	Volts	High Amps	Ph	Hz	DBs @ 7ft	Guard Color
18B4W3-W	18"	1/12	3	1850	1550	115	.9	1	60	54	White
18B4B3-W	18"	1/8	3	2050	1550	115	1.0	1	60	55	Black
20B4WV-W	20"	1/10	Var.	1980	1700	115	1.1	1	60	56	White
20B4WV-230W	20"	1/10	Var.	1980	1700	230	.5	1	60	56	White
20B4B2-45	20"	1/8	2	2370	1550	115	1.2	1	60	55	Black
20B4B3-W	20"	1/8	3	2370	1550	115	1.2	1	60	55	Black
20B4WV48-W	20"	1/3	Var.	4685	1700	115	3.5	1	60	64	White
20B4WV48-230W	20"	1/3	Var.	4685	1700	230	1.7	1	60	64	White
24B4WV-W	24"	1/3	Var.	5230	1700	115	3.5	1	60	62	White
24B4WV-W230	24"	1/3	Var.	5230	1700	230	1.7	1	60	62	White

**Shipping Information:**

Model #	Boxed Dims In.	Boxed Wt Lbs	Pallet Qtys	Pallet Dims In.	Pallet Wt Lbs	Dim A In.	Dim B In.	Dim C In.
18B4W3-W	22 x 22 x 9	16	40	48 x 48 x 88	680	8	5	21
18B4B3-W	21 x 21 x 7	18	48	48 x 48 x 88	904	7	5	20
20B4WV-W	24.5 x 23 x 13	22	28	48 x 48 x 95	646	11	6	23
20B4WV-230W	24.5 x 23 x 13	22	28	48 x 48 x 95	646	11	6	23
20B4B2-45	24 x 24 x 8	22	36	48 x 48 x 88	830	8	5.5	22
20B4B3-W	24 x 24 x 8	22	36	48 x 48 x 88	830	8	5.5	22
20B4WV48-W	24.5 x 23 x 13	30	24	48 x 48 x 90	760	12.5	6	23
20B4WV48-230W	24.5 x 23 x 13	30	24	48 x 48 x 90	760	12.5	6	23
24B4WV-W	30 x 30 x 16	34	20	60 x 60 x 85	720	14	6	26
24B4WV-W230	30 x 30 x 16	34	20	60 x 60 x 85	720	14	6	26