

# Option A - Installation Instructions

Bed Fly Conversion Kit

## Step 1. Configuring your Poles



Bird Beak Peg  
SKU: 773B

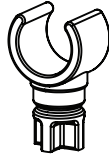

C-Clip  
SKU: 760A

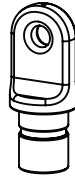

Bow End Insert  
19mm  
SKU: 791A



Bow End Insert  
23mm  
SKU: 792

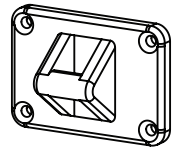

Bird Beak Plate  
SKU: 775B

### Starting Poles

Below are the 4 poles you will start with to complete one end of the camper.

#### Pole A 3pcs

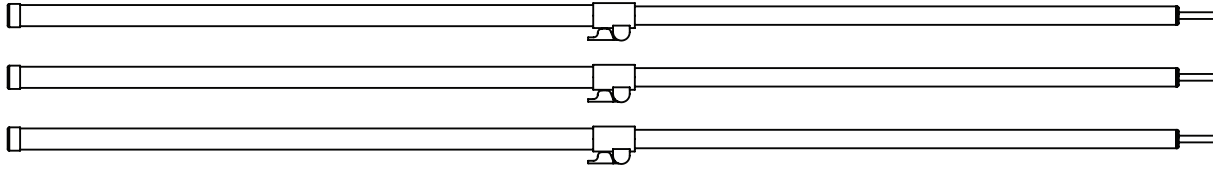

#### Pole B

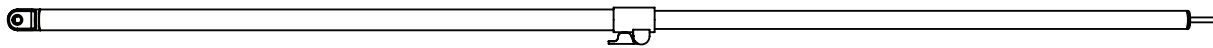

**Note:** Pole B will remain unmodified

1. We will start by modifying 1 x Pole A to produce Poles #1 and #2 (see page 4 for numbered pole references)

At the straight spigot end of the pole, measure and cut 150mm from the base of the spigot.

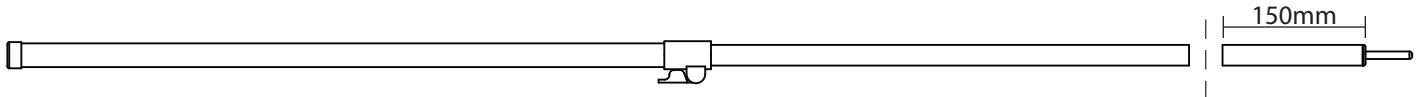

Into this short 150mm off-cut pole we will fit and secure a C-Clip, this will now complete pole #2. Pole #'s are as per reference image on page 4.

C-Clip  
SKU: 760A

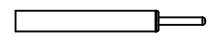

Pole #2 - Complete

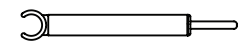

2. Now back to the same Pole A which we cut the 150mm length from in the previous step, we will now cut the ground foot off and then fit and secure a bow end insert into each end. This finished pole now becomes our pole #1.

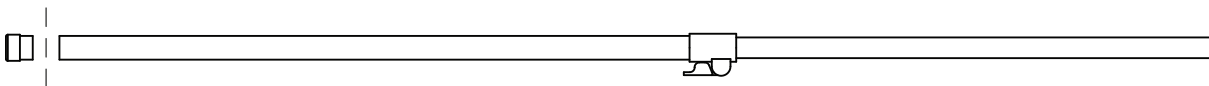

Bow End Insert  
23mm  
SKU: 792

Bow End Insert  
19mm  
SKU: 791A

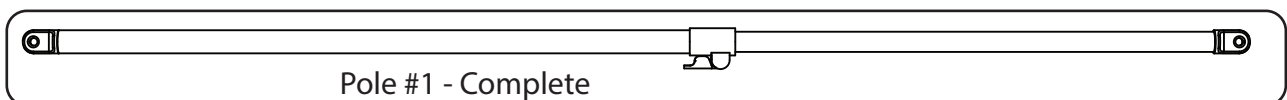

# Option A - Installation Instructions

Bed Fly Conversion Kit

3. We will now make the angled uprights, these are referred to as Poles 4a and 4b depending on which style of mounting you're using. Review the page titled "Common mounting options" before beginning. You will need to make 2 angled uprights for each end, to do so simply repeat the steps below appropriately.

Cut and remove the ground foot from an unmodified pole 'A'

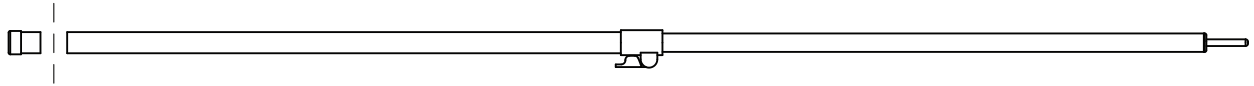

To create pole 4a, fit and secure a Bow End Insert at the end where the ground foot was removed.

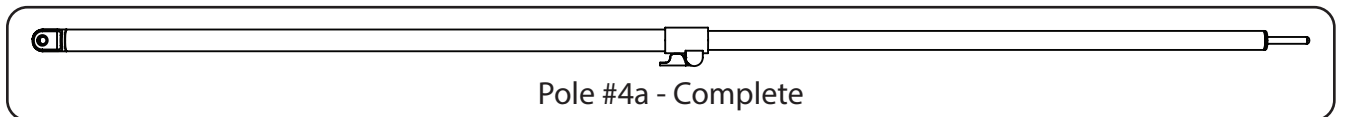
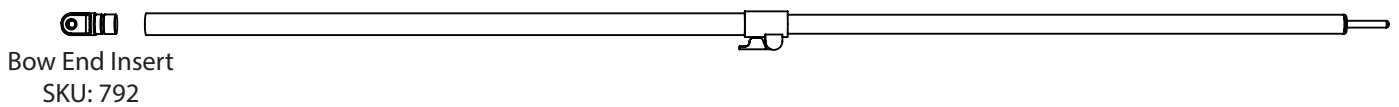

- OR -

To create pole 4b, fit and secure a Bird Beak Peg at the end where the ground foot was removed.

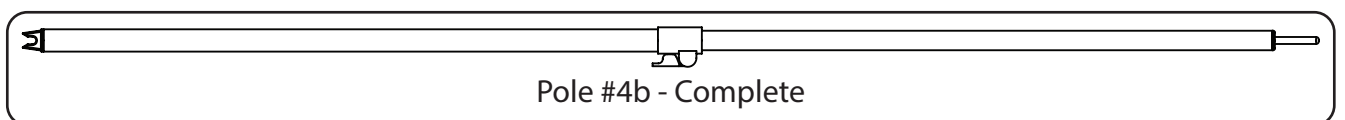
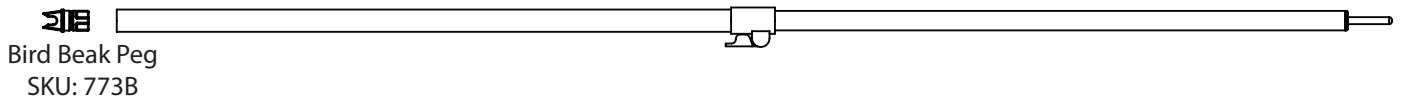

## Bird Beak Plates Mounting

*The below is only required where you have chosen Bird beak plates as a mounting option*

The bird beak plates are typically mounted on the rear bumper bar with 4 x self drilling screws or rivets (screws/rivets not supplied).

Typical install pictured on the right >

Note: Attach the bird beak plates as close to the ends of the bar as possible to minimise clashing with the sliding beds.



# Option A - Installation Instructions

Bed Fly Conversion Kit

## Step 2. Installing Bolts Mounting Hardware

Contents of 1 x Bolts Mounting Hardware Kit | SKU:BFCKHW02

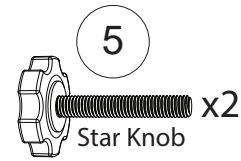
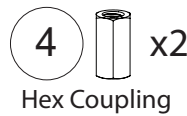
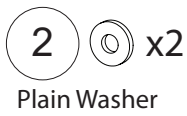

The steps below describe the installation of the bolts mounting hardware on one side only, you'll complete these steps twice for each end which you wish to use bolts mounting on.

### Step 1. Drill an 8.5mm hole at position (A)

**Tip 1:** When choosing where to drill the hole, ensure that you can get access to the rear of the planned hole with a spanner/socket so that you can adequately tighten the bolt in step 2.

**Tip 2:** Check the position of the proposed hole to ensure that your upright pole (pole 4) can reach the bed fly and also the mounting position without obstructing any side access hatches or clashing on pole carriers/stone guards.



The hole location pictured here may be different to your preferred location after reading tip 1 & 2 above.

### Step 2. Assemble Hardware as shown below

Through the hole which you have just drilled, thread the hex head bolt through from the rear and install the washer and plain hex nut. Tighten the hex nut before installing the coupling and tightening the coupling.

**Note:** Two types of M8 nuts are supplied in the kit. Ensure you use the **plain hex nut** at this point (not the nylon lock nut)

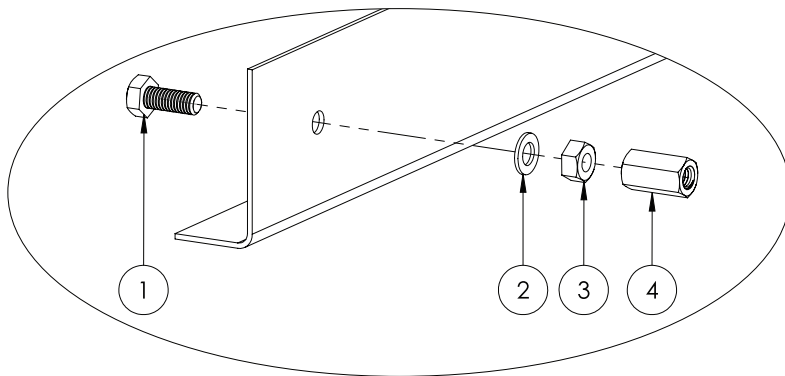

### Step 3. Assemble Star Knob and Lock Nut to Pole

Pass the Star knob through the bow end insert of the upright poles and secure it in place using the nylon lock nut.

**Note:** Two types of M8 nuts are supplied in the kit. Ensure you use the **nylon lock nut** at this point

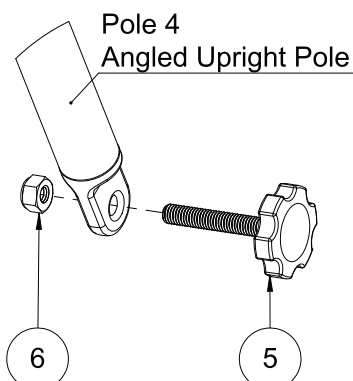

The Nylon lock nut can be identified as it has a small piece of nylon on one face of the nut



Plain Nut



Nylon Lock Nut

# Option A - Installation Instructions

Bed Fly Conversion Kit

## Step 3. Erecting the bed fly

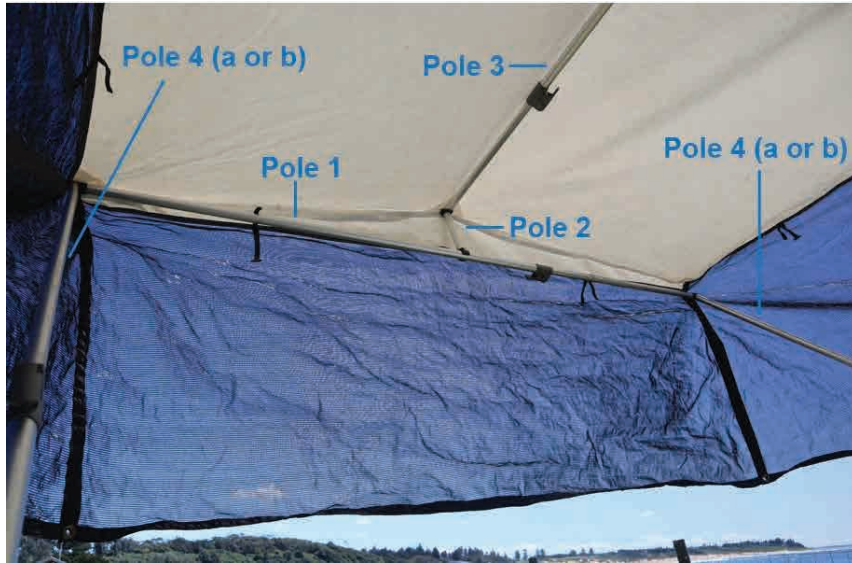

The numbered poles above match the pole #'s used throughout this manual.

1. Begin by securing the two angled uprights [Pole 4 (a or b)] into their appropriate mounting positions on the trailer.



Pole 4a and bolts mounting



Pole 4b and bird beak plate mounting

2. Pass the straight spigot on pole 4 through the ends of the horizontal spreader bar (Pole 1) and then through the eyelet on the bed fly. Complete this again for the second Pole 4.

4. Connect pole 3 to the van using the bent spigot and roof rafter bracket.

3. Extend the horizontal spreader bar (pole 1) to remove slack in the bed fly.

5. Clip Pole 2 onto the horizontal spreader bar (pole 1) and now pass the spigot on pole 2 through the bow end insert on pole 3.

6. Extend the roof rafter pole (pole 3) comfortably to take up any slack. Extend both the angled uprights before winding the roof up