

# Wood Rod Hanger Threaded Rod Anchor System

The wood rod hanger from Simpson Strong-Tie is a one-piece fastening system for suspending 1/4" or 3/8" threaded rod. Vertical rod hangers are designed to suspend threaded rod in overhead applications from wood members. Horizontal rod hangers are available for applications requiring installation into the side of joists, columns and overhead members. Both rod hangers provide attachment points for use in pipe hanging, fire protection, electrical conduit and cable-tray applications. Recommended for use in dry, interior, non-corrosive environments only.

**Features**

- Threaded anchors for rod-hanging applications in wood
- Suitable for installation horizontally or vertically in overhead applications
- No predrilling required
- Type-17 point provides for fast starts

**Codes:** FM 3058980;  
UL File Ex3605

**Material:** Carbon steel

**Coating:** Zinc plated



**RWH**  
**Horizontal Wood**  
**Rod Hanger**



**RWV**  
**Vertical Wood**  
**Rod Hanger**

Wood Rod Hangers

| Rod Size (in.) | Size (in.)   | Model No. | Application | Point Style | Quantity |        |
|----------------|--------------|-----------|-------------|-------------|----------|--------|
|                |              |           |             |             | Box      | Carton |
| 1/4-20         | 1/4 x 2      | RWV25200  | Vertical    | Type 17     | 25       | 250    |
| 3/8-16         | 1/4 x 1      | RWV37100  |             |             |          |        |
| 3/8-16         | 1/4 x 2      | RWV37200  |             |             |          |        |
| 3/8-16         | 5/16 x 2 1/2 | RWV37212  | Horizontal  | Type 17     | 25       | 250    |
| 1/4-20         | 1/4 x 1      | RWH25100  |             |             |          |        |
| 3/8-16         | 1/4 x 2      | RWH37200  |             |             |          |        |
| 3/8-16         | 5/16 x 2 1/2 | RWH37212  |             |             |          |        |



**Type-17 point for**  
**use in wood**

# Wood Rod Hanger Design Information — Wood



## Tension Wood Rod Hanger Allowable Loads

| Model No. | Rod Size (in.) | Size (in.) | Minimum Edge Distance (in.) | Minimum End Distance (in.) | Minimum Spacing (in.) | Allowable Tension Loads (lb.) |     |     | Pipe Size (in.) |             |
|-----------|----------------|------------|-----------------------------|----------------------------|-----------------------|-------------------------------|-----|-----|-----------------|-------------|
|           |                |            |                             |                            |                       | DF                            | SP  | SPF | UL Approval     | FM Approval |
| RWW25200  | ¼-20           | ¼ x 2      | ¾                           | 2¾                         | 2¾                    | 375                           | 435 | 310 | —               | —           |
| RWW37100  | ¾-16           | ¼ x 1      |                             |                            |                       | 155                           | 190 | 105 | —               | —           |
| RWW37200  | ¾-16           | ¼ x 2      |                             |                            |                       | 375                           | 435 | 310 | 3               | —           |
| RWW37212  | ¾-16           | 5/16 x 2½  |                             | 605                        | 590                   | 495                           | 4   | 4   |                 |             |

1. Load values are based on full shank penetration into the wood member.
2. Allowable loads may be increased by CD = 1.6 for wind or earthquake.
3. Allowable loads are based on a factor of safety of 5.0.
4. Mechanical and plumbing design codes may prescribe lower allowable loads. Verify with local codes.
5. Allowable loads are based on Douglas Fir-Larch (DF), Southern Pine (SP) and Spruce-Pine-Fir (SPF) wood members having a minimum specific gravity of 0.50, 0.55 and 0.42, respectively.



## Shear Wood Rod Hanger Allowable Loads

| Model No. | Rod Size (in.) | Size (in.) | Minimum Edge Distance (in.) | Minimum End Distance (in.) | Minimum Spacing (in.) | Allowable Shear Loads (lb.) |     |     | Pipe Size (in.) |
|-----------|----------------|------------|-----------------------------|----------------------------|-----------------------|-----------------------------|-----|-----|-----------------|
|           |                |            |                             |                            |                       | DF                          | SP  | SPF | UL Approval     |
| RWH25100  | ¼-20           | ¼ x 1      | 1                           | 2¾                         | 2¾                    | 110                         | 135 | 85  | —               |
| RWH37200  | ¾-16           | ¼ x 2      | 2½                          |                            |                       | 240                         | 225 | 330 | 3               |
| RWH37212  | ¾-16           | 5/16 x 2½  |                             |                            | 3¼                    | 3¼                          | 230 | 265 | 240             |

1. Load values are based on full shank penetration into the wood member.
2. Allowable loads may not be increased for short-term loading.
3. Allowable loads are based on a factor of safety of 5.0.
4. Mechanical and plumbing design codes may prescribe lower allowable loads. Verify with local codes.
5. Allowable loads are based on Douglas Fir-Larch (DF), Southern Pine (SP) and Spruce-Pine-Fir (SPF) wood members having a minimum specific gravity of 0.50, 0.55 and 0.42, respectively.

## Installation Sequence

1. Attach RND62 nut driver to a drill.
2. Insert rod hanger into the RND62 nut driver.
3. Using rotation-only mode, drive rod hanger until it contacts the surface. Do not over-tighten. RND62 nut driver will disengage the rod hanger at the appropriate depth to prevent over-driving.
4. Insert threaded rod. Minimum thread engagement should be equal to the nominal diameter of the threaded insert.

## Vertical Wood Rod Hanger

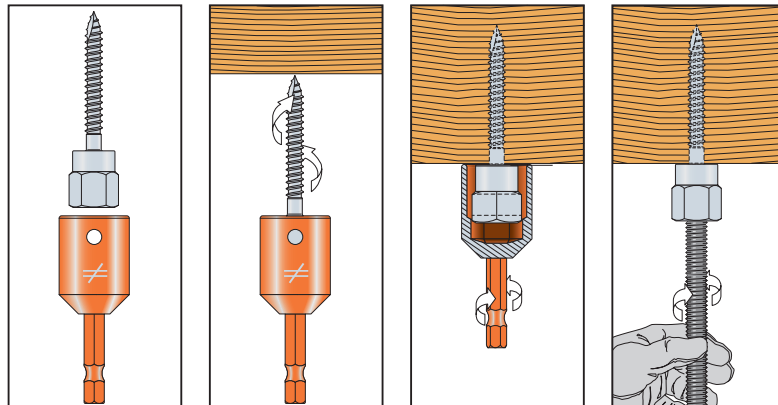

## Horizontal Wood Rod Hanger

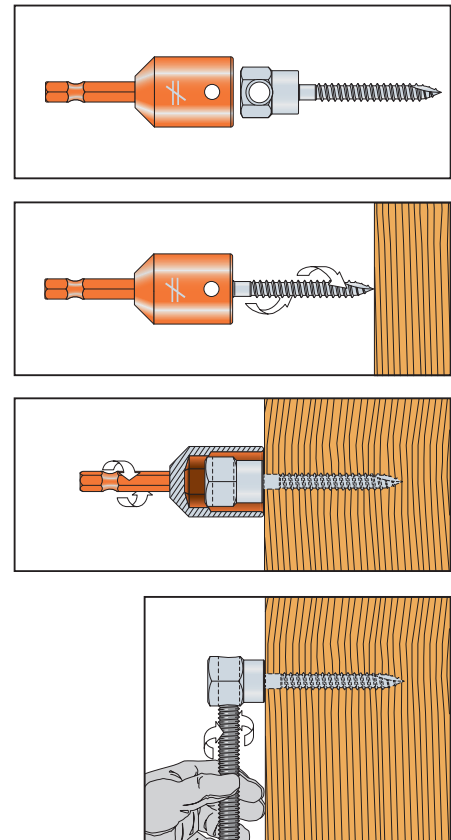

\*See p. 14 for an explanation of the load table icons.