

# Options for Multiple-Beam, Bolted Column Caps

## Instructions for Ordering Multi-Beam Column Caps:

- Choose column cap style.** Look at the configuration of the column caps to determine which style column cap you require. If you don't know which style column cap is required, refer to your plans to determine the correct configuration.
- Determine column cap dimensions.** Fill in the dimensions of the column cap on the worksheet. If you don't know the dimensions of the column cap, go directly to the Beam and Post Dimensions section.
- Provide beam and post dimensions.** The Beam and Post Dimensions section of this worksheet is required. Fill in all applicable dimensions in actual inches, not as nominal dimensions.
- Determine beam orientation.** Refer to your plans or check the configuration of the column cap you selected in order to determine the orientation of the beam. Check the box for the beam orientation that best describes your beam configuration: Beam B flush at bottom of Beam A; Beam B flush at both the top and bottom of Beam A; or Beam B flush at top of Beam A.
- Check the box for the required style and strap orientation.**
- Select finish.** Standard finish is Simpson Strong-Tie® gray paint, available in HDG (specify HDG).
- Place order.** Contact Simpson Strong-Tie for ordering information.

## Multiple Beam Column Caps

ECCLL     ECCLR

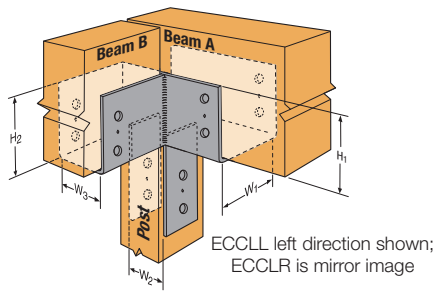

CCC

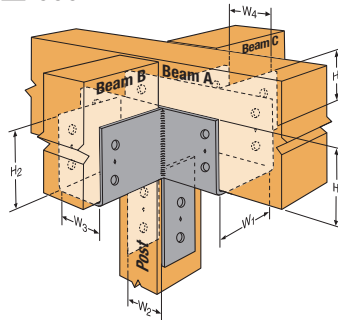

CCT

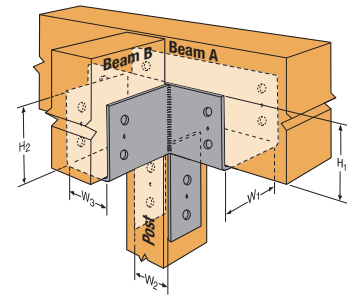

### Beam Dimensions:

Provide dimensions in actual inches (not nominal dimensions).

Beam A: Width \_\_\_\_\_ Height \_\_\_\_\_

Beam B: Width \_\_\_\_\_ Height \_\_\_\_\_

Beam C: Width \_\_\_\_\_ Height \_\_\_\_\_

### Post Dimensions:

Post Size \_\_\_\_\_

If post is not square, specify width of post between the straps \_\_\_\_\_

### Column Cap Dimensions:

$W_1 =$  \_\_\_\_\_  $H_1 =$  \_\_\_\_\_

$W_3 =$  \_\_\_\_\_ (See Wood Construction Connectors catalog for standard  $H_1$  dimension)

$W_4 =$  \_\_\_\_\_  $H_2 =$  \_\_\_\_\_

### Post Dimensions:

$W_2 =$  \_\_\_\_\_  $H_3 =$  \_\_\_\_\_

$W_1, W_3$  and  $W_4$  will typically be  $\frac{1}{8}$ "– $\frac{1}{4}$ " greater than beam widths.  $W_2$  will typically be  $0$ "– $\frac{1}{8}$ " greater than post width.

### Orientation of Beam Height

Refer to your plans to determine the correct orientation of your beam. Check the box for the orientation that best describes your beam configuration and ensure that the column cap dimensions are as follows:

- Side Beam Flush at Top and Bottom     Side Beam Flush at Top — Extends Below Main Beam     Side Beam Flush at Bottom — Extends Above Main Beam

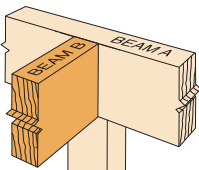

Column Cap Dimensions:  $H_2 = H_1$

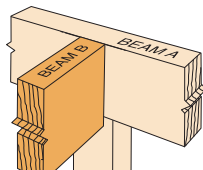

Column Cap Dimensions:  $H_2 > H_1$

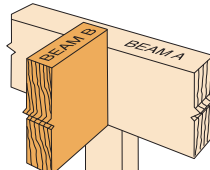

Column Cap Dimensions:  $H_2 = H_1$

Standard Strap Orientation

Straps Rotated\*  
 No Straps

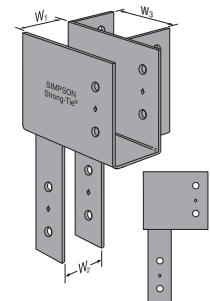
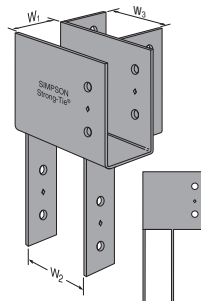

Column Cap Dimensions:  $W_2 \leq W_1$

\*Not available for all models of column caps.

For allowable loads, refer to the current Wood Construction Connectors catalog.



Visit [strongtie.com](http://strongtie.com) to use our free Post-to-Beam Selector app.

# Options for Multiple-Beam, Bolted Column Caps

Model	W <sub>1</sub> (in.)	W <sub>2</sub> (in.)	W <sub>3</sub> (in.)	H <sub>1</sub> (in.)	H <sub>2</sub> (in.)	Side Stirrup Direction
ECCL3¼-4	3¼	3⅝	Specify	6½	Specify	Specify Left or Right
ECCL3¼-6	3¼	5½				
ECCL44	3⅝	3⅝	3⅝	4	6½	Left
ECCL444	3⅝	3⅝				
ECCL444TC	3⅝	3⅝				
ECCLR444	3⅝	3⅝				
ECCLR444TC	3⅝	3⅝	Specify	6½	Specify	Specify Left or Right
ECCL46	3⅝	5½				
ECCL464	3⅝	5½	3⅝	6½	6½	Left
ECCLR464	3⅝	5½				
ECCL5¼-4	5¼	3⅝	Specify	8	Specify	Specify Left or Right
ECCL5¼-6	5¼	5½				
ECCL5¼-8	5¼	7½				
ECCL64	5½	3⅝				
ECCL66	5½	5½	5½	6½	6½	Left
ECCL666	5½	5½				
ECCLR666	5½	5½	Specify	8	Specify	Specify Left or Right
ECCL68	5½	7½				
ECCL7⅛-4	7⅛	3⅝	Specify	8	Specify	Specify Left or Right
ECCL7⅛-6	7⅛	5½				
ECCL7⅛-7⅛	7⅛	7⅛				
ECCL76	6⅞	5½				
ECCL77	6⅞	6⅞				
ECCL78	6⅞	7½				
ECCL86	7½	5½				
ECCL88	7½	7½				

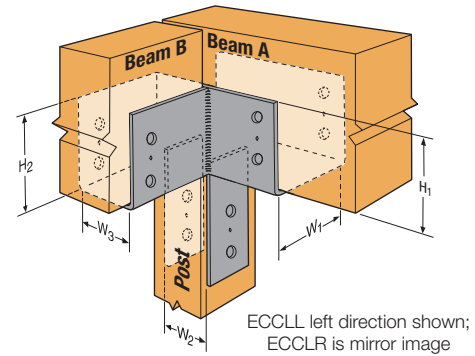

ECCL / ECCLR

Model	W <sub>1</sub> (in.)	W <sub>2</sub> (in.)	W <sub>3</sub> (in.)	W <sub>4</sub> (in.)	H <sub>1</sub> (in.)	H <sub>2</sub> (in.)	H <sub>3</sub> (in.)
CCC3¼-4	3¼	3⅝	Specify	Specify	6½	Specify	Specify
CCC3¼-6	3¼	5½					
CCC44	3⅝	3⅝					
CCC46	3⅝	5½					
CCC5¼-4	5¼	3⅝					
CCC5¼-6	5¼	5½					
CCC5¼-8	5¼	7½					
CCC64	5½	3⅝					
CCC66	5½	5½					
CCC68	5½	7½					
CCC7⅛-6	7⅛	5½					
CCC7⅛-7⅛	7⅛	7⅛					
CCC76	6⅞	5½					
CCC78	6⅞	7½					
CCC86	7½	5½					
CCC88	7½	7½					

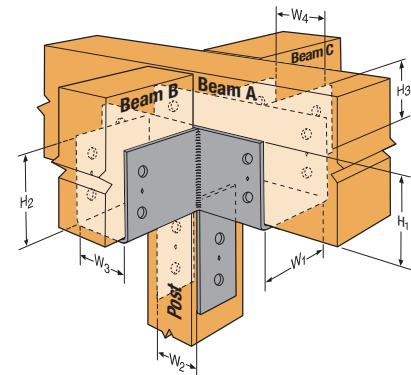

CCC

Model	W <sub>1</sub> (in.)	W <sub>2</sub> (in.)	W <sub>3</sub> (in.)	H <sub>1</sub> (in.)	H <sub>2</sub> (in.)
CCT3¼-4	3¼	3⅝	Specify	6½	Specify
CCT3¼-6	3¼	5½			
CCT44	3⅝	3⅝			
CCT46	3⅝	5½			
CCT5¼-4	5¼	3⅝			
CCT5¼-6	5¼	5½			
CCT5¼-8	5¼	7½			
CCT64	5½	3⅝			
CCT66	5½	5½			
CCT68	5½	7½			
CCT7⅛-4	7⅛	3⅝			
CCT7⅛-6	7⅛	5½			
CCT7⅛-7⅛	7⅛	7⅛			
CCT76	6⅞	5½			
CCT77	6⅞	6⅞			
CCT78	6⅞	7½			
CCT86	7½	5½			
CCT88	7½	7½			

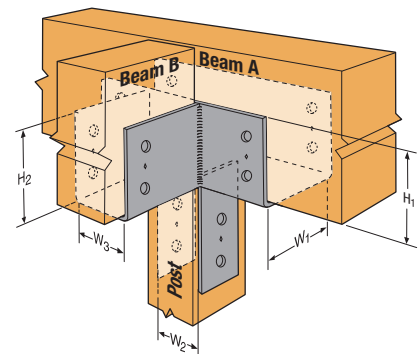

CCT

This technical bulletin is effective until December 31, 2023, and reflects information available as of December 1, 2021. This information is updated periodically and should not be relied upon after December 31, 2023. Contact Simpson Strong-Tie for current information and limited warranty or see [strongtie.com](http://strongtie.com).