

Wireless TV Speaker

Easy Setup Guide



Scan the QR code for an easy step by step video guide.

Accessories

- Wireless Speaker
- Transmitter Base
- AC Adapter
- Optical Cable
- 3.5mm Cable
- 3.5mm/RCA Cable Adapter

For support visit: www.audiorange.com/spk-1000fm/support



Important Safety Instructions

Please read these safety instructions carefully before using your AudioRange SPK-1000FM

- This device is intended for home and personal use only.
- Keep the device dry and away from water. Water may damage the device.
- Do not open the unit or battery. Opening the battery compartment voids this product's warranty.
- The wireless TV speakers use a lithium-ion battery. Do not burn or place used batteries/devices in household trash.
- Do not pull on the cord to unplug this device, doing so may damage the cord.
- The device should not be used if damaged or malfunctioning.
- Make sure the device is unplugged when cleaning.

WARNING: Consult your doctor or physician if you have a pacemaker before using

Set-up Preparations

Plug the AC adapter into the base. The base's front power indicator light will turn on once it's connected.

Place the wireless speaker on the base.

A red LED will flash as the speaker charges.

Allow at least 6 hours to charge.

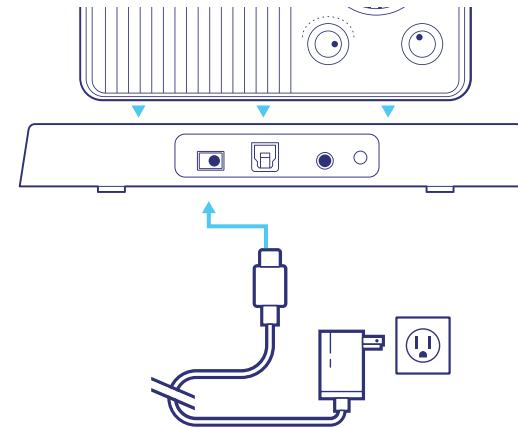

Locate audio connections on the back or side of your TV.

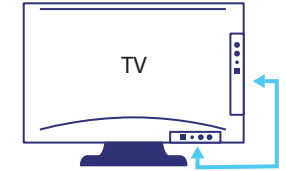

 If you are using the 3.5mm headphone connection please start with **STEP 1a.**

 If you are using the 3.5mm headphone connection with the RCA adapter please start with **STEP 1a.**

 If you are using Optical connection please start with **STEP 1b.**

STEP 1a:

Turn on TV.

Option 1: Plug the 3.5mm in-line jack into the TV. Then plug the opposite end into the base.

Option 2: If you are using the RCA connections, begin by plugging in the 3.5mm in-line jack into the back of the transmitter. Next, connect the RCA adapter to the 3.5mm in-line and then plug the red and white RCA connections into their matching ports on the TV.

Once the desired connection is made, proceed to **STEP 2**.

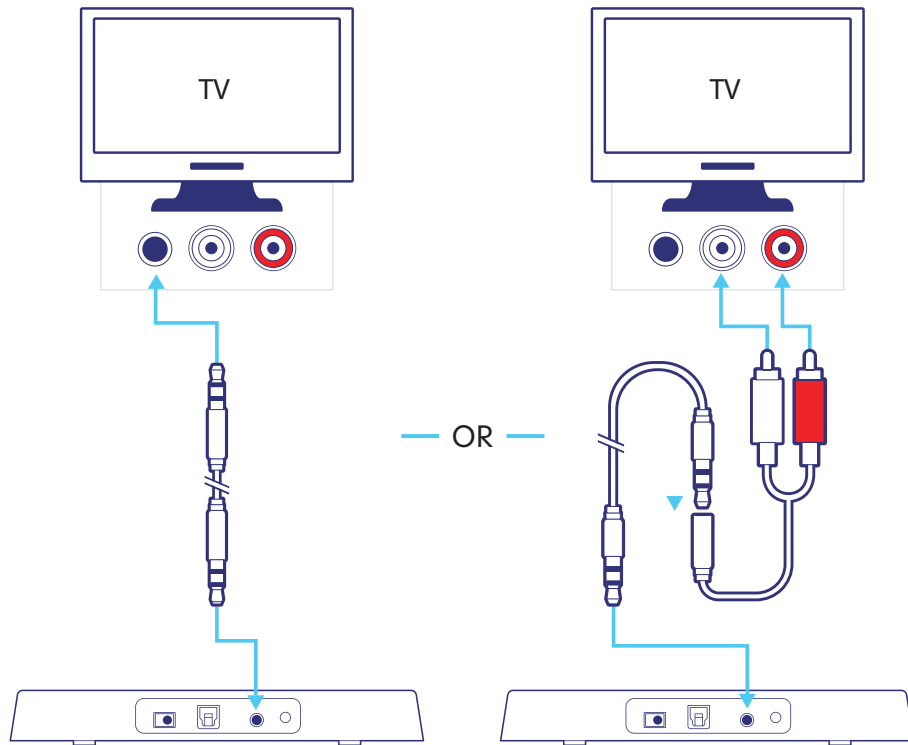

STEP 1b:

Turn on TV.

Plug the optical cable* into the TV and base.

**Remove plastic protective tips at both ends of cord.*

Once the Optical Cable is plugged in, proceed to **STEP 2**.

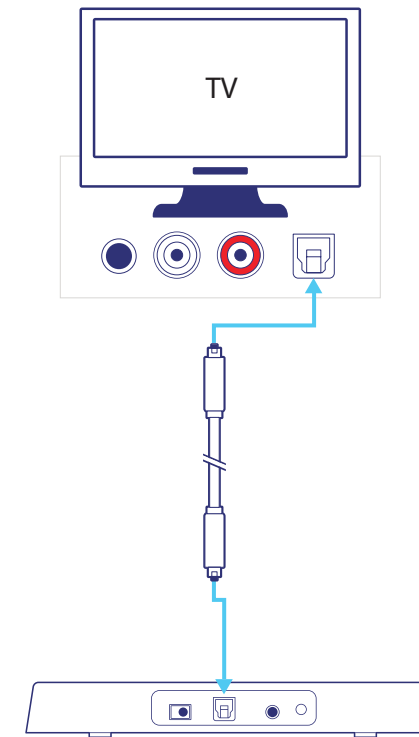

STEP 2

Turn on the wireless speaker by rotating the on/off volume control knob on the front of the speaker.

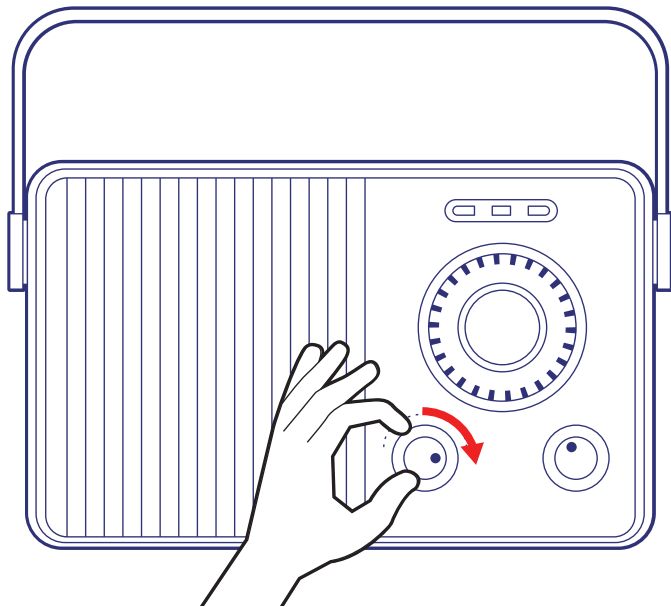

STEP 3

Rotate the mode switch to 2.4G on the front of the speaker to connect to the TV.

Once the indicator light is on, proceed to Step 4.

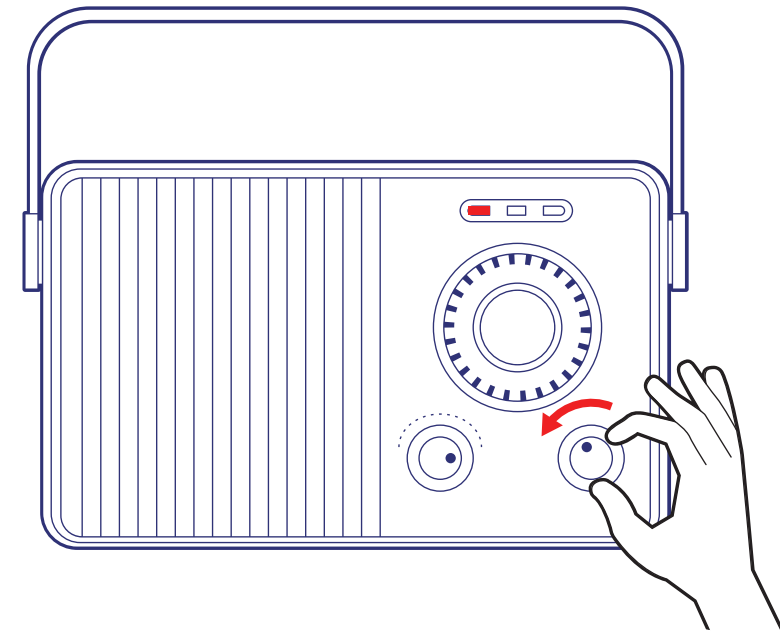

STEP 4

You have now successfully set up your Audiorange SPK-1000FM.

If you cannot hear any sound:

- Increase the volume on the wireless speaker with the on/off volume control knob
- Increase the volume on the TV
- Check that your TV's audio settings are set to external speaker

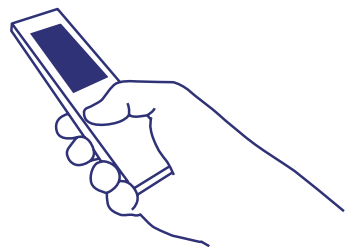
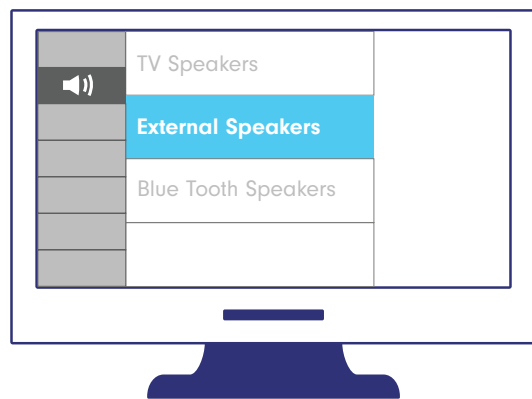

IMPORTANT: If you cannot access your TV's audio settings, please refer to your TV manual for help.

Product Details

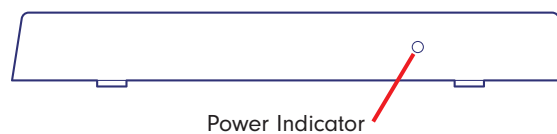
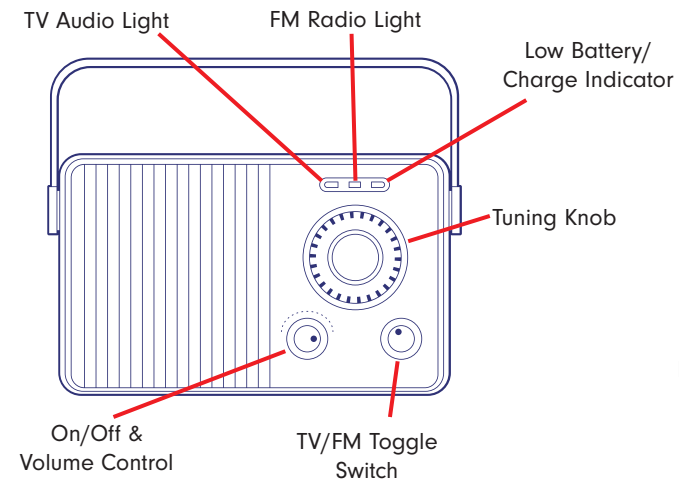

Receiver

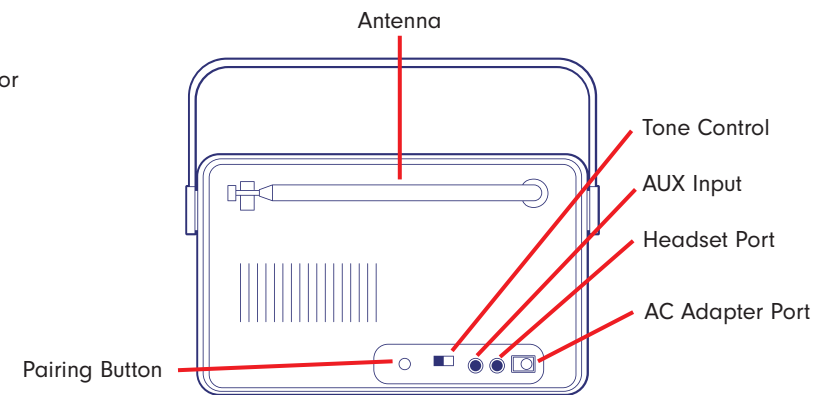

Transmitter

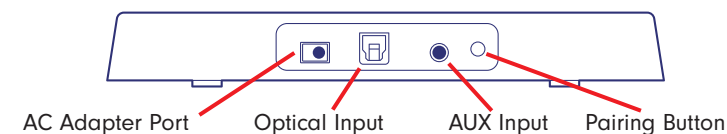

How to Use

Turning the Speaker on/off

Rotate the on/off volume control knob to the on position.

The wireless audio transmission or FM mode indicator light will turn on, depending on the mode selected.

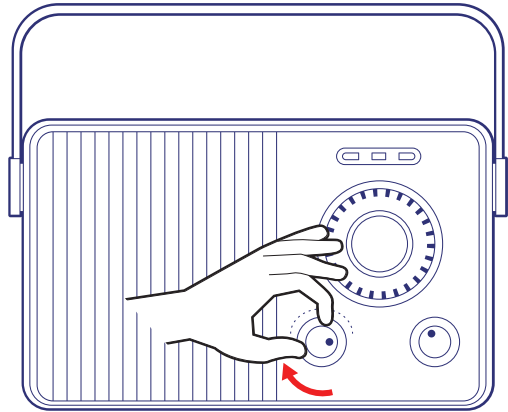

On/Off &
Volume Control

Adjusting the Volume

Rotate the on/off volume control knob toward the + icon to make the volume louder.

Turn the knob towards the - icon to make the volume quieter.

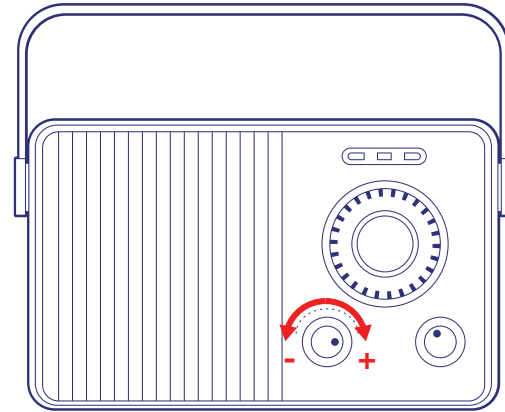

On/Off &
Volume Control

Recharging the Speaker

Place the speaker on top of the base, and make sure it is lined up properly. The charging indicator light will blink while it's charging.

When fully charged, the speaker will have up to 8 hours of usage time.

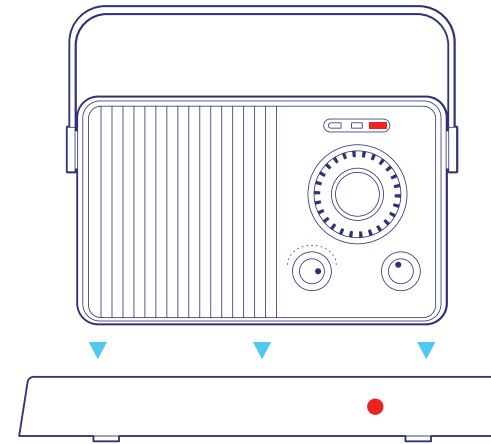

Power Indicator

Setting Tone Control

You can set the tone control to a position that allows you to enhance the audio. Turn the tone adjustment on the back of the speaker to TV to better understand dialog, or to music for hi-fi music listening.

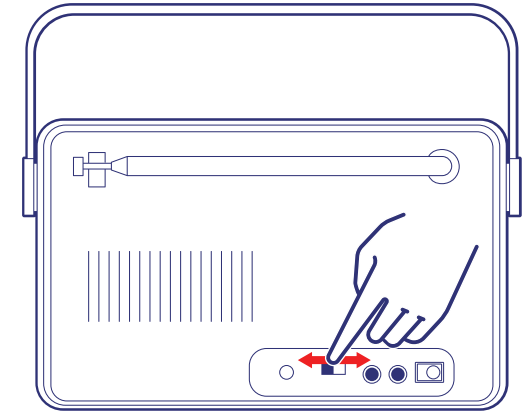

Music/TV
Tone Control

Connecting Headphones

Plug your headphones into the jack with the headphone icon, located on the back of the speaker.

No sound will play from the speaker. Adjust the headphone volume by rotating the on/off volume control knob.

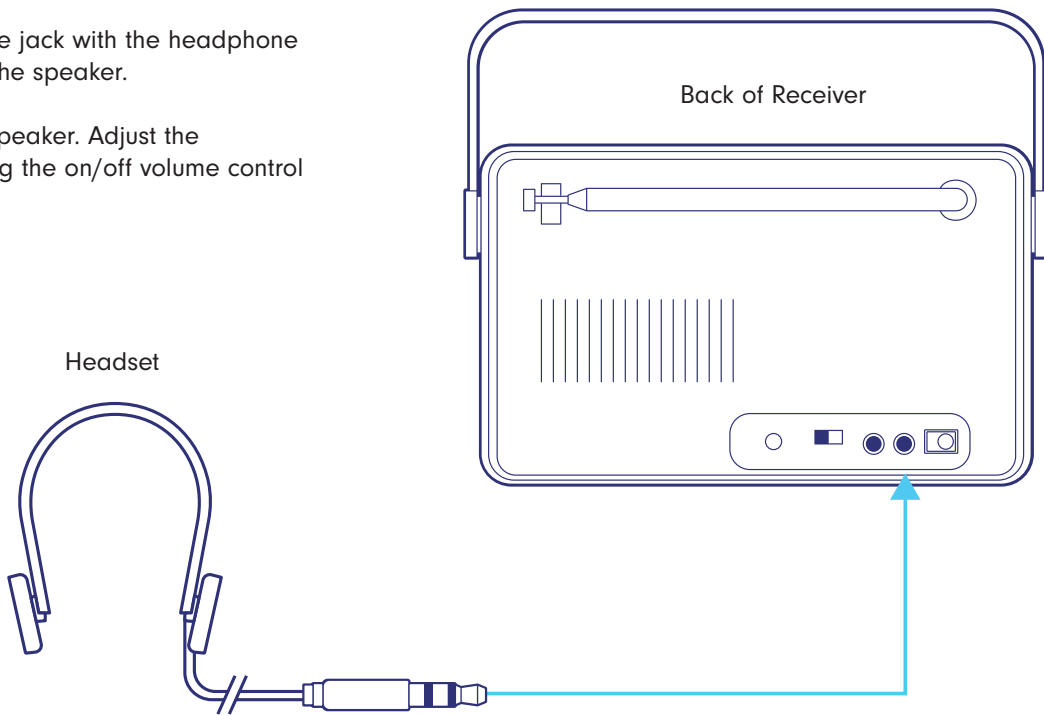

Switching to FM mode

You can quickly disconnect the speaker from your TV's audio and switch to FM mode. Start by rotating the on/off volume control knob to on and adjust the volume.

Rotate the mode switch to FM mode, and the FM mode indicator light on the front of the speaker will turn on.

Detach the FM pull rod antenna located on the back of the speaker, and pull on the top of the antenna to elongate it.

Tuning the radio

Rotate the tuning knob on the front of the speaker to select your favorite FM radio station.

IMPORTANT: The FM Radio's audio quality is dependent on outside factors such as signal strength, signal clarity, and weather. For a stronger signal it is recommended to place the radio near a window.

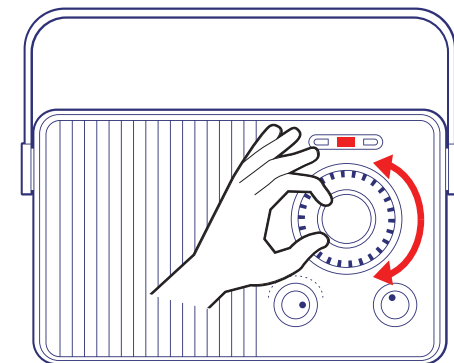
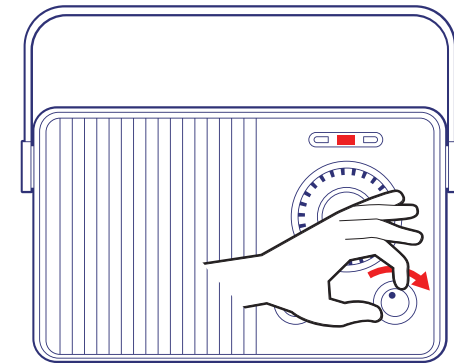

Pairing the Receiver

Press and hold the pairing button located on the bottom back of the speaker for 5 seconds, until the 2.4G indicator light starts blinking.

Press and hold the pairing button on the back of the base until the power indicator starts blinking. The base should pair with the speaker within 2 seconds. Once paired, the 2.4G indicator light on the new speaker will stop blinking and audio will play within 5 seconds.

It may take up to 20 seconds to pair.

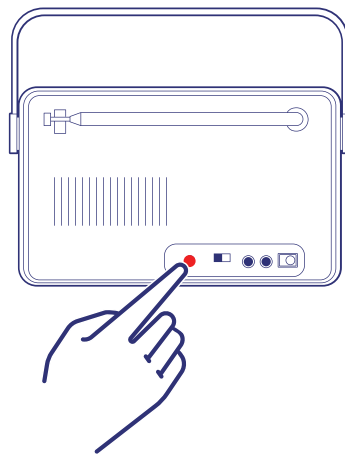

Pairing Buttons

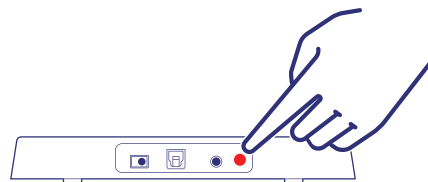

Pairing Additional Receivers

Add up to 50 speakers to work with your base. Each receiver must be paired with the base and fully charged. Connect your current speaker to the base and play audio through the speaker. Turn the additional speaker on while audio is playing on the original speaker, following step 2.

Follow the previous pairing steps used to pair the original receiver and repeat these steps for additional speakers or if a new speaker doesn't pair successfully.

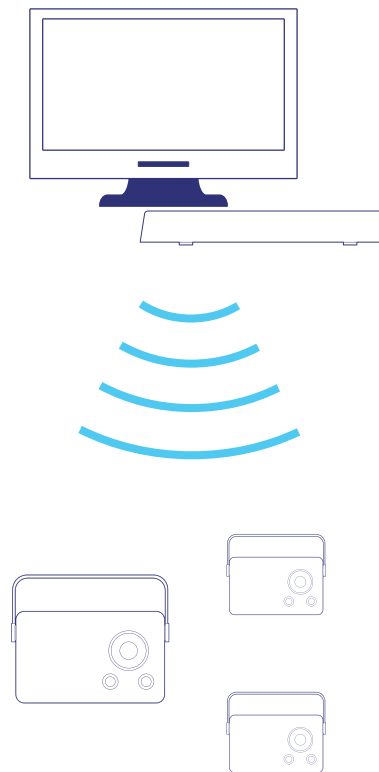

Trouble-Shooting

No Sound/Low Sound

- Make sure volume is turned up on the TV.
- Make sure cables are plugged in appropriately to the back of base and TV. The power indicator on the base will light up if the AC adapter is properly connected.
- Refer to steps 1a or 1b. Check that the dock is switched to the correct mode, 2.4G or FM.
- The audio is being outputted by the TV. Refer to step 4 to make sure TV audio is set to external speaker.
- Make sure the speaker is fully charged. The low battery/charging indicator light will blink if the speaker needs to be charged.
- Make sure that wireless speaker is within 100 feet of the base.

Distorted Sound

- Speaker is too far from the base. Move the speaker closer to the base or change the position of the base.
- Base signal may be blocked. Keep base away from all electronic devices except the TV it is connected to. Do not place base inside cabinets.
- Charge the speaker, the battery may be low.

Speaker Won't Charge

- Check to see that the AC adapter is properly connected to the base.
- Make sure the speaker is correctly placed on the base. The charge indicator should blink while it is charging. Use a dry cotton swab and/or paper towel to clean the top of the base and bottom of the speaker.

Won't Connect to FM station

- If you hear static on FM station, adjust tuning knob to find a clear signal.
- The FM signal will be stronger if the radio signal tower is close to the speaker. Inclement weather may also reduce the FM signal clarity.
- If a FM station that is normally clear produces static, adjust the antenna and move the speaker close to a window.

Cleaning & Maintenance

- Unplug base from TV and power outlet.
- Wipe device down with soft cloth and mild soap.
- Dry with paper towel.
- Do not use harsh cleaning chemicals such as bleach or alcohol.
- Do not submerge in water.

Technical Specs

Operating wattage: 1x5 W speaker

Frequency response (2.4G): 2.4 GHz Radio Frequency

Charge time: 6+ hours

Operating range (2.4G): 100ft or more in open field

AC Adapter power: 100-240VAC/50-60Hz input; 9VDC 1.5A output

Usage time: up to 8 hours

Warranty Information

AudioRange warrants this product for its useful life (not to exceed two years for products with electrical or electronic components or consumables) against deficiencies in material and workmanship. This LIMITED LIFETIME WARRANTY does not cover products that are improperly used, abused, altered or repaired. Products found to be defective within the warranty period will be repaired or replaced at AudioRange's discretion. AudioRange reserves the right to make all determinations under this warranty. Products failing due to normal wear and tear, abuse or natural breakdown of materials over extended use and time may be repaired or replaced for a fee. For product support please visit audiorange.com/support

ALL IMPLIED WARRANTIES OF MERCHANTABILITY OR FITNESS FOR A PARTICULAR PURPOSE ARE LIMITED TO THE DURATION OF THIS WARRANTY. AUDIORANGE DISCLAIMS ALL OTHER EXPRESSED OR IMPLIED WARRANTIES OR CONDITIONS. TO THE EXTENT NOT PROHIBITED BY LAW, IN NO EVENT WILL AUDIORANGE BE LIABLE FOR ANY LOSS OF REVENUE OR PROFIT, OR FOR ANY SPECIAL, INDIRECT, CONSEQUENTIAL, INCIDENTAL OR PUNITIVE DAMAGES, HOWEVER CAUSED, ARISING OUT OF OR RELATED TO THE USE OF OR INOPERABILITY OF THE PRODUCT, EVEN IF AUDIORANGE HAS BEEN ADVISED OF THE POSSIBILITY OF SUCH DAMAGES. IN NO EVENT WILL AUDIORANGE'S LIABILITY EXCEED THE AMOUNT PAID BY YOU FOR THE PRODUCT.

This Limited Lifetime Warranty gives you specific legal rights, and you also may be other rights that vary from state to state or country to county. Some places do not allow limitations on implied warranties

or the exclusion of limitation of incidental or consequential damages, so the above limitations or exclusions may not apply to you.

For Limited Lifetime Warranty evaluation please visit www.audiorange.com/support for a return authorization before shipping your product to AudioRange. For warranty evaluation, your product must be accompanied by an explanation and receipt. All shipping for warranty evaluation must be pre-paid and insured. AudioRange cannot be liable for lost in-bound packages. Damage not covered under the Limited Lifetime Warranty may be repaired or replaced for a reasonable rate and a fee will be charged. Warranty void where prohibited.

Our 30-Day Money Back Guarantee

Every sale at AudioRange is backed by a 30-day money back guarantee. To receive a refund (shipping included), please contact us at support@audiorange.com.

Warranty Registration

To register your FREE limited lifetime warranty, please visit www.audiorange.com/support.

Modifications

Any modifications to this device are prohibited and will void warranty.

FCC Statement

The device complies with Part 15 of the FCC Rules. Operation is subject to the following two conditions: (1) This device may not cause harmful interference, and; (2) This device must accept any interference received, including interference that may cause undesired operation.

NOTE: This equipment has been tested and found to comply with the limits for a Class B digital device, pursuant to part 15 of the FCC Rules. These limits are designed to provide reasonable protection against harmful interference in a residential installation. This equipment generates, uses and can radiate radio frequency energy and, if not installed and used in accordance with the instructions, may cause harmful interference to radio communications.

However, there is no guarantee that interference will not occur in a particular installation. If this equipment does cause harmful interference to radio or television reception, which can be determined by turning the equipment off and on, the user is encourage to try to correct the interference by one or more of the following measures:

Reorient or relocate the receiving antenna.

Increase the separation between the equipment and the receiver. Connect the equipment to an outlet on a circuit different from the one the receiver is connected to. Consult the dealer or an experienced radio/TV technician for help.

The provided shielded USB cable must be used with this unit to ensure compliance with the class B FCC limits.

Warning: Changes or modifications to this unit not expressly approved by the party responsible for compliance could void the user's authority to operate the equipment.

Feedback

We're eager to hear about your experiences with your new Audio Range ITE-100. Please take a moment to reach out to with the outcome of your experience.



Satisfied?

We're happy that you're happy with your new ITE-1000. There are a few ways you can express your newfound joy that can help us!



Share your experience by leaving a review and rating on Amazon



Tell your friends, family or recommend our products to others.



Unsatisfied?

Our US based customer service team will work hard to make sure you are satisfied with your new ITE-1000. Here's how we can connect:



support@audiorange.com



(866) 462-1588