

## Guangzhou Zhiying Technology Co., Ltd

Block 15th, No.200 Fangcun Avenue East, Liwan District, Guangzhou, China, 510000

support@syncoaudio.com

www.syncoaudio.com

<https://www.facebook.com/syncomicrophones>

**WMic-T1 Microphone >>> User Manual**

Thank you for choosing SYNCO WMic-T1,  
Please read this manual carefully before use and follow all instructions mentioned herein.



# Contents

● Package List.....	1
● Feature Introduction.....	2
● Caring For Your SYNCO WMic-T1 Microphone.....	2
● Components Introduction.....	3
● How to Install the Batteries.....	4
● Indicator Light.....	4
● Operation and Usage.....	5
● Specifications.....	6
● Warranty.....	8

## Package List

(Package includes the following items)

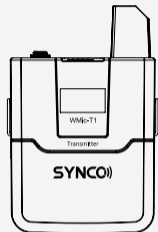

Transmitter x1

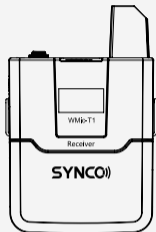

Receiver x1

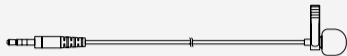

Lavalier Mic x1



3.5mm TRRS Output Cable x1



3.5mm TRS Output Cable x1

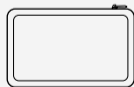

Storage Bag x1

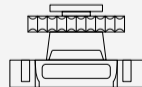

Cold Shoe Adapter x1



Belt Clip x2



User Manual x1

## Feature Introduction

- UHF wireless transmission, high-fidelity sound;
- Real-time noise reduction, ensuring a higher signal-to-noise ratio;
- Compatible with smartphones, digital SLR cameras, camcorders, recorders, personal computers;
- Audio processing chip, minimizing noise in wireless transmission system;
- 16 switchable channels for recording without environmental interference;
- Adjustable volume;
- Different status lights for real-time checking;
- Both the receiver and transmitter are powered by two AA batteries;

## Caring For Your SYNCO WMic-T1 Microphone

- Please keep the product in a dry, clean, dust-free environment.
- Keep corrosive chemicals, liquids and heat source away from the product to prevent mechanics damage.
- Use only a soft and dry cloth for cleaning the product.
- Malfunction may be caused by dropping, impact of external force.
- Do not attempt to disassemble the product. Doing so voids warranty.
- Please have the product checked or repaired by authorized technicians if any malfunctions happened.
- Failure to follow all the instructions may result in mechanics damage.
- Warranty does not apply to human errors.

## Components Introduction

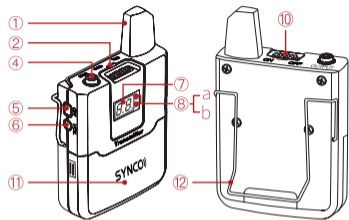

### Transmitter

- |                        |                             |
|------------------------|-----------------------------|
| ① Antenna              | ⑦ Screen Display            |
| ② Battery Indicator    | ⑧ Transmitting Status Light |
| ④ 3.5mm Mic Input Port | ⑩ Power Button              |
| ⑤ Channel Button       | ⑪ Battery Cover             |
| ⑥ Volume Button        | ⑫ Belt Clip                 |

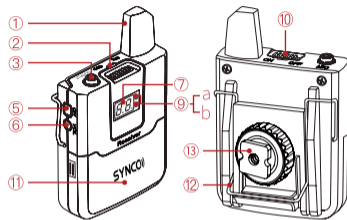

### Receiver

- |                           |                          |
|---------------------------|--------------------------|
| ① Antenna                 | ⑦ Screen Display         |
| ② Battery Indicator       | ⑨ Receiving Status Light |
| ③ 3.5mm Audio Output Port | ⑩ Power Button           |
| ⑤ Channel Button          | ⑪ Battery Cover          |
| ⑥ Volume Button           | ⑫ Belt Clip              |
|                           | ⑬ Cold Shoe Adapter      |

## How to Install the Batteries?

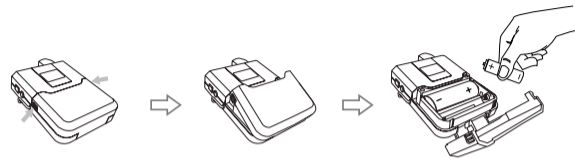

1. Battery Requirement: 2pcs \* AA batteries
2. Press the two clips to open the receiver/transmitter battery cover
3. Insert two batteries according to the positive and negative electrode
4. Close the battery cover

## Indicator Light

Receiver	Green Light Flickers(b)	Sound Input
	Red Light Keeps on(a)	Channel Matches
Transmitter	Red Light Flickers(a)	Audio Distortion
	Green Light Flickers(b)	Sound Input
Battery Indicator	Red Light Flickers	Low Battery Power

## Operation and Usage

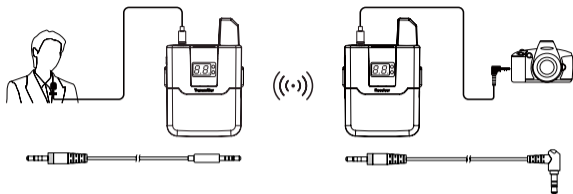

### Receiver

- ① Attach the cold shoe adapter to the receiver, and mount it on the camera/photographic equipment.
- ② Plug one end of the 3.5mm audio cable into the receiver's "LINE OUT" socket and the other end into the camera's "MIC" interface.
- ③ Push the power button to turn on the device.

### Transmitter

- ① Insert the lavalier mic into MIC socket of the transmitter.
- ② Push the power button to turn on the device.
- ③ Clip the receiver on your belt or put it in the pocket.

☆ Long press "Channel" button, to change channel number.

☆ Press "Volume" button to adjust the sound volume.

## Specifications

### Transmitter

Channel	16
Frequency Range	572MHz-586MHz
Oscillation Mode	PLL Frequency Synthesis
Working Distance	≥50m
Transmit Power	13.5dBm
Carrier Frequency Error	0.005%
SNR	>70dB
Harmonic Radiation	-32dBm
Modulation Mode	FSK
Maximum Frequency Deviation	± 65KHz
Dynamic Range	92 dB
Antenna	1/4 Wavelength Wire Antenna

Maximum Input Level	250mV
Input Impedance	2.2KΩ
Input Gain Adjustment	1-5 levels adjustable
Audio Output	3.5mm
Battery	AA 1.5V x 2, 120mA
Dimensions	96x60x18.8 (mm)
Net Weight	55g (without battery)
Working Temp.	0°C ~ +50°C
Storage Temp.	-20°C ~ 60°C

## Receiver

Channel	16
Frequency Range	572MHz-586MHz
Oscillation Mode	PLL Frequency Synthesis
Receiving Mode	Superheterodyne
Working Distance	≥50m
SNR	>70dB
Dynamic Range	92 dB
Received Power	13.5dBm
Image Rejection	45dBm
Antenna	1/4 Wavelength Wire Antenna
Noise Control	Built-in Setting Parameters
RF Sensitivity	When inputting 10dBu, S/N ≥ 45dB
Output Level Range	1-5 levels adjustable
Frequency Setting	Manual IR Sync

Audio Output	3.5mm
Output Impedance	400Ω
Battery	AA 1.5V x 2
Dimensions	96x60x18.8 (mm)
Net Weight	55g (without battery)
Working Temp.	0°C ~ +50°C
Storage Temp.	-20°C ~ 60°C

## WARRANTY

### Warranty Period

Thank you for purchasing SYNCO products.

1. Customers are entitled to free replacement or repair service in case of quality defect(s) found in the product under normal use within 30 days upon receipt of the product.
2. Original SYNCO products are entitled to **12-month** limited warranty service. The warranty period begins on the date of purchase of brand new, unused products by the first end-user.

Within the warranty period, if product defect or failure is attributable to material deflection or technological problem, the defective product or defective part will be repaired or replaced without charge (service and materials fee).

### Warranty Exclusions and Limitations

- Faults resulted from inappropriate use of a product without following its operation specification
- Artificial damage, e.g. crash, squeeze, scratch, or soaking
- Modifications to a product by its user or a third party without prior written consent of SYNCO, e.g. replacement of element or circuit, label alteration
- The code on product is inconsistent with that of warranty certificate, or the code on the product or warranty certificate is altered or torn off
- All consumable accessory attached to a product, like cable, wind muff, battery
- Faults as a result of force majeure, such as fire, flood, lightning, etc.

## Warranty Claim Procedure

- If failure or any problem occurs to your product after purchase, please contact a local agent for assistance, or you can always contact SYNCO's customer service through email at [support@syncoaudio.com](mailto:support@syncoaudio.com).
- Please retain your sales receipt and warranty certificate as proof of purchase. If any of these documents is missing, only sales return or chargeable service will be provided.
- If the SYNCO product is out of the warranty coverage, the service and the parts cost will be charged.

WARRANTY CERTIFICATE			
Please register your warranty. Meanwhile, you are welcomed to contact us via Email : <a href="mailto:support@syncoaudio.com">support@syncoaudio.com</a>			
USER INFORMATION	Customer Name:		
	Phone Number:		
	Email:		
	Address:		
SALES INFORMATION	Sales Date:		
	Model:		
	Product Code:		
	Dealer:		
REPAIR RECORD	Service Date:		
	Technician:		
	Issue:		
RESULT	<input type="checkbox"/> Solved	<input type="checkbox"/> Unsolved	<input type="checkbox"/> Returned(Replaced)

