

C2
Microphone
User Manual

Thank you for choosing MOMAN product. Please read this manual carefully before use and follow all instructions mentioned herein.

Caring For Your MOMAN Product

- Please keep the product in a dry, clean, dust-free environment.
- Keep corrosive chemicals, liquids and heat source away from the product to prevent mechanics damage.
- Use only a soft and dry cloth for cleaning the product.
- Malfunction may be caused by dropping, impact of external force.
- Do not attempt to disassemble the product. Doing so voids warranty.
- Please have the product checked or repaired by authorized technicians if any malfunctions happened.
- Failure to follow all the instructions may result in mechanics damage.
- Warranty does not apply to human errors.

Package List

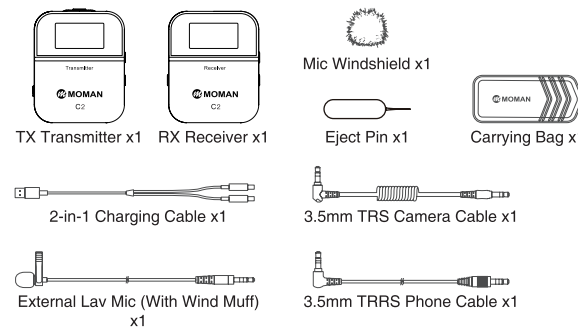

Product Introduction

• TX Transmitter

- 1.External Mic Input
- 2.USB-C Port
- 3.Power (MUTE)
- 4.Reset (Help with Eject Pin)
- 5.Low Cut
- 6.Pairing
- 7.Built-in Mic
- 8.Display Screen
- 9.Pocket Clip

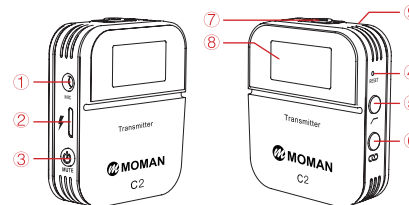

• RX Receiver

- 1.USB-C Port
- 2.Power (MUTE)
- 3.Reset (Help with Eject Pin)
- 4.Gain Control
- 5.Pairing
- 6.3.5mm Audio Output
- 7.3.5mm Monitoring Jack
- 8.Display Screen
- 9.Pocket Clip

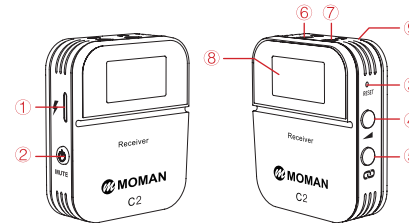

• Display Screen

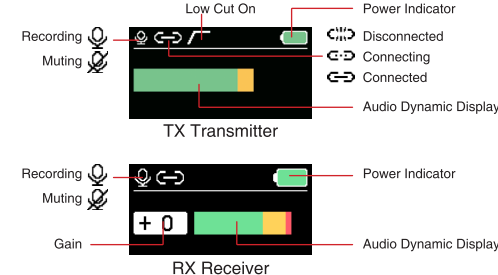

Operation

• TX

1.Power/ Mute

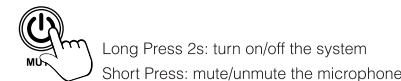

2.Charging

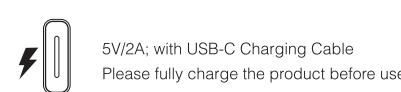

3.External Mic Input

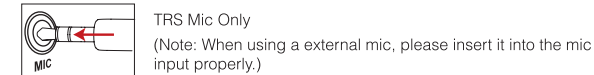

4.Mic Windshield & Device Installation



5.Reset



6.Low Cut

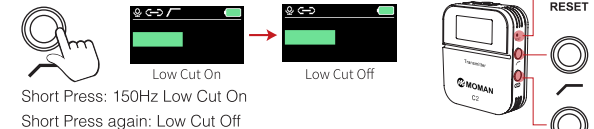

7.Pairing



The system will pair automatically after power on.
Manual pairing: long press the pairing button on the RX and TX for 3 seconds at the same time

RX

1.Power/ Mute

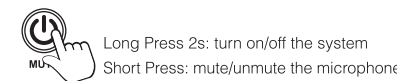

2.Charging



3.Reset



4.Gain Control

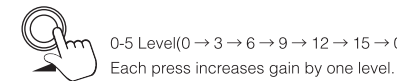

5. Pairing

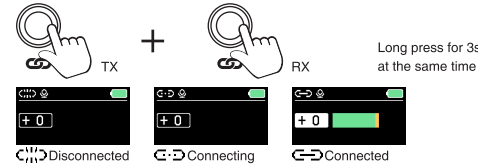

The system will pair automatically after power on.

Manual pairing: long press the pairing button on the RX and TX for 3 seconds at the same time

6. Audio Monitoring & Output Connection

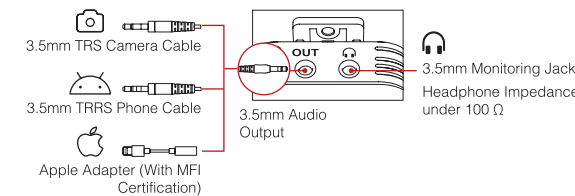

Setting The Recording Level Correctly

Camera devices generally have poor-quality, noisy preamps. In order to get the cleanest signals possible, it is highly recommended that you set the recording level on your camera quite low, 1/2 or 1/3 of it.

C2 provides variable gain control, allowing you to tailor your levels to just about environment and recording device.

Adjust the recording level of inbuilt mics for SONY Camera

(Take A7S II for example)

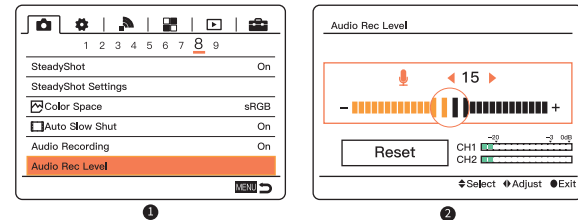

Adjust the recording level of inbuilt mics for Canon Camera

(Take EOS 5D Mark IV for example)

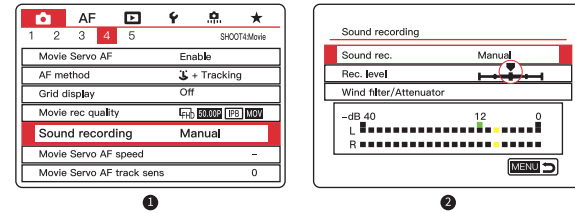

Adjust the recording level of inbuilt mics for Panasonic Camera

(Take LUMIX GH5 for example)

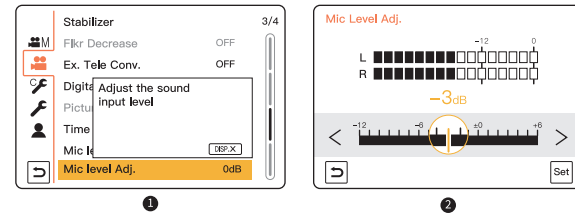

Specifications

TX Transmitter

Wireless Transmission	Digital 2.4GHz
RF Frequency Band	2400-2483.5MHz
Working Distance	492ft/150m(LOS area); 164ft/50m(NLOS area)
Mounting	Pocket Clip
Audio Input	1/8" / 3.5mm TRS Mic Input
Audio Input Level	1V (0dBV)
RF Output Power	< 10mW
Power Requirements	3.3V-4.7V
Battery Type	Built-in Lithium Battery, 500mAh
Battery Charging Time	1.5H
Battery Life	8H
Display	TFT Screen
Dimensions	52x42x17mm
Material	Plastic
Weight	39g

RX Receiver

Wireless Transmission	Digital 2.4GHz
RF Frequency Band	2400-2483.5MHz
Approximate RF Sensitivity	-81dBm
Working Distance	492ft/150m(LOS area); 164ft/50m(NLOS area)
Mounting	Pocket Clip
Number of Audio Channels	1

Audio Output	1/8" / 3.5mm TRS Mic Output 1/8" / 3.5mm TRS Headphone Output
Gain	0-5 Level
Audio Output Level	Line Out: 1V; Monitoring: 25-30mW
Power Requirements	3.3V-4.7V
Battery Type	Built-in Lithium Battery, 500mAh
Battery Charging Time	1.5H
Battery Life	8H
Display	TFT Screen
Dimensions	52x42x17mm
Material	Plastic
Weight	39g
Microphone	
Form Factor	Built-in/External Mic
Sound Field	Mono
Polar Pattern	Omnidirectional
Frequency Range	50Hz-20KHz
Sensitivity	-40dB (±3 dB, re 1V/Pa at 1KHz)
Maximum SPL	135dB SPL (at 1KHz)

Moman (UK) Limited

Unit 25 Basepoint Business Centre, Aviation Park, West Christchurch, United Kingdom BH23 6NX

www.momanmic.com www.momanx.com www.momanx.co.uk

@MomanGlobal

https://moman.co/youtube