



WARRANTY & WATCH CARE





WARRANTY & WATCH CARE

## CONTENT

### WARRANTY & USER INSTRUCTIONS

International warranty	<i>Pages</i> 3-4
Special recommendation	<i>Pages</i> 5-7
Instructions Model - BOLT-68 - 3 Hands & GMT	<i>Pages</i> 9-11
Instructions Model - BOLT-68 - 3 Hands Automatic	<i>Pages</i> 13-15
Instructions Model - BOLT-68 - Racing	<i>Pages</i> 17-21
Instructions Model - BOLT-68 - Chronograph	<i>Pages</i> 23-26
Instructions Model - BOLT-68 - Chronograph Automatic	<i>Pages</i> 29-32
BOLT-68 - Bayonet system	<i>Pages</i> 35-38

## INTERNATIONAL WARRANTY

Limited 2 years warranty:

Your Bomberg watch is warranted for a 2 years period under the terms and conditions of this warranty.

The international Bomberg warranty covers material and manufacturing defects existing at the time of the delivery of the purchased Bomberg watch. The warranty only comes into force if the warranty certificate is dated, fully and correctly completed and stamped by an official Bomberg retailer.

During the warranty period and by presenting the valid warranty certificate, you will have the right to have any defect repaired free of charge.

This manufacturer's warranty does not cover:

- The life of the battery;
- Normal wear and tear and aging (scratched crystal, alteration of the colour and/or material of nonmetallic straps and chains, such as leather, textile, rubber; peeling of the plating);

- Any damage on any part of the watch resulting from abnormal / abusive use, lack of care, negligence accidents (knocks, dents, crushing, broken crystal, etc.), incorrect use of the watch and non-observance of the use directions provided by Bomberg;
- The Bomberg watch handled by non-authorized persons (for battery replacement, services or repairs) or which has been altered in this original conditions beyond Bomberg.

## **SPECIAL RECOMMENDATIONS**

### **How often should my watch be checked?**

We recommend a yearly water resistancy check (partial service with movement check).

### **How often should my watch be serviced?**

Like any other precision instrument a watch should be serviced regularly to ensure perfect runwaring. We cannot say how often you should have your watch serviced as this depends on the model, the climate where you live and how you look after the watch yourself. As a rule, a watch should be serviced every 4 or 5 years, depending on the conditions in which it is worn.

### **Where should I go to get my watch serviced or for a new battery?**

We recommend that you go to an official Bomberg agent or retailer. They are the only people who have the necessary tools and devices to work on your watch and to carry out the necessary checks at specialized level.

Furthermore, only specialists can guarantee that their work meets the stringent quality standards set by Bomberg.

## What can I do to ensure that my watch functions perfectly for many years?

**Magnetic fields:** avoid putting your watch on a loud-speaker or a refrigerator because these machines create magnetic fields that may damage it.

**Salt-Water:** always rinse your watch in fresh water after swimming in the sea.

**Shocks:** avoid subjecting your watch to shocks, including sudden changes in temperatures.

**Screwed crown:** always make sure you have screwed the crown properly to avoid any humidity getting into the mechanism.

**Cleaning:** use a toothbrush and soapy water to clean bracelet and water resistancy cases and a soft cloth to dry off afterwards. For the leather strap, it's necessary to use special cleaning products.

**Chemical products:** avoid all direct contact with solvents detergents, perfume, cosmetics, etc. which may damage the bracelet or strap, the case or the gaskets.



**Temperatures:** avoid exposing your watch to extreme temperatures (over 60°C or 140°F and under 0°C or 32°F) and to sudden fluctuations in temperature.

**Water-resistance:** All Bomberg watches are water-resistant. They can withstand a water pressure of at least 3 bar (depth of 30 meters). Water resistance is not a permanent condition. To ensure permanent water resistance, the watch should be checked once a year. To ensure conformance with the warranty regulations, these operations must be performed by an authorized Bomberg dealer or authorized Bomberg Service Center.

**Chronograph pushers:** do not adjust the pushers under water as this could cause wetness in the mechanism.





BOLT-68 - 3 HANDS & GMT

*BOLT-68 - 3 Hands & GMT*

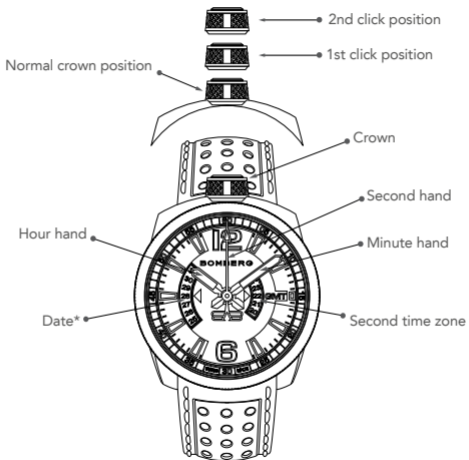

## BOMBERG MODEL - BOLT-68 - 3 Hands & GMT

### Setting the time:

1. Unscrew and pull the crown out to the 2nd click position so that the second hand stops.
2. Turn the crown to set the hour and minute hands.
3. After the time has been set, push the crown back to the normal position and small second hand begins to run again. Screw it in back now.

### Setting the date:

1. Unscrew and pull the crown out to the 1st click position.
2. Turn the crown anti-clockwise to set the date.\*
3. After the date has been set, push the crown back to the normal position and screw it in.

### Setting the second time zone:

1. Unscrew and pull the crown out to the 1st click position.
2. Turn the crown clockwise to set the second time.
3. After the second time has been set, push the crown back to the normal position and screw it in.

*\*Important: It is not possible to adjust the date between 10.30 pm and 0.00 am.  
It is necessary to adjust the date after each month with less than 31 days.*





BOLT-68 - 3 HANDS AUTOMATIC

*BOLT-68 - 3 Hands Automatic*

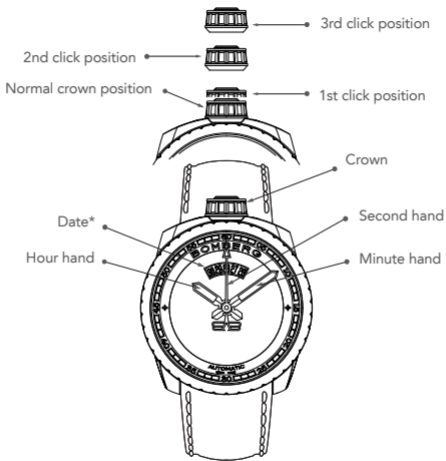



## **BOMBERG MODEL - BOLT-68 - 3 Hands Automatic**

### **Manual winding:**

1. Unscrew and pull the crown out to the 1st click position.
2. Turn the crown clockwise to wind the watch..
3. After winding, push the crown back to the normal position and screw it in.

### **Setting the date:**

1. Unscrew and pull the crown out to the intermediate 2nd click position.
2. Turn the crown clockwise to set the date.\*
3. After the date has been set, push the crown back to the normal position and screw it in.

### **Setting the time:**

1. Unscrew and pull the crown out to the 3rd click position so that the second hand stops.
2. Turn the crown to set the hour and minute hands.
3. After the time has been set, push the crown back to the normal position and small second hand begins to run again. Screw it in back now.

*\*Important: It is not possible to adjust the date between 8.00 pm and 3.00 am.  
It is necessary to adjust the date after each month with less than 31 days.*





BOMBERG

BOLT-68 - RACING

*BOLT-68 - Racing*

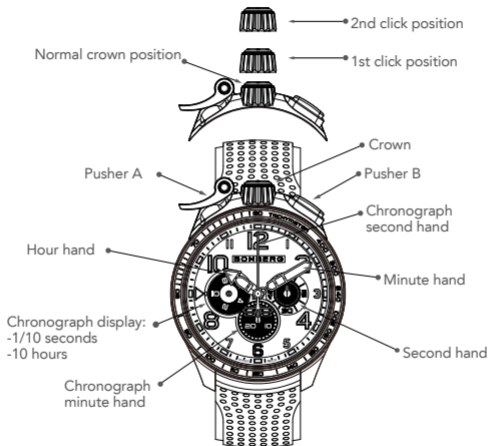

## BOMBERG MODEL - BOLT-68 - Racing

### Setting the time:

1. Unscrew and pull the crown out to the 2nd click position so that the second hand stops.
2. Turn the crown to set the hour and minute hands.
3. After the time has been set, push the crown back to the normal position and small second hand begins to run again. Screw it in back now.

## **BOMBERG MODEL - BOLT-68 - Racing**

### **Using the chronograph:**

This chronograph is able to measure and display time in 1/10 second united up to 29 minutes and 59 seconds. After 30 minutes, is able to measure and display time in 1/1 second united up to 9 hours, 59min and 59sec.

### **Measuring time with the chronograph:**

1. The chronograph can be started and stopped each time pusher "A" is pressed.
2. Pressing pusher "B" resets the chronograph and the hands return to zero position.

### **Measuring intermediate time with the chronograph:**

1. Press the "A" to start the chronograph.
2. Press the "B" to display an intermediate time. Timing continues in background.
3. Press the "B" again to restart the chronograph. The 3 chronograph hands are quickly advanced to the ongoing measured time.
4. Press the "A" to stop the chronograph.
5. When the chronograph is stopped, pressing "B" resets every function and the hands return to zero position.

## BOMBERG MODEL - BOLT-68 - Racing

### Chronograph reset (INCL. AFTER REPLACING BATTERY):

This procedure should be performed when the chronograph second hand does not return to zero position after the chronograph has been reset, and including after the battery has been replaced.

1. Unscrew and pull the crown out to the 2nd click position.
2. Keep "A" and "B" pushed simultaneously for at least 2 seconds; the chronograph second hand rotates by  $360^{\circ}$  -> corrective mode activated.
3. Press "A" to set the chronograph hand to the zero position. The chronograph hand can be advanced rapidly by continuously pressing "A".
4. Press "B" to set the next chronograph hand and repeat step 3.
5. Once the hand have been zeroed, return the crown to the normal position and screw it in.







BOMBERG

BOLT-68 - CHRONOGRAPH

## BOLT-68 - Chronograph



## BOMBERG MODEL - BOLT-68 - Chronograph

### Setting the time:

1. Unscrew and pull the crown out to the 2nd click position so that the second hand stops.
2. Turn the crown to set the hour and minute hands.
3. After the time has been set, push the crown back to the normal position and small second hand begins to run again. Screw it in back now.

### Setting the date:

1. Unscrew and pull the crown out to the 1st click position.
2. Turn the crown anti-clockwise to set the date.\*
3. After the date has been set, push the crown back to the normal position and screw it in.

*\*Important: It is not possible to adjust the date between 8.30 pm and 0.00 am.  
It is necessary to adjust the date after each month with less than 31 days.*

## **BOMBERG MODEL - BOLT-68 - Chronograph**

### **Using the chronograph:**

This chronograph is able to measure and display time in 1/10 second united up to 29 minutes and 59 seconds. After 30 minutes, is able to measure and display time in 1/1 second united up to 9 hours, 59min and 59sec.

### **Measuring time with the chronograph:**

1. The chronograph can be started and stopped each time pusher "A" is pressed.
2. Pressing pusher "B" resets the chronograph and the hands return to zero position.

### **Measuring intermediate time with the chronograph:**

1. Press the "A" to start the chronograph.
2. Press the "B" to display an intermediate time. Timing continues in background.
3. Press the "B" again to restart the chronograph. The 3 chronograph hands are quickly advanced to the ongoing measured time.
4. Press the "A" to stop the chronograph.
5. When the chronograph is stopped, pressing "B" resets every function and the hands return to zero position.

## BOMBERG MODEL - BOLT-68 - Chronograph

### Chronograph reset (INCL. AFTER REPLACING BATTERY):

This procedure should be performed when the chronograph second hand does not return to zero position after the chronograph has been reset, and including after the battery has been replaced.

1. Unscrew and pull the crown out to the 2nd click position.
2. Keep "A" and "B" pushed simultaneously for at least 2 seconds; the chronograph second hand rotates by  $360^{\circ}$  -> corrective mode activated.
3. Press "A" to set the chronograph hand to the zero position. The chronograph hand can be advanced rapidly by continuously pressing "A".
4. Press "B" to set the next chronograph hand and repeat step 3.
5. Once the hand have been zeroed, return the crown to the normal position and screw it in.





BOLT-68 - CHRONOGRAPH AUTOMATIC

*BOLT-68 - Chronograph Automatic*





## **BOMBERG MODEL - BOLT-68 - Chronograph automatic**

### **Manual winding:**

1. Unscrew and pull the crown out to the 1st click position.
2. Turn the crown clockwise to wind the watch.
3. After winding, push the crown back to the normal position and screw it in.

### **Setting the date:**

1. Unscrew and pull the crown out to the intermediate 2nd click position.
2. Turn the crown clockwise to set the date.\*
3. After the date has been set, push the crown back to the normal position and screw it in.

### **Setting the time:**

1. Unscrew and pull the crown out to the 3rd click position so that the second hand stops.
2. Turn the crown to set the hour and minute hands.
3. After the time has been set, push the crown back to the normal position and small second hand begins to run again. Screw it in back now.

*\*Important: It is not possible to adjust the date between 8.00 pm and 2.00 am.  
It is necessary to adjust the date after each month with less than 31 days.*

**BOMBERG MODEL - BOLT-68 - Chronograph automatic**

**Measuring time with the chronograph:**

1. Press the pusher "A" to start the chronograph and press the pusher "B" to stop the chronograph.
2. Press "B" again to reset the chronograph. The hands return to zero.

It is possible to restart and stop the chronograph as you want, without doing a reset.







BOLT-68 - BAYONET SYSTEM

### **Bayonet system**

A watch? NO! Two watches, two ways of being? An object of desire? YES! Certainly for men whose masculinity is not open to question.

Using an ingenious bayonet system with a trigger guard – an exclusive system patented by BOMBERG – the time-keeping module can be detached from its base and attached to a metal chain.

The new configuration is now a pocket watch. But be warned, the chain differs quite a bit from the fine chains on the pocket watches of yesteryear. As you will no doubt have realized, this tool is more for a pocket on a pair of jeans than that of a gentleman's waistcoat.

From a technical point of view, this dual usage – pocket and wrist – has meant new developments in three areas: size, engineering and security.

**To remove the watch case from the band:**

1. Rotate the watch case anti-clockwise at 10.
2. After two clicks, the watch case is released.
3. Lift the watch case from the attachment to remove it from the band.

**To place the watch case on the chain:**

1. Hold medallion with chain pending down and BB logo facing your hand.
2. Place the watch case in release position with the crown at 10 and rotate clockwise.
3. After two clicks, the case will lock into place.

**To put back the watch case to the band:**

1. Hold the band with buckle up.
2. Place the watch case in release position with the crown at 10 and rotate clockwise.
3. After two clicks, the case will lock into place.

BOLT-68 - Bayonet system

Disassembly

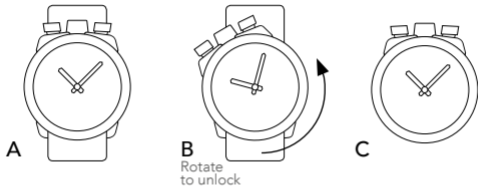

Assembly

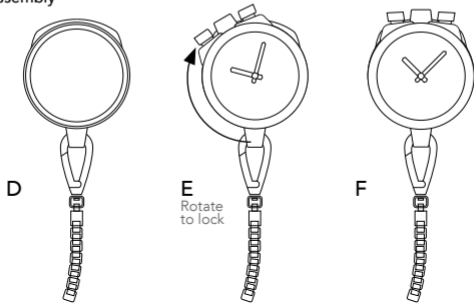











[bombergwatches.com](http://bombergwatches.com)  
[welcome@bomberg.ch](mailto:welcome@bomberg.ch)



  
BOMBERG

[bombergwatches.com](http://bombergwatches.com)  
[welcome@bomberg.ch](mailto:welcome@bomberg.ch)