

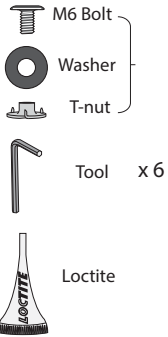

Reckless 40 V4.0 Instructions

Included hardware



Step #1

- A) Decide between the Wide Setting or Narrow Setting*
- B) Place T-nuts in holes on the backside of center harness between foam and saddle.
- C) Place M6 bolts/washers through the corresponding set of holes on the front side of leg harness. (add loctite now)
- D) Line up the holes on the leg and center piece, tighten with provided tool. (This is easiest on a flat surface!)

* Narrow setting is intended for thinner machines like dirt and enduro bikes. The "Wide Setting" is for mid to large bikes

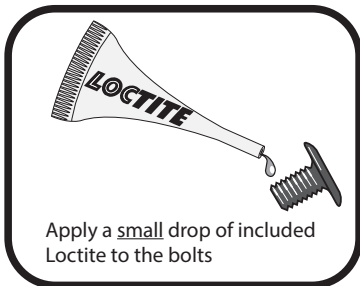
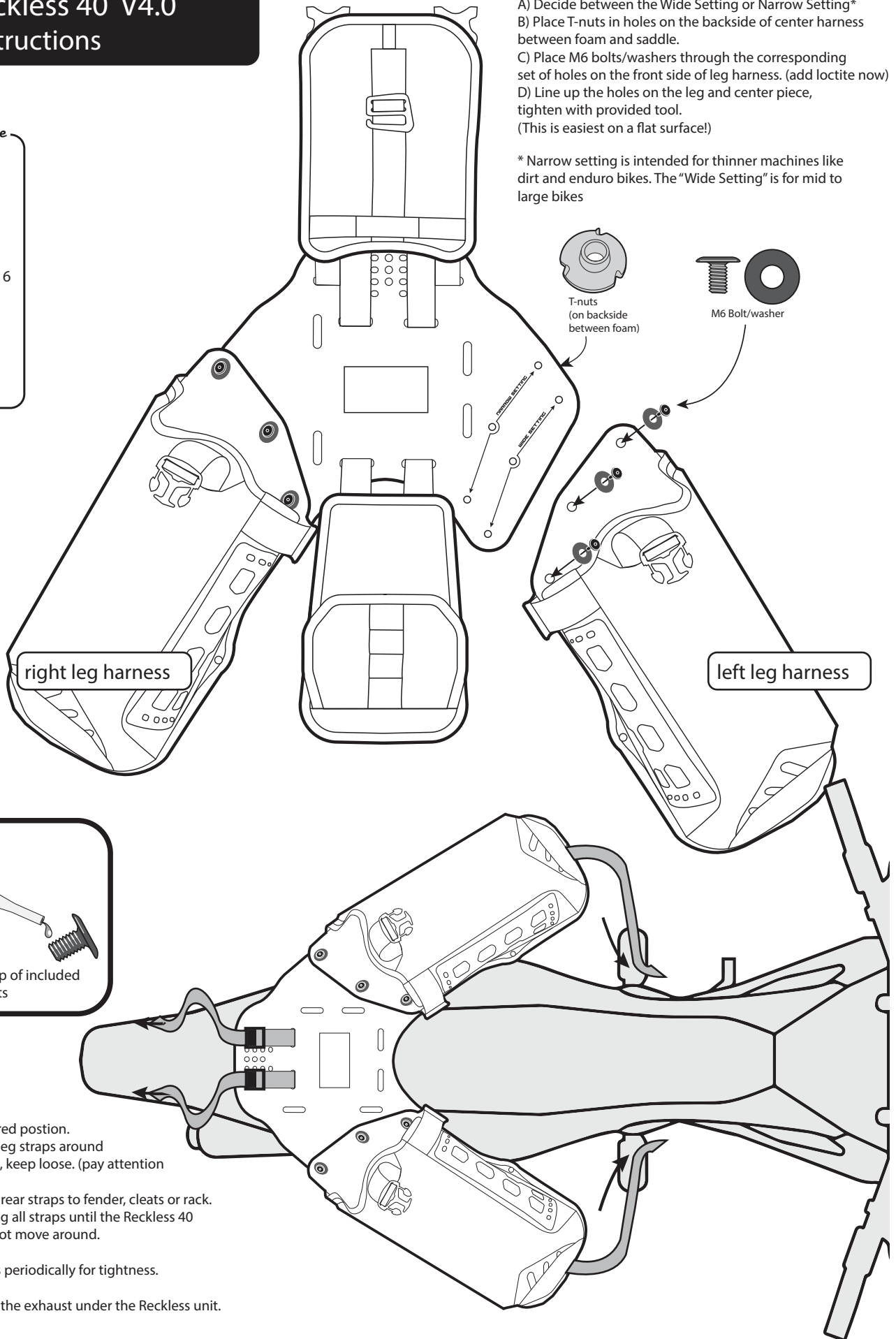

Apply a small drop of included Loctite to the bolts

Step #2

- A) Place on bike in desired position.
- B) Strap down forward leg straps around appropriate frame tube, keep loose. (pay attention to hot engine areas)
- C) Next strap down the rear straps to fender, cleats or rack.
- D) Now begin tightening all straps until the Reckless 40 is very tight and does not move around.

! Check straps and bolts periodically for tightness.

E) Install heat shield on the exhaust under the Reckless unit. (see next page)



Reckless 40 V4.0 Instructions

Optional beavertail modification

Standard beaver-tail orientation

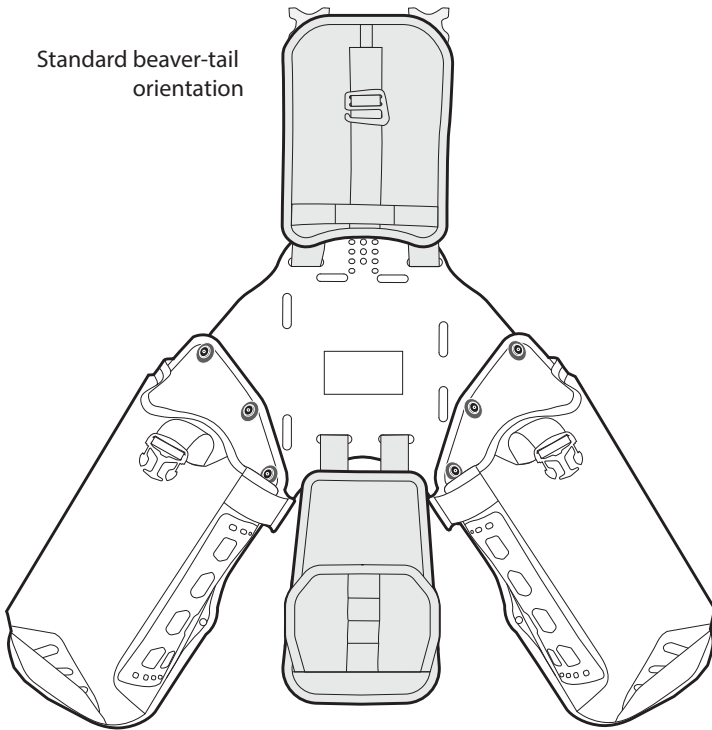

Transverse beaver-tail orientation. This can help accommodate a larger tail bag than the system was originally designed for.

Beaver-tail extender. This helps to accommodate a larger tail bag.

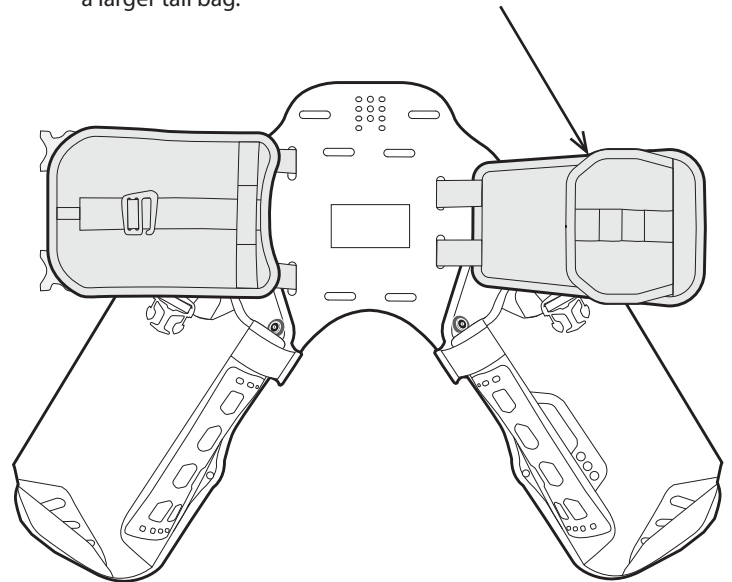

Heat Shield Placement

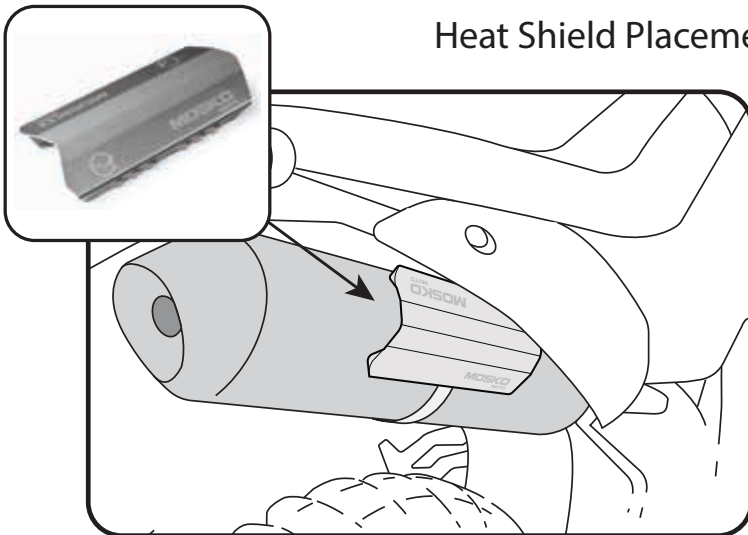

It is your responsibility to place the provided heat shield on your exhaust pipe using the hose clamp, in a location that protects the bag and your motorcycle's body panels from melting due to tail pipe heat. It is important to check after each use that your heat shield is located properly.

Failure to do so may result in severe product/bike damage that is not covered under warranty. Dual exhausts, extra exposed or extremely hot running exhausts, may require a second heat shield, either in line or stacked.

Fastening the dry bags properly

Do not route the straps this way

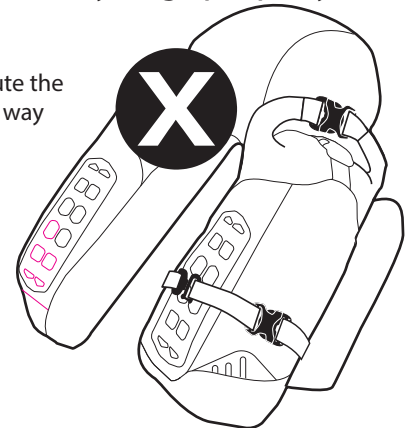

The dry bag should be connected to the harness like this

