

# ILLUSTRATED PARTS BREAKDOWN - IPB

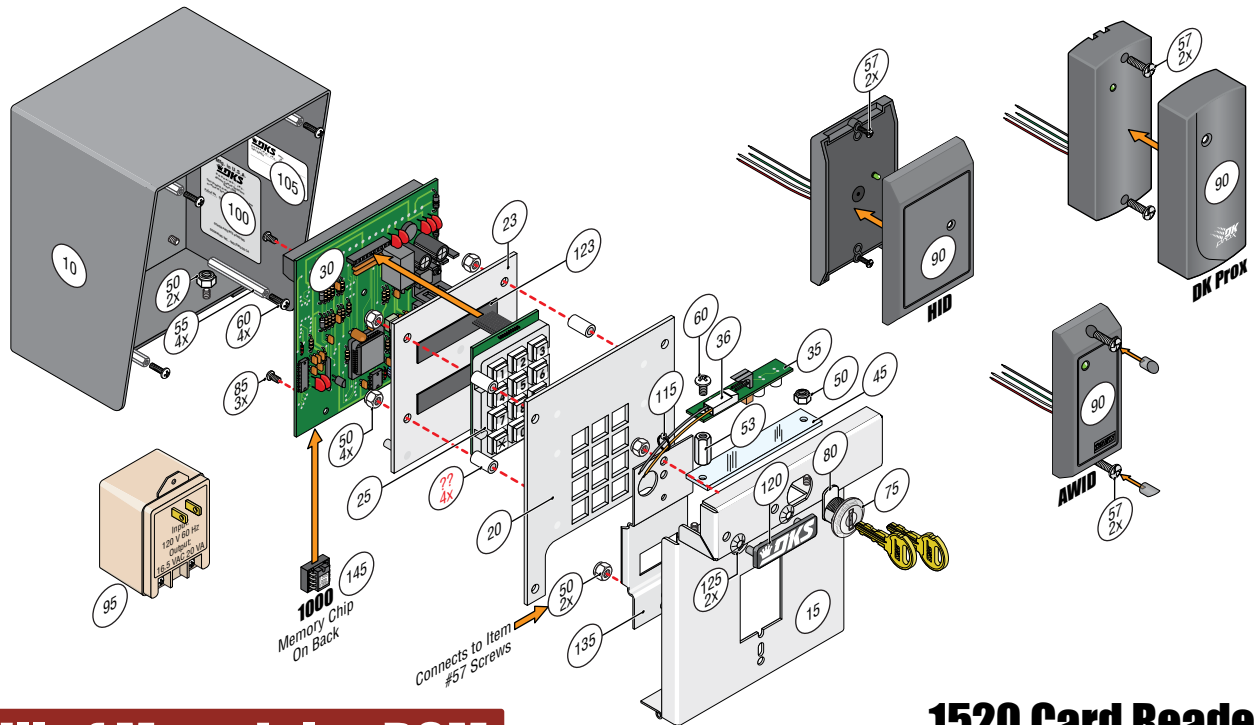

## Bill of Materials - BOM

## 1520 Card Readers 1520-080 AWID, 1520-082 HID, 1520-084 DK Prox

Item	Part Number	Quantity	UM	Description
10	1506-101	1	EA	Box Digital Lock Hinged
15	1508-053	1	EA	Faceplate Card Reader Hinged
20	1516-025	1	EA	Subplate Card Reader Stand Alone
23	1506-015	1	EA	Bracket Digital Lock
25	1514-030	1	EA	Keypad Assembly Plastic
30	1505-009	1	EA	PCB Card Reader Prox / Printer
35	2356-010	1	EA	PCB LED Light Straight
36	2344-037	1	EA	Wire Harness Assy LED
45	1502-005	1	EA	Cover Plastic
50	2902-003	9	EA	Nut Nylon Lock 6-32
51	1800-018	.41	FT	Weather Strip .125" x .187" (Inside Box, not shown)
53	2900-905	1	EA	Standoff Aluminum 7/16" 6-32
55	2900-904	4	EA	Standoff Aluminum 2" 6-32
57	2616-428	2	EA	Screw One Way 6-32 x 3/4"
60	2616-000	4	EA	Screw Phillips Head 6-32 x 1/4
75	4001-035	1	EA	Lock N16058BDxSFx2K Key 16120
80	1702-505	1	EA	Cam 9/16"
85	1904-001	3	EA	Screw Round Head 4-40 x 1/4"
90	1815-300	1	EA	Card Reader <b>DKProx Mullion</b>
90	1815-382	1	EA	Card Reader <b>HID</b>
90	1815-280	1	EA	Card Reader <b>AWID</b>
95	1804-060	1	EA	Transformer 16.5 VAC 20VA plug
100	2599-008	1	EA	Label Patent
105	1400-009	1	EA	Decal Identification
115	1804-031	1	EA	Tie Wrap 4"
120	2600-734	1	EA	Nameplate Plastic DKS Small
123	1897-050	2	EA	Gasket Support Thick 1/16"
125	2802-040	2	EA	Washer Push on Clamp
135	1520-021	1	EA	Bracket Keypad Guard
145	1520-042	1	EA	Memory Chip - 1000 Cards
??	3002-021	4	EA	Spacer Nylon 6 x 3/8"

# ILLUSTRATED PARTS BREAKDOWN - IPB

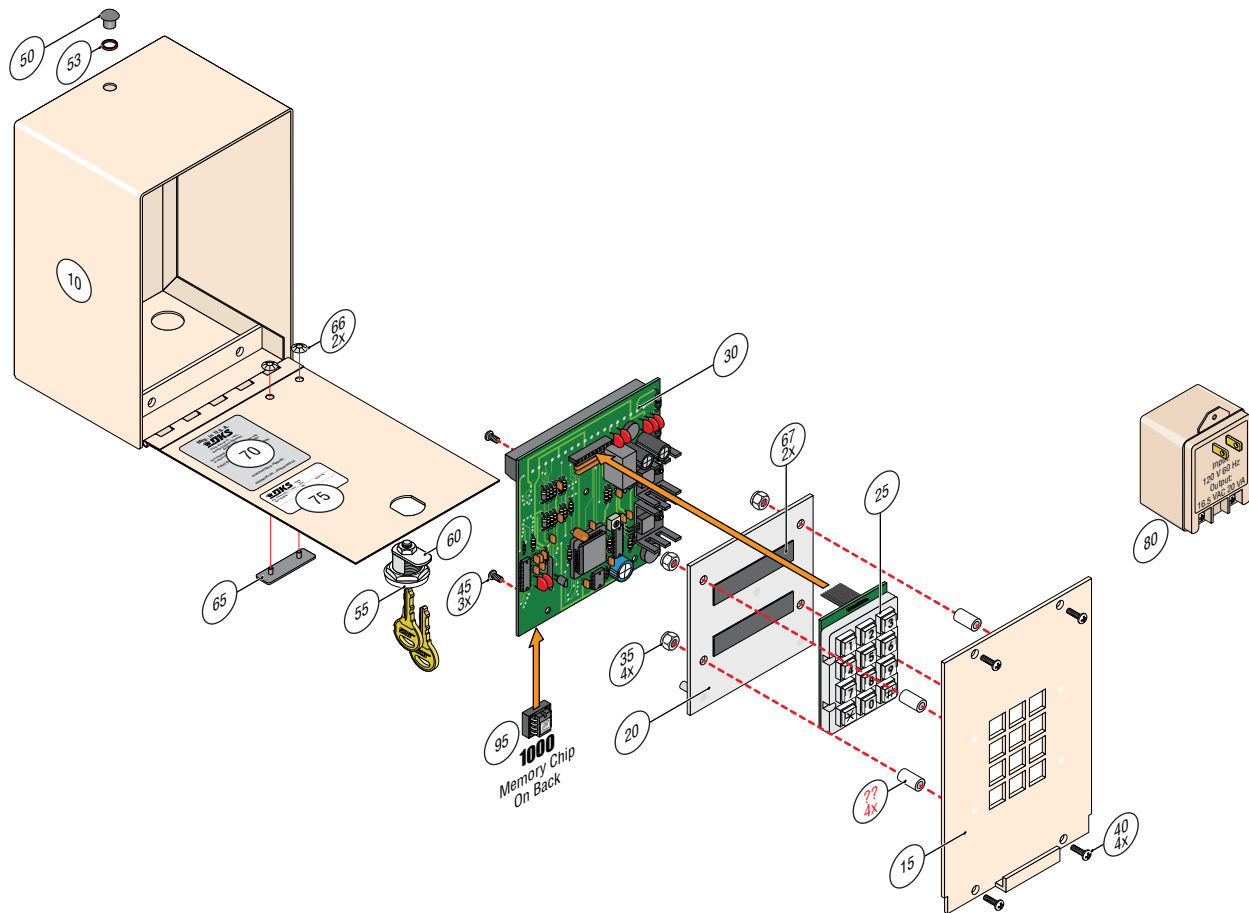

## Bill of Materials - BOM

## 1520 Controller 1520-081

Item	Part Number	Quantity	UM	Description
10	1514-101	1	EA	Box Radio Receiver
15	1514-052	1	EA	Faceplate Radio Receiver
20	1506-015	1	EA	Bracket Digital Lock
25	1514-030	1	EA	Keypad Assembly Plastic
30	1505-009	1	EA	PCB Card Reader Prox / Printer
35	2902-003	4	EA	Nut Nylon Lock 6-32
40	2616-000	4	EA	Screw Phillips Head 6-32 x 1/4"
45	2904-001	3	EA	Screw Round Head 4-40 x 1/4"
50	2600-880	1	EA	Hole Plug Plastic for 3/8" Hole
53	1215-020	1	EA	O-Ring .375 x .500 x .0625
55	4001-035	1	EA	Lock N16058BDxSFx2K Key 16120
60	1702-501	1	EA	Cam 7/8"
65	2600-734	1	EA	Nameplate Plastic DKS Small
66	2802-040	2	EA	Washer Push on Clamp
67	1897-050	2	EA	Gasket Support Thick 1/16"
70	2599-008	1	EA	Label Patent
75	1400-009	1	EA	Decal Identification
80	1804-060	1	EA	Transformer 16.5 VAC 20VA plug
95	1520-042	1	EA	Memory Chip - 1000 Cards
??	3002-021	4	EA	Spacer Nylon 6 x 3/8"