

Option 1 Mounting Bird Feeder

Note: Remove Camera Module before mounting!

Mounting of the Bird Feeder Camera is accomplished by threading a screw or a nail to a post, wall, or flat surface & simply sliding the feeder across the nail or screw until it is hanging from the the screw or nail.

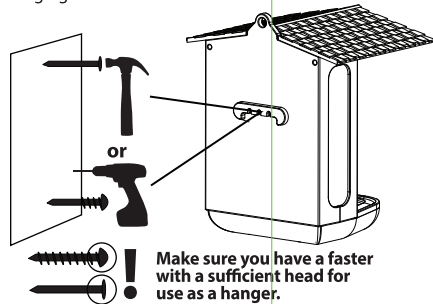

Charging and use of the camera:

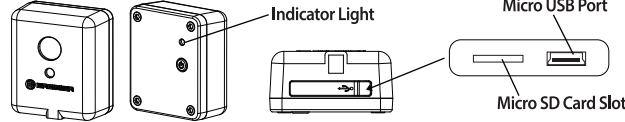

1. Your camera charges by plugging the provided USB cable into the Camera and to then into your computer. A red light will illuminate while charging. Charging should take 2-4 hours.
 2. After charging, remove USB Cable from computer according to computer manufacturers instructions.
 3. Remove USB Cable from Camera.
 4. Insert Micro SD card into the Micro SD Card Slot (Max 32 GB). The card will only fit in one direction. **DO NOT FORCE THE CARD INTO THE SLOT!**
 5. Depress Power Button and unit will be live and taking pictures
- NOTE: The indicator light will illuminate in short bursts while pictures are being recorded within 1 minute. After 1 minute, the camera is on (stand by to take photos). THERE WILL BE NO FLASH EVEN WHEN IT'S TAKING PHOTOS.**
6. Place the camera on the "post" by aligning the "post" with the "mounting cell"
 7. To view pictures remove camera from the feeder by sliding the camera up until free from the post.
 8. Remove card from camera and use a card reader to view your photos

Cleaning your Feeder

1. Remove Camera as instructed previously and set aside. **The Camera is water resistant NOT waterproof!**
2. Remove Roof and base tray cover. Wash with a mild detergent and air dry.
3. Re-assemble and rehang.



Refilling your Bird Feeder with seed

1. Gently pull the roof from the Feeder by holding the Feeder and pulling on the roof. You should feel the roof detach from the Feeder & become free. Fill with your favorite seed.
2. Replace roof by aligning the half circle tabs with guides on the feeder.

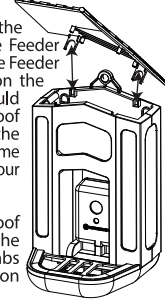

Option 2 Mounting Bird Feeder

Note: Remove Camera Module before mounting!

Mounting of the Bird Feeder can be made by installing a screw or nail to the desired surface and hanging the feeder on the edge of the fastener. **NOTE: Your fastener selection must have a head which will be sufficient for hanging.**

