



SHASTA RIDGE SERIES

4K WIFI ACTION CAMERA USER MANUAL



*Simulated image.

Introduction

Welcome to a whole new adventure!

With its waterproof casing, multiple mounting accessories, 6-axis stabilization unit and wide 170° field of view, the Alpen Shasta Ridge 4K WiFi Action Camera has everything you need to capture the extremes of all of your outdoor adventures in ultra-high definition.

Whether you are trail riding, hunting, kayaking, snorkeling or climbing, this versatile camera can document your experiences in a range of resolution options including 4K video up to 60 fps and 16MP photo resolution. The device has easy touchscreen controls and is iOS and Android compatible. It also can be operated using a remote-control device that attaches to the user's wrist.

To ensure it is ready to go rain or shine wherever the action takes you, the Shasta Ridge camera is waterproof up to 15 feet (4.5 meters) on its own and up to 100 feet (30 meters) when inside the waterproof case. It comes with a variety of accessories to accommodate multiple mounting needs and a 6-axis gyro unit that provides excellent stabilization during fast-paced activities. A ground stake is included for coordinating extreme angle shots or positioning in unique settings like the middle of a decoy array.

To discover more about the features of the Alpen Shasta Ridge 4K WiFi Action Camera and how to use them, please read this manual thoroughly.

To keep up to date on latest manual, please visit www.bresserusa.com or www.alpenoptics.com.

Table of Contents

P. 04	: About this Manual and General Warnings
P. 08	: What's Included
P. 10	: Meet the Alpen 4K Camera / Parts Diagrams
P. 12	: Camera Functions
P. 13	: Touchscreen Gestures
P. 14	: Camera Setup
P. 17	: Remote Control
P. 18	: Camera Settings
P. 20	: Using the Camera
P. 24	: Recording Videos
P. 26	: Taking Photos
P. 28	: Playback Media
P. 30	: WiFi Connection / APP Download
P. 31	: Transferring Media
P. 32	: Waterproof
P. 33	: Mounting the Camera
P. 34	: Video Settings
P. 38	: Photo Settings
P. 42	: Camera Tech Specs

About this Instruction Manual



Please read the safety instructions and the operating instructions carefully before use. Keep these instructions for renewed use at a later date. When the device is sold or given to someone else, the instruction manual must be provided to the new owner/user of the product.

Read these safety instructions before using your device and store them for possible future reference. This product is intended only for private use. It was developed as an electronic medium for the use of multimedia services.

Important Safety Instructions

- 1) Read these instructions.
- 2) Keep these instructions.
- 3) Heed all warnings.
- 4) Follow all instructions.
- 5) Store the device in cool, dry and dust-proof places.
- 6) The camera's body is designed to be waterproof to 15 feet. However, all doors must be secured to avoid any damages. Do not use this camera in water deeper than 15 feet (4.5 meters) unless it is securely enclosed in the waterproof housing.
- 7) Clean only with dry cloth.
- 8) Never touch the lens surface with your fingers.
- 9) Do not block any ventilation openings. Install in accordance with the manufacturer's instructions.
- 10) Never point the camera lens directly at the Sun. Doing so may damage the image sensor.
- 11) Do not place or store the device near any heat sources such as radiators, heat registers, stoves, or other apparatuses (including amplifiers) that produce heat.
- 12) Do not defeat the safety purpose of the polarized or grounding-type plug. A polarized plug has two blades with one wider than the other. A grounding type plug has two blades and a third grounding prong. The wide blade or the third prong are provided for your safety. If the provided plug does not fit into your outlet, consult an electrician for replacement of the obsolete outlet.
- 13) The charging cord should always be readily accessible.
- 14) While it is charging, keep the product and the power cord out of the reach of children to prevent accidental suffocation or electric shock.
- 15) Protect the power cord from being walked on or pinched particularly at plugs, convenience receptacles, and the point where they exit from the apparatus.
- 16) In case of overheating, smoke, or unpleasant smell in the process of charging, unplug your device immediately to prevent a fire.
- 17) If the charging cord is damaged, have it repaired by the manufacturer, its service or a similarly qualified person in order to avoid any hazard.
- 18) Replacing the battery incorrectly or with a battery that is not the same type or its equivalent could result in an explosion.
- 19) The battery should not be exposed to excessive heat such as sunlight, fire or any heat sources such as radiators, heat registers, stoves, or other apparatuses (including amplifiers) that produce heat.
- 20) The battery must be installed according to the polarity.
- 21) The battery must be disposed of safely. Always use the collection bins provided (check with your dealer) to protect the environment.

- 22) Non-rechargeable batteries are not to be recharged.
- 23) Rechargeable batteries must be removed from the unit before being charged, and should only be charged under adult supervision.
- 24) Do not short-circuit the supply terminals.
- 25) Only use attachments/accessories specified by the manufacturer or sold with the apparatus. When a cart is used, use caution when moving the cart/apparatus combination to avoid injury from tip-over.
- 26) Unplug this apparatus during lightning storms or when unused for long periods of time.
- 27) Refer all servicing to qualified service personnel. Servicing is required when the apparatus has been damaged in any way, such as the power supply cord or plug is damaged, liquid has been spilled or objects have fallen into the apparatus, the waterproof seal has been compromised, it does not operate normally, or has been dropped.
- 28) Do not expose the unit to strong magnetic objects or strong radio waves. Strong magnetic fields may cause product malfunctions or damage to images and sounds.
- 29) If the unit has not been operated in a long time, check whether the camera operates normally or not before using the camera again.
- 30) Always backup or download any data from any memory card before reusing. It is recommended that you test any memory card to make sure it is properly storing the data before any imaging session.
- 31) Please choose branded Micro SD card. Neutral cards are not guaranteed to work normally.
- 32) Do not place memory card near strong magnetic objects to avoid data loss.
- 33) Do not bend the memory card and avoid dropping or stressing the card.
- 34) Keep the memory card clean and avoid touching any liquids. If the memory card gets wet, wipe it dry with a soft cloth.
- 35) When the memory card is not in use, place it in a card sleeve.
- 36) Please note it is normal that the memory card will become hot after prolonged use.
- 37) Do not use the memory card with other digital cameras. If you want to use a different memory card with your camera, format it first.

General Warnings

- **Risk of choking!** — Keep packaging material, like plastic bags and rubber bands, out of the reach of children, as these materials pose a choking hazard. This product contains small parts that could be swallowed by children.
- **Leaking battery acid can lead to chemical burns!** Avoid contact of battery acid with skin, eyes and mucous membranes. In the event of contact, rinse the affected region immediately with plenty of water and seek medical attention.
- **Risk of electric shock!** — Never bend, pinch or pull the power and connecting cables, extensions and adapters. Protect the cables from sharp edges and heat. Before operating, check the device, cables and connections for damage. Never use a damaged unit or a unit with damaged power cables. Damaged parts must be exchanged immediately by an authorized service center.
- **Risk of property damage!** — Do not disassemble the device. In the event of a defect, please contact your dealer. The dealer will contact the service center and can send the device in to be repaired, if necessary.

- **Do not expose the device to high temperatures!** Use only the supplied power adapter. Do not short-circuit the device or throw it into a fire. Excessive heat or improper handling could trigger a short circuit, a fire or an explosion.

- **Do not interrupt an ongoing data connection to a computer before all data has been transferred!** This could lead to data loss for which the manufacturer is not liable.

CAUTION

RISK OF EXPLOSION IF BATTERY IS REPLACED BY AN INCORRECT TYPE.

Disposal of a battery into fire or a hot oven, or mechanically crushing or cutting of a battery, can result in an explosion.

Leaving a battery in an extremely high temperature environment can result in an explosion or the leakage of flammable liquid or gas.

A battery subjected to extremely low air pressure may lead to an explosion or the leakage of flammable liquid or gas.

Notes on Cleaning

Turn off the camera. Clean the eyepieces and/or lenses only with a soft, lint-free cloth, (e.g. microfiber cloth). To avoid scratching the lenses, use only gentle pressure with the cleaning cloth. Only use a dry cloth to clean the exterior of the device. To avoid damaging the electronics, do not use any cleaning fluid. Clean the protective case after each use with clear, clean water and dry it thoroughly.

Disposal



Dispose of the packaging materials properly, according to their type, such as paper or cardboard. Contact your local waste-disposal service or environmental authority for information on the proper disposal.



The integrated battery must only be removed for disposal. Opening the device housing can damage the unit. Drain the battery completely before disposal. Remove all the screws in the housing and open the device housing. Remove the connections to the battery and remove it. Cover the open contacts with tape and package the battery in such a way that it cannot shift in the packaging.



CAUTION: Changes or modifications not expressly approved by the party responsible for compliance could void the user's authority to operate the equipment. Note: This equipment has been tested and found to comply with the limits for a Class B digital device, pursuant to part 15 of the FCC Rules. These limits are designed to provide reasonable protection against harmful interference in a used in accordance with the instructions, may cause harmful interference to radio communications. However, there is no guarantee that interference will not occur in a particular installation. If this equipment does cause harmful interference to radio or television reception, which can be determined by turning the equipment off and on, the user is encouraged to try to correct the interference by one or more of the following measures:

- Reorient or relocate the receiving antenna.
- Increase the separation between the equipment and receiver.
- Connect the equipment into an outlet on a circuit different from that to which the receiver is connected.
- Consult the dealer or an experienced radio/TV technician for help.

This device complies with Part 15 of the FCC Rules. Operation is subject to the following two conditions: (1) this device may not cause harmful interference, and (2) this device must accept any interference received, including interference that may cause undesired operation.

FCC SAR statement

This equipment complies with FCC radiation exposure limits set forth for an uncontrolled environment. End user must follow the specific operating instructions for satisfying RF exposure compliance. This transmitter must not be co-located or operating in conjunction with any other antenna or transmitter.

The portable device is designed to meet the requirements for exposure to radio waves established by the Federal Communications Commission (USA). These requirements set a SAR limit of 1.6 W/kg averaged over one gram of tissue. The highest SAR value reported under this standard during product certification for use when properly worn on the body.

What's Included

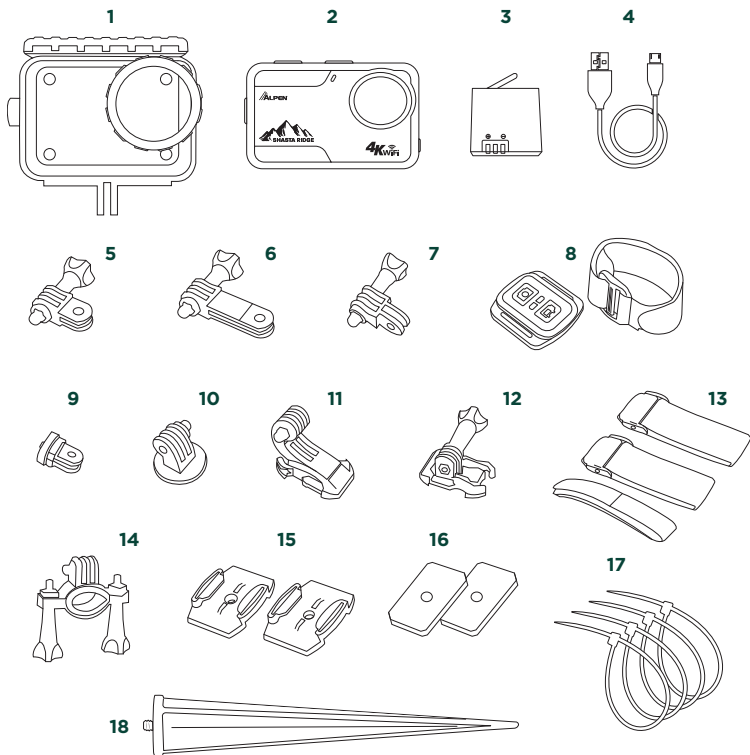

What's Included

1. Waterproof Case
2. 4K Wifi Action Camera
3. Rechargeable Battery
4. USB Cable
5. Short Pivot Mount w/Thumb Screw
6. Long Pivot Mount w/Thumb Screw
7. Pivot Mount w/Thumb Screw
8. Remote and Wrist Strap
9. Pivot Mount
10. Adapter
11. J-Hook Buckle Mount
12. Release Buckle Mount w/Thumb Screw
13. Straps
14. Handlebar/Pole Mount
15. Flat Adhesive Mounts
16. Adhesive Pads
17. Zip Ties
18. Ground Stake

Meet the Alpen 4K Camera

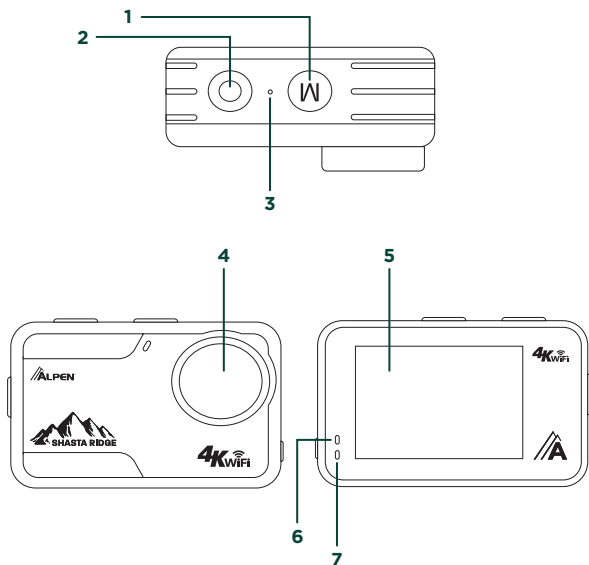

1. Mode Button
2. OK/Capture Button
3. Microphone
4. Camera Lens

5. 2.0" LCD Screen
6. Charging Indicator
7. Power On/Functioning Indicator

Meet the Alpen 4K Camera

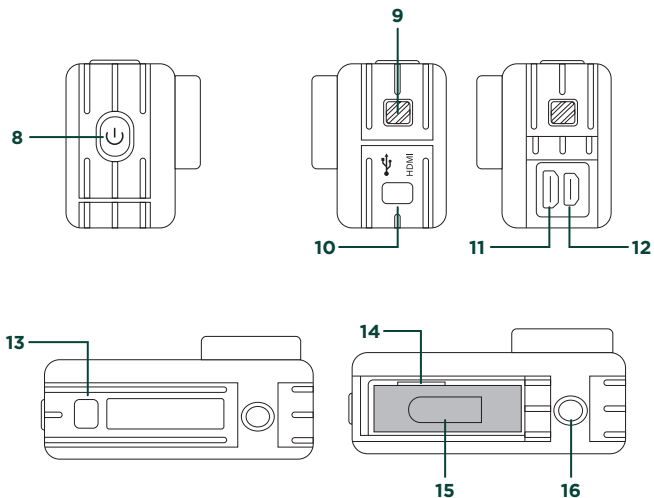

- 8. Power Button
- 9. Speaker
- 10. HDMI/USB Door
- 11. USB Port
- 12. HDMI Port

- 13. Battery Door
- 14. MicroFlash Card Slot
- 15. Battery
- 16. Tripod

Alpen 4K Camera Functions

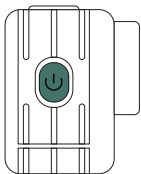

Power Button Functions

- Press and hold the Power button for 2 seconds to turn on and off the camera.
- Press the Power button to switch between Video and Photo modes.
- Acts as a down arrow on some menus.

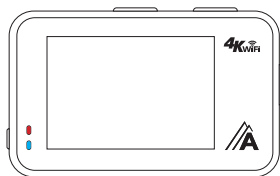

LED Indicators

- Top LED will show red during charging and will turn off once battery is fully charged.
- Bottom LED will show blue when power is on and will blink when recording video.

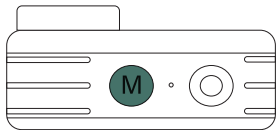

Mode Button Functions

- Press the Mode button to enter the mode menu.
- Scroll through the options by pressing the Mode button and press OK button to select.

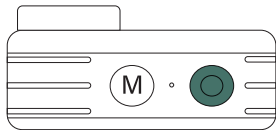

OK Button Functions

- Shutter function for video and photo modes.
- Hold the OK button to open Wifi. Press OK to exit Wifi.
- When in playback mode, OK button can be used to play/pause videos.

Using the Touch Screen

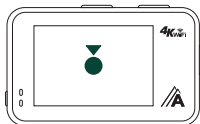

Tap

Select an item to turn it on or off.

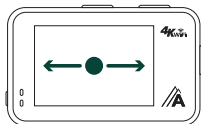

Swipe Left or Right

Switch between Video and Photo modes.

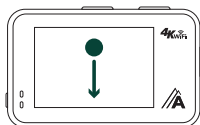

Swipe Down From Edge

Displays drop down menu.

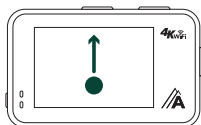

Swipe Up From Edge

Displays all camera modes.

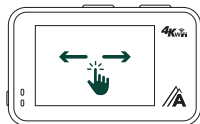

Press and Hold Swipe Left or Right

Advance video playback

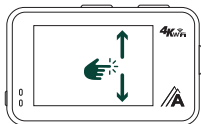

Press and Hold Swipe Up or Down

Adjust video's audio volume.

Setting Up Your Camera

Charging Camera

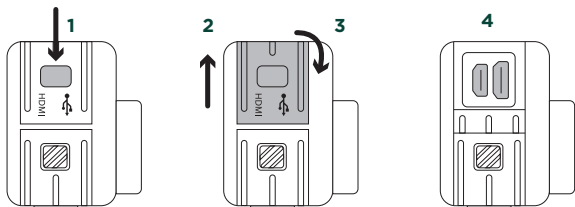

1. Press and hold button.
2. Slide door up.
3. Open door.
4. HDMI(left)/USB(right) Ports



WARNING: Your camera's body is designed to be waterproof. Make sure to correctly close the doors to avoid any damages.

To charge your camera, connect to a USB charger with the provided USB cable. If you are using a computer, you can plug the device into your computer and select Charging Mode on the screen.

It takes about 2 to 4 hours for the battery to fully charge. The camera status light will turn off when it is done.

Note: Camera will power on when connected with the USB cable. You can use the camera when charging or it can be powered off.

Setting Up Your Camera

Replacing Rechargeable Battery

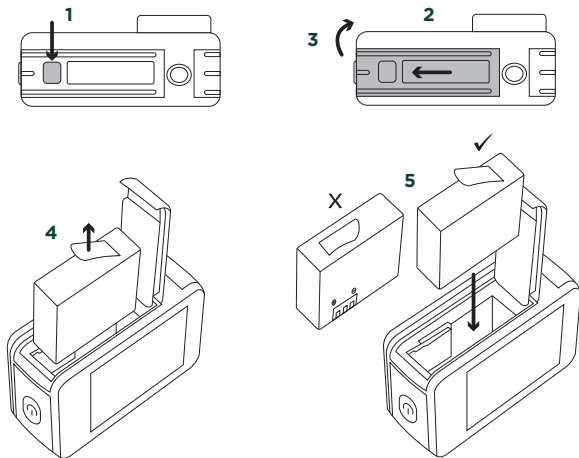

1. Press and hold button.
2. Slide battery door.
3. Open battery door.
4. Use the tab to pull out the battery.
5. Insert battery as shown with the (+/-) terminals facing away from the screen.



WARNING: Your camera's body is designed to be waterproof. Make sure to correctly close the doors to avoid any damages.

See page 4 for important battery information.

Setting Up Your Camera

MicroFlash Card Setup

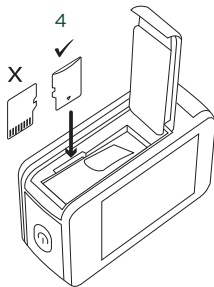
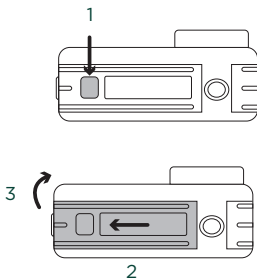

1. Press and hold button.
2. Slide battery door.
3. Open battery door.
4. Insert MicroFlash card correctly as shown. You can eject the card by lightly pressing it into the slot and then releasing. The card will pop out.



WARNING: Your camera's body is designed to be waterproof. Make sure to correctly close the doors to avoid any damages.

Your camera requires a MicroFlash Card (card not included) Class 10 or higher. For best performance, use brand name memory cards that meet these requirements:

- **microSD, microSDHC**
- **Class 10 speed rating**
- **Capacity up to 128GB**

Please turn off the camera before inserting or removing the memory card. When the memory card is first used, please make sure that the memory card is formatted first and keep your card in good condition by reformatting it regularly after all media is saved first.

See page 5 for important MicroFlash card information. Check the card manufacturer's guidelines to see your card's acceptable temperature range and other important information.

Using the Remote Control

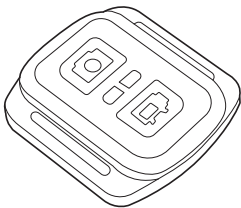

Your remote should already be paired to your camera. When using your remote you can choose between two functions.



Photo Mode

To take a picture you can simply press the red camera button on your remote. If you are in video mode, you can switch to photo mode simply by pressing the camera button and the system will switch automatically and take a photo.



Video Mode

To start recording you should press the grey video button on your remote. To stop recording simply press the button again. If you are in photo mode already if you press the video button it will automatically switch from photo mode to video mode and start recording.

Please note: The remote control operates off of a CR2025 3V battery.

Camera Settings

Customizing Camera Settings

Tap on Camera Setup (#7)  from the live preview screen or press on the  button on top of the camera and tap  to display the camera settings menu.

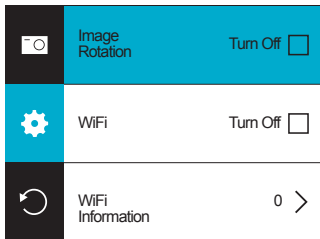

Image Rotation

When this option is turned on, the screen image will be rotated 180°.

WiFi

This option allows users to turn the wireless connectivity on and off. The option must be turned on to control the camera using the XDV PRO app.

WiFi Information

This option provides the camera name and password information that a user needs to connect to the device and the app.

Reset WiFi

The option is used to reset the WiFi function.

Light Frequency

There are three light frequencies to choose from: Auto, 50 Hz and 60 Hz. Adjustments to the light frequency setting can impact how much flicker appears when you play back content on a TV. 60Hz is the standard in North America, and 50Hz is the standard outside North America.

LED Indicator

This option turns the blue LED indicator on or off.

Auto Screensaver

This option can be used to change or disable the automatic screensaver.

Camera Settings

When on, the screen will go black after a set period of 30 seconds, 1 minute or 2 minutes. To resume using the camera, tap on the screen and slide the lock icon from the left to the right.

Auto Power OFF

This option can be used to change or disable the automatic power off feature. When on, the camera will power off after a set period of 3 minutes, 5 minutes or 10 minutes.

Button Prompt

This option sets the volume level for the audible tone heard when a button is pressed. It can also be used to turn this alert sound off.

Language

This option sets the language for the camera prompts.

Time Format

Users can select between three different date formats using this setting. Options are YYYY/MM/DD, MM/DD/YYYY or DD-MM-YYYY.

Time Set

To set the time: enter the hour first (using a 24-hour format), then press the OK button. Then, set the minute and press the OK button. Finally, select the appropriate second and press OK. When finished, tap the checkmark in the top right corner to exit the screen.

Date Set

To set the date: enter the year first, then press the OK button. Then set the month and press the OK button. Finally, select the day of the month and press OK. When finished, tap the checkmark in the top right corner to exit the screen.

Format

This option is used to format a microflash card prior to use.

Device Info

This option provides details on the operating software.

Factory Reset

This option will return all settings to the factory settings.

Using Your Camera



WiFi

OFF ON



Microphone

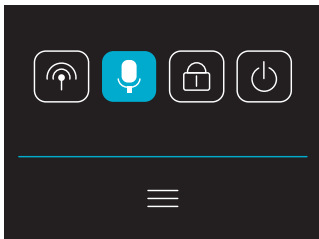

Lock Screen



Power OFF

Dropdown Menu Screen

The Dropdown Menu Screen gives users quick access to essential functions. To reach the Dropdown Menu, simply swipe down from the top of the touchscreen. From this menu, users can turn the wireless connection on and off, turn the microphone on and off, lock the screen or power down the camera.



Unlock Screen

If the screen is in Lock mode, tap the screen once to bring up the screen image above. To unlock, use your finger to slide the left lock icon to the right. This will open the screen and allow you to access all of the camera's functions.

Using Your Camera

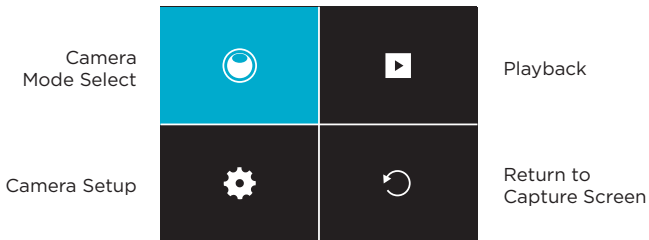

Shortcut Menu Screen

The Shortcut Menu Screen can be accessed by pressing the Mode button. You can then navigate between the four menu options by pressing Mode until the option you want is highlighted in blue. To select the option highlighted in blue, press the OK button. The function of each option is detailed below:

Camera Mode Select	Displays photo and video capture mode options.
---------------------------	--

Camera Setup	Displays camera settings for the current capture modes.
---------------------	---

Playback	Displays captured photos and videos.
-----------------	--------------------------------------

Return to Capture Screen	Returns to the live preview screen.
---------------------------------	-------------------------------------

Using Your Camera

Live Preview Screen

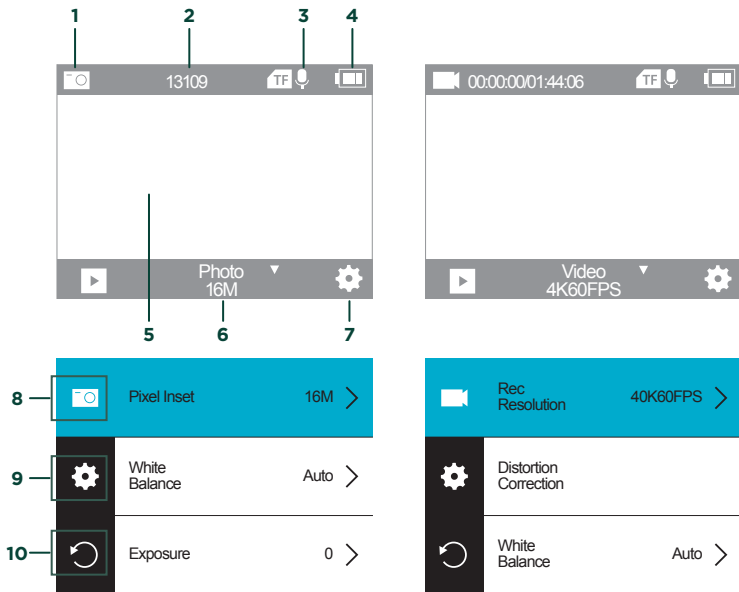

1. Camera Mode
2. Photos or Record Time Remaining
3. Microphone On
4. Battery Status
5. Capture Screen
6. Photo or Video Options
7. Camera Setup
8. Photo or Video Settings Menu
9. Camera Setup Menu
10. Return to Capture Screen

Using Your Camera

Changing Capture Mode

Tap on the Photo or Video Options (#6) from the live preview screen or press on the **M** button on top of the camera and tap . All modes will be displayed.

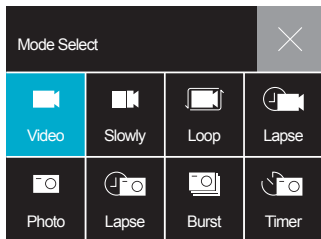

Video

Records Videos

Slowly

Records videos in slow motion.

Loop

Records in set time interval until stopped.

Lapse

Records a timelapse video.

Photo

Captures Photos

Lapse

Captures photos in set intervals ranging from 3 to 30 seconds.

Burst

Captures a quick set of 3, 5 or 10 photos.

Timer

Sets a period of 3, 5, 10 or 20 seconds to capture a photo.

To learn more, see page 24 for Video Presets and page 26 for Photo Presets.

Recording Video

Presets

Your camera comes with four video presets. Once you've chosen your preset, press the OK/Capture button  to start/stop recording.

Video

The "Video" preset is the standard recording mode. All resolutions are available in this mode.

Slowly

The "Slowly" preset records slow motion videos. Only four recording resolutions are available when operating the camera in slow motion video mode.

Loop

The "Loop" preset allows users to continuously record for a selected time interval of 2 minutes, 3 minutes or 5 minutes. If the video is not manually stopped prior to reaching the time limit, the camera will immediately start recording another video of the same length as soon as the current recording times out.

Lapse

The "Lapse" preset records timelapse videos in intervals ranging from 0.5 seconds to 60 seconds.

Recording Video

Customizing Video Settings

Tap on Camera Setup (#7) from the live preview screen to display the screen below. From this screen you are able to customize the settings per each mode.

To learn more, see page 34 for all Video Settings.

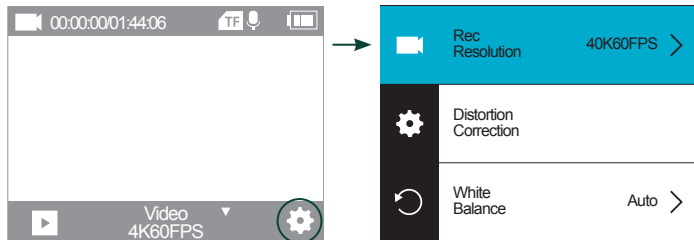

Default Settings

The chart below shows the default video settings. Any of these can be adjusted in the Camera Setup menu. Not all options are available for every video mode.

Rec Resolution	Distortion Correction	White Balance	Exposure	Metering Mode
4K30FPS	Off	Auto	0	Average Metering
Sharpness	Video Quality	ISO	Time Watermark	Rec Audio
Middle	Middle	Auto	Turn On	Turn On

Taking Photos

Presets

Your camera comes with four Photo presets. Once you've chosen your preset, press the OK/Capture button  to take a photo.

Photo

The "Photo" preset is the standard photo mode.

Lapse

The "Lapse" preset captures photos in set intervals of 3 seconds, 10 seconds, 15 seconds, 20 seconds or 30 seconds.

Burst

The "Burst" preset captures a rapid set of photos. The burst can be programmed to include 3 photos, 5 photos or 10 photos.

Timer

The "Timer" preset allows the user to set a timer of 3 seconds, 5 seconds, 10 seconds or 20 seconds to capture a photo. When the time expires, the photo will be taken automatically.

Taking Photos

Customizing Video Settings

Tap on Camera Setup (#7) from the live preview screen to display the screen below. From this screen you are able to customize the settings per each mode.

See to learn more, see page 38 for all Photo Settings.

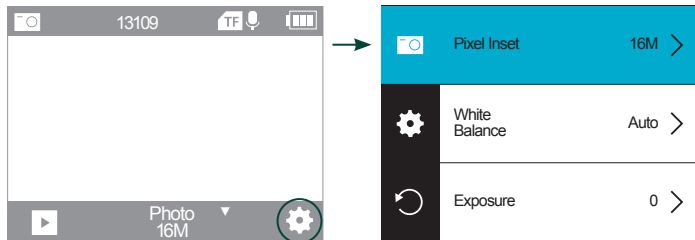

Default Settings

The chart below shows the default photo settings. Any of these can be adjusted in the Camera Setup menu. Not all options are available for every photo mode.

Pixel Inset	White Balance	Exposure	Metering Mode
16M	Auto	0	Average Metering
Sharpness	Long Exposure	ISO	Time Watermark
Middle	Auto	Auto	Turn On

Playback Media

Playing Back Your Media

To view all photos and videos, press on the **M** button on top of the camera and tap  to bring up your media.

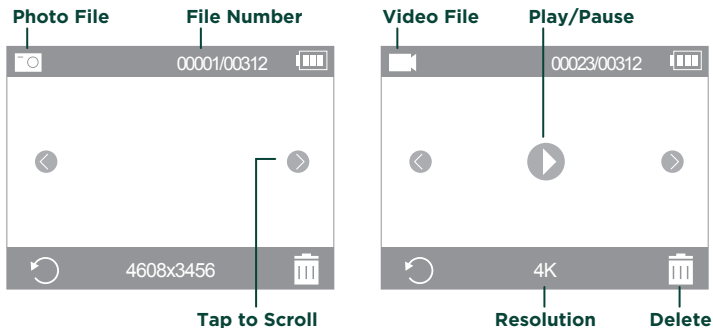

Button Playback Functions:

During playback, the camera buttons perform distinct functions:

Press the Mode button to scroll through saved media files.

Press the OK button to play or pause a video.

Hold the OK button to get a delete prompt for the current media file.

To return to the live screen, press the Power button.

Touchscreen Playback Functions:

When in playback mode, tap the arrows on the touchscreen to scroll through the saved media files. On videos, tap the large center arrow to play.

To delete a video touch the trash can icon.

To find out file information, such as date stamp or video length, tap the resolution information at the bottom of the media file.

Playback Media

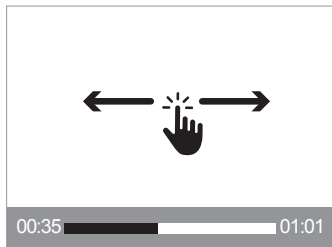

Advance Video

The touchscreen allows users to navigate videos with the touch of a fingertip. To advance the video, press and hold then swipe right. To rewind, press and hold then swipe left.

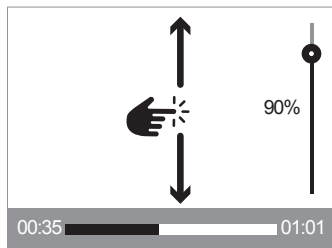

Volume Control

During playback, users can control the volume using the touchscreen. Press and hold, then swipe up to increase or swipe down to decrease volume.

Connecting to a TV

To view videos and images on a television or monitor, connect the camera to the device using a mini-HDMI cable. Once connected, the screen on the camera will go black. Users can control the play back using the buttons or by watching the tv/monitor screen to navigate the touchscreen.

WiFi Connection

Turning ON/OFF WiFi

Before using the WiFi function, please install the **XDV PRO** app on your Android or Apple iOS smart device and follow these steps:

1. Swipe down from the top edge of the screen to bring up the Dropdown Menu. Tap the WiFi icon  .

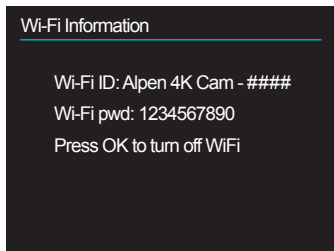

2. Using your smart device's WiFi settings, locate the camera's WiFi connection. It will appear as **Wi-Fi ID: Alpen 4K Cam -** followed by 4 random numbers. The default password is **1234567890**.
3. Once connected, the XDV PRO app can be used to view images in real time. It can also be used to control the camera's video functions, take photos and videos, and download content directly to your device.

WiFi signal not stable?

The WiFi signal is susceptible to interference, make sure the phone is not held too far away from the camera to prevent loss of signal.

Unable to connect to WiFi?

First, make sure your smart device's WiFi is turned on. Press the power button on the camera and press and hold the OK button to activate wireless function. The WiFi logo will appear on the screen. If there is no connection, it is recommended to power off and power on both the camera and your smart device and repeat the steps.

Transferring Your Media

Connecting to Computer

The camera can be connected to a computer using the provided USB cable. Once connected, a menu will pop up showing two options: Charging Mode and Mass Storage Mode.

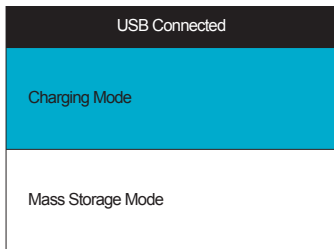

Charging Mode:

When in Charging Mode, users can still take photos and/or videos and access the other functions.

Mass Storage Mode:

When Mass Storage Mode is selected, a connection icon will appear on the camera screen. No camera functions are available in this mode. On the connected computer, the camera will pop up as an external hard drive. Users can open the drive to access the stored photo/video files. Files can be copied to the connected computer or even deleted. Please note: Deleting a file from the camera drive on a computer WILL delete the file from the device as well. Be sure to follow the hard drive ejection protocols for your computer before physically disconnecting the cable from the computer.

Waterproof

To ensure it is ready to go rain or shine wherever the action takes you, the Shasta Ridge camera is waterproof up to 15 feet (4.5 meters) on its own and up to 100 feet (30 meters) when inside the waterproof case.

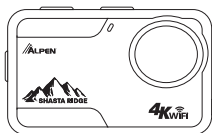

Camera Only = 15 ft / 4.5 m waterproof

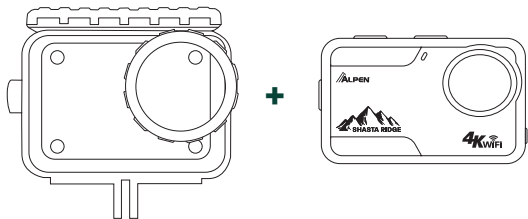

Case and Camera = 100 ft / 30 m waterproof



WARNING: Your camera's body is designed to be waterproof. Make sure to correctly close the doors to avoid any damages.

Mounting Your Camera

Stick On Mounting

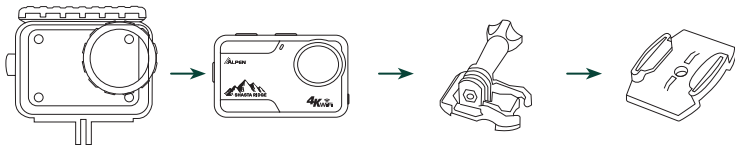

Pole/Bar Mounting

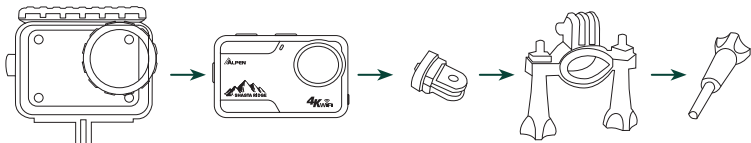

Ground Stake Mounting

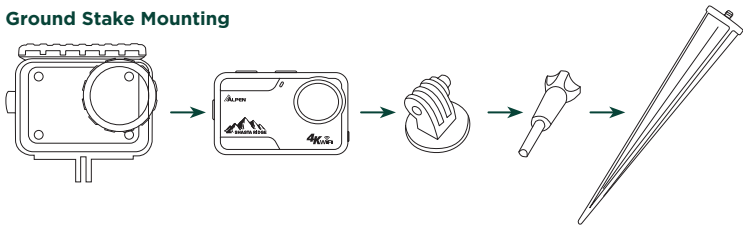

See page 8 for What's Included.

Video Settings

See page 22 on How to Change Settings.

Video Mode

Rec Resolution	<ul style="list-style-type: none"> • 4K 60FPS • 4K 30FPS • 2.7K 30FPS • 1080P 120FPS • 1080P 60FPS • 1080P 30FPS • 720P 240FPS • 720P 120FPS • 720P 60FPS • 720P 30FPS
Distortion Correction	n/a
White Balance	Auto / Sunny / Cloudy / Incandescent / Fluorescence
Exposure	-3 / -2 / -1 / 0 / +1 / +2 / +3
Metering Mode	Average Metering / Center Metering / Spot Metering / Matrix Metering
Sharpness	High / Middle / Low
Video Quality	High / Middle / Low
ISO	Auto / 100 / 200 / 400 / 800 / 1600 / 3200 / 6400
Time Watermark	Turn ON / OFF
Rec Audio	Turn ON / OFF

Video Settings

See page 22 on How to Change Settings.

Slowly Mode

Slowly Rec	<ul style="list-style-type: none">• 1080P 4X• 1080P 2X• 720P 8X• 720P 4X
White Balance	Auto / Sunny / Cloudy / Incandescent / Fluorescence
Exposure	-3 / -2 / -1 / 0 / +1 / +2 / +3
Metering Mode	Average Metering / Center Metering / Spot Metering / Matrix Metering
Sharpness	High / Middle / Low
Video Quality	High / Middle / Low

Video Settings

See page 22 on How to Change Settings.

Loop Mode

Rec Resolution	<ul style="list-style-type: none"> • 4K 60FPS • 4K 30FPS • 2.7K 30FPS • 1080P 120FPS • 1080P 60FPS • 1080P 30FPS • 720P 240FPS • 720P 120FPS • 720P 60FPS • 720P 30FPS
Video Length	2 min / 3 min / 5 min
Distortion Correction	n/a
White Balance	Auto / Sunny / Cloudy / Incandescent / Fluorescence
Exposure	-3 / -2 / -1 / 0 / +1 / +2 / +3
Metering Mode	Average Metering / Center Metering / Spot Metering / Matrix Metering
Sharpness	High / Middle / Low
Video Quality	High / Middle / Low
ISO	Auto / 100 / 200 / 400 / 800 / 1600 / 3200 / 6400
Time Watermark	Turn ON / OFF
Rec Audio	Turn ON / OFF

Video Settings

See page 22 on How to Change Settings.

Lapse Mode

Rec Resolution	<ul style="list-style-type: none"> • 4K • 2.7 • 1080P • 720P
Rec Interval	0.5s / 1s / 2s / 5s / 10s / 30s / 60s /
Distortion Correction	n/a
White Balance	Auto / Sunny / Cloudy / Incandescent / Fluorescence
Exposure	-3 / -2 / -1 / 0 / +1 / +2 / +3
Video Length	Unlimited / 6s / 8s / 10s / 20s / 30s / 60s / 120s
Metering Mode	Average Metering / Center Metering / Spot Metering / Matrix Metering
Sharpness	High / Middle / Low
Video Quality	High / Middle / Low
ISO	Auto / 100 / 200 / 400 / 800 / 1600 / 3200 / 6400

Photo Settings

See page 22 on How to Change Settings.

Photo Mode

Pixel Inset	<ul style="list-style-type: none">• 16M (4608 x 3456)• 13M (4160 x 3200)• 8M (3264 x 2448)
White Balance	Auto / Sunny / Cloudy / Incandescent / Fluorescence
Exposure	-3 / -2 / -1 / 0 / +1 / +2 / +3
Metering Mode	Average Metering / Center Metering / Spot Metering / Matrix Metering
Sharpness	High / Middle / Low
Long Exposure	Auto / 2s / 5s / 10s / 15s / 20s / 30s
ISO	Auto / 100 / 200 / 400 / 800 / 1600 / 3200 / 6400
Time Watermark	Turn ON / OFF

Photo Settings

See page 22 on How to Change Settings.

Lapse Mode

Pixel Inset	<ul style="list-style-type: none"> • 16M (4608 x 3456) • 13M (4160 x 3200) • 8M (3264 x 2448)
Photo Interval	3s / 10s / 15s / 20s / 30s
White Balance	Auto / Sunny / Cloudy / Incandescent / Fluorescence
Exposure	-3 / -2 / -1 / 0 / +1 / +2 / +3
Metering Mode	Average Metering / Center Metering / Spot Metering / Matrix Metering
Sharpness	High / Middle / Low
ISO	Auto / 100 / 200 / 400 / 800 / 1600 / 3200 / 6400
Time Watermark	Turn ON / OFF

Photo Settings

See page 22 on How to Change Settings.

Burst Mode

Pixel Inset	<ul style="list-style-type: none">• 16M (4608 x 3456)• 13M (4160 x 3200)• 8M (3264 x 2448)
Burst Count	3P/s / 5P/s / 10P/s
White Balance	Auto / Sunny / Cloudy / Incandescent / Fluorescence
Exposure	-3 / -2 / -1 / 0 / +1 / +2 / +3
Metering Mode	Average Metering / Center Metering / Spot Metering / Matrix Metering
Sharpness	High / Middle / Low
ISO	Auto / 100 / 200 / 400 / 800 / 1600 / 3200 / 6400
Time Watermark	Turn ON / OFF

Photo Settings

See page 22 on How to Change Settings.

Timer Mode

Pixel Inset	<ul style="list-style-type: none"> • 16M (4608 x 3456) • 13M (4160 x 3200) • 8M (3264 x 2448)
Countdown	3s / 5s / 10s / 20s
White Balance	Auto / Sunny / Cloudy / Incandescent / Fluorescence
Exposure	-3 / -2 / -1 / 0 / +1 / +2 / +3
Metering Mode	Average Metering / Center Metering / Spot Metering / Matrix Metering
Sharpness	High / Middle / Low
ISO	Auto / 100 / 200 / 400 / 800 / 1600 / 3200 / 6400
Time Watermark	Turn ON / OFF

Camera Tech Specs

CPU	V316
Sensor	IMX386
Lens	170 degrees wide-angle
Screen	2.0-in LCD
App	XDV PRO; Andriod & iOS
Waterproof(w/o case)	up to 15ft (4.5m)
Waterproof(w/ case)	up to 100ft (30m)
Languages	English/Traditional Chinese/Simplified Chinese/ Japanese/Korean/Russian/German/French/ Italian/Portuguese/Spanish/Thai
Photo Format	JPEG
Video Format	MP4
Video Compression Format	H.264
Storage	Micro Flash up to 128 GB
Speaker & Mic	Built-in

Camera Tech Specs

Battery	Rechargeable Li-ion 3.7V  1050mAH
Recording Time	About 60 minutes (at 4K)
Charging Time	About 2 - 4 hours
WiFi	2.4G
USB Connection Port	Micro USB 2.0
HDMI Connection Port	Micro HDMI
Computer Support	Windows and Mac



©2021 Alpen Optics
1010 S. 48th Street, Springdale AR 72762.
All rights reserved. Made in China.
bresserusa.com | alpenoptics.com
866.252.3811

Contents, colors and specifications may vary.