

Craft-A-Flower:
Saffron Layering Die Set
LAYERING GUIDE

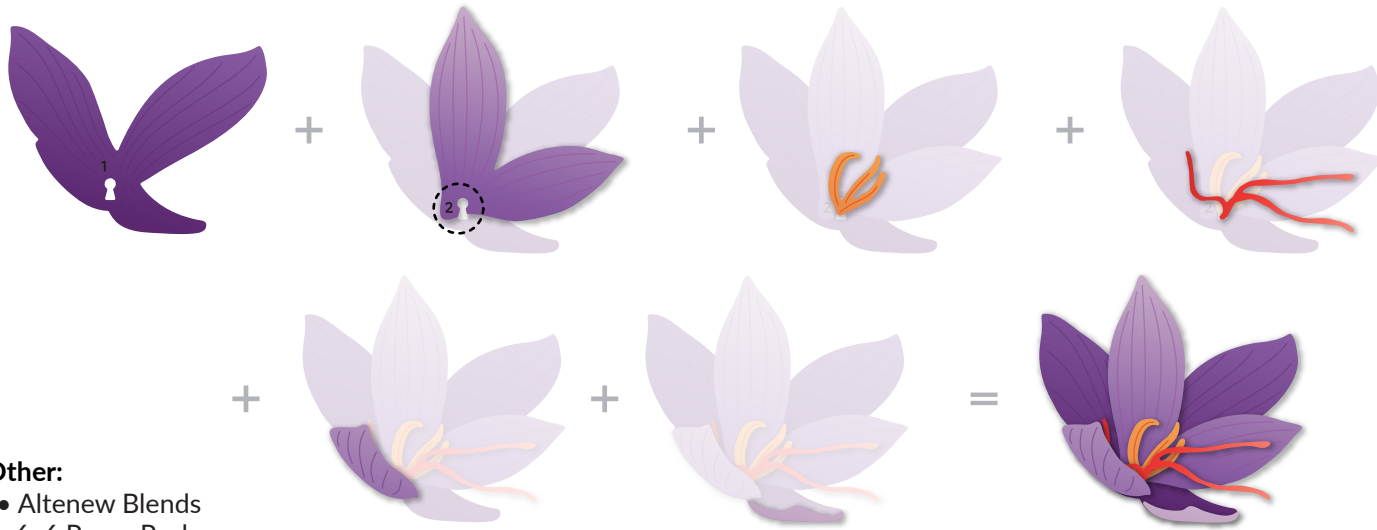

Other:
• Altenew Blends
6x6 Paper Pack

Designer's Tips:

Remove the stamen (also known as threads) layer and substitute with three strands of red embroidery floss. This will result in an even more realistic effect!

Try ink blending white cardstock before you die cut, varying the depth and tone. Once the elements are cut, you can further enhance the colors by deepening the center of each petal with additional ink blending.

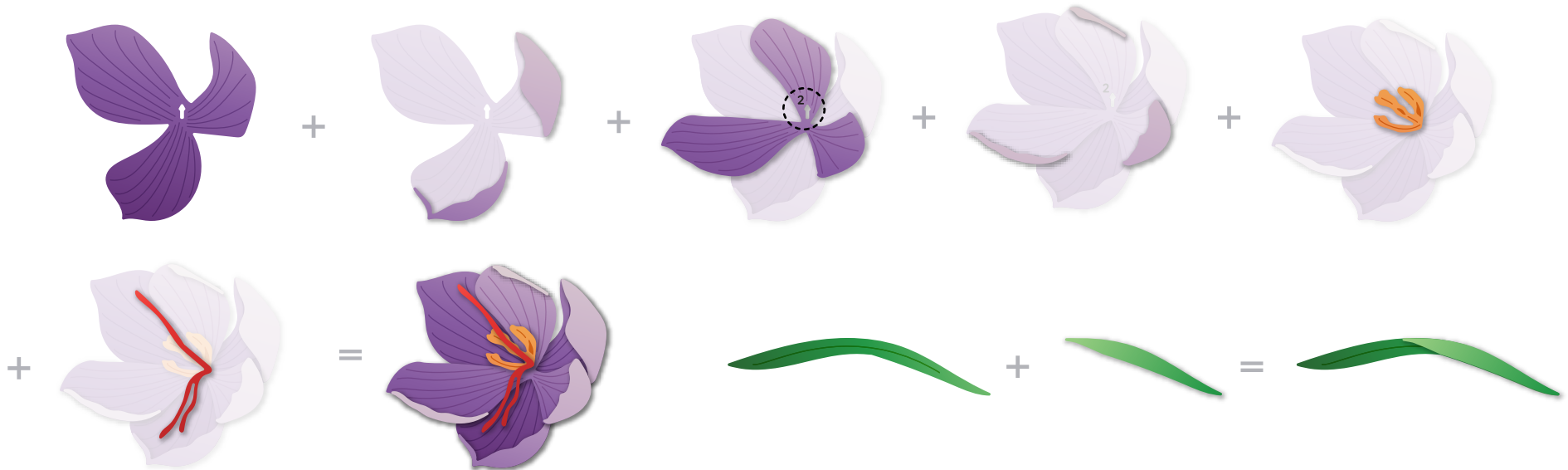

*50% actual size