

**Build-A-Garden:**  
**Esplanade Flowers Stamp & Stencil Set**  
**LAYERING GUIDE**

**Inks:**

- Obsidian
- Soft Lilac
- Lavender Fields
- Deep Iris
- Midnight Violet
- Firefly
- Grass Field
- Shadow Creek

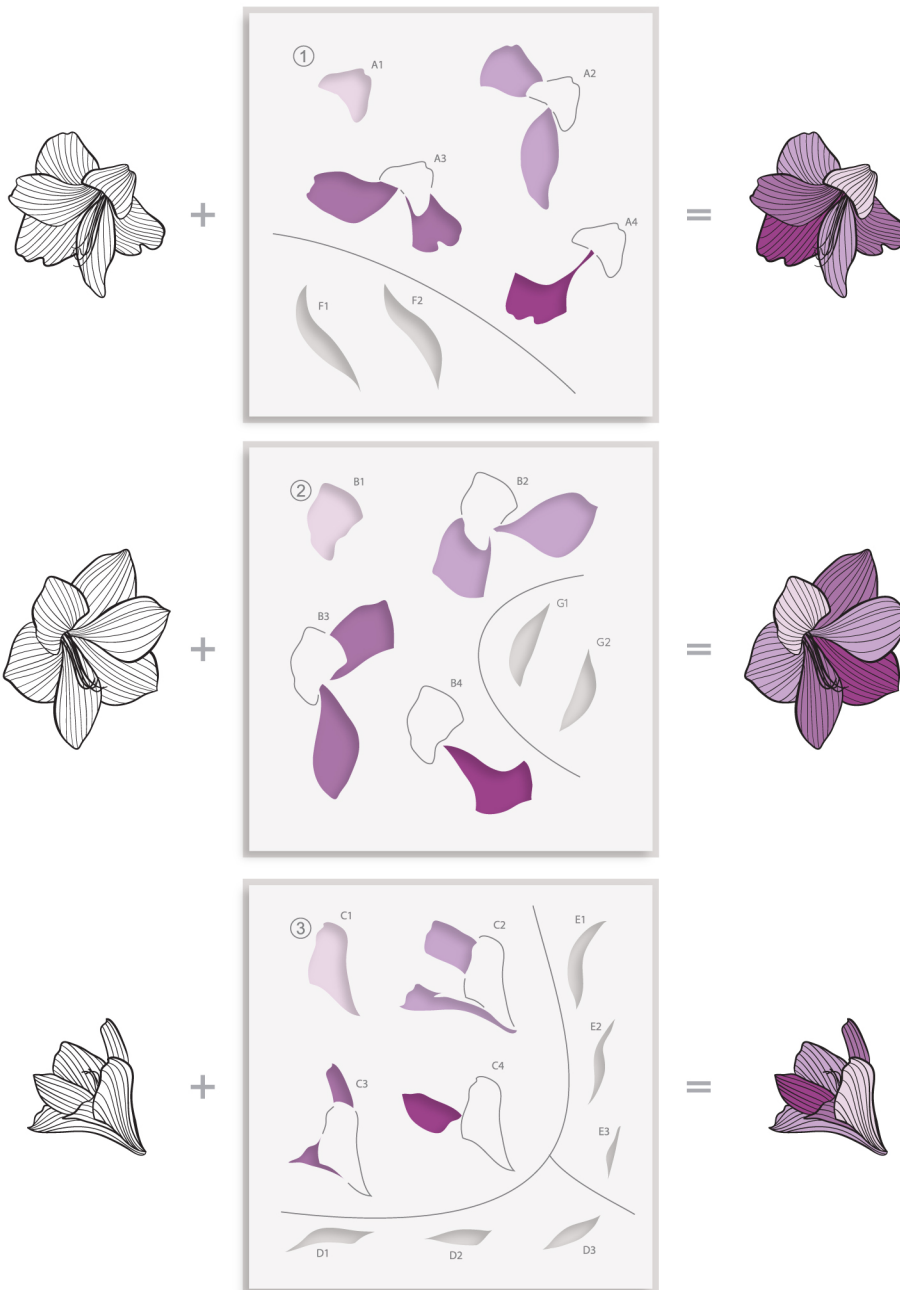

\*35% actual size  
Page 1 of 2

## Build-A-Garden: Esplanade Flowers Stamp & Stencil Set

### LAYERING GUIDE



#### Designer's Tips:

Vary your design by stamping just the outlines, or add in the optional linear elements. You can also omit the outlines and use the inner lines to add detail to the stenciled images. Mix and match techniques for a unique look!

Create additional depth on your project by die cutting each element along with 4-5 coordinating cutouts from white cardstock. Stack and adhere them together before attaching to your card or layout!