

POLLINATOR GARDEN

BEGINNER'S GUIDE FOR MICHIGAN NATIVE PLANTS

Below is a rough layout for a sunny, pollinator-friendly native pollinator garden that anyone could grow in their own backyard. This lot is approximately 3'-4' wide and 7'-10' long but can be scaled to fit your available space.

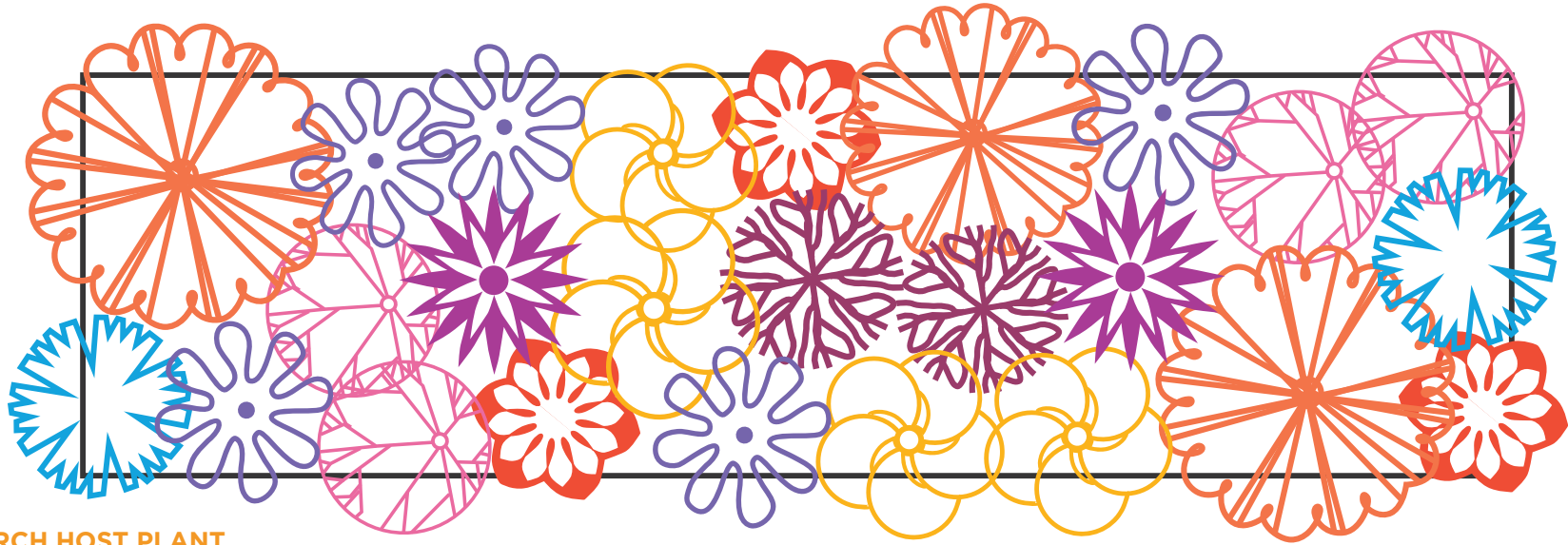

MONARCH HOST PLANT



BUTTERFLY MILKWEED

Asclepias tuberosa
Orange
1'- 3' tall
June-July



ROSE MILKWEED

Asclepias incarnata
Pink
3'- 4' tall
June-August



NEW-ENGLAND ASTER

Aster novae-angliae
Purple
3'- 6' tall
Sept-Oct



MARSH BLAZING STAR

Liatris spicata
Pink
3'- 4' tall
July-August



WILD COLUMBINE

Aquilegia canadensis
Red
1'- 3' tall
May-July



BEARDTONGUE

Penstemon digitalis
White
3'- 4' tall
June-July



PURPLE CONEFLOWER

Echinacea Purpurea
Pink
3'- 4' tall
June-August



BLACK-EYED SUSANS

Rudbeckia hirta
Yellow
1'- 3' tall
June-Sept

WHERE TO PURCHASE:

WIEGAND'S NURSERY
Macomb, MI
www.wiegandsnursery.com

WILDTYPE NATIVE PLANT NURSERY
Mason, MI
www.wildtypeplants.com

FOGLER'S GREENHOUSE
Rochester, MI
www.foglersgreenhouse.com

PRAIRIE NURSERY
NATIVE PLANTS & SEEDS
www.prairienursery.com

for more pollinator friendly native plants and gardening info
please visit: www.rochestermi.org/pollinators

