

# Sweet 16 Woodturning Lathe

Converts to any of these configurations  
in under a minute !

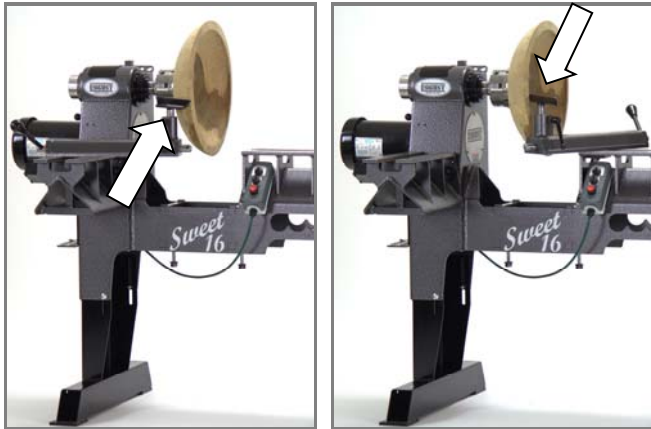

Above: Sweet 16 as a normal 16" lathe. Standard Bed Shown, Short & Long Beds also available



Above: Move the gap section to the headstock and turn up to 32" diameter. Move the tool rest to either side of the work.



Positioned the gap at the end of the bed to turn long spindles. Note banjo bridges gap.

General	
Model	<b>Sweet 16</b>
Weight	450 lbs. Short Bed, 460 lbs. Standard Bed, 480 lbs. Long Bed
Swing	16" normal configuration 32" with gap bed removed
Center Distance	Short: 14", 28" with gap as extension Standard: 24", 38" with gap as extension Long: 36", 50" with gap as extension
Spindle height	Adjustable from 42" to 49"
Items included	Faceplate; Robust cup style drive center and live center; 12 in. toolrest; knock-out rod; manual; tailstock quill extension
Options	Different Bed lengths; Vacuum adapter; Caster kit; 3, 4, 6, 9, 12 and 15" Toolrests; Curved tool rests; Tool & Tailstock Rack; Steady rest; 110 volt E-box; Foot "off" switch; Tilt Away™; Lamp set
Ways	304L Stainless Steel
Warranty	Seven year "head to tail" warranty includes everything, even the headstock bearings
Headstock	
Spindle	1-1/4" x 8 TPI pre-hardened aircraft grade 4140 chrome moly steel. Metric optional
Bore	#2 Morse Taper with thru-hole for vacuum
Indexing	48 position indexing
Spindle Lock	For added safety, engaging the spindle lock disconnects "on" switch
Spindle Bearings	Three heavy duty ball bearings each rated over 6,800 lb. dynamic load,
Tailstock	
	Weighs 35lbs. #2 Morse Taper - 3/8" through hole. Self-ejecting quill travels 3.5" Graduated in inches
Drive	
Motor	US made Leeson 1.5 or 2 HP. 1740 RPM, AC Totally enclosed, fan cooled.
Drive	US made Vector style variable frequency drive with constant torque and auto-tune
Speed Range	Variable: 60 - 2900 RPM – single pulley
Controls	Variable Speed, Forward, Reverse, Stop, Emergency Stop, Digital Readout.
Voltage	1.5HP in 110 or 220 VAC, 2HP in 220 VAC Both will operate 50 or 60 Hz.



Robust Tools, LLC  
[www.turnrobust.com](http://www.turnrobust.com)

20190312

Phone: 608-924-1133  
Email: [info@turnrobust.com](mailto:info@turnrobust.com)