

YAMAHA

SPINNING REEL

CROSSFIRE 5000

Please order by parts number, not key number
 Veuillez indiquer le numéro de la pièce (Non "Key" No.)

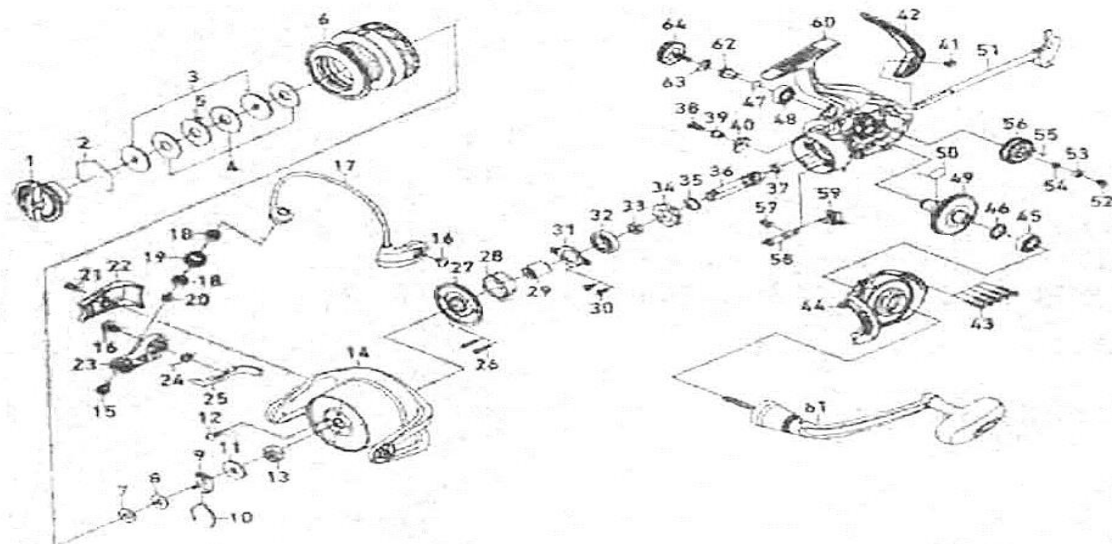

Key No.	Part No.	Part Name	Key No.	Part No.	Part Name
1	Q30-5801	DRAG KNOB	33	Q21-6301	COLLAR
2	F88-4001	DRAG WASHER RET	34	E26-2701	A/R RATCHET
3	H17-5101	KEY WASHER	35	Q21-6000	BEARING RETAINER
4	F75-5504	DRAG WASHER	36	Q29-0801	PINION GEAR
5	F75-5701	EARED WASHER	37	Q18-8501	COLLAR
2~6	Q30-5101	SPOOL ASSEMBLY	38	B00-8601	SCREW
7	F05-0100	WASHER	39	H35-4401	COLLAR
8	F05-0002	SPOOL WASHER	40	H24-3201	A/R PAWL
9	H17-4201	CLICK LEAF SPRING HOLDER	41	G27-0801	SCREW
10	F70-4902	SPOOL CLICK LEAF SPRING	42	Q18-9003	REAR COVER
11	F04-9901	WASHER	43	G41-0701	SCREW
12	G62-7701	SCREW	44	Q31-0701	SIDE COVER
13	H49-5901	ROTOR NUT	45	H73-5002	BALL BEARING
14	H17-3316	ROTOR	46	371-2800	WASHER
15	F60-8901	SCREW	47	H04-7201	RETAINER
16	G45-5601	BAIL ARM SCREW	48	H18-5201	BALL BEARING
17	Q24-5701	BAIL ASSEMBLY	49	H17-2803	DRIVE GEAR
18	H19-4701	COLLAR	50	H24-4401	SPRING
19	Q24-6101	LINE ROLLER	51	Q27-0701	MAIN SHAFT
20	H04-9901	COLLAR	52	Q18-8201	SCREW
21	G20-5101	SCREW	53	B86-1705	BALL BEARING
22	H17-3603	ARM LEVER COVER	54	Q21-6000	BEARING RETAINER
23	H17-3505	BAIL ARM	55	Q21-5901	O-RING
24	F60-8001	BAIL SPRING	56	Q21-5801	OSC GEAR
25	H17-3401	BAIL TRIP LEVER	57	H69-7801	A/R CAM SPRING
26	G83-7101	SCREW	58	Q21-5701	A/R CAM
27	Q21-6701	SEALED CAP	59	Q26-6701	A/R LEVER
28	J01-5701	ROLLER CLUTCH	60	Q31-0601	BODY
29	Q21-6601	SPACING SLEEVE	61	Q30-5001	HANDLE ASSEMBLY
30	Q21-9501	SCREW	62	F40-9001	HANDLE COLLAR
31	Q21-6101	BEARING RETAINER	63	160-8101	WASHER
32	G42-6301	BALL BEARING	64	Q18-9301	HANDLE SCREW