



SetPower

AJ Series

User Manual

V1.3

CONTENT

1.SAFETY INFORMATION	01
2.DESRIPTION	02
3.GETTING STARTED	03
4.FILLING	07
5.DEFROSTING	07
6.MAINTENANCE	07
7.CLEANING	07
8.SUGGESTIONS	08
9.GENERAL SAFETY MESSAGES	08
10.NOTICE	08
11.FAULTS	09

1.SAFETY INFORMATION

Please read this operating manual carefully before starting the appliance. Keep it in a safe place for future reference. If the appliance is passed on to another person, this instruction manual must be handed over to the user along with it.

The manufacturer cannot be held liable for damage resulting from improper usage or incorrect operation.

WARNING

- This appliance is not intended for use by persons (including children) with reduced physical, sensory or mental capabilities, or lack of experience and knowledge, unless they have been given supervision or instruction concerning use of the appliance by a person responsible for their safety.
- Children should be ensured that they do not play with the appliance.
- Cleaning and user maintenance shall not be carried out by children without supervision.
- Do not store explosive substances such as aerosol cans with a flammable propellant in this appliance.
- Do not use this appliance near direct heat sources, for example, a cooker, radiator or exposing it to direct sunlight.
- The appliance shall not be exposed to rain. Place the refrigerator on a dry, protected surface, away from edges.
- Do not use an extension cord.

NOTICE

- No responsible for the damage by ignoring the safety instructions SetPower.
- The use of accessories that are not recommended by SetPower can cause injuries and will invalidate any warranty that you may have.
- Place the products so that they do not collide against each other or break when the appliance is in motion.
- If the supply cord is damaged, it must be replaced by the manufacturer, its service agent or similarly qualified persons in order to avoid a hazard.
- Disconnect the power cable from the plug before carrying out any maintenance.
- Do not place carbonated drinks and gaseous drinks under 0°C(32°F) in this appliance.

INTENDED TO USE

This appliance is intended to be used in household and similar applications such as:

- Staff kitchen areas in shops, of fces and other working environments.
- Farm houses and by clients in hotels, motels and other residential type environments.
- Bed and breakfast type environments.
- Catering and similar non-retail applications.

CAUTION

- Keep ventilation openings, clear of obstruction in the appliance enclosure or in the built-in structure.
- Do not use electrical appliances inside the food storage compartments of the appliance, unless they are of the type recommended by SetPower.
- Do not place ice or liquids which are not sealed in containers within the refrigerator.
- Do not place hot products or hot food in this appliance.

CORRECT DISPOSAL OF THIS PRODUCT:

To prevent possible harm to the environment or human health from uncontrolled waste disposal, recycle it responsibly to promote the sustainable reuse of material resources. To return your used device, please use the recovery systems or contact the retailer that they can take this product for environmental safe recycling.

DANGER

- Risk of child entrapment.

Before you throw away your old refrigerator or freezer:

- Take off the doors.
- Leave the shelves in place so that children may not easily climb inside.

2. DESCRIPTION

Please read these instructions and the Safety section carefully before using your refrigerator.

AJ30 Series

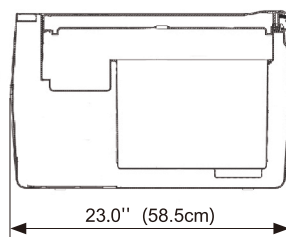
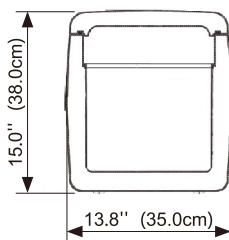

AJ40 Series

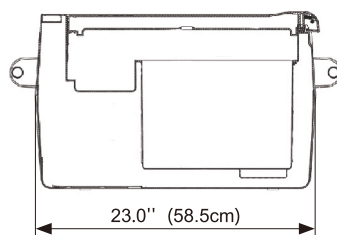
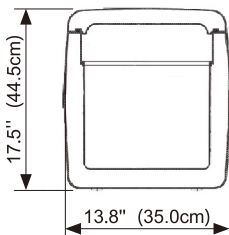

AJ50 Series

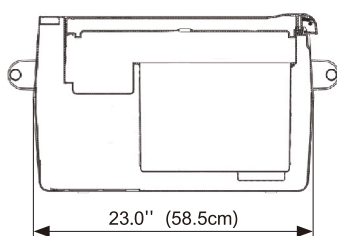
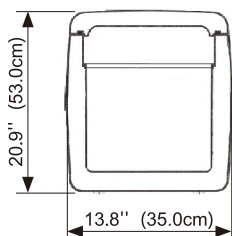

AC ADAPTER

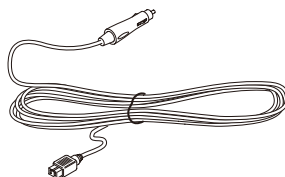

DC CONNECTION CABLE

MODEL	AJ30	AJ40	AJ50
Dimensions HxLxW	15.0 x 23.0 x 13.8(inch)	17.5 x 23.0 x 13.8(inch)	20.9 x 23.0 x 13.8(inch)
	38.0 x 58.5 x 35.0(cm)	44.5 x 58.5 x 35.0(cm)	53.0 x 58.5 x 35.0(cm)
Net Weight	28.0 lbs	30.0 lbs	33.1 lbs
	12.7 kg	13.6 kg	15.0 kg
Storage Volume	31.7 quarts	42.3 quarts	52.8 quarts
	30 liters	40 liters	50 liters
Voltage	DC 12/24V		
Refrigerant	R134a		
Temperature Range	-18°C to +10°C (0°F to 50°F)		

This appliance contains fluorinated greenhouse gas R134a within an hermetically sealed system and its operations depends on the presence of this gas.

3. GETTING STARTED

INSTALLATION

- Place the refrigerator on a dry, sheltered, flat surface and away from any edges. The refrigerator must not be used unsheltered, in the open air or exposed to splashing or rain.
- Your refrigerator requires good ventilation, especially around the back of the refrigerator, allow a gap of at least 15 cm around the sides, back and top. Never use your refrigerator in the boot of a car or against.
- Do not install the refrigerator near heat sources, sunlight.
- Should you need to leave the device under the sun for long periods, eg : in a car or in other vehicles, make sure you protect it, to prevent the cover plastic materials from getting damaged or warped.
- To fix it inside the car and to avoid damages during transport, we suggest to secure the fridge trough metal brackets placed on the sides.
- Avoid introducing liquids or ice not inserted in containers.
- Do not put hot food items into the refrigerator.
- Avoid using the refrigerator under the rain or in presence of water.

HANDLE INSTALLATION

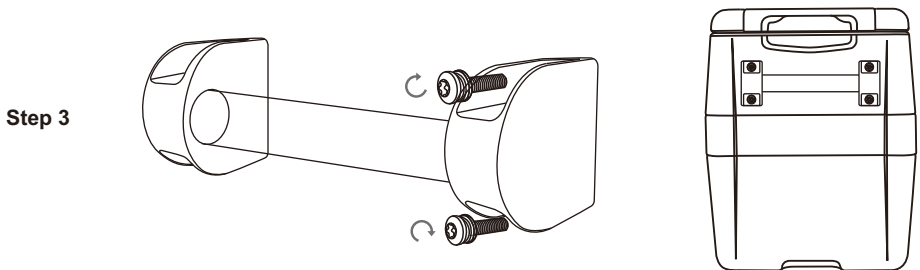
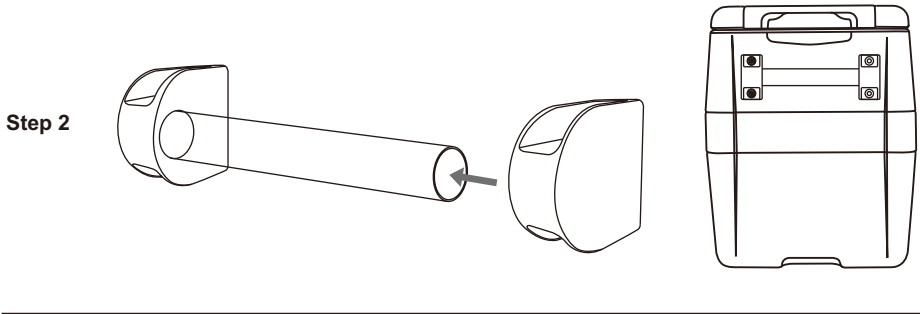
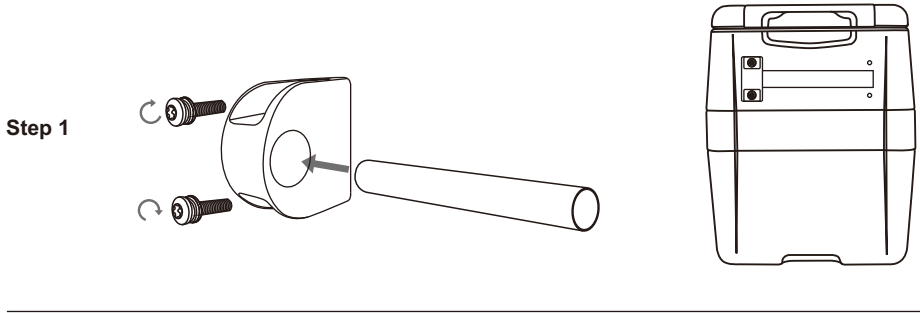
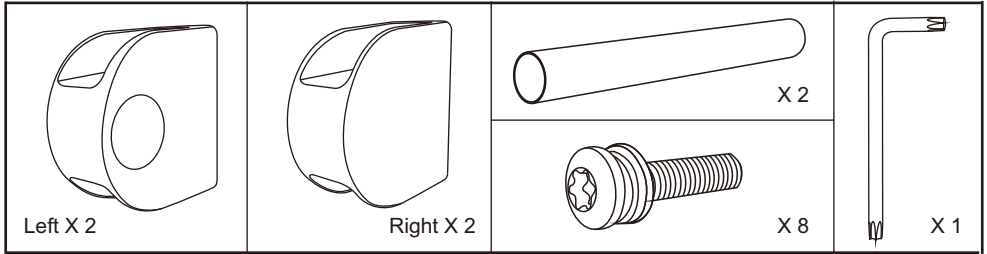

USE

You can visit our Youtube Channel

@official setpowerusa to watch tutorial video.

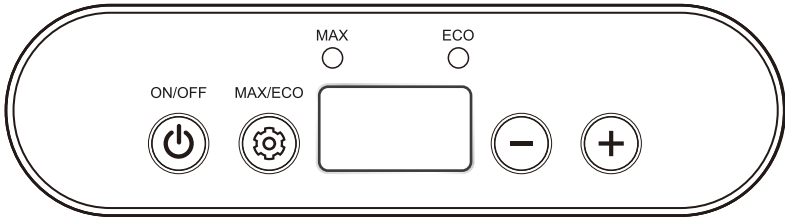

On/Off

- Plug in the DC or AC power. Press the button to turn on the unit. The screen on the control panel will light up and interior temperature will display.

Adjusting Temperature

- Press the button or to adjust the temperature. Press the button to increase while the button to decrease the temperature. Holding buttons can accelerate the process of temperature adjustment.

Max&Eco mode

- With the unit turn on, Press Button to toggle the operation mode.

Switch Between °F and °C

- When the unit is in stand-by mode (unit turned off but plugged into power), press and hold and Button at the same time for 3 seconds.

After seeing flashing C/F, press or to choose C (Celsius) or F (Fahrenheit).

Battery Protection Settings

- When the unit is in stand-by mode (unit turned off but plugged into power), press and hold Button and Button at the same time for 3 seconds.

Then, press or to adjust the protection level. There are 3 protection levels available, " == " refers to Middle Level, which is also the default value. " ≡≡ " means High Level, " -- " means Low Level.

Protection Level Power Source	Mid Level is the Default Setting					
	HIGH		MID		LOW	
	≡≡		==		--	
Display	Start-up	Cut-off	Start-up	Cut-off	Start-up	Cut-off
12V	12.4V	11.1V	11.7V	10.4V	10.9V	9.6V
24V	25.7V	24.3V	24.2V	22.8V	22.7V	21.3V

What is Battery Protection Settings

This function is designed to prevent over-discharge and battery depletion. When the measured DC voltage is below the Cut-off value, the compressor is shut off to prevent battery depletion. After the voltage is higher than Start-up value, the compressor will go back to work again. Improper protection setting or low-power battery may cause E1 error, please lower the battery protection or recharge the battery in time.

TIPS

1) Use the product in MAX mode in these cases:

- use of the product as refrigerator with high ambient temperature;
- when the suitable temperature need to be achieved in few time.

2) Use the product in ECO mode in these cases:

- use of the product as refrigerator and, in particular, with low ambient temperature;
- when the vehicle is parked for long time (with engine switched off)

USING THE REFRIGERATOR IN A VEHICLE

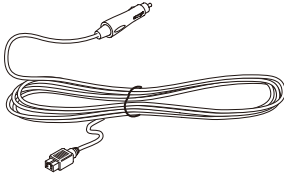

- Connect the feeding cable to a direct current 12 or 24 V DC power source.
- Make sure the polarity is right.
- The supply line is protected by a 15 A fuse located on the box.
- If connected to an existing cigarette plug, carefully check up that power supply is sufficient.
- If the supplied power cable is not used, see the table containing the information related to the cable section:

CABLE AREA mm ² (AWG)	MAX CABLE LENGHT METRES (ft)	
	12V	24V
2,5 (AWG 13)	2,5 (8 FT)	5 (16FT)
4 (AWG 11)	4 (13 FT)	8 (26 FT)
6 (AWG 9)	6 (20 FT)	12 (40 FT)

CUT IN / CUT OUT

- Your fridge has built in battery protection and needs a minimum 10.9 V to start and 9.6 V to continue operating.
- During operation a load is placed on the power supply and voltage can drop by as much as 2 V, especially if the wiring is insufficient (less than 6mm direct to battery) or if there is a loose connection somewhere.
- If this occurs when you try and start your SetPower and the power supply drops under 10.9 V it will not start.
If this occurs when your SetPower is running and the power supply drops below 9.6 V it will stop.

COMMON 12V POWER SUPPLY ISSUES

Wiring

Often the standard wiring from the car battery to the 12V outlet is too small. A minimum 6mm automotive wiring should be used and the earth should be wired directly back to the battery.

Battery

The car battery could be old, undersized or have a dead cell causing too much voltage drop.

Connections

The 12 V plug, car 12 V socket or any of the connections between the fridge and the battery could be faulty or have come loose since installation.

USING THE REFRIGERATOR AT HOME

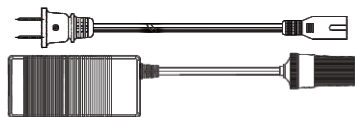

- This model can be fed equally using 12/24V or mains power 110 -120V (100 - 240V)AC.
- Can connect with 110-120V (100-240V) AC with AC Adapter.
- The refrigerator is provided with automatic switch over from one kind of feeding to the other.
- Should both be present at the same time, the device will always set itself on mains power priority feeding by 110 - 120V (100 - 240V) AC.

4.FILLING

Do not put hot food items into the refrigerator. Place the products in such a way as to avoid them hitting against each other or breaking because of the movement of the vehicle.

Make sure that the lid is always well closed and open it for as short a time as possible.

5.DEFROSTING

Defrosting is needed when the layer of frost is thicker than 4 mm.

To carry out this operation, turn off the refrigerator.

Do not use sharp or cutting tools to remove the layer of frost or ice.

Wait until complete unfreezing and then turn on again.

6.MAINTENANCE



Before carrying out any maintenance operation on the refrigerator, take the power cable out of its socket.

7.CLEANING

- Regularly clean the inside and outside of the refrigerator using only warm water and a neutral detergent.
- Subsequent to washing, rinse with clean water and dry thoroughly using a soft cloth.
- Do not use the following: special glass and mirror cleaning products, liquid, powder, or spray detergents, alcohol, ammonia or abrasive products.
- If you are not using the refrigerator, we suggest cleaning it well inside and leaving the door ajar to ventilate the interior.

8. SUGGESTIONS

Should the device fail to work or work badly, before referring to our after-sales service, make sure that:

- a) the feeding voltage is not missing;
- b) the voltage is the same as the one shown on the plate;
- c) the connections and the polarities are right;
- d) the airing grids are not covered over;
- e) the refrigerator unit is not near any heat source;
- f) the fuse of the feeding line is not blown.

9. GENERAL SAFETY MESSAGES



Failure to obey the following warnings could result in death or serious injury:

- **ELECTRICAL SHOCK HAZARD.** Do not immerse the product in water, or use it in an area that is excessively muddy.
- Do not use the cooler for any purpose other than as a mobile cooling device.



FALL HAZARD. Do not stand on the cooler. Doing so could damage the unit or cause minor to moderate injury.

10. NOTICE

Failure to obey the following notices could result in property damage:

- Keep sand or dirt away from the cooling system ventilation area.
- Do not leave the cooler on the deck of a boat for an extended period. Salt water damage to the cooling system, electronics, or metal hardware could occur.
- Do not expose the cooler to extreme heat.
- Only use mild soap and water to clean the cooler.
- Do not use a DC extension cord.
- Do not use a power strip or two-way splitter.
- Do not use power cord adapters of any kind other than those provided by the manufacturer.
- Do not use ice cubes or fill the cooler with water. If ice does accumulate at the bottom of the cooler, defrost the unit and use the drain plug to drain the water.
- Do not modify the unit in any way.
- Do not place hot materials (75 °F or higher) in the cooler. Allow materials to cool (50 °F or less) before placing them inside the cooler.
- Do not tip or store the cooler at an angle greater than 30° for extended periods. Compressor oil contamination of the cooling system could occur.
- Allow 2–4 inches of space around the cooler at all times for proper ventilation of the cooling system.
- The cooler must be secured at all times using straps or a mounting plate, especially in mobile applications.



The power supply cable must be replaced only by qualified technical personnel and in any case by an after sales service authorised by the Manufacturer.

SetPower is not liable in any way if you do not comply strictly with all the provisions in this manual.

This appliance is not intended for use by persons (including children) with reduced physical, sensory or mental capabilities, or lack of experience and knowledge, unless they have been given supervision or instruction concerning use of the appliance by a person responsible for their safety. Children should be supervised to ensure that they do not play with the appliance.

11. FAULTS

Number of flashes	Error type
E1	Battery protection cut-out (The voltage is outside the cut-out setting).
E2	Fan over-current cut-out (The fan loads the electronic unit with more than $1A_{\text{peak}}$).
E3	Motor start error (The rotor is blocked or the differential pressure in the refrigeration system is too high (>5 bar)).
E4	Minimum motor speed error (If the refrigeration system is too heavily loaded, the motor cannot maintain minimum speed 1,850 rpm).
E5	Thermal cut-out of electronic unit (If the refrigeration system has been too heavily loaded, or if the ambient temperature is high, the electronic unit will run too hot).
E6	Module fault.
E7	Thermal head fault (Open circuit or short circuit).

OUR GUARANTEE

SetPower product comes with a 3-year warranty on the compressor and 1 year warranty on all other parts for your peace of mind. In the unlikely event this product fails when used according to our user guide, we will either repair or replace it. For full warranty terms and conditions on this product, please see the user guide.

We'd welcome you contact us support@setpowerusa.com if you have any question about the product.

Quality Service Guarantee

This product is warranted for 3 years on the compressor and 1 year for all other parts from the date of purchase. Our goods come with guarantees that cannot be excluded under the Local Consumer Law. You are entitled to a replacement or refund for a major failure and compensation for any other reasonably foreseeable loss or damage. You are also entitled to have the goods repaired or replaced if the goods fail to be of acceptable quality and the failure does not amount to a major failure. Warranty does not cover products that have not been used in accordance with user guide or are outside the warranty terms and conditions.



official@setpowerusa.com

support@setpowerusa.com

SetPower

3-YEAR WARRANTY

