

User Manual

# Tripod Stand 2.0

Important: Read the user manual carefully  
and keep it for future use.



## What is Included?

- 1 Wooden top in walnut wood
- 6 tube assembly parts
- 3 tube assembly parts with finished ends ("feet")

## Assembly

The Stand is designed specifically for Moonboon's Baby Hammock, Twin Baby Hammock and Cradle. Use the Stand with or without the Moonboon Motor. The Stand has a maximum carry capacity of 28 kg (62 lbs).

The Stand is easy to assemble. No tools are needed.

1

Start by assembling the individual legs. Each leg has 3 tube assembly parts. Starting with the Foot-pipe, assemble one leg at a time. 1) Insert the metal shafts into the bearing. 2) Push the two parts together. 3) Twist into the locked position.

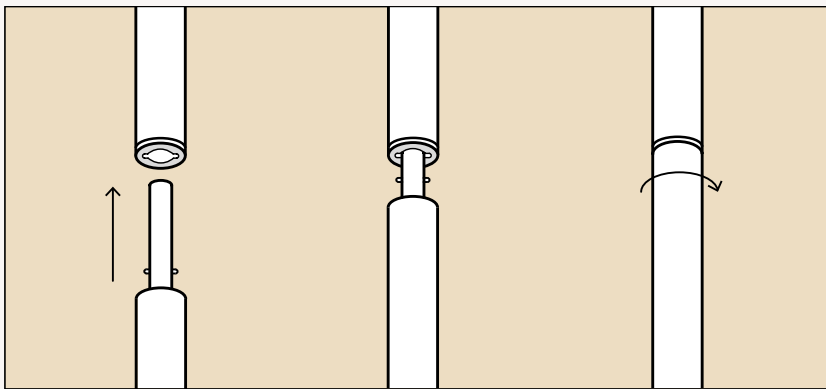

2

Attach the legs to the wooden top assembly with the eye bolt facing downwards. Ensure that each leg is firmly affixed and twisted into the locked position.

3

Firmly place the stand on the floor with the rubber soles of the flat-bottom feet on the floor surface. Place the legs as far apart as possible to achieve maximum balance. Avoid stressing the structure, and do not place the legs further apart than 130 cm (4.2 feet).

4

You are now ready to mount your Moonboon Baby Hammock, Twin Baby Hammock, Cradle or Moonboon Motor. See the next section for details.

### Please note

The Tripod Stand 2.0 may only be placed on a flat floor. Maximal permitted slope of the floor is 0.15 degrees.

Requirements for flatness are max. 2 mm (1/16 inch), measured at 2 meters (6.5 feet).

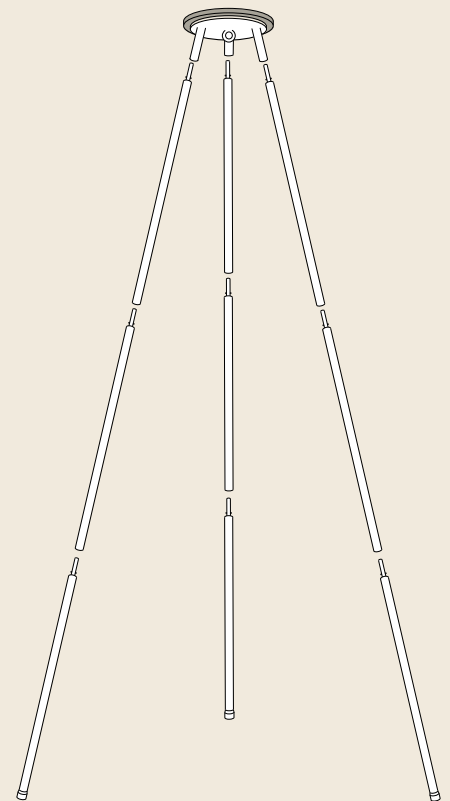

# Mounting

## Mounting a Baby Hammock, Twin Baby Hammock or Cradle

Connect the Hammock Spring with a safety snap hook to the eye bolt on the wooden top assembly. Do not use any chain or mounting strap above the Baby Hammock/ Cradle.

Please read the user manual for your Baby Hammock, Twin Baby Hammock or Cradle thoroughly before use.

## Mounting a Baby Hammock, Twin Baby Hammock or Cradle and a Moonboon Motor

The Stand is designed specifically for the Moonboon Baby Hammock with a Motor or a Cradle with a Motor.

First, attach the Motor to the eye bolt of the Stand using a safety snap hook. Attach the spring and then hang the Baby Hammock, Twin Baby Hammock or Cradle under the Motor, according to the product's user manual.

Orient both snap hooks with the narrow end towards the motor. Check that the snap hooks are hanging and locked correctly. Keep the power supply cord away from the Baby Hammock, Twin Baby Hammock, Cradle and the Stand.

Please read the user manual for your Baby Hammock/Twin Baby Hammock/Cradle or Motor thoroughly before use.

## **Please note**

Only use a stainless-steel safety snap hook without coating for mounting the Baby Hammock, Twin Baby Hammock, Cradle or Moonboon Motor in the Stand.

## **Please note**

The Moonboon stand is designed for the Moonboon Baby Hammock, Twin Baby Hammock, Cradle, and Motor. We can't guarantee that products from other brands can be adequately mounted or will function correctly with the stand.

# Important!

To avoid the Stand tipping over or tilting, never push the Baby Hammock, Twin Baby Hammock or Cradle back and forth or use it as a swing or toy.

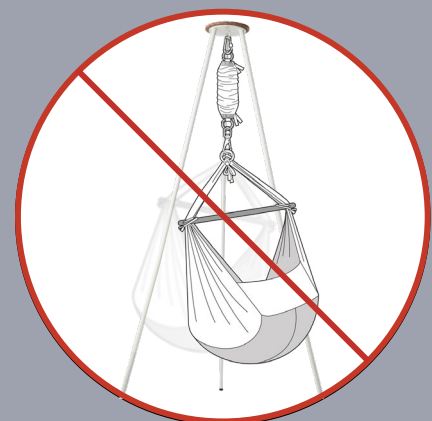

# Transportation

Easily disassemble the Stand for transport. Clear the parts from the eye bolt and put the Stand on its side. Disassemble the leg for carrying.

## **Please note**

Never move the Stand when in use or while your baby is in the Baby Hammock, Twin Baby Hammock or Cradle.

Always turn off the Moonboon Motor when making adjustments or moving the Stand.