

Alere iCup® Rx

Urine Drug Screen Procedure

For detailed instructions, please read the package insert.

Kit Contents

- 25 Alere iCup® Rx Test Devices
- 1 Adulteration Color Comparison Chart
- 1 Instruction Insert
- 25 Security Seals

Store at 4-30°C (39-86°F) in the original sealed pouch. Do not freeze.

Cup Components

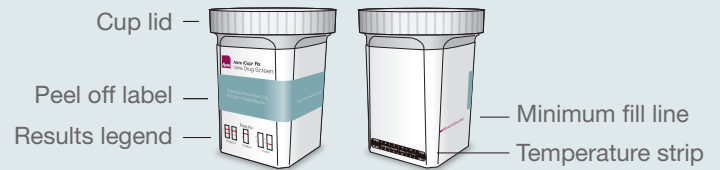

Collection and Testing Procedure

1 Collect sample and attach lid.



2 Verify the urine temperature is within acceptable range of 32-38°C (90-100°F).



3 Peel back label to reveal results.

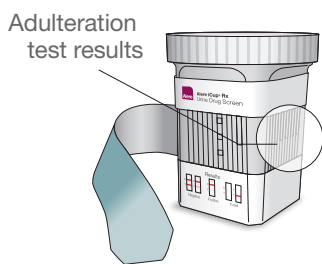

Adulteration on test result (if applicable)

If your cup is equipped with adulterant pads, verify that pad colors are within acceptable range according to the adulteration guide.

TEST STEP	TEST TIME	ACCEPTABLE		UNACCEPTABLE	
		LOW	HIGH	LOW	HIGH
Creatinine	45 seconds	Light Yellow	Yellow	Orange	Dark Orange
Specific Gravity	45 seconds	Light Blue	Blue	Dark Blue	Black
Oxidant Bleach	30 seconds	Light Blue	Blue	Dark Blue	Black

For illustrative purposes only. Please refer to color comparison chart included with kit.

Adulteration color chart

4 Wait 5 minutes, and read drug test result.



Drug test result interpretation



Drug test result area

Laboratory Confirmation

Preliminary positive drug test results

Apply security seal to preliminary positive specimens being sent for lab confirmation.

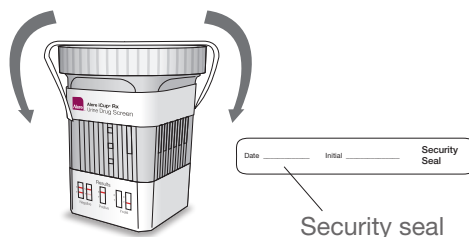

This assay provides only a preliminary analytical test result. A more specific alternative chemical method must be used in order to obtain a confirmed analytical result. Gas chromatography-mass spectrometry (GC-MS) and liquid chromatography-tandem mass spectrometry (LC-MS/MS) are the preferred confirmatory methods. Clinical consideration and professional judgment should be applied to any drug test result, particularly when preliminary positive results are indicated.

