

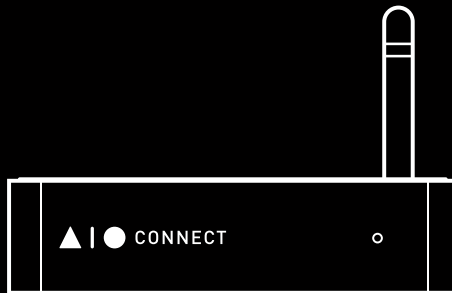

TRIANGLE  
MANUFACTURE ELECTROACOUSTIQUE



Mode d'emploi & Garantie  
Owner's manual & Warranty

---

TRIANGLE DISTRIBUTION FRANCE  
44 rue Barreyre - CS40099 - 33300 Bordeaux  
FRANCE

# USER MANUAL

---

# ENGLISH

## UNPACKING

Open the box and take out the device.

If you notice any defects in one of the elements as you unpack, please get in touch with your reseller. Your device is fragile and it is recommended to handle it carefully.

Before disposing of the packaging, make sure there is nothing left inside.

### EACH BOX CONTAINS:

- ▶ An AIO C and its antenna
- ▶ User manual
- ▶ 1x USB Cable
- ▶ 1x USB Power Adapter
- ▶ 1x Mini Jack - Mini Jack stereo cable
- ▶ 1x RCA - Mini Jack stereo cable

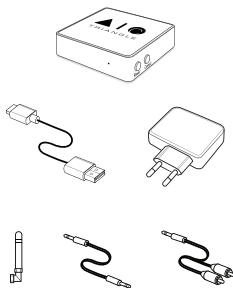

## INSTALLATION PRECAUTIONS

### Before the installation

Before connecting your AIO C, check the stability of the surface you want to install it on and reduce the distance between the speaker and your router as much as possible.

### Moving the device

Always remove the power cord and disconnect the cables between all audio components when moving the device. This will prevent a short-circuit or the damage to the plugs or connection cables.

### Locations to avoid

Avoid humid locations or direct sunlight. It is preferable to install your speaker in a temperate place.

### Recycling

Protection of the environment: your products contain valuable materials which can be recovered or recycled. **Take them to the appropriate collection points.**



# DEVICE DESCRIPTION

- 1. Control LED
- 2. Power switch
- 3. Network pairing
- 4. Wifi antenna
- 5. AC outlet
- 6. Optical input
- 7. Stereo Jack input
- 8. Ethernet cable input

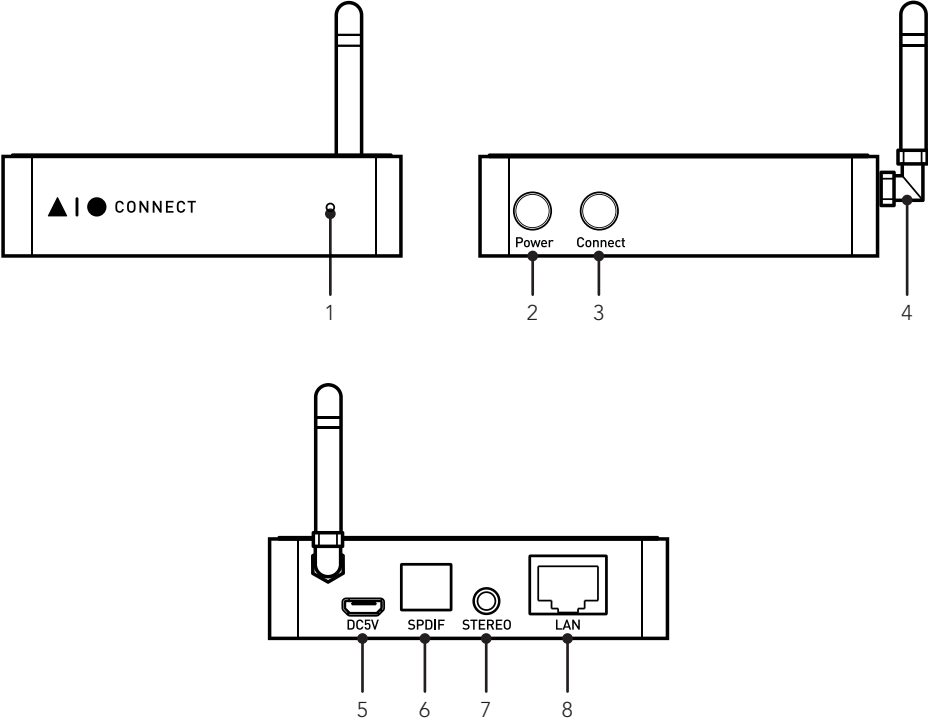

## NETWORK SETUP GUIDE

Network: You must have a router connected to broadband Internet to make the most of the streaming services.

Remember to check the reception quality of your WiFi network when setting up your product. A poor reception can affect the smoothness and the quality of your sound (see p.32 "Details of the device").

Your mobile device must be connected to the same WiFi network as your AIO system.

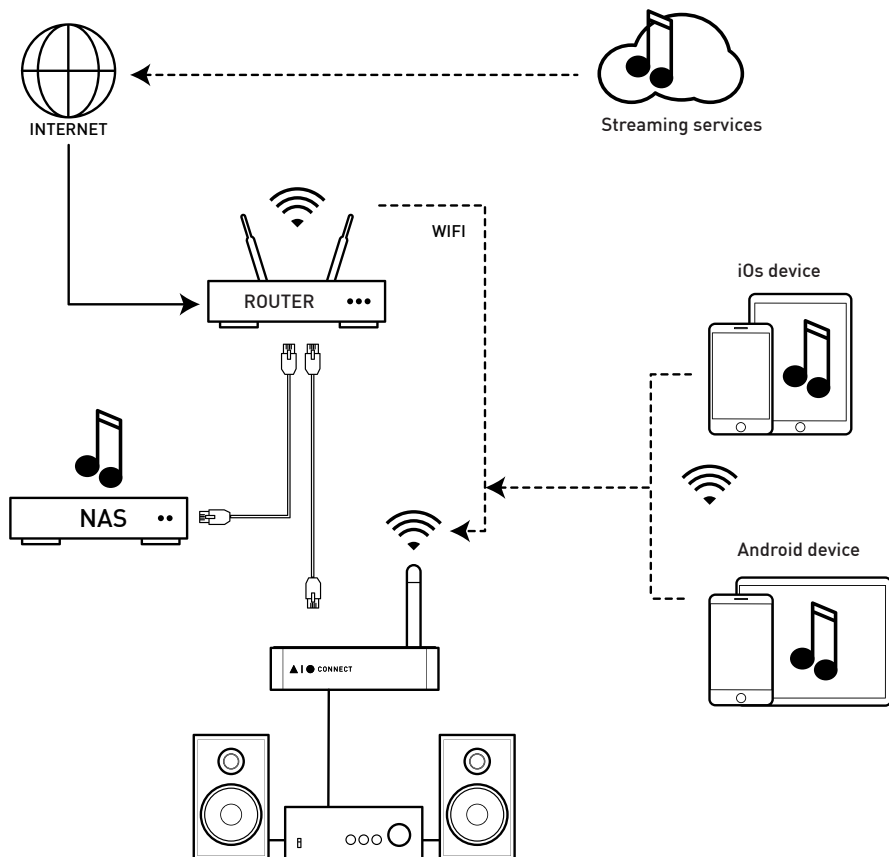

**Note :** the Ethernet cable is not provided.

## AUDIO CONNECTIONS

There are 2 types of connection possible:

- **JACK 3.5MM :**

Connect a 3.5mm/2xRCA Jack or 3.5mm/3.5mm Jack cable (depending on the type of input available on your amplifier), then select the source on your amplifier to enjoy your AIO C.

- **OPTIQUE :**

Connect an optical cable between your AIO C and your amplifier; the optical cable allows a better quality of listening if this input is available on your amplifier. Then select the optical source on your amplifier.

## NETWORK INSTALLATION

▶ Plug your AIO's power cord into a power outlet.

▶ **Connection by WiFi :**

- ▶ Press the Power button.
- ▶ Press the Connect button on your AIO C.

▶ **Connexion with an Ethernet cable :**

- ▶ Connect the Ethernet cable. In this case, your AIO C will automatically be recognized on your network without any necessary configuration.

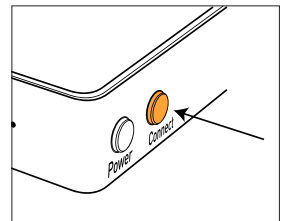
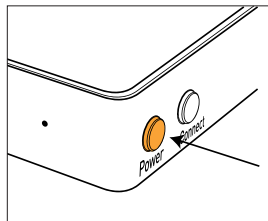
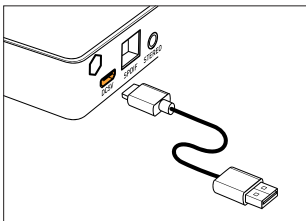



## Download the app

Go to your store (App Store or Google Play) and download the app **TRIANGLE AIO**.

## Launch the app and follow the instructions.

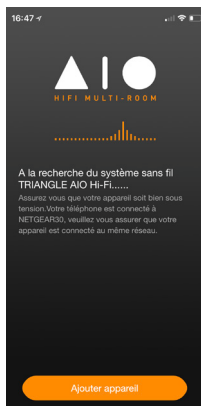

1. Press «Add device».

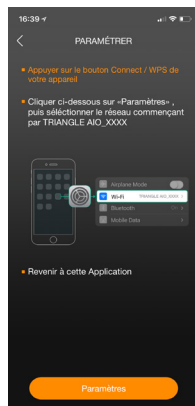

2. The app opens your configuration tool to find the WiFi network «TRIANGLE AIOC-XXX».

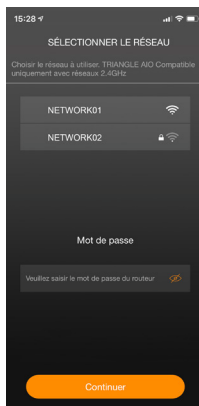

3. Once you are connected to the WiFi of your AIO, go back to the app. Select your WiFi network and enter the password.

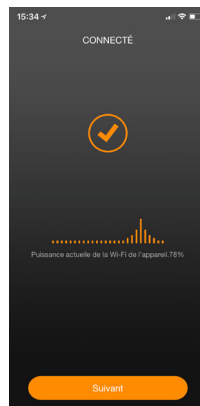

4. Your AIO C is ready to operate.

## APP OVERVIEW

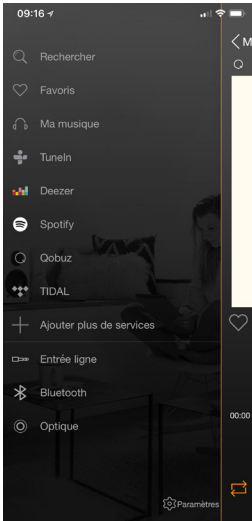

Sources

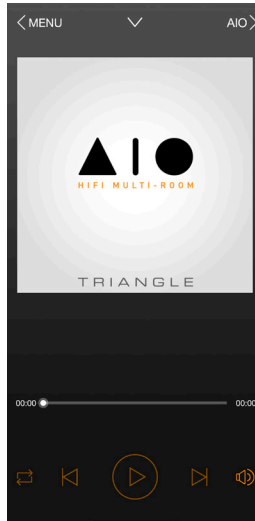

Playback Screen

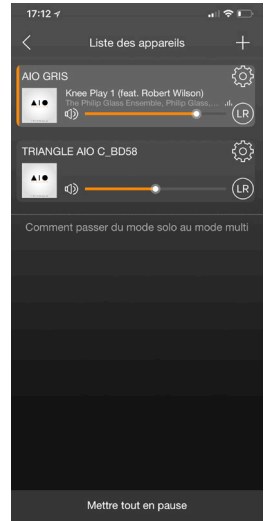

AIO devices

← The navigation is in 3 panels.  
Just swipe the screen from left to right  
to make them appear. →



# 1. Playback screen

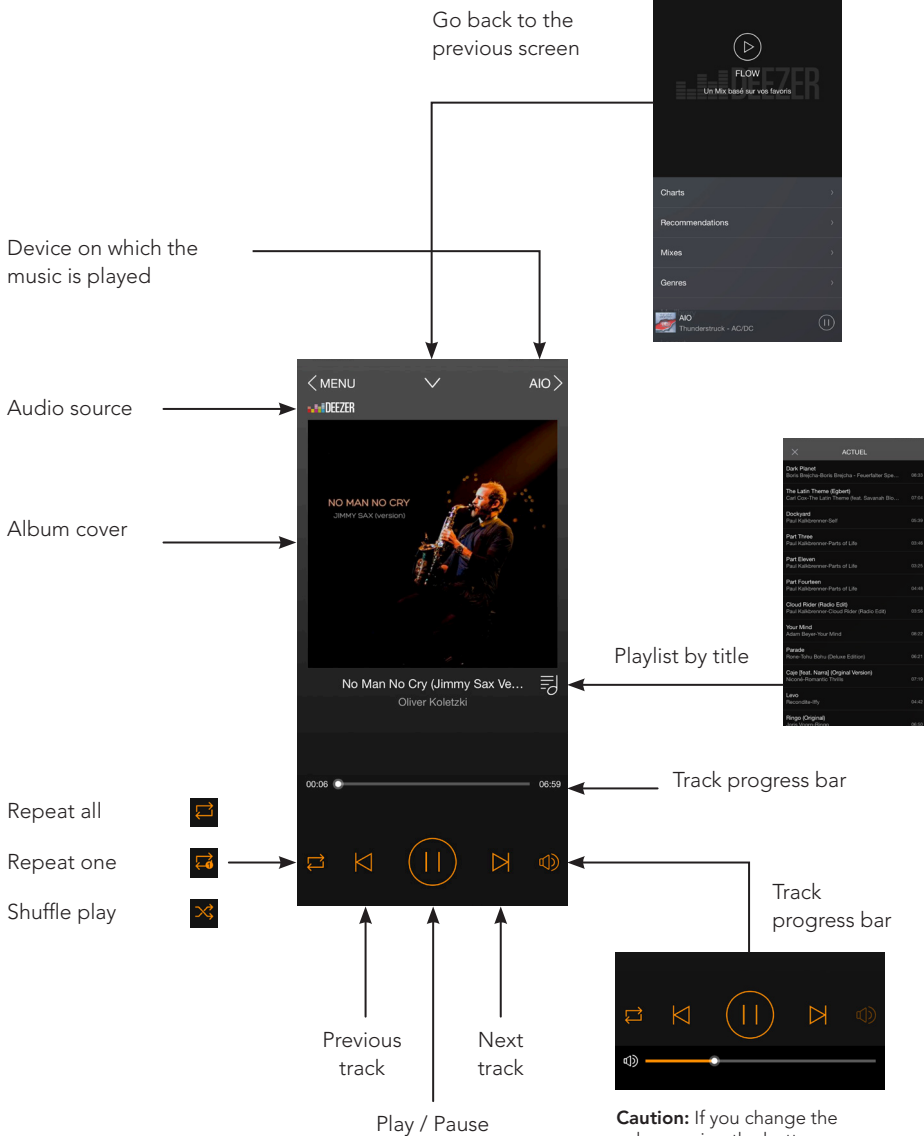

**Caution:** If you change the volume using the buttons on your mobile device, there may be some latency and large increments. For fine adjustments, use the screen of the app.

## 2. List of connected AIO

Album cover of the track being played

Each speaker can play a different song.

Speaker volume

The default setting is in stereo (LR).

It is possible to assign a speaker only to the right channel or to the left one by pressing this function.

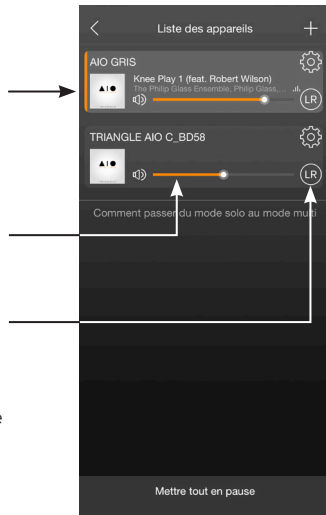

Add an AIO device to the network (p.27)

Settings

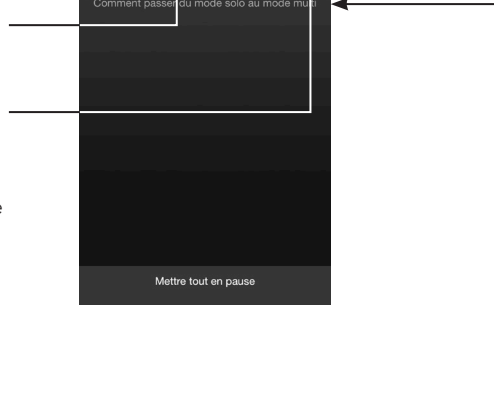

### Grouping AIO devices

The "Party Mode" allows to connect up to 5 devices using one WiFi connection and up to 10 devices using an Ethernet connection.

It is possible to designate the speaker as a Left speaker (L) or a Right speaker (R).

The default setting is in mixed mode (left and right - LR).



### 3. Settings

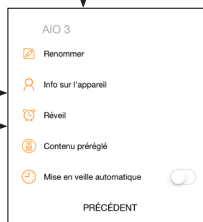
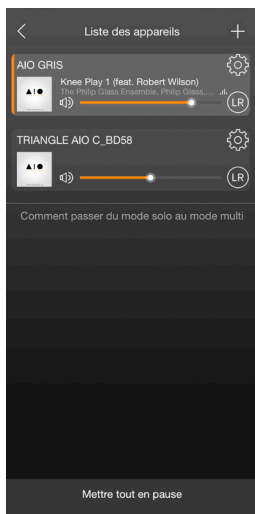

Renaming the speaker

Favorites

Setting the Auto Power-Down (the sound stops but the device remains connected)

#### Details of the AIO



#### Setting the alarm

In order to ensure that the alarm works, leave your device turned on.



Quality of the WiFi signal

Hotspot

AIO3 has the "hot spot" function, it can manage your own WIFI network and extend your current WIFI network.

You just need to activate this function in the APP and define a password.

### 4. Sources

**Search :** to quickly access the music saved on your mobile device.

**Favorites :** To quickly access your favorite track on your mobile device.

**Tuneln** gives you access to all the digital radios.

**Spotify :** see next page.

**Deezer - Qobuz - Tidal**  
You need a subscription to access these services.

Adding or removing services from the menu

Source selection

**My playlists :**  
Create a playlist from the songs saved on your mobile device.

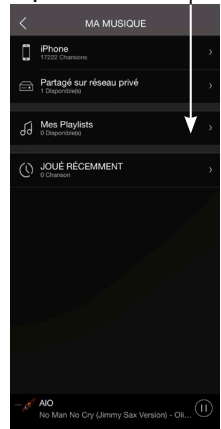
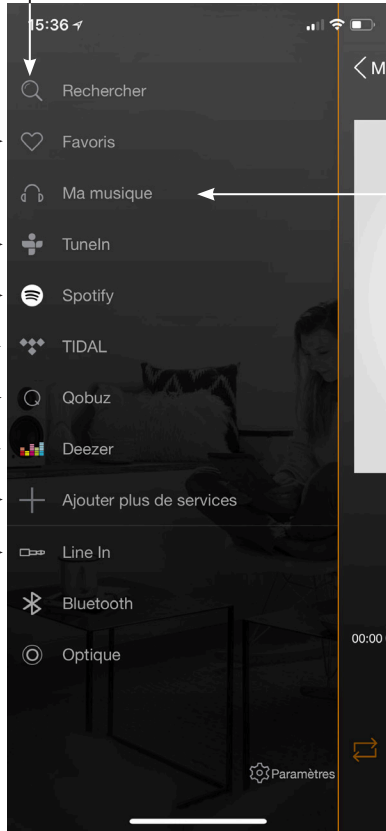

**My music :** The AIO speaker lets you play music you downloaded on your phone and access the music stored on a NAS drive on your network or on your connected USB drive.

You must allow the app to read the musical content on your mobile device (see Settings of the TRIANGLE AIO app in the general menu on your mobile device depending on your iOS or Android system).

To be able to access your songs, they must be saved directly on your phone. Some tunes might be protected by DRM technology which will prevent you from playing them.



Your new speaker has Spotify Connect built in.

Spotify Connect lets you control the music playing on your device, using the Spotify app on your mobile, tablet or PC. Listening is seamless. You can take calls, play games, even switch your phone off – all without interrupting the music. Learn more at [spotify.com/connect](https://www.spotify.com/connect)

The Spotify software is subject to third party licenses found here: [www.spotify.com/connect/third-party-licenses](https://www.spotify.com/connect/third-party-licenses)

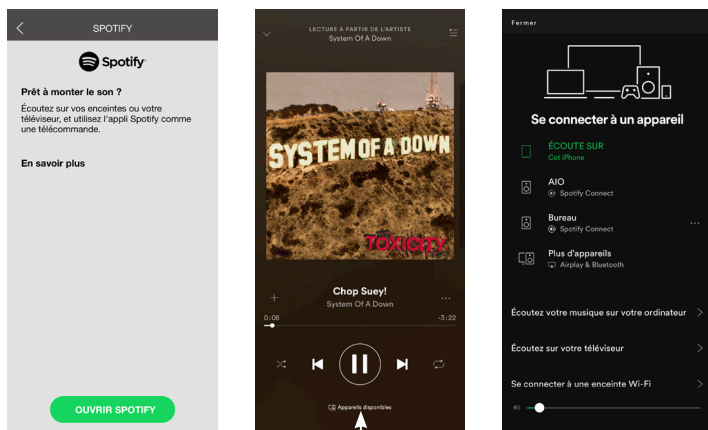

Choosing your speaker

### Listen out loud with Spotify connect

1. Connect your TRIANGLE AIO device to your WI-Fi network
2. Open up the Spotify app on your phone, tablet or laptop using the same Wi-Fi network
3. Play a song and select Devices Available
4. Select your TRIANGLE AIO device and start listening

The Spotify software's subject to third party licence found here: [www.spotify.com/connect/third-party-licenses](https://www.spotify.com/connect/third-party-licenses)

**Listening yo music in high definition:**

To listen to music in high definition, you must have a subscription with a provider and set up the dedicated app.

Example on the Qobuz app >>

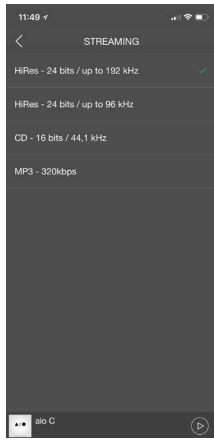
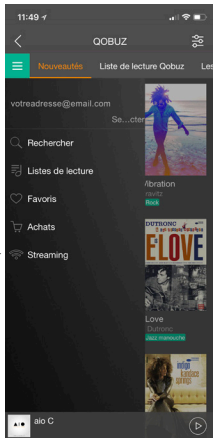

## TROUBLESHOOTING

If the device does not work correctly, check the points listed below. If the problem persists, the device may not operate normally. Unplug the power cord immediately and get in touch with your reseller.

OBSERVATION	SOLUTION
My AIO does not connect to the network.	<p>Check that your mobile device is connected to the network on which you are trying to connect your AIO.</p> <p>Place your AIO closer to the router.</p> <p>Connect an Ethernet cable between your router and the AIO.</p> <p>Check that your app is up to date, or reinstall it.</p> <p>Restart your mobile phone and your network.</p>
The music is cutting out or jerky.	<p>Check the Internet connection.</p> <p>Make sure your network or another device is not using a large part of your bandwidth.</p> <p>Check the quality of the WiFi signal (see p.29)</p> <p>Check that your app is up to date, or reinstall it.</p> <p>Restart your mobile phone and your network.</p>

## FREQUENTLY ASKED QUESTIONS

How many speakers can I group?	AIO can group up to 5 speakers in WiFi, 10 via Ethernet, if the quality of the connection is good enough.
What happens when I get a call on my mobile phone while I use the app?	The music continues to play on your speaker without interruption.
Can the AIO play songs in high resolution (High Res)?	The AIO can play songs up to 24 bit/192 kHz, but be careful, you must have a good Internet connection and your streaming app must be set-up correctly.

**CAUTION**

To avoid the risk of electric shock, do not open the device.



# AIO CONNECT

---

Spécifications techniques Technical specifications	AIO C
<b>Connectivité / Connectivity</b>	
Réseau sans fil Wireless network	IEEE 8.2.11b/g/n 2.4GHz Ethernet
Branchement Wired connectivity	Single 10/100M RJ45 Jack
Fréquence Frequency Response	20Hz - 20KHz
Alimentation Power input	5V-1A
Entrée audio Audio input	USB 2.0
Formats audio Music file formats	MP3 - AAC+ALAC - FLAC - AOE - WAV
Dimensions	L80 x P80 x H20 mm L3.15 x W3.15 x H0.79"
Poids Weight	160g 0.35 lbs

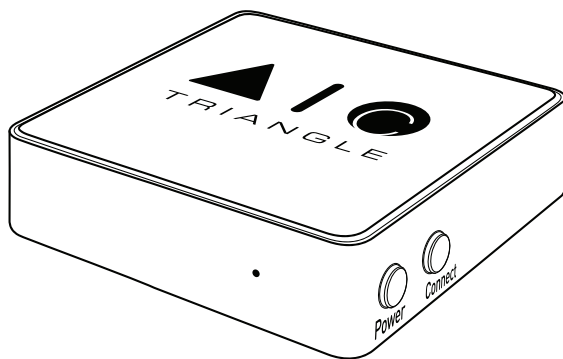

AIO C



TRIANGLE

MANUFACTURE ELECTROACOUSTIQUE